

REAR MOUNTED CULTIVATOR

ASSEMBLY

1. Attach parallel bars to draw bar assembly as shown at (1) and (1). Lock with jam nut so that bars are free to swing.
2. Attach depth crank (2) at (3) and (3). Adjusting nuts should be equally spaced on threads.
3. Clamp wheel standards to draw bar assembly as shown at (4) and (4).
4. Clamp gang tool holders to tool bar as shown at (5) and (5).
5. Attach the four tool standards to the right and left tool frame assemblies as illustrated at (6).
6. Assemble upper and lower tool control handle as shown.
7. Attach tool handle assembly (7) to draw bar assembly using clamp as shown. Be sure the tool handle is installed, especially when cultivating straddling the row. The close control which the handle allows protects the young plants.
8. Bolt a cultivator shovel to each tool holder as shown at (8).

INSTRUCTIONS AND PARTS LIST

ADJUSTMENTS

Attach cultivator to tractor with draw bar pin. Place tractor and cultivator on flat surface, such as cement drive or walk. Adjust clamp (5) so that each of the center shovels are of equal height. Then adjust the four tool standards (6) so that the shovels are the same height as the two in the center.

The adjustment for the height of the handles is in the draw bar end. Loosen nuts (A), set handles at desired height, then tighten nuts securely. The depth crank (2) regulates the depth of cultivation and raises tools for transporting.

MAINTENANCE

Grease wheel bearings daily.

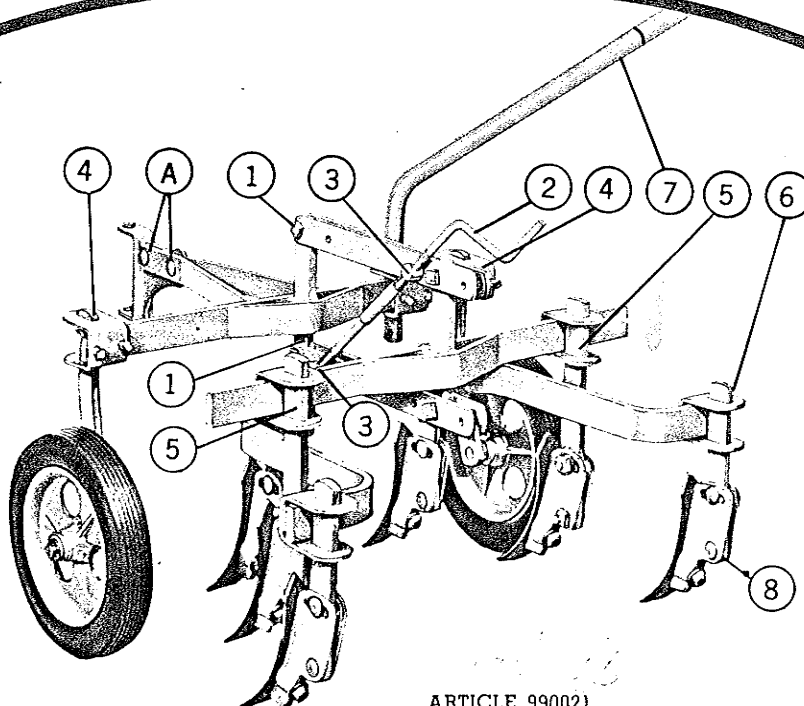

ARTICLE 990021

3/8-16 X 1 1/2 Cammige Bolt 70203

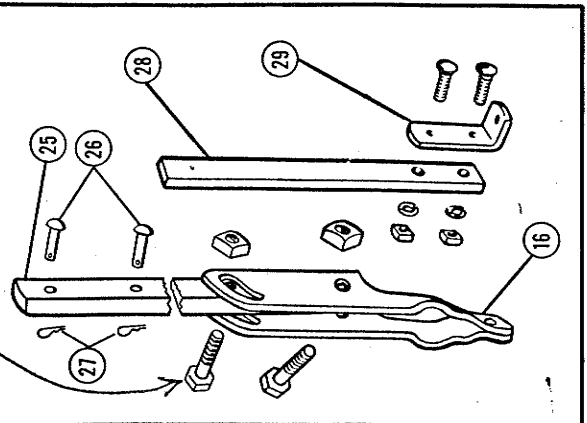
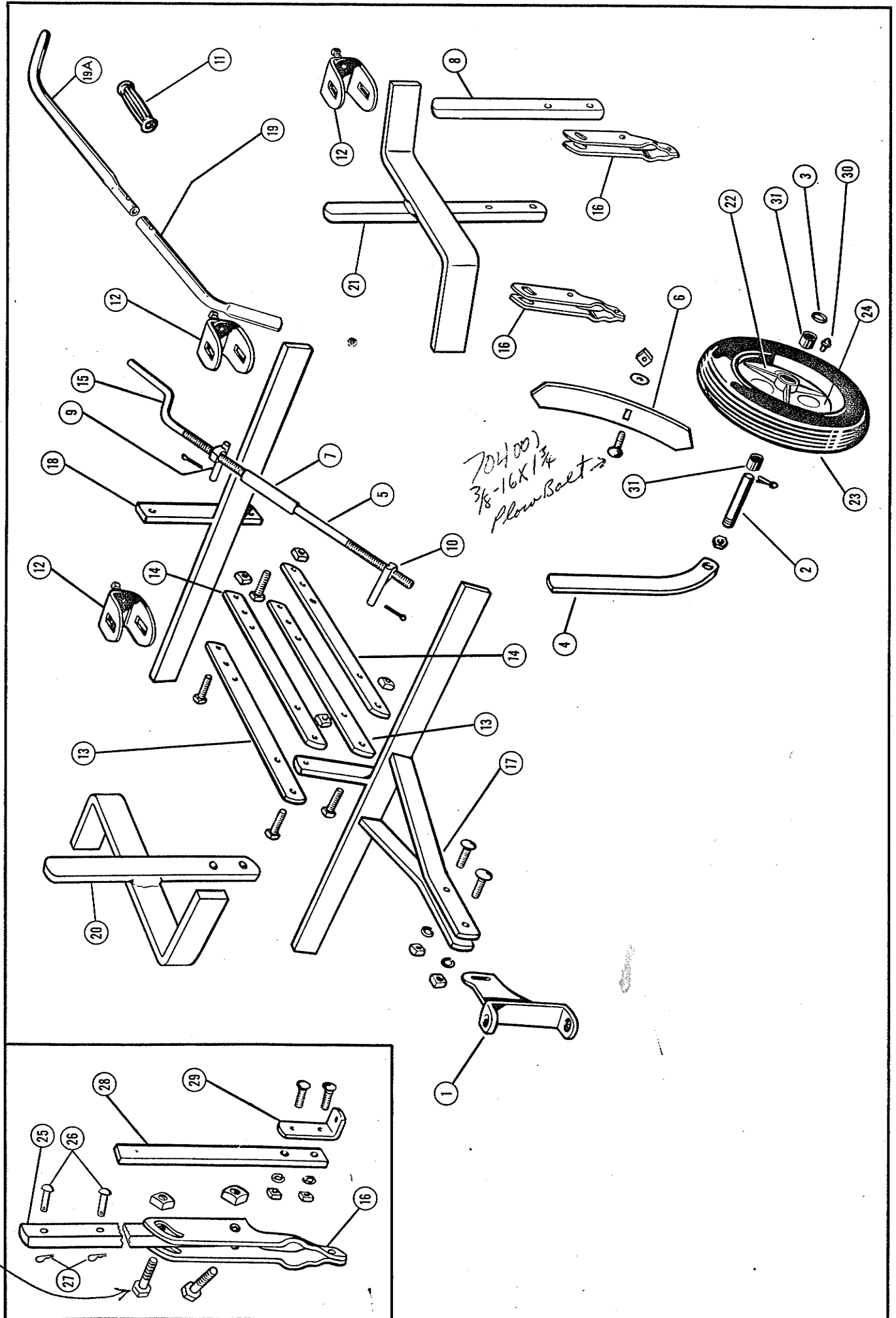

OPERATION

The garden can be more easily cared for by planting rows the long way of the plot.

Select the proper cultivating steels so the maximum results are obtained. Seedlings require different attention than sturdy plants.

On well-prepared land the 6-inch weeding hoe is the ideal tool for cultivating little seedlings. Under trash conditions the wide angle of the 12-inch weeding knife tends to clear itself of trash. These are both surface-type tools for mulching and shallow cultivation. Do not set these tools too deep as they should only break up the crust without throwing dirt. The duck-foot cultivator teeth are recommended for maintaining a mulch when the land is comparatively free from weeds.

The following list shows row spacings for various crops. The tallest plants are in wider rows to permit your tractor to work the middles when plants get too tall for straddle cultivation. Vegetables requiring the same spacing should be planted together and in continuous rows so the tractor can work the longest period of time.

Beans (bush)	16-18	Leeks	16
Beets	15	Onions (green)	15
Brussel sprouts	36	Parsley	15-18
Cabbage	36	Parsnips	15-18
Carrots	15	Peas (green)	18
Cauliflower	36	Peppers	30-36
Celeriac	30	Potatoes	42-48
Celery	30-36	Radishes	14
Corn (sweet)	30-36	Rhubarb	36-48
Eggplant	36	Spinach	15-18
Kale	18	Tomato	42-60
Lettuce	15-18	Turnips	12-18

NOTE: Since the principal purpose or function of cultivation is weed control, it follows that cultivation should be done at the time most favorable for killing weeds, which is just as they are breaking through the surface. Practically all the benefits derived from cultivation are secured from shallow cultivation. Deep cultivation, if practiced, should be carried on during the early stages of growth and the depth lessened as the plants grow larger and the roots increase in length. All tools on this cultivator have an individual adjustment for depth and an individual adjustment for pitch.

How to Order Repair Parts for Simplicity Garden Tractors and Attachments

The Authorized Simplicity dealer from whom you purchased your tractor and attachments can supply you with any replacement parts you may need. For prompt service, be sure to see your dealer first. He will furnish the correct parts from his stock or order them for you if necessary. However, you may mail-order directly from the factory.

To have your order filled correctly and for prompt ser-

vice, please furnish the following information:

1. Model, number and year of purchase of tractor or attachment.
2. Part number, description, and quantity of part. (See parts list)

Be sure to include postage with your order. We do not pay transportation charges. Shipping weights are shown. Any excess will be promptly refunded.

We reserve the right to change construction, specifications, prices and terms, without notice and without obligation as to tractors and attachments heretofore shipped.

PRICES SHOWN ARE U.S.A. PRICES. PRICES OUTSIDE OF U.S.A. SUBJECT TO LOCAL IMPORT DUTIES, TAXES, ETC.

CULTIVATOR PARTS LIST

Order by Part Number

Item No.	Part No.	Name of Part	Ship. Wt.	
			Lbs.	Oz.
1	SSA7A	Draw Bar End	1	8
2	SSA54A	Gauge Wheel Spindle		6
3	SSA55	Gauge Wheel Washer		2
4	SSA-A3	Gauge Wheel Standard 112057	2	6
5	SSA-A9	Lower Screw Member		6
6	SSA-A14A	Cultivator Steel with Bolt		8
7	SSA-A17	Adjustment Coupling		8
8	SSA-A18	Tool Standard — Short	2	
9	SSA-A21	Upper Adj. Nut		8
10	SSA-A22	Lower Adj. Nut		8
11	DA-76A	Handle Grip		8
12	SSA-A23	Shank Clamp	1	8
13	SSA-B2A	Parallel Bar (Right)—Unthreaded	1	10
14	SSA-B3A	Parallel Bar (Left)—Threaded	1	10
15	SSA-B8	Upper Screw Member	1	8
16	SSA-AX3	Tool Holder Assembly	2	
17	SSA-BX1A	Draw Bar Assembly	15	
18	SSA-BX2A	Tool Bar Assembly	12	4
19	117005	Handle, Control, Upper	2	4
19A	117006	Handle, Control, Lower	2	4
20	SSA-CX3	RH Tool Frame Assembly	7	8
21	SSA-CX4	LH Tool Frame Assembly	7	8
22	SSA-AX6	Wheel complete w/Juvenile Tires 10 x 1.75	10	
23	SSA-A240	Tire — 10 x 1.75	3	
24	SSA-B28	Wheel Only	6	
30	..	#1641 Grease Fitting		2
31	SSA-A27	Wheel Bushing		4

REPAIR PARTS

8" FURROW OPENER AND EXTRA STRAIGHT STANDARD PARTS LIST

Order by Part Number

Item No.	Part No.	Name of Part	Ship. Wt.	
			Lbs.	Oz.
25	SSA-B13	Standard	3	
26	SSA-A15	Pin		2
27	SSA-A45A	Spring Clip		2
16	SSA-AX3	Tool Holder Assembly	2	

6" HILLING BLADES, 12" WEEDING KNIVES AND 6" WEEDING HOES PARTS LIST

Order by Part Number

Item No.	Part No.	Name of Part	Ship. Wt.	
			Lbs.	Oz.
28	SSA25	Tool Standard	2	4
29	SSA105	Tool Holder		10

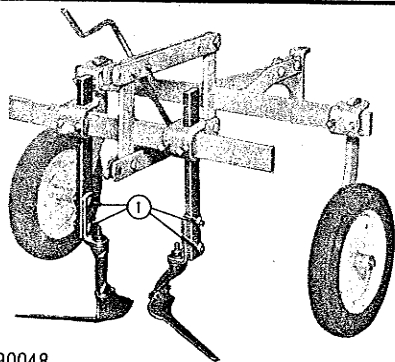

ARTICLE 990048

6-INCH WEEDING HOES. Assemble as shown. With cultivator attached to tractor and on a level surface, loosen bolts (1) and set knife edges level with surface. The 6-inch weeding hoes are recommended for weeding, mulching, and shallow cultivation. They break up crust without throwing dirt. The high shields protect small plants and permit very close cultivation. Attach to the gang tool holder as shown.

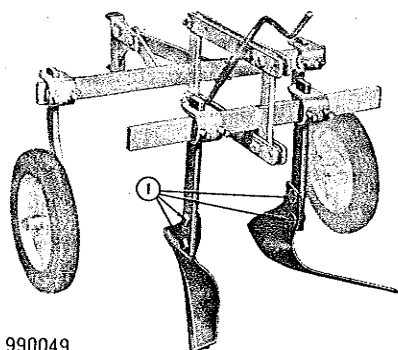

ARTICLE 990049

12-INCH WEEDING KNIVES. Assemble knives to standards as shown. Bolts (1) provide adjustment to level cutting edge. The high shields protect leaves and plants, and the knives are shaped to work close to the row at the surface while curving away from the roots underneath. The wide angle cutting edge clears trash more readily than most surface tools.

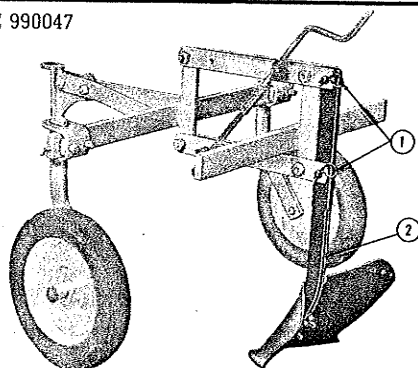

ARTICLE 990047

8-INCH FURROW OPENER. Attach standard (2) to cultivator frame as shown with pins (1). Furrow opener may be adjusted for pitch by loosening the two bolts in the tool holder assembly and adjusting pitch of furrow opener as desired.

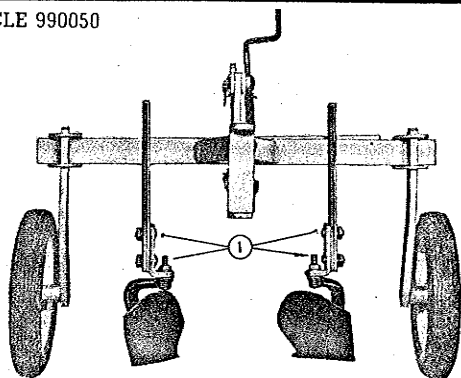

ARTICLE 990050

6-INCH HILLING BLADES. Attach blades to standards as shown. Loosen bolts (1) to adjust blades to desired pitch. These blades are recommended for closing furrows and light hilling operations.

EXTRA STRAIGHT STANDARD

Pictures A, B, and C show an extra straight standard recommended for adapting a wide variety of cultivating tools as shown. These tools are not supplied by Simplicity but are available in most farm implement stores.

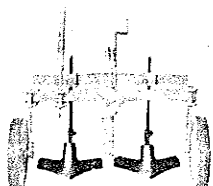

A

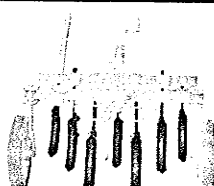

B

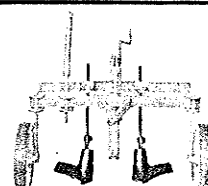

C