

REMINGTON®

POWERCLEAN™
TITANIUM Shaving System



*Use and
Care Guide*

R-1000

IMPORTANT SAFETY INSTRUCTIONS

When using an electrical appliance, basic precautions should always be followed, including the following.

Read all instructions before using this appliance.

DANGER

To reduce the risk of electric shock:

- Do not reach for an appliance that has fallen into water. Unplug it immediately.
- Do not place or store this appliance where it can fall or be pulled into a tub or sink.
- Do not place in or drop into water or other liquid.
- Except when charging, always unplug this appliance from the electrical outlet immediately after using.
- Unplug this appliance before cleaning it.
- Do not use while bathing or in a shower.
- Use only when the shaver is in dry condition.
- Detach the appliance from the power supply cord before cleaning.
- Do not submerge in water.

WARNING

To reduce the risk of burns, fire, electric shock or injury to persons:

- This appliance is for household use only.
- Close supervision is necessary when this appliance is used by, on, or near children or invalids.
- An appliance should never be left unattended when it's plugged in except when charging.
- Use this appliance only for its intended use as is described in this manual. Do not use attachments not recommended by Spectrum Brands, Inc.
- Keep the cord away from heated surfaces.
- Never operate this appliance if it has a damaged cord or plug, if it is not working properly, if it has been dropped or damaged, or if it has been dropped into water. If any of these things happen, return the appliance to an authorized service center for examination and repair.
- Never operate the appliance with the air openings blocked or while on a soft surface, such as a bed or couch, where the air openings may be blocked. Keep the air openings free of lint, hair, and the like.

- Never drop or insert any object into any of the appliance's openings.
- Do not use outdoors or operate where aerosol (spray) products are being used, or where oxygen is being administered.
- Always store this appliance and cord in a moisture-free area. Do not store it in temperatures exceeding 140°F (60°C).
- Do not plug or unplug this appliance when your hands are wet.
- Do not wrap the cord around the appliance.
- Plug charger directly into receptacle-do not use an extension cord.
- Before plugging in, read the information about dual voltage contained in the instruction section of this manual.
- Always attach plug to appliance first, then to outlet. To disconnect, turn all controls to "off" then remove the plug from outlet.
- Unplug charger before plugging or unplugging appliance.
- Do not use this appliance with a damaged or broken head or cutters, as facial injury may occur.
- Shavers, including the trimmer, are for use on facial hair only. It should not be used for shaving the hair on your head or any other part of your body.
- Use only on a level surface.
- Unplug the cleaning base before filling. Fill reservoir with Remington® cleaning solution only. Do not overfill.

SAVE THESE INSTRUCTIONS

Contents

English1
 Spanish17
 French35

Product Features

Shaver Parts

- (A) Head guard
- (B) Head & cutter assembly
- (C) ComfortSelect™ lever
- (D) On/off button
- (E) Percentage of charge 6 LED's
- (F) Hair pocket release button
- (G) Cleaning brush
- (H) Storage pouch
- (I) Charger
- (J) Trimmer button

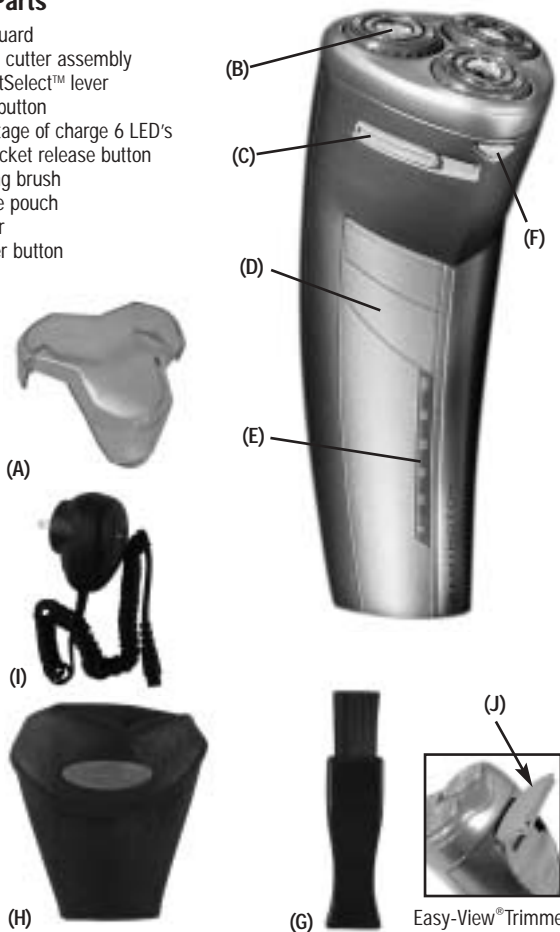

Titanium PowerClean System

Congratulations on your purchase of a premium Remington® PowerClean™ System with Revolutionary Shaving Technology.

	Power system	Run time	Quick charge	Complete Battery Gauge	Worldwide voltage	Washable
R-1000	Cord/cordless	60 min	x	x	x	x



R-1000
 ■ Full battery gauge

Worldwide Voltage

■ You can take your shaver with you when you travel to just about anywhere in the world. Your shaver features worldwide automatic voltage conversion providing AC current between 100-240 volts AC, 50-60 Hz. Just plug it in to the local outlet (you may need an adapter plug) and use as usual. Your shaver will convert automatically to the local current requirements.

Power System

■ Cord/Cordless shavers can be used with or without the cord. They do not recharge during use, however, and frequent corded use will result in reduction of battery life.

Product Features (continued)

Power Clean System

The Remington® PowerClean System automatically cleans, charges, and renews your shaver.

The cleaning base also serves as a storage unit. For peak performance of your shaver, clean it daily by pushing the CLEAN button.

During the automated cleaning process, the shaver is switched on and off at intervals to obtain best cleaning results. Since the specially formulated cleaning fluid also contains a small amount of oil, the cleaning procedure also fulfills the lubrication needs of your shaver.

NOTE: Remington® recommends cleaning your shaver daily for optimum shaving performance.

NOTE: With daily cleaning, the solution will last about 4 weeks. The cleaning solution, if not used daily, will last longer. Normal evaporation will occur even when the unit is not being used. In hot, humid weather, solution may evaporate more rapidly.

- Use only the power supply cord supplied with this product.
- In order to avoid any leakage of the cleaning fluid, place the cleaning base on a flat table surface. Be careful not to tip, move suddenly, or transport in any way if the base is filled with the cleaning fluid.
- Do not place the cleaning base in a cabinet or any other enclosed area unless the solution is empty. Do not store it over radiators, nor place it on polished, lacquered, or any other surface that is susceptible to damage by isopropyl alcohol. Always operate and store it in a well ventilated area.
- To avoid evaporation, do not expose cleaning solution to direct sunlight.
- The cleaning base contains highly flammable liquid. Keep it away from sources of ignition. No smoking. Keep out of reach of children. Discard cleaning solution bottle after contents have been poured into the cleaning base.
- When cleaning the shaver, its clear plastic head guard must be removed.

Cleaning System Parts

Cleaning System Parts

- (A) Shaver
- (B) Cleaning base
- (C) Cleaning light (amber)
- (D) Charging light (blue)
- (E) Replace solution indicator light (red)
- (F) Cleaning button
- (G) Latch buttons
- (H) Cleaning Solution bottle
- (I) Filter
- (J) Safety power plug

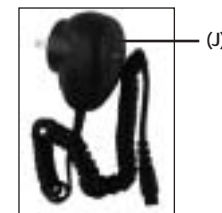
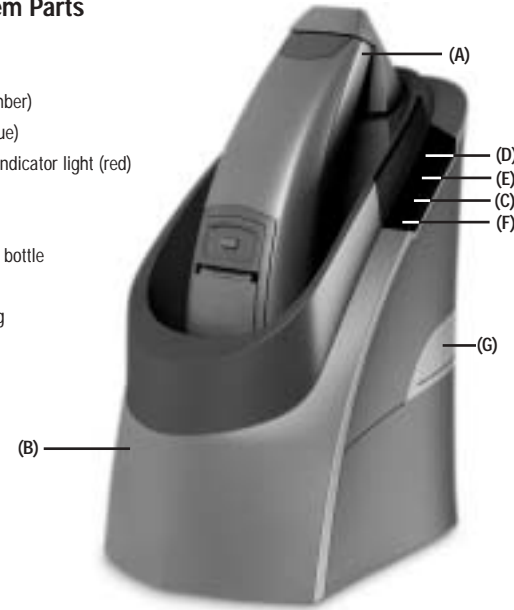

How To Use

Before using read the important safety instruction section in front of the manual.

Preparing the System

Cleaning solution:

1. Press the latch buttons on the sides of the cleaning base and lift the upper portion off the unit. You will need to keep the buttons pressed in as you move the upper portion away from the base. The cleaning solution tank is in the unit's bottom portion.

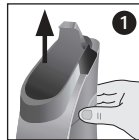

2. Remove the filter from the tank and set aside.

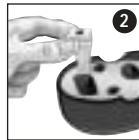

3. Pour the bottle of cleaning solution into the base of the unit through the opening where the filter was removed.



4. Place the filter back into its original position.

NOTE: It is important to make sure the filter is in place. The filter collects hair clippings and debris, and should be replaced along with the solution. Failure to do so will permanently clog the system rendering it inoperable.

5. Replace the top portion of the cleaning base by lining up the three posts with the three holes in the tank. Push the top portion down until the two latches click into place.

8

6. You can dispose of the bottle and cap with your normal trash, or recycle where local ordinances apply.

Charging

Prior to using your shaver for the first time, put it on charge for 24 hours.

NOTE: It may take up to 3 cycles for the battery to reach full capacity.

Using Cleaning Base

Plug the power cord into the cleaning base and then into an electrical outlet.

Make sure arm is in the up position before inserting shaver. Push down to release arm. It will "pop-up".

Place the shaver into the unit, head side down, and slide its "tail" toward the "neck" of the base until it stops.

Push the arm down until it contacts the shaver (clicks into place).

Charging

Your shaver automatically begins to recharge as soon as it is in place in the cleaning base. While it is charging, the blue indicator light will flash; when it is fully charged the blue light will stop blinking and glow steadily.

Your Shaver can also be recharged by plugging it into the cord directly.

- Use only the charging adapter supplied with the shaver.
- Make sure your shaver is turned off.
- Connect the cord to the shaver, then plug the charging adapter into the electrical outlet. A charging indicator light will come on.
- Your shaver cannot be overcharged, so you can leave it plugged in and charging between shaves.

- To preserve the life of the batteries, let them fully run out every six months, then recharge them for a full 24 hours.

- Cord/cordless rechargeable shavers can run directly off the cord if necessary. They will not recharge while you are shaving, so after shaving with the cord, turn the unit off and set it aside to charge. Cord/cordless shavers should not be used strictly as cord-operated shavers, as continued cord-only use will result in reduction of battery life.

- Quick Charge provides up to 60 min. of shaving after a one-hour charge, or a single shave after a five-minute charge.

NOTE: If your shaver battery is completely discharged or the shaver has not been used for a long time, the shaver may not start when operated using the cord. If this happens, charge the shaver for approximately five minutes before shaving.

NOTE: It may take up to 3 cycles for the battery to reach full capacity.

Operating the Cleaning System

Cleaning

To activate cleaning mode, simply press the CLEAN button on the cleaning base. The amber indicator light flashes through the entire cleaning cycle, which lasts approximately 2 minutes. When the cleaning cycle has been completed, the amber light will stop blinking and glow steadily. The unit then returns to charging mode.

! Wait until the cleaning cycle has finished before removing the shaver from the base. If the shaver is removed during the cleaning cycle it will be covered with cleaning solution and be unusable.

Shaver should be left in cleaning base for 24 hours to allow it to dry for next usage.

Solution levels

The cleaning solution will slowly evaporate with use. When the solution levels get low, the red replacement indicator light will begin to flash. This means you have enough cleaning solution left for approximately 5 more cleanings. If the red light stops blinking and glows steadily, the unit will not operate until the solution and filter have been replaced.

Replacing the Filter and Solution

Only Remington's special cleaning solution and filter can be used with the Power Clean System. The cleaning solution contains a high percentage of alcohol and a special oil that lubricates your shaver each time it is cleaned. The filter is specially designed to collect hair debris yet allow for the system to clean your shaver.

Remove and discard filter and empty any remaining cleaning solution. Rinse unit tank then let dry. Fill with fresh solution, insert new filter and replace upper portion.

Wipe off the unit periodically with a damp cloth and remove any hair debris that has collected where the shaver sits.

9

How To Use

NOTE: To avoid damage to the cleaning system, use only Remington's special cleaning solution.

Remington's replacement solution and filter is model #CC-100. U.S. residents: To order, contact us at (800) 231-8793, www.remington-products.com, or visit your local retailer.

Canadian residents: For shaver accessories, call (800) 268-0425.

Model R-1000

A blue lighted fuel gauge displays the amount of charge remaining in 20% increments. When only 20% of the charge remains, the recharge red warning light illuminates.

Troubleshooting:

- If your R-1000 shaver battery is completely discharged or the shaver has not been used for an extended period of time, the shaver may not start when operated using the cord. If this condition occurs, charge the shaver for approximately five minutes before shaving.
- Your cord/cordless shaver should not be used strictly as a cord-operated shaver, as continued cord only use will result in reduction of battery life.
- In order to preserve the life of the batteries, they should be fully discharged every six months and then fully charged for 24 hours.

Cleaning & Maintenance *(without using base)*

Cleaning your shaver

TO ASSURE OPTIMAL PERFORMANCE, IT IS RECOMMENDED THAT YOU CLEAN YOUR SHAVER AFTER EACH USE.

Before cleaning, detach the handheld unit from the power supply cord before cleaning. The cutting system of this shaver was designed to be cleaned by rinsing under warm running water or by brushing.

Cleaning your Remington® branded shaver is easy.

- Open the hair pocket by pressing the release button and rotating away from the body of the shaver.

You may blow out the stubble thoroughly, or rinse the shaver head in water. Rinse both sides of the head assembly.

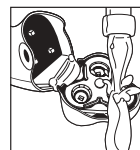

- **At Least Once a Week:**

For more complete cleaning, remove the cutter retainer assembly from the hair pocket by turning the center knob approximately 1/4 turn counter clockwise. Hold cutter retainer assembly as shown, and remove head by turning approximately 1/8 turn in the direction shown. Brush clean both the head and the cutter.

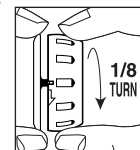

Reassemble head to cutter retainer assembly by aligning and turning head 1/8 turn in the opposite direction. Repeat this process for each of the 3 heads. Clean each head and cutter set one at a time to prevent mixing cutter components. (These should be kept as sets). After cleaning, place cutter retainer assembly in the hair pocket, and secure by turning center knob approximately 1/4 turn clockwise.

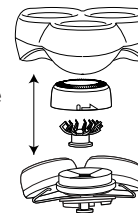

Caution: Never put the shaver completely under water. Do not use any aggressive cleansing agent as this may destroy the shaver coatings.

- To clean and lubricate your shaver's cutters and head assembly, apply Remington® Shaver Saver® (SP-4) Lubricant. The lubricant helps remove hair clippings while reducing wear. A quick spray after each shave keeps your shaver operating at peak performance.

Caution: Do not remove or replace the head assembly while shaver is running or plugged into an electrical outlet as it may cause damage to the unit's cutters. The shaver shall not be used until it has dried.

- Worn or damaged parts should be replaced with Remington® branded replacement parts only.

How To Use Shaver

Getting a Close, Comfortable Shave

The Best Technique

It's simple to get a great shave from your new shaver. Here are a few tips for getting the closest shave possible:

Always use a clean, dry shaver. Make sure that the cutter head assembly is in the locked position.

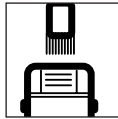

Wait at least 15 minutes after getting up before shaving, to ensure the face is free of puffiness that may be present from sleeping.

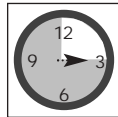

Make sure your face is clean and dry before starting.

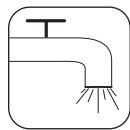

This is a washable shaver, the head-assembly part of which may be cleaned under water.

To Shave

Push the on/off button to activate the shaver for shaving.

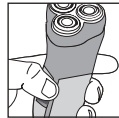

The Power Clean shaver needs no adjustments to the heads or cutters before you shave.

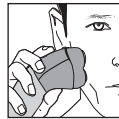

The floating heads will automatically adjust to the contours of your face. It is not necessary to apply pressure while shaving...let the shaver glide lightly on your skin. This gentle touch makes shaving easier and helps avoid possible skin irritation.

Use short, circular strokes. Use your free hand to stretch your skin. This encourages your whiskers to stand out, making it easier for them to enter the cutting chamber.

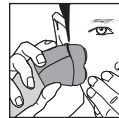

To Trim

To use the Easy-View® locking pop-up trimmer, simply push the trimmer button up.

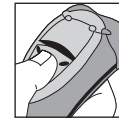

The trimmer will pop-up for use. Hold the shaver as shown in the illustration. To conserve battery energy (on rechargeable shavers only), it is recommended to use the trimmer only when needed for trimming. When through using, push the trimmer button downward to lock into the off position.

NOTE: It is important to always use the button to close the trimmer to avoid damaging the locking mechanism.

Trim Sideburns

Simply touch the comb-edge of the trimmer to the desired line for neat, clean sideburns.



Trim Mustache

Hold shaver at desired trim line for a quick, easy, professional trim. The trimmer can also be used to trim the upper edge of your mustache.

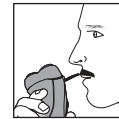

■ Always keep the protective head guard on the cutter head and keep the trimmer in the "off" position when the shaver is not in use. The head guard must be put on with the rear tab to the back of the shaver.

ComfortSelect™ Suspension System

Your Remington shaver is equipped with ComfortSelect™ suspension system for personalized comfort.



For a closer shave, move the ComfortSelect™ lever to the right. For a more comfortable shave with less irritation, move the lever to the left.

Battery Removal

Battery Removal:

When your rechargeable shaver reaches the end of its useful life, the batteries must be removed from the shaver and be recycled or disposed of properly in accordance with your state and local requirements. If this is not required by law, you may elect to dispose of the shaver without removing the batteries.

THE FOLLOWING PROCEDURE SHOULD BE FOLLOWED FOR BATTERY REMOVAL:

1. To avoid a possible electric shock hazard, unplug cord from electrical outlet and shaver.
2. Open the head assembly by pressing the head release button and lifting the head assembly. Pull the entire head assembly off of the shaver assembly. 
3. Push the trimmer button up to open the trimmer. 
4. Remove the trimmer assembly by squeezing the sides as shown in the picture. Remove bottom cover plate (cap) by gently prying off of shaver. 
5. Using a small Phillips head screwdriver, remove the 3 screws from the back of the shaver.
6. Pull or gently pry the shaver halves apart, exposing the battery. 
7. Pry the lower battery clip off.
8. Lift or pry the batteries out of the shaver.
9. Cut the wires on both ends of each battery and remove them from the shaver.

14

CAUTION: DO NOT PUT IN FIRE OR MUTILATE YOUR BATTERIES WHEN DISPOSING AS THEY MAY BURST OR RELEASE TOXIC MATERIALS. DO NOT SHORT CIRCUIT AS IT MAY CAUSE BURNS. DISPOSE PROPERLY IN ACCORDANCE WITH YOUR LOCAL AND STATE REQUIREMENTS.

When is it time to replace your heads and cutters?

It is very important to replace your heads and cutters when necessary to insure a close, comfortable shave without irritation. We recommend they be replaced every 12 months. Here are some signs of head and cutter wear, indicating that replacement is needed.

Irritation

As the heads get excessively worn there may be some skin irritation. This would be especially noticed when applying after shave lotion.

Pulling

When the cutters wear you may feel a sense of pulling and a loss of closeness when you shave. This is an indication that it is time to replace your heads and cutters.

The replacement part for this shaver is model #SP-27.

U.S. residents: To order, contact us at 800-231-8793, visit us at www.remington-products.com or visit your local retailer.

Canadian residents: For any shaver accessory requirements, please call (800) 268-0425 or write: Remington Products (Canada) Inc., P.O. Box 601, Postal Station "T," Dept. A-100, 3019 Dufferin St., Toronto, Ontario, Canada M6B3T7.

Performance Guarantee

Full Two-Year Warranty

Spectrum Brands, Inc. warrants this product against any defects that are due to faulty material or workmanship for a two-year period from the original date of consumer purchase. This warranty does not include damage to the product resulting from accident or misuse.

If the product should become defective within the warranty period, we will repair it or elect to replace it free of charge. Return your product and sales receipt with your name, address and day time phone number to: Spectrum Brands, Inc., Attention: Consumer Services, 601 Rayovac Drive, Madison, WI 53711. For more information call 800-736-4648.

Warranty excludes:

- Heads and cutters

KEEP ORIGINAL SALES RECEIPT AS PROOF OF PURCHASE FOR WARRANTY PURPOSES.

This warranty does not cover products damaged by the following:

- Accident, misuse, abuse or alteration of the product
- Servicing by unauthorized persons
- Use with unauthorized accessories
- Connecting it to incorrect current and voltage
- Wrapping cord around appliance causing premature wear & breakage
- Any other conditions beyond our control

SPECTRUM BRANDS, INC. SHALL NOT BE RESPONSIBLE FOR ANY INCIDENTAL, SPECIAL OR CONSEQUENTIAL DAMAGES RESULTING FROM THE USE OF THIS PRODUCT. ALL IMPLIED WARRANTIES, INCLUDING BUT NOT LIMITED TO IMPLIED WARRANTIES OF FITNESS AND MERCHANTABILITY, ARE LIMITED IN DURATION TO TWO YEARS FROM DATE OF ORIGINAL PURCHASE.

This warranty gives you specific legal rights and you may also have other rights which vary from state to state or province to province. Some states do not allow the exclusion or limitation of incidental, special or consequential damages.

Performance Guarantee Spectrum Brands, Inc. Money-back Offer

If within 30 days after you have purchased your Remington® branded product, you are not satisfied and would like a refund, return it with the sales slip indicating purchase price and date of purchase to the retailer from whom it was purchased. Spectrum Brands, Inc. will reimburse all retailers who accept the product within 30 days from the date of purchase. If you have any questions concerning the money-back guarantee, please call 800-736-4648.

15

Warranty

Warranty Service

In the U.S. and Canada, service is provided by authorized service dealers. For the address of your nearest authorized service dealer, contact us at 800-736-4648 (in U.S.), 800-268-0425 (in Canada), visit our website at www.remington-products.com or consult your local Yellow Pages under "Shaver-Electric-Repair."

KEEP ORIGINAL SALES RECEIPT AS PROOF OF PURCHASE FOR WARRANTY PURPOSES.

Questions or comments:

Call 800-736-4648 in U.S. or 800-268-0425 in Canada. Or visit www.remington-products.com

100-240 VAC 50/60 Hz
12Vdc, 650mA

REMINGTON, MICROFLEX, EASY VIEW, COMFORT SELECT, POWER CLEAN and SHAVER SAVER are trademarks of ROVCAL, INC.

© 2006 ROVCAL, INC.
7/06 Job #CS30039

U.S. Patent D447,284 and Patents Pending.

Dist. by: Spectrum Brands, Inc.,
Madison, WI 53711
800-736-4648

Dist. by: Spectrum Brands Canada, Inc.,
Mississauga, ON L4W 2T7
800-268-0425

MADE IN CHINA

T2208579

