

PHILIPS  
**NORELCO**

**SMARTTOUCH-XL**



**9160XL**

Rechargeable Tripleheader®  
Cordless/Cord Razor

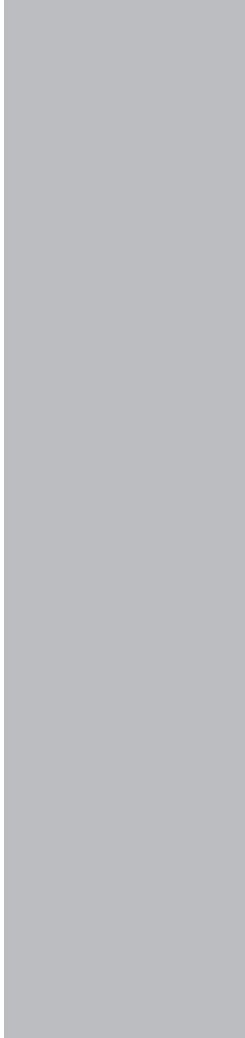

9160XL

ENGLISH 4

ESPAÑOL 28

## IMPORTANT SAFETY INSTRUCTIONS

When using an electric razor, basic precautions should always be followed, including the following:

**Read all instructions before using this appliance.**

### DANGER

**To reduce the risk of electric shock:**

1. Do not reach for a corded razor/charging stand that has fallen into water. Unplug immediately.
2. Use razor only in dry condition. Do not use a razor/charging stand while bathing or in a shower.
3. Do not submerge razor in water.
4. Do not place or store a razor or charging stand where it can fall or be pulled into a tub or sink. Do not place or drop a razor or charging stand into water or other liquid.
5. Always unplug this razor/charging stand from the electrical outlet immediately after use, except when razor is (re)charging.
6. Unplug and remove power supply cord from razor before cleaning.

### WARNING

**To reduce the risk of burns, fire, electric shock, or injury to persons:**

1. Close supervision is necessary when this razor is used by, on, or near children or invalids.
2. Use this razor for its intended household use as described in this manual. Do not use attachments not recommended by Philips Electronics North America Corporation.
3. Never operate this razor/charging stand if it has a damaged cord or charging plug, if it is not working properly, if it has been dropped or damaged, or dropped into water while plugged in. Return the razor/charging stand to the Philips Norelco Service Location for examination and repair.

4. Keep the razor, charging stand, cord and charging plug away from heated surfaces.
5. Never drop or insert any object into any opening.
6. Do not charge or plug in razor/charging stand outdoors or operate where aerosol (spray) products are being used or where oxygen is being administered.
7. Do not use this razor with a damaged or broken comb, as facial injury may occur.
8. For corded use, always attach plug to razor first, then to outlet. Be certain that plug is inserted firmly into razor, up to mark indicated on plug. For stand use, always put razor in stand first, attach cord to stand, then plug into outlet. To disconnect, turn razor off then remove charging plug from outlet.
9. Never put the razor in direct sunlight or store in a pouch at a temperature above 140°F.
10. Razor can be rinsed under running tap water. Do not charge or operate razor corded until fully dried.
11. To prevent possible damage to the cord, do not wrap cord around the razor or charging stand.

## SAVE THESE INSTRUCTIONS

**IMPORTANT:** The power plug contains a transformer. Do not cut off the power plug to replace it with another plug, as this will cause a hazardous condition.



**60 - DAY MONEY-BACK GUARANTEE**

To enjoy the closest and most comfortable shave from your new Philips Norelco Men's Razor, the razor should be used exclusively for 3 weeks. This allows your hair and skin enough time to adapt to the Philips Norelco Shaving System. If, after that period of time, you are not fully satisfied with your Philips Norelco Men's Razor, send the product back and we'll refund you the full purchase price. **The razor must be shipped prepaid by insured mail, insurance prepaid, and have the sales slip, indicating purchase price and the date of purchase, enclosed.** The razor must be postmarked no later than 60 days after the date of purchase. Philips Norelco reserves the right to verify the purchase price of the razor and limit refunds not to exceed suggested retail price.

Send dated sales slip, your complete name and address as indicated below, and the razor, prepaid to:

**Philips Domestic Appliances and Personal Care Company**  
**A Division of Philips Electronics North America Corporation**  
**450 North Medinah Rd, Dock 16**  
**Roselle, IL 60172-2329**

Please allow 4-6 weeks for delivery of check. (Please Print)

Name \_\_\_\_\_

Address \_\_\_\_\_

City \_\_\_\_\_

State \_\_\_\_\_ Zip \_\_\_\_\_

Daytime Telephone No. (\_\_\_\_) \_\_\_\_\_

E-mail Address \_\_\_\_\_

REASON FOR RETURNING: \_\_\_\_\_

\_\_\_\_\_

\_\_\_\_\_

\_\_\_\_\_

\_\_\_\_\_

**Table of Contents**

Features .....8-9

5 LED Battery Level Indicators .....10-11

Charging Stand Clock .....11-12

Before First Use.....13

Charging .....13-15

Recharging.....15

Quick Charge.....16

Put It To The Test & Shaving Tips .....16

Personal Comfort Control .....17

How To Shave With An Electric Razor .....17-18

Trimming.....18-19

Cleaning.....19-23

Replacing the Razor Heads.....24

Storage .....24

Assistance.....25

Accessories.....25

Warranty.....27

Spanish .....28

**Features**

SmartTouch Contour Following System

Personal Comfort Control Dial

Razor Head Assembly

Protective Razor Head Cap

Individually Floating Heads

Razor Head Release Button

- Hair Chamber captures shaven hair

Electronic ON/OFF Button

5 LED Charge Indicators

- Indicates the amount of charge remaining in batteries

Cleaning Indicator Light

Replacement Head Indicator Light

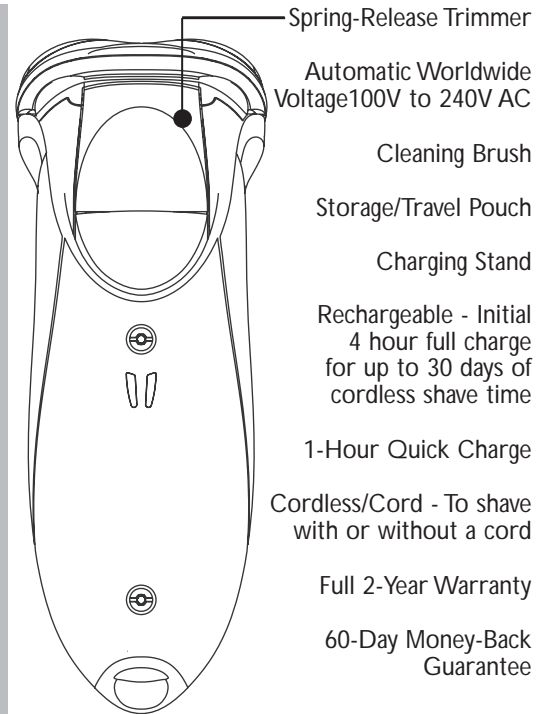
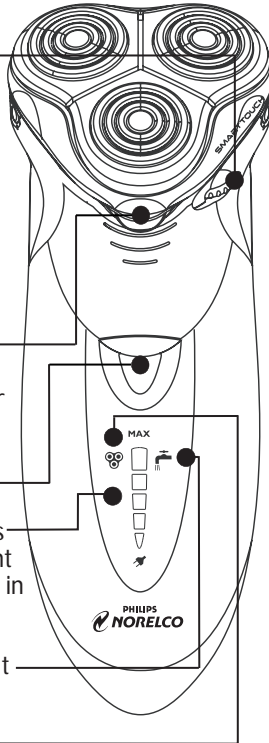

How the Unique  Philips Norelco Lift and Cut<sup>®</sup> Shaving System Makes Close Comfortable:



### 5 LED Battery Level Indicators

The meter provides the following information:

#### LED Battery Charge Meter

The Lights on the display indicate approximately how much power is left in the batteries.

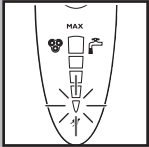

#### Charging Indicator

When you charge razor, the bottom light on the display lights up red. It will then turn green and blink. As charging continues, more and more lights of the display meter will light up green to indicate what level of the batteries have been charged. When the battery contains enough power for one shave, all lights start blinking sequentially.

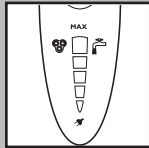

#### Full Charge Indicator

When the batteries have been fully charged, all the lights on the display will light up green. A few hours after charging, all lights will go out.

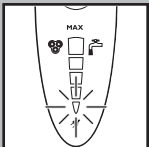

#### Low Battery Indicator

When the battery is running low, the bottom light on the display lights up red. When you turn the razor OFF, the bottom light will blink a few times.

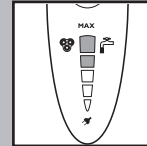

#### Remaining Battery Capacity

The remaining battery capacity is shown when you unplug the razor or when you switch it on or off.

- When all lights burn green, the battery is 100% charged.
- When the bottom light burns green, 20% of the battery capacity is left.

### Charging Stand Clock

#### To set time

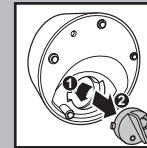

- 1 Turn clock module, located on underside of stand, counterclockwise (1) to remove from stand (2).

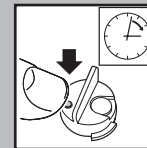

- 2 Press small, left button to set correct time. The clock can only be set forward.

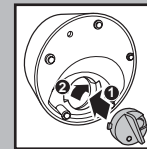

- 3 Replace clock module into underside of stand(1). Turn clockwise to secure in place (2).

### To replace clock battery

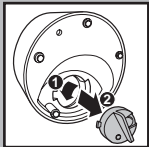

- 1 Turn clock module counterclockwise (1) and remove from stand (2).

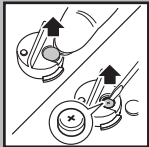

- 2 Remove battery cover and then use a flat-bladed screwdriver to lift out the battery.

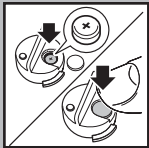

- 3 Replace battery with 1.5V button cell watch battery, placing rounded side of battery into battery compartment, flat side (+) facing out. Replace battery cover.

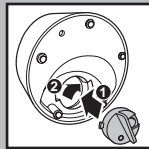

- 4 Replace clock module into stand (1) and turn clockwise to secure in place (2).

### Before First Use

- ▶ Charge the razor before you start using it (see 'Charging'). Make sure the razor is switched off before you start charging it.

### Important

- ▶ Only use the power plug and/or charging stand provided to charge the razor.
- ▶ The charging plug transforms 100 – 240V AC to less than 24V DC.

### Charging

- ▶ Battery performance is best if you recharge only when the batteries are (almost) completely empty.
- ▶ Charging or recharging at temperatures below 40°F or higher than 95°F adversely affects lifetime of batteries.
- ▶ Continuously recharging or continuously using as a corded razor will reduce life of batteries.
- ▶ You may also shave using the cord provided. This razor will not recharge while being used corded.
- ▶ Do not charge razor in a pouch.
- ▶ Recharge only when the bottom light on the display lights up red.
- ▶ Do not charge/recharge or use razor corded until fully dried.

### Placing or removing razor from charging stand:



- ▶ Always place razor in stand in an upright position making sure charging contacts in bottom of stand fit into recess in bottom of razor.



- ▶ Always remove razor from stand by lifting straight up. Do not tilt razor.
- ▶ Do not leave the charging stand with the razor in it continuously plugged into outlet as it would reduce life of batteries. If storing razor in stand, remove the plug from outlet as soon as the razor is fully charged.



- 1 Connect cord directly to razor or place razor in charging stand and connect the small plug of cord to charging stand. Connect the charging plug into any 100V to 240V AC outlet. Use only the charging plug provided.

As you charge razor, the bottom light on the display turns red. After approximately 3 minutes, it will then turn green and blink. As charging continues, more and more lights of the display meter will briefly blink green and light up to indicate what level of the batteries have been charged.

- ▶ An adaptor plug may be necessary for charging plug usage in some foreign countries. Use an attachment plug adaptor of the proper configuration for the power outlet. The charging plug will automatically convert to work on 100V to 240V AC systems.

- 2 First time charging and recharging after non-use for 1 month or more requires a full 4 hours. A fully charged razor has a cordless shaving time of up to 30 days. When batteries are fully charged, all the "lights" in the display will light up green. A few hours after charging, all lights go off.

### Recharging

- 1 First time charging requires 4 hours. After initial charge, recharging requires 1 hour. Recharge only when the bottom light on the display lights up red.

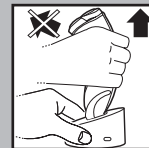

- 2 When razor is fully charged, disconnect the charging plug from outlet. Do not keep razor or charging stand permanently plugged into outlet. If using charging stand, always remove razor from stand by lifting straight up. Do not tilt razor.



### Quick Charge

When batteries are totally depleted, recharging the razor for approximately 3 minutes gives enough energy for a 3-minute cordless shave.

All of the lights on the Charge Meter will blink sequentially when the battery contains enough energy for a 3-minute cordless shave.

### Put It To The Test & Shaving Tips

- ▶ **21 Day Trial and Conversion Process.** It is a fact that your skin and beard need time to adjust to a new shaving system.
- ▶ Use your new razor exclusively for 3 weeks to fully enjoy the closeness of a Philips Norelco shave.
- ▶ At first you may not get as close a shave as you expect, or your face may even become slightly irritated. This is normal since your beard and skin will need time to adjust. Invest 3 weeks and you'll soon experience the full joy of your new razor.
- ▶ Stick with it! If you alternate shaving methods during the adjustment period, it may make it more difficult to adapt to the Philips Norelco shaving system.
- ▶ If you are still not convinced after 21 days, Philips Norelco will refund you the full purchase price, guaranteed.

### Personal Comfort Control



- ▶ Your Smart Touch razor has 3 adjustable settings that allow you to personalize your shave for your specific skin type from sensitive to normal skin. You can select your personal comfort control setting by turning the dial. Each setting is indicated by a "click".

Choose a comfort control setting:

- ▶ **For Sensitive Skin:**  
Choose comfort control setting "S" to relax the spring and pressure of the floating heads against your skin for a gentler, more comfortable shave.
- ▶ **For Normal Skin:**  
Choose comfort control setting "N" to tighten the spring and pressure of the floating heads against your skin for a faster shave.
- ▶ The in-between positions are best suited for skin types between normal and sensitive.

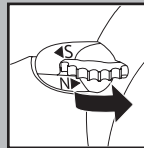
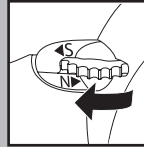

### How To Shave With An Electric Razor

- ▶ Use this razor for its intended household use as described in this manual.
- ▶ Shaving with a clean, dry face gives the best results.



- 1** Turn razor ON by pressing the on/off button once. Shave against the direction of beard growth using both straight and circular movements.

- 2 Stretch your skin with your free hand so blades can lift and cut whiskers. Gently press razor to skin so the floating heads can follow the contours of your face. DO NOT press too hard. Too much pressure can pinch the skin into the combs.



- 3 Turn razor OFF by pressing the on/off button once.
- 4 Put the protective razor head cap on the razor to protect razor heads.

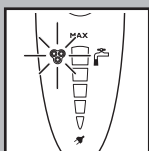

For optimal shaving results, replace razor heads (model #HQ9) once a year or when the replacement head symbol starts blinking.

### Trimming

To groom sideburns and moustache:

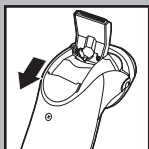

- 1 Turn razor ON.
- 2 Push down spring-release trimmer switch. The trimmer can be activated while the razor is running.
- 3 Hold trimmer as shown and move in downward strokes with gentle pressure.



- 4 Close trimmer by pressing trimmer down.
- 5 Turn razor OFF.

### Cleaning



- ▶ The tap symbol on the back of the razor indicates that the razor can be rinsed under running tap water.
- ▶ Regular cleaning guarantees better shaving results.
- ▶ Always switch Razor OFF, unplug and remove power cord before cleaning.
- ▶ Never clean, remove or replace head assembly while motor is on.
- ▶ Do not apply pressure to combs. Do not touch razor heads with hard objects as this may dent or damage precision-made slotted combs.
- ▶ Do not use razor if combs are damaged or broken. Facial injury may occur.
- ▶ Unplug the charging stand. The charging stand may be wiped clean using a damp cloth.

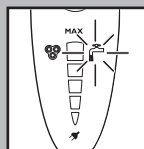

- 1 The faucet symbol will start blinking after each shave to remind you that the razor needs to be cleaned (except when the bottom light burns red).

### Cleaning: Razor Heads

The easiest and most hygienic way to clean the razor heads is to rinse them after each use or at least once a week with hot water: Water from the tap should be on a hot setting, BUT BE CAREFUL TO TEST WATER FIRST SO AS NOT TO BURN OR SCALD HANDS.

- ▶ Regular cleaning guarantees better shaving results.
- ▶ Do not immerse razor in water.

**1** Always turn razor OFF, unplug from outlet and remove cord from razor or charging stand before cleaning.

**2** Press the Razor Head Release Button, flip open the Razor Head Assembly.

**3** Clean inside razor heads and hair chamber by running under hot water.

**4** Clean outside of Razor Head Assembly by running under hot water.

**5** Close the Razor Head Assembly and shake off excess water.

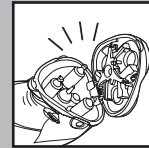
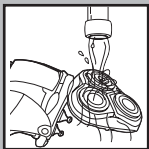
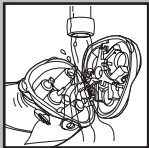

**6** Open Razor Head assembly again and leave open to air dry.

NOTE: Do not wipe or dry the shaving heads with a towel or tissue. This could damage the shaving heads.

**7** If the shaving unit becomes detached from the razor, you can easily reattach it.

**8** You may also clean the hair chamber without water by using the supplied brush.

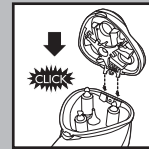

### Once A Month: Razor Heads

Do not mix up the cutters and combs as the shaving performance may be adversely affected for several weeks before optimal shaving performance is restored.

**1** Turn razor OFF, remove the charging plug from the outlet and cord from the razor or charging stand.

**2** Press the razor head release button to open the razor head assembly.

**3** Turn the wheel counterclockwise (1) and remove the retaining frame (2).

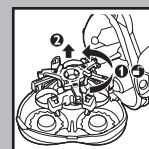
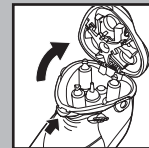

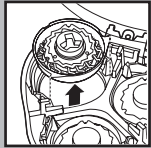

- 4** Remove and clean one set of cutters and combs at a time.

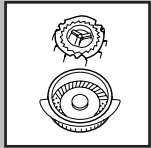

- 5** Separate the cutter from the comb and rinse clean under hot water.

Do not clean more than one cutter and comb at a time, since they are all matching sets. If you accidentally interchange the cutters and combs, it could take several weeks before optimal shaving performance is restored.

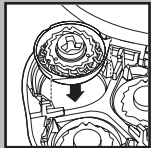

- 6** Replace the set back into the Razor Head Assembly so that the 'wings' on the comb fit within the brackets located towards the center of the Assembly.

The set will only fit into the Razor Head Assembly if the 'wings' are between the brackets. Make sure that the two pointy edges of the head fit exactly into the recesses.

- 7** Repeat the process for the other two sets of cutters and combs.

- 8** Replace the frame.

- 9** Press down (1) and turn wheel clockwise (2) until it locks into place.

- 10** Close the Razor Head Assembly.

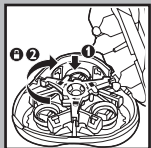

### Once A Month: Razor Heads

For optimum performance, razor cutters and combs should be cleaned in a degreasing liquid (e.g. Philips Norelco Razor Cleaner, model RC1776, or rubbing alcohol) and lubricated with Philips Norelco Razor Lubricant, model AL80, or one drop of mineral oil (in the center of the head). This helps prevent wear of the shaving heads.

### After Each Use: Trimmer

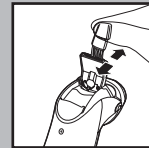

- 1** Turn razor OFF.
- 2** Push down spring-release trimmer switch.
- 3** Clean trimmer with the brush every time you use it.
- 4** Lubricate the trimmer teeth with Philips Norelco Razor Lubricant (model AL80) or with one drop of mineral oil every 6 months.
- 5** Close trimmer by pressing trimmer down.



This razor has no other user-serviceable parts. Any other service should be performed by the Philips Norelco Service Location.

### Replacing the Razor Heads

- ▶ Replace the razor heads once a year for optimal shaving results.
- ▶ Replace damaged or worn razor heads with model HQ9 Philips Norelco razor heads only.

### Razor head check indication

- ▶ The replacement head indicator symbol starts blinking to remind you to check if it's time to replace your razor heads to obtain optimal shaving results.

### Storage

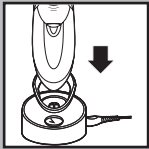

- ▶ The razor can be placed in the charging stand for safe storage. If storing razor in stand, remove the plug from outlet as soon as the razor is fully charged.
- ▶ Be sure razor is turned off. Remove cord from outlet and razor or charging stand before storing in a safe, dry location where it will not be crushed, banged, or subject to damage.
- ▶ Do not wrap cord around razor or charging stand when storing.
- ▶ Store cord in a safe location where it will not be cut or damaged.
- ▶ Do not keep razor or charging stand permanently plugged into outlet.
- ▶ Do not place or store razor or charging stand where it can fall or be pulled into a tub or sink, water or other liquid while plugged in.
- ▶ Put the Protective Razor Head Cap on razor to protect heads.



### Assistance

- ▶ For assistance, call toll free:  
**1-800-243-3050**  
or visit our website:  
**[www.philips.com/norelco](http://www.philips.com/norelco)**
- ▶ Information is available 24 hours a day, 7 days a week.

### Accessories

- ▶ Replacement Heads  
Model HQ9 - For maximum razor performance, replace your Philips Norelco razor heads once a year or as soon as the replacement head symbol starts blinking.
- ▶ Razor Cleaner  
RC1776 - Philips Norelco Razor Cleaner.
- ▶ Razor Lubricant  
AL80 - Philips Norelco Razor Lubricant.
- ▶ Car Cord Adaptor Cable  
HQ8010 - Charges razor from a 12V battery in your car, truck, van, boat or camper.
- ▶ Philips Norelco Razor Accessories may be purchased at a store near you or on our website [www.philips.com/norelco](http://www.philips.com/norelco)

**FULL TWO YEAR WARRANTY**

Philips Electronics North America Corporation warrants each new Philips Norelco Product, Model 9160XL (except cutters and combs) against defects in materials or workmanship for a period of two years from the date of purchase, and agrees to repair or replace any defective product without charge.

**IMPORTANT:** This warranty does not cover damage resulting from accident, misuse or abuse, lack of reasonable care, the affixing of any attachment not provided with the product or loss of parts or subjecting the product to any but the specified voltage.\* Use of unauthorized replacement parts will void this warranty.

**PHILIPS ELECTRONICS NORTH AMERICA CORPORATION WILL NOT PAY FOR WARRANTY SERVICE PERFORMED BY A NON-AUTHORIZED REPAIR SERVICE AND WILL NOT REIMBURSE THE CONSUMER FOR DAMAGE RESULTING FROM WARRANTY SERVICE PERFORMED BY A NON-AUTHORIZED REPAIR SERVICE. NO RESPONSIBILITY IS ASSUMED FOR ANY SPECIAL, INCIDENTAL OR CONSEQUENTIAL DAMAGES.**

In order to obtain warranty service, simply ship the product postage prepaid to the Philips Norelco Service Location (information available online at [www.philips.com/norelco](http://www.philips.com/norelco) or at 1-800-243-3050). It is suggested that for your protection you return shipments of product by insured mail, insurance prepaid. Damage occurring during shipment is not covered by this warranty.

**NOTE:** No other warranty, written or oral, is authorized by Philips Electronics North America Corporation.

This warranty gives you specific legal rights, and you may also have other rights which vary from state to state. Some states do not allow the exclusion or limitation of incidental or consequential damages, so the above exclusion and limitations may not apply to you.

\* Read enclosed instructions carefully.



Manufactured for:

Philips Domestic Appliances and Personal Care Company  
A Division of Philips Electronics North America Corporation  
1010 Washington Blvd., Stamford, CT 06912-0015



This symbol on the product's nameplate means it is listed by Underwriters' Laboratories, Inc.

Norelco, Personal Comfort Control, Tripleheader, Lift and Cut, and  are Registered Trademarks of Philips Electronics North America Corporation.



is a Trademark of Philips Electronics North America Corporation.

PHILIPS is a Registered Trademark of Koninklijke Philips Electronics N.V.

© 2006 Philips Electronics North America Corporation. All Rights Reserved.