

#### FULL TWO YEAR WARRANTY

Philips Electronics North America Corporation warrants each new Norelco Product, Model 4807XL/4805XL (except cutters and combs), against defects in materials or workmanship for a period of two years from the date of purchase, and agrees to repair or replace any defective product without charge.

**IMPORTANT:** This warranty does not cover damage resulting from accident, misuse or abuse, lack of reasonable care, the affixing of any attachment not provided with the product or loss of parts or subjecting the product to any but the specified voltage.\* Use of unauthorized replacement parts will void this warranty.

**PHILIPS ELECTRONICS NORTH AMERICA CORPORATION WILL NOT PAY FOR WARRANTY SERVICE PERFORMED BY A NON-AUTHORIZED REPAIR SERVICE AND WILL NOT REIMBURSE THE CONSUMER FOR DAMAGE RESULTING FROM WARRANTY SERVICE PERFORMED BY A NON-AUTHORIZED REPAIR SERVICE.**

**NO RESPONSIBILITY IS ASSUMED FOR ANY SPECIAL, INCIDENTAL OR CONSEQUENTIAL DAMAGES.**

In order to obtain warranty service, simply take or ship the product postage prepaid to any Authorized Norelco Service Location. It is suggested that for your protection you return shipments of product by insured mail, insurance prepaid. Damage occurring during shipment is not covered by this warranty.

**NOTE:** No other warranty, written or oral, is authorized by Philips Electronics North America Corporation.

This warranty gives you specific legal rights, and you may also have other rights which vary from state to state. Some states do not allow the exclusion or limitation of incidental or consequential damages, so the above exclusion and limitations may not apply to you.

\* Read enclosed instructions carefully.

Manufactured for:  
Norelco Consumer Products Company  
A Division of Philips Electronics North America Corporation  
1010 Washington Blvd.  
Stamford, CT 06912-0015

**MADE IN HOLLAND.**



This symbol on the product's nameplate means it is listed by Underwriters' Laboratories, Inc.

Norelco, Lift and Cut, RAZORMATE and  are Registered Trademarks of Philips Electronics North America Corporation.

 and Micro Action are Trademarks of Philips Electronics North America Corporation.

PHILIPS and Philips Shield are Registered Trademarks of Philips Electronics N.V.

© 1998 Philips Electronics North America Corporation.  
All Rights Reserved.



**INGENIOUS MEN'S GROOMING SOLUTIONS**



**4807XL/4805XL**  
**Rechargeable Razor**  
**With Micro Action**



*If you need help,  
answers or service,  
please call us at  
1-800-243-3050  
or visit our website:  
[www.norelco.com](http://www.norelco.com)*



**PHILIPS**

## IMPORTANT SAFETY INSTRUCTIONS

When using an electric razor, basic precautions should always be followed, including the following:

Read all instructions before using this appliance.

### DANGER

To reduce the risk of electric shock:

1. Do not reach for a razor that has fallen into water. Unplug immediately.
2. Do not use while bathing or in a shower.
3. Do not place or store razor where it can fall or be pulled into a tub or sink. Do not place in or drop into water or other liquid.
4. Always unplug this razor from the electrical outlet immediately after using, except when razor is (re)charging.
5. Unplug this razor before cleaning.
6. When discarding razor, unplug razor and remove rechargeable batteries. See enclosed sheet for instructions.

### WARNING

To reduce the risk of burns, fire, electric shock, or injury to persons:

1. Close supervision is necessary when this razor is used by, on, or near children or the disabled.
2. Use this razor for its intended household use as described in this manual. Do not use attachments not recommended by Philips Electronics North America Corporation.

3. Never operate this razor if it has a damaged cord or plug, if it is not working properly, if it has been dropped or damaged, or dropped into water. Return the razor to an Authorized Norelco Service Location for examination and repair.
4. Keep the cord away from heated surfaces.
5. Never drop or insert any object into any opening.
6. Do not charge or plug in razor outdoors or operate where aerosol (spray) products are being used or where oxygen is being administered.
7. Do not use this razor with a damaged or broken comb, as facial injury may occur.
8. Always attach plug to razor first, then to outlet. Be certain that plug is inserted firmly into razor up to mark indicated on plug. To disconnect, turn razor off, then remove plug from outlet.
9. To prevent possible damage to the cord, do not wrap cord around the razor.
10. Never put razor in direct sunlight or store in pouch at a temperature above 140°F.

## SAVE THESE INSTRUCTIONS

**IMPORTANT:** Your razor contains NICKEL-CADMIUM RECHARGEABLE BATTERIES. See enclosed instruction sheet for battery disposal information.

## ■ FOR ASSISTANCE

For assistance or the Authorized Norelco Service Location nearest you, call toll free:

**1-800-243-3050**  
or visit our website:  
[www.norelco.com](http://www.norelco.com)

Authorized Norelco Service Location information is available 24 hours a day, 7 days a week.

## FEATURES

*Easy-To-Clean Razor Head Assembly*

*Razor Head Release Button*

*Protective Razor Head Assembly Guard*

*Full 2-Year Warranty*

*Charge Indicator Light*

*Travel/Storage Pouch (model 4805XL only)*



*Pop-Out Trimmer for beards, moustaches and sideburns*

*Hair Chamber captures shaven hair*

*Adjustability Band*

*Rechargeable - shaves with or without a cord*

*Locking ON/OFF Switch*

*Worldwide Universal Voltage*

*NOTE: You may operate this razor on all voltages from 100 to 240 Volt AC/DC.*

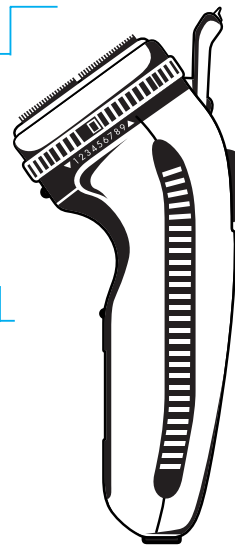

**How the Norelco  Lift and Cut® Patented Shaving System Makes Close Comfortable:**

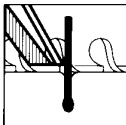

*Groove channels beard closer to cutting system*

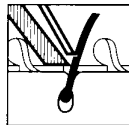

*Lifter raises hair*

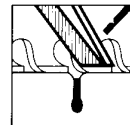

*Blade cuts hair which then drops below skin level*

## IMPORTANT

Invest 3 weeks for the shave of a lifetime!

The Norelco Micro Action Razor with the patented Lift and Cut® System is unlike any other shaving system you've ever tried. So different, it can take your skin and beard a little time to adapt. But it's an investment worth making.

**Use your new razor exclusively for 3 weeks to fully enjoy the closeness of a Norelco shave.\***

At first you may not get as close a shave as you expect, or your face may even become slightly irritated. This is normal since your beard and skin will need time to adjust.

Invest 3 weeks and you'll soon experience the full joy of your new razor. That incredibly close, incredibly comfortable shave that is so uniquely Norelco.

**\*Stick with it! If you alternate shaving methods during the adjustment period, it may make it more difficult to adapt to the Norelco shaving system.**

### VOLTAGE

In North America, Central America and South America, the most common voltage is between 110V and 130V AC. When traveling to other countries, common voltage may range to 240V AC. Your new razor will automatically convert internally to work on 100V to 240V AC / DC systems.

An adaptor plug may be necessary for cord usage in some foreign countries. It is suggested that you take all adaptor plugs with you when traveling overseas to ensure compatibility with most foreign outlet configurations.

Norelco Travel Adaptor Plug Kit, model TP5, may be purchased at a store near you or at an Authorized Norelco Service Location.

## 1. TO CHARGE

- Use only the cord provided.
- (Re)charge at temperatures between 40°F and 95°F. Charging at lower or higher temperatures adversely affects life-time of batteries.

1. Slide and depress ON/OFF switch to OFF.
2. Connect cord to razor. Plug into 100V to 240V AC/DC outlet.
3. Green Charging Indicator Light will light to indicate razor is (re)charging.
4. Charging requires a full 8 hours.

- (Re)charging longer than required period of time will not harm razor. However, continuously charging razor will reduce life of batteries.

## 1A. TO RECHARGE

1. Recharging requires 8 hours for approximately 2 weeks of 3 minute shaves per day.
2. If razor has not been used for at least a month, razor must be recharged for a full 8 hours (see TO CHARGE).

## 2. CORD/CORDLESS SHAVING

### CORD

1. Connect cord provided to razor.
2. Plug into 100V to 240V AC/DC outlet.
3. Slide and depress ON/OFF switch ON. Begin shaving.
4. Turn razor OFF and unplug.

**IMPORTANT:** It is not recommended that this razor be used exclusively as a corded razor. Continual use as a corded razor as well as continuously charging razor will reduce life of batteries.

**NOTE:** Razor does not recharge during corded shaving.

### CORDLESS

1. Charge according to directions. Unplug razor from outlet.
2. Slide and depress ON/OFF switch ON. Begin shaving.

## 3. ADJUSTABILITY BAND

1. Select position best suited for your skin and beard type and which will give you the most comfortable shave.
2. Each position is indicated by a clicking sound. Move Adjustability Band (Fig. 1) on razor clockwise for a lower setting and counterclockwise for a higher setting.

- Lowest setting for sensitive skin/soft beard (#1).

- Highest setting for not so sensitive skin/tough beard (#9).

- Choose one setting for "custom" shaving cheeks/chin, another "comfort" setting for neck.

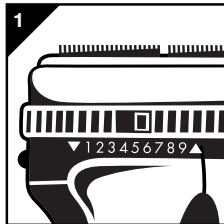

## 4. SHAVING

1. Remove Protective Razor Head Assembly Guard. Turn razor ON.
2. Shave against the direction of beard growth using a quick, circular motion.
3. Keep the skin taut using your fingers to stretch the skin so blades can lift and cut whiskers off (Fig. 2).
4. Easy does it. Gently press the razor to your skin so the floating heads can follow the contours of your face.
5. Turn razor OFF (and unplug if shaving with cord).

**IMPORTANT:** Clean razor head regularly following **MAINTENANCE** instructions.

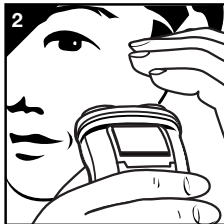

## 5. POP-OUT TRIMMER

1. Switch razor ON.
2. Push Trimmer Slide Switch up to pop out Trimmer.
3. Hold Trimmer, as shown (Fig. 3), to exact hairline desired. Move Trimmer downward with gentle pressure.
4. Close Trimmer by pushing Trimmer Slide Switch down.
5. Turn razor OFF (and unplug if shaving with cord).



## 6. TO CLEAN TRIMMER

1. Switch razor OFF (and unplug if shaving with cord).
2. Push Trimmer Slide Switch up to pop out Trimmer.
3. Brush out Trimmer section using long bristles of brush (Fig. 4).

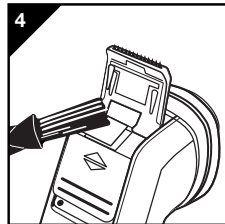

4. Lubricate Trimmer teeth twice a year with Norelco Razor Lubricant, model AL80, or one drop of mineral oil (Fig. 5).
5. Close Trimmer by pushing Trimmer Slide Switch shown.

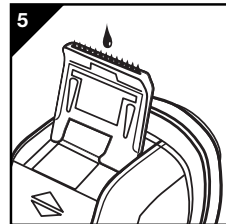

## 7. MAINTENANCE/ CLEANING INSTRUCTIONS

### IMPORTANT

- Always switch razor OFF and remove plug from outlet before cleaning.
- Always store razor with Protective Plastic Head Guard on Razor Head Assembly.
- Never clean, remove or replace head assembly while motor is on.
- Do not apply pressure to combs. Do not touch razor heads with hard objects as this may dent or damage precision-made slotted combs.
- Do not use razor if combs are damaged or broken.

## 7. CLEANING INSTRUCTIONS (CONT.)

### 7A. ONCE A WEEK

1. Clean Razor Head Assembly as shown (Fig. 6).
2. Press Razor Head Release Button and lift Razor Head Assembly using thumb and index finger to remove from razor housing (Fig. 7).
3. Clean inside of Razor Head Assembly and Hair Chamber with long bristles of brush.
4. Press Razor Head Assembly back on razor housing.

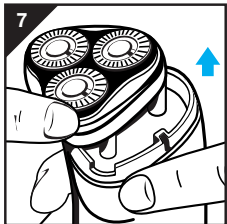
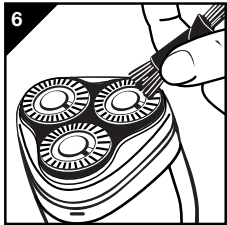

### 7B. ONCE EVERY 4-8 WEEKS

**IMPORTANT:** Do **NOT** interchange the cutters and combs. They are a matched set and if interchanged may adversely affect shaving performance until cutters reseal themselves. Therefore, remove, clean, and replace each set individually.

1. Remove Razor Head Assembly (Fig. 7).
2. While holding Razor Head Assembly in one hand, press center wheel down while turning counterclockwise to re-

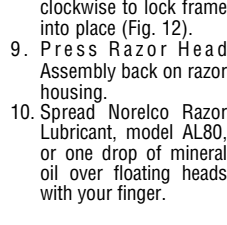
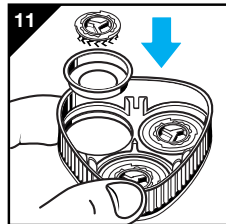
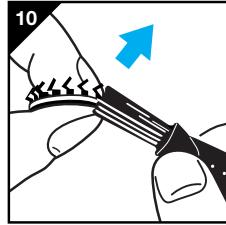
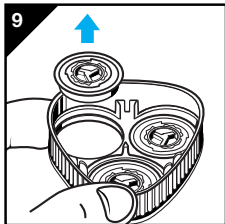
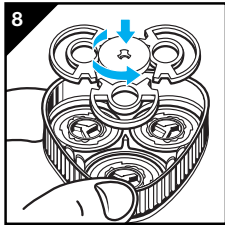

- lease frame and lift out. Set frame aside (Fig. 8).
3. Remove one cutter/comb, at a time, out of frame as shown (Fig. 9).
4. Cutter should be held as shown and brushed in an upward motion (Fig. 10). Clean inside of comb with long bristles of brush in a circular motion.
5. For consistently close and comfortable shaves, razor heads should be cleaned and lubricated every 4-8 weeks. Clean heads in

a degreasing liquid (e.g. Norelco Razor Cleaner, RAZORMATE Electrosonic Cleaner or alcohol).

6. While holding Razor Head Assembly in one hand, gently place one cutter/comb back into Assembly (Fig. 11).
7. Repeat procedure for other two cutting heads.
8. Replace frame, with cutting heads in place, back into Razor Head Assembly. While pressing down, turn wheel clockwise to lock frame into place (Fig. 12).
9. Press Razor Head Assembly back on razor housing.
10. Spread Norelco Razor Lubricant, model AL80, or one drop of mineral oil over floating heads with your finger.

## 8. HQ4 REPLACE- MENT HEADS AND RAZOR ACCESSORIES

### Replacement Heads:

The self-sharpening rotary blades in your Norelco razor are precision-made to give closer shaves. When they finally do need replacing, specify only Norelco brand replacement cutters and combs, model HQ4.

**DO NOT USE** shaver sharpeners as this will damage your blades and lifters and will adversely affect the shaving performance.

**NOTE:** It is recommended that you **replace** your razor heads once a year.

### Razor Cleaners:

Norelco RAZORMATE Electrosonic Heads Cleaner, model ERC100.

Norelco Razor Cleaner, model RC1776.

Norelco Razor Lubricant, model AL80.

Norelco Razor Accessories may be purchased at a store near you, at an Authorized Norelco Service Location, or by using the handy order form enclosed.

## 9. IMPORTANT BATTERY DISPOSAL INFORMATION

### When discarding your razor:

THIS NORELCO RAZOR CONTAINS NICKEL-CADMIUM RECHARGEABLE BATTERIES WHICH MUST BE RECYCLED OR DISPOSED OF PROPERLY.

Refer to enclosed instruction sheet for directions on removing rechargeable batteries.

### CAUTION:

- Batteries should be removed by consumer **only** when razor is to be discarded.
- Make sure razor is unplugged before dismantling for battery removal.
- All servicing or battery replacement should be performed by an Authorized Norelco Service Location only.



## 60-Day Money-Back Guarantee

To enjoy the closest and most comfortable shave from your new Norelco Men's Razor, the razor should be used exclusively for 3 weeks. This allows your hair and skin enough time to adapt to the Norelco Shaving System. If, after that period of time, you are not fully satisfied with your Norelco Men's Razor, send the product back and we'll refund you the full purchase price.

**The razor must be shipped prepaid by insured mail, insurance prepaid, and have the sales slip, indicating purchase price and the date of purchase, enclosed.** The razor must be postmarked no later than 60 days after the date of purchase. Norelco reserves the right to verify the purchase price of the razor and limit refunds not to exceed suggested retail price.

Send dated sales slip, your complete name and address as indicated below, and the razor, prepaid to:

**Norelco Consumer Products Company**  
A Division of Philips Electronics North America  
Corporation  
P.O. Box 1116  
Skokie, IL 60076

Please allow 4-6 weeks for delivery of check.

Please Print!

NAME: \_\_\_\_\_

ADDRESS: \_\_\_\_\_

CITY: \_\_\_\_\_

STATE: \_\_\_\_\_ ZIP: \_\_\_\_\_

TELEPHONE NO.: (\_\_\_\_\_) \_\_\_\_\_  
Area Code

REASON FOR RETURNING: \_\_\_\_\_

\_\_\_\_\_  
\_\_\_\_\_  
\_\_\_\_\_  
\_\_\_\_\_  
\_\_\_\_\_