

Important safety instructions

The use of any electrical appliance requires the following common sense safety rules.

Primarily there is danger of injury or death and secondly the danger of damage to the appliance. These are indicated in the text by the following two conventions:

WARNING: Danger to the person!
IMPORTANT: Damage to the appliance! In addition we offer the following safety advice.

Location

- Do not use outdoors.

Children

- Children do not understand the dangers associated with operating electrical appliances. Never allow children to use this appliance.
- Close supervision is necessary when any appliance is used near children.

Personal safety

- Burns can occur from touching hot metal parts, hot water or steam. Use caution when you turn a steam iron upside down, there may be hot water in the water tank.
- Do not use the vertical steam feature on clothes that are being worn.
- Do not leave the iron unattended whilst plugged in or on an ironing board. Never allow the mains lead to over hang the work surface.
- The socket should always be off before plugging or unplugging from the socket. Never yank the cord to disconnect from the socket, instead, grasp plug and pull to disconnect.
- Do not allow the cord to touch hot surfaces. Let the iron cool completely before putting away. Loop cord loosely around the iron before storing.

Other safety considerations

- Use the iron only for its intended use.
- To protect against the risk of electric shock do not put the appliance in water or in any other liquid.
- Always disconnect the iron from the electrical socket when filling with water or emptying, and when not in use.
- Do not operate the iron with a damaged cord or if the iron has been dropped or damaged. To avoid the risk of electric shock, do not disassemble the iron, but telephone Morphy Richards for advice. Incorrect reassembly can cause a risk of electric shock when the iron is used.

Anti-scale models only

- Keep the anti-scale sachet out of reach of children.
- Wipe up spilt anti-scale granules immediately.
- If the granules come into accidental contact with the eyes, flush them with water for at least 15 minutes and remove all particles. Consult a physician if irritation persists.
- If the granules come into contact with the skin, remove particles and wash with water.
- Do not remove the anti-scale cartridge from the iron, unless the tank is empty.
- When filling ensure that the iron is disconnected from the electrical socket, and that the cartridge is inserted correctly.

Special instructions

- If your iron does not work, check the following points:
Has the temperature control been set to the required temperature? Is the plug in its socket? Is the plug itself or the socket faulty? (Check by plugging in another appliance).

Emptying and storing

When you have finished ironing, unplug your iron. Ensure that the variable steam control is set at the 'X' position, lift up the fill cap and empty any remaining water out of the filling hole.

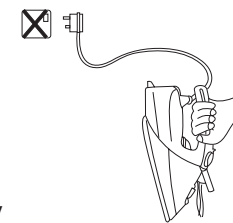

Do not store in the box, but in an upright position, so that any drops of water remaining cannot leak out and discolour the soleplate.

Important: The flex can be damaged if wound too tightly around the iron after use. Make a loose loop with the flex and wrap it around the iron. The iron must be cool before winding the flex and storing on its heel.

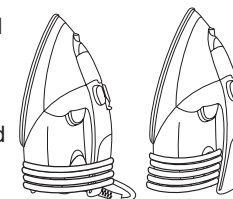

Maintenance

Jet cleaning

Your iron has a built in cleaning system designed to keep the water valve, steam chamber and steam vents clear of lint and loose mineral deposits. The 'jet clean' should be operated after each period of ironing.

To operate, ensure that there is little water in the tank, place the iron on its heel and turn the temperature control dial to the maximum setting. Wait for the temperature indicator light to go out, then unplug the iron and hold it about 6" (150mm) above the sink in the ironing position. Press the shot of steam button about 10 times in succession.

After this cleaning operation, empty out any remaining water.

To clean a stainless steel or anodised soleplate (certain models only)

To keep the soleplate of your iron clean and free of limescale, we recommend that you use one of the gentle chrome, silver or stainless steel cleaners that are generally available. Always follow the manufacturers instructions. To clean off melted man-made fibres set the iron at 3 dot position and pass it over a clean piece of cotton which will draw the deposit off the surface.

To clean a coated soleplate (certain models only)

In the unlikely event of any man-made fibre fusing to the soleplate, set the iron at the 3 dot position and pass it over a clean piece of cotton which will draw the deposit off the surface.

Do not use scouring powder or solution as this could cause damage to the coating.

To clean the exterior

Allow the iron to cool and wipe over with a damp cloth and mild detergent, then wipe with a dry cloth.

Helpline

If you have any difficulty with your appliance, do not hesitate to call us.

We are more likely able to help than the store from where you bought it.

Please have the following information ready to enable our staff to deal with your query quickly.

- Name of the product
- Model number as shown on the underside of the appliance.



No drip system

Your iron is fitted with a no drip system which is designed to prevent water escaping from the soleplate when the iron is too cold.

During use, the no drip system may emit a loud click, particularly during heat-up or whilst cooling down. This is perfectly normal and indicates that the system is functioning correctly.

Anti-scale system

(certain models only)

The anti-scale cartridge is designed to reduce the build-up of limescale which occurs during steam ironing, this will prolong the working life of your iron. However, please note that the anti-scale cartridge will not completely stop the natural process of limescale build-up.

Using your anti-scale iron for the first time

If you are using your iron for the first time you will notice that there is no anti-scale sachet present in the anti-scale cartridge. To keep the granules in optimum working condition they are stored in an air-tight container located in the packaging of your iron. To activate the anti-scale system you must place the anti-scale cartridge with sachet, as described below.

Refilling intervals

How often you need to refill your anti-scale cartridge depends on how often you use your iron with its steam functions and how 'hard' your water supply is. Water hardness varies greatly from one area to another. For advice on the relative hardness of your water, contact your local water supplier.

If, on average you spend 2 hours per week ironing, then we suggest you refill your anti-scale cartridge as shown in the table. If you iron more or less frequently then you should alter the interval between refills accordingly.

Water hardness	Soft	Medium	Hard
Refill interval (months)	6	3	1½

Replacement anti-scale refills

To obtain replacement anti-scale refills telephone our spares number on: 0870 167 6646.

Filling / Refilling your anti-scale cartridge

- 1 Empty any remaining water from the tank, (see emptying and storing section).
- 2 Remove the anti-scale cartridge from the iron by turning it anti-clockwise quarter of a turn and pulling it out.
- 3 Remove the cartridge lid as follows, hold the cartridge upright and gently squeeze it by the retaining lugs. Gently pull off the lid. If you are refilling, dispose of the used sachet.
- 4 Remove the anti-scale sachet from its packaging.
- 5 Fit the new sachet into the cartridge.
- 6 Replace the lid back on the cartridge by aligning the holes with their lugs and pressing down until it clicks shut on both sides.
- 7 Insert the cartridge back in its hole. Push it in as far as possible making sure it is aligned as shown. Turn it clockwise until the pointer aligns with the marker on the iron and it is closed flush tight.
- 8 Your iron is now ready to use and the water tank can be filled.

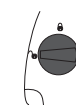
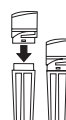
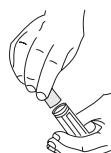
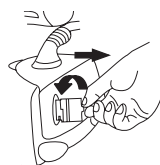

- **WARNING: when not in use, your iron should never be placed flat and left on an ironing board.**
- To prevent damage to the textile being ironed, follow the temperature guide carefully. (Test the inside of the hem of the garment).
- When ironing is complete, remove the plug from the socket, empty any remaining water from the tank, and allow to cool before storage.
- If you drop or severely knock your iron this could cause internal damage even if the outside appears alright. Have it checked by a qualified electrician.
- It is recommended that you use up one beaker of water by operating your iron's steam and shot of steam functions before ironing any clothes as some dripping may occur while your irons steam system is activated.

Electrical requirements

Check that the voltage on the rating plate of your appliance corresponds with your house electricity supply which must be A.C. (Alternating current).

If the socket outlets in your home are not suitable for the plug supplied with this appliance the plug should be removed and the appropriate one fitted.

WARNING : The plug removed from the mains lead, if severed, must be destroyed as a plug with a bared flexible cord is hazardous if engaged into a live socket outlet.

Should the fuse in the 13 amp plug require changing a 13 amp BS1362 fuse must be fitted.

WARNING: THIS APPLIANCE MUST BE EARTHED.

Instructions for use

Temperature guide

Heat setting markings on the adjustable control dial of all Morphy Richards irons match those of the International Textile Care Labelling Code.

Symbol				
		(120°C Max) Cool	(160°C Max) Warm	(210°C Max) Hot
Control knob positions	Do not iron at all	●	●●	●●●
Fabric		Nylon, Acetates e.g. Acrilan, Courtelle, Orlon, Triacetates, e.g. Tricel/Polyester	Wool, Polyester mixtures e.g. Polyester/Cotton	Cotton, Linen Rayon, Rayon mixtures, e.g. Rayon/Linen
Ironing		Iron on wrong side if moisture required use damp cloth (Not Acetate)		Fabrics requiring this setting usually require steam pressing for heavy cotton, denim etc.
With water in tank		← Dry and spray →	← Steam/spray/shot of steam →	← Jet clean →
Without water in tank		←	Dry ironing	→

Components of your iron

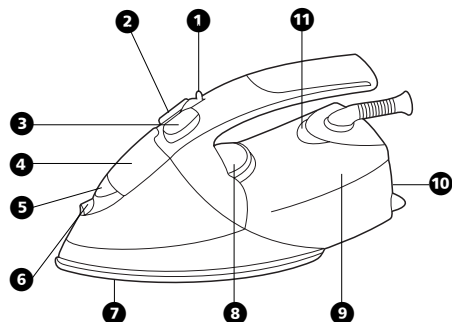

- 1 Variable steam control
- 2 Spray button
- 3 Shot of steam button
- 4 Filling hole with cap
- 5 Filler cap release button
- 6 Spray nozzle
- 7 Soleplate
- 8 Temperature control dial with indicator
- 9 Water tank
- 10 Anti-scale cartridge (certain models only)
- 11 Temperature indicator light (red)

Before use

Note: The steam facility should only be used on garments which are suitable for ironing at the 2 and 3 dot settings.

When ironing with the steam facility at the 2 dot setting, the steam output should be set at the lower end of the steam range (see variable steam section).

Textiles and clothes are supposed to carry ironing instructions. If they don't you should follow the fabric guide on page 3, but be sure to test the temperature by ironing the hem of the garment or similar area first.

If you turn the control dial down from a hot setting to a cooler setting, wait until the iron temperature has stabilised before you continue ironing.

Filling

- 1 Make sure that the iron is not plugged in and then set the variable steam control 1 to the '☒' position before filling the iron with water.
- 2 Push the filler cap release button 5 and lift up the fill cap. Fill the water through the filling hole 4 into the water tank 9, using the beaker provided. **A** One beaker fills the tank (275 ml). After filling replace the fill cap. In hard water areas the use of distilled or demineralised water is recommended.
- 3 Always pour out the remaining water after use. **Warning: When filling your iron with tap water always use the beaker provided. Never fill directly under the tap.**

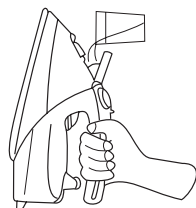

A

Temperature control

Plug in the iron and switch on. Set the temperature control dial **B** to the temperature required, but don't start ironing immediately. If you wait a few minutes, the iron will stabilise at the required setting. Your Morphy Richards iron is fitted with an indicator light 11 which will go on and off while you are ironing.

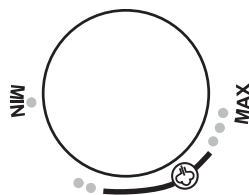

B

This is perfectly normal as it shows that the iron is maintaining the heat setting you have chosen.

It is always a good idea to begin with cool fabrics and work up to higher settings.

An iron heats up quicker than it cools down so you'll save time and electricity.

Features of your iron

Temperature indicator light

The indicator light shows that the iron is warming up. When the required temperature is reached the light will go out and will cycle on-off during operation.

Dry ironing

You can use your iron as a dry iron only. Make sure the variable steam control 1 is set to the '☒' symbol.

Any temperature setting may be used depending on the garment. The spray feature may be used provided there is water in the tank (see filling section). You do not need to put any water in the tank when dry ironing only.

Spray

Press the spray button 2 and aim the spray of water at stubborn creases. You can do this whilst dry ironing providing there is water in the tank. When using the water spray it may be necessary to push the button a few times to get the spray pump primed.



Variable steam

Fill the iron with water as described in 'Filling', page 4 and insert the plug into the electrical socket.

The steam output can be varied from low to high by sliding the variable steam control **C**. When using the iron at the bottom of the steam range, the steam output should be adjusted to the lowest setting.

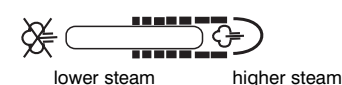

The steam facility should only be used on garments which are suitable for ironing at 2 and 3 dot setting.

Shot of steam

Press the shot of steam button 3 to obtain a burst of extra steam for ironing out creases in heavy material such as denim etc.

The shot of steam can be used whilst dry ironing, providing there is water in the tank, and the temperature control is set within the steam range.

Do not use shot of steam at temperatures below the steam range shown on the control.

Note: For optimum steam quality, do not operate the shot more than three times in succession.



Vertical steam

Hold the iron in a vertical position between 1cm and 2cm away from the item **D**. Press the shot of steam button 3, this will create vertical steam. This feature is especially useful for removing creases from hanging clothes, curtains, wall hangings, etc.

Note: For optimum steam quality, do not operate the shot more than three times in succession.

