

Rotary Tillers

RTR0542 and RTR0550

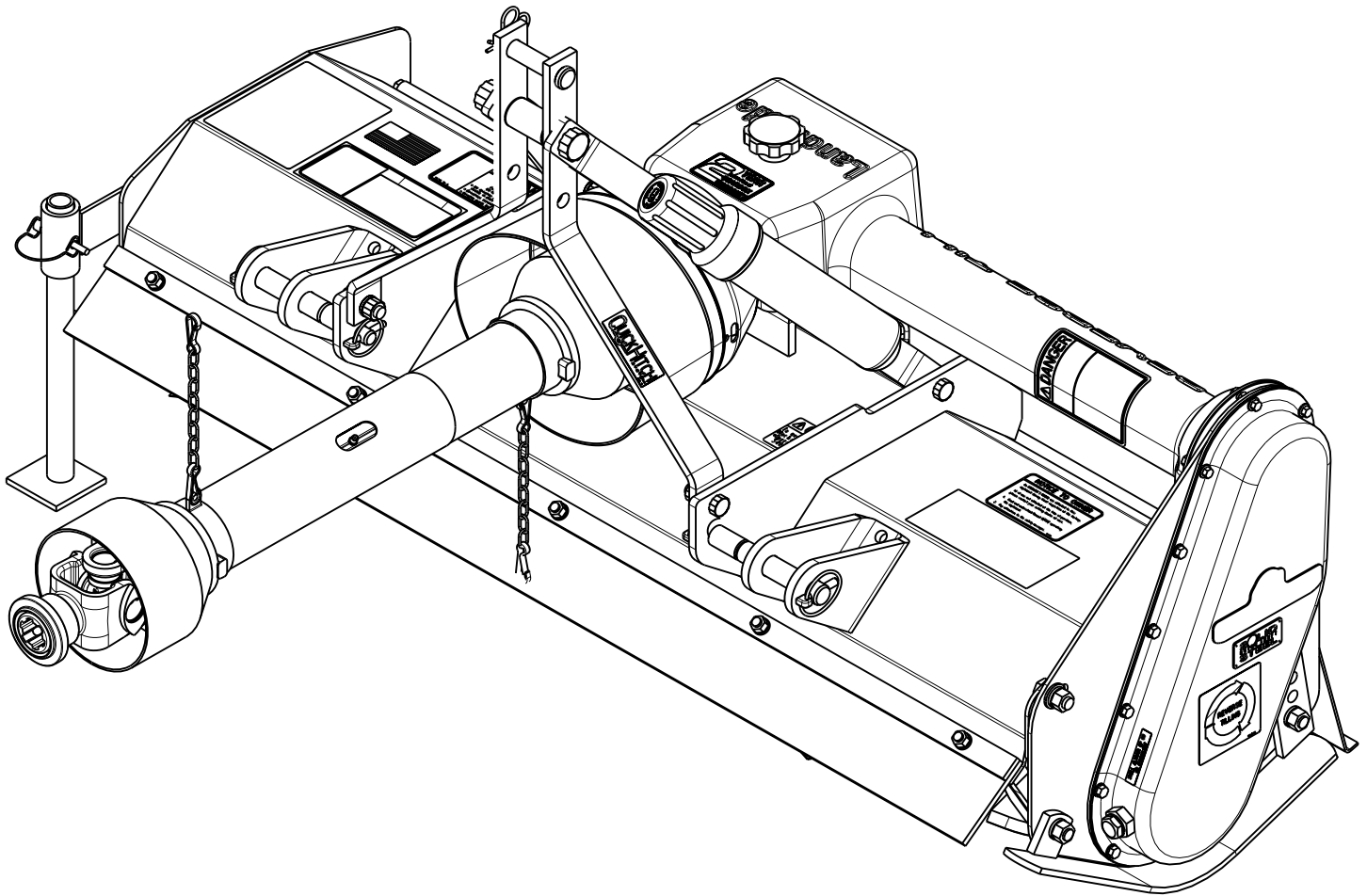

23769

311-464M Operator's Manual



Read the Operator's manual entirely. When you see this symbol, the subsequent instructions and warnings are serious - follow without exception. Your life and the lives of others depend on it!

© Copyright 2008 Printed

8/27/08

Cover photo may show optional equipment not supplied with standard unit.



Important Safety Information	1	Section 3: Adjustments	18
Safety at All Times	1	3-Point Hitch Adjustment	18
Look For The Safety Alert Symbol	1	Drive Chain Tension Adjustment	18
Safety Labels	4	Rear Deflector Adjustment	18
Introduction	8	Skid Shoe Adjustment	18
Application	8	Section 4: Maintenance and Lubrication	19
Using This Manual	8	Maintenance	19
Terminology	8	Tine Replacement	19
Definitions	8	Driveline Protection	19
Owner Assistance	8	Clutch Run-In	19
Serial Number Plate	8	Clutch Disassembly	20
Further Assistance	8	Clutch Assembly	20
Section 1: Assembly and Set-Up	9	Storage	20
Dealer Preparations	9	Lubrication	21
Tractor Requirements	9	Driveline U-Joint	21
Support Stand Adjustment	10	Driveline Shaft	21
Hitch Assembly	10	Chaincase	21
Tractor Hook-Up	11	Bearing On Right End Of Rotor Shaft	22
3-Point Category 0 Hitch	11	Gearbox	22
3-Point Category I-Limited Hitch	11	Section 5: Specifications & Capacities	23
3-Point Category I Hitch	12	Section 6: Features and Benefits	24
3-Point Category I Quick Hitch	12	Section 7: Troubleshooting	25
Support Stand Storage	12	Section 8: Appendix	26
3-Point Hitch Checks	12	Torque Values Chart for Common Bolt Sizes	26
Driveline Installation	13	Warranty	27
Section 2: Operating	15		
Operator's Responsibilities	15		
General Notes for Field Operations	15		
Operating Check List	16		
Transporting	16		
Parking	16		
General Operating Instructions	17		

© Copyright 2008 All rights Reserved

Land Pride provides this publication "as is" without warranty of any kind, either expressed or implied. While every precaution has been taken in the preparation of this manual, Land Pride assumes no responsibility for errors or omissions. Neither is any liability assumed for damages resulting from the use of the information contained herein. Land Pride reserves the right to revise and improve its products as it sees fit. This publication describes the state of this product at the time of its publication, and may not reflect the product in the future. The illustrations in this manual are not intended for safe and proper assembly or disassembly of equipment. The illustrations are intended for ordering parts only.

Land Pride is a registered trademark.

All other brands and product names are trademarks or registered trademarks of their respective holders.

Printed in the United States of America.

Important Safety Information

These are common practices that may or may not be applicable to the products described in this manual.

Safety at All Times

Thoroughly read and understand the instructions given in this manual before operation. Refer to the "Safety Label" section, read all instructions noted on them.

Do not allow anyone to operate this equipment who has not fully read and comprehended this manual and who has not been properly trained in the safe operation of the equipment.

- ▲ Operator should be familiar with all functions of the unit.
- ▲ Operate implement from the driver's seat only.
- ▲ Make sure all guards and shields are in place and secured before operating implement.
- ▲ Do not leave tractor or implement unattended with engine running.
- ▲ Dismounting from a moving tractor could cause serious injury or death.
- ▲ Do not allow anyone to stand between the tractor and implement while backing up to the implement.
- ▲ Keep hands, feet, and clothing away from power-driven parts.
- ▲ Wear snug fitting clothing to avoid entanglement with moving parts.
- ▲ Watch out for wires, trees, etc., when raising implement. Make sure all persons are clear of working area.
- ▲ Turning tractor too tight may cause implement to ride up on wheels. This could result in injury or equipment damage.
- ▲ Do not carry passengers on implement at any time.

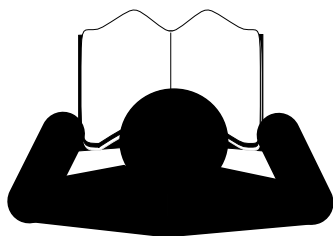

Look For The Safety Alert Symbol

The SAFETY ALERT SYMBOL indicates there is a potential hazard to personal safety involved and extra safety precaution must be taken. When you see this symbol, be alert and carefully read the message that follows it. In addition to design and configuration of equipment, hazard control and accident prevention are dependent upon the awareness, concern, prudence and proper training of personnel involved in the operation, transport, maintenance and storage of equipment.

Be Aware of Signal Words

A Signal word designates a degree or level of hazard seriousness. The signal words are:

⚠ DANGER

Indicates an imminently hazardous situation which, if not avoided, will result in death or serious injury. This signal word is limited to the most extreme situations, typically for machine components that, for functional purposes, cannot be guarded.

⚠ WARNING

Indicates a potentially hazardous situation which, if not avoided, could result in death or serious injury, and includes hazards that are exposed when guards are removed. It may also be used to alert against unsafe practices.

⚠ CAUTION

Indicates a potentially hazardous situation which, if not avoided, may result in minor or moderate injury. It may also be used to alert against unsafe practices.

For Your Protection

- ▲ Thoroughly read and understand the "Safety Label" section, read all instructions noted on them.

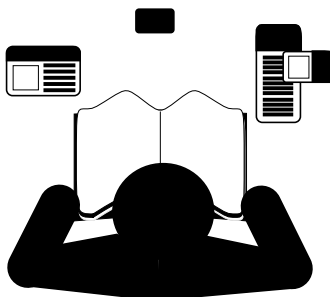

Shutdown and Storage

- ▲ Lower machine to ground, put tractor in park, turn off engine, and remove the key.
- ▲ Detach and store implements in a area where children normally do not play. Secure implement by using blocks and supports.

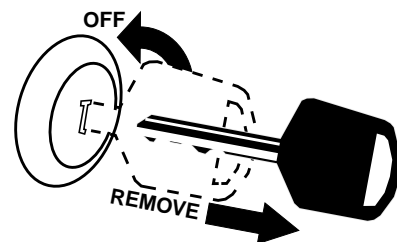

Important Safety Information

These are common practices that may or may not be applicable to the products described in this manual.

Use Safety Lights and Devices

- ▲ Slow moving tractors, self-propelled equipment, and towed implements can create a hazard when driven on public roads. They are difficult to see, especially at night.
- ▲ Flashing warning lights and turn signals are recommended whenever driving on public roads. Use lights and devices provided with implement.

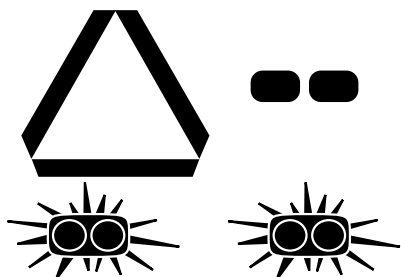
**Transport Machinery Safely**

- ▲ Comply with state and local laws.
- ▲ Maximum transport speed for implement is 20 mph. **DO NOT EXCEED.** Never travel at a speed which does not allow adequate control of steering and stopping. Some rough terrain require a slower speed.
- ▲ Sudden braking can cause a towed load to swerve and upset. Reduce speed if towed load is not equipped with brakes.

- ▲ Use the following maximum speed - tow load weight ratios as a guideline:

20 mph when weight is less than or equal to the weight of tractor.

10 mph when weight is double the weight of tractor.

- ▲ **IMPORTANT:** Do not tow a load that is more than double the weight of tractor.

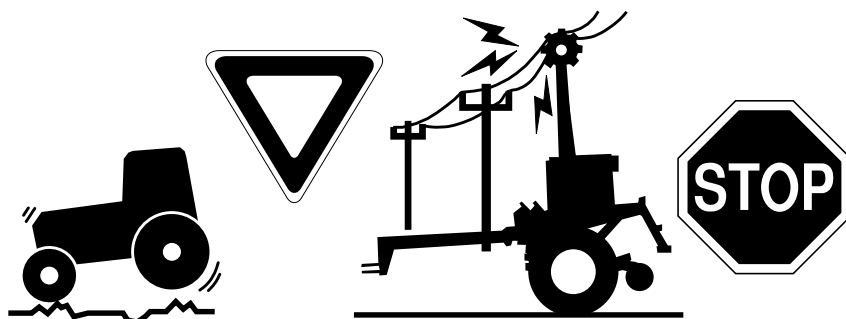
**Practice Safe Maintenance**

- ▲ Understand procedure before doing work. Use proper tools and equipment, refer to Operator's Manual for additional information.
- ▲ Work in a clean dry area.
- ▲ Lower the implement to the ground, put tractor in park, turn off engine, and remove key before performing maintenance.
- ▲ Allow implement to cool completely.
- ▲ Do not grease or oil implement while it is in operation.
- ▲ Inspect all parts. Make sure parts are in good condition & installed properly.
- ▲ Remove buildup of grease, oil or debris.
- ▲ Remove all tools and unused parts from implement before operation.



Important Safety Information

These are common practices that may or may not be applicable to the products described in this manual.

Prepare for Emergencies

- ▲ Be prepared if a fire starts.
- ▲ Keep a first aid kit and fire extinguisher handy.
- ▲ Keep emergency numbers for doctor, ambulance, hospital and fire department near phone.

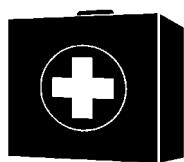
**Wear Protective Equipment**

- ▲ Protective clothing and equipment should be worn.
- ▲ Wear clothing and equipment appropriate for the job. Avoid loose fitting clothing.
- ▲ Prolonged exposure to loud noise can cause hearing impairment or hearing loss. Wear suitable hearing protection such as earmuffs or earplugs.
- ▲ Operating equipment safely requires the full attention of the operator. Avoid wearing radio headphones while operating machinery.

**Avoid High Pressure Fluids Hazard**

- ▲ Escaping fluid under pressure can penetrate the skin causing serious injury.
- ▲ Avoid the hazard by relieving pressure before disconnecting hydraulic lines or performing work on the system.
- ▲ Make sure all hydraulic fluid connections are tight and all hydraulic hoses and lines are in good condition before applying pressure to the system.
- ▲ Use a piece of paper or cardboard, NOT BODY PARTS, to check for suspected leaks.
- ▲ Wear protective gloves and safety glasses or goggles when working with hydraulic systems.
- ▲ If an accident occurs, see a doctor immediately. Any fluid injected into the skin must be treated within a few hours or gangrene may result.



Important Safety Information

Safety Labels

1. Your tiller comes equipped with all safety labels in place. They were designed to help you safely operate your tiller. Read and follow their directions.
2. Keep all safety labels clean and legible.
3. Replace all damaged or missing labels. To order new labels go to your Land Pride dealer.
4. Some new equipment installed during repair requires safety labels to be affixed to the replaced component as specified by Land Pride. When ordering new components make sure

the correct safety labels are included in the request. To order new labels go to your Land Pride dealer.

5. Refer to this section for proper label placement. To install new labels:

- a. Clean the area the label is to be placed.
- b. Spray soapy water on the surface where the label is to be placed.
- c. Peel backing from label. Press firmly onto the surface.
- d. Squeeze out air bubbles with the edge of a credit card.

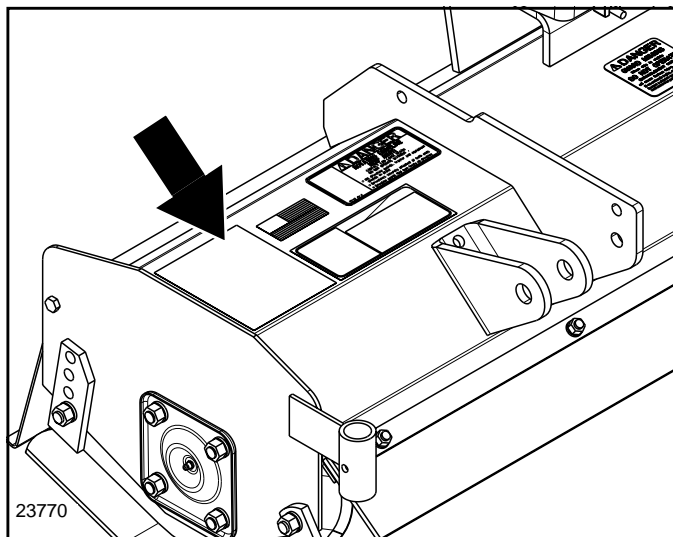

Reference RTR0542 & RTR0550 (Shown)

WARNING

To prevent serious injury or death:

- * Read and understand Operator's Manual before using. Review annually.
- * Do not permit riders on the tractor or implement. Never carry children on tractor seat.
- * Do not allow children to operate implement.
- * Operate only with guards installed and in good condition.
- * Keep away from moving parts.
- * Operate only with tractor equipped with ROPS and seatbelts.
- * Before operating, clear debris from working area.
- * Do not operate in the raised position.
- * Stop engine, set brake and wait for all moving parts to stop before dismounting.
- * Support implement securely before working beneath unit.
- * Transport with clean reflectors, SMV and working lights as required by federal, state, and local laws.
- * Stand clear when implement is in operation.

Si no lee ingles, pida ayuda a alguien que si lo lea para que le traduzca las medidas de seguridad.

818-858C REV.B

818-858C

General Safety Instructions

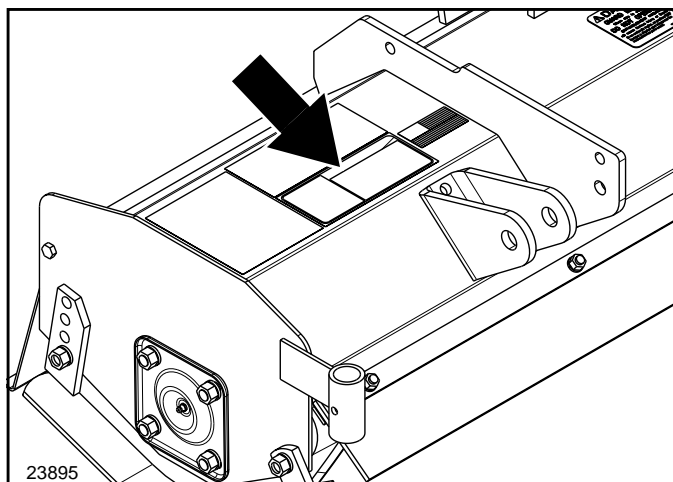

Reference RTR0542 (Shown) & RTR0550

DANGER

ROTATING TINES HAZARD

To prevent serious injury or death from rotating tines:

- DO NOT go under frame when tines are turning or engine is running. Keep others away.
- Disconnect & lockout power source BEFORE adjusting or servicing.
- Keep hands, feet, hair, and clothing away from moving parts.

818-171C Rev. C

818-171C

Rotating Tines Hazard!

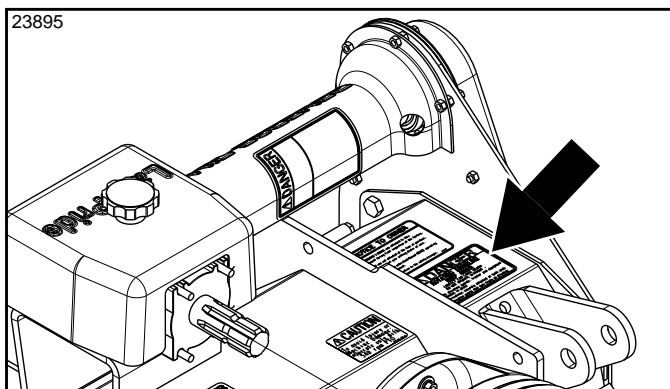
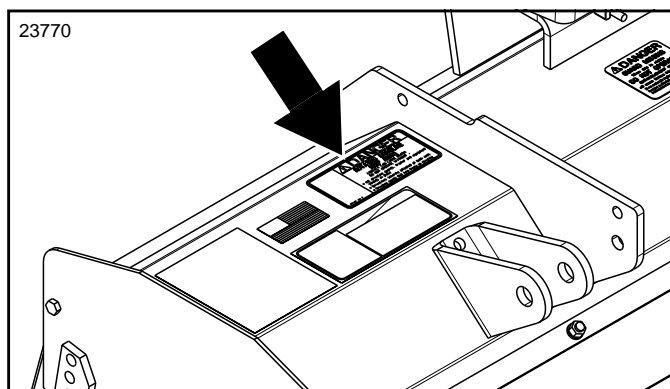
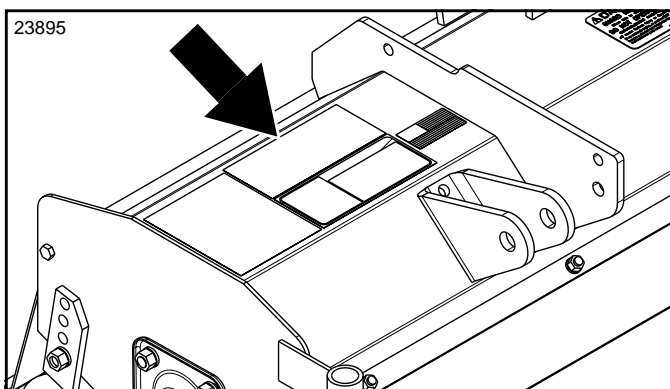
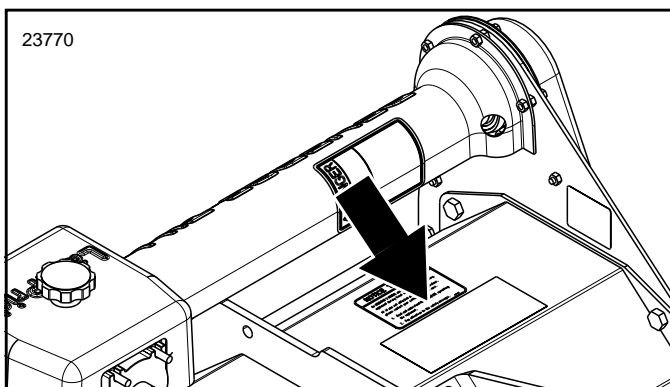
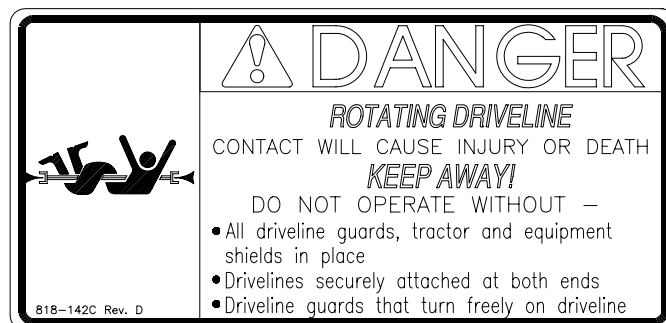
Important Safety Information**Reference RTR0542****Reference RTR0550****Reference RTR0542****Reference RTR0550****818-142C**

Rotating Driveline Hazard - Keep Away!

**818-284C**

Flying Debris Hazard!

Important Safety Information

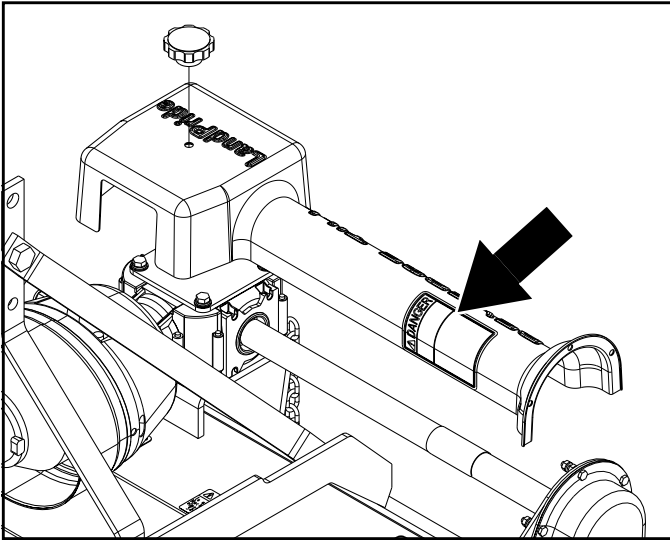

Reference RTR0542 & RTR0550 (Shown)

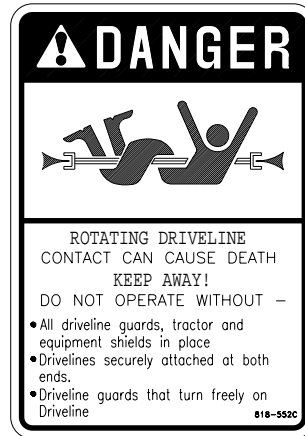

818-552C

Rotating Driveline Hazard
Keep Away!

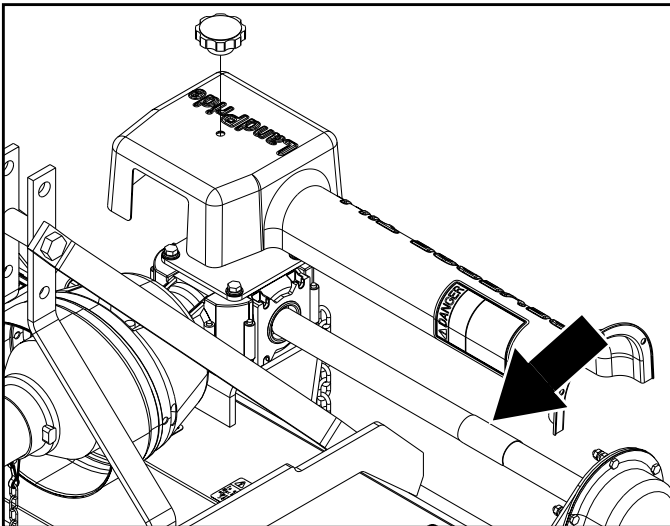

Reference RTR0542 & RTR0550 (Shown)



818-543C

Rotating Driveline Hazard - Keep
Away!

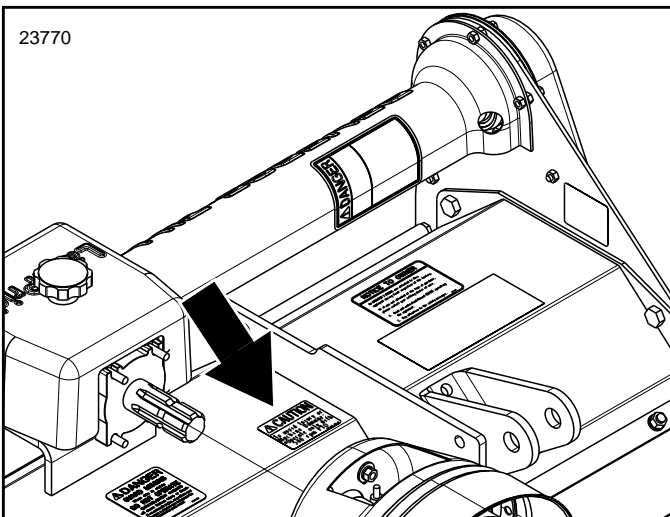

Reference RTR0542 & RTR0550 (Shown)



818-130C

Operate only w/540 rpm PTO

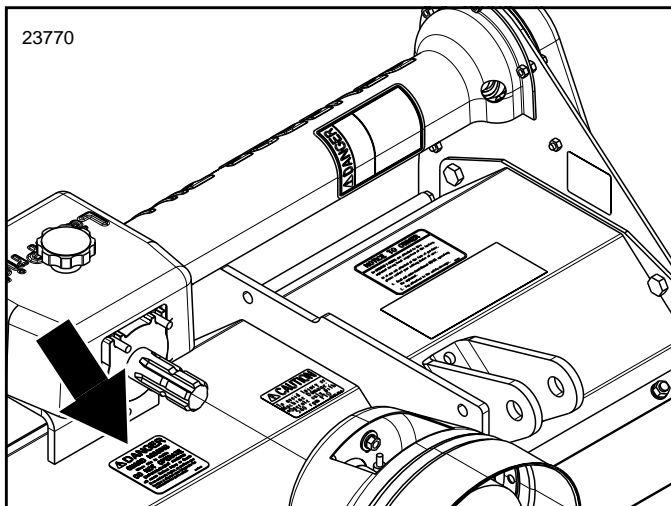
Important Safety Information

Reference RTR0542 & RTR0550 (Shown)

**818-543C**

Guard missing

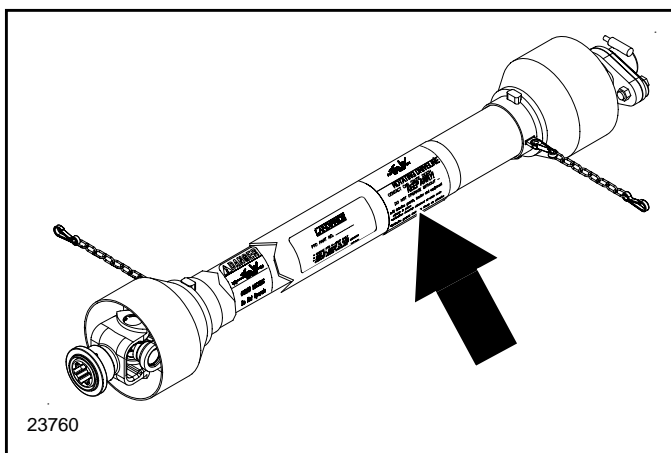

Reference RTR0542 & RTR0550

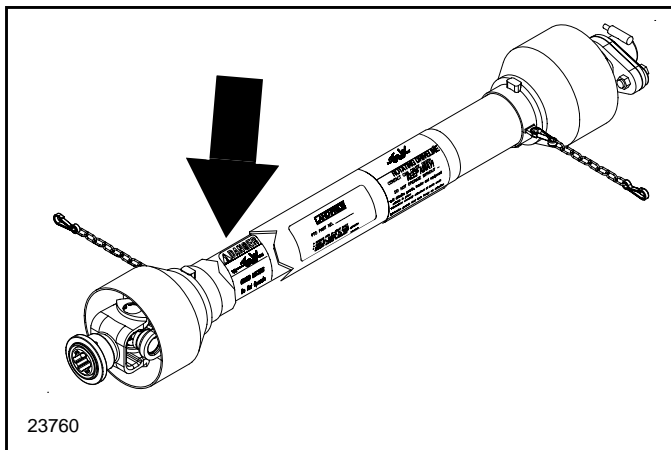
**818-552C**Rotating Driveline Hazard
Keep Away!

Reference RTR0542 & RTR0550

**818-540C**

Shield missing - Do Not operate.

Introduction

Land Pride welcomes you to the growing family of new product owners.

This rotary tiller has been designed with care and built by skilled workers using quality materials. Proper assembly, maintenance, and safe operating practices will help you get years of satisfactory use from the machine.

Application

The RTR05 Series Reverse-Till Rotary Tillers are designed and built by Land Pride to till soil for seedbed or planting preparation. The RTR05 Series tillers are adapted for tractors with 540 rpm PTO speed and Category 0, Category I-Limited and Category I 3-point hitch on tractors in the 17-25 HP range. The RTR05 Series are Quick-Hitch adaptable.

Reverse rotation tillers tend to achieve greater depth penetration, moving and pulverizing more soil in the process, while burying residue as opposed to leaving it on top. RTR05 Series Land Pride Tillers have applications in homeowner landscaping, smaller nurseries, gardens, smaller hobby farms, and medium duty residential use.

See "Features and Benefits" section or "Product Specifications" for additional information and performance enhancing options.

Using This Manual

- This Operator's Manual is designed to help familiarize you with safety, assembly, operation, adjustments, troubleshooting, and maintenance. Read this manual and follow the recommendations to help ensure safe and efficient operation.
- The information contained within this manual was current at the time of printing. Some parts may change slightly to assure you of the best performance.
- To order a new Operator or Parts Manual contact your authorized dealer. Manuals can also be downloaded, free-of-charge from our website at www.landpride.com.

Terminology

"Right" or "Left" as used in this manual is determined by facing the direction the machine will operate while in use unless otherwise stated.

Definitions

NOTE: A special point of information that the operator must be aware of before continuing.

IMPORTANT: A special point of information related to its preceding topic. Land Pride's intention is that this information should be read and noted before continuing.

Owner Assistance

The Warranty Registration card should be filled out by the dealer at the time of purchase. This information is necessary to provide you with quality customer service.

If customer service or repair parts are required contact a Land Pride dealer. A dealer has trained personnel, repair parts and equipment needed to service the implement.

The parts on your Rotary Tiller have been specially designed and should only be replaced with genuine Land Pride parts. Therefore, should your Rotary Tiller require replacement parts go to your Land Pride Dealer.

Serial Number Plate

For prompt service always use the serial number and model number when ordering parts from your Land Pride dealer. Be sure to include your serial and model numbers in correspondence also. Refer to Figure 1 for the location of your serial number plate

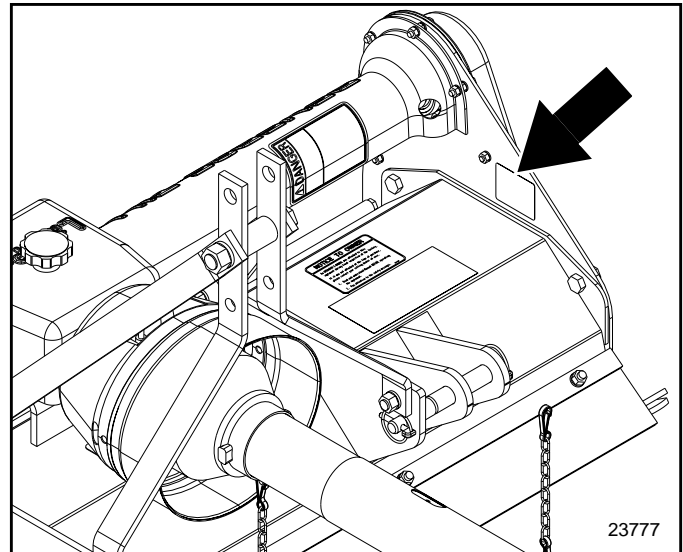

Serial Number Plate Location
Figure 1

Further Assistance

Your dealer wants you to be satisfied with your Rotary Tiller. If for any reason you do not understand any part of this manual or are not satisfied with the service received, the following actions are suggested:

1. Discuss the matter with your dealership service manager making sure he is aware of any problems you may have and that he has had the opportunity to assist you.
2. If you are still not satisfied, seek out the owner or general manager of the dealership, explain the problem and request assistance.
3. For further assistance write to:

Land Pride
Service Department
P.O. Box 5060
Salina, KS 67402-5060

E-mail address
lp servicedept@landpride.com

Section 1: Assembly and Set-Up

Dealer Preparations



CAUTION

To avoid bodily injury caused by accidental falling of tiller, securely support tiller on safe supporting stands or blocks!

This unit is shipped almost completely assembled. Carefully follow instructions for final assembly.

Before attempting assembly check the following items. Having all the needed parts and equipment readily at hand will speed up your assembly task and will make the job as safe as possible.

- Check for fasteners and pins that were shipped with the tiller. All hardware coming from the factory has been installed in the location where it will be used. If a part or fastener is temporarily removed for assembly reasons, remember where it goes. Keep the parts separated.
- Have a fork lift or loader along with chains and safety stands that are sized for the job ready for the assembly task.
- Have a minimum of 2 people on hand during assembly.
- Check to see that all nuts are tightened. Refer to the *Torque Values Chart* on page 26 for proper torque values.

Tractor Requirements

This tiller is designed to connect to a tractor's 3-point hitch with Category 0, Category I-Limited, Category I and Category I quick hitch. Tractor PTO rating should operate at 540 rpm and not exceed 25 horsepower.

NOTE: In order to maintain steering control, ballast may have to be added to your tractor. To determine whether or not to add ballast, refer to your tractor operator's manual.

1. **Category 0** tractors have 5/8" diameter hitch link holes in the center and lower hitch arms.
2. **Category I-Limited** tractors have a 7/8" diameter lower hitch link holes and either 5/8" or 3/4" diameter top center link hole. The lower arms are spaced closer together than a Category I hitch.
3. **Category I** tractors have a 7/8" diameter lower hitch link holes and 3/4" diameter top center link hole.

The lower 3-point arms must be stabilized to prevent side-to-side movement.

Section 1: Assembly and Set-Up

Support Stand Adjustment

Refer to Figure 1-1 on page 10:

1. Lower support stand (#1) to grade to stabilize the tiller while installing hitch assembly.
2. Secure support stand in bracket with 1/4" x 1 3/4" long wire lock pin (#8).

IMPORTANT: Before tilling, remove support stand (#1) from its support bracket, turn stand upside down and replace it through the top of the support bracket. Secure support stand in bracket with wire lock pin (#8).

Hitch Assembly

Refer to Figure 1-1:

1. Attach 3-point hitch Assembly (#2) to inside of the hitch plates with four 1/2" -13 x 1 1/4" GR5 long bolts (#4), 1/2" lockwashers (#7), and 1/2" nuts (#5).
2. Tighten hex nuts (#5) to the correct torque. Refer to *Torque Values Chart* on page 26 for proper torque values.
3. Tighten 3/4"-10 hex nut (#6) to the correct torque. Nut is installed on 3/4"-10 x 1 3/4" GR5 hex bolt.

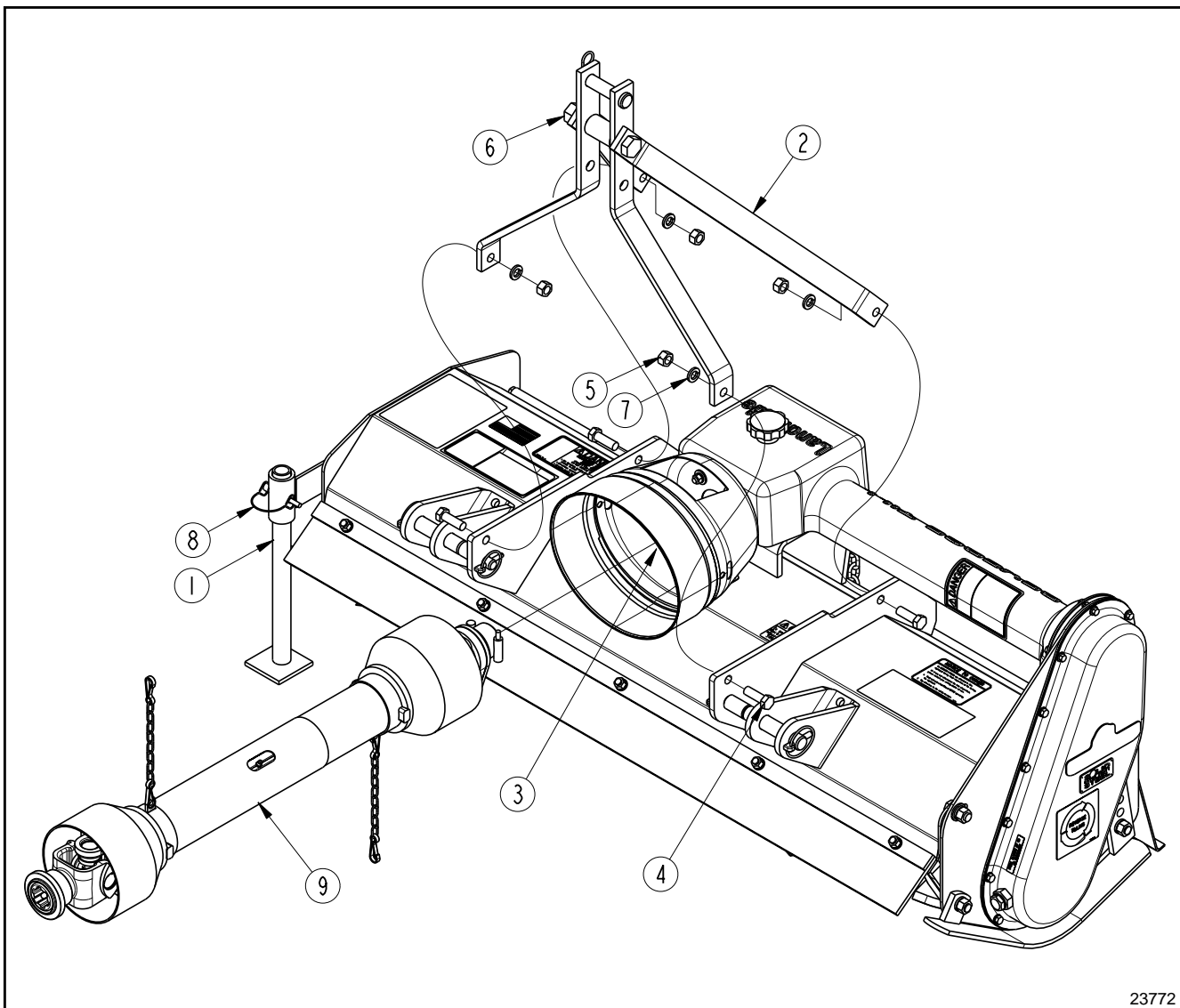

23772

Hitch, Support Stand and Driveline Assembly
Figure 1-1

Section 1: Assembly and Set-Up

Tractor Hook-Up

Refer to Figure 1-4:



DANGER

Tractor hook-up to equipment is dangerous and can result in serious injury or death. **Do not** allow anyone to stand between the tiller and tractor during hook-up operations. **Do not** operate the hydraulic 3-point lift controls while someone is directly behind the tractor or near the tiller.

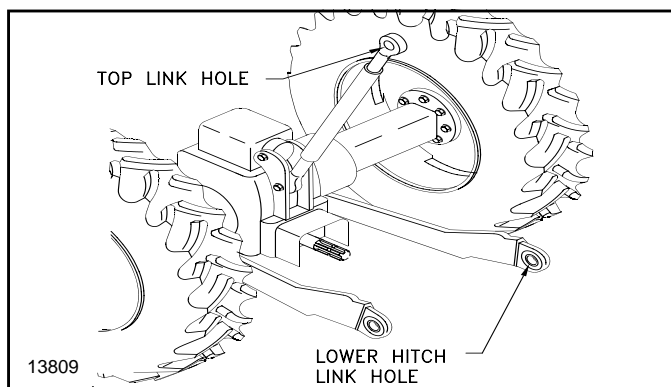

Tractor 3-Point Hitch
Figure 1-4

Refer to Figure 1-4:

For proper hitch configuration determine the hitch category for the tractor being used.

1. **Category 0** tractors have 5/8" diameter hitch link holes in the center and lower hitch arms.
2. **Category I-Limited** tractors have a 7/8" diameter lower hitch link holes and either 5/8" or 3/4" diameter top center link hole. The lower arms are spaced closer together than a Category I hitch.
3. **Category I** tractors have a 7/8" diameter lower hitch link holes and 3/4" diameter top center link hole.

The lower 3-point arms must be stabilized to prevent side-to-side movement. Most tractors have sway blocks or adjustable chains for this purpose.

3-Point Category 0 Hitch

Refer to Figure 1-5:

1. Remove the two inside 1/4" linch pins (#1) and hitch pins (#2). Remove hitch pin bushings (#3) and keep for future use with Category I-Limited and Category I tractor hook-ups.
2. Slowly back the tractor up to tiller until the lower 3-point arms are aligned with the inside hitch clevises on the tiller as shown.
3. Replace the lower hitch pins and replace the two 1/4" linch pins.
4. Attach the tractor's top center link to the tiller's lower 5/8" hitch holes using a 5/8" diameter hitch pin. Properly secure hitch pin with a linch pin. (Center hitch pin and linch pin are supplied by the customer).

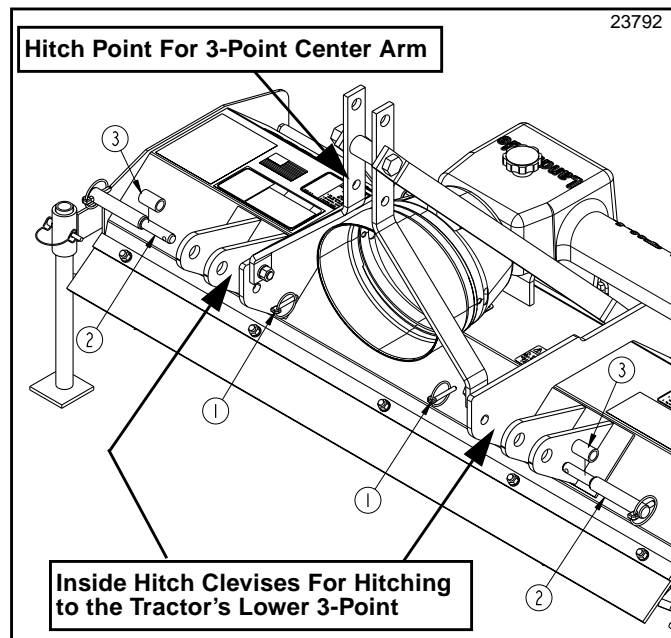

3-Point Category 0 Hitch
Figure 1-5

3-Point Category I-Limited Hitch

Refer to Figure 1-6:

1. Remove the two inside 1/4" linch pins (#1) and hitch pins (#2). Do not remove the hitch pin bushings (#3) from the hitch pins (#2).
2. Slowly back the tractor up to tiller until the lower 3-point arms are aligned with the inside hitch clevises on the tiller as shown.

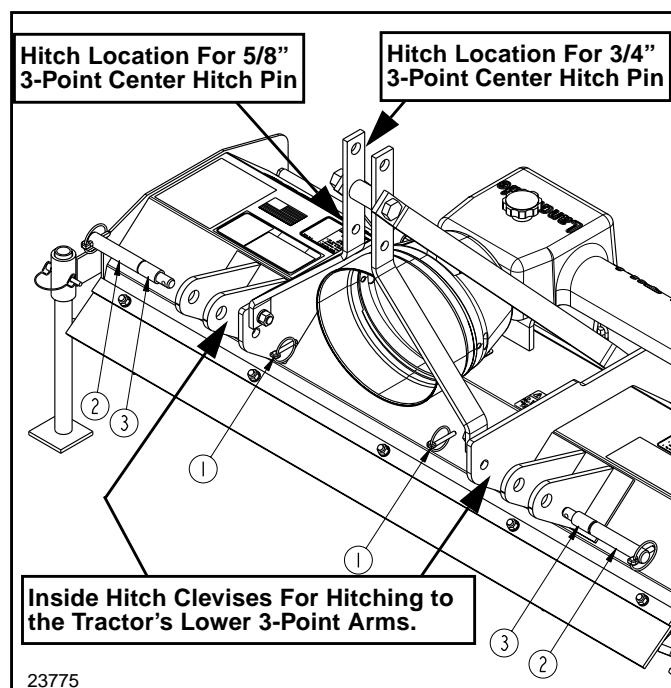

3-Point Category I-Limited Hitch
Figure 1-6

Section 1: Assembly and Set-Up

3. Replace the lower hitch pins (#2) and bushings (#3). Secure with two 1/4" linch pins (#1).
4. Depending upon the size of the hole in the tractor's top center link, attach the center link to either the tiller's lower 5/8" hitch holes or its upper 3/4" hitch holes with a hitch pin of the same diameter. Properly secure hitch pin with a linch pin. (Center hitch pin and linch pin are supplied by the customer).

3-Point Category I Hitch

Refer to Figure 1-7

1. Remove the two inside 1/4" linch pins (#1) and hitch pins (#2). Do not remove the hitch pin bushings (#3) from hitch pins (#2).
2. Slowly back the tractor up to tiller until the lower 3-point arms are aligned with the outside hitch clevises on the tiller as shown.
3. Replace the lower hitch pins (#2) and secure with the two 1/4" linch pins (#1).
4. Attach the tractor's top center link to the tiller's lower 3/4" hitch holes using a 3/4" diameter hitch pin. Properly secure hitch pin with a linch pin. (Center hitch pin and linch pin are supplied by the customer).

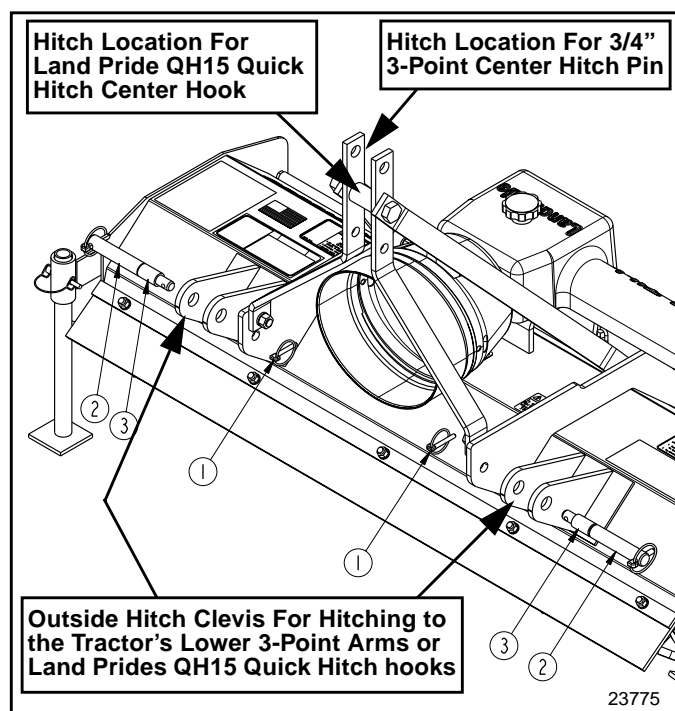

3-Point Category I-Limited Hitch
Figure 1-7

3-Point Category I Quick Hitch

Follow all instructions and safety precautions provided in Land Pride's QH15 Quick Hitch Operators Manual No. 320-003M. Also available free-of-charge from our website at www.landpride.com.

Support Stand Storage

Refer to Figure 1-8

1. Slowly raise the tiller with the tractor's hydraulic 3-point lift until the tines are about 1-2" above the ground.
2. Remove support stand wire retaining pin (#2) and support stand (#1).
3. Invert support stand (#1) and reinsert it in the support stand mounting bracket (#3) as shown.
4. Secure support stand in place with wire retaining pin (#2).

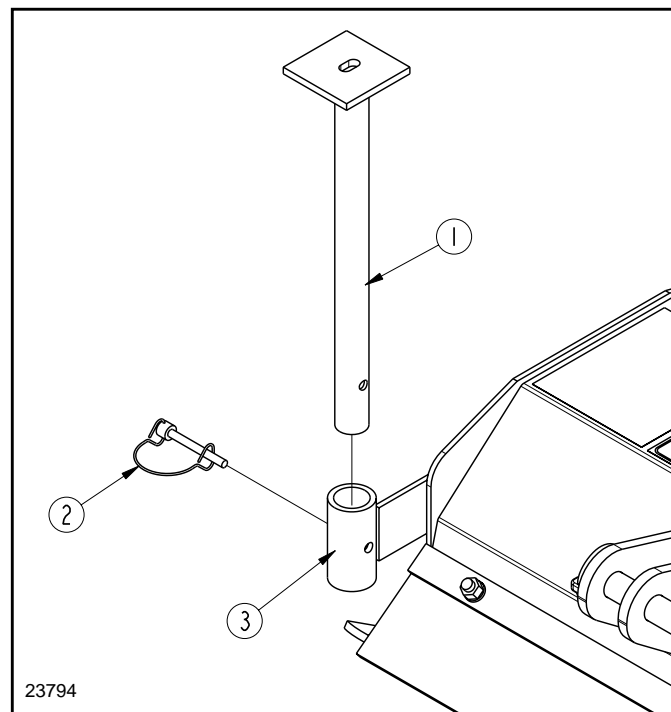

Support Stand Storage Position
Figure 1-8

3-Point Hitch Checks

1. Ensure that the lower arms are blocked to prevent excessive side movement.
2. Slowly raise the tiller with the tractor's hydraulic 3-point lift until the tines are about 1-2" above the ground.
3. Adjust the tractor's lower lift arms to level the tiller from left to right. **Final leveling adjustments will be made in the Adjustment Section on page 18.**
4. Adjust the top-link so that the tiller is approximately level from front to rear. **Final leveling adjustments will be made in the Adjustment Section on page 18.**
5. Slowly operate the tractor's 3-point hydraulic control up and down to check for clearance between the tires, frame, drawbar etc.

Section 1: Assembly and Set-Up

Driveline Installation

If the tiller is to be used on more than one tractor, an additional driveline may be required - especially if a quick hitch is used.



CAUTION

Do not use a PTO adaptor with a quick hitch. A PTO adaptor will increase the strain on the tractor's PTO shaft and can damage the PTO shaft and tiller driveline.



WARNING

Damaged drivelines can cause serious injury or death.



CAUTION

Tractor PTO shield and all tiller guards must be in place at all times during operation!

IMPORTANT: Some tractors are equipped with multi-speed PTO ranges. Be certain your tractor's PTO is set for 540 rpm.

IMPORTANT: PTO operation and/or engagement with unit raised too high will damage the driveline.

IMPORTANT: Land Pride recommends that a lift height limiter be used to prevent the tiller from being raised more than 4" to 6" out of the ground when PTO is engaged and when driving from site to site.

The tiller should be raised fully up only while loading and unloading from a transportation device such as a trailer.

IMPORTANT: Avoid premature driveline breakdown. A driveline that is operating **must not exceed** an angle of 25 degrees up or down while operating the 3-point lift. See Figure 1-9 below.

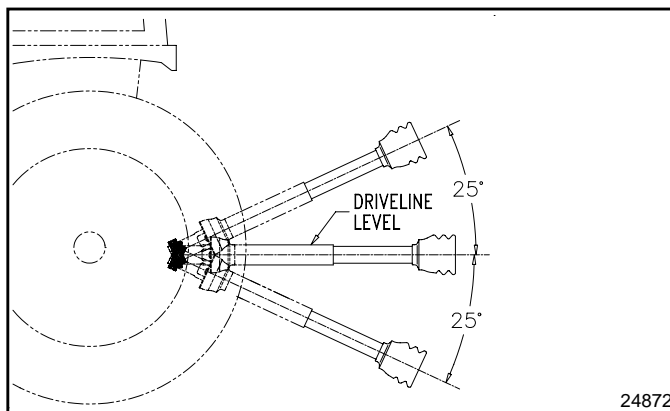

Maximum PTO driveline Movement During Operation
Figure 1-9

IMPORTANT: The PTO driveline may be too long for some tractors. If the tiller is used on more than one tractor, an additional PTO driveline may be required.

Refer to Figure 1-10 & Figure 1-11:

The tiller driveline is coupled to the tractor and implement shafts with either push pin couplers, pull collar couplers or a combination of both and with either a shear bolt or slip clutch on the implement end for protection from shock loads.

Always engage the PTO at low engine rpm to minimize start-up torque on the driveline. **Drivelines with friction clutches must go through a "run-in" operation prior to initial use and after long periods of inactivity.** See "Section 4: Maintenance and Lubrication" on page 19 for a detailed description of maintaining the driveline.

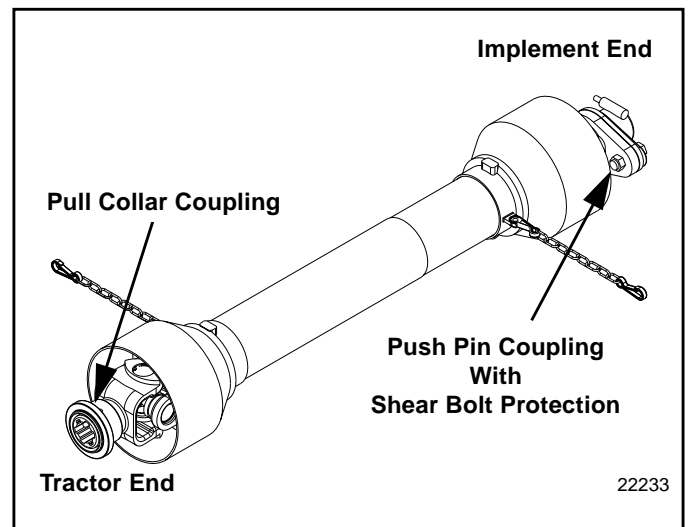

Figure 1-10

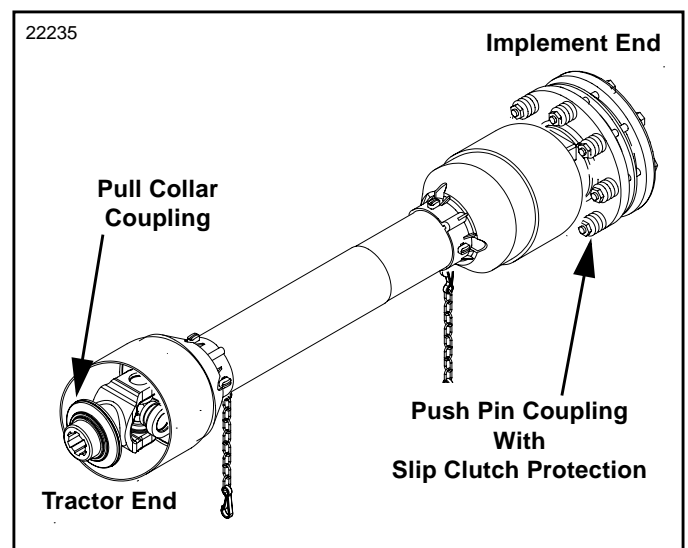
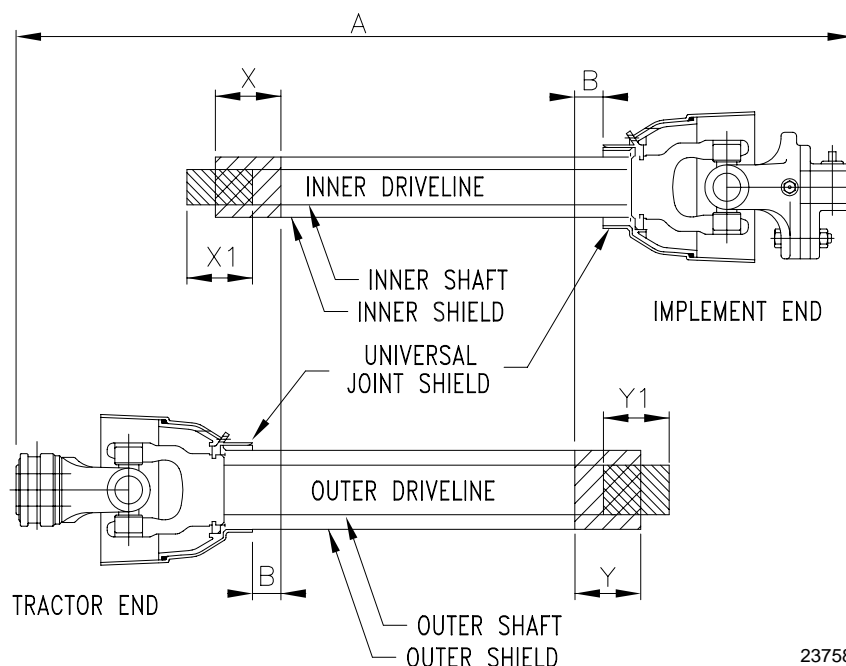

Figure 1-11

Section 1: Assembly and Set-Up



23758

Driveline Shortening
Figure 1-12

Refer to Figure 1-1 on page 10:

IMPORTANT: The implement must be raised fully up when checking to see if the driveline will fit correctly between tractor and tiller.

1. Start tractor and slowly engage tractor's hydraulic 3-point to lift the arms fully up.
2. Slide the slip clutch or shear bolt yoke end of driveline (#9) over the splined input shaft of gearbox (#3). Secure with driveline yoke locking device.
3. Slide the opposite driveline yoke end over the tractor's splined driveline shaft. Secure with driveline yoke locking device. Skip to step 5 if driveline fits between tractor and implement.

Refer to Figure 1-12:

4. The driveline will require shortening if it is too long. Shorten driveline as follows:
 - a. Set tractor in park, shut tractor engine off, set park brake and remove switch key.
 - b. Pull driveline apart into two sections as shown in Figure 1-12. Attach the outer driveline universal joint to the tractor shaft and inner driveline universal joint to the tiller gearbox shaft. Pull on each driveline section to be sure the universal joints are secured to the shafts.
 - c. Hold the driveline sections parallel to each other to determine if they are too long. The inner and outer shields on each section should end approximately 1/4" short of reaching the universal joint shield on the adjacent section

(see "B" dimension). If they are too long, measure 1/4" ("B" dimension) back from the universal joint shield and make a mark at this location on the inner and outer driveline shields.

- d. Cut off the inner shield at the mark ("X" dimension). Cut the same amount off the inner shaft ("X1" dimension). Repeat cut off procedure ("Y" & "Y1" dimensions) to the outer driveline half.
- e. Remove all burrs and cuttings.
- f. Apply multi-purpose grease to the inside of the outer shaft and reassemble the driveline.
- g. Attach inner driveline yoke end to the tiller divider gearbox input shaft.
- h. Attach outer driveline yoke to the tractor's shaft.
5. The driveline should now be moved back and forth to insure that both ends are secured to the tractor and tiller shafts. Reattach any end that is loose.

IMPORTANT: Two small chains are supplied with the driveline. These chains must be attached to the driveline shields and to the rotary tiller and tractor to restrict the shields from rotating.

6. Hook driveline safety chain at the tiller to the square tube located between the two hitch plates. Re-latch safety chain at the driveline guard.
7. Hook driveline safety chain at the tractor to the tractor. Re-latch safety chain at the driveline guard.
8. Slowly operate the tractor's 3-point hydraulic control up and down and check for clearance between the driveline and drawbar.

Section 2: Operating

Operator's Responsibilities



WARNING

It is the operator's responsibility not to allow anyone near the tiller during its operation.



WARNING

Do not till on inclines exceeding 15 degrees. The action of the tines being forced down into the ground can cause tractor roll-over on steep inclines.



CAUTION

Be sure that you are not working over any underground wiring, pipes, or other obstructions. If there is any doubt, call your public service agency.



DANGER

Make all hydraulic adjustments from the tractor seat. Never make adjustments while standing along side the tractor or behind the tractor.



DANGER

Clear the area of debris before tilling. Blade impact on objects not seen can cause projectiles resulting in bodily injury or death.

- Follow all directions on the safety labels.
- Make sure all safety labels are in their proper location and in good condition before operation.
- Do not allow anyone to operate this tiller who has not been properly trained in its safe operation.
- Do not let anyone under the age of 16 operate the tiller.
- Use the tiller for its intended purpose only.
- Never carry passengers or use the tiller as a wagon to carry things.
- Never use the tiller to pull or tow other equipment or objects.
- Do not operate the tiller with the front rubber dirt deflector removed.
- Do not operate the tiller in the raised position.
- Never work under the unit without properly blocking the unit up.
- Clear the area of debris before tilling.
- Before working the soil contact your local utility services, so that they may mark the location of any under ground utility services in the area. Be sure to ask how close you can work to the marks or flags they positioned.

- All nuts, bolts, screws, and fasteners should be checked periodically for tightness. Refer to the *Torque Value Chart* in the “**Appendix**” section on page 26.
- Do not alter the tiller in a way which will adversely affects its performance or reliability or use the tiller for a purpose for which it was not designed.

General Notes for Field Operations



CAUTION

Do not over speed PTO or machine damage may result. This tiller is designed to be used with a tractor using a 540 rpm rear PTO.

Before beginning to till, the following inspection should be performed:

1. Check oil level in gearbox and chaincase. Refer to the *Lubrication* portion of the “**Maintenance and Lubrication**” section on page 21.
 2. Check that all plugs have been replaced properly in the gearbox and chaincase.
 3. Be sure all tiller tines, bolts and nuts are tight.
 4. Be certain all guards, shields and dirt deflectors are in place and secure.
 5. Grease PTO shaft and all other grease fittings. Refer to the *Lubrication* portion of the “**Maintenance and Lubrication**” section on page 21.
 6. Clear the area to be tilled of rocks, branches and other foreign objects.
 7. Tall grass and weeds should be mowed before tilling.
 8. Operate with 540 rpm PTO tractor.
 9. At first begin tilling at a slow forward speed and shift up as ground conditions warrant.
 10. Tiller should be operated with the tiller deck level to the ground.
 11. Tiller tines will cut better when operating the tractor at full 540 rpm PTO speed than at reduced throttle.
 12. Do not engage PTO at full throttle.
 13. Tilling should not be done in wet conditions as soil will stick to tines.
 14. After tilling the first 50 feet, stop and check to see that the tiller is adjusted properly.
 15. Do not make turns or attempt to back up while tiller is in the ground. See important note below.
- IMPORTANT:** Turning or backing up with rotary tines in the ground will damage the tiller.
16. Do not engage PTO with machine in the fully raised or lowered position.
 17. Periodically check for foreign objects wrapped around the rotor shaft and remove them after disengaging PTO, turning off tractor engine and removing ignition key.

Section 2: Operating

Operating Check List

In addition to design and configuration of equipment, hazard control and accident prevention are dependent upon the awareness, concern, prudence and proper training involved in its operation, transport, maintenance and storage of equipment. Before beginning operation the following inspections should be performed.

<input type="checkbox"/>	Read and follow the “ Important Safety Information ” section on starting on page 1 carefully.
<input type="checkbox"/>	Read all of <i>Tractor Hookup</i> in the “ Assembly and Setup ” section on page 11.
<input type="checkbox"/>	Read all of the “ Operating Instructions ” section on page 15.
<input type="checkbox"/>	Lubricate the tiller as needed. Refer to the <i>Lubrication</i> portion of the “ Maintenance and Lubrication ” section on page 19.
<input type="checkbox"/>	Check the tiller initially and periodically for loose bolts & pins, using the <i>Torque Values Chart</i> in the “ Appendix ” section on page 26.
<input type="checkbox"/>	Make sure all guards, shields and dirt deflectors are in place.
<input type="checkbox"/>	Check initially and periodically for loose bolts, pins, and chains.

Transporting



CAUTION

When traveling on public roads whether at night or during the day, use accessory light and devices for adequate warning to operators of other vehicles. Comply with all federal, state and local laws.

IMPORTANT: Always disengage the PTO before raising the tiller to transport position.

1. When raising the tiller to the transport position, be sure that the driveline does not contact tractor or tiller. Adjust the tractor's 3-point hitch lift height so that the tiller's driveline is not lifted more than 25 degrees from horizontal to prevent damage to the driveline.
2. Be sure to reduce tractor ground speed when turning, and leave enough clearance so the tiller does not contact obstacles such as buildings, trees or fences.
3. Select a safe ground travel speed when transporting from one area to another. When traveling on roadways, transport in such a way that faster moving vehicles may pass you safely.
4. When traveling over rough or hilly terrain, shift tractor to a lower gear.

Parking

The following steps should be done when preparing to store the tiller or unhitch it from the tractor. See also *Storage* in the “**Maintenance and Lubrication**” section on page 20 for additional information on long term storage of your tiller.

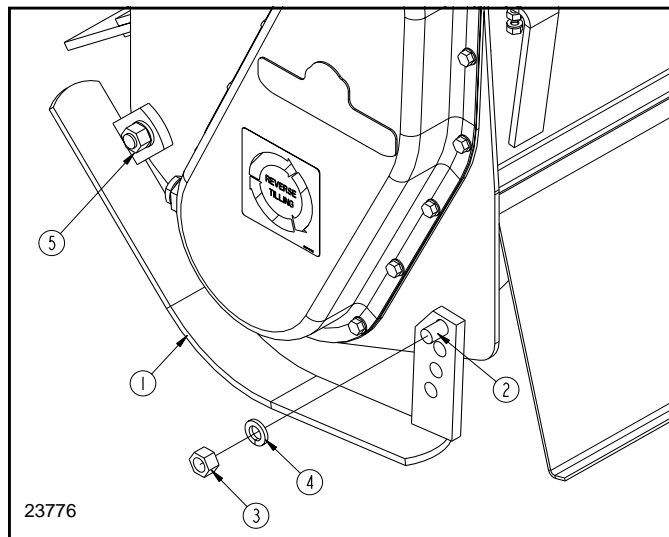

Figure 2-1

IMPORTANT: It is important to adjust the skid shoes fully down as shown in Figure 2-1 to stabilize the tiller when parked. Always follow “Skid Shoe Adjustment” steps on page 18 when repositioning the skid shoes.

Refer to Figure 2-1:

1. Reposition the left hand skid shoe (#1) by:
 - a. Loosen 1/2" -13 nut (#5).
 - b. Remove 1/2" nut (#3), 1/2" lockwasher (#4) and 1/2"-13 x 1 1/4" GR5 hex head cap screw (#2).
 - c. Pivot skid shoe down and replace hex head cap screw (#2) in the top hole as shown. Secure cap screw with nut (#3) and lockwasher (#4).
 - d. Tighten nuts (#3 & #5) to the correct torque. Refer to *Torque Values Chart* in the “**Appendix**” section on page 26 for the proper torque.
2. Repeat step #1 for the right hand skid shoe.
3. See Figure 1-1 on page 10. Remove support stand from the support bracket, turn it up-right and replace it through the bottom of the support bracket.
4. Secure support stand with wire lock pin.
5. Park tiller on a level, solid surface.
6. Shut tractor engine off and engage parking brake.
7. Unhitch tiller from tractor.



WARNING

Place blocks under the tiller as needed to prevent it from tipping over onto a child and/or an adult. A tiller that tips over can result in injury or death.

8. Check tiller for stability by physically applying pressure at the hitch plates to see if it will tip forward or backward. If the tiller moves in either direction, then block under the tiller as needed to prevent that movement.

Section 2: Operating

General Operating Instructions

Before using your Land Pride RTR05 Series Reverse-Tine Rotary Tiller, you should have completely read the Operator's Manual, properly attached the Tiller to the tractor, cut the driveline to proper length, run-in the clutch if your model is equipped with one, and gone through the Operating Checklist. If you have missed any of these steps, please complete them before proceeding.

Now that you have properly prepared yourself and your tiller, it's time to do some tilling. Carefully drive the tractor to the site where you intend to till. You should have already cleaned this site of any large limbs, rocks, trash, metal or extraneous debris. If you are in tall grass or weeds, we highly recommend you cut or mow before you till.

Line the tractor up just to the right of center on your tillage plot. You will be working from the center out and turning to the left to line up for your next pass. Lower the tiller half way to the ground and reduce your tractor engine speed to idle. Engage the PTO and gradually increase the engine speed until you reach full PTO speed of 540 rpm. Lower the tiller to the ground and simultaneously commence forward travel as ground conditions warrant. Do not make turns or attempt to back up while tiller is in the ground. See important note below.

<p>IMPORTANT: Turning or backing up with rotary tines in the ground will damage the tiller.</p>
--

Travel about 50 ft. and then stop to check your results. When stopping, remember to lift the tiller out of the ground, stop the tractor, reduce engine speed, disengage the PTO, set the park brake, shut off the tractor, and remove the keys. If you are tilling too shallow or too deep, adjust the skid shoes accordingly. If the soil texture is too coarse, lower the leveling door and reduce your ground speed. If the soil texture is too fine, you will need to raise your leveling door and increase your ground speed. For any other problem conditions that may arise, you will want to refer to the Troubleshooting section on page 25.

When you are done tilling for the day, make sure you use proper tractor shut down procedures before you get off of the tractor. If you are detaching your tiller, make sure you park it on a dry and level surface leaving it clean and ready for the next use. When you put your tiller up for the season, make sure you refer to the Storage Directions on page 20.

With a little practice and a few adjustments, you will soon be achieving the results you want with your Land Pride 05 Series Reverse Tine Rotary Tiller. See "Features and Benefits" on page 24 or "Product Specifications" on page 23 for additional information and performance enhancing options.

3-Point Hitch Adjustment

1. Park tractor and tiller on a flat level surface.
2. Slowly raise the tiller with the tractor's hydraulic 3-point lift until the tines are about 1-2" above the ground.
3. Ensure that the lower arms are blocked to prevent excessive side movement.
4. Place a spirit level on the top cover running from left to right and adjust one of the lower 3-point arms up or down until the tiller is level from left to right.
5. Rotate the spirit level 90 degrees and adjust the tractor's top center link in or out until the tiller is level from front to back.
6. Slowly operate the tractor's 3-point hydraulic control up and down to check for clearance between the tires, frame, drawbar etc.

Drive Chain Tension Adjustment

The tension on the drive chain is self adjusting and does not require any maintenance during the life of the chain.

Rear Deflector Adjustment

Refer to Figure 3-4:

The rear deflector (#1) can be adjusted closer to the ground to produce a fine soil texture or can be raised to produce a coarse soil texture. Adjust the chain length by repositioning the chain (#2) in slot "A".

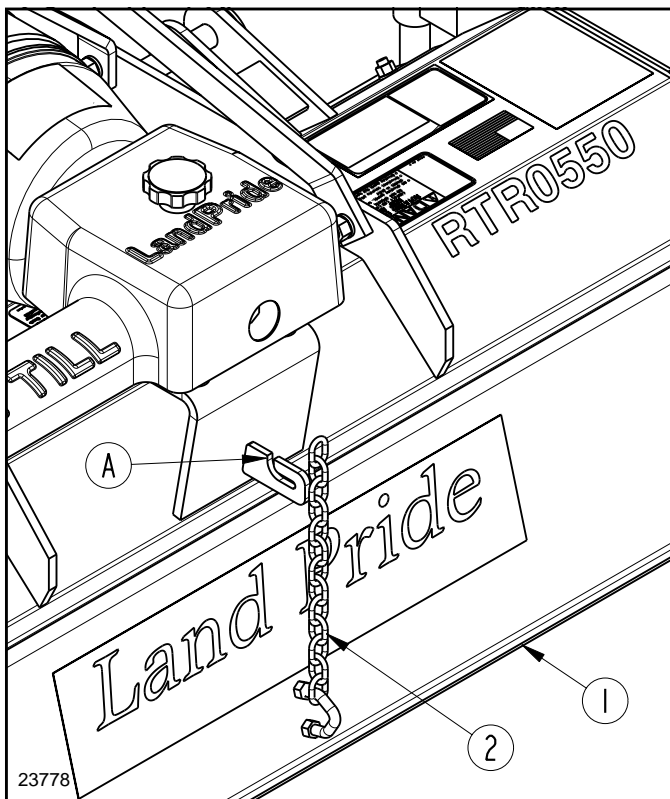

Rear Deflector
Figure 3-4

Skid Shoe Adjustment

Refer to Figure 3-5:

The skid shoes can be adjusted to the desired tilling depth by raising or lowering them as follows:

1. Raise tiller off the ground. Place a support under the tiller tines (not under the skid shoes) and lower the tiller onto the support. Make certain the tiller is secure when resting on the support before working on or around the tiller.
2. Always place tractor in park, set tractor brakes, shut tractor engine off and remove switch key before dismounting the tractor.
3. Loosen 1/2" -13 nut (#5).
4. Remove 1/2" nut (#3), 1/2" lockwasher (#4) and 1/2"-13 x 1 1/4" GR5 hex head cap screw (#2).
5. Pivot skid shoe down or up to the desired height and replace hex head cap screw (#2). Secure cap screw with nut (#3) and lockwasher (#4).
6. Tighten nuts (#3 & #5) to the correct torque. Refer to *Torque Values Chart* in the "Appendix" section on page 26 for the proper torque.

IMPORTANT: Be sure both skid shoes are adjusted the same.

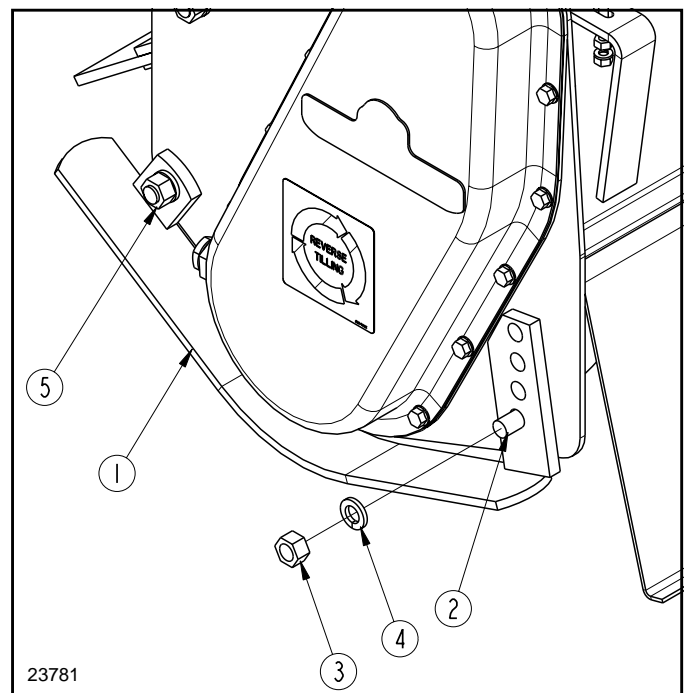

Skid Shoe Adjustment
Figure 3-5

Section 4: Maintenance and Lubrication

Maintenance

CAUTION

For safety reasons, each maintenance operation must be performed with the tractor's PTO disengaged, the Tiller lowered completely to the ground or on safely supported blocking, tractor engine shut off and ignition key removed.

Proper servicing and adjustment is the key to the long life of any implement. With careful and systematic inspection, you can avoid costly maintenance, time and repair.

After using your tiller for several hours, check all bolts to be sure they are tight.

Replace any worn, damaged or illegible safety labels by obtaining new labels from your Land Pride Dealer.

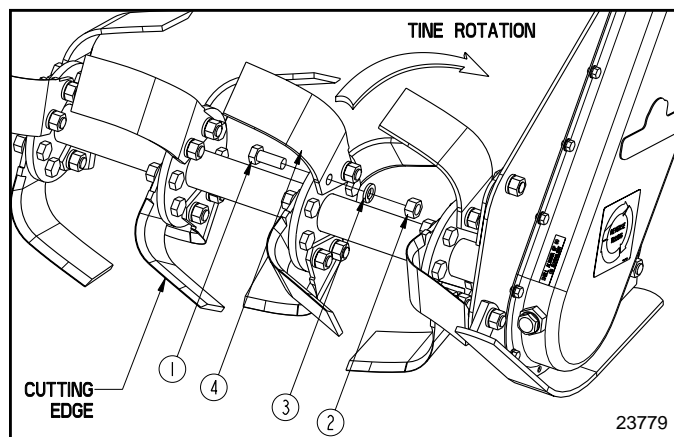

Tine Replacement
Figure 4-1

Tine Replacement

Refer to Figure 4-1:

IMPORTANT: Replace tines with genuine Land Pride tines only.

When ordering replacement tines, be sure to order both right and left hand tines. Always install tines with cutting edge facing direction of rotor shaft rotation.

WARNING

Worn tines may be very sharp!

- Remove two 1/2"-20 x 1 1/4" GR5 hex head cap screws (#1), hex nuts (#2) and lockwashers (#3). Remove tine (#4).
- Attach each new tine to the flange making certain it is mounted so that the cutting edge crosses over the flange and leads in rotation as shown in Figure 4-1.
- Replace cap screws and fasteners (#1, #2 & #3). Tighten nuts to proper torque. See *The Torque Values Chart* in the "Appendix" section on page 26.

Driveline Protection

CAUTION

Engage parking brake, disengage PTO, shut off tractor, and remove key before making any of the following adjustments.

Tiller drive components are protected from shock loads by either a two plate friction clutch or a shear bolt. Avoid shear bolt failure by engaging the PTO slowly at low engine rpm. See your Land Pride Dealer when replacing shear bolts. Torque shear bolt nuts to 8 ft. lbs.

Shear Bolt and Lock Nut Part Numbers

Part No.	Part Description
RTR05	
165.000.509	BOLT & NUT M6X40 CL 8.8 (Torque nut to 8 ft. lbs.)
Note: If M6 bolt shears excessively, a 1/4"-20 GR5 bolt & nut may be used. A 1/4" -20 GR8 bolt is not recommended as it may cause damage to profiles, tiller frame and/or components.	

Clutch Run-In

Friction clutches should be "run-in" prior to initial operation and after long periods of inactivity. To prevent driveline and gearbox damage, repeat "Run-In" instructions at the beginning of each season and when moisture and/or condensation seizes the inner friction plates.

Refer to Figure 4-2 on page 19

- Using a pencil or other marker scribe a line across the exposed edges of the clutch plates and friction disks.
- Carefully loosen each of the 8 spring retainer nuts by exactly 2 revolutions. It will be necessary to hold the hex end of the retainer bolt in order to count the exact number of revolutions.
- Start the tractor and engage the driveline drive for 2-3 seconds to permit slippage of the clutch surfaces. Disengage the driveline, then re-engage a second time for 2-3 seconds. Disengage driveline, shut off tractor and remove key. Wait for all components to stop before dismounting from tractor.

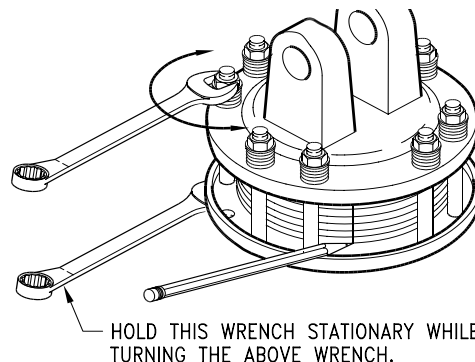

Clutch Run-In
Figure 4-2

Section 4: Maintenance and Lubrication

4. Inspect the clutch and ensure that the scribed markings made on the clutch plates have changed position. Slippage has not occurred if any two marks on the friction disk and plate are still aligned. A clutch that has not slipped must be disassembled to separate the friction disk plates. See *Clutch Disassembly* to disassemble clutch.
5. Tighten each of the 8 spring retainer nuts on the clutch housing exactly 2 revolutions to restore the clutch to the original setting pressure.
6. The clutch should be checked during the first hour of tilling and periodically each week. An additional set of scribe marks can be added to check for slippage. See *Clutch Assembly* to adjust for proper spring length.

Clutch Disassembly

Refer to Figure 4-4

Disassembly of the clutch is simply a matter of first removing the spring retainer nuts (#9a), springs (#2) and bolts (#9b) from the assembly. Each friction disk (#5) must then be separated from the metal surface adjacent to it.

Inspection

Inspect all parts for excessive wear and condition. Clean all parts that do not require replacement. The original friction disk thickness is 1/8" and should be replaced if the thickness falls below 3/32". If the clutches have been slipped to the point of "smoking", the friction disks may be damaged and should be replaced. Heat build-up may also affect the yoke joints.

Clutch Assembly

Refer to Figure 4-4

Reassemble each friction disk (#5) next to the metal plate it was separated from. Make certain bushing #4 is positioned as shown. Install bolts (#9b) through the end plates and intermediate plates as shown. Place springs (#2) over the bolts and secure with nuts (#9a).

Refer to Figure 4-3

Progressively tighten each spring retainer bolt until correct spring length "B" is reached.

- B = 1.335" to 1.345"

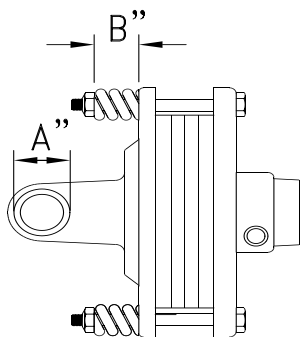

23576

Clutch Adjustment
Figure 4-3

Storage



CAUTION

Engage parking brake, disengage PTO, shut off tractor, and remove key before making any of the following adjustments.

At the end of the working season or when the tiller will not be used for a long period, it is good practice to clean off any dirt or grease that may have accumulated on any of the moving parts.

Check the tines for wear and replace if necessary. See *Tine Replacement* on page 19.

Inspect the tiller for loose, damaged or worn parts and adjust or replace if needed.

Lubricate as noted in *Lubrication* on page 21.

Repaint parts where paint is worn or scratched to prevent rust.

Drain gearbox and chaincase oil. Drain oil in gearbox by removing the bottom drain plug, or right hand cap. Drain oil in chaincase by removing the bottom plug and tipping tiller backwards. Be sure to refill gearbox and chaincase at this time.

Store tiller in a clean, dry place.

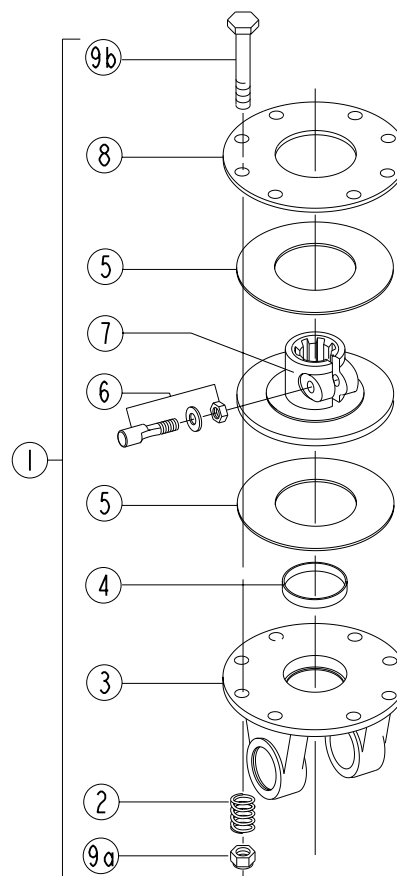

23844

Clutch Assembly
Figure 4-4

Section 4: Maintenance and Lubrication

Lubrication

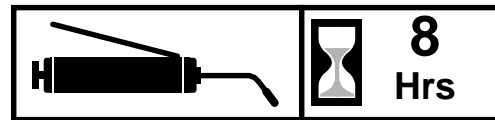
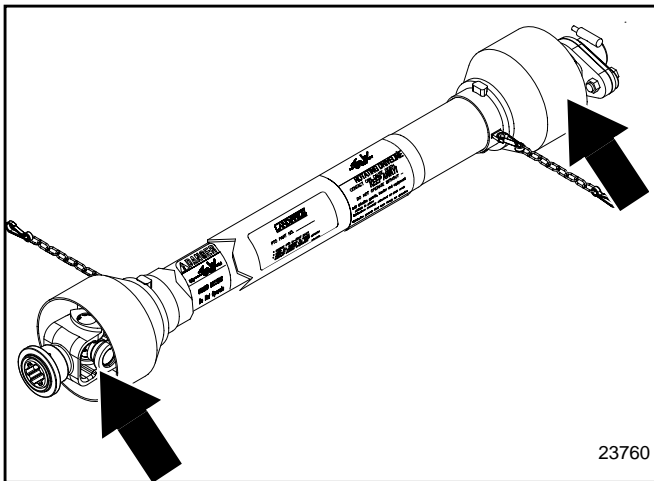
Lubrication
LegendMulti-purpose
spray lubeMulti-purpose
grease lubeMulti-purpose
oil lubeIntervals in hours at which
lubrication is required.**Driveline U-Joint**

Driveline U-joint with grease every 8 hours of operation

Type of grease = Multi-Purpose

Quantity = Coat Generously

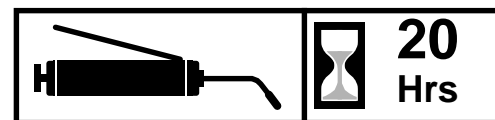
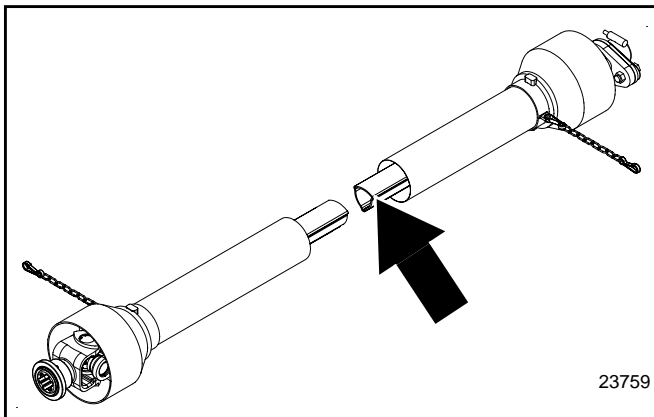
**Driveline Shaft**

Disconnect driveline shaft from the tractor and slide apart. Clean and coat the inner tube of the driveline shaft with a light film of grease and then reassemble.

Type of grease = Multi-Purpose

Quantity = Coat Generously

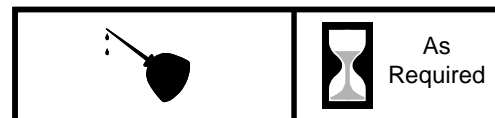
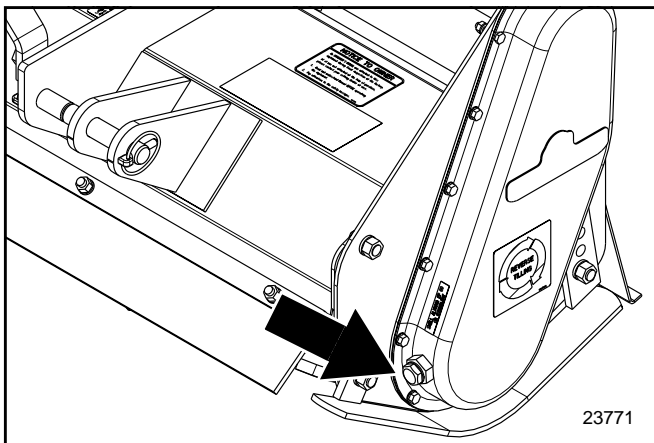
**Chaincase**

With tiller on level ground, check oil level in chaincase by removing lower plug. Oil should reach the plug hole. Fill if necessary with Shell Alvania EP 00 oil and retighten plug. Tiller should be level when checking.

Type = Recommended: Shell Alvania EP00 Oil
Alternate: SAE 90 wt. oil

Quantity = As required

Section 4: Maintenance and Lubrication

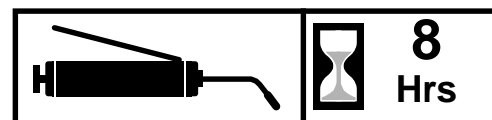
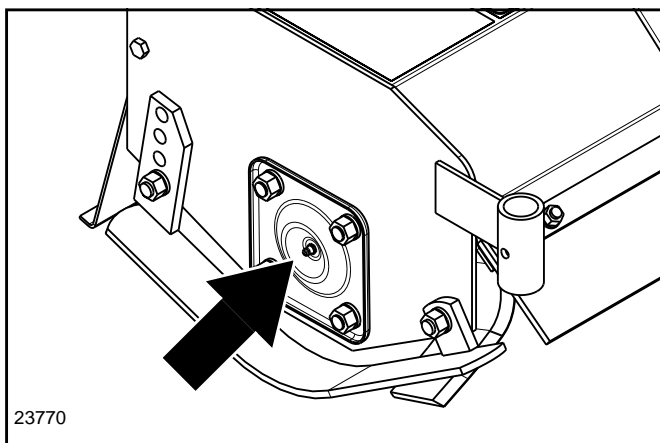

Bearing On Right End Of Rotor Shaft

Type of Lubrication: Multi-Purpose

Quantity = As Required

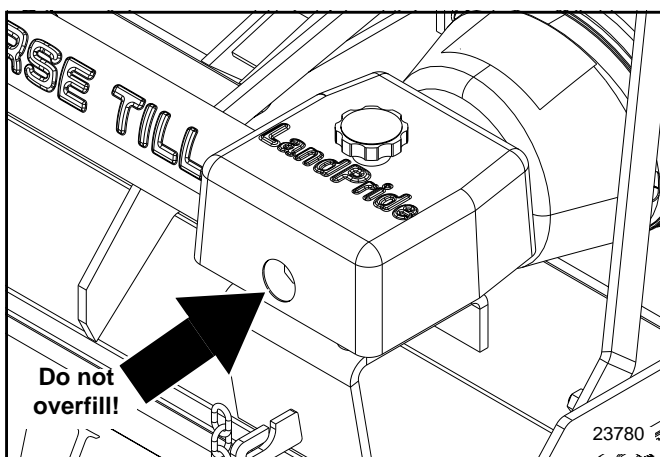

Gearbox

Check oil every 50 hours of operation. Check oil level in gearbox by removing the center plug at the rear of the box. Oil should come to bottom of center plug.

Type of Lubrication: SAE 80-90W EP Oil



RTR05 Series		
Model	RTR0542	RTR0550
Width	42"	50"
Overall Width	47 5/16"	55 5/16"
Weight	268#	298#
Number of flanges	5	6
Number of tines per flange	4	4
Driveline	Category II Shear-bolt - standard Slip-Clutch - optional	
Gearbox	25 HP input at 540rpm 1.92:1 ratio Cast iron housing, straight bevel gears	
Gearbox Lubrication	SAE 80-90W EP oil	
Drive Chain	#80 Roller chain in flowable grease bath	
Drive Chain Lubrication	Shell Alvania EP 00 or equivalent	
Sprockets	Case hardened teeth, splined bores	
Rotor Swing Diameter	13"	
Rotor Shaft Speed	225 rpm at 540 rpm PTO	
Recommended Maximum PTO HP	25 HP	
Hitch Type	Category 0, Category I-Limited, Category I and fits Land Pride's Category I Quick Hitch	



RTR05 Series



Features	Benefits
American made	Many tillers are imported. American made means better parts availability.
Gearbox Warranty	2 Years on housing, seals, & bearings. (Shows our confidence in the product.)
Working widths	42" and 50" to meet specific customer needs.
Tractor HP range	17-25 HP
Reverse tilling action	Reverse action 'sucks' tiller into ground, does not walk on top of hard ground like forward rotation tillers can.
Front deflector	Front deflector is flexible to take the beating from rocks or debris.
Formed rear deflector	Keeps dirt in and leaves a level finish. Forming gives deflector additional strength. Adjustable deflector allows for various finish results.
Adjustable skid shoes	Control depth with seven adjustments.
Solid rotor shaft	1 3/4" Solid steel rotor shaft for strength.
Double lip seal on rotor bearing	Double lip seal helps keep the dirt out and the grease in.
4 'C' shaped heat-treated tines per flange	'C' Shaped tines require less HP to move through the ground.
13" Rotor swing diameter	For deep tilling and turning the soil over faster.
5" Digging depth	For deep soil penetration.
Fully shielded shear pin or slip-clutch driveline	Protects the gearbox and rotor shaft upon hitting obstructions. Slip-clutch saves having to replace shear-pins.
Stamped chain cover	Stamped forming gives the chain cover strength.
#80 Drive chain enclosed in oil bath	Heavy drive chain stretches less, and oil bath keeps wear to a minimum.
Adjustable parking stand	Allows for easy hook-up and storage.
Clevis lower hitch	Provides additional strength and easy one person hook-up.
Fits Land Pride Quick-Hitch	Allows for quick and easy one person hook-up. Additional PTO driveline may be required.

Section 7: Troubleshooting

Problem	Cause	Solution
Machine makes intermittent clicking noise	Loose tines Gearbox tooth damaged Chain damaged	Tighten tines Replace damaged gear Replace damaged chain link
Driveline vibrates	Worn universal joint Excessive trash wrapped on rotor Machine lifted too high	Replace universal joint Remove trash Lower machine and readjust tractor lift stop
Gearbox noise is noticeable and constant	May be normal on new machine Low oil level Worn gears	Allow time for break-in Add oil Replace gears
Oil leaking from gearbox	Damaged seals or gaskets Gearbox overfilled	Replace seals or gaskets Drain to proper level
Rotor will not turn	PTO not engaged Broken drive chain Driveline shearbolt sheared Friction clutch slipping	Engage PTO Repair drive chain Replace shearbolt Reduce load to tiller
Tillage depth insufficient	Tiller carried by tractor Insufficient power Skid Shoes need adjusting Worn or bent tines Tines incorrectly installed Obstacles entangled in tines and/or rotor Lower hitch clevises on tiller in wrong position	Lower tractor 3-point arms Increase tractor rpm Adjust skid shoes Replace tines Check tine placement Clear rotor and/or tines Relocate lower hitch clevises
Soil texture too coarse	Rear deflector too high PTO speed too slow Ground speed too fast	Lower rear deflector Increase PTO speed Decrease ground speed
Soil texture too fine	Rear deflector too low Ground speed too slow	Raise rear deflector Increase Ground Speed
Machine skips or leaves crop residue	Badly worn tines Friction clutch slipping Ground speed too fast for conditions	Replace worn tines Reduce load Reduce ground speed
Tines balling up with soil	Worn or bent tines Tines incorrectly installed Rear deflector too low Tractor speed too fast Soil too wet	Replace tines Install tines correctly Raise rear deflector Decrease tractor speed Wait until soil dries
Tiller bumping on ground	Obstacles entangled in tines and/or rotor Tines not installed correctly	Clear rotor and/or tines Install tines correctly

Torque Values Chart for Common Bolt Sizes

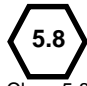
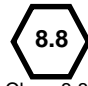
Bolt Size (Inches) in-tpi ¹	Bolt Head Identification					
	 Grade 2		 Grade 5		 Grade 8	
	N · m	ft-lb ³	N · m	ft-lb	N · m	ft-lb
1/4" - 20	7.4	5.6	11	8	16	12
1/4" - 28	8.5	6	13	10	18	14
5/16" - 18	15	11	24	17	33	25
5/16" - 24	17	13	26	19	37	27
3/8" - 16	27	20	42	31	59	44
3/8" - 24	31	22	47	35	67	49
7/16" - 14	43	32	67	49	95	70
7/16" - 20	49	36	75	55	105	78
1/2" - 13	66	49	105	76	145	105
1/2" - 20	75	55	115	85	165	120
9/16" - 12	95	70	150	110	210	155
9/16" - 18	105	79	165	120	235	170
5/8" - 11	130	97	205	150	285	210
5/8" - 18	150	110	230	170	325	240
3/4" - 10	235	170	360	265	510	375
3/4" - 16	260	190	405	295	570	420
7/8" - 9	225	165	585	430	820	605
7/8" - 14	250	185	640	475	905	670
1" - 8	340	250	875	645	1230	910
1" - 12	370	275	955	705	1350	995
1-1/8" - 7	480	355	1080	795	1750	1290
1 1/8" - 12	540	395	1210	890	1960	1440
1 1/4" - 7	680	500	1520	1120	2460	1820
1 1/4" - 12	750	555	1680	1240	2730	2010
1 3/8" - 6	890	655	1990	1470	3230	2380
1 3/8" - 12	1010	745	2270	1670	3680	2710
1 1/2" - 6	1180	870	2640	1950	4290	3160
1 1/2" - 12	1330	980	2970	2190	4820	3560

Bolt Size (Metric) mm x	Bolt Head Identification					
	 Class 5.8		 Class 8.8		 Class 10.9	
	N · m	ft-lb	N · m	ft-lb	N · m	ft-lb
M 5 X 0.8	4	3	6	5	9	7
M 6 X 1	7	5	11	8	15	11
M 8 X 1.25	17	12	26	19	36	27
M 8 X 1	18	13	28	21	39	29
M10 X 1.5	33	24	52	39	72	53
M10 X 0.75	39	29	61	45	85	62
M12 X 1.75	58	42	91	67	125	93
M12 X 1.5	60	44	95	70	130	97
M12 X 1	90	66	105	77	145	105
M14 X 2	92	68	145	105	200	150
M14 X 1.5	99	73	155	115	215	160
M16 X 2	145	105	225	165	315	230
M16 X 1.5	155	115	240	180	335	245
M18 X 2.5	195	145	310	230	405	300
M18 X 1.5	220	165	350	260	485	355
M20 X 2.5	280	205	440	325	610	450
M20 X 1.5	310	230	650	480	900	665
M24 X 3	480	355	760	560	1050	780
M24 X 2	525	390	830	610	1150	845
M30 X 3.5	960	705	1510	1120	2100	1550
M30 X 2	1060	785	1680	1240	2320	1710
M36 X 3.5	1730	1270	2650	1950	3660	2700
M36 X 2	1880	1380	2960	2190	4100	3220

¹ in-tpi = nominal thread dia. inches-threads per inch
² N · m = newton-meters
³ ft-lb = foot pounds
⁴ mm x pitch = nominal thread dia. in millimeters x thread pitch

Torque tolerance + 0%, -15% of torquing values. Unless otherwise specified use torque values listed above.

Warranty

Land Pride warrants to the original purchaser that this Land Pride product will be free from defects in material and workmanship beginning on the date of purchase by the end user according to the following schedule when used as intended and under normal service and conditions for personal use.

Use: Strictly for residential use only.

Overall Unit and Driveline: One year Parts and Labor

Gearbox: 2 years Parts and Labor

Tines and Driveline Friction Discs: Considered wear items

This Warranty is limited to the replacement of any defective part by Land Pride and the installation by the dealer of any such replacement part, and does not cover common wear items such as blades, belts, tines, etc. Land Pride reserves the right to inspect any equipment or parts which are claimed to have been defective in material or workmanship.

This Warranty does not apply to any part or product which in Land Pride's judgment shall have been misused or damaged by accident or lack of normal maintenance or care, or which has been repaired or altered in a way which adversely affects its performance or reliability, or which has been used for a purpose for which the product is not designed. Misuse also specifically includes failure to properly maintain oil levels, grease points, and driveline shafts.

Claims under this Warranty should be made to the dealer which originally sold the product and all warranty adjustments must be made through such dealer. Land Pride reserves the right to make changes in materials or design of the product at any time without notice.

This Warranty shall not be interpreted to render Land Pride liable for damages of any kind, direct, consequential, or contingent to property. Furthermore, Land Pride shall not be liable for damages resulting from any cause beyond its reasonable control. This Warranty does not extend to loss of crops, any expense or loss for labor, supplies, rental machinery or for any other reason.

No other warranty of any kind whatsoever, express or implied, is made with respect to this sale; and all implied warranties of merchantability and fitness for a particular purpose which exceed the obligations set forth in this written warranty are hereby disclaimed and excluded from this sale.

This Warranty is not valid unless registered with Land Pride within 30 days from the date of purchase by the end user.



Corporate Office: P.O. Box 5060
Salina, Kansas 67402-5060 USA
www.landpride.com
