

REPLACING THE RECLINE ACTUATOR

It is imperative that Human Touch® products are repaired in a manner that ensures product safety and regulatory compliance and that is fully consistent with the practices used during the manufacturing process. Therefore, Human Touch requires that all product repairs are performed using only factory-new parts and in accordance with these repair instructions. Failure to adhere to these instructions voids the product warranty and releases Human Touch from all liability for injury or product damage resulting from the repair.

SERVICE LEVEL: 3

Tools Required: Phillips-head screwdriver, small flat-head screwdriver, 6 mm Allen wrench, nail clipper or other instrument suitable for cutting zip ties, new zip tie.

NOTE: SAVE ALL PARTS FOR USE DURING REASSEMBLY.

REMOVING THE RECLINE ACTUATOR

1. Power off the chair, then unplug it.



2. Gently tip the chair onto its side (Fig.1).
3. Locate the two cable harnesses that lead to the recline actuator (Fig.1).
4. Using a nail clipper or other instrument suitable for cutting zip ties, cut all the zip ties that secure both harnesses to the chair frame.
5. Using a Phillips-head screwdriver, remove the two screws that secure the connector junction box cover, then remove the cover (Fig.2).
6. Locate the connectors at the end of each of the recline actuator cable harnesses, then disconnect the connectors (Fig.3).

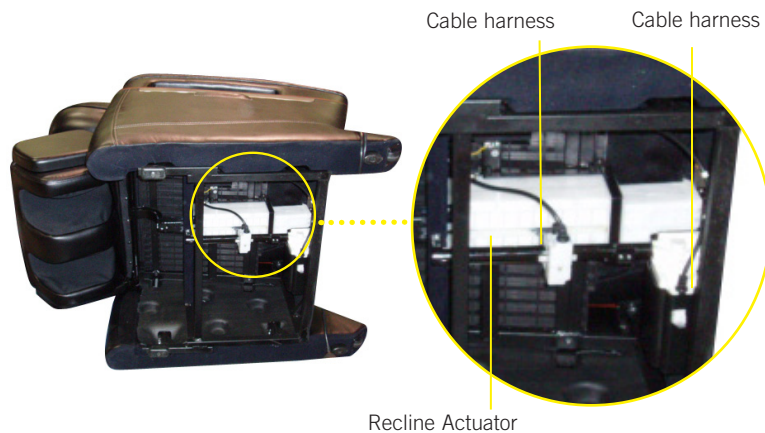

(Fig.1)

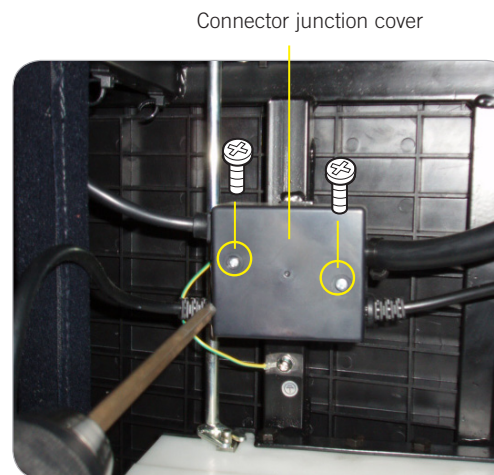

(Fig.2)

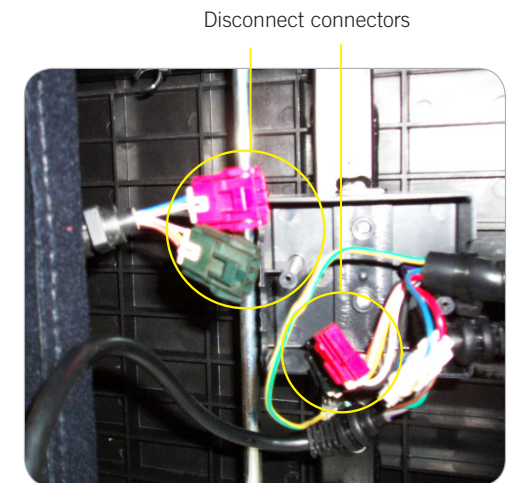

(Fig.3)

7. Using a Phillips-head screwdriver, remove the two screws from the bracket that secures the actuator shaft (Fig.4).
8. Using a 6-mm Allen wrench, remove the two Allen bolts that secure the white sensor housing to the calf massager deployment mechanism (Fig.5).
9. Using a small flat-head screwdriver, remove the “C” clip from the hinge pin that secures the actuator to the chair frame (Fig.6).
10. Remove the hinge pin, then remove the actuator from the chair (Fig.7).

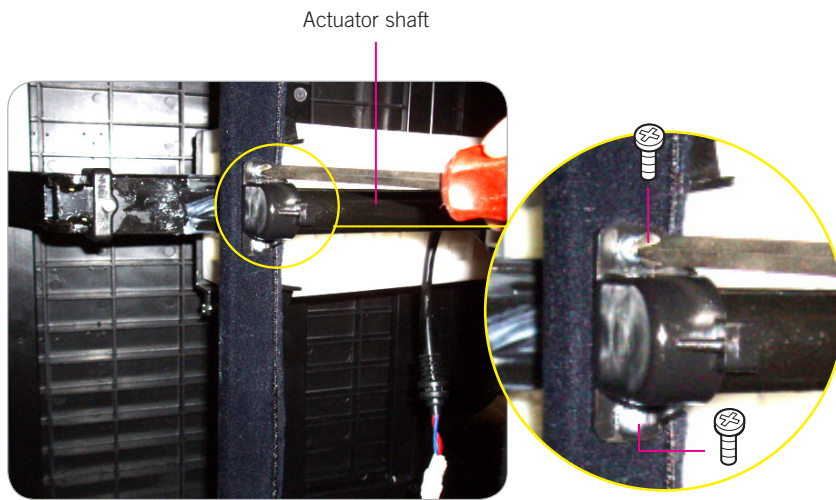

(Fig.4)

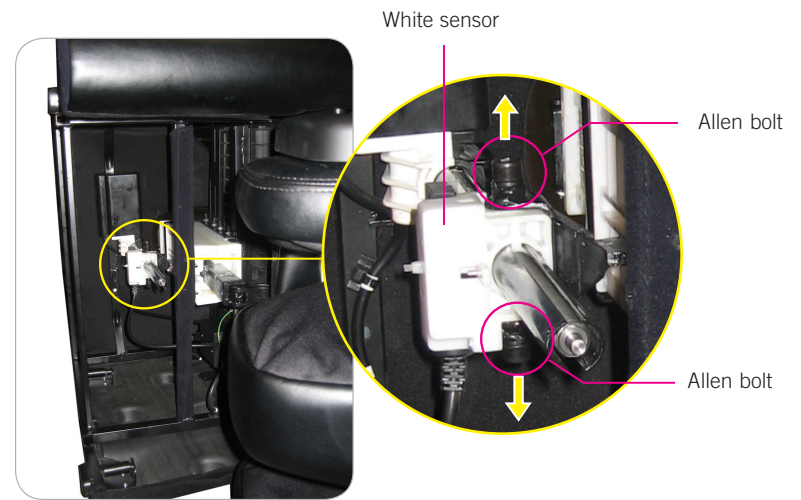

(Fig.5)

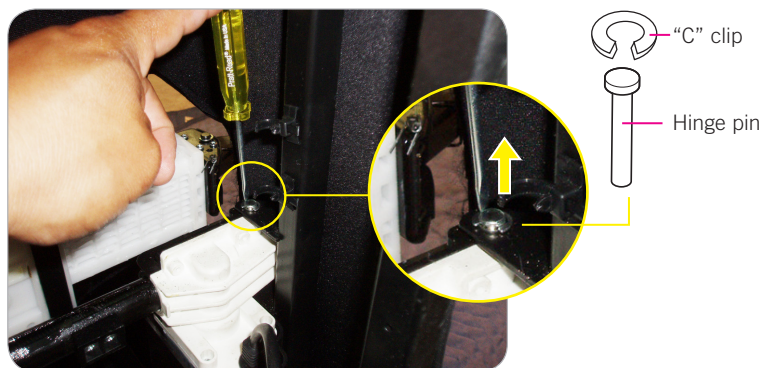

(Fig.6)

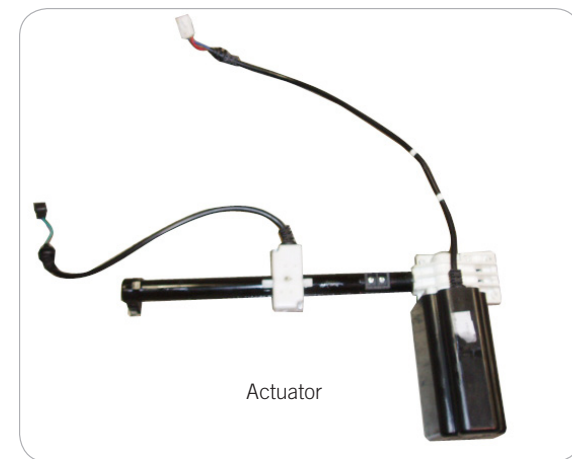

(Fig.7)

INSTALLING THE NEW RECLINE ACTUATOR

1. Place the new actuator into position, then install the hinge pin to hold it in place.
2. Replace the “C” clip to secure the hinge pin.
3. Replace the two Allen bolts to secure the sensor housing to the calf massager deployment mechanism.
4. Place the bracket that secures the actuator shaft into position, with the actuator threaded through it, then secure it using two screws.
5. Connect the actuator connectors to the corresponding connectors on the chair.
6. Place the connectors inside the connector junction box, replace the junction box cover, then secure it using two screws.
7. Replace the zip ties to secure the cable harnesses to the bottom of the chair frame.
8. Gently return the chair to the upright position.
9. Plug in the chair, power it on, then verify that the recline actuator is working properly.