

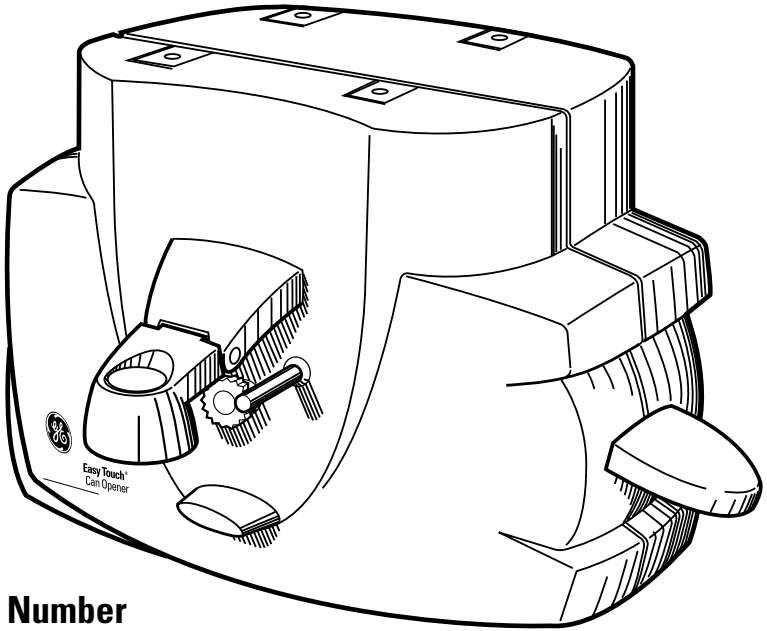

Easy Touch[®] Can Opener



Item Stock Number

GE106623

UPC:

681131066235

Can Opener Safety	2	How to Open Cans	6
Know Your Can Opener	3	How to Sharpen Knives	7
Mounting Your Can Opener	3	How to Open Bottles	7
Mounting Template	4	How to Clean Blade Assembly .	7
Mounting Directions	4	Customer Assistance	8

For product service, call customer service at (877) 207-0923

Can Opener Safety

IMPORTANT SAFEGUARDS

In order to prevent the risk of fire, electric shock, burns or other injury or damage, follow these instructions carefully. When using electrical appliances, basic safety precautions should always be followed including the following:

1. Read all instructions.
2. To protect against risk of electrical shock, do not immerse cord, plug or motor unit in water or other liquid.
3. Close supervision is necessary when any appliance is used by or near children.
4. Unplug from outlet when not in use, before putting on or taking off parts, and before cleaning.
5. Avoid contacting moving parts.
6. Do not operate any appliance with a damaged cord or plug, or after the appliance malfunctions or is dropped or damaged in any manner. Call Customer Service Dept. (see warranty) to return for examination, repair, or electrical or mechanical adjustment.
7. The use of attachments not recommended or sold by the manufacturer may cause fire, electric shock or injury.
8. Do not use outdoors.
9. Do not let cord hang over edge of table or counter, or contact hot surfaces, including the stove.
10. Do not open pressurized (aerosol-type) cans or cans of flammable liquids, such as lighter fluids.
11. Do not mount the unit over or near any portion of a heating or cooking appliance or a sink or basin.
12. To reduce the risk of fire or electric shock, do not operate any heating appliance beneath the mounted unit.

SAVE THESE INSTRUCTIONS!

Consumer Safety Information

THIS APPLIANCE IS INTENDED FOR HOUSEHOLD USE ONLY.

This appliance has a polarized plug (one blade is wider than the other). As a safety feature, this plug will fit in a polarized outlet only one way. If the plug does not fit fully in the outlet, reverse the plug. If it still does not fit,

contact a qualified electrician. Do not attempt to defeat this safety feature.

CAUTION: To reduce the risk of electric shock, do not immerse the can opener in water.

Know Your Can Opener

Parts and Features

- 1** Piercing Lever
- 2** Cutting Blade
- 3** Feed Wheel
- 4** Can Rest
- 5** Knife Sharpener
- 6** Bottle Opener

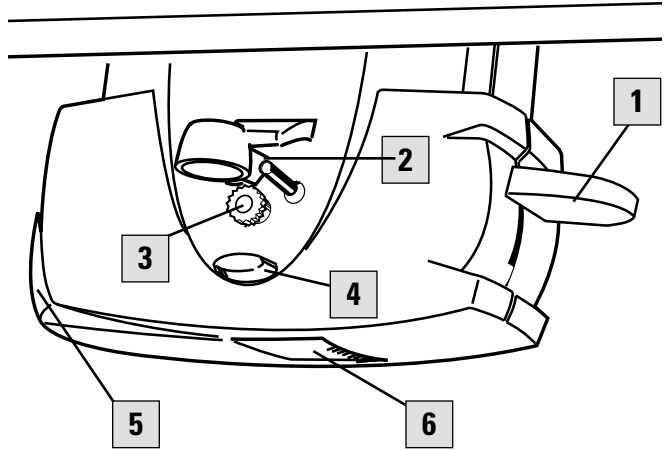

Mounting Your Can Opener

Where To Mount Your Can Opener

Your can opener is designed to be installed under a cabinet. Do not attempt to open cans until it has been properly mounted.

Hints For Selecting Location

- Can opener may be mounted under wood or metal cabinets. Do not attempt to open cans until it has been properly mounted.
- Hold can opener in various locations, making sure to allow room for operation of lever and bottle opener. Evaluate its appearance and convenience, keeping in mind your normal kitchen routine.
- Locate near an electrical outlet so the cord does not come in contact with other appliances or workspace.
- Do not mount can opener over a sink, range or other heating appliance or operate any heating appliance beneath the can opener.

Mounting Directions

1. Cabinet with overhang:
Fold the template along the dashed line. Line up the edge of the template to the edge of the cabinet on the underside, then tape in place.

Cabinet without overhang:
Fold template along the outside edge of the bold line. Line up the edge of template to the edge of the cabinet on the underside, then tape in place.

2. Mark the center of the four holes through the template using a sharp point (nail or awl).
3. Remove template and drill four $\frac{3}{16}$ " holes where marked.

CAUTION: Always use safety glasses when drilling to avoid eye injury.



MOUNTING TEMPLATE

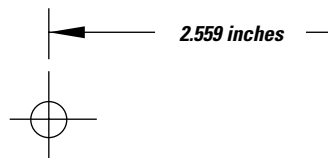
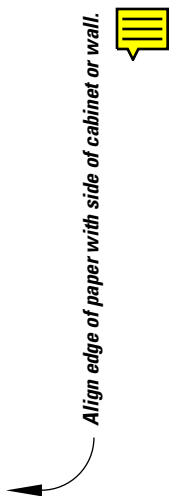

Mark the **CENTER** of the hole



Front edge of cabinet (w

Align edge of paper with front edge of cabinet (without

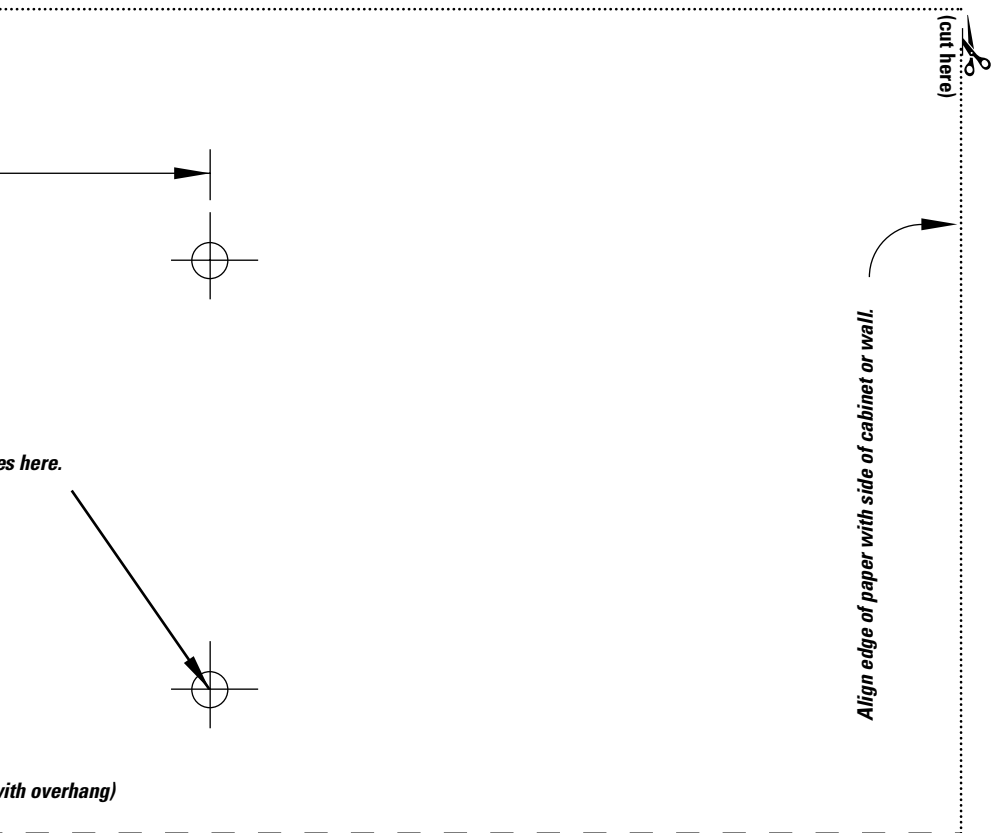

(with overhang).

How to Mount Can Opener

The following parts are included for installing the can opener:

- 4 Phillips recessed flat-head screws
- 4 plastic washers
- 1 Cord clip
- 1 Template to position drilled holes (provided)

Tools required:

- Drill with a 3/16" bit
- Phillips screwdriver

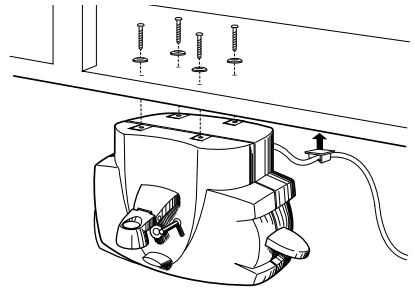

1. Place the hole template (provided), on the bottom shelf of cabinet as directed. Make sure it is face-up and lined up with the front of the cabinet, as indicated on the template. Mark the center of the holes with sharp point by pushing through the crosshairs. Remove the template and drill four 3/16" holes at marked points. **CAUTION: Always use safety glasses when drilling to avoid injuries to eyes. Keep the template for future use.**

2. Using the Phillips screwdriver, insert

each screw and washer through the topside of the cabinet into the can opener holes (See above drawing). Make sure the cord is aligned through the slot on the back of the unit.

3. A cord clip is provided to keep cord out of sight, away from the work area. Plug in and clip as desired. To secure, peel off paper backing of cord clip and press in place. Surface must be clean, dry and free of dust and grease.

NOTE: Always leave can opener unplugged when not in use.

How To Open Cans

1. Plug cord into 120 volt, AC outlet.
2. Raise piercing lever, tilt can so that the rim of the can rests on the edge of the feed wheel, lower the lever until the blade pierces the can.
3. Press lever down all the way to pierce lid and start cutting action. "Power Pierce" feature: When you press lever, motor will start rotating can for easier piercing.
4. Let go of lever and can opener will continue cutting and will stop automatically when can has been opened. (It is normal for motor to occasionally continue cutting action for a few seconds after lid has been

completely severed.)

5. To remove can, grasp can firmly and raise lever.

Carefully slide lid from magnet and dispose of properly.

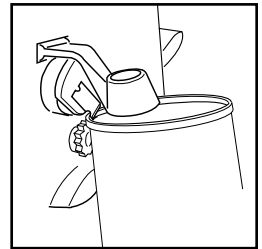

PLEASE NOTE:

Unit will not open rimless cans. If there is a dent in the rim of the can, open other end. Never open or eat the contents of a dented, bulging or punctured can.

How to Sharpen Knives

Do not attempt to sharpen hollow ground blades or those with serrated edges

1. Be sure knife is clean and free of grease.
2. Place heel of knife into the guide slot located on the left side of the can opener. Lightly draw the blade towards you, applying a slight downward pressure. Repeat this procedure four to five times to put on a “factory sharp” edge.

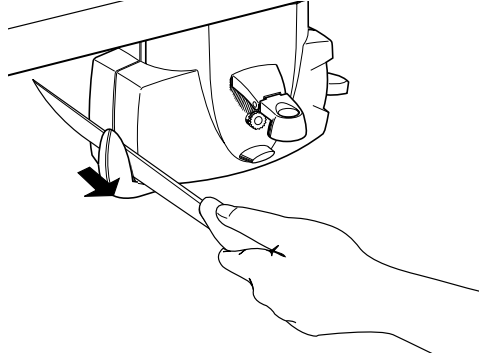

How to Open Bottles

1. Insert bottle into bottle opener making sure the prying edge is placed between the edge of the bottle and the top of the bottle.
2. Grasp bottle tightly with one hand.
3. Slowly and carefully move the bottle from right to left, making sure the prying edge begins to separate the bottle cap from the bottle.
4. If done correctly, the bottle cap should now easily remove from the bottle.

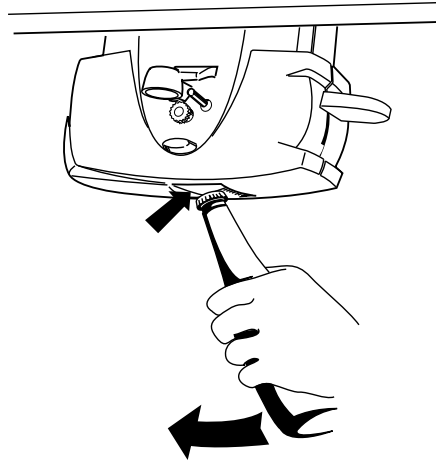

How to Clean Blade Assembly

1. Unplug cord.
2. Wipe can opener with a damp cloth.
Clean around blade area with toothpick or cotton swab if necessary.

HINT: Cutting mechanism may collect food or paper from can labels, and should be cleaned frequently to maintain optimum performance.

Two Year Limited Warranty

What does your warranty cover?

- Any defect in material or workmanship.

For how long after the original purchase?

- Two years.

What will we do?

- Provide you with a new, or at our option, a reconditioned unit.
- The exchange unit is warranted for the remainder of your product's original two-year warranty period.

How do you make a warranty claim?

- Return product to nearest WAL★MART store or ship unit via UPS Ground Service CUSTOMER SERVICE DEPARTMENT 233 Fortune Blvd, Milford MA 01757
- All parts of this product are guaranteed for a period of two years as follows:
 - Within the first 24 months from date of purchase, subject to the conditions below, manufacturer will repair or replace the product if it is defective in workmanship providing it is returned to manufacturer, freight prepaid, with PROOF OF PURCHASE and date, together with \$5.00 for return shipping and handling charges.
- Carefully pack the item in its original carton or other suitable box to avoid damage in shipping. We recommend using the original carton and packing materials.
- Before packing your unit for return, be sure to enclose: your name, full address with zip code and telephone number, a dated sales receipt or PROOF OF PURCHASE (if the unit was a gift, provide a statement and the date received), your \$5.00 check for return shipping and handling, and the model number of the unit and the problem you are having. (Enclose in an envelope and tape directly to the unit before the box is sealed).
- Manufacturer recommends you ship the package U.P.S. ground service for tracking purposes.
- All shipping charges must be prepaid

by you.

- Ship to:
CUSTOMER SERVICE DEPARTMENT
233 Fortune Blvd,
Milford MA 01757
- Shipping and handling charges: \$5.00

What does your warranty not cover?

- Customer instruction. This instruction manual provides information regarding operating instructions and user controls. For additional information, ask your dealer.
- Commercial use.
- Damage from misuse, abuse, or neglect.
- Products which have been modified or incorporated into other products.
- Products purchased or serviced outside the USA.

How does state law relate to this warranty?

- This warranty gives you specific legal rights, and you may also have other rights which vary from state to state.

What if you purchased this product in the USA and encounter a problem while using it outside the USA?

- Follow the shipping directions provided for warranty claims.

For products purchased outside the United States and Canada, see dealer for warranty. WAL★MART Stores, Inc. Bentonville, AK 72716



is a trademark of General Electric Company and is used under the license by WAL★MART Stores, Inc. Bentonville, AR 72716