

Parts Manual for

# SNAPPER®

## SHREDDER GRINDER CHIPPER SERIES 0



<b>MODEL</b>
<b>SG5000</b>

PARTS FOR THIS MACHINE MUST BE ORDERED FROM:  
1189 Old Schuylkill Road \* P.O. Box 111 \* Parker Ford, PA 19457-0111  
Phone: (610) 495-7181 or (800) 348-1117, Fax: (610) 495-5951

**SNAPPER** McDonough, GA., 30253 U.S.A.

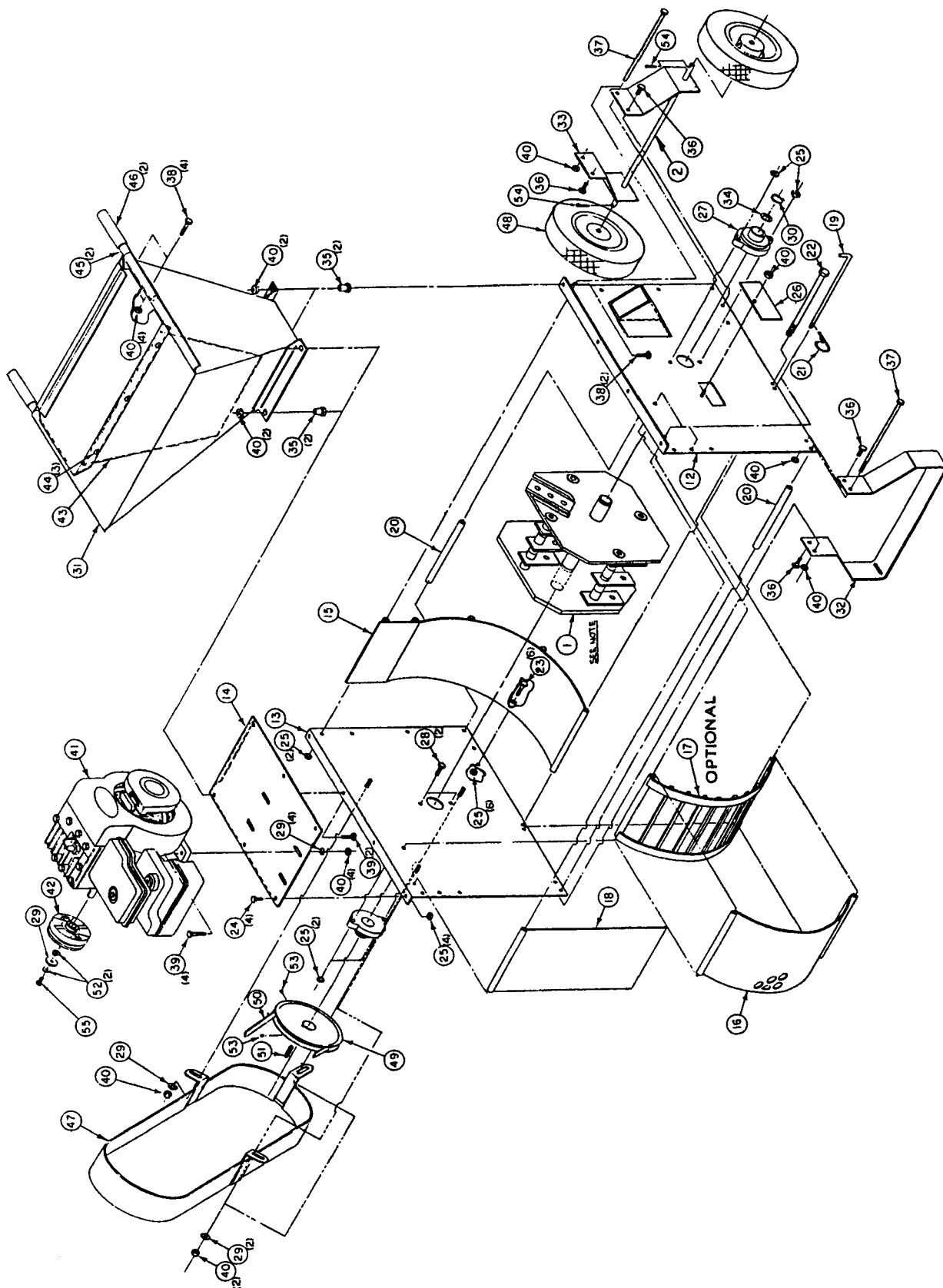

## PARTS LIST FOR SG 5000

Item No.	Part No.	Description	Quantity
1	40811	Rotor Weldment	1
2	40911	Axle	1
4	40810	Hammer Rod	4
5	40802	Hammer	16
6	40805	Spacer - 5/16" LG	4
7	40804	Spacer - 5/8" LG	22
8	40803	Spacer - 7/8" LG	4
9	40807	Chipper Knife	1
10	40848	5/16-18 x 1" Flat Hd. Socket Cap Screw	3
11	40806	Groove Pin	4
12	40812	Chipper Side Plate	1
13	40813	Drive Side Plate	1
14	40814	Top Plate	1
15	40815	Scroll	1
16	40816	Screen 1"	1
17	40817	Bar Screen (Optional)	1
18	40818	Baffle Plate	1
19	40819	Screen & Baffle Rod	4
20	40820	Pipe Spacer	2
21	11773	Hair Cotter - 3/32"	4
22	40854	5/16-18 x 8 Hex Hd. Cap Screw Blk.	1
23	90627	5/16-18 x 1-1/4 Hex Hd. Cap Screw	8
24	76934	5/16-18 x 3/4 Hex Hd. Cap Screw	4
25	90194	5/16-18 Grip-Co Lock Nut	20
26	40809	Cover Plate	1
27	40821	Bearing	2
28	90636	5/16-18 x 1 Hex Hd. Cap Screw	4
29	90692	5/16 Flatwasher	8
30	40851	1" Retaining Ring	1
31	40822	Hopper	1
32	40823	Front Foot	1
33	40909	Axle Bracket	2
34*	40825	1 1/2" O.D. x 1 1/64" I.D. x .050 Thk. Shim	1
35	40799	Vibration Dampener	4
36	76934	5/16-18 x 3/4 Hex Hd. Cap Screw Pltd.	4
37	40854	5/16-18 x 8 Hex Hd. Cap Screw Pltd.	2
38	90627	5/16-18 x 1-1/4 Hex Hd. Cap Screw Pltd.	6
39	76935	5/16-18 x 1-1/2 Hex Hd. Cap Screw Pltd.	6
40	90194	5/16-18 Grip-Co Lock Nut Pltd.	22
41	40826	5 HP Engine	1
42	40887	Clutch (see page 12 for assembly)	1
43	40828	Hopper Flex Guard	1
44	40801	Push Type Tie Button	3
45	40829	Handle	2
46	40800	Handle Grip	2
47	40798	Belt Guard	1
48	40830	8 x 1.75 Wheel	2
49	40831	Sheave A550 x 1" (includes item #53)	1
50	40832	V-Belt 4L-410	1
51	13250	1/4" Sq. x 1" LG Shaft Key	1
52	90187	5/16 Split Lockwasher	2
53	90201	5/16-18 x 5/16 Set Screw	2
54	90042	1/8 x 1-1/4 LG Cotter Pin	2
55	90233	5/16-24 x 3/4" Hex Hd. Cap Screw	1

\* A variety of shims with different thicknesses are available.

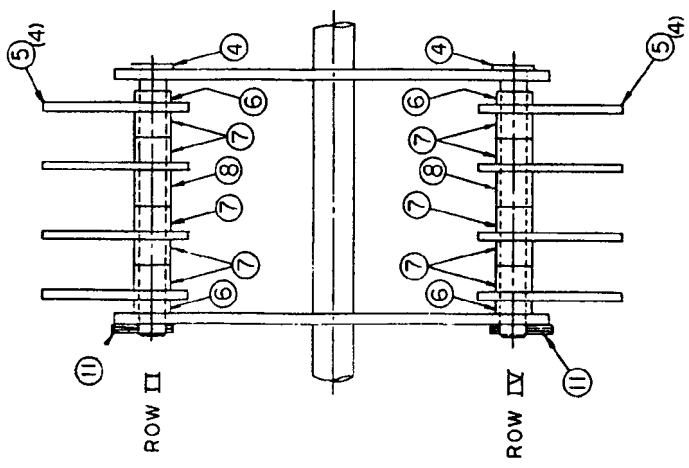
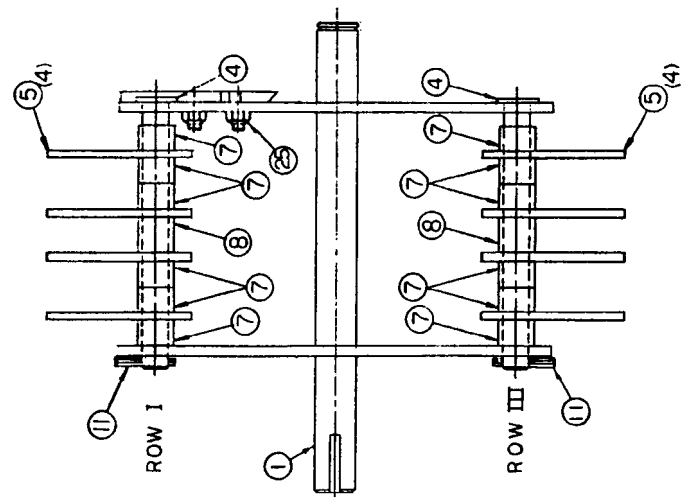
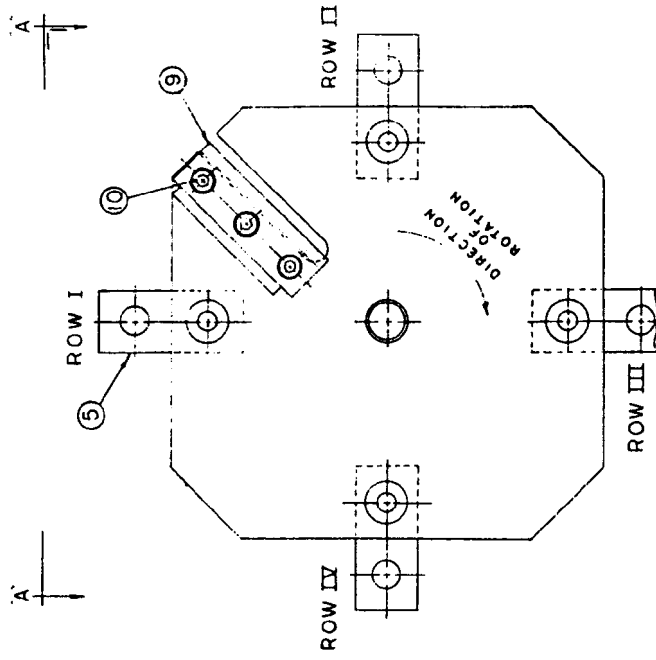

A:	25	3	1/8"-18 UNC GRIPCO LOCK NUT	90194
	11	4	GROOVE PIN	40008
A:	10	3	1/8" LG FLAT HD HEX SOCKET CAP SCREW	40046
	9	1	CHIPPER KNIFE	40007
	8	4	SPACER LG	40008
	7	22	SPACER LG	40004
	6	4	SPACER LG	40005
	5	16	HAMMER	40002
	4	4	HAMMER ROD	40010
	1	1	ROTOR WELDMENT	60611

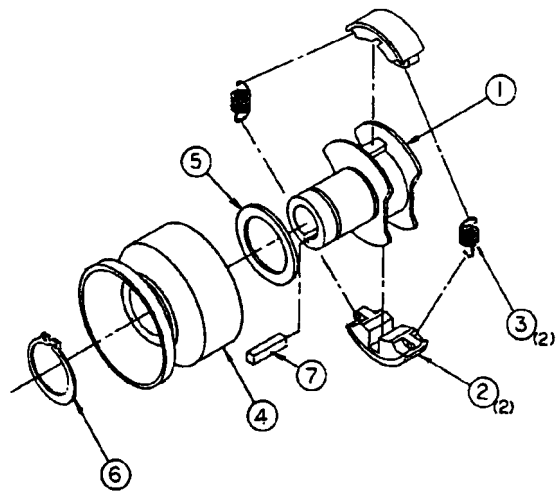

**CLUTCH PARTS LIST, 3/4" BORE - 3 HP & 5 HP ENGINES**  
**Complete Part 40887**

<b>Key No.</b>	<b>Part No.</b>	<b>Description</b>	<b>Quantity</b>
1	40878	Hub Assembly	1
2	40879	Shoe	2
3	40880	Spring	2
4	40881	Drum Assembly	1
5	40792	Washer	1
6	40791	Retaining Ring	1
7	10061	Shaft Key	1

*Parts Manual for*

**SNAPPER<sup>®</sup>**

**SG5000 SHREDDER GRINDER  
CHIPPER  
SERIES 0**

COPYRIGHT © 1999  
SNAPPER INC.  
ALL RIGHTS RESERVED

**SNAPPER<sup>®</sup>** McDonough, GA., 30253 U.S.A.