

**EQUATOR**

**SERVICE MANUAL  
AND  
SPARE PARTS CATALOG**

*First Edition - October 2003*

**BUFFET CART**

MODELS: CM 3000



**Advanced Appliances**

**NEW  
for 2001**

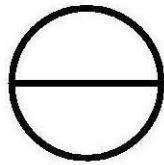

# EQUATOR®

## Heated Buffet Carts



**CM 3000**

Great For  
**BARBEQUES!**

Made in England



**CB 3000**



**CT 3000**



**CS 3000**

Equator Buffet Carts are electrically heated carts that keep food hot for hours, while also offering valuable storage space when not in use. The Buffet Carts self-regulate temperatures to ensure that food stays well within the FDA's Food Safety standards.

<b>Buffet Cart Specifications</b>				
Model	CM 3000	CB 3000	CT 3000	CS 3000
Color of unit	Mahogany	Black Ash	Teak	Brushed Stainless
Size of Unit (HxWxD)	27½" x 29" x 16"	27½" x 29" x 16"	27½" x 29" x 16"	27½" x 29" x 16"
Shipping Size (HxWxD)	30½" x 31" x 17½"	30½" x 31" x 17½"	30½" x 31" x 17½"	30½" x 31" x 17½"
Net Weight (Lb/Kg)	80 (36.3)	80 (36.3)	80 (36.3)	80 (36.3)
Gross Weight (Lb/Kg)	84 (38.18)	84 (38.18)	84 (38.18)	84 (38.18)
Electrical	110 V/60Hz	110 V/60Hz	110 V/60Hz	110 V/60Hz
Heated Shelves	Yes	Yes	Yes	Yes
Power Cord Length	6'4"	6'4"	6'4"	6'4"
Heating Element Temp	145°-170°	145°-170°	145°-170°	145°-170°
Removable Dish Holder	Yes	Yes	Yes	Yes
Pyrex Glass Dishes	3	3	3	3
Sliding Tops	Yes	Yes	Yes	Yes
Full Length Doors	Yes	Yes	Yes	Yes
Casters	Yes	Yes	Yes	Yes
On/Off Light	Yes	Yes	Yes	Yes
Spare Parts	Available	Available	Available	Available
Warranty	1 yr. parts/labor	1 yr. parts/labor	1 yr. parts/labor	1 yr. parts/labor
Extended Warranty	1&2 yr. parts/labor	1&2 yr. parts/labor	1&2 yr. parts/labor	1&2 yr. Parts/labor

These units may comply with the generic kosher rule that "both solid dry foods and liquid foods may be placed in warmer before Sabbath."



**Equator Corporation** • Equator Plaza • 10067 Timber Oak Drive • Houston, Texas 77080-7045 • USA

Toll Free: 800-935-1955 • 713-464-3422 • Fax: 713-464-2151 • [www.equatorappliances.com](http://www.equatorappliances.com) • E-mail: [mail@equatorappliances.com](mailto:mail@equatorappliances.com)

Equator Corporation reserves the right to change model specifications and features at any time. All facts were accurate at the time of printing. Equator and the Equator logo are registered trademarks of Equator Corporation. © Equator Corporation, Printed in the United States of America. 2000 First Edition. All rights reserved.

EQ-BC-2000-01

# TABLE OF CONTENTS

<b>WARRANTY</b>	<b>1</b>
<b>SERVICE HINTS</b>	<b>2</b>
<b>TECHNICAL DATA</b>	<b>4</b>
<b>WIRING DIAGRAM</b>	<b>4</b>
<b>EXPLODED VIEW</b>	<b>5</b>
<b>PARTS LIST</b>	<b>6</b>

# WARRANTY INFORMATION

**Your Equator appliance is protected by this warranty under normal, personal, family or household use (1 Year), and limited commercial use (90 days) in the USA and Canada.**

## WARRANTY

Equator Corporation undertakes to the consumer-owner to repair or, at Equator Corporation's option, to replace any part of this product which proves to be defective in workmanship or material under normal personal, family or household use, in the USA and Canada, for a period of one year from the date of original purchase.

For commercial use, the product is warranted for a period of 90 days.

During this period, Equator Corporation will provide all labor and parts necessary to correct such defect, free of charge, if the appliance has been installed and operated in accordance with Equator Corporation's written instructions with the appliance. Ready access to the appliance, for service, is the responsibility of the consumer-owner.

## EXCLUSIONS

In no event shall Equator Corporation be liable for incidental or consequential damages or for damages resulting from external causes such as abuse, misuse, incorrect voltage or acts God.

This warranty does not cover service calls which do not involve defective workmanship or materials covered by this warranty. Accordingly, diagnosis and repair costs for a service call which does not involve defective workmanship or materials will be the responsibility of the consumer-owner.

Specifically, the following work is not covered under warranty and does not constitute warranty work:

- . Installation -e.g. improper hook-up or leveling
- . Maintenance - e.g. cleaning of air and/or water filter
- . Damage - e.g. Replacing broken door handle

Most work is covered. The defining factor is, has the machine malfunctioned (Equator is responsible) or has the customer omitted or done something to cause machine to malfunction (customer is responsible).

Some States do not allow the exclusion or limitation of incidental or consequential damages, so the above limitation or exclusion may not apply to you.

## WARRANTY SERVICE

This warranty is given by:

Equator Corporation,  
Equator Plaza,  
2801 W. Sam Houston Pkwy. N.,  
Houston, TX 77043-1611.

Service under this warranty must be obtained by the following steps, in order:

Call an Equator Corporation Authorized Service Agent (obtain number of nearest agent from your dealer or by calling Equator Service at 1-800-776-3538). Under normal circumstances, Service will be provided during regular business hours (9:00 a.m. to 5:00 p.m. weekdays).

## GENERAL

Since it is responsibility of the consumer-owner to establish the warranty period by verifying the original purchase date, Equator Corporation recommends that a receipt, delivery slip or some other appropriate payment record be kept for that purpose.

Remember to send in your Warranty Registration Card so that a proof of your purchase exists with Equator.

This warranty gives you specific legal rights, and you may also have other rights which vary from State to State.

### *Corporate Office*

**EQUATOR CORPORATION**  
Equator Plaza  
2801 W. Sam Houston Pkwy. N.  
Houston, TX 77043-1611  
Tel: 713-464-3422 - Fax: 713-464-2151  
Tel: 800-776-3538

# DISASSEMBLY AND ASSEMBLY

ENSURE APPLIANCE IS DISCONNECTED FROM THE ELECTRICITY SUPPLY BEFORE DISASSEMBLING.  
NOTE ALL CONNECTION DETAILS AND ROUTING OF LEADS BEFORE DISASSEMBLING.

Numbers appearing in the text refer to illustrations and parts list numbers.

## A. SLIDING TABLETOPS

Slide both tabletops open. Remove cover caps 130 and the two screws securing handle 105. Withdraw the handle from the tabletop assembly.

Slide the tabletop required inwards, past its closed position, until the two plastic sliding blocks 106 on the cabinet channels are exposed. Withdraw the sliding blocks from the cabinet channels, and then slide the tabletop assembly out clear of the channels.

## B. DOORS

1. Remove both sliding tabletops completely (see A.1.) and magnetic door catches 111 (push-fit).
2. Drill out the rivet at each end of the front slide channel using a 3mm bit. Use extreme care when drifting. Withdraw leg top caps 108, then remove front top panel 109 to release top door pivots 128. Lift doors 123 and 125 clear of the cabinet.

## C. TOP ELEMENT ASSEMBLY

1. From inside of cabinet, squeeze locking barbs and release mains lead bush 121 retainer from rear panel. Remove rear cover strip 510, secured by a single screw, to the extent of the mains lead wires. Disconnect the top element leads from terminal block 120.

NOTE: Terminal block 120 includes push-in locking terminals for internal wiring. Leads inserted in the front-most terminals may *only* be released by inserting a small screwdriver or similar in the slots provided in the front of the terminal block. Rear-most leads may release with a sharp pull. If leads cannot be released, or are not gripped on insertion, item 120 **must be replaced**.

2. Open the sliding tabletops and remove glass dishes and lids 101 and holders 103.
3. Remove the sliding tabletops as in A. 1. Then slide each tabletop in turn inwards past its closed position to gain access to the four screws securing top element assembly 107.
4. Use a powerful magnet or suitable tool to lift the element assembly out clear of the cabinet, feeding the element wires through grommet 110 in the cabinet.
5. Refit in reverse order, taking care that the rear cover strip fixing screw is clear of cables when fixing.

## D. MIDDLE AND BOTTOM ELEMENT ASSEMBLY / NEON

1. Remove rear cover strip 510 as shown in C.1. And disconnect the middle shelf element leads 113 from terminal block 120 (See note in C. 1.)
2. Remove the two screws securing the element assembly through the rear panel of the cabinet, and two screws from under the front edge of the shelf (bottom element front screws are under the front of the cabinet, behind the bottom rail) — see fig.1.
3. Lift the element assembly out clear of the cabinet, feeding the element wires through grommet 110 in the cabinet.
4. Neon 11 8 is a push fit assembly which is located by two barbs that spring open behind element panel trim 5.1.5. It can only be removed from the front. Pushing from behind the neon assembly (inside the front shelf rail) using a suitable tool can assist removal.  
To re-fit, thread the neon leads through the hole in the element panel trim 51 5, push-fit neon into hole and route with element leads to terminal block.
5. Re-fit in reverse order, taking care that the rear cover strip fixing screw is clear of cables when fixing.

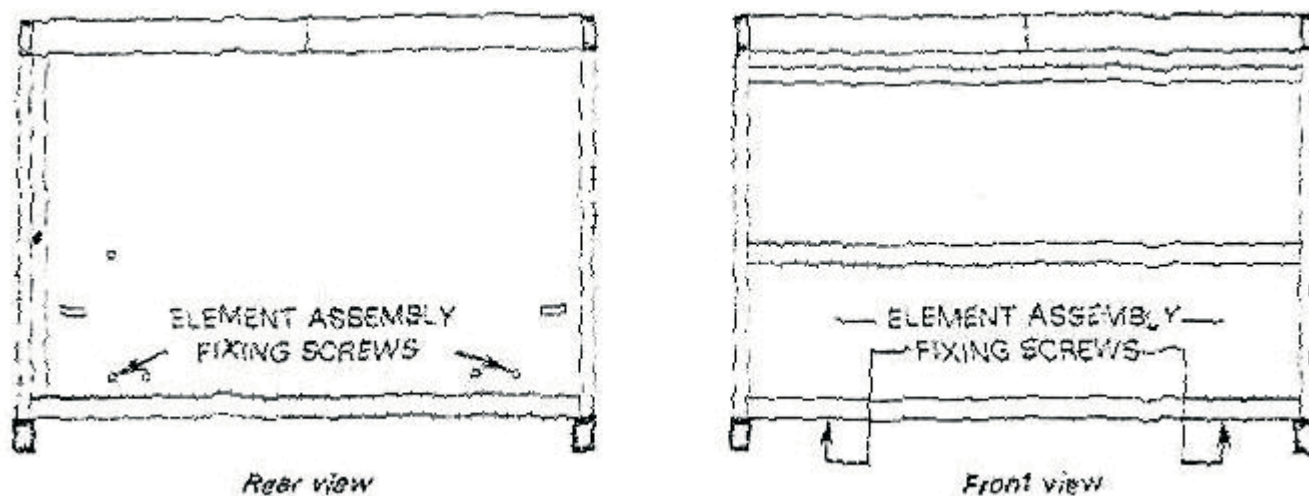

Fig. - HL6232E/F Element Assembly Fixing Points

## E. MAINS LEAD

1. Remove rear cover strip 510 as in C.1.
2. Disconnect LIVE and NEUTRAL mains lead wires from terminal block 1 20: release the earth lead from the cabinet earth stud.
3. To remove mains lead bush 121, rotate the retainer arm through 90°, then use pliers to squeeze the mains lead locking tab and push the bush, complete with mains lead, out of the cover strip.
4. Refit in reverse order, ensuring correct wire colour connections and that a sound earth connection is made.

## F. CABINET ITEMS

1. Magnetic catches 111 are a push-fit in front top panel 109.
2. To remove front top panel 109, remove both sliding tabletops completely (see A.1.) and magnetic catches 111. Drill out the rivet at each end of the front slide panel using a 3mm bit. Use extreme care when drilling. Withdraw leg top caps 108, and then remove the front top panel assembly. Refit in reverse order.
3. Castor wheels 116 are a push-fit onto castor wheel inserts 117. The castor wheel inserts are a push-fit into the cabinet. Remove by prising out with care.

### THEORETICAL WIRING DIAGRAM

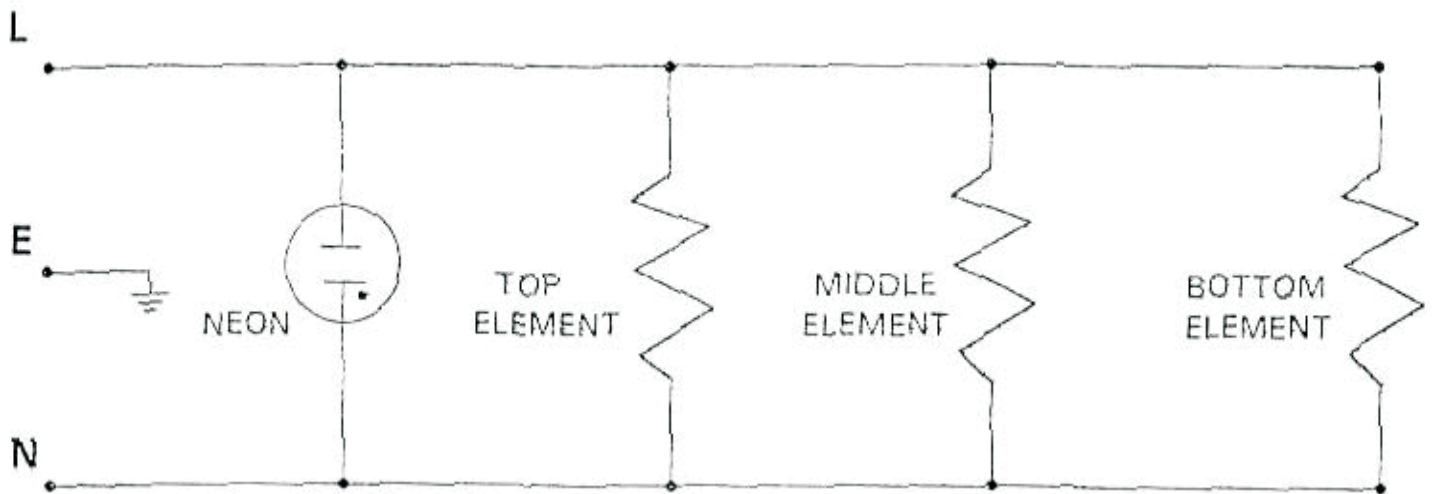

### SPECIFICATION

Voltage	120 V ac. 60Hz
Loading	410 W (Top 110 W, Middle 110 W, Bottom 190 W)
Cord length	2 m
Pre-heat time	30 minutes approx
Finish	See text
Dimensions (approx)	725mm W x 380mm D x 695mm H

### SERVICE INFORMATION

The elements used in this appliance are of the adhesive variety and cannot be removed easily. For this reason, elements and plates are supplied as complete assemblies.

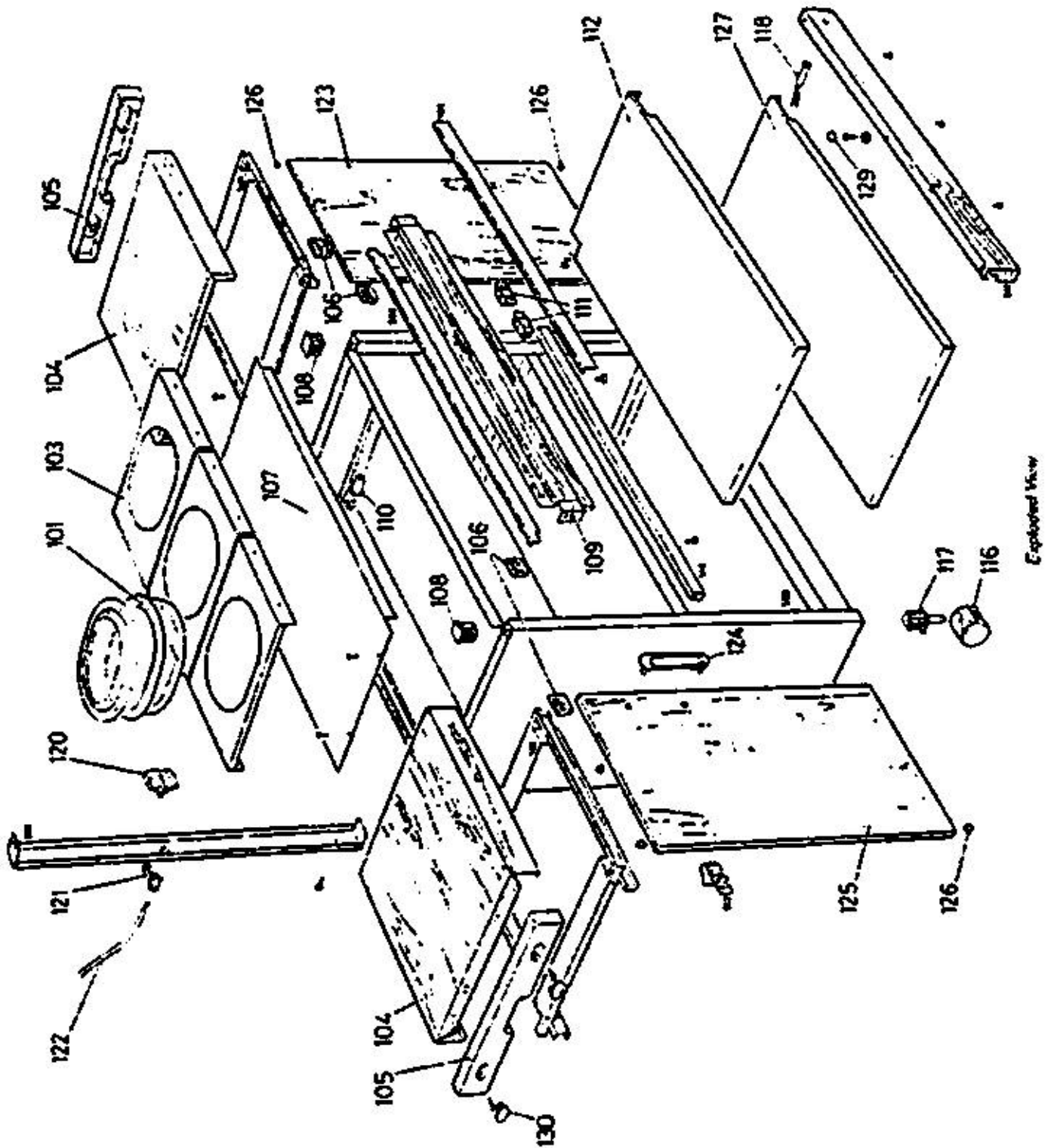

Exploded View



## SPARE PARTS LIST

ITEM	DESCRIPTION	CODE
101	GLASS DISH & LID	0101 092 21701
103	GLASS DISH HOLDER	0101 081 00161
104	TABLE TOP COVER	SEE ITEM 150
105	TABLE TOP HANDLE	0101 077 61391
106	TABLE TOP SLIDING BLOCK	0101 077 61341
107	TOP ELEMENT ASSEMBLY	0101 089 24271
108	LEG TOP CAP	0101 077 61311
109	FRONT TOP PANEL	SEE ITEM 150
110	GROMMET SLEEVE	0101 078 53301
111	MAGNETIC CATCH (FS10)	0101 078 53351
112	MID ELEMENT ASSEMBLY	0101 089 24261
116	BRUANDET CASTER (4 PACK)	0101 078 53291
117	CASTOR INSERT	0101 077 61301
118	NEON ASSEMBLY	0101 078 53872
120	TERMINAL BLOCK	0101 078 53261
121	STRAIN RELEASE BUSH	0101 077 61511
122	MAINS CABLE	0101 076 53022
123	DOOR ASSEMBLY RIGHT	SEE ITEM 150
124	DOOR HANDLE PAIR	0101 092 30061
125	DOOR ASSEMBLY LEFT	SEE ITEM 150
126	DOOR HINGE PIN	0101 075 71811
127	BOTTOM ELEMENT ASSEMBLY	0101 089 24251
129	SCREW COVER CAP	0101 077 61381
130	SCREW COVER CAP	0101 077 61461
150	FULL WOOD SET	0101 092 30031
508	CABINET FRAME	0101 081 00311
512	PLINTH	SEE ITEM 150

OUTER GLIDE COVER (PRINTED)	0101 077 71441
-----------------------------	----------------

PLEASE NOTE
FULL WOOD SETS INCLUDE DOORS, FRONT PANEL, PLINTH, AND TABLE TOPS