

# **CURTIS** SNOW PLOWS

## **HOME-PRO 3000**



**1FK33 2005 - Toyota Tacoma, Reg.Cab, 4 cyl.,  
Manual Transmission  
(with Max. GVWR & Max. FGAWR ONLY)**

### **Vehicle Mounting Kit Installation Instructions & Owner's Manual**

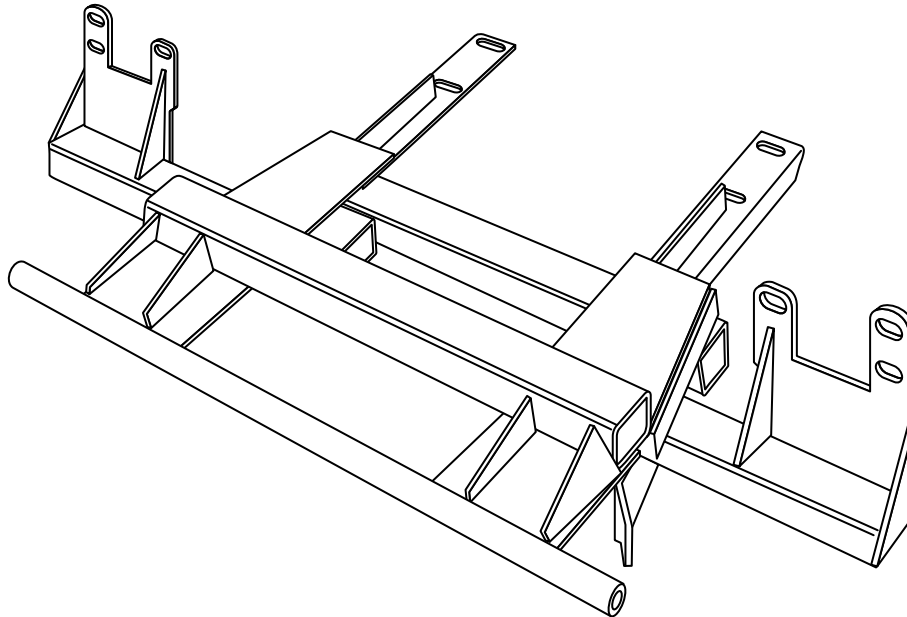

Curtis Tractor Cab, Inc. and/or Curtis International, Inc. reserves the right to change product design or specification without notice or liability. Curtis Snow plows and truck equipment should only be used on vehicles equipped with the manufacturer's snow plow preparation package. Snow plowing without the original snow plow preparation package may damage your vehicle and the added weight of the equipment may impair the operation and control of the vehicle.



# HOME-PRO 3000



1FK33 2005 - Toyota Tacoma, Reg.Cab, 4 cyl.,  
Manual Transmission  
(with Max. GVWR & Max. FGAWR ONLY)

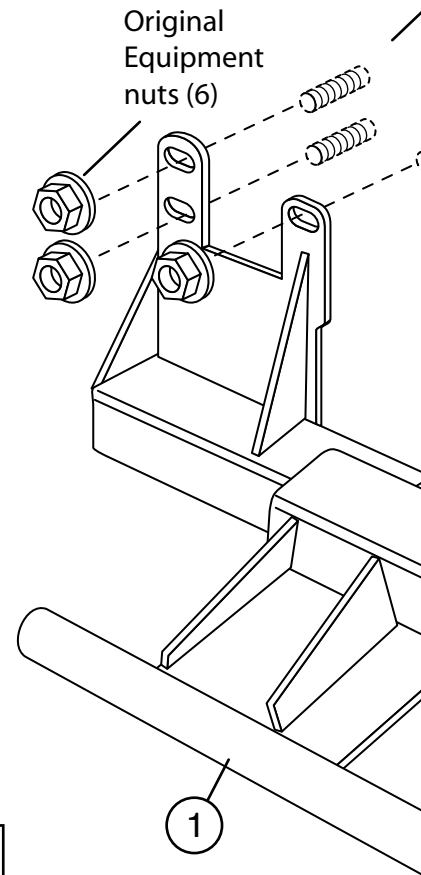

## Parts List

Schematic Ref. #	Part #	Description	Qty.
1.	1FK33P1	Mounting Frame	1
2.	DPHBrkt24	Dual Plug Harness Bracket	1
	**	#10 – 32 x 3/4" Hex Head Screw (Plated)	2
	**	#10 – 32 Nyloc Lock Nut (Plated)	2
	**	#8 – 32 x 1" Hex Head Screw (Plated)	1
	**	#8 – 32 Nyloc Lock Nut (Plated)	1
	**	#8 Nylon Flat Washer (3/4" O.D.)	1
	**	#8 Flat Washer (SAE) (Plated)	1

\*\* Indicates Hardware Components Included in  
Plow Light Harness Kit P/N 1TBP51E1

Original bumper  
attaching bolts (6)

Original  
Equipment  
bolts (4)

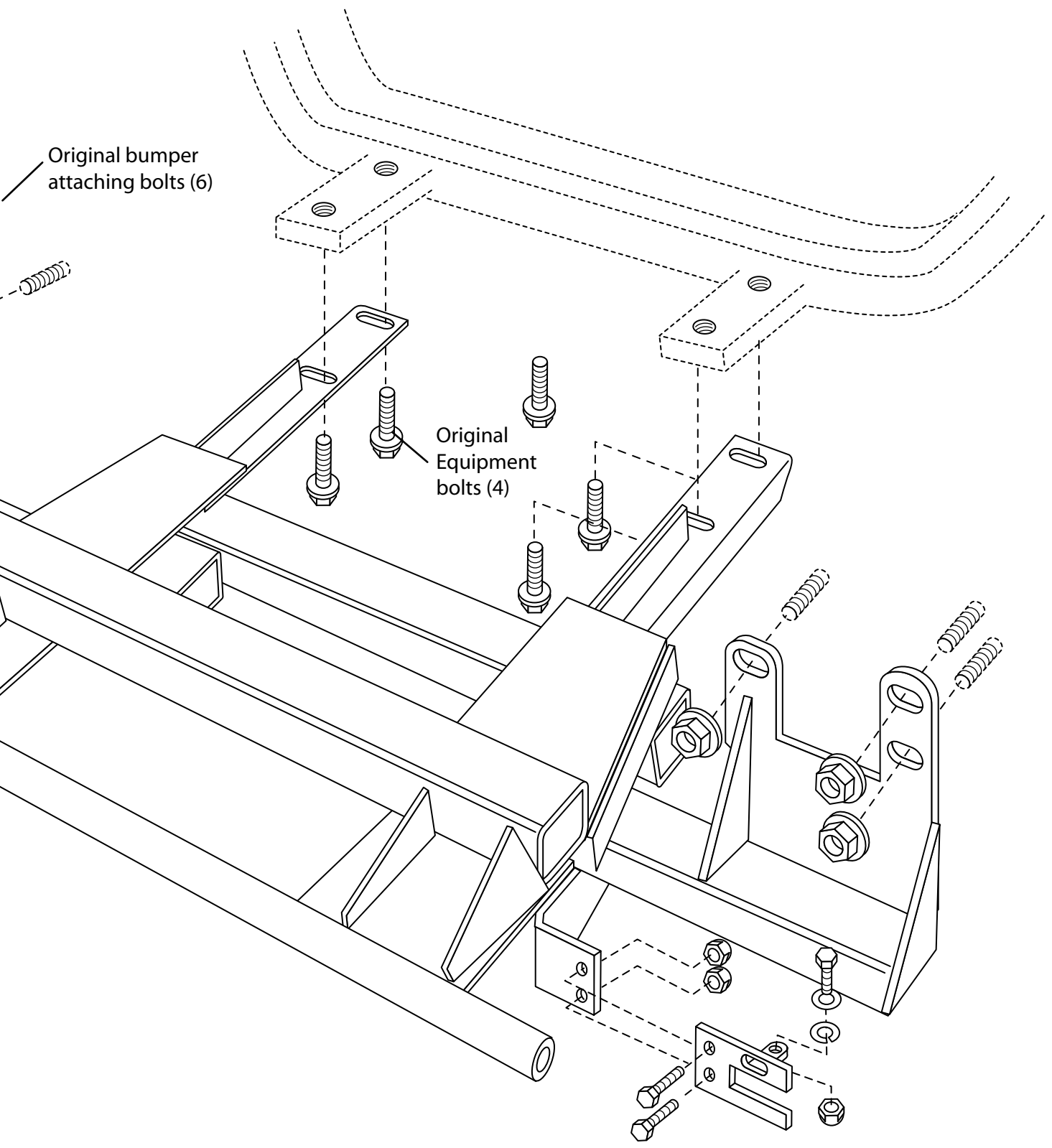

# Vehicle Mounting Kit **HOME-PRO 3000**

## Installation Instructions

**1FK33 2005 - Toyota Tacoma, Reg.Cab, 4 cyl.,  
Manual Transmission  
(with Max. GVWR & Max. FGAWR ONLY)**

### **IMPORANT NOTE:**

It is highly recommended that front “helper springs”, “air shocks”, or other similar devices be installed onto this vehicle to prevent the front suspension from “bottoming out” while carrying a snow plow. The vehicle must also be properly “ballasted” by placing ballast weight behind the centerline of the rear axle so that no more than 62% of the total weight of the vehicle, snow plow, driver, ballast weight, (and any cargo) is placed on the front axle while at the same time not exceeding the Gross Vehicle Weight Rating and Front or Rear Gross Axle Weight Ratings.

- 1. PRELIMINARY:** Remove and store the original equipment front skid / splash pan and the two longitudinal channel struts bolted between the blocker beam (just behind the front bumper) and the front suspension cross member. Remove the three nuts from the bumper attaching bolts at the front of each frame rail. Save all the original equipment fasteners, some will be used to attach the plow mounting, save the remainder for possible reinstallation if the plow mounting is removed. The skid / splash pan and longitudinal st  
Leave all fasteners loose or “finger tight” until all components have been installed onto the vehicle or until installation instructions specify to do so.
- 2. MOUNTING FRAME:** Lift the mounting frame (1) up under the front of the vehicle with the slotted holes in the front brackets over the six bumper attaching bolts at the front of the frame rails. Fasten using the six original equipment nuts removed previously. Fasten the rear push angles of the mounting frame (1) to the threaded holes (that the rear of the longitudinal struts were attached to) in the front suspension cross member using four of the original equipment fasteners. Tighten all fasteners fully.
- 3. FINAL ASSEMBLY AND INSPECTION:** Inspect the mounting attachment bolts to be certain that they are all in place and that they are all tight.

**OPTIONAL: PLUG MOUNT BRACKET INSTALLATION:** Install the Plug Mount Bracket if the harness will be mounted on the frame kit, otherwise, the harness may be routed through the grill, bumper, etc... Using (2) 10-32 x 3/4” hex bolts and nylon locknuts, fasten the Plug Mount Bracket to the Plug Mount Bracket Mounting Tab located on the drivers side of the frame kit receiver. The included 8-32 hardware is used for mounting the hi-amp battery leads to the Plug Mount Bracket, if used.