

Varioguard

 **hauck**
FUN FOR KIDS

ECE R44/04 Gr. 0+ / I - 18 kg

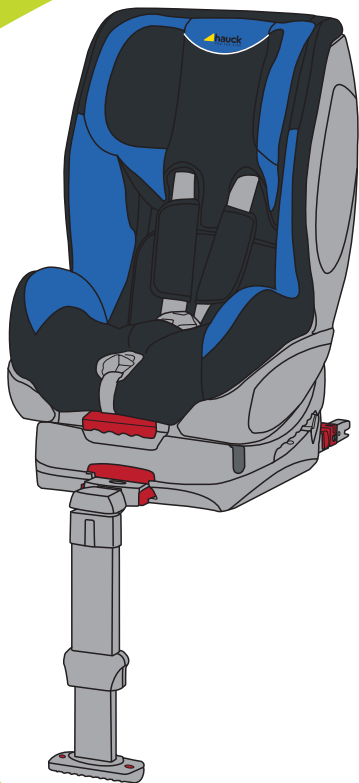

Liste des types



B1, C

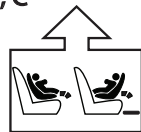

INFORMATION DE MONTAGE POUR VÉHICULES AUTOMOBILES LORS DE L'APPLICATION DE LA FIXATION ISOFIX OU DE LA CEINTURE 3 POINTS

Ce système de retenue pour enfant avec partie inférieure est classé dans la catégorie «semi-universelle». Il est adapté pour être fixé dans la plupart des véhicules avec ISOFIX ou avec une ceinture 3 points. Les numéros dans le schéma suivant représentent les positions de montage ISOFIX dans le véhicule sur les pages suivantes. Lorsque le système de retenue pour enfant peut être installé sur le siège correspondant, vous voyez un ● à cet endroit. Dans le cas contraire, un ○ vous indique que le siège ne peut PAS être installé sur le siège du véhicule. La colonne de gauche se base sur un montage dans le véhicule avec les fixations ISOFIX, la colonne de droite indique les positions de montage en cas d'utilisation de la ceinture 3 points. Cette liste n'est pas exhaustive. Si votre véhicule n'est pas dans la liste ou si vous avez des doutes sur la possibilité d'application du système de retenue dans votre véhicule, adressez-vous au fabricant du siège pour enfant ou au commerçant spécialisé à qui vous avez acheté ce produit. Favorisez toujours le montage du siège pour enfant sur la BANQUETTE ARRIÈRE de votre véhicule. N'installez JAMAIS le système de retenue sur un siège de véhicule équipé d'un AIRBAG actif. Cela représente un danger de mort ou de blessure grave.

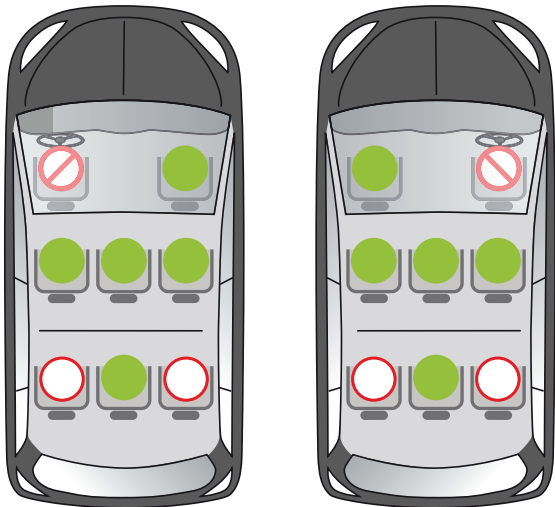

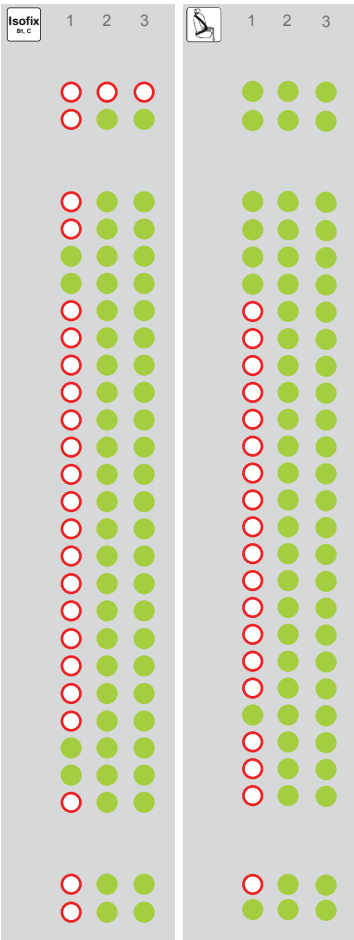

	isofix B.C.					
	1	2	3	1	2	3
Continental GTC (2005 - 2012)	○	●	●	○	●	●
Mulsanne (2010 >)	○	●	●	●	●	●
BMW						
1 Series Convertible (2008 >)	○	●	●	○	●	●
1 Series Coupe (2008 >)	○	●	●	○	●	●
1 Series F20 (2011 >)	○	●	●	○	●	●
3 Series Coupe (2007 >)	○	●	●	○	●	●
3 Series F30 (2012 >)	○	●	●	○	●	●
5 Series M5 (2005 - 2011)	○	●	●	○	●	●
5 Series Saloon (2003 - 2010)	○	●	●	○	●	●
5 Series Touring (2011 >)	○	●	●	●	●	●
5 Series Touring (2003 - 2010)	○	●	●	○	●	●
5 Series (2011 >)	○	●	●	●	●	●
6 Series Coupe (2011 >)	○	●	●	○	○	○
6 Series Convertible (2011 >)	○	●	●	○	○	○
6 Series Gran Coupe (2011 >)	○	●	●	○	●	●
7 Series (2010 >)	○	●	●	○	●	●
X3 F25 (2011 >)	○	●	●	●	●	●
X5 (2007 >)	○	●	●	●	●	●
X6 (2008 >)	○	●	●	●	●	●
X6 M (2008 >)	○	●	●	●	●	●
5-GT (2010 >)	○	●	●	●	●	●
Cadillac						
BLS Saloon (2006 - 2011)	○	●	●	○	●	●
Chevrolet						
Aveo 5dr (2012 >)	○	●	●	●	●	●
Aveo 3dr (2012 >)	○	●	●	●	●	●
Captiva (2007 >)	○	●	●	○	●	●
Cruze (2009 >)	○	●	●	○	●	●

	isofix M.C.	1	2	3		1	2	3
Spark (2009 >)		○	●	●		●	●	●
Volt (2011 >)		○	●	●		○	●	●
Matiz (2005 - 2009)		○	○	○		●	●	●
Chrysler								
Grand Voyager (2008 >)		○	●	●		●	●	●
300 C (2012 >)		○	●	●		○	●	●
Delta (2011 >)		○	●	●		●	○	○
Ypsilon (2011 >)		○	●	●		●	●	●
Citroen								
Berlingo Multispace (2007 >)		○	○	○		●	○	○
C1 (2005 >)		○	●	●		○	○	○
C3 5 Door (2009 >)		○	●	●		●	●	●
C3 Picasso (2009 >)		○	●	●		●	●	●
C4 (2010 >)		○	●	●		○	●	●
C4 Picasso (2007 >)		○	○	○		●	●	●
C5 Saloon (2008 >)		○	●	●		○	●	●
C5 Tourer (2008 >)		○	●	●		○	●	●
DS3 (2010 >)		○	●	●		○	●	●
DS4 (2011 >)		○	●	●		○	●	●
DS5 (2013 >)		○	○	○		○	○	○
Dacia								
Duster (2012 >)		○	○	○		●	●	●
Sandero (2013 >)		○	●	●		●	●	●
Fiat								
500 (2008 >)		○	●	●		●	●	●
500 C (2009 >)		○	●	●		●	●	●
Abarth 500 (2009 >)		○	●	●		●	●	●
Bravo (2007 >)		○	●	●		●	○	○

	isofix B.C			isofix B.C		
	1	2	3	1	2	3
500L (2013 >)	○	●	●	●	●	●
Panda (2012 >)	○	●	●	●	●	●
Grande Punto (2006 >)	○	●	●	●	●	●
Abarth Grande Punto (2008 - 2011)	○	●	●	●	●	●
Ford						
B Max (2012 >)	○	●	●	●	●	●
C Max (2003 >)	○	○	○	●	●	●
Fiesta (2008 >)	○	●	●	●	●	●
Focus (2010 >)	○	●	●	○	●	●
Focus CMax (2003 - 2010)	○	○	○	○	●	●
Galaxy (2006 >)	○	○	○	●	●	●
KA (2009 >)	○	●	●	●	●	●
Kuga (2013 >)	○	●	●	●	●	●
Mondeo Estate (2007 >)	○	●	●	●	●	●
Mondeo Hatchback (2007 >)	○	●	●	●	●	●
Mondeo Saloon (2007 >)	○	●	●	●	●	●
S Max (2006 >)	○	●	●	●	●	●
CMax (2012 >)	○	●	●			
Honda						
Accord Saloon (2008 >)	○	●	●	○	●	●
Accord Tourer (2008 >)	○	●	●	○	●	●
Civic (2012 >)	○	●	●	●	●	●
Civic (2006 - 2011)	○	●	●	○	●	●
Civic Hybrid Saloon (2006 - 2010)	○	●	●	○	●	●
Civic Type R (2007 - 2010)	○	●	●	○	●	●
CRV (2007 - 2013)	○	●	●	●	●	●
FRV (2006 - 2011)	○	○	○	●	○	○
Insight (2009 >)	○	●	●	●	○	○
Jazz (2008 >)	○	●	●	○	○	○

	isofix B.C					
	1	2	3	1	2	3
Hyundai						
i10 Hatchback (2008 >)	○	●	●	●	●	●
i20 Hatchback (2009 >)	○	●	●	●	●	●
i30 (2012 >)	○	●	●	●	●	●
i40 (2011 >)	○	●	●	●	●	●
iX20 (2010 >)	○	●	●	●	●	●
iX35 (2010 >)	○	●	●	○	●	●
SantaFe (2012 >)	○	●	●	○	●	●
Tucson (2010 >)	○	●	●	●	●	●
Veloster (2012 >)	○	●	●	●	●	●
Infiniti						
EX (2009 >)	○	●	●	○	●	●
FX (2009 >)	○	●	●	●	○	○
G Coupe (2009 >)	○	●	●	○	○	○
G Saloon (2009 >)	○	●	●	○	●	●
M (2010 >)	○	●	●	○	●	●
Jaguar						
X-Type (2001 - 2010)	●	●	●	●	●	●
X-Type estate (2004 - 2010)	●	●	●	●	●	●
XF (2008 >)	○	●	●	○	●	●
XF R (2009 >)	○	●	●	○	●	●
XF Sportbrake (2013 >)	○	●	●	○	●	●
XJ (2010 >)	○	○	○	○	●	●
XK (2006 >)	○	●	●	○	●	●
XK Convertible (2006 >)	○	●	●	○	●	●
XK R (2006 >)	○	●	●	○	●	●
Jeep						
Grand Cherokee (2011 >)	○	●	●	○	●	●
Compass (2011 >)	○	●	●	○	●	●

	Isofix B.C.			Child Seat		
	1	2	3	1	2	3
Kia						
Ceed Hatchback (2012 >)	○	●	●	●	●	●
Optima (2012 >)	○	●	●	●	●	●
Picanto (2008 >)	○	●	●	●	●	●
Rio (2012 >)	○	●	●	●	●	●
Sorento (2012 >)	○	●	●	○	●	●
Soul (2009 >)	○	○	○	●	●	●
Sportage (2011 >)	○	●	●	○	●	●
Venga (2010 >)	○	●	●	●	○	○
Land Rover						
Discovery 4 (2009 >)	○	●	●	●	●	●
Freelander 2 (2006 >)	○	●	●	●	●	●
Range Rover (2013 >)	○	●	●	○	●	●
Range Rover (2002 - 2012)	○	○	○	○	●	●
Range Rover Sport (2005 - 2012)	○	●	●	○	●	●
Range Rover Evoque (2011 >)	○	●	●	●	●	●
Lexus						
CT (2011 >)	○	●	●	○	●	●
GS (2013 >)	○	●	●	○	●	●
IS Saloon (2005 - 2012)	○	●	●	○	○	○
RX (2010 >)	○	●	●	○	●	●
Mazda						
CX-5 (2011 >)	○	●	●	●	●	●
CX-7 (2007 - 2011)	○	●	●	●	●	●
2 (2007 >)	○	●	●	●	●	●
2 Saloon (2007 >)	○	●	●	●	●	●
3 Hatchback (2009 >)	○	●	●	●	●	●
3 Saloon (2009 >)	○	●	●	○	●	●
5 (2005 >)	○	●	●	●	●	●

Kia

- Ceed Hatchback (2012 >)
- Optima (2012 >)
- Picanto (2008 >)
- Rio (2012 >)
- Sorento (2012 >)
- Soul (2009 >)
- Sportage (2011 >)
- Venga (2010 >)

Land Rover

- Discovery 4 (2009 >)
- Freelander 2 (2006 >)
- Range Rover (2013 >)
- Range Rover (2002 - 2012)
- Range Rover Sport (2005 - 2012)
- Range Rover Evoque (2011 >)

Lexus

- CT (2011 >)
- GS (2013 >)
- IS Saloon (2005 - 2012)
- RX (2010 >)

Mazda

- CX-5 (2011 >)
- CX-7 (2007 - 2011)
- 2 (2007 >)
- 2 Saloon (2007 >)
- 3 Hatchback (2009 >)
- 3 Saloon (2009 >)
- 5 (2005 >)

	isofix B.C.	1	2	3		1	2	3
6 Estate (2008 - 2012)		○	●	●		●	●	●
6 Hatchback (2007 - 2012)		○	●	●		●	●	●
6 Saloon (2007 - 2009)		○	●	●		●	●	●
6 Saloon (2013 >)		○	●	●		●	●	●
6 Estate (2012 >)		○	●	●		●	●	●
Mercedes Benz								
A Class (2005 - 2012)		○	●	●		●	●	●
A Class (2013 >)		○	●	●		●	●	●
B Class (2012 >)		○	●	●		○	●	●
C Class (2008 >)		○	●	●		○	●	●
C Class Estate (2008 >)		○	●	●		○	●	●
C Class Coupe (2011 >)		○	●	●		○	●	●
CLA (2013 >)		○	●	●		○	●	●
CLS Shootingbrake (2012 >)		○	●	●		●	●	●
CLS Coupe (2011 >)		○	●	●		●	●	●
E Class (2009 >)		○	●	●		○	●	●
E Class Coupe (2009 >)		○	●	●		○	●	●
E Class Estate (2009 >)		○	●	●		○	●	●
E-Class Saloon (2013 >)		○	●	●		●	●	●
GL Class (2006 - 2012)		○	●	●		●	●	●
M/ML Class (2005 - 2012)		○	●	●		●	●	●
R Class (2006 - 2012)		○	●	●		●	●	●
S Class (2006 - 2013)		○	●	●		○	●	●
SL Class (2012 >)		○	—	—		○	—	—
SLK (2011 >)		○	—	—		○	—	—
Mini								
Mini Hatchback (2006 >)		○	●	●		●	●	●
Mini Cooper S (2006 >)		●	●	●		●	●	●
Mini Coupe (2009 >)		○	—	—		○	—	—
Mini Countryman (2010 >)		○	●	●		●	●	●



1 2 3



1 2 3

Mitsubishi

ASX (2010 >)	○	●	●	○	●	●
Colt (2007 >)	○	●	●	●	●	●
Miev (2009 - 2012)	○	●	●	●	●	●
Lancer (2008 - 2011)	○	●	●	○	○	○
Lancer Sportback (2008 - 2011)	○	●	●	○	○	○
Lancer Ralliart (2009 - 2011)	○	●	●	○	○	○
Outlander (2007 - 2013)	○	●	●	○	●	●
Shogun (2007 >)	○	●	●	●	●	●

Nissan

Juke (2010 >)	○	●	●	○	●	●
Micra (2011 >)	○	●	●	●	○	○
Note (2006 >)	○	●	●	●	●	●
Qashqai+2 (2008 >)	○	●	●	○	●	●
X-Trail (2007 >)	○	●	●	○	●	●

Opel

Adam (2013 - >)	○	○	○	●	○	○
Agila (2008 >)	○	●	●	○	●	●
Ampera (2011 >)	○	●	●	○	●	●
Antara (2007 >)	○	●	●	○	●	●
Astra 5dr (2010 >)	○	●	●	●	●	●
Astra Estate (2010 >)	○	●	●	●	●	●
Astra GTC (2011 >)	○	●	●	●	●	●
Corsa D (2007 - 2012)	○	●	●	●	●	●
Corsa 3dr Hatchback (2006 >)	○	●	●	●	●	●
Corsa 5dr Hatchback (2006 >)	○	●	●	●	●	●
Corsa VXR (2007 >)	○	●	●	●	●	●
Insignia Hatchback (2009 >)	○	●	●	●	●	●
Insignia Saloon (2009 >)	○	●	●	●	●	●
Insignia Sports Tourer (2009 >)	○	●	●	●	●	●
Meriva (2010 >)	○	●	●	●	●	●

	isofix B.C.					
	1	2	3	1	2	3
Mooka (2013 >)	○	●	●	●	●	●
Zafira (2005 >)	○	●	●	○	●	●
Zafira VXR (2005 >)	○	●	●	○	●	●
Peugeot						
107 (2005 >)	○	●	●	○	○	○
207 3dr (2006 - 2012)	○	●	●	●	●	●
207 5dr (2006 - 2012)	○	●	●	●	●	●
207 SW (2007 - 2012)	○	●	●	●	●	●
208 3dr (2013 >)	○	●	●	●	●	●
208 5dr (2013 >)	○	●	●	●	●	●
307 (2001 - 2007)	○	●	●	●	●	●
307 Estate (2002 - 2007)	○	●	●	●	●	●
308 Hatchback (2008 >)	○	●	●	●	●	●
308 SW (2008 >)	○	●	●	●	●	●
3008 (2009 >)	○	○	○	●	●	●
4008 (2011 >)	○	●	●	○	●	●
508 (2011 >)	○	●	●	●	●	●
508 SW (2011 >)	○	●	●	●	●	●
508 RXH (2013 >)	○	●	●	●	●	●
5008 (2010 >)	○	○	○	●	○	○
RCZ (2011 >)	○	○	○	○	○	○
Porsche						
Cayenne (2011 >)	○	●	●	○	●	●
Panamera (2011 >)	○	○	○	○	●	●
Renault						
Clio (2005 - 2012)	○	●	●	●	●	●
Clio Renault Sport (2006 - 2012)	○	●	●	●	●	●
Clio Sport Tourer (2007 - 2012)	○	●	●	●	●	●
Clio (2013 >)	●	●	●	●	●	●

	isofix B.C.			B.C.		
	1	2	3	1	2	3
Laguna (2008 - 2012)	○	●	●	○	●	●
Laguna Sport Tourer (2008 - 2012)	○	●	●	○	●	●
Megane Hatchback (2008 >)	○	●	●	●	●	●
Megane Saloon (2006 - 2009)	○	●	●	●	●	●
Megane Tourer (2006 - 2009)	○	●	●	●	●	●
Megane Sport (2006 - 2009)	○	●	●	●	●	●
Megane Sport Tourer (2009 >)	○	●	●	●	●	●
Modus (2004 - 2012)	○	●	●	●	●	●
Grand Modus (2008 - 2012)	○	●	●	●	●	●
Scenic (2009 >)	○	○	○	○	●	●
Twingo (2012 >)	○	●	●	●	●	●
Saab						
9-3 (2002 - 2012)	○	●	●	○	●	●
9-3 Sport Wagon (2005 - 2012)	○	●	●	○	●	●
9-3 X (2009 - 2012)	○	●	●	○	●	●
9-5 Estate (2005 - 2010)	○	○	○	○	●	●
9-5 (2011-2012)	○	○	○	○	●	●
Seat						
Alhambra (2010 >)	○	○	○	○	●	●
Altea (2004 - 2011)	○	●	●	○	●	●
Altea XL (2007 - 2011)	○	●	●	○	●	●
Altea Freetrack4 (2007 - 2009)	○	●	●	○	●	●
Exeo (2008 >)	○	●	●	○	●	●
Exeo ST Estate (2008 >)	○	●	●	○	●	●
Ibiza Cupra (2009 >)	○	●	●	●	●	●
Ibiza FR (2009 >)	○	●	●	●	●	●
Ibiza Hatchback (2008 >)	○	●	●	●	●	●
Leon Cupra (2007 - 2011)	○	●	●	○	●	●
Leon FR (2006 - 2012)	○	●	●	○	●	●
Leon Hatchback (2005 - 2012)	○	●	●	○	●	●

	isofix B.C					
	1	2	3	1	2	3
Leon (2013 >)	○	●	●	●	●	●
Mii (2012 >)	○	●	●	●	●	●
Toledo (2013 >)	○	●	●	●	●	●
Skoda						
Citigo (2012 >)	○	●	●	●	●	●
Fabia Estate Combi (2008 >)	○	●	●	○	●	●
Fabia Hatchback (2007 >)	○	●	●	○	●	●
Octavia Estate Combi (2005 - 2013)	○	●	●	○	●	●
Octavia Hatchback (2004 - 2013)	○	●	●	○	●	●
Octavia Scout (2007 - 2013)	○	●	●	○	●	●
Rapid (2013>)	○	●	●	●	●	●
Roomster (2006 >)	○	●	●	○	●	●
Superb Combi Estate (2008 >)	○	●	●	●	●	●
Superb (2008 >)	○	●	●	●	●	●
Yeti (2009 >)	○	●	●	○	●	●
Smart						
For Two Coupe (2007 >)	○	—	—	●	—	—
Ssangyong						
Kyron (2005 - 2011)	○	●	●	●	●	●
Suzuki						
Alto (2009 >)	○	●	●	○	●	●
Grand Vitara (2006 >)	○	○	○	○	●	●
Splash (2008 >)	○	●	●	○	●	●
Swift (2011 >)	○	●	●	○	●	●
Swift Sport (2011 >)	○	●	●	○	●	●
SX-4 (2006 >)	○	●	●	○	○	○
SX-4 Saloon (2009 >)	○	●	●	○	○	○

Toyota

Auris (2007 - 2012)	○	●	●	○	●	●
Avensis Hatchback (2009 >)	○	●	●	●	●	●
Auris (2013 >)	○	●	●	●	●	●
Avensis Tourer (2009 >)	○	●	●	●	●	●
Aygo (2005 >)	○	●	●	○	○	○
GT86 (2012 >)	○	●	●	○	●	●
Land Cruiser (2003 - 2009)	○	●	●	○	○	○
Land Cruiser (2009 >)	○	●	●	○	●	●
Prius (2004 - 2009)	○	●	●	○	●	●
Prius (2009 >)	○	●	●	●	●	●
Prius Plus + (2012 >)	○	○	○	●	●	●
Rav 4 MK3 (2006 - 2011)	○	●	●	○	●	●
RAV4 (2013 >)	○	●	●	●	●	●
Verso (2009 - 2011)	○	●	●	○	●	●
Verso (2012 >)	○	○	○	○	●	●
Yaris Hatchback (2011 >)	○	●	●	●	●	●
Yaris SR (2007 - 2009)	○	●	●	●	●	●

Vauxhall

Adam (2013 >)	○	○	○			
Agila (2008 >)	○	●	●	●	○	○
Ampera (2011)	○	●	●	○	●	●
Antara (2007 >)	○	●	●	○	●	●
Astra 5dr (2010 >)	○	●	●	○	●	●
Astra Estate (2010 >)	○	●	●	●	●	●
Astra GTC (2011 >)	○	●	●	●	●	●
Corsa D (2007 >)	○	●	●	●	●	●
Corsa 3dr Hatchback (2006 >)	○	●	●	●	●	●
Corsa 5dr Hatchback (2006 >)	○	●	●	●	●	●
Corsa VXR (2007 >)	○	●	●	●	●	●
Insignia Hatchback (2009 >)	○	●	●	●	●	●
Insignia Saloon (2009 >)	○	●	●	●	●	●

	isofix B.C					
	1	2	3	1	2	3
Insignia Sports Tourer (2009 >)	○	●	●	●	●	●
Meriva (2010 >)	○	●	●	●	●	●
Mokka (2013 >)	○	●	●	●	●	●
Zafira (2005 >)	○	●	●	○	●	●
Zafira VXR (2005 - 2010)	○	●	●	○	●	●
Volkswagen						
Beetle (2012 >)	○	●	●	○	●	●
Multivan Caravelle (2003 >)	○	●	●	●	●	●
Golf Cabriolet (2009 - 2012)	○	●	●	●	●	●
Golf Hatchback (2009 - 2012)	○	●	●	○	●	●
Golf Hatchback MK7 (2012 >)	○	●	●	○	●	●
Golf GTI (2009 - 2012)	○	●	●	○	●	●
Golf Plus (2009 - 2011)	○	●	●	●	●	●
Jetta (2011 >)	○	●	●	○	●	●
Passat (2010 >)	○	●	●	○	●	●
Passat (2005 - 2010)	●	●	●	○	●	●
Passat Alltrack (2012 >)	●	●	●	○	●	●
Passat CC (2008 >)	○	○	○	○	●	●
Passat Estate (2005 >)	○	●	●	○	●	●
Polo 3dr (2009 >)	○	●	●	●	●	●
Polo 5dr (2009 >)	○	●	●	●	●	●
Scirocco (2008 >)	○	●	●	○	●	●
Sharan (2010 >)	○	○	○	●	●	●
Tiguan (2008 >)	○	●	●	○	●	●
Touareg (2012 >)	○	●	●	●	●	●
Touran (2003 - 2010)	○	○	○	○	○	○
Touran (2010 >)	○	○	○	○	○	○
UP! (2012 >)	○	●	●	●	●	●



1 2 3



1 2 3

Volvo

- C30 (2007 - 2012)
- S60 (2010 >)
- S80 (2007>)
- V40 (2012 >)
- V40 Cross Country (2012 >)
- V60 (2011 >)
- V70 (2008 >)
- XC60 (2008 >)
- XC70 (2008 >)
- XC90 (2003 >)

	1	2	3		1	2	3
C30 (2007 - 2012)	○	●	●		○	●	●
S60 (2010 >)	○	●	●		○	●	●
S80 (2007>)	○	●	●		○	●	●
V40 (2012 >)	○	●	●		○	●	●
V40 Cross Country (2012 >)	○	●	●		○	●	●
V60 (2011 >)	○	●	●		○	●	●
V70 (2008 >)	○	●	●		○	●	●
XC60 (2008 >)	○	●	●		○	●	●
XC70 (2008 >)	○	●	●		○	●	●
XC90 (2003 >)	○	●	●		●	●	●

AVERTISSEMENT:

Ce système de retenue pour enfant est applicable de manière « semi-universelle ». Conformément la réglementation numéro 44/04 dans sa version actuelle, il est autorisé pour l'utilisation générale dans des véhicules et utilisable dans tous les véhicules indiqués dans la liste des types fournie. Un montage correct est probable lorsque le fabricant du véhicule prévoit l'application de systèmes de retenue « semi universels » pour enfants de ce groupe d'âge dans son manuel d'utilisation. Ce système de retenue a été classé comme « semi universel » dans des conditions plus strictes que les systèmes de retenue plus anciens qui ne mentionnent pas cet avertissement. Le système de retenue pour enfant peut être utilisé dans des véhicules avec une ceinture 3 points déroulable lorsque ceux-ci ont été contrôlés et autorisés selon la norme ECE R16 ou autre norme comparable.

Ce siège auto est également un système de retenue ISOFIX : il est également autorisé selon la réglementation numéro 44/04 dans sa version actuelle pour l'utilisation générale dans des véhicules équipés d'un système de fixation ISOFIX. Le système de retenue pour enfant est adapté pour tous les sièges de véhicule identifiés en tant que sièges ISOFIX (vous trouverez plus d'informations à ce sujet dans le manuel d'utilisation de votre véhicule) selon la catégorie du siège auto et de la fixation. La classe de poids et la classe ISOFIX pour ce système de retenue pour enfant sont : 0-18 kg, B1, C. Si vous avez des questions, veuillez vous adresser au fabricant du siège auto ou du véhicule ou bien au vendeur de ce système de retenue pour enfant.

hauck GmbH +
Co KG
Frohnlicher Str. 8
D-96242 Sonnefeld
Germany

Tel. : +49(0)9562/986-0
Fax : +49(0)9562/6272
E-mail : info@hauck.de
Internet: <http://www.hauck.de>

Vehicle_Fitting_List_Varioguard_F

