

Canon

imageRUNNER®
5070



CORPORATE
SYSTEMS



meap
POWERED BY I

DESIGNED TO DELIVER CUSTOMIZED APPLICATIONS FOR SPECIFIC BUSINESS NEEDS

Capture, create, and communicate at network speed with the Canon imageRUNNER® 5070. From high-speed scanning and local document storage to advanced finishing, electronic distribution, and Internet-ready capabilities, the imageRUNNER 5070 delivers unmatched performance, durability, and innovation.

Delivering output at speeds of up to 50 pages per minute (letter), the imageRUNNER 5070 features Canon's MEAP® (Multifunction Embedded Application Platform) architecture as well as enhanced device management and security features. Send enhancements allow you to distribute documents instantaneously while usability improvements ensure ease-of-use. Plus, this device supports integration with Web-based information systems. With all these advanced features—and more—your office can achieve a new level of performance with the imageRUNNER 5070.

imageRUNNER 5070 Specifications

Type:	Digital, Multifunction Imaging System
Imaging System:	Laser Dry Electrostatic Transfer
Developing System:	Dry Mono Component Developing System
Fixing System:	Induction Heating Fusing System
Image Server Memory:	Standard 512MB RAM/20GB HDD
First-copy Time:	Approx. 3.3 Seconds or Less From Platen Glass
Warm-up Time:	Approx. 30 Seconds or Less
Copy/Print Speed:	50 cpm/ppm (Letter)
Acceptable Originals:	Sheets, Books, 3-dimensional Items (Up to 4.4 lb.)
Max. Original Size:	11" x 17"
Max. Copy Size:	11" x 17"
Min. Copy Size:	3-7/8" x 5-7/8"
Max. Mail Boxes Supported:	100
Max. Copy Reservation:	5 Jobs
Actual Resolution:	600 x 600 dpi
Interpolated Resolution:	1200 x 600 dpi (Copy) 2400 x 600 dpi (Print)
Halftones:	256 Gradations
Duplexing:	Standard Automatic Trayless Duplexing
Magnification:	25% to 400% (Platen) 25% to 200% (Feeder) (in 1% Increments)
Exposure Control:	Automatic or Manual (9 Levels)
Paper Sources	
Standard:	Dual Front-loading Trays (1,500 Sheets Each) Dual Front-loading Cassettes (550 Sheets Each) 50-sheet Stack Bypass
Optional:	3,500-sheet Paper Deck (Total: 7,650 Sheets)
Multiple Copies:	1 to 999
Paper Weights (From All Sources):	17 lb. Bond to 110 lb. Index
Dimensions (H x W x D):	47" x 25-3/8" x 29-1/4" (1192mm x 643mm x 743mm)
Weight:	Approx. 474 lb. (215kg)
Power Requirements:	120VAC, 60Hz, 16A
Power Consumption:	1.85kW (Max.)
Plug:	NEMA 5-20R
Toner Yield:	45,000 Images (at 6% Coverage)

Accessories

Universal Send™ Kit-D1 (Optional)

Sending Methods:	E-mail, I-fax, Super G3 Fax (Optional), File Server (IPX, FTP, SMB), User Inbox
Address Book Capacity:	Max. 1,800 Destinations
File Format	
Standard:	TIFF, PDF,
Optional:	PDF (OCR)
Sending Sizes:	Statement to 11" x 17"

Duplexing Automatic Document Feeder (Standard)

Acceptable Originals:	Statement to 11" x 17"
Capacity:	100 Sheets (20 lb. Bond)
Original Paper Weight:	13 lb. to 32 lb. Bond
Feeding Speed:	65 Sheets/Minute (Letter)
Power Source:	From Main Unit

Copy Tray-L1 (Optional)

Capacity:	250 Sheets (20 lb. Bond)
Dimension (H x W x D):	7-3/8" x 17-5/8" x 13-3/8" (186mm x 446mm x 340mm) (When auxiliary tray and auxiliary wire are extended)
Weight:	Approx. 1.4 lb. (670g)

Finisher-T1 and Saddle Finisher-T2 (Optional)

Number of Trays:	3 Trays
Tray Capacity	
No-collate Mode	
Tray A:	250 Sheets (Letter, Statement-R, Executive)
Tray B:	1,300 Sheets (Letter, Statement-R, Executive)
Tray C:	650 Sheets (Legal, Letter-R, 11" x 17") 2,450 Sheets (Letter, Executive) 1,700 Sheets (Statement-R) 650 Sheets (Legal, Letter-R, 11" x 17")
Collate and Group Mode	
Tray B:	1,300 Sheets (Letter, Executive) 650 Sheets (Legal, Letter-R, 11" x 17")
Tray C:	1,700 Sheets (Letter, Executive) 650 Sheets (Legal, Letter-R, 11" x 17")
Staple Mode	
Tray B/C:	1,300 Sheets/100 Sets (Letter, Executive) 650 Sheets/50 Sets (Legal, Letter-R, 11" x 17")
Max. Stapling Capacity	
Corner/Double:	50 Sheets (Letter, Executive) 30 Sheets (Letter-R, Legal, 11" x 17")

Saddle-stitching (Saddle Finisher-T2 Only)

Acceptable Paper Sizes:	Letter-R, Legal, 11" x 17"
Capacity/Tray:	1 to 5 Sheets/25 Sets 6 to 10 Sheets/15 Sets 11 to 15 Sheets/10 Sets
Max. Stapling Capacity/Set:	15 Sheets
Folding:	V-fold
Dimension (H x W x D):	42-3/4" x 25-1/2" x 25-7/8" (1,085mm x 648mm x 657mm)
Weight	
Finisher T1:	Approx. 88.2 lb. (40kg)
Saddle Finisher T2:	Approx. 163 lb. (74kg)
Attachable Accessories:	Puncher Unit-M1

Puncher Unit-M1 (Option for Finisher-T1/Saddle Finisher-T2)

Max. Paper Weight:	17 lb. Bond to 110 lb. Index
Paper Sizes	
2-hole:	Letter-R, Legal, Executive Letter, 11" x 17"
3-hole:	Letter, 11" x 17"
Punch Method:	Sequential Processing System (One sheet at a time)
Punch Dust Stock:	3,000 Sheets
Power Source:	From Main Unit
Dimension (H x W x D):	32-3/4" x 4-1/4" x 24-1/2" (833mm x 107mm x 614.8mm)
Weight:	Approx. 15.9 lb. (7.2kg)

Paper Deck-V1 (Optional)

Number of Drawers:	1
Paper Capacity:	3,500 Sheets (20 lb. Bond)
Paper Size:	Letter
Paper Weight:	17 lb. Bond to 110 lb. Index
Power Source:	From Main Unit
Dimension (H x W x D):	22-5/8" x 12-3/4" x 23" (574mm x 323mm x 583mm)
Weight:	Approx. 101 lb. (46kg)

Super G3 Fax Board-R1 (Optional)

Applicable Line:	Public Switched Telephone Network (PSTN)
Connection Lines:	1
Sending/Original Size:	Statement to 11" x 17"
Recording/Printing Size:	Statement to 11" x 17"
Transmission Times**	
ECM-MMR:	Approx. 3.2 Seconds
G3MR:	Approx. 13 Seconds
G3MH:	Approx. 13 Seconds
JBIG:	Approx. 2.6 Seconds
Scan Line Density	
Standard:	8 pels/mm x 3.85 lines/mm
Fine:	8 pels/mm x 7.7 lines/mm
Super-Fine:	8 pels/mm x 15.4 lines/mm
Ultra-Fine:	16 pels/mm x 15.4 lines/mm
Auto Dial Function:	Address Book: 1,800 Destinations
Image Memory:	Approx. 8,000 Pages

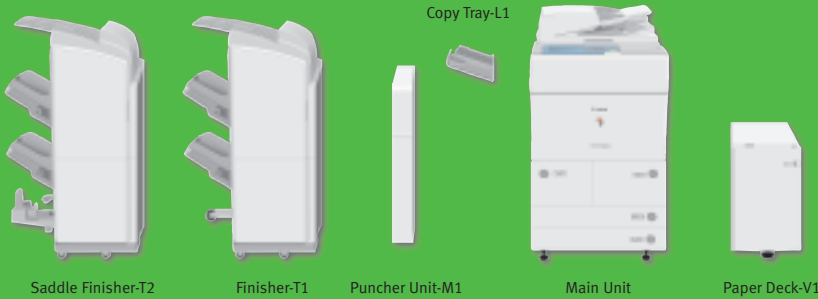

imageRUNNER®
5070

imageRUNNER 5070 Specifications (Continued)

Canon Multi-PDL Printer Kit-G5 (Optional)

Processor:	Canon Custom Processor—Shared
Memory:	512MB—Shared
Storage:	20GB—Shared
PDL Support:	PCL 5e/6, PostScript® 3™ Emulation, UFR II (Ultra Fast Rendering)
Interface Connections	
Standard:	10/100Base-TX (RJ-45), USB 2.0 High Speed
Network OS:	Windows® 98/Me/2000/XP Windows NT® 4.0/Server 2003 Solaris™ 1.1x, 2.5x or later Macintosh® OS 8.0 or later (PPD) Novell® NetWare® v.3.2, 4.1, 4.11, 4.2, 5, 5.1, 6, 6.5 (IPX/SPX™)
Printer Drivers	
UFR II:	Windows 2000/XP Windows Server 2003 Citrix MetaFrame Macintosh OS X (OS 10.1.5 or later)
PCL 5e/6:	Windows 98/Me/2000/XP Windows NT 4.0/Server 2003 Citrix MetaFrame
PS 3 Emulation:	Windows 98/Me/2000/XP Windows NT 4.0/Server 2003 Macintosh OS X (OS 10.2 or later)

Internal Fonts

PS:	136 Scalable Fonts
PCL 5e/6:	80 Scalable Fonts, 30 Barcode Fonts, 2 OCR Fonts, 10 Bitmap Fonts
Utility Software:	Network ScanGear Remote UI™ NetSpot® Console, NetSpot Job Monitor NetSpot Resource Downloader NetSpot Device Installer USB Class Driver, Fax Driver JBIG ImageViewer Canon LPR 2 Canon NDPS Gateway Canon Font Manager Canon Watermark Add-in DSE (Device Status Extension) Address Book Conversion Utility

Other Optional Accessories and Utilities

- Accessibility Handle-A1
- Barcode Printing Kit-A1
- Braille Label Kit-A1
- Card Reader-C1
- Card Reader Attachment-C2
- Card Sets

- Cassette-AB1
- Document Tray-K1
- eCopy Suite
- Expansion Bus Board-C1
- imageRUNNER Security Kit-A2
- imageWARE™ Suite
- NetSpot Suite
- Remote Operator's Software Kit-A1
- Tab Feeding Attachment-A1
- USB Application Interface Board-D1
- Universal Send PDF Enhancement Kit-B1
- Voice Guidance Kit-A2
- Web Access Software-A1

** Approximate 3-second-per-page fax transmission time based on ITU-T No. 1 Chart (MMR, Standard Mode) at 33.6 Kbps modem speed when transmitting to another V.34 machine. The Public Switched Telephone Network (PSTN) currently supports 28.8 Kbps modem speeds or lower, depending on telephone line conditions.



1-800-OK-CANON
www.usa.canon.com

Canon U.S.A., Inc.
One Canon Plaza
Lake Success, NY 11042

As an ENERGY STAR® Partner, Canon U.S.A., Inc. has determined that these products meet the ENERGY STAR guidelines for energy efficiency. ENERGY STAR and the ENERGY STAR mark are registered U.S. marks. Windows and Windows NT are registered trademarks of Microsoft Corporation in the United States and/or other countries. Adobe and PostScript are registered trademarks of Adobe Systems Incorporated in the United States and/or other countries. Apple and Macintosh are registered trademarks of Apple Computer, Inc. Intel and Celeron are registered trademarks of Intel Corporation. eCopy ShareScan is a trademark of eCopy, Inc. Novell and NetWare are registered trademarks of Novell, Inc. in the United States and other countries. Solaris is a trademark of Sun Microsystems, Inc. in the United States and other countries. IPX/SPX is a trademark of Novell, Inc. CANON, IMAGERUNNER, and MEAP are registered trademarks, and UNIVERSAL SEND and the GENUINE logo are trademarks of Canon Inc. in the United States and may also be registered trademarks or trademarks in other countries. IMAGEWARE is a registered trademark of Canon U.S.A., Inc. in the United States and is a trademark of Canon Inc. in certain other countries. Remote UI is a trademark of Canon U.S.A., Inc. IMAGEANYWARE is a trademark of Canon. All referenced product names and other marks are trademarks of their respective owners.

Some products shown with optional accessories and equipment.

©2005 Canon U.S.A., Inc. All rights reserved.

