

Save

Ariens OWNERS MANUAL

924000 SERIES SNO-THROS

MODEL 924046 5 H.P. 24"
SMALL WHEEL
SERIAL NUMBER 000101 AND UP

MODEL 924048 7 H.P. 24"
SMALL WHEEL W/DIFFERENTIAL
SERIAL NUMBER 000101 AND UP

MODEL 924050 8 H.P. 24"
LARGE WHEEL W/DIFFERENTIAL
SERIAL NUMBER 000101 AND UP

MODEL 924052 10 H.P. 32"
LARGE WHEEL W/DIFFERENTIAL
SERIAL NUMBER 000101 AND UP

MODEL 924049
7 H.P. TRAC-TEAM TRACTOR
SMALL WHEEL W/DIFFERENTIAL
SERIAL NUMBER 000101 AND UP

MODEL 924051
8 H.P. TRAC-TEAM TRACTOR
LARGE WHEEL W/DIFFERENTIAL
SERIAL NUMBER 000101 AND UP

ATTACHMENTS:

MODEL 824006 24" SNO-THRO
ATTACHMENT FOR SMALL WHEEL TRACTOR
SERIAL NUMBER 000101 AND UP

MODEL 824005 24" SNO-THRO
ATTACHMENT FOR LARGE WHEEL TRACTORS
SERIAL NUMBER 000101 AND UP

MODEL 824008 32" SNO-THRO
ATTACHMENT FOR LARGE WHEEL TRACTORS
SERIAL NUMBER 000101 AND UP

▲ SAFETY MESSAGE ▲

The product for which you have requested information or replacement parts is not a current product. The replacement models incorporate product designs, safety features, safety instructions or warnings which represent the latest "State Of The Art" developments. For your safety and those around you please contact your nearest Ariens/Gravely Dealer for a demonstration of the current product safety provisions and features.

A MESSAGE TO THE ARIENS CUSTOMER...

Welcome to the world of Ariens equipment. We are pleased that you have selected Ariens and sincerely believe you have purchased the best equipment available. The care you give your new Ariens equipment will greatly determine the satisfaction and service life you will obtain from it. Use this manual and the engine manual supplied, as your guide. By observing the instructions and suggestions in these manuals, your Ariens equipment will serve you well for many years.

Your Ariens dealer will be happy to supply any service or advice which may be required to keep your Ariens equipment operating at peak efficiency. He stocks genuine Ariens parts and lubricants; manufactured with the same precision and skill as the original equipment. His factory trained staff is kept well informed on the best methods of servicing Ariens

equipment and is ready and able to serve you. If engine repairs or services are required, they can be obtained from an Ariens dealer or from an authorized engine manufacturer's service station.

Should service be required on equipment, be prepared to supply the serviceman with the Model Number and Serial Number of the equipment and the engine, as well as a full description of the trouble encountered.

Finally, your local Ariens dealer is in the best position to answer your questions and service equipment. If for some reason he is unable to satisfy your requirements, assistance is always available from the Consumer Services, Ariens Company, Brillion, Wisconsin 54110. Telephone: (414) 756-2141.

Ariens COMPANY BRILLION, WISCONSIN 54110

PART NUMBER 024449B

"A CUT ABOVE THE REST!"

PRINTED IN U.S.A.

Clutch Lever
Depress for attachment drive

Clutch Lever
Depress for wheel drive

Ariens 511032

- 5 HP. 78640
- 7 HP. 78641
- 8 HP. 78642
- 10 HP. 78643

SAFETY INSTRUCTIONS

AVOID POTENTIAL HAZARDS

1. Read owners manual for operating and safety instructions.
2. Observe all labels and instructions.
3. Stop engine and wait for all movement to stop before unclugging or servicing machine.
4. Never allow children to operate the equipment. Never allow adults to operate the equipment without proper instruction.
5. Keep the area of operation clear of all persons, especially children.
6. Never direct discharge at bystanders or allow anyone in front of unit.
7. Keep machine properly maintained and serviced with all shields, guards and protective devices in place.

78617

78616

SCREENED ON PANEL

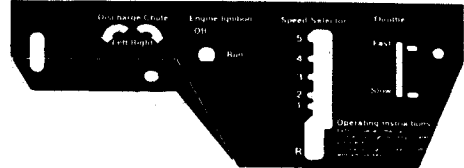

78638

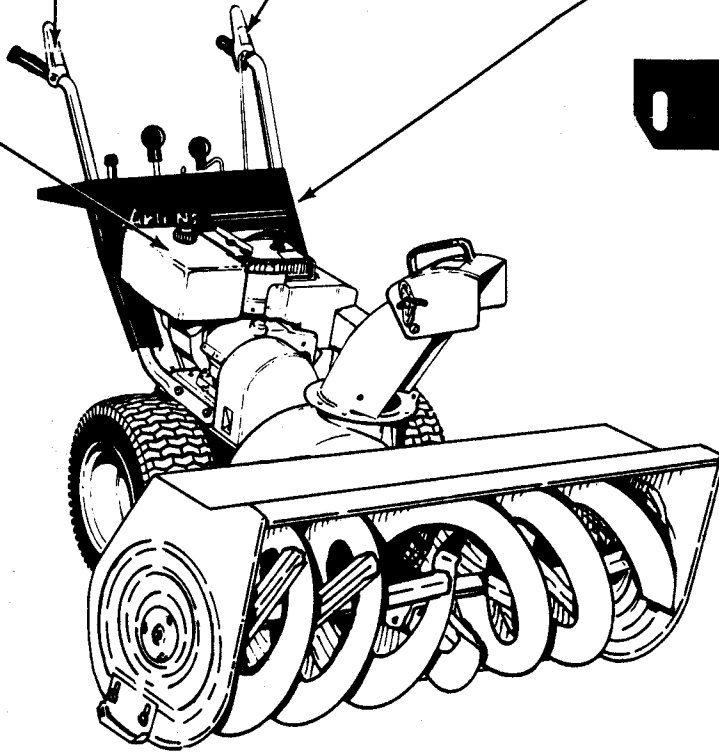

ORDER ALL DECALS BY ARIENS PART NUMBER SHOWN

INSTRUCTIONS FOR SAFE OPERATION



IMPORTANT

Safe Operation Practices for Snow Throwers

Training

1. Read the owner's manual carefully. Be thoroughly familiar with the controls and the proper use of the equipment. Know how to stop the unit and disengage the controls quickly.
2. Never allow children to operate the equipment. Never allow adults to operate the equipment without proper instruction.
3. Keep the area of operation clear of all persons, particularly small children, and pets.
4. Exercise caution to avoid slipping or falling, especially when operating in reverse.

Preparation

1. Thoroughly inspect the area where the equipment is to be used and remove all doormats, sleds, boards, wires, and other foreign objects.
2. Disengage all clutches and shift into neutral before starting the engine (motor).
3. Do not operate the equipment without wearing adequate winter outer garments. Wear footwear which will improve footing on slippery surfaces.

4. Handle fuel with care; it is highly flammable.
 - a. Use an approved fuel container.
 - b. Never add fuel to a running engine or hot engine.
 - c. Fill fuel tank outdoors with extreme care. Never fill fuel tank indoors.
 - d. Replace gasoline cap securely and wipe up spilled fuel.
5. Use a grounded three-wire plug-in for all units with electric drive motors or electric starting motors.
6. Adjust the collector housing height to clear gravel or crushed rock surface.
7. Never attempt to make any adjustments while the engine is running (except where specifically recommended by manufacturer).
8. Let engine and machine adjust to outdoor temperatures before starting to clear snow.

Operation

1. Do not put hands or feet near or under rotating parts. Keep clear of the discharge opening at all times.
2. Exercise extreme caution when operating on or crossing gravel drives, walks, or roads. Stay alert for hidden hazards or traffic. Do not carry passengers.
3. After striking a foreign object, stop the engine, remove the wire from the spark plug, thoroughly inspect the snow thrower for any damage, and repair the damage before re-starting and operating the snow thrower.

(5,7 HP.)
Off ●
● Full
Choke
78602

(8,10 HP.)
Choke
Off ●
● Full
78603

5 H.P. ENGINE DECAL 78611
7 H.P. ENGINE DECAL 78637
8 H.P. ENGINE DECAL 78636
10 H.P. ENGINE DECAL 78635

10HP

Engine Primer
Push to prime
78606

78645

WARNING
ROTATING PARTS
Stop engine and remove spark plug ignition wire before removing obstructions.
78618

WARNING
MUFFLER & ADJACENT AREAS MAY EXCEED 150 F
78601

WARNING
ROTATING PARTS
Keep clear of collector rakes while engine is running
78639

This engine has provisions for electric starter kit.
78607



Differential Lock
In Out
78644 (ON LEFT WHEEL HUB OF MODELS 924048, 924050 & 924052)

Attention
When using summer attachments, remove heater box and install air cleaner
78608

Tecumseh Engine Instructions
CAUTION
For your personal protection read all safety notes in engine owner's manual
OPERATION
For detailed lubrication, starting & operating instructions, see engine owner's manual & equipment mtr. & instructions
LUBRICATION
Summer SAE 30 Oil
Winter SAE 5W-30 Oil
Tecumseh Products Company
900 North Street
Grafton, WI 53024, U.S.A.
78609

ORDER ALL DECALS BY ARIENS PART NUMBERS SHOWN

BE AWARE OF SAFETY DECALS

- If the unit should start to vibrate abnormally, stop the engine and check immediately for the cause. Vibration is generally a warning of trouble.
- Stop the engine whenever you leave the operating position, before unclogging the collector/impeller housing or discharge guide, and when making any repairs, adjustments, or inspections.
- When clearing, repairing, or inspecting, make certain the collector/impeller and all moving parts have stopped. Disconnect the spark plug wire.
- Do not run the engine indoors, except when starting the engine and for transporting the snow thrower in or out of the building. Open the outside doors; exhaust fumes are dangerous.
- Do not clear snow across the face of slopes. Exercise extreme caution when changing direction on slopes. Do not attempt to clear steep slopes.
- Never operate the snow thrower without proper guards, plates, or other safety protective devices in place.
- Never operate the snow thrower near glass enclosures, automobiles, window wells, drop-offs, etc, without proper adjustment of the snow discharge angle. Keep children and pets away.
- Do not overload the machine capacity by attempting to clear snow at too fast a rate.

- Never operate the machine at high transport speeds on slippery surfaces. Use care when backing.
- Never direct discharge at bystanders or allow anyone in front of the unit.
- Disengage power to the collector/impeller when snow thrower is transported or not in use.
- Use only attachments and accessories approved by the manufacturer of snow thrower (such as wheel weights, counterweights, cabs, etc).
- Never operate the snow thrower without good visibility or light. Always be sure of your footing, and keep a firm hold on the handles. Walk; never run.

Maintenance and Storage

- Check shear bolts, engine mounting bolts, etc, at frequent intervals for proper tightness to be sure the equipment is in safe working condition.
- Never store the machine with fuel in the fuel tank inside a building where open flame or sparks are present. Allow the engine to cool before storing in any enclosure.
- Always refer to owner's manual instructions for important details if the snow thrower is to be stored for an extended period.
- Run the machine a few minutes after throwing snow to prevent freeze-up of the collector/impeller.

CONTROLS

- ① **SPEED SELECTOR:** Sets speed of tractor. Change speed or shift to reverse.
- ② **THROTTLE:** Controls engine speed. On 5 and 7 HP Models move throttle control to "FAST" position after engine has stopped to minimize throttle damage due to freezing. On 8 and 10 HP Models move throttle to "SLOW" position after engine has stopped to minimize throttle damage due to freezing.
- ③ **WHEEL DRIVE CLUTCH LEVER:** Activates tractor drive. Depress to move tractor, release to disengage drive and stop machine.
- ④ **ATTACHMENT DRIVE CLUTCH LEVER:** Activates auger and impeller. Depress to run auger and impeller, release both attachment and tractor clutch to stop attachment.
- ⑤ **HAND CRANK:** Turns discharge chute 230° so snow can be thrown away from area being cleared.
- ⑥ **CHOKE:** Move choke to choke position to start engine. Models 924046 and 924048 have choke on top of heater box. Models 924050 and 924052 have choke at rear of heater box.
- ⑦ **PRIMER BUTTON:** Injects gas directly into carburetor. (A) Move choke lever to full. (B) Push primer bulb two times. (C) Pull start rope three times. If engine fails to start, repeat procedure from step (B).
- ⑧ **KEY SWITCH:** Prevents unauthorized use. Turn on to run, turn off to stop.
- ⑨ **STARTER BUTTON:** The starter button ⑩ is found on all units equipped with electric starters. Plug the 120 volt cord into the starter block; plug the opposite end into a convenient 120 volt outlet. Push the starter button to start the engine.

OPERATION

BEFORE STARTING:

Fill engine crankcase ⑬ with Ariens Sno-Thro oil 5W-20 when using Sno-Thro.

Fill fuel tank ⑭ with fresh, clean, regular gasoline. Do not mix oil with gasoline.

Make visual check with regards to safety precautions, obstructions, lubrication and maintenance.

DIFFERENTIAL LOCK: Models 924048, 924050 & 924052.

The differential lock ⑬ is located in the left wheel hub. When preparing to blow snow, turn the differential lock till it snaps IN. In this position the differential is locked and both wheels turn together. Power is applied equally to both. To use the differential, pull back on the knob and turn it to the OUT position. This unlocks the differential for easy turning with mower, vacuum or broom attachments.



CAUTION:

A high speed impeller rotates inside this housing to throw the snow. **NEVER** reach or push any object into the discharge chute with the impeller rotating!

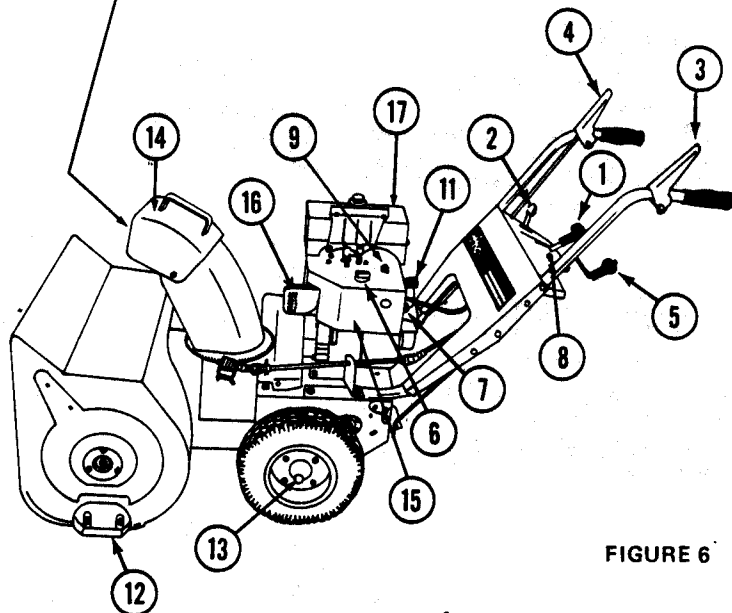

FIGURE 6

CAUTION:

If tractor is to be used with lawn attachments, be sure heater box ⑮ is removed and air cleaner installed. Follow detailed instructions packed with attachment.

NOTE:

Check for frozen throttle control and for frozen impeller fan before starting engine. These problems arise in wet, slushy snow. If the impeller is frozen, it is best freed by thawing in a heated garage or other building. A frozen throttle control may be freed by starting the engine and letting it run long enough to heat up the carburetor and loosen the cable. The best solution for both problems is preventing freezing. Allow the engine to run for a short time before shutting down to throw the remaining slush and water out of the blower housing and thus prevent freezing of the impeller fan. On 5 and 7 HP Models move throttle control to "FAST" position after engine has stopped to minimize throttle damage due to freezing. On 8 and 10 HP Models move throttle to "SLOW" position after engine has stopped to minimize throttle damage due to freezing.

TO START: Controls are identified in Figure 6.

Turn key ⑧ to "run" position.

Move choke lever ⑥ to CHOKE position:

Move throttle ② to FAST position.

Push primer bulb ⑦ 2 times.

Pull recoil starter ⑪ to start engine. If the machine is equipped with an electric starter attach the starter cable to the starter switch, plug the cable into any convenient 120 volt electrical outlet - and depress the starter button to crank and start the engine. Follow the starter manufacturers instructions supplied with the starter.

Move choke ⑥ to no choke gradually as engine warms up.

TO TRANSPORT:

- Move speed selector ① to desired speed.
- Press down on handle bars to raise front of Sno-Thro slightly off the ground.
- Depress wheel drive clutch lever ③ to transport unit.

TO OPERATE:

- Move deflector ⑭ to desired height.
- Turn hand crank ⑤ to direct discharge chute.
- Depress attachment clutch ④ to engaged position.
- Move speed selector ① to desired speed.
- Move throttle ② to desired speed.
- Depress the wheel drive clutch lever ③ to move tractor.
- Speed of the machine is controlled by the throttle and speed selector.

TO STOP:

- Release wheel drive clutch lever ③. Depress attachment clutch lever ④ to allow the Sno-Thro to run for a short time to throw out slush and water and prevent freezing the impeller fan.
- Turn key ⑧ to "off" position to stop.
- 5 and 7 HP Models: Move throttle to "FAST" position after engine has stopped.
- 8 and 10 HP Models: Move throttle to "SLOW" position after engine has stopped.

NOTE: This Sno-Thro is equipped with a mechanical interlock between wheel drive clutch and attachment clutch levers. When both clutch levers are engaged the mechanical interlock will engage and the attachment clutch will remain engaged as long as the wheel drive clutch lever is not released. This frees the right hand to operate other controls. Once the mechanical interlock is engaged, both the wheel drive and attachment clutch levers must be released to disengage the attachment drive.

MAINTENANCE

Ariens Company recommends that you have adjustments made by your local Ariens dealer. He has the tools and know-how to properly perform these maintenance adjustments which may be required to keep the Sno-Thro operating at peak efficiency. The Sno-Thro is equipped with the finest quality engine obtainable. However, should servicing be required, it can be obtained from an Ariens dealer or an authorized engine manufacturer's service station. Should you decide to make adjustments on your Sno-Thro yourself, Ariens recommends that you call your dealer for the answers to any questions that might arise in performing this work.

SHEAR BOLT REPLACEMENT

Occasionally a small object may enter the collector and jam the rakes. When this occurs, the shear bolts securing the rakes to the shaft will break and allow the rake to turn freely on the shaft preventing damage to the gear drive. When this happens, turn off the engine, remove wire from spark plug, remove the broken shear bolt and replace with a new ARIENS shear bolt. Use of any other type of shear bolt may result in severe damage to the machine. USE ONLY ARIENS SHEAR BOLTS FOR REPLACEMENT.

RUNNERS AND SCRAPER BLADE

The runners ⑫ on each side of the blower housing, and the scraper blade, along the back of the blower housing, are all adjustable to suit conditions. Raising or lowering the runners controls the distance the scraper blade is held above the surface being cleared. Runners are adjusted by loosening the two nuts securing each runner. Move the runner to the desired position and retighten the nuts. Be sure to adjust both runners to the same height to keep blower housing level. Uneven runners make the machine difficult to steer and will result in an uneven clearing job.

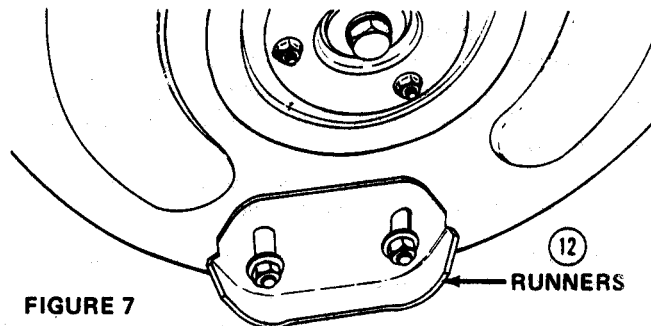

FIGURE 7

Adjustment of the runners is critical to good cleaning. If the machine is to be used on a gravel surface lower the runners so the blower will not pick up gravel. Then after the remaining snow is packed down, the runners may be raised for close scraping. On smooth concrete or blacktopped surfaces, the runners may be raised so the scraper blade rests on the surface and scrapes clean.

The scraper is adjustable so it may be lowered to compensate for wear. If the blade is allowed to wear down too far the blower housing may be damaged.

ATTACHMENT CLUTCH ADJUSTMENT

The Attachment Clutch is adjusted by connecting the chain to the spring just below the clutch handle. Connect the spring to a chain link so the chain is snug but so the idler drops away from the belt with the handle all the way up.

WHEEL DRIVE CLUTCH ADJUSTMENT

A drive disc adjustment is provided to compensate for wear on the friction wheel. If slippage occurs when the wheel drive clutch is engaged, tighten the drive disc adjustment. This adjustment is accessible without removing the bottom cover. See Figure 8.

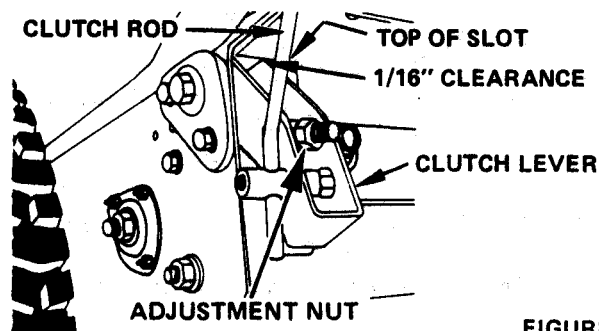

FIGURE 8

Adjust as follows: Place speed selector ① between first and reverse. Tip machine forward on blower housing. Tighten the adjustment nut while turning the wheels until the wheels begin to bind. Back off 3 turns. Wheels should then turn easily.

CHUTE CRANK ADJUSTMENT

In the event the chute crank fails to rotate freely, loosen the nut securing the worm clevis to the bracket. This hole in the bracket is slotted to permit adjustment. Position the worm so there is a little clearance between worm and the gear teeth on the blower. Tighten the nut. Rotate the discharge chute through its full travel to see that it turns easily. Re-adjust if required. Lubricate as described under LUBRICATION for smooth operation.

BELT REPLACEMENT

CAUTION

Since replacing the belts will involve turning the engine over with the starter, and the engine might accidentally start, resulting in injury, the spark plug wire **MUST** be disconnected during this procedure.

The drive belt and the attachment drive belt are both accessible by removing the blower housing as follows:

1. Remove the hair pin cotter in the chute crank assembly. Separate the chute crank.
2. Remove the two flanged whizlock screws securing the belt guard to the tractor. Remove the belt guard.

NOTE: *Tipping the tractor back on the handlebars when separating the units may result in bending the bottom cover. To avoid this situation, either tip the unit up on the blower housing and remove the bottom cover before separating the units; or support the handlebars so the tractor does not tip all the way over; then lift off the blower housing.*

3. Remove the cap screws on each side that secures the blower housing to the frame. As the blower housing and tractor are tipped apart, roll the belt off the engine sheave between the sheave and belt finger. This can be easily done by pulling the recoil starter rope to rotate the engine sheave. With the belt disconnected, the blower housing may then be lifted from the frame.

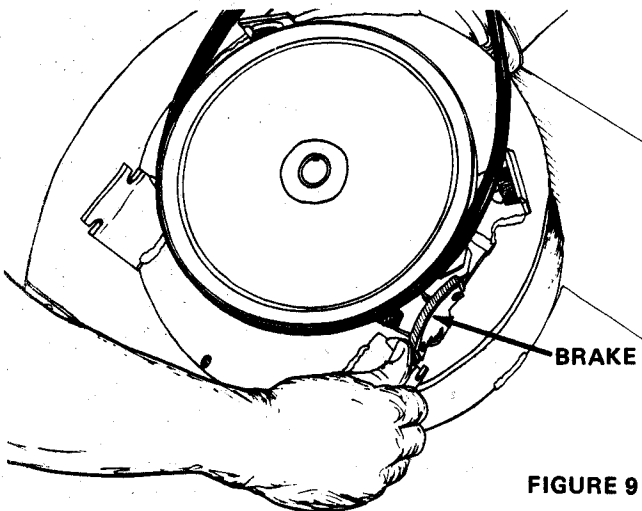

FIGURE 9

REPLACEMENT OF THE ATTACHMENT DRIVE BELT

The sno-thro attachment drive belt is on the sheave on the blower housing. To replace this belt, hold the impeller brake away from the belt and slip the belt from the sheave. See Figure 9.

Replace the belt by slipping it into position on the sheave; positioning the brake shoe on the belt.

REPLACEMENT OF TRACTOR DRIVE BELT (See Figure 10.)

The drive belt is held in place on the sheaves by an idler pulley. To free the belt, the idler can be pulled from the belt and the belt removed from the sheave. Activate clutch to gain clearance. It may be necessary to pull back blower idler arm clevis pin for additional clearance.

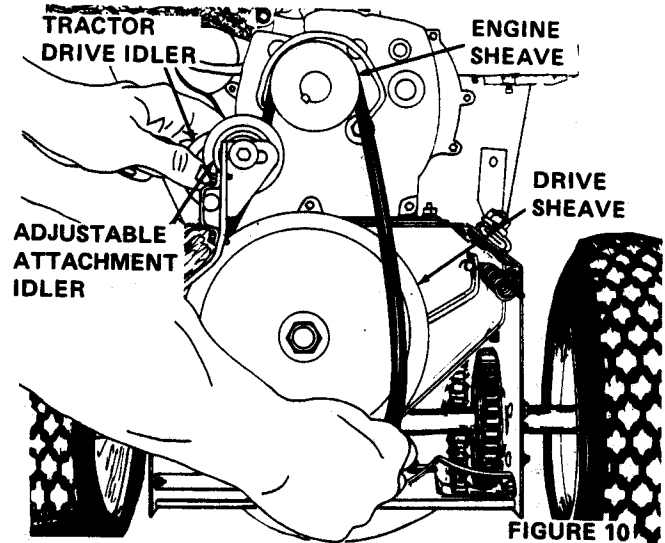

FIGURE 10

To replace the belts, position on the engine sheave first, then on the drive sheave. Position the idler carefully on the belt.

With the belt in position and the idler in place, check the belt alignment. The engine sheave and the tractor sheave must align with one another **WITH THE TRACTOR CLUTCH ENGAGED**. If the sheaves are not properly aligned, loosen the setscrews on the engine sheave and align the sheaves. Re-tighten the setscrews. Recheck the belt alignment **WITH THE CLUTCH ENGAGED**.

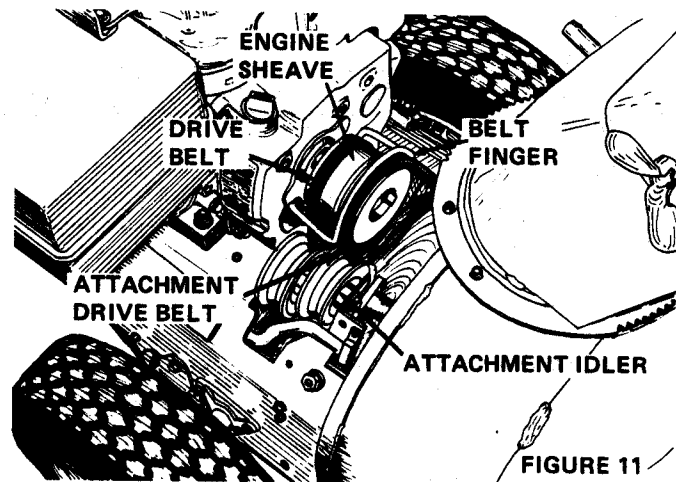

FIGURE 11

REPLACEMENT OF BLOWER HOUSING (See Figure 11.)

Position the blower housing on the rod in the tractor frame and secure as follows:

1. Tip the blower and tractor together. Hold the attachment drive belt up as the units are tipped together. Secure with two cap screws into the frame. As the cap screws are tightened, hold up on the handlebars to be sure the two units are secured together.

- Roll the attachment belt on to the engine sheave. Pull the recoil starter rope to turn the engine sheave and roll the belt into place under the belt finger.
- Check the belt finger spacing. There should be 1/8 inch clearance all around the belt finger and belt with the attachment clutch engaged. Readjust the belt finger if required.
- Check the sheave alignment with the attachment belt in place. Readjust the position of the blower sheave as required to align the sheaves. Be sure the brake pad aligns with the blower sheave.
- The idler on the attachment belt is adjustable. If the belt slips, adjust the idler in the slot in the idler arm to apply more tension to the belt. Belt should declutch when attachment clutch is disengaged.
- Replace the belt guard and chute crank assemblies. Re-adjust the chute crank as described in the paragraph above. Replace the spark plug wire.

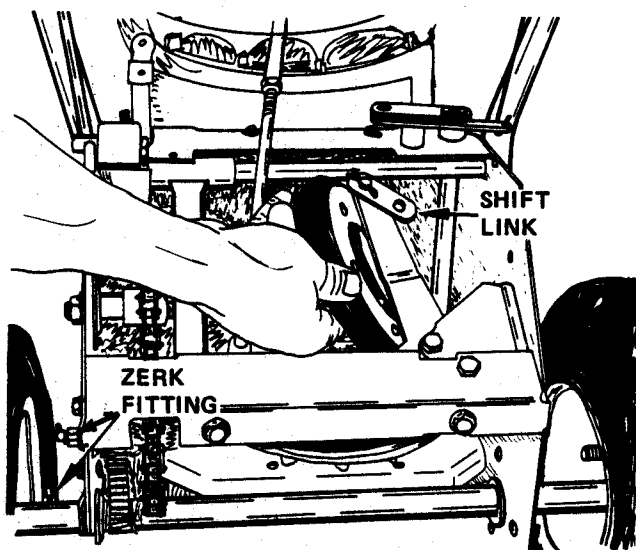

FIGURE 12

REPLACEMENT OF FRICTION WHEEL

- Tip the machine up on the blower housing and brace securely. Remove two cap screws and loosen the other two, securing the bottom cover and remove the cover.
- Place the speed selector in FIRST position. Depress the wheel drive clutch lever to hold the friction wheel while the five bolts securing the friction wheel to the hub are loosened. Remove the five bolts, shift to THIRD position and disconnect the shift link. See Figure 12.
- Position a new friction wheel on the hub and replace the five bolts. Tighten these bolts to 8-10 foot pounds with a torque wrench. Replace the shift links.
- Replace the bottom cover. Readjust the drive disc as described in the WHEEL DRIVE CLUTCH ADJUSTMENT on page 5.

DRIVE CHAIN ADJUSTMENT MODELS 924050 and 924052

If sno-thro is difficult to push because of tight or interfering drive chains, proceed as follows:

- Stand unit up on blower housing and remove bottom cover.
- Chain tension is adjusted by loosening the two nuts on the 24364 Reduction Shaft. Adjust reduction sprocket up or down in slot to obtain proper tension (chain should be snug). Retighten both nuts. Torque to 170-180 inch lbs.
- Chain interference with the 3085 Bearing Flange on 24045 Hex Shaft occurs if there is no 64058 Washer between the 10276 Sprocket and 54079 Bearing. Install washer.

LUBRICATION

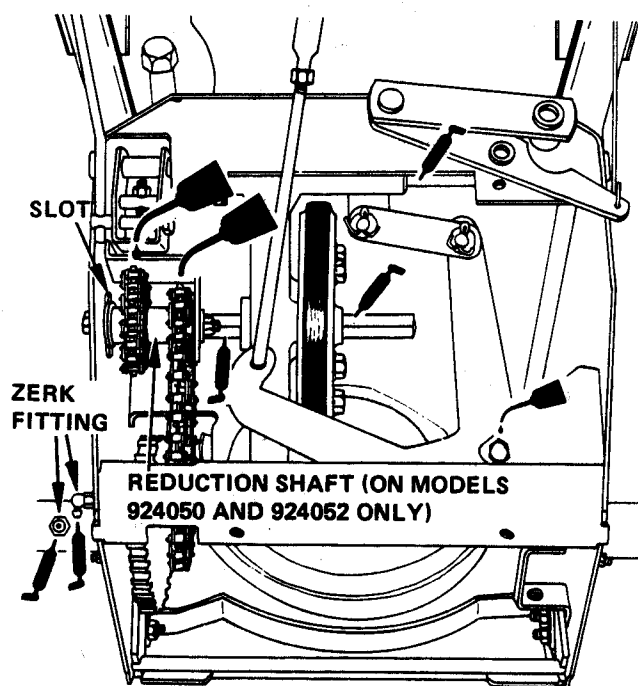

FIGURE 13

ENGINE

Fill crankcase with Ariens Sno-Thro oil 5W-20 when using Sno-Thro at temperatures below 40 degrees F.

Use Ariens Gard-N-Yard oil MS classification SAE-30 when using lawn attachments at temperatures above 40 degrees F.

Fill fuel tank (17) with fresh, clean, regular gasoline.

NOTE:

For detailed instructions on engine refer to manufacturer's booklet packed with the machine.

TRACTOR DRIVE

At start of season, grease gears, pinion sprocket, hex and axle shaft as indicated in Figure 13. Use Ariens Moly Lithium grease.

Put two or three drops of light oil on speed selector and other linkage points. **CAUTION:** Do not allow grease or oil to come in contact with friction wheel, drive disc or belts.

SNO-THRO UNIT

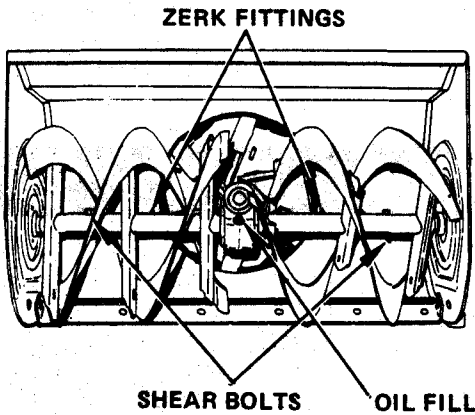

FIGURE 14

NOTE:

When replacing a worn or broken shear bolt, use **ARIENS** shear bolts only.

Grease rake shaft periodically or each time a shear bolt is replaced. At the end of the season, remove shear bolts, use a grease gun on zerk fittings to grease rake shaft, turn rakes on shaft several times and replace shear bolts. See Figure 14. Use Ariens Moly Lithium grease.

MODEL 924052 GEARCASE

Check oil level periodically. Oil level must be up to oil fill hole. Change oil every 25 hours or once each season whichever comes first. Fill with Ariens Special L-2 Gear Lubricant. Approximately 5 oz.

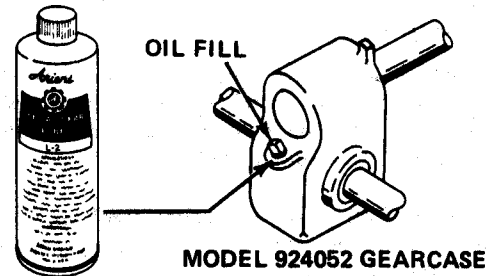
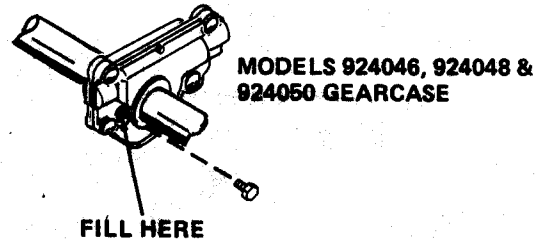

FIGURE 15



MODELS 924046, 924048 & 924050 GEARCASE

The blower gear case is lubricated with Ariens Liquid Grease (Part No. 000070). This grease will not flow at lower temperatures. It is therefore difficult to check the lubricant level. Best method for checking is to place the unit in a warm location overnight. This allows the grease to flow to level. Check the lubrication by removing the filler plug on the side of the gear case just above the left auger shaft. Lubrication should be even with the hole with the machine sitting level. It may be necessary to insert a wire into the hole to check level. The unit will not be damaged by over lubricating.

STORAGE

ENGINE: Follow detail instructions in the engine manual.

SNO-THRO: Lubricate, clean and repaint as necessary. Cover and store in dry place.

**24" & 32" SNOW-THRO FOR
MODELS 924046, 48,
50 & 52**

**SNO-THRO DE 24" ET 32"
MODELES 924046,
48, 50 ET 52**

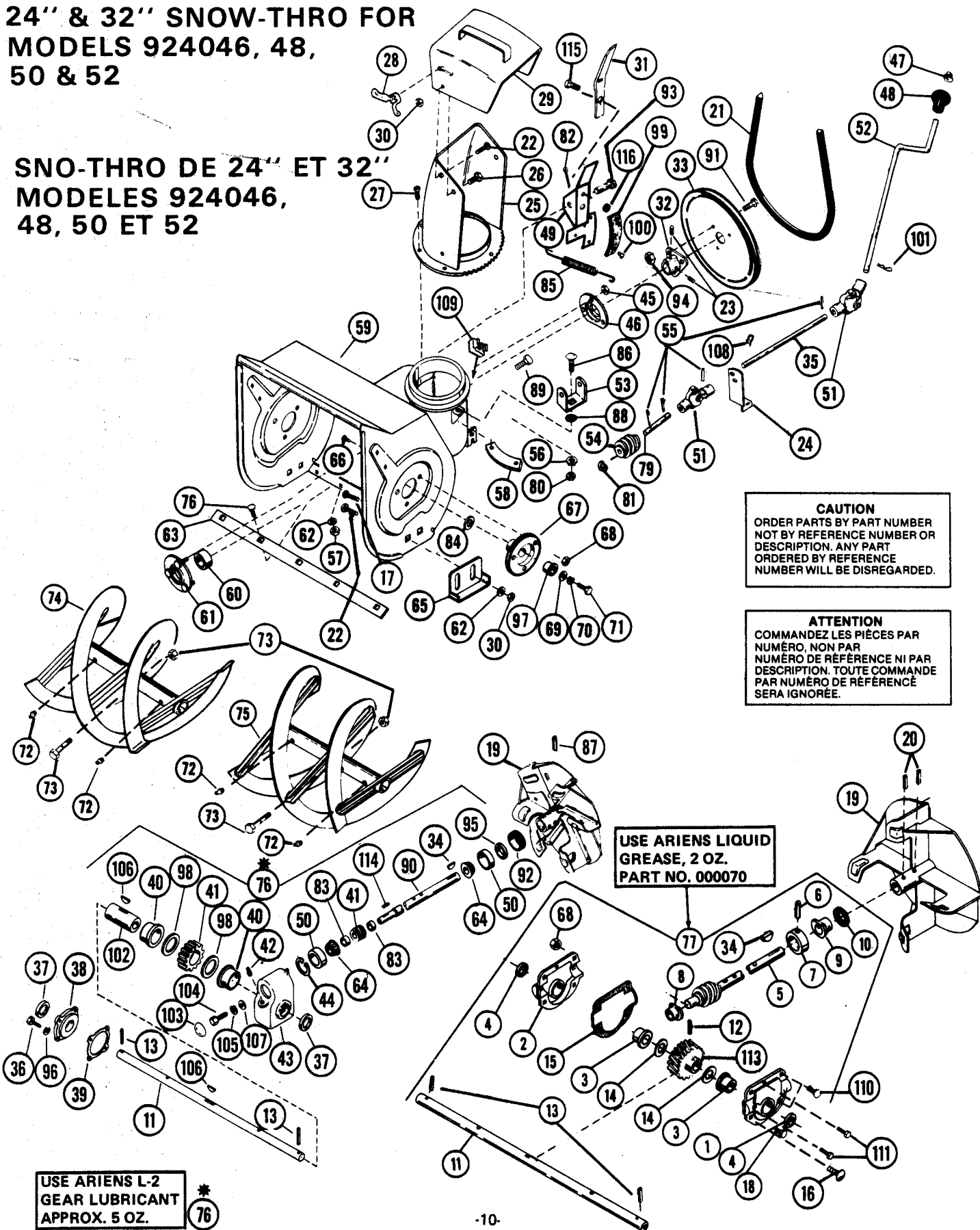

CAUTION
ORDER PARTS BY PART NUMBER
NOT BY REFERENCE NUMBER OR
DESCRIPTION. ANY PART
ORDERED BY REFERENCE
NUMBER WILL BE DISREGARDED.

ATTENTION
COMMANDEZ LES PIÈCES PAR
NUMÉRO, NON PAR
NUMÉRO DE RÉFÉRENCE NI PAR
DESCRIPTION. TOUTE COMMANDE
PAR NUMÉRO DE RÉFÉRENCE
SERA IGNORÉE.

**USE ARIENS LIQUID
GREASE, 2 OZ.
PART NO. 000070**

**USE ARIENS L-2
GEAR LUBRICANT
APPROX. 5 OZ. ***
76

24" & 32" SNOW-THRO FOR MODELS 924046, 48, 50 & 52

SNO-THRO DE 24" ET 32" MODELES 924046, 48, 50 ET 52

No DE REF.	NO DE PIECE STOCK NO.	CODE D'INV CODE	DESCRIPTION	QUANTITE' NO. REQ'D				No DE REF.	NO DE PIECE STOCK NO.	CODE D'INV CODE	DESCRIPTION	QUANTITE' NO. REQ'D			
				924046	924048	924050	924052					924046	924048	924050	924052
1	024379	O	GEARCASE, L.H. Half	1	1	1	-	60	054063	S	RADIAL BEARING	1	1	1	-
2	024380	O	GEARCASE, R.H. Half	1	1	1	-		054052	S	BALL BEARING	-	-	-	1
3	055122	S	FLANGE BUSHING	2	2	2	-	61	003017	S	BEARING FLANGE	1	1	1	-
4	056061	M	SEAL	2	2	2	-		031860	S	BEARING FLANGE	-	-	-	1
5	024382	S	WORM SHAFT & GEAR	1	1	1	-	62	064002	M	WASHER, 5/16 x 7/8 x .083	9	9	9	10
6	058045	M	GROOVE PIN	1	1	1	-	63	010164	M	SCRAPER BLADE	1	1	1	-
7	032103	S	THRUST COLLAR	1	1	1	-		024373	M	SCRAPER BLADE	-	-	-	1
8	055111	S	FLANGED BUSHING	1	1	1	-	64	054045	S	BEARING CONE	-	-	-	2
9	055112	S	FLANGED BUSHING	1	1	1	-	65	010165	M	RUNNER	2	2	2	-
10	056047	M	"O" RING	1	1	1	-		029225	M	RUNNER	-	-	-	2
11	024383	O	RAKE SHAFT	1	1	1	-	66	070058	M	RIBBED NECK BOLT	6	6	6	6
	024065	O	RAKE SHAFT	-	-	-	1	67	024374	S	BEARING SUPPORT	2	2	2	2
12	058069	M	GROOVE PIN	1	1	1	-	68	065056	M	FLANGED WHIZLOCK NUT	10	10	10	6
13	058030	M	ROLLPIN, 3/16 x 1 1/2"	2	2	2	2	69	064047	M	WASHER, .516 x 1.441 x 1/8	2	2	2	2
14	064166	M	WASHER	2	2	2	-	70	063006	M	LOCKWASHER	2	2	2	2
15	032038	M	GASKET	1	1	1	-	71	059024	M	CAP SCREW, 1/2-13 x 1	2	2	2	2
16	062054	M	CARRIAGE BOLT	2	2	2	-	72	022093	M	SPIN DRIVE ZERK FITTING	4	4	4	4
17	062013	M	CARRIAGE BOLT	-	-	-	2	73	510015	F	SHEAR BOLT W/NUT	2	2	2	2
18	070010	M	FLGD WHIZLOCK SCREW	1	1	1	-	74	524039	S	RIGHT RAKE	1	1	1	-
19	024237	O	FAN	1	1	1	-		524013	S	RIGHT RAKE	-	-	-	1
	024376	O	FAN	-	-	-	1	75	524040	S	LEFT RAKE	1	1	1	-
20	058037	M	ROLLPIN, 1/4 x 1-3/4"	2	2	2	-		524014	S	LEFT RAKE	-	-	-	1
21	072108	F	VEE BELT	1	1	-	1	76	524035	S	GEARCASE ASSEMBLY, 32"	-	-	-	1
	072086	F	VEE BELT	-	-	1	-	77	524030	S	GEARCASE ASSEMBLY, 24"	1	1	1	-
22	062010	M	CARRIAGE BOLT, 3/8-16 x 6	6	6	6	4	79	010494	O	WORM SHAFT	1	1	1	1
23	060012	M	SETSCREW	2	2	2	2	80	065015	M	NUT	1	1	1	1
24	024434	O	CHUTE CRANK BRACKET	1	1	1	1	81	010260	M	WAVE WASHER	1	1	1	1
25	024349	O	DISCHARGE CHUTE	1	1	1	-	82	067019	M	HAIR PIN	1	1	1	1
	024403	O	DISCHARGE CHUTE	-	-	-	1	83	002005	M	BEARING SPACER	-	-	-	2
26	059023	M	CAP SCREW, 3/8-16 x 3/4	2	2	2	2	84	064046	M	WASHER, 1.505 x 1.005	2	2	2	2
27	074054	M	TAPTITE	6	6	6	8	85	083164	M	SPRING	1	1	1	1
28	010193	M	WING NUT	1	1	1	1	86	062011	M	CARRIAGE BOLT, 5/16-18 x 1	1	1	1	1
29	510012	S	DEFLECTOR CHUTE	1	1	1	1	87	058015	M	ROLLPIN, 5/16 x 1-3/4	-	-	-	2
30	065039	M	LOCKNUT	6	6	6	6	88	063032	M	LOCKWASHER	1	1	1	1
31	024405	O	BRAKE ARM EXTENSION	-	-	1	-	89	070031	M	FLGD' WHIZLOCK SCREW	2	2	2	2
32	024389	S	PULLEY HUB	1	1	1	1	90	024375	O	WORM SHAFT	-	-	-	1
33	073070	S	SHEAVE	1	1	1	1	91	070060	M	RIBBED NECK BOLT	3	3	3	3
34	066001	M	KEY, Woodruff, 3/16 x 7/8	1	1	1	1	92	024015	O	ADJUSTMENT PLUG	-	-	-	1
35	024346	O	ROD	1	1	1	1	93	024345	M	CLEVIS PIN	1	1	1	1
36	059001	M	CAP SCREW, 1/4-20 x 3/4	-	-	-	4	94	065078	M	FLANGED WHIZLOCK NUT	3	3	3	3
37	056070	M	SEAL	-	-	-	2	95	056061	F	SEAL	-	-	-	1
38	024013	O	GEARCASE COVER	-	-	-	1	96	063017	M	LOCKWASHER	-	-	-	4
39	002008	M	GASKET	-	-	-	1	97	055035	S	FLANGE BUSHING	2	2	2	2
40	055059	M	FLANGED BUSHING	-	-	-	2	98	064087	M	WASHER, 1.825 x 2.5 x .012	-	-	-	2
41	524009	M	WORM AND WORM GEAR	-	-	-	1	99	022178	M	BRAKE LINING	1	1	1	1
42	001138	M	PIPE PLUG	-	-	-	1	100	068062	M	RIVET	2	2	2	2
43	024002	S	GEAR CASE	-	-	-	1	101	067010	M	HAIRPIN COTTER	1	1	1	1
44	057075	M	SNAP RING	-	-	-	1	102	024064	O	GEARCASE SHAFT	-	-	-	1
45	065040	M	LOCKNUT	3	3	3	3	103	004037	S	DUST CAP	-	-	-	1
46	010142	S	BEARING FLANGE	1	1	1	-	104	059022	M	CAP SCREW, 5/16-18 x 3/4	-	-	-	1
	031859	S	BEARING FLANGE	-	-	-	1	105	063003	M	LOCKWASHER	-	-	-	1
47	010198	S	CAP	1	1	1	1	106	066008	M	KEY, Woodruff No. 6	-	-	-	2
48	075083	S	KNOB	1	1	1	1	107	064082	M	WASHER	-	-	-	1
49	624035	M	BRAKE ARM ASSEMBLY	1	1	1	1	108	067010	M	HAIRPIN	1	1	1	1
50	054044	S	BEARING CUP	-	-	-	2	108	067004	M	COTTER PIN	-	-	-	1
51	624065	M	UNIVERSAL JOINT	2	2	2	2	109	070026	M	NUT RETAINER	2	2	2	2
52	024461	S	CHUTE CRANK	1	1	1	1	110	062001	M	CARRIAGE BOLT	2	2	2	2
53	022123	M	WORM CLEVIS	1	1	1	1	111	074027	M	TAPTITE	2	2	2	2
54	024427	S	WORM GEAR, L.H.	1	1	1	1	112	062026	M	CARRIAGE BOLT	5	5	5	6
55	058034	M	ROLLPIN, 1/2 x 3/4	3	3	3	3	113	024381	M	WORM GEAR	1	1	1	-
56	063023	M	LOCKWASHER	1	1	1	1	114	066013	M	KEY, STRAIGHT	-	-	-	1
57	065042	M	LOCKNUT	5	5	5	6	115	059028	M	CAP SCREW	-	-	-	1
58	010438	M	CHUTE CLAMP	3	3	3	4	116	065056	M	WHIZLOCK NUT	-	-	-	1
59	524036	O	BLOWER HOUSING	1	1	-	-								
	524037	O	BLOWER HOUSING	-	-	1	-								
	524038	O	BLOWER HOUSING	-	-	-	1								

SUGGESTED PARTS STOCKING CODE
 F - FAST S - SLOW
 M - MEDIUM O - CUSTOMER ORDER ONLY

CODE SUGGERÉ D'INVENTAIRE DES PIÉCES
 F - FAST (rapide) S - SLOW (lent)
 M - MEDIUM (moyen) O - Commande du client seulement

TRACTOR PARTS FOR MODELS }
 PIÈCES DU TRACTEUR DES MODÈLES }

924046, 924048,
 924050 & 924052

ENGINE SPECIFICATIONS

5 HP. TECUMSEH M50-65422 L
 7 HP. TECUMSEH H70-130210E
 8 HP. TECUMSEH HM80-155128F
 10 HP. TECUMSEH HM100-159024D

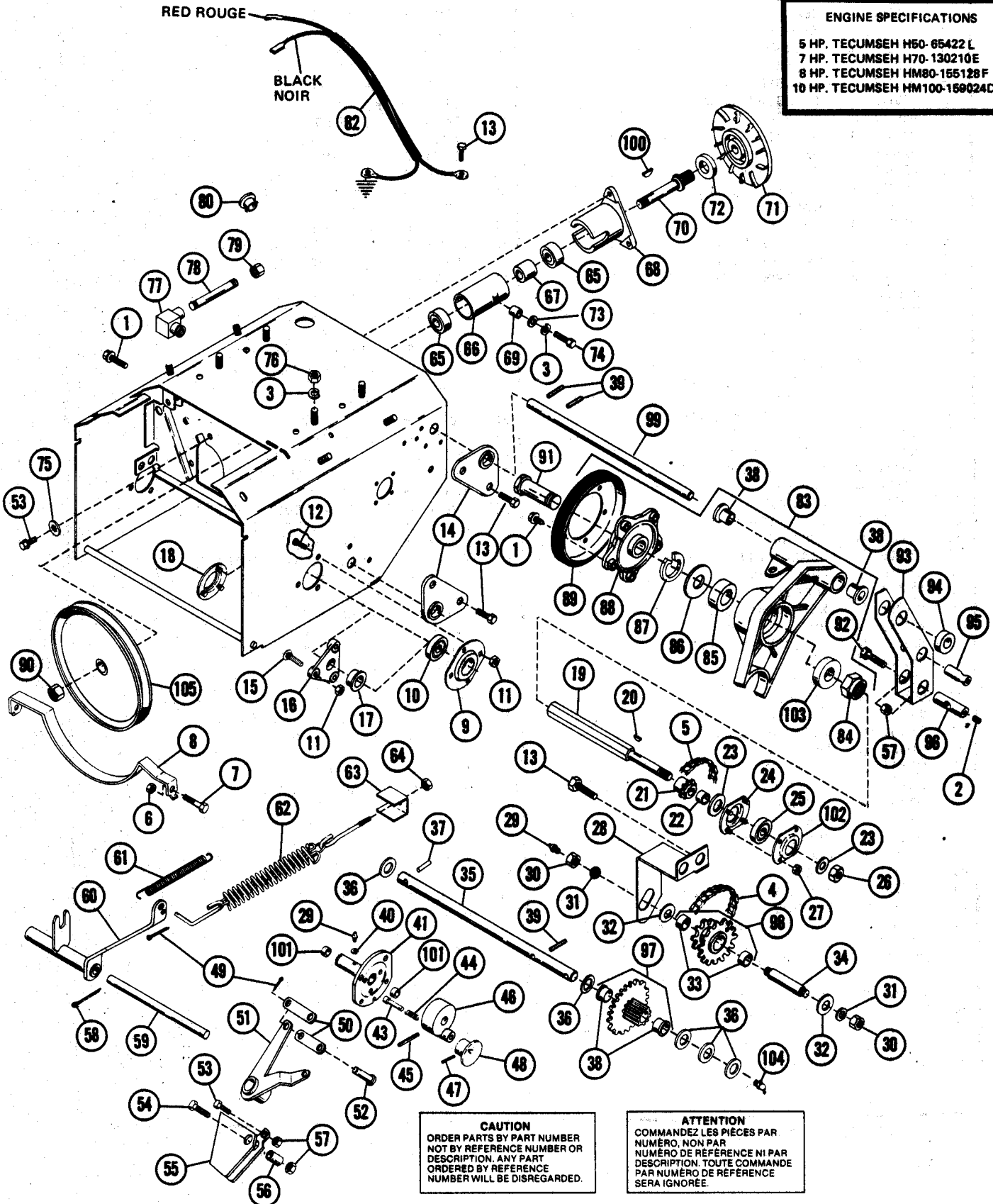

CAUTION
 ORDER PARTS BY PART NUMBER
 NOT BY REFERENCE NUMBER OR
 DESCRIPTION. ANY PART
 ORDERED BY REFERENCE
 NUMBER WILL BE DISREGARDED.

ATTENTION
 COMMANDEZ LES PIÈCES PAR
 NUMÉRO, NON PAR
 NUMÉRO DE RÉFÉRENCE NI PAR
 DESCRIPTION. TOUTE COMMANDE
 PAR NUMÉRO DE RÉFÉRENCE
 SERA IGNORÉE.

**TRACTOR PARTS FOR MODELS
924046, 924048, 924050 & 924052
PIECES DU TRACTEUR DES MODELES
924046, 924048, 924050 & 924052**

NoDE REF.	NO DE CODE PIECE D'INV	DESCRIPTION	QUANTITÉ NO. REQ'D					NoDE REF.	No DE CODE PIECE D'INV.	DESCRIPTION	QUANTITÉ NO. REQ'D												
			924046	924048	924049	924050	924051				924052	924046	924048	924049	924050	924051	924052						
REF. NO.	PART NO.	STOCK CODE						REF. NO.	PART NO.	STOCK CODE													
1	070009	M	FLANGE WHIZLOCK SCREW	8	8	8	8	58	067002	F	COTTER PIN 3/32x1	2	2	2	2								
2	060012	M	SET SCREW	1	1	1	1	59	024089	O	FORK PIVOT ROD	1	1	1	1								
3	063003	M	LOCKWASHER	5	5	5	5	60	024272	O	CLUTCH FORK	1	1	1	1								
4	024074	M	PINION CHAIN	-	-	1	1	61	083094	S	SPRING	1	1	1	1								
5	024073	M	IDLER CHAIN	-	-	1	1	62	624027	S	SPRING ASSEMBLY	1	1	1	1								
	012078	M	IDLER CHAIN	1	1	-	-	63	010542	S	ADAPTER SPACER	1	1	1	1								
6	065040	M	LOCKNUT	2	2	-	2	64	065062	M	LOCKNUT, NYLON	1	1	1	1								
7	059028	M	CAP SCREW 1/4-20x1/2	2	2	-	2	65	054039	M	BEARING, BALL	2	2	2	2								
8	024236	M	BELT FINGER	1	1	-	1	66	022002	S	SPINDLE HOUSING	1	1	1	1								
9	010142	S	BEARING FLANGE	-	2	-	-	67	024155	S	BEARING SPACER	1	1	1	1								
9	024363	S	BEARING RETAINER	-	-	2	2	68	022003	S	DRIVE SPINDLE HOUSING	1	1	1	1								
10	054136	M	BEARING BALL	-	-	2	2	69	003034	M	ROLLER	1	1	1	1								
10	054093	M	BEARING, RADIAL	-	2	-	-	70	024076	S	SPINDLE	1	1	1	1								
11	065056	M	LOCKNUT	6	6	6	8	71	010546	M	DRIVE PLATE	1	1	1	1								
12	070058	F	RIBBED NECK BOLT	-	-	-	8	72	024071	M	DRIVE DISC SPACER	1	1	1	1								
13	070015	F	FLANGE WHIZLOCK SCREW	9	9	9	9	73	084123	F	WASHER, 5/16x11/16x.065	1	1	1	1								
14	024077	M	SHAFT SUPPORT	4	4	4	4	74	059003	M	CAP SCREW 5/16-18x1	1	1	1	1								
15	070011	F	RIBBED NECK BOLT	6	-	6	-	75	063018	M	LOCKWASHER	3	3	3	3								
16	012023	S	BEARING SUPPORT	2	-	-	-	76	065015	F	NUT	4	4	4	4								
17	055039	M	FLANGED BUSHING	2	-	-	-	77	010485	S	STREET ELBOW	-	-	1	1								
18	003017	M	BEARING FLANGE	-	2	-	-	78	012222	M	NIPPLE	-	-	1	1								
19	024338	O	HEX SHAFT	1	1	-	-	79	025208	M	CAP	-	-	1	1								
19	024045	O	HEX SHAFT	-	-	1	1	80	075040	O	BUTTON PLUG	1	1	1	1								
20	066015	M	KEY, WOODRUFF 1/8x5/8	1	1	1	1	81	075050	M	SNAP BUSHING	1	1	1	1								
21	010276	S	9 TOOTH SPROCKET	1	1	1	1	82	022161	O	SHORTING WIRE	1	1	1	1								
22	025089	S	ROLLER	1	1	-	-	83	624022	O	CARRIER	1	1	1	1								
23	064058	M	WASHER .500/.505x1x.062	2	2	2	2	84	65086	M	LOCKNUT	1	1	1	1								
24	003085	S	BEARING FLANGE	1	1	1	1	85	054093	M	BEARING, RADIAL	1	1	1	1								
25	054080	S	BEARING, RADIAL	1	1	1	1	86	064071	M	WASHER	1	1	1	1								
26	065054	M	LOCKNUT	1	1	1	1	87	057021	M	SNAP RING' INTERNAL	1	1	1	1								
27	065094	F	LOCKNUT	4	4	4	4	88	024454	S	DISC HOB	1	1	1	1								
28	024366	S	SHAFT SUPPORT	-	-	1	1	89	003003	F	FRICTION DISC	1	1	1	1								
28	024339	S	CLUTCH STOP	1	1	1	1	90	065077	M	LOCKNUT	1	1	1	1								
29	022093	M	SPIN DRIVE ZERK FITTING	-	2	2	2	91	024455	S	SPINDLE HUB	1	1	1	1								
30	065018	F	NUT	-	-	2	2	92	059022	M	CAP SCREW, 5/16-18 x 3/4	1	1	1	1								
31	063014	M	LOCKWASHER	-	-	2	2	93	024228	O	CLUTCH ENGAGEMENT YOKE	1	1	1	1								
32	064093	F	WASHER .380/.385x3/16x.062	-	-	2	2	94	024086	S	SPACER	1	1	1	1								
33	055040	M	BUSHING	-	-	2	2	95	024227	S	ADAPTER	1	1	1	1								
34	024364	S	REDUCTION SHAFT	-	-	1	1	96	022135	S	ROD ADAPTER	1	1	1	1								
35	024367	S	PINION SHAFT	1	1	1	1	97	524002	O	PINION & SPROCKET	1	1	-	-								
36	064039	M	WASHER .625/.835x.005x.062	5	5	5	5	97	524032	O	PINION & SPROCKET	-	-	1	1								
37	058009	F	ROLL PIN	1	1	1	1	98	624072	O	SPROCKET ASSEMBLY	-	-	1	1								
38	055026	M	FLANGED BUSHING	4	4	4	4	99	024081	S	CARRIER SHAFT	1	1	1	1								
39	058029	F	ROLL PIN	3	3	3	3	100	066006	M	WOODRUFF KEY	1	1	1	1								
40	063025	F	LOCKWASHER	-	1	1	1	101	065057	M	BUSHING	-	-	1	1								
41	810938	O	AXLE ASSEMBLY L.H.	-	1	-	-	101	055029	M	BUSHING	-	2	-	-								
41	624074	O	AXLE L.H.	-	-	-	1	102	024141	M	BEARING FLANGE	1	1	1	1								
41	624083	O	AXLE ASSEMBLY L.H.	-	-	1	-	103	055126	M	SPACER	1	1	1	1								
42	055029	M	SLEEVE BUSHING	-	2	1	1	104	013136	M	ZERK FITTING	1	1	1	1								
43	010374	S	PIN	-	1	1	1	105	073049	M	PULLY	1	1	1	1								
44	083007	S	SPRING	-	1	1	1																
45	058042	M	GROOVE PIN	-	1	1	1																
46	010372	F	LOCKNUT, HOB	-	1	1	1																
47	058032	F	ROLL PIN 3/32x1	-	1	1	1																
48	010375	S	KNOB	-	1	1	1																
49	067001	F	COTTER PIN	3	3	3	3																
50	024233	S	SHIFT LINK	2	2	2	2																
51	024232	S	LEVER SHIFT ARM	1	1	1	1																
52	012151	S	CLEVIS PIN	2	2	2	2																
53	059039	M	CAP SCREW 5/16-18x1/2	4	4	4	4																
54	059136	M	CAP SCREW 5/16-18x3	1	1	1	1																
55	024231	O	BRACKET SHIFT LEVER	1	1	1	1																
56	024115	S	SPACER	1	1	1	1																
57	065042	F	LOCKNUT	3	3	3	3																

SUGGESTED PARTS STOCKING CODE
 F - FAST S - SLOW
 M - MEDIUM O - CUSTOMER ORDER ONLY

CODE SUGGERÉ D'INVENTAIRE DES PIÈCES
 F - FAST (rapide) S - SLOW (lent)
 M - MEDIUM (moyen) O - Commande du client seulement

**TRACTOR PARTS FOR MODELS }
PIÈCES DU TRACTEUR DES MODÈLES }**

**924046, 924048,
924050 & 924052**

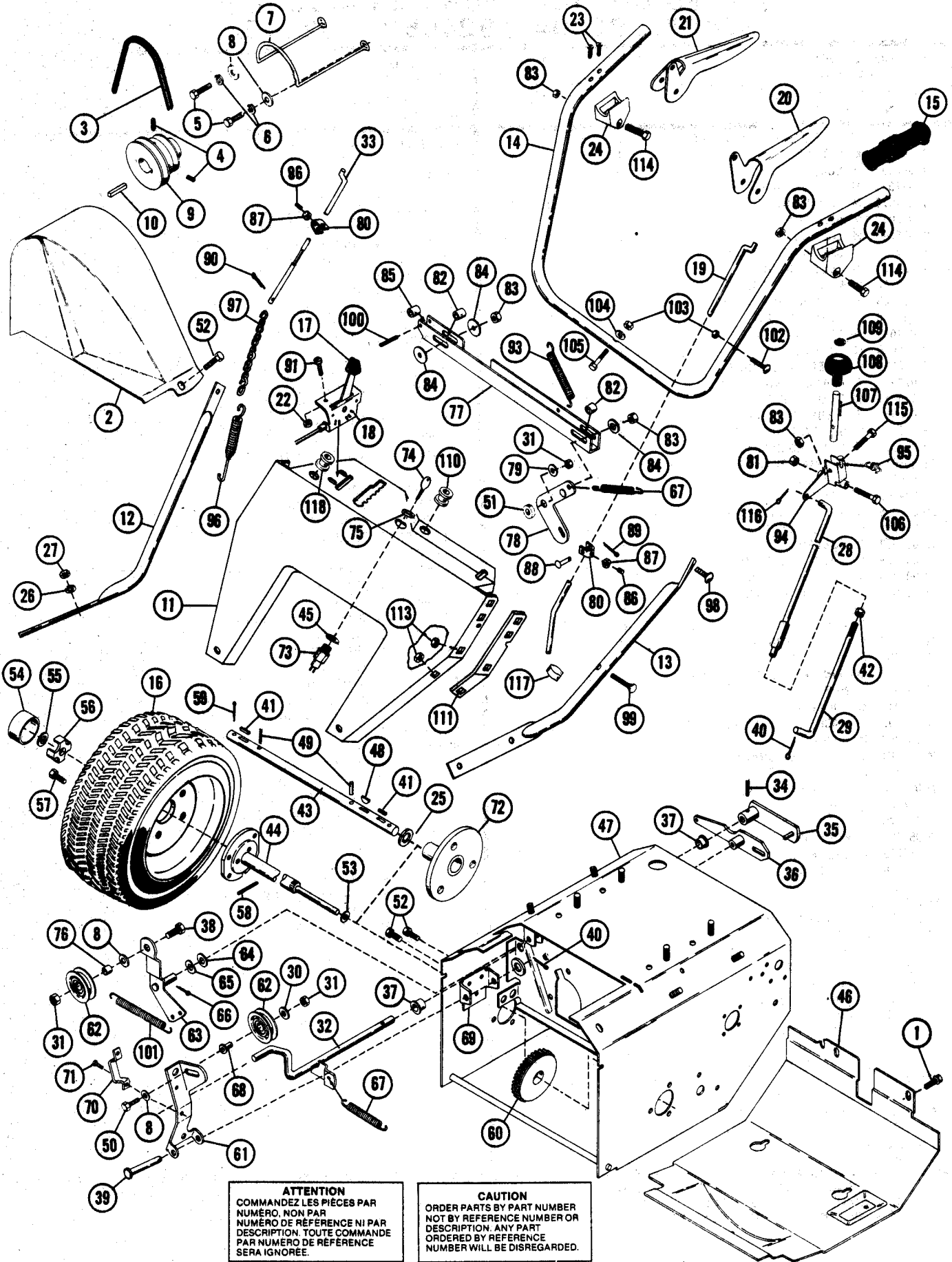

ATTENTION
COMMANDEZ LES PIÈCES PAR
NUMÉRO, NON PAR
NUMÉRO DE RÉFÉRENCE NI PAR
DESCRIPTION. TOUTE COMMANDE
PAR NUMÉRO DE RÉFÉRENCE
SERA IGNORÉE.

CAUTION
ORDER PARTS BY PART NUMBER
NOT BY REFERENCE NUMBER OR
DESCRIPTION. ANY PART
ORDERED BY REFERENCE
NUMBER WILL BE DISREGARDED.

TRACTOR PARTS FOR MODELS 924046, 924048, 924050 & 924052 PIECES DU TRACTEUR DES MODELES 924046, 924048, 924050 & 924052

No DE REF.	No DE CODE PIECE D'INV. PART STOCK NO.	CODE	DESCRIPTION	QUANTITE NO. REQ'D				No DE REF.	No DE CODE PIECE D'INV. PART STOCK NO.	CODE	DESCRIPTION	QUANTITE NO. REQ'D			
				924046	924048	924050	924052					924046	924048	924050	924052
1	070009	M	FLANGE WHIZLOCK SCREW	4	4	4	4	56	003376	S	SPINDLE CUP	2	1	1	1
2	024406	F	BELT COVER	1	1	1	1	57	070032	S	WHEEL BOLT	6	6	8	8
3	072098	F	V BELT	1	1	1	1	58	058003	M	ROLL PIN, 3/16 x 1-1/4	1	1	1	1
3	072066	F	V BELT	1	1	1	1	58	058030	M	ROLL PIN, 3/16 x 1-1/2	1	1	1	1
4	060012	M	SETSCREW	2	2	2	2	59	067014	M	COTTER PIN	2	2	2	2
5	059053	M	CAP SCREW, 5/16-24 x 3/4"	2	2	2	2	60	612999	S	DIFFERENTIAL ASSEMBLY	1	1	1	1
6	063032	M	LOCKWASHER	2	2	2	2	60	624073	S	DIFFERENTIAL ASSEMBLY	1	1	1	1
7	024253	M	BELT FINGER	1	1	1	1	60	010211	S	SPUR GEAR	1	1	1	1
8	064002	M	WASHER, 5/16 x 7/8 x .083	4	4	4	4	61	024348	S	IDLER ARM	1	1	1	1
9	024021	S	ENGINE SHEAVE	1	1	1	1	62	012132	S	IDLER	2	2	2	2
9	024357	S	ENGINE SHEAVE	1	1	1	1	63	024222	S	IDLER ARM	1	1	1	1
10	066018	M	KEY, Straight 1/4 x 1/4 x 1-3/4	1	1	1	1	64	064052	M	WASHER, .380/.385 x 13/16 x 24	1	1	1	1
11	024435	O	HANDLEBAR PANEL	1	1	1	1	65	010260	S	WAVE WASHER	1	1	1	1
12	024447	M	LOWER HANDLEBAR, R.H.	1	1	1	1	66	067004	F	COTTER PIN	2	2	2	2
13	024448	M	LOWER HANDLEBAR, L.H.	1	1	1	1	67	063187	S	SPRING	1	1	1	1
14	024432	M	UPPER HANDLEBAR	1	1	1	1	68	012131	S	BEARING SPACER	1	1	1	1
14	024431	M	UPPER HANDLEBAR	1	1	1	1	69	024347	O	BRACKET	1	1	1	1
15	075006	M	GRIP	2	2	2	2	70	024353	M	RETURN CLIP	1	1	1	1
16	610660	S	TIRE & WHEEL ASSEMBLY	2	2	2	2	71	074054	F	TAPTITE	2	2	2	2
			Consists Of					72	024323	M	WHEEL HUB	2	2	2	2
		M	071046 TIRE	2	2	2	2	73	624067	M	KEY SWITCH	1	1	1	1
		M	071050 TUBE	2	2	2	2	74	013157	S	IGNITION KEY	1	1	1	1
		S	071062 RIM	2	2	2	2	75	065076	M	NUT	1	1	1	1
16	603002	S	WHEEL ASSEMBLY	2	2	2	2	76	011031	S	SPACER	1	1	1	1
		M	071082 TIRE	2	2	2	2	77	024459	O	SLIDER	1	1	1	1
		M	071037 TUBE, Available	2	2	2	2	78	024460	O	BELL CRANK	1	1	1	1
		S	071076 RIM	2	2	2	2	79	064090	M	WASHER	1	1	1	1
16	603948	S	TERRA TIRE & WHEEL ASSEMBLY	2	2	2	2	80	024457	S	CLEVIS	2	2	2	2
		M	071021 TURV SAVER TIRE	2	2	2	2	81	065042	M	LOCKNUT	2	2	2	2
		M	071087 TUBE AVAILABLE	2	2	2	2	82	055132	S	SLEEVE BUSHING	2	2	2	2
		S	071077 RIM	2	2	2	2	83	065040	M	LOCKNUT	6	6	6	6
17	075019	M	KNOB	1	1	1	1	84	064037	M	WASHER	3	3	3	3
18	069105	F	THROTTLE CONTROL	1	1	1	1	85	055131	S	SLEEVE BUSHING	1	1	1	1
18	069124	F	THROTTLE CONTROL	1	1	1	1	86	060036	M	SETSCREW	2	2	2	2
19	024444	M	CLUTCH ROD, Tractor	1	1	1	1	87	065099	M	NUT	2	2	2	2
19	024433	M	CLUTCH ROD, Tractor	1	1	1	1	88	024458	M	CLEVIS PIN	1	1	1	1
20	532007	M	CLUTCH HANDLE, Tractor	1	1	1	1	89	067019	M	HAIR PIN	1	1	1	1
21	532008	M	CLUTCH HANDLE, Attachment	1	1	1	1	90	067018	M	COTTER PIN	1	1	1	1
22	065051	M	KEPS NUT	2	2	2	2	91	061057	M	MACHINE SCREW, 10-24 x 1/2	2	2	2	2
23	074039	S	TAPPING SCREW	4	4	4	4	93	063149	M	SPRING	1	1	1	1
24	022129	S	HANDLE PIVOT	2	2	2	2	94	024443	S	PIVOT	1	1	1	1
25	064033	M	WASHER, 7/64, 7/64 x 1.375 x .125	1	1	1	1	95	063184	M	SPRING	1	1	1	1
26	063004	F	LOCKWASHER	4	4	4	4	96	063183	M	CLUTCH SPRING	1	1	1	1
27	065018	F	NUT	4	4	4	4	97	002270	M	CLUTCH CHAIN	1	1	1	1
28	024442	S	SHIFT ROD UPPER	1	1	1	1	98	062061	M	CARRIAGE BOLT, 5/16-18 x 5/8	2	2	2	2
29	024441	S	SHIFT ROD LOWER	1	1	1	1	99	062062	M	CARRIAGE BOLT, 5/16-18 x 1 1/2	2	2	2	2
30	064007	F	WASHER, 1/4 x 47/64 x .065	1	1	1	1	100	058005	M	ROLL PIN, 3/16 x 7/8	1	1	1	1
31	065042	F	LOCKNUT	3	3	3	3	101	063094	M	SPRING	1	1	1	1
32	024428	O	ACTIVATING SHAFT	1	1	1	1	102	062060	M	CARRIAGE BOLT, 1/4-20 x 1 1/2	4	4	4	4
33	024456	S	CLUTCH ROD ATTACHMENT	1	1	1	1	103	065058	M	FLANGE WHIZLOCK NUT	5	5	5	5
34	058026	F	ROLL PIN	1	1	1	1	104	064094	M	WASHER	1	1	1	1
35	032010	S	LEVER	1	1	1	1	105	059150	M	CAP SCREW, 1/4-20 x 1 1/2 Grade 5	1	1	1	1
36	024429	S	LEVER	1	1	1	1	106	059131	M	CAP SCREW	1	1	1	1
37	055037	M	FLANGED BUSHING	2	2	2	2	107	024448	M	ROD	1	1	1	1
38	059003	M	CAP SCREW, 5/16-18 x 1	1	1	1	1	108	075096	M	KNOB	1	1	1	1
39	024354	F	CLEVIS PIN	1	1	1	1	109	057086	M	SNAP RING	1	1	1	1
40	067001	F	COTTER PIN	2	2	2	2	110	075095	M	SNAP BUSHING	1	1	1	1
41	066011	M	KEY, Feather 3/16 x 3/16 x 1-1/4	2	2	2	2	111	024468	M	STIFFENER, R.H.	1	1	1	1
42	065031	M	NUT	1	1	1	1	111	024467	M	STIFFENER, L.H.	1	1	1	1
43	024322	M	AXLE SHAFT	1	1	1	1	113	065078	M	FLANGE WHIZLOCK NUT	4	4	4	4
44	010370	M	AXLE, R.H.	1	1	1	1	114	059050	M	CAP SCREW, 1/4-20 x 1 1/2	2	2	2	2
44	024371	M	AXLE, R.H.	1	1	1	1	115	059132	M	CAP SCREW, 1/4-20 x 1"	1	1	1	1
44	024409	M	AXLE ASSEMBLY, R.H.	1	1	1	1	116	067024	M	COTTER PIN	1	1	1	1
45	063019	O	LOCKWASHER	1	1	1	1	117	069012	M	CLAMP	1	1	1	1
46	024430	O	BOTTOM COVER	1	1	1	1	118	075060	M	SNAP BUSHING	1	1	1	1
47	024437	O	FRAME	1	1	1	1								
47	024436	O	FRAME	1	1	1	1								
48	066012	M	KEY, Woodruff 1/4 x 3/4	1	1	1	1								
49	058003	M	ROLL PIN, 3/16 x 1-1/4	2	2	2	2								
50	059069	M	CAP SCREW, 5/16-18 x 1-1/4	1	1	1	1								
51	010358	S	SPACER	1	1	1	1								
52	070015	F	FLANGE WHIZLOCK SCREW	5	5	5	5								
53	064036	F	WASHER, .875/.885 x 1.385 x .062	1	1	1	1								
53	064170	F	WASHER, .875/.885 x 1.385 x .062	2	2	2	2								
54	003377	O	HUB CAP	2	2	2	2								
55	010366	S	PUSHNUT	1	1	1	1								

NOTE: FOR DECALS SEE PAGES 2 & 3
NOTE: DECALQUES (voir p. 2 & 3)

SUGGESTED PARTS STOCKING CODE
F - FAST S - SLOW
M - MEDIUM O - CUSTOMER ORDER ONLY

CODE SUGGERE D'INVENTAIRE DES PIECES
F - FAST (rapide) S - SLOW (lent)
M - MEDIUM (moyen) O - Commande du client seulement

DEALER SET UP AND PRE-SERVICE

1. GENERAL

All hardware and parts required for assembly are shipped in the parts bag or are located, in place, on the machine. The upper handlebars and panel are assembled at the factory with the two clutch rods and interlock system in place and adjusted. The lower handlebars must be installed. The snow head and tractor are shipped assembled with lower shift rod in place. Attachment clutch rod is in place on handle panel assembly.

Model 924052 (the 32" snow head) is shipped with the runners and discharge chute detached and they will have to be installed.

2. HANDLEBAR

Install the lower handlebars on the frame using the studs and hardware in place on the frame. (Leave the hardware loose on the studs until the upper handlebars are installed). Be sure to install the chute crank bracket on the left rear stud on top of the handlebar.

Install the upper handlebar and panel on the lower handlebars. Use a flat washer on the outside of each cap screw. Use a 5/8" carriage bolt and locknut in each of the top holes, and an 1 1/2" carriage bolt and locknut in each of the lower holes. With everything in place, tighten all handlebar hardware.

3. THROTTLE CONTROL

Route throttle control under handlebar and insert into position in handlebar panel. See Figure 16. Secure with two machine screws # (10-24x1/2) and two keps nuts from parts bag. Install knob on throttle lever.

4. SHIFT CONTROL ROD

Remove the upper shift rod from the shift lever and place the shift lever in REVERSE position. Pull up on the lower shift rod which is already installed in the frame. Hold the lower shift rod up while screwing the upper rod in place. Turn the upper rod into the lower until the end of the upper rod lines up with the hole in the shift handle. Install the upper rod in the shift handle and tighten the locknut joining the upper and lower shift rods.

5. ATTACHMENT CLUTCH ROD

The attachment clutch rod is installed in the upper handlebars but the chain must be hooked to the spring already in place on the clutch bell crank. Connect the spring to a link in the chain that will keep the chain snug without pulling up on the bell crank. The clutch idler pulley must tighten up on the belt when the handle is down and must fall away from the belt when the handle is upright. Adjust chain as required.

6. DRIVE WHEEL CLUTCH ADJUSTMENT

- The clutch handle is already positioned on the handlebar and the tractor clutch rod is in place in the handle. Check to be sure the clutch handle is free to fall down on the grip.
- Insert the lower end of the tractor clutch rod into the rod adapter.

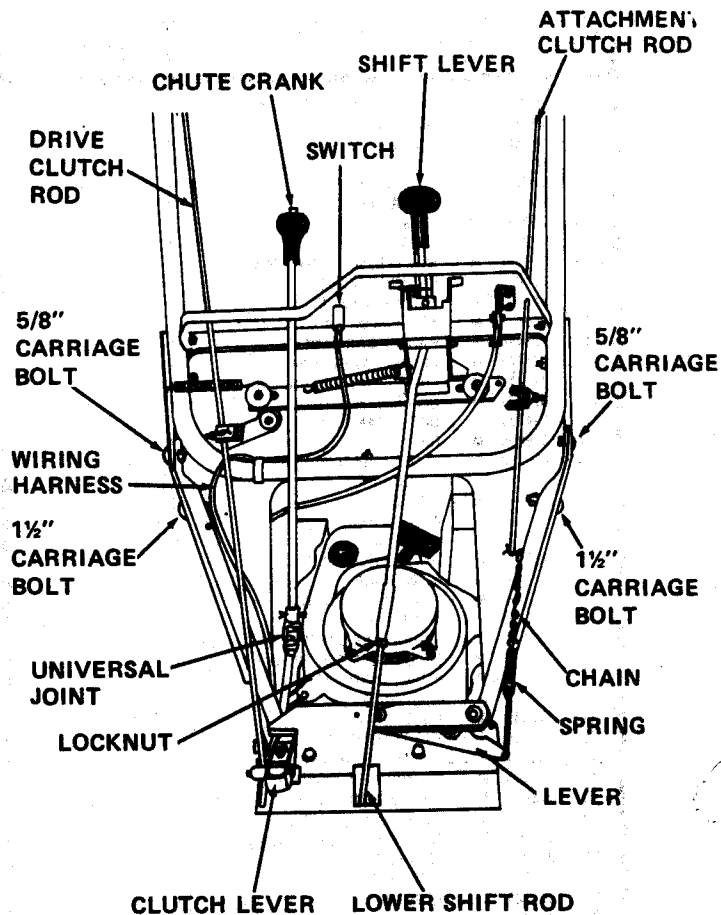

FIGURE 16

- Position the clutch handle so that it is all the way up. See Figure 17. Tighten the tractor clutch rod in the rod adapter with the setscrew. With handle down, clutch lever should come within 1/16" of top of slot in frame. Adjust as required. See Figure 8 of owners section.

7. KEY SWITCH CONNECTION

The key switch is factory installed in the handlebar panel and the wiring is connected to the engine. Route the wiring harness up the inside of the panel, alongside the lower handlebar. Connect wire harness to switch. See Figure 16.

TIP HANDLE FORWARD
AS FAR AS POSSIBLE

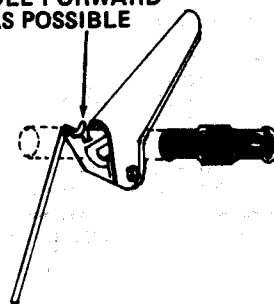

FIGURE 17

8. DISCHARGE CHUTE (MODEL 924052 ONLY)

The discharge chute is shipped with the four mounting clips attached to the chute. Remove the clips and hardware. Position the discharge chute on the blower housing. Secure with the clips and hardware. Be sure the chute rotates freely.

9. DEFLECTOR

The deflector is installed on the discharge chute but must be raised into operating position. Remove the carriage bolt and wing nut. Rotate deflector up into operating position. Reinstall the carriage bolt and wing nut.

10. CHUTE CRANK

The chute crank is packed separately in the carton. The intermediate shaft, universal joints and chute crank bracket are in place on the machine. The chute crank bracket should be installed on the rear, left hand stud at the time the handlebars are installed. Insert the chute crank down into the hole in the handlebar panel and connect to the universal joint on the intermediate shaft with the hairpin cotter provided. On all models, after completing the chute crank connection, check the alignment of worm and chute by rotating the discharge chute through its full travel. Chute should rotate easily, if not, reposition worm as required.

11. RUNNERS— ON MODEL 924052 ONLY

Install runners on each side of the blower housing. Use longer carriage bolts (62013) in the rear holes, shorter carriage bolts (62010) in the front holes. Use a washer (64002) and locknut (65039) on each bolt outside the housing. Adjust the runners to equal height on each side. See paragraph on page 5 for proper adjustment.

12. ENGINE

Before starting the engine, fill the crankcase with Ariens Sno-Thro oil 5W-20 for snow blower operation below 40 degrees F. Use Ariens Gard-N-Yard oil 10W-30 for operation at temperatures above 40 degrees F.

13. BLOWER GEAR CASE

On 32" Models 924052, and 824008. Check the oil level in the auger gear case. Oil level must be even with the oil filler hole. Fill with Ariens Special L-2 Gear Lubricant. Replace the filler plug.

On 24" Models 924046, 924048, 924050, 824006 and 824007. The blower gear case is factory lubricated and should require no lubrication by the dealer. Full instructions for checking are given in the LUBRICATION section of the manual.

14. TIRE PRESSURE

Tires have been over inflated for shipping purposes. For operation, reduce tire pressure to 12 to 20 PSI. If tire chains are used, a pressure of 20 PSI is recommended for proper operation.

15. MECHANICAL INTERLOCK

Check for proper operation of mechanical interlock. Adjust slider hardware if necessary to assure free operation. See page 5 for proper operation of mechanical interlock.

16. BELT ADJUSTMENT

Check the position of the belt fingers on the engine sheave and the alignment of the sheaves. Adjust as shown in Figure 10 and as described in REPLACEMENT OF TRACTOR DRIVE BELT on page 6.

17. DRIVE CHAIN ADJUSTMENT

If Models 924050 or 924052 Sno-Thro are difficult to push because of tight or interfering drive chains, re-adjust as described in DRIVE CHAIN ADJUSTMENT on Page 7.

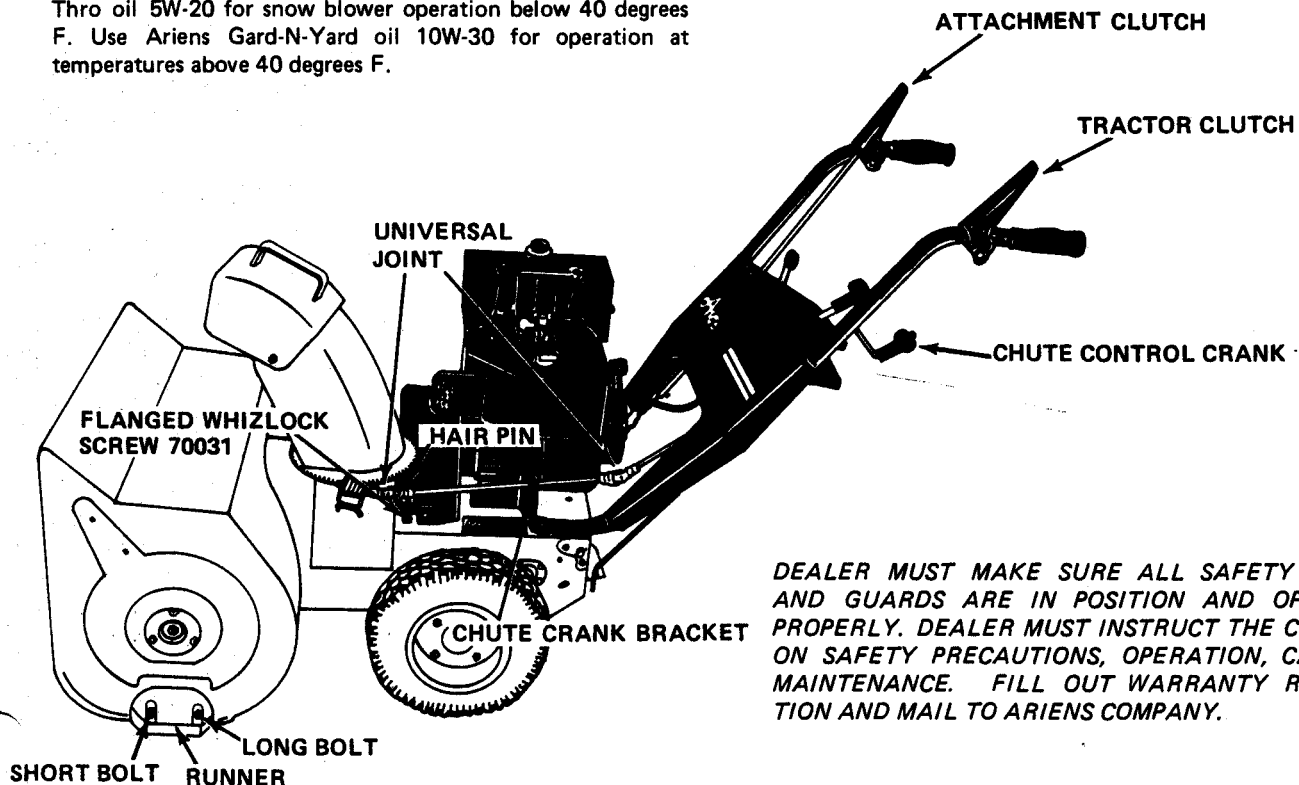

DEALER MUST MAKE SURE ALL SAFETY DEVICES AND GUARDS ARE IN POSITION AND OPERATING PROPERLY. DEALER MUST INSTRUCT THE CUSTOMER ON SAFETY PRECAUTIONS, OPERATION, CARE AND MAINTENANCE. FILL OUT WARRANTY REGISTRATION AND MAIL TO ARIENS COMPANY.

FIGURE 18