

MULTI-PURPOSE WORK BENCH ASSEMBLY INSTRUCTIONS

#92558

	DESCRIPTION	ORDER PART #	QTY
A	M10 X 55MM BOLT		3
B	M6 X 50MM BOLT		6
C	M6 X 16MM BOLT		16
D	M6 NUT		12
E	6MM WASHER		6
F	10MM WASHER		5
G	12MM WASHER		4
H	10MM END CLIP		2
I	12MM END CLIP		4
J	10MM PVC COVER		2
K	12MM PVC COVER		2
L	M6 PVC NUT COVER		4
M	WHEEL AXLE	WB0001	1

	DESCRIPTION	ORDER PART #	QTY
N	LARGE WHEEL	WB0002	2
O	WHEEL COVER	WB0003	4
P	AXLE SLEEVE	WB0004	3
Q	RIGHT SUPPORT FRAME	WB0005	1
R	LEFT SUPPORT FRAME	WB0006	1
S	CUSHION HANDLE GRIP	WB0007	1
T	CASTERS	WB0008	2
U	FRONT SUPPORT BAR	WB0009	1
V	REAR SUPPORT BAR	WB0010	1
W	MIDDLE SUPPORT FRAME	WB0011	1
X	FRONT PANEL	WB0012	1
Y	COILED SHELF	WB0013	1
Z	SINK TOP BASIN	WB0014	1

	DESCRIPTION	ORDER PART #	QTY
AA	DRAIN PLUG	WB0015	1
BB	DOWEL RODS	WB0016	3
CC	REAR FAUCET PANEL	WB0017	1
DD	FOLDING COUNTER	WB0018	1
EE	AXLE FOR FOLDING COUNTER	WB0019	1
FF	DRAWER	WB0020	1
GG	BOTTOM TRAY	WB0021	2
HH	"S" HOOKS	WB0022	6
II	FAUCET	WB0023	1
JJ	FOLDING COUNTER HINGE	WB0024	2

TOOLS REQUIRED FOR ASSEMBLY

Hex Wrench
Hex Bolt Driver

STEP 1

Identify all parts packed in carton against the parts list. Remove all protective on a non-abrasive surface to avoid scratching. If you are missing any parts or proceed with assembly, call our Customer Service Center at 1-800-416-3511 (EST). Do not attempt assembly if any parts are missing or damaged.

Read entire assembly instructions before beginning assembly.

STEP 2 WHEEL ASSEMBLY

Insert wheel axle (M) through bottom shaft of right side support frame (Q) so that it is centered inside the shaft with equal amount of axle on each side. Snap 12mm end clip (I) on notch in axle closest to the right side support frame (Q). Add the following parts to the axle in this order: 12mm washer (G), wheel cover (O), axle sleeve (P), wheel (N), wheel cover (O), 12mm washer (G), 12mm end clip (I) as shown in *figure 1*. Be sure the wheel is inserted over the axle sleeve in a manner that allows it to rotate freely. Secure the wheel assembly on the axle with the 12mm washer clip (I). Repeat procedure for opposite side wheel.

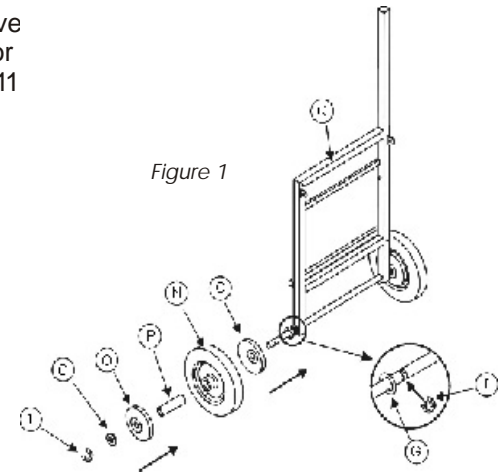

STEP 3 LEFT SIDE SUPPORT FRAME ASSEMBLY

Screw in the two casters (T) into the bottom of the left side support frame (R) as shown in *figure 2*. Add the cushion handle grip (S) to the left side support frame (R) as shown in *figure 2*. Insert two M6 x 50mm bolts (B) through end of cushion grip handle and through the holes in the left side support frame. Add a 6mm washer (E), 6mm nut (D). Tighten with wrench. Do not over tighten. Add M6 PVC cover to the end of each nut. Repeat on opposite side of cushion grip handle.

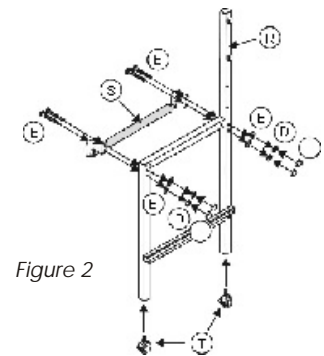

STEP 4 FRAME ASSEMBLY

Connect right side support frame (Q) and left side support frame (R) using the rear support bar (V). Be sure that the hole in the center of the rear support bar is facing up. Add a 10mm washer (F) to a M10 x 55 mm bolt (A) and insert through the left side frame support(r) into the fixed nuts in the rear support bar (V) as shown in *figure 3*. Repeat for opposite side. (Q). Attach front support bar to middle support frame as shown in *figure 3* using a M6 x 16mm bolt. Tighten with wrench. Do not over tighten. With bottom of rear portion of middle support frame resting on the rear support bar, attach front support bar to right side support frame (with wheels) using M6x 16mm bolt (C) as shown in *figure 3*. Tighten with wrench. Do not over tighten. Attach middle support frame (W) to the rear support bar (V). Align middle support bar with hole in rear support bar as shown in figure 4. Add a 10mm washer (F) to an M10 x 55mm bolt (A). Insert bolt through middle support frame and into the fixed nut inside the rear support bar.

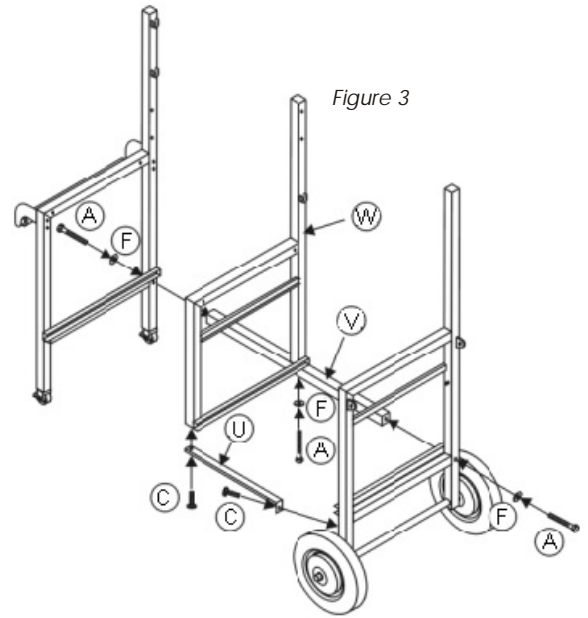

STEP 5 COILED SHELF ASSEMBLY

Attach coiled shelf (Y) to right side support frame (Q) and middle support frame (W) using M6 x 16 bolts (C) as shown in *figure 4*. Position coiled shelf between the right side and middle support frames so that coiled portion of the panel is facing towards the bottom. Insert bolts through the holes from behind the coiled shelf and into the fixed nuts inside the right side and middle support frames. Use hex wrench to tighten completely. Do not over tighten. Attach front panel to left side and middle support panels as shown if *figure 4* using M6 x 16mm bolts (C). Insert bolts through holes from behind the front panel into the fixed nuts in the front portion of the left side and middle support frames. Tighten using hex wrench. Do not over tighten.

Figure 4

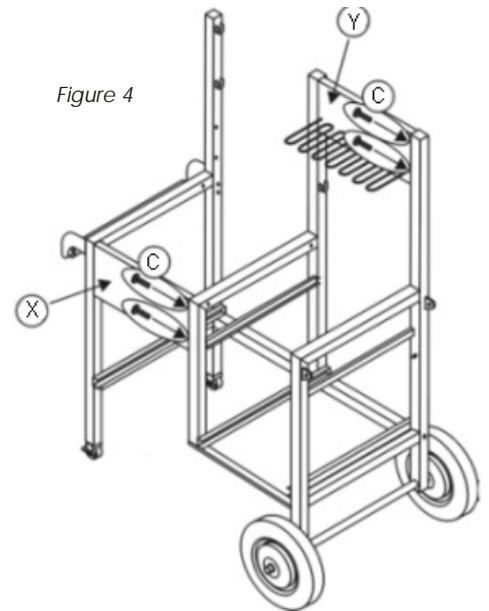

STEP 6 SINK ASSEMBLY

Install sink drain/stopper assembly (AA) as shown in *figure 5*. Separate the three pieces and insert the center gasket into the whole in the sink basin. Insert the funnel-shaped portion into the sink drain as shown. From underneath the sink basin, attach the bottom portion of the sink drain/stopper assembly onto the bottom portion of the funnel shaped piece to hold firmly in place.

Figure 5

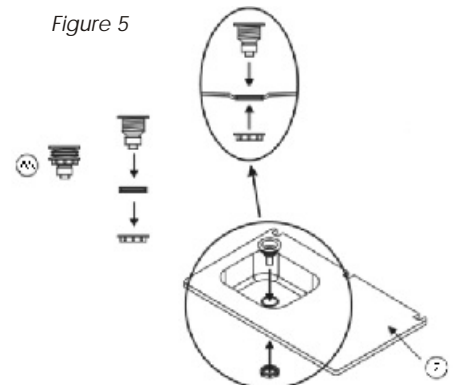

STEP 6 SINK ASSEMBLY (continued)

Position the sink top assembly (Z) over the left side, right side and middle support frames, making sure the holes for the bolts are properly aligned. Once in proper position, use M6 x 16mm bolts (C) to attach sink top/basin assembly to the left support frame. Insert bolts through holes in sink top into the fixed nuts in the left side support frame. Repeat procedure for right side support frame. Insert M6 x 50mm bolts (B) through the holes in the middle portion of the sink top/basin assembly through the holes in the middle support frame. Be sure to insert the bolts in the direction towards the right side support frame as shown in *figure 6*. Add a 6mm washer (E) and an m6 nut to the end of each bolt. Tighten with wrench. Do not over tighten.

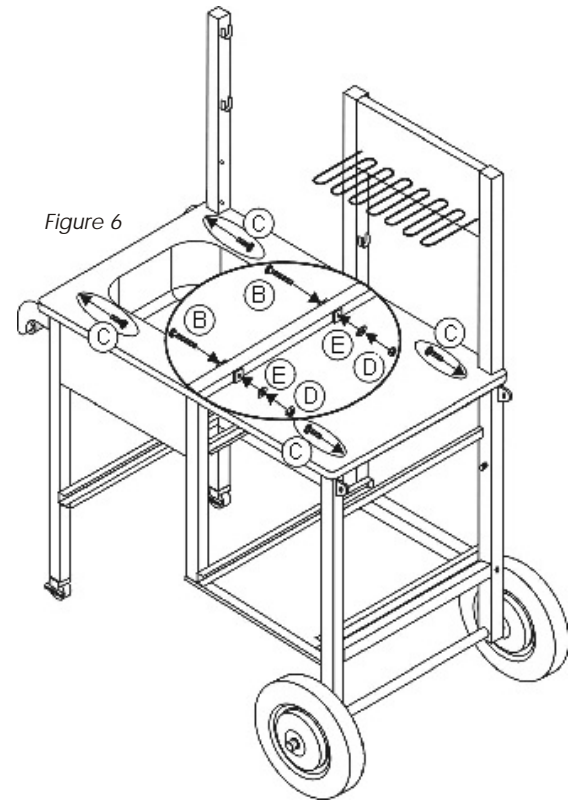

STEP 7 FAUCET AND FOLDING COUNTER ASSEMBLY

Attach rear faucet panel (CC) to left side support frame and middle support frame using M6 x 16mm bolts (C). Insert bolts outwards through holes from behind the rear faucet panel and into the fixed nuts in the middle support frame. Repeat procedure for opposite side. Tighten bolts using hex wrench. Tighten completely. Do not over tighten.

Attach the three dowels rods (BB) by snapping into place as shown. Two on left side, one on right side beneath the coiled shelf.

Attach folding counter (DD) to right side of the assembled unit. Position the folding counter between the axle guides on the right side support frame (just below where it meets with the sink top/basin assembly). Slide the folding shelf axle (EE) through the axle guides and through the hollow shaft of the folding shelf. Add 10mm washer to each end of the axle. Secure into place by attaching 10mm end clips (H) to each end of the axle. Attach lower part of front hinge to the front right side support frame as shown in *figure 7*. Attach one end of hinge to threaded post on right side frame and the other end of hinge to threaded post on the underside of the folding shelf. Secure with M6 nut (D). Tighten with wrench. Repeat for remaining hinge. Note: hinge will lock with shelf in the “up” position. Collar on hinge will slide down to lock into position.

Attach faucet (II) to rear faucet panel (CC) by unscrewing plastic gasket and sealer ring from faucet head. Place faucet through hole in rear faucet panel and re-screw gasket and ring. Adjust faucet until properly aligned. Tighten.

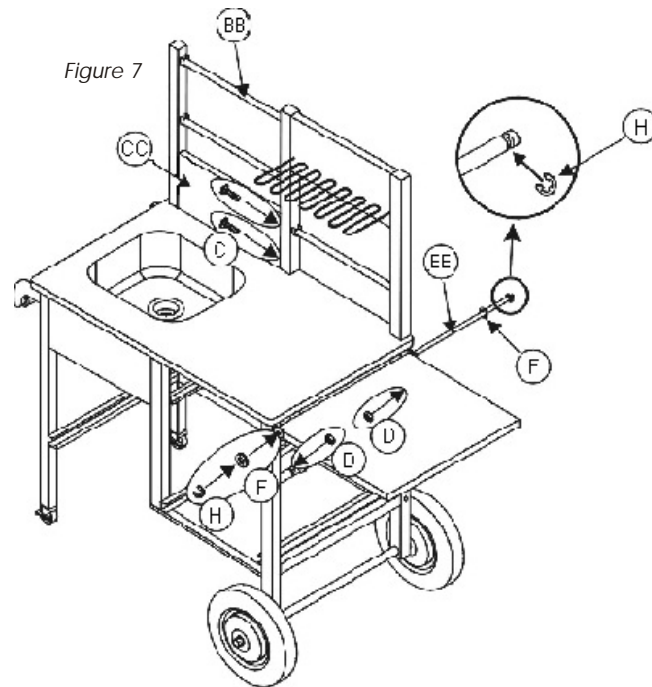

STEP 8 FINAL TOUCHES

Drawer assembly. Tilt the front end of drawer up and slide into track. Make sure track and drawer runners are properly aligned.

Slide the two bottom trays (GG) into frame as shown in *figure 8*.

At this time, make sure all nuts and bolts are tightened completely using wrench and hex key wrench. Do not over tighten. Add 12mm PVC cover (K) to each end of wheel axle and 10mm PVC cover (J) to each end of the folding shelf axle as shown in *figure 8*.

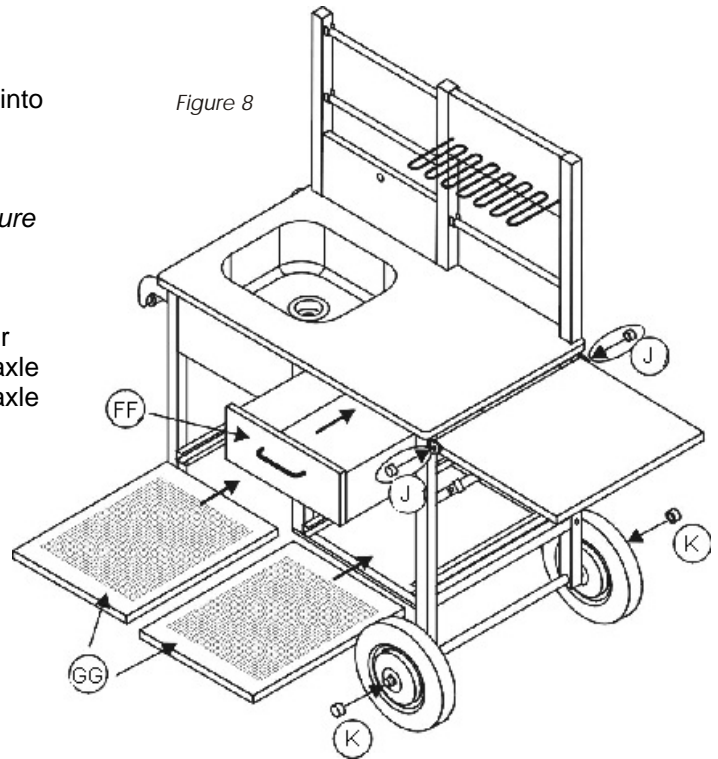

LIMITED WARRANTY

This warranty is extended to the original purchaser and applies to defects in materials and workmanship of our Outdoor Living patio furniture, provided your furniture is maintained with care and used only for personal, residential purpose.

Frames and Welds are warranted to be free from defects in materials and workmanship for a period of five years.

Exclusions: Items used for commercial, contract or other non-residential purposes, display models, items purchased "as is," or items damaged due to acts of nature, vandalism, misuse or improper assembly are not covered. Discoloration or fading of the finish or fabric (if applicable) as a result of exposure to the elements, chemicals or spills are not covered. Table top breakage, corrosion or rusting of hardware, loss of use or other incidental damages are not covered.

If within the stated warranty period a product is found to be defective in material or workmanship, the purchaser must contact the manufacturer's customer service center at 1-800-416-3511. The manufacturer will, at its option, repair or replace the defective parts.

Warranty is to the original purchaser only and is non-transferrable. Any replacement of warranted items will be in the original style and color. If original style and color is not available or has been discontinued, an item of similar style and color will be substituted. As some states do not allow exclusions or limitations on an implied warranty, the above exclusions and limitations may not apply. This warranty gives you specific rights and you may also have other rights which vary from state to state.