

WASHER-DRYER

INSTRUCTION BOOKLET

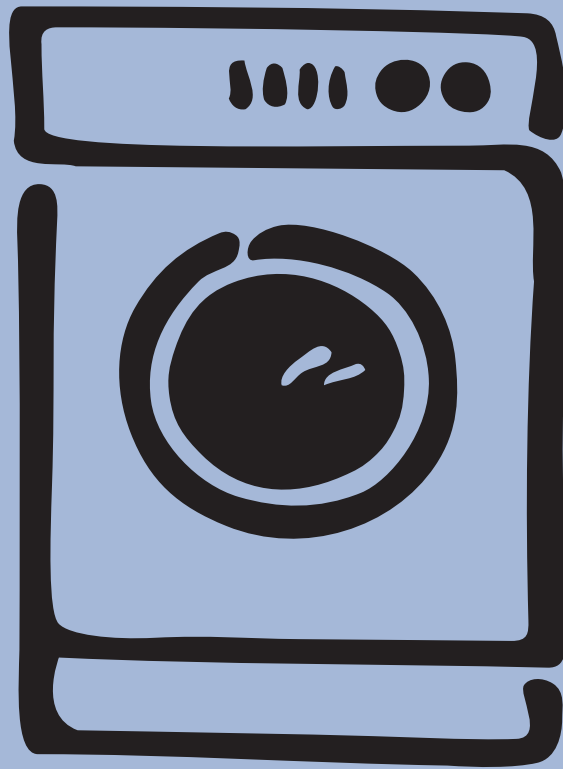

EWV 1292

Dear customer,

Please read these operating instructions carefully and pay particular attention to the safety notes indicated in the first pages. We recommend that you keep this instruction booklet for future reference and pass it on to any future owners.

Transport damages

When unpacking the appliance, check that it is not damaged. If in doubt, do not use it and contact the Service Centre.

The symbols you will see on some paragraphs of this booklet have the following meaning:



The warning triangle and/or the key words (Warning!, Caution!) emphasize information that is particularly important for your safety or correct functioning of the appliance.



The information marked with this symbol provides additional instructions and practical tips on the use of the appliance.



Tips and information about economical and ecological use of the machine are marked with this symbol.

Our contribution to the protection of the environment: we use environmentally friendly paper.

Contents

Warnings	4-5	Operating sequence	18-21
Disposal	5	Washing programmes	22-23
Tips for environmental protection	5	Timed dryings	24
Technical specifications	6	International wash code symbols	25
Installation	7	Maintenance	26
Unpacking	7	Door seal	26
Positioning	7	Bodywork	26
Water inlet	7	Detergent dispenser drawer	26
Water drainage	8	Drain pump	26-27
Electrical connection	8	Water inlet filter	27
Your new washer-dryer	9	Emergency emptying out	27
Description of the appliance	9	Frost precautions	27
Detergent dispenser drawer	9	Something not working?	28-29
Use	10		
Control panel	10		
Controls	13		
Programme information	14		
Washing hints	15		
Sorting the laundry	15		
Temperatures	15		
Before loading the laundry	15		
Maximum loads	15		
Laundry weights	15		
Removing stains	15		
Detergents and additives	16		
Drying hints	17		
Load	17		
Garments not suitable for drying	17		
Drying symbols on garment labels	17		
Duration of the drying cycle	17		
Fibre residue	17		
Additional drying	17		

Warnings

The following warnings are provided in the interests of overall safety. You must read them carefully before installing or using the appliance.

Installation

- All internal packing must be removed before using the appliance. Serious damage may be caused to the machine or adjacent furniture if the protective transit devices are not removed or are not completely removed. Refer to the relevant paragraph in the instruction book.
- Any electrical work required to install this appliance must be carried out by a qualified electrician.
- Any plumbing work required to install this appliance must be carried out by a qualified plumber.
- After having installed the machine, check that it is not standing on its electrical supply cable.
- If the appliance is placed on a carpeted floor, ensure that air can circulate freely between the feet and the floor.

Use

- This appliance is designed for domestic use. It must not be used for purposes other than those for which it was designed.
- Only wash and dry fabrics which are designed to be machine washed and dried. Follow the instructions on each garment label.
- Do not overload the appliance. Follow the instructions in the instruction book.
- Make sure that all pockets are empty. Objects such as coins, safety pins, pins and screws can cause extensive damage.
- Do not machine wash garments saturated with petroleum, methylated spirits, trichlorethylene, etc. If such fluids have been used to remove stains prior to washing, wait until they have completely evaporated from the fabric before placing garments in the appliance.
- Place small items such as socks, belts, etc. in a cloth bag or pillowcase to prevent them getting trapped between the drum and the tub.
- If you use a liquid detergent with a dispenser which has to be placed directly in the drum, remember to remove this dispenser before drying.

- Use only the recommended quantities of fabric softener. An excessive amount could damage the laundry.
- Leave the porthole door slightly ajar when the appliance is not in use. This preserves the door seal and prevents the formation of musty smells.
- Always check that water has emptied out before opening the door. If not, drain the water following the instructions in the instruction book.
- Always unplug the appliance and shut the water tap after use.

General safety

- Repairs to the machine must be carried out only by qualified personnel. Repairs carried out by inexperienced persons could cause serious danger. Contact your local Service Centre.
- Never pull the power supply cable to remove the plug from the socket; always take hold of the plug itself.
- During high temperature wash programmes and during the drying cycle the door glass may get hot. Do not touch it!

Child safety

- Children are often not aware of how dangerous electrical appliances can be. When the machine is working, children should be carefully supervised and not be allowed to play with the appliance.
- The packaging components (e.g. plastic film, polystyrene) can be dangerous to children - danger of suffocation! Keep them out of children's reach.
- Keep all detergents in a safe place out of children's reach.
- Make sure that children or pets do not climb into the drum. To avoid this the machine incorporates a special feature. To activate this device, rotate the button (without pressing it) inside the door clockwise until the groove is horizontal. If necessary use a coin.

To disable this device and restore the possibility of closing the door, rotate the button anti-clockwise until the groove is vertical.

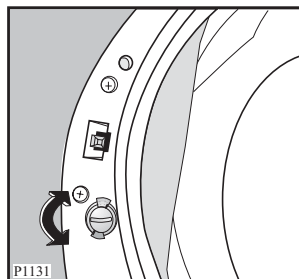

- When the appliance is to be scrapped, cut off the electrical supply cable and destroy the plug with the remaining cable. Disable the door catch in order to prevent children from becoming trapped inside while playing.

Disposal

Packaging materials

The materials marked with the symbol  are recyclable.

>PE<=polyethylene

>PS<=polystyrene

>PP<=polypropylene

This means that they can be recycled by disposing of them properly in appropriate collection containers.

Machine

Use authorised disposal sites for your old appliance. Help to keep your country tidy!

The symbol  on the product or on its packaging indicates that this product may not be treated as household waste. Instead it shall be handed over to the applicable collection point for the recycling of electrical and electronic equipment. By ensuring this product is disposed of correctly, you will help prevent potential negative consequences for the environment and human health, which could otherwise be caused by inappropriate waste handling of this product. For more detailed information about recycling of this product, please contact your local city office, your household waste disposal service or the shop where you purchased the product.

Tips for environmental protection

To save water, energy and to help protect the environment, we recommend that you follow these tips:

- Normally soiled laundry may be washed without prewashing in order to save detergent, water and time (the environment is protected too!).
- The machine works more economically if it is fully loaded (for both washing and drying cycles).
- The machine will consume less energy if the laundry is **adequately spun** before being dried.
- With adequate pre-treatment, stains and limited soiling can be removed; the laundry can then be washed at a lower temperature.
- Measure out detergent according to the water hardness, the degree of soiling and the quantity of laundry being washed.

Technical specifications

DIMENSIONS	Height	85 cm	
	Width	60 cm	
	Depth	63 cm	
MAXIMUM LOAD	Cotton	7 kg	3,5kg
	Synthetics	3 kg	2 kg
	Delicates	3 kg	-
	Woollens/Handwash	2 kg	-
SPIN SPEED		1200 rpm max.	
POWER SUPPLY VOLTAGE/FREQUENCY		230-240 V/50 Hz	
TOTAL POWER ABSORBED		2050 W	
MINIMUM FUSE PROTECTION		10 A	
WATER PRESSURE	Minimum	0,05 MPa	
	Maximum	0,8 MPa	

CE This appliance complies with the following EEC Directives:
73/23/EEC of 19/02/73 relating to low voltage
89/336/EEC of 03/05/89 relating to electromagnetic compatibility.

Installation

Unpacking

 All transit bolts and packing must be removed before using the appliance.

You are advised to keep all transit devices so that they can be refitted if the machine ever has to be transported again.

1. Using a spanner, unscrew and remove the two rear bottom screws. Slide out the two plastic pins.

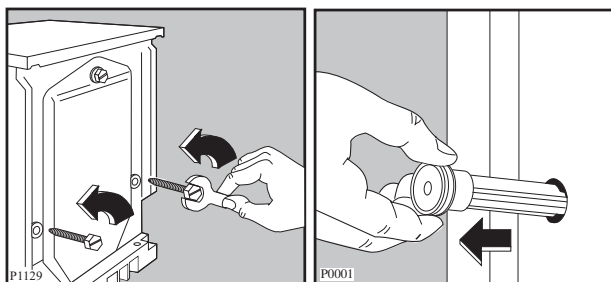

2. Lay the machine on its back, taking care not to squash the hoses. This can be avoided by placing one of the corner packing pieces between the machine and the floor.
3. Remove the polystyrene block(s) from the bottom of the machine. Unscrew and remove the four feet. Release the two plastic bags.
4. Very carefully slide out the left polythene bag, removing it towards the right and then downwards.

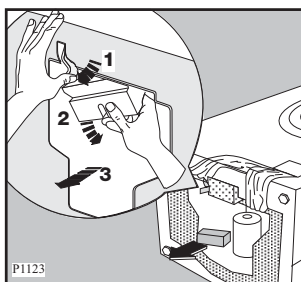

5. Very carefully slide out the right polythene bag, removing it towards the left and then upwards.
6. Carry out the bottom cover placed into the drum of your appliance, lay its hook as the arrow «A» indicates and push the top of the cover to seal it closed.

Important!

You can find more detailed instructions regarding the bottom cover assembling in its relative bag.

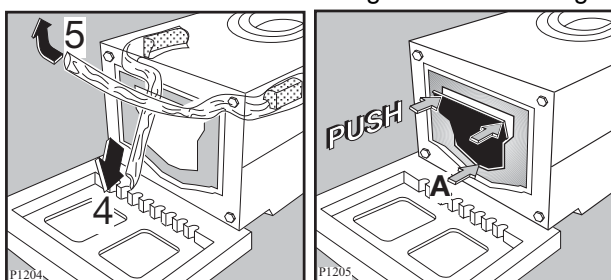

7. Set the machine upright and remove the remaining rear screw. Slide out the relevant pin.
8. Plug all the holes with the plugs which you will find in the envelope containing the instruction booklet.

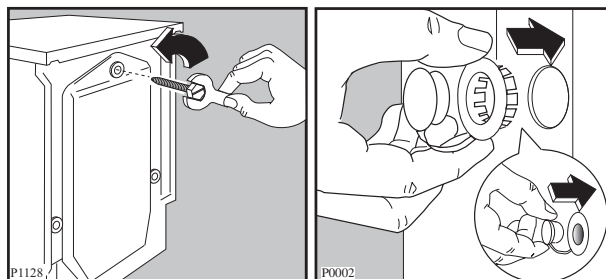

Positioning

Install the machine on a flat hard floor. Make sure that air circulation around the machine is not impeded by carpets, rugs etc. Check that the machine does not touch the wall or other kitchen units. Carefully level by screwing the adjustable feet in or out. Never place cardboard, wood or similar materials under the machine to compensate for any unevenness in the floor.

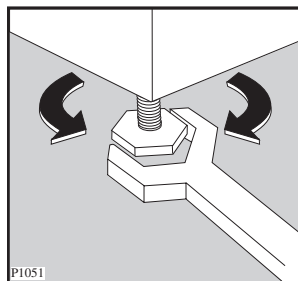

Water inlet

Connect the water inlet hose to a tap with a 3/4" thread.

Do not use already employed hoses.

The other end of the inlet hose which connects to the machine can be turned in any direction. Simply loosen the fitting, rotate the hose and retighten the fitting, making sure there are no water leaks

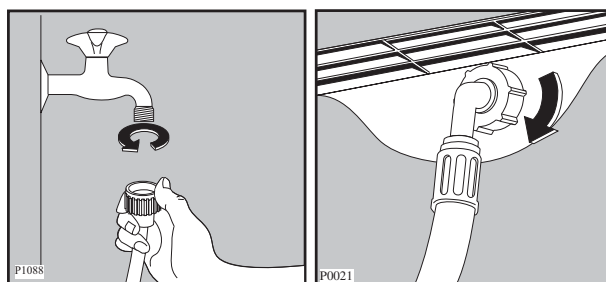

The inlet hose must not be lengthened. If it is too short and you do not wish to move the tap, you will have to purchase a new, longer hose specially designed for this type of use.

Water drainage

The end of the drain hose can be positioned in three ways:

Hooked over the edge of a sink using the plastic hose guide supplied with the machine. In this case, make sure the end cannot come unhooked when the machine is emptying.

This could be done by tying it to the tap with a piece of string or attaching it to the wall.

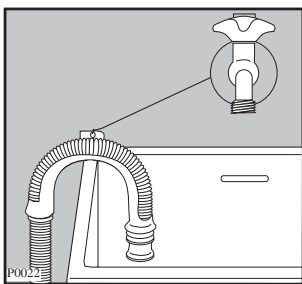

In a sink drain pipe branch. This branch must be above the trap so that the bend is at least 60 cm above the ground.

Directly into a drain pipe at a height of not less than 60 cm and not more than 90 cm. The end of the drain hose must always be **ventilated**, i.e. the inside diameter of the drain pipe must be larger than the outside diameter of the drain hose.

The drain hose must not be kinked. Run it along the floor; only the part near the drainage point must be raised.

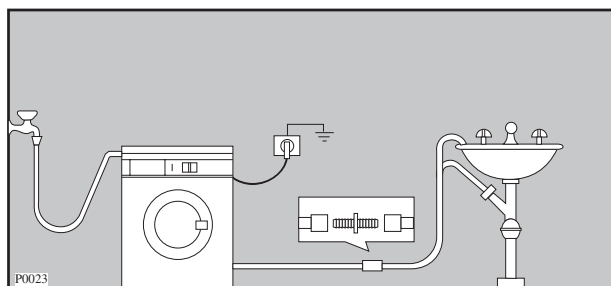

Electrical connection

This machine is designed to operate on a 230-240 V, single-phase, 50 Hz supply.

Check that your domestic electrical installation can take the maximum load required (2.05 kW), also taking into account any other appliances in use.

WARNING: THIS APPLIANCE MUST BE EARTHED.



The manufacturer declines any liability should this safety measure not be observed.

Should the appliance power supply cable need to be replaced, this must be carried out by our Service Centre.

The appliance is supplied with a 13amp plug fitted. In the event of having to change the fuse in the plug supplied, a 13amp ASTA approved (BS1363A) fuse must be used.

Should the plug need to be replaced for any reason, proceed as described below.

The wires in the mains lead are coloured in accordance with the following code:

- Green and Yellow - Earth
- Blue - Neutral
- Brown - Live

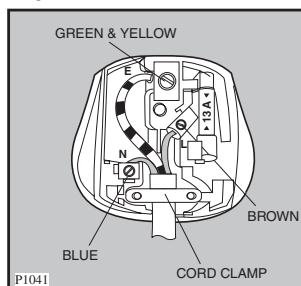

The wire coloured green and yellow must be connected to the terminal marked with the letter «E» or by the earth symbol \perp or coloured green and yellow.

The wire coloured blue must be connected to the terminal marked «N» or coloured black.

The wire coloured brown must be connected to the terminal marked «L» or coloured red.

Upon completion there must be no cut, or stray strands of wire present and the cord clamp must be secure over the outer sheath.

WARNING:



A cut off plug inserted into a 13 amp socket is a serious safety (shock) hazard. Ensure that the cut off plug is disposed of safely.

Important !

The power supply cable must be easily accessible after installing the machine.

Your new washer-dryer

This new machine, which is fitted with the New Jet System, meets all modern needs for effective treatment of laundry with low water, energy and detergent consumption.

Further savings are achieved by washing small loads of laundry, since water and electricity consumption is proportional to the quantity and type of laundry being washed.



- **The possibility** of selecting the temperature, spin speed and all options offered by this machine gives you truly “customised” washing.
- The **DELAY START** option allows you to delay starting of the wash programme to the desired time of day.
- The **RINSE HOLD** function  (stop with water in drum) can be selected for all fabrics: the laundry is left immersed in the final rinse water to avoid the formation of creases.
- **The programme progress display** shows the programme steps selected and the programme phase which is running.
- **The special wool programme** with its new delicate wash system treats your woollens with extreme care.
- **The drying programmes** will give your wash that soft, relaxed feel whatever the weather.
- **3-compartment drawer** for detergent and fabric softener.
- **The balance control device** ensures the machine is stable during the spin.

Description of the appliance

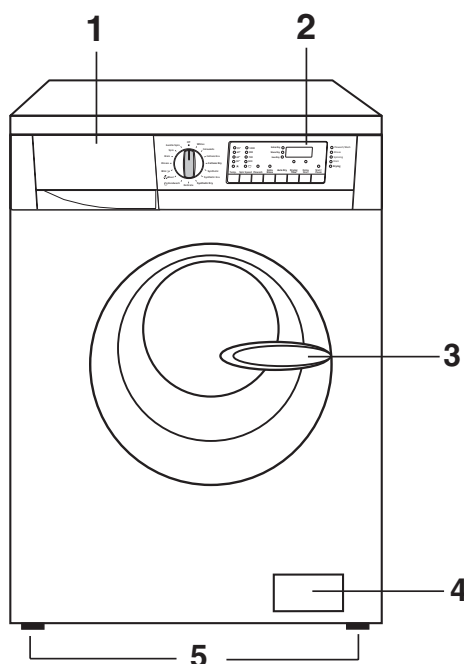
- 1 Detergent dispenser drawer
- 2 Control panel
- 3 Door handle
- 4 Drain pump
- 5 Adjustable feet



Detergent dispenser drawer

-  Prewash
-  Main wash
-  Fabric softener, starch

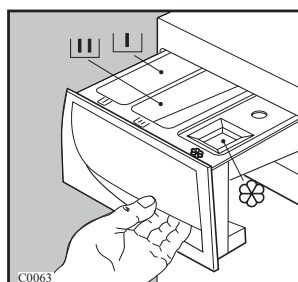

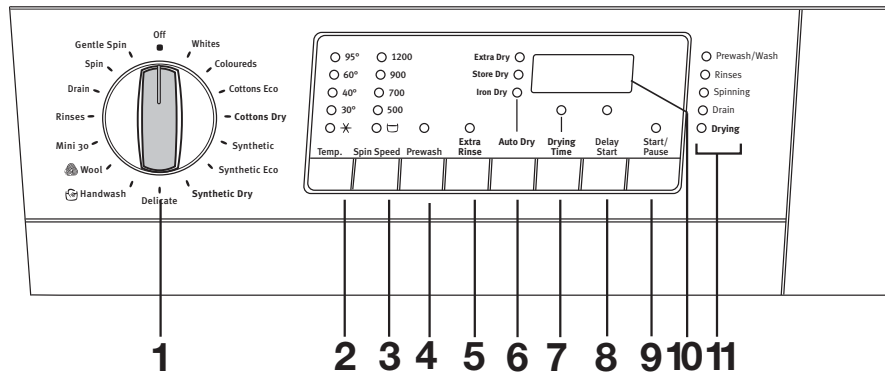

Use

Control panel



1 “Temp.” button

The programme selector dial is divided into the following sections:

- Cottons,
- Synthetics,
- Delicate,
- Wool  and Handwash ,
- Special programmes from “Mini 30” and “Gentle Spin”
- Reset programme/Switching the machine (Off)

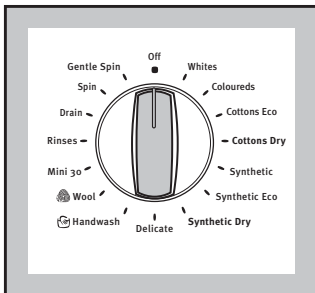

The selector dial can be turned either clockwise or anticlockwise to select the required wash and drying programme .

Positions “Cottons Eco” and “Synthetic Eco” correspond to an ENERGY SAVING programme and * to a cold wash.

Before setting the dial to any position ensure that the machine is switched off.

Important!

At the end of the programme the selector dial must be turned to position Off.

2 “Temp.” button

Press this button repeatedly to increase or decrease the temperature, if you want your laundry to be washed at a temperature different from the one proposed by the machine. The relevant light will light up.

Maximum temperatures are 95°C for cotton, 60°C for synthetic fabrics, 40°C for delicate fabrics, wool and handwash, 30°C for Mini 30.

Position * corresponds to a COLD WASH. This option can be used for very delicate laundry, such as curtains.

3 Spin speed button

Press this button repeatedly to change the spin speed, if you want your laundry to be spun at a speed different from the one proposed by the machine. The relevant light will light up. Maximum speeds are:

- for cotton: 1200 rpm;
- for synthetic fabrics, wool and handwash: 900 rpm;
- for delicate fabrics and “Mini 30” programme: 700 rpm.

RINSE HOLD position : when you choose this option, the machine will not drain the water of the last rinse, so as not to wrinkle the laundry.

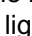
At the end of the cycle, the light of the “Start/Pause” button goes out, the pilot light  remains lit, the door is blocked and a blinking zero will appear on the display to indicate that the water must be drained.

To complete the cycle, choose one of the following options:

- Select programme “Drain” and then depress the “Start/Pause” button: the water is emptied out without spinning.
- Select programme “Spin” or “Gentle Spin”. Select the spin speed by means of the relevant button and then depress the “Start/Pause” button. The water is emptied out and the laundry is spun at the selected spin speed.

Attention! Before selecting the “Drain”, the “Spin” or “Gentle Spin” programmes, the selector dial must to be turned to the “Off” position.

Important!

The “Rinse Hold” option **cannot** be selected for the automatic WASHING & DRYING programme.

OPTION buttons

Depending on the programme, different functions can be combined. These must be selected after choosing the desired programme and before depressing the “Start/Pause” button.

When these buttons are pressed, the corresponding pilot lights illuminate. When they are pressed again, the pilot lights go out.

If an incorrect option is selected, the pilot lights flash for about 2 seconds and the message Err is displayed.

4 “Prewash” button

Select this option if you wish your laundry to be prewashed before the main wash (**not available for wool and handwash**).

The prewash ends with a short spin at 650 rpm in programmes for cotton and synthetic fabrics, whereas in the programme for delicate fabrics the water is only drained.

5 “Extra Rinse” button

This option can be used with all programmes except the wool and handwash programmes. The machine add 2 rinses for cotton and 1 rinse for synthetics and delicates.

This option is recommended for people who are allergic to detergents and in areas where the water is very soft.

6 “Auto Dry” button

By means of this button you can choose the required degree of drying for cottons and synthetics:

Extra dry (cottons).

Store dry (cottons and synthetics).

Iron dry (cottons).

The corresponding pilot light illuminates.

The drying time is automatically adjusted by the machine: the laundry will be dried to the selected degree of dryness.

Important!

By depressing “Auto Dry” and “Start/Pause” buttons simultaneously, the acoustic signal at the end of the cycle, during the programme setting and in case of incorrect selection is suppressed.

7 “Drying Time” button

By depressing this button you can select a timed programme for cotton or synthetics, the relevant light illuminates. To select “cottons” you have to push the button for about 2 seconds. To select the drying time push the button until the time you want appears in the display according to the fabrics (cotton or synthetics) you have to dry.

For **Cottons and Synthetics** you can select a drying time from 10 minutes to 130 minutes.

8 DISPLAY

The following pieces of information are shown on the display:

- **Duration of washing programme** in hours and minutes, after you have selected a programme (for example 2.05).

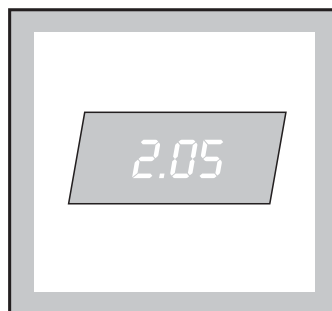

The duration is calculated automatically on the basis of the maximum recommended load for each type of fabric.

While the programme is running (after you have pressed the Start/Pause button), the displayed time value decreases by one unit every minute.

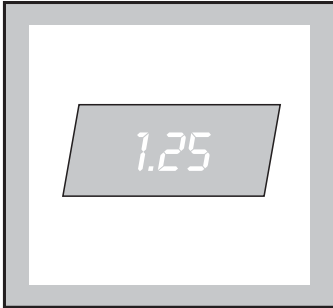

- **The washer-dryer has stopped with water in the tub**, at the end of a programme with  option selected: this is indicated by a **flashing zero**.
- **The washer-dryer has completed the programme**: this is indicated by a **flashing zero**.

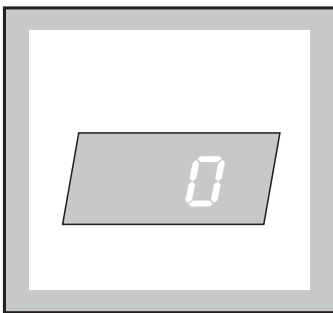

After starting the programme, the remaining time is updated every minute.

- **Selection of drying time** in minutes.

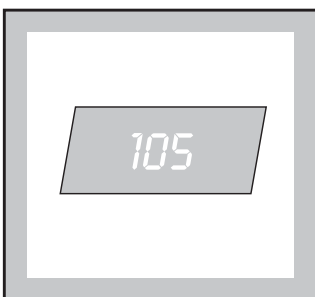

After starting the programme, the remaining time is updated every minute.

Important!

If you select a drying time longer than 55' minutes, after 3 seconds, the display will show it in hours and minutes (see the example below).

Example:

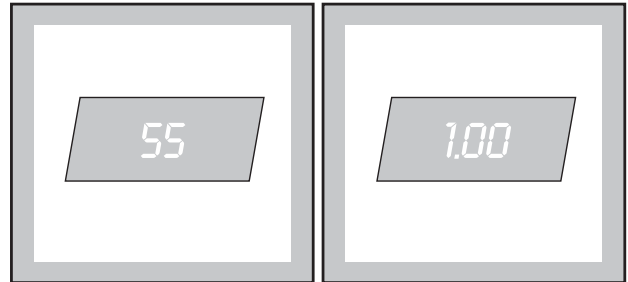

- **Delay start**, a time value indicated in hours (23 hours max) and selected by means of the relevant button.

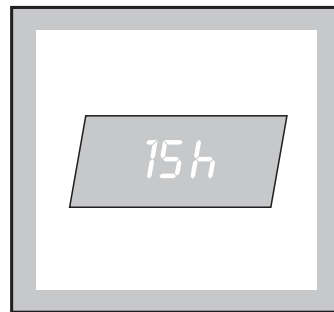

The delay time is displayed for 3 seconds, then the duration of the selected programme reappears. After you have pressed the Start/Pause button, the countdown is updated every hour, and, for the last two hours, every 30 minutes.

- **An incorrect option selection has been made**: this is indicated by the message **Err** when a function incompatible with the current programme is selected.

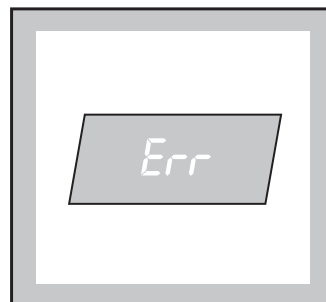

•

An **alarm code** indicates a fault in the machine operation (see the relevant chapter, "Something Not Working")

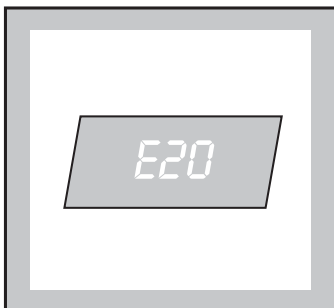

9 “Delay Start” button

This button makes it possible to delay the starting of the programme 30 min - 60 min - 90 min, 2 hours and then by 1 hour up to a maximum of 23 hours.

The delay you have selected is shown on the display for about 3 seconds; afterwards, the duration of the programme reappears.

You must select this option **after** you have set the programme and **before** you press the “Start/Pause” button.

The time value shown on the display will decrease by one unit every hour.

You can change the delay time at any moment, before you press the “Start/Pause” button.

If you have already pressed the “Start/Pause” button, and you wish to **cancel** the delay time, proceed as follows:

- set the machine to PAUSE by pressing the “Start/Pause” button;
- press the “Delay Start” button until the symbol  is displayed.
- press the “Start/Pause” button again.

Important!

- The “Delay Start” **cannot** be used with “Drain”, “Spin” or “Gentle Spin” programmes.

10 “Start/Pause” button

This button has two functions:

- **Start:** after you have selected the desired programme and options, press this button to start the machine. The light above the button will stop flashing and remain lit.

If you have selected a delay time by means of button 9, the countdown will begin and will be shown on the display.

- **Pause:** when you press this button again, the programme in progress is interrupted. The light above the button will start flashing. To restart the programme, press the button again.

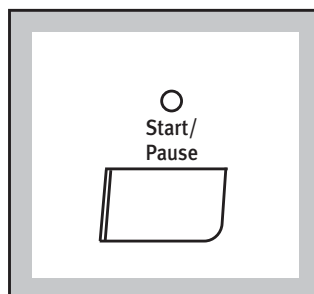

When you PAUSE the cycle, and it becomes possible to open the door, provided

- the machine is not in the heating or drying phase;
- the level of the water is not high;
- the drum is not turning.

Important!

You must set the machine to PAUSE before you make any change in the programme in progress.

11 Programme phase indicator lights

When you select a programme, the lights relevant to the phases that form the programme light up.

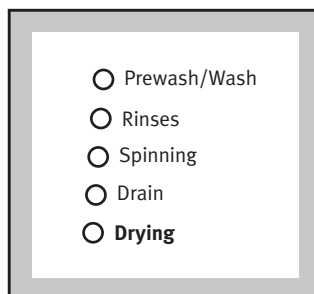

After you have started the programme, only the light relevant to the phase that is currently being carried out will remain lit.

Programme informations

Mini 30

This is a complete programme that can be combined with the following options: Spin speed reduction,  (Rinse Hold) and "Delay Start".

To be used for laundry which is lightly soiled or which needs freshening up.

Max. load 3 kg.

Washing temperature 30 C.

Programme duration 30 minutes.

Final spin speed 700 rpm.

Rinses

With this programme it is possible to rinse and spin the garments which have been washed by hand. The machine performs 3 rinses, followed by a final long spin at the maximum speed.

Important!

The spin speed will automatically assume the setting for cotton items. If required, reduce the speed to the desired level by depressing the "Spin Speed" button.

Drain

For emptying out the water of the programme with  (Rinse Hold) or, if you want to change a programme due to a wrong selection and it is necessary to empty out the water.

Turn first the programme selector dial to "Off", then select the "Drain" programme and depress the "Start/Pause" button.

Spin

Separate long spin at the max speed for hand washed garments. It has to be used for cotton items. You can reduce the speed by means of "Spin Speed" button to adapt it to the fabrics to be spun.

Gentle Spin

Separate short spin at the max speed for hand washed garments. It has to be used for synthetics, delicates, wool items. You can reduce the speed by means of "Spin Speed" button to adapt it to the fabrics to be spun.

Off = Reset / Switching the machine off

To reset a programme or switch the machine off, turn the selector dial to "Off".

Now a new programme can be selected.

i Washing hints

Sorting the laundry

Follow the wash code symbols on each garment label and the manufacturer's washing instructions. Sort the laundry as follows: whites, coloureds, synthetics, delicates, woollens.

Temperatures

- 95°** for normally soiled white cottons and linen (e.g. tea cloths, towels, tablecloths, sheets...)
- 60°** for normally soiled, colour fast garments (e.g. shirts, night dresses, pyjamas....) in linen, cotton or synthetic fibres and for lightly soiled white cotton (e.g. underwear).
- * (cold)** for delicate items (e.g. net curtains), mixed **30°-40°** laundry including synthetic fibres and woollens.

Before loading the laundry

Never wash whites and coloureds together. Whites may lose their "whiteness" in the wash.

New coloured items may run in the first wash; they should therefore be washed separately the first time.

Make sure that no metal objects are left in the laundry (e.g. hair clips, safety pins, pins).

Button up pillowcases, close zip fasteners, hooks and poppers. Tie any belts or long tapes.

Remove persistent stains before washing. Rub particularly soiled areas with a special detergent or detergent paste.

Treat curtains with special care. Remove hooks or tie them up in a bag or net.

Maximum loads

Recommended loads are indicated in the programme charts.

General rules:

Cotton, linen: drum full but not too tightly packed;

Synthetics: drum no more than half full;

Delicate fabrics and woollens: drum no more than one third full.

Washing a maximum load makes the most efficient use of water and energy.

For heavily soiled laundry, reduce the load size.

Laundry weights

The following weights are indicative:

bathrobe	1200 g
napkin	100 g
quilt cover	700 g
sheet	500 g
pillow case	200 g
tablecloth	250 g
towelling towel	200 g
tea cloth	100 g
night dress	200 g
ladies' briefs	100 g
man's work shirt	600 g
man's shirt	200 g
man's pyjamas	500 g
blouse	100 g
men's underpants	100 g

Removing stains

Stubborn stains may not be removed by just water and detergent. It is therefore advisable to treat them prior to washing.

Blood: treat fresh stains with cold water. For dried stains, soak overnight in water with a special detergent then rub in the soap and water.

Oil based paint: moisten with benzine stain remover, lay the garment on a soft cloth and dab the stain; treat several times.

Dried grease stains: moisten with turpentine, lay the garment on a soft surface and dab the stain with the fingertips and a cotton cloth.

Rust: oxalic acid dissolved in hot water or a rust removing product used cold. Be careful with rust stains which are not recent since the cellulose structure will already have been damaged and the fabric tends to hole.

Mould stains: treat with bleach, rinse well (whites and fast coloureds only).

Grass: soap lightly and treat with bleach (whites and fast coloureds only).

Ball point pen and glue: moisten with acetone (*), lay the garment on a soft cloth and dab the stain.

Lipstick: moisten with acetone as above, then treat stains with methylated spirits. Remove any residual marks from white fabrics with bleach.

Red wine: soak in water and detergent, rinse and treat with acetic or citric acid, then rinse. Treat any

residual marks with bleach.

Ink: depending on the type of ink, moisten the fabric first with acetone (*), then with acetic acid; treat any residual marks on white fabrics with bleach and then rinse thoroughly.

Tar stains: first treat with stain remover, methylated spirits or benzine, then rub with detergent paste.

(*) do not use acetone on artificial silk.

Detergents and additives

Good washing results also depend on the choice of detergent and use of the correct quantities to avoid waste and protect the environment. Although biodegradable, detergents contain substances which, in large quantities, can upset the delicate balance of nature.

The choice of detergent will depend on the type of fabric (delicates, woollens, cottons, etc.), the colour, washing temperature and degree of soiling.

All commonly available washing machine detergents may be used in this appliance:

- powder detergents for all types of fabric,
- powder detergents for delicate fabrics (60°C max) and woollens,
- liquid detergents, preferably for low temperature wash programmes (60°C max) for all types of fabric, or special for woollens only.

The detergent and any additives must be placed in the appropriate compartments of the dispenser drawer before starting the wash programme.

If using concentrated powder or liquid detergents, a programme **without** prewash must be selected.

The washing machine incorporates a recirculation system which allows an optimal use of the concentrated detergent.

Pour liquid detergent into the dispenser drawer compartment marked  **just before** starting the programme.

Any fabric softener or starching additives must be poured into the compartment marked  before starting the wash programme.

Follow the product manufacturer's recommendations on quantities to use and **do not exceed the «MAX» mark in the detergent dispenser drawer.**

Quantity of detergent to be used

The type and quantity of detergent will depend on the type of fabric, load size, degree of soiling and hardness of the water used.

Water hardness is classified in so-called "degrees" of hardness. Information on hardness of the water in your area can be obtained from the relevant water supply company, or from your local authority.

Follow the product manufacturers' instructions on quantities to use.

Use less detergent if:

- you are washing a small load,
- the laundry is lightly soiled,
- large amounts of foam form during washing.

Drying hints

As a dryer, the machine works on the condensation principle.

Therefore, **the water tap must be open and the drain hose must drain water into a sink or into the drain pipe, even during the drying cycle.**

Load

Sort of laundry	max. load (dry weight)
Linen and cottons	3,5 kg
Synthetics	2 kg

Warning:

Loads of washed laundry exceeding these values must be divided before being dried, otherwise poor results will be obtained.





Garments not suitable for drying

- Particularly delicate items such as synthetic curtains, woollen and silk, garments with metal inserts, nylon stockings, bulky garments such as anoraks, bedcovers, quilts, sleeping bags and duvets must not be machine dried.
- Garments padded with foam-rubber or materials similar to foam-rubber must not be machine dried; they represent a fire hazard.
- Also, fabrics containing residues of setting lotions or hair sprays, nail solvents or similar solutions must not be machine dried in order to avoid the formation of harmful vapours.

Drying symbols on garment labels

Always look at the garment label to check whether garments can be machine dried.

The following symbols refer to drying:

-  Machine drying is usually possible
-  Normal drying (normal temperature)
-  Gentle drying (reduced temperature)
-  Do not machine dry

Duration of the drying cycle

The drying time can vary according to

- the final spin speed;
- the required degree of drying (extra dry, store dry or iron dry);
- the type of laundry;
- the size of load.

The usual drying times for the timed programmes are indicated in the programme chart. As you become more familiar with the appliance, you will discover the drying times that best suit your needs according to the various type of fabric. It is a good idea to make a note of these times.

Fibre residue

After drying fluffy fabrics, such as new towels, it is advisable to perform the rinse programme by means of the SKIP/RESET button to be sure that any residue that may remain in the tub is completely removed and does not stick to garments dried afterwards.

After each drying cycle the filter should be checked and cleaned.

Additional drying

Should the laundry still be too wet at the end of the programme, set another short drying cycle.

Warning! To prevent the formation of creases or shrinking of fabrics, avoid excessive drying.

i Operating sequence

Washing only

Before washing your first load of laundry, we recommend that you run a cotton cycle at 95°C, with the machine empty, in order to remove any manufacturing residue from the drum and tub. Pour half a measure of detergent into the main wash compartment and start up the machine.

1. Place the laundry in the drum

Open the door.

Place the laundry in the drum, one item at a time, shaking them out as much as possible.

Close the door.

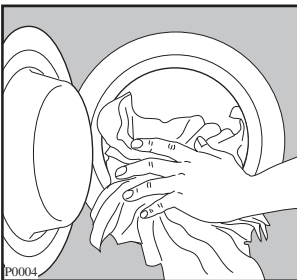

2. Measure out the detergent

Pull out the dispenser drawer until it stops. Measure out the amount of detergent recommended by the manufacturer in a graduated cup and pour it into the main wash compartment .

If you wish to carry out the prewash programme, pour detergent into the appropriate compartment marked .

3. Measure out the additive

If required, pour fabric softener into the compartment marked , **without exceeding the «MAX» mark.**

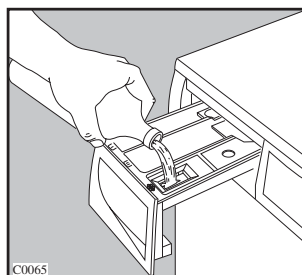
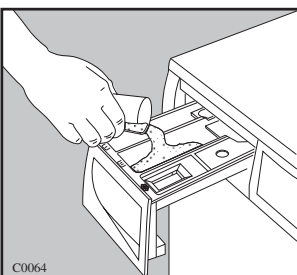

4. Switch the machine on

Turn the selector dial to the desired position to switch the machine on. To switch the appliance off turn it to “Off”.

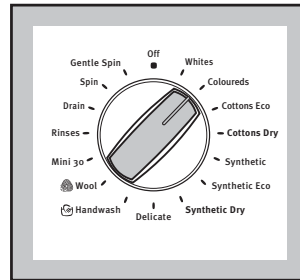

5. Select the desired programme/temperature

Turn the selector dial to 95° programme. The lights relevant to the phases that form the programme will light up.

The display will show the duration of the selected programme, calculated on the basis of the maximum load for each type of fabric. The “Start/Pause” button light will start flashing.

If the load of laundry to be washed is small, at the beginning of the cycle the display will still indicate the duration relevant to the maximum load. The duration value will be gradually adjusted during the cycle.

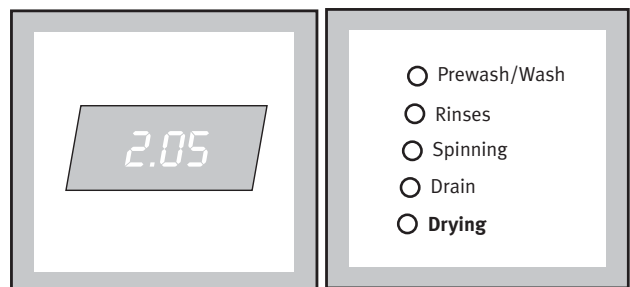

6. Select the temperature

Press the "Temp." button if you wish to select a temperature value different from the one proposed by the machine or the ✱ (COLD WASH). The relevant light will light up.

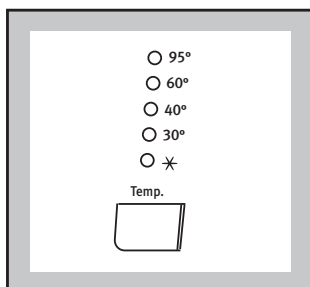

7. Select the spin speed or ☐ (Rinse Hold) option

Press the "Spin Speed" button repeatedly, in order to select the desired spin speed or the ☐ option. The relevant light will light up.

If you select the ☐ option, the machine will stop at the end of the programme with the water still in the tub.

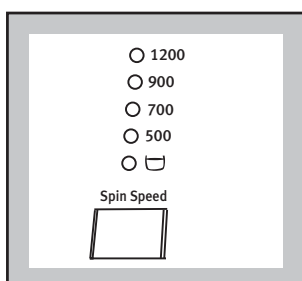

8. Select the desired options

If your laundry is very dirty, it may be advisable to select the "Prewash" option.

If you wish the machine performs an extra rinse, select "Extra Rinse" option. The relevant light illuminates.

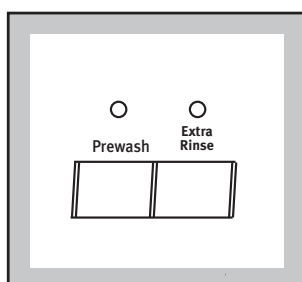

9. Select the "Delay Start"

Before you start the programme, if you wish the starting to be delayed, press the "Delay Start" button repeatedly, or keep it pressed, to select the desired delay.

The selected delay time value (up to 23 hours) will appear on the display for 3 seconds, then the duration of the programme will appear again.

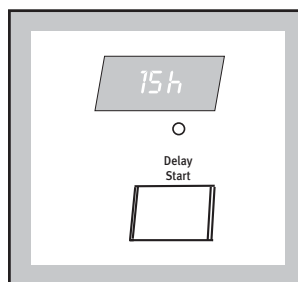

10. Start the programme

Press the "Start/Pause" button. The relevant light will stop flashing and only the light relevant to the phase that is in progress will remain lit.

If you have chosen a delayed start, the washing machine will begin the countdown.

The display will show the duration of the programme or the selected delay.

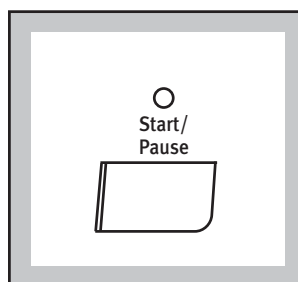

11. How to change an option or a programme during its cycle

It is possible to change any option before the programme carries it out.

Before you make any change, you must pause the machine by pressing the "Start/Pause" button.

Changing a running programme is possible only by **resetting it**.

Turn the programme selector dial to "Off" and then to the new programme position.

Start the new programme by depressing the "Start/Pause" button. The washing water in the tub will not emptied out.

12. How to cancel a programme during its cycle

Depress the "Start/Pause" button to interrupt a programme which is running, the corresponding light starts to flash. Depress the button again to restart the programme.

13. How to open a programme during its cycle

You can open the door, after having set the washing machine to Pause, provided the following conditions exist:

- the machine is not in the heating phase beyond 55°C;
- the level of the water is not high;

If these requirements are met, when you pause the washer dryer, the door can be opened.

Should it not be possible to open the door, and should it be absolutely necessary to do so, switch the machine off by turning the selector dial to "Off".

After approximately 3 minutes, you can open the door.

Pay attention to the level and temperature of the water in the machine!

When you close the door to restart the programme turn the dial to the previous programme repeating the options previously selected and press "Start/Pause" button.

14. At the end of the programme

At the end of the programme, the washer-dryer stops automatically.

The light of the "Start/Pause" button goes off, the pilot light "Prewash/Wash" goes off. The display will show a flashing zero.

If you had selected the  (Rinse Hold) option, the corresponding lights will be on, the display will show a flashing zero but the door will be locked to indicate that the water must be drained.

To complete the cycle, there are 2 possibilities :

- turn the selector dial to the "Off" position, select programme "Drain" and then depress the "Start/Pause" button: the water is emptied out without spinning.

or

- turn the selector dial to the "Off" position and then select programme "Spin" or "Gentle Spin". Select the spin speed by means of the relevant button and then depress the "Start/Pause" button. The water is emptied out and the laundry is spun at the selected spin speed.

Remove the laundry from the washing machine.

Check whether the drum is completely empty, by rotating it with your hand. The purpose of this is to prevent any items of laundry from remaining accidentally in the drum, where they might get damaged in a subsequent wash (e.g. by shrinking) or bleed colour into another load of laundry.

We advise you to close the water supply tap and disconnect the plug from the socket.

Leave the door ajar in order to air the washing machine.

DRYING 3,5 KG OF COTTON

You have for example just machine-washed and spun at 1200 rpm 7 kg of laundry. They are cotton fabrics of medium weight which you want to iron as soon as they are dry.

Remove the laundry from the appliance and divide the items to obtain two loads of approx. 3,5 kg each.

The water tap must be open and the drain hose must be positioned in the sink or connected to the drain pipe.

1. Load the laundry.
2. Turn the programme selector dial to the "Dry" programme for cottons.
3. If you wish to carry out the electronic drying, depress "Auto Dry" button until the light "Iron Dry" illuminates.

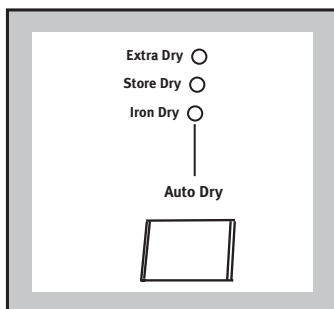

If you want a timed drying, depress the "Drying dry" button until the time you want appears on the display.

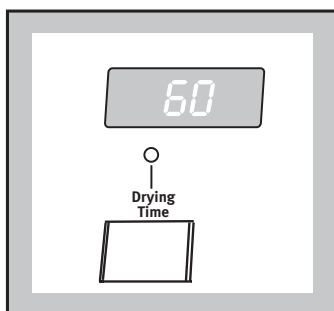

4. Press the "Start/Pause" button to start the programme.

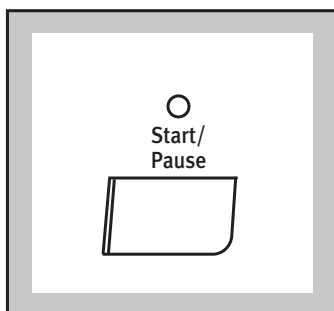

5. At the end of the programme turn the programme selector dial to "Off" to switch the machine off.
6. Remove the laundry.

Note:

The programme time will automatically increase by up to 1 minute, this is quite normal.

AUTODRYING 2 KG OF SYNTHETICS

Warning! For NON-STOP programmes, it is also essential not to exceed the maximum load sizes of 3 kg for cotton and 2 kg for synthetics.

You intend to wash and dry automatically 2 kg of synthetics which do not need ironing.

Do not use a dosing device/ball when carrying out a washing & drying programme.











1. Load the laundry.
2. Add detergent and fabric softener.
3. Switch the machine on by turning the selector dial to a programme for synthetics.
4. Select the wash programme/fabric and temperature.
5. Select the drying time or degree of drying.
6. Select the required options by means of the relevant buttons. If possible, do not select a spin speed lower than that proposed by the appliance to avoid a too long drying time so saving energy. In any case the reduction of the spin speed is only possible after selecting drying. The lowest values you can select are the following:
 - 900 r.p.m. for Cottons & Synthetics with electronic drying
 - 900 r.p.m. for Cottons and 700 r.p.m. for Synthetics with timed drying
7. Start the programme by depressing the "Start/Pause" button.
8. At the end of the programme turn the programme selector dial to "Off" to switch the machine off.
9. Remove the laundry.

Attention!

During drying the door can only be opened for the first 10 minutes and at the end of drying (after the cooling phase).

Programme table

Washing programmes

Fabrics	Programme/ Temperature	Type of laundry	Available options	Load
White cotton	95° - ✖ Cold Whites	Sheets, household linen, towels, tablecloths	Spin reduction/  Prewash Extra rinse	7 Kg
Coloured cotton	60° - ✖ Cold Coloureds	Fast coloured and non-fast items, for example hand towels, sheets, underwear, tablecloths, shirts, blouses	Spin reduction/  Prewash Extra rinse	7 Kg
White and coloured cotton	40° - 30° Cottons Eco	Fast coloured and non-fast items, for example hand towels, sheets, underwear, tablecloths, shirts, blouses	Spin reduction/  Prewash Extra rinse	7 Kg
Synthetics	60° - ✖ Cold Synthetic	Shirts, blouses, underwear, mixed fabrics	Spin reduction/  Prewash Extra rinse	7 Kg
Synthetics	40° Synthetic Eco	Shirts, blouses, underwear, mixed fabrics	Spin reduction/  Prewash Extra rinse	3 Kg
Delicates	40° - ✖ Cold Delicate	Acrylic, viscose, polyester items, duvets, curtains	Spin reduction/  Prewash Extra rinse	3 Kg
Handwash	40° - ✖ Cold  Handwash	Garments bearing the “Hand wash” label	Spin reduction/ 	3 Kg
 Wool	40° - ✖ Cold  Handwash	Garments bearing the “Pure new wool, non-shrink, machine washable”	Spin reduction/ 	2 kg

The “E60° ” (White cotton) is the reference programme for the data entered in the energy label, in compliance with EEC 92/75 standards.

* This data is given purely as an indication: the consumption values may vary in relation to the quantity and type of laundry, the temperature of the water supply and the ambient temperature. The data refers to the highest temperature provided for each programme.

Programme table

Washing programmes

Programme	Programme description	Available options	Load
Mini 30 Short cycle for lightly soiled fabrics	Wash at 30°C 2 rinses Short spin	Spin reduction/☐	3 Kg
Rinses	3 rinses Long spin at the max speed	Spin reduction/☐ Extra rinse	7 Kg
Drain For emptying out the water at the end of the programme with ☐ option	Water draining	-	7 Kg
Spin	Drain and long spin at max. speed	Spin reduction	7 Kg
Gentle Spin	Drain and short spin	Spin reduction	7 Kg
Off (Reset)	For cancelling the programme which is running or to switch the machine off		-













Programme table



Timed drying





Degree of drying	Type of fabric	Max. load	Spin speed	Drying time mins
Extra dry Ideal for towelling materials	Cotton and linen (bathrobes, bath towels, etc.)	3,5 kg	1200	95
		1.5 kg	1200	60
Store dry Suitable for items to put away without ironing	Cotton and linen (towels, T-shirts, bathrobes)	3,5 kg	1200	85
		1.5 kg	1200	50
	Synthetics and mixed fabrics (jumpers, blouses, underwear, household linen)	2 kg	900	75
		1 kg	900	40
Iron dry Suitable for ironing	Cotton and linen (sheets, tablecloths, shirts, etc.)	3,5 kg	1200	65
		1.5 kg	1200	45





i International wash code symbols







These symbols appear on fabric labels, in order to help you choose the best way to treat your laundry.

Energetic wash   Delicate wash	 Max. wash temperature 95°C	 Max. wash temperature 60°C	 Max. wash temperature 40°C	 Max. wash temperature 30°C	 Hand wash	 Do not wash at all
		 				

 Bleaching	 Bleach in cold water	 Do not bleach
---	---	--

 Ironing	 Hot iron max 200°C	 Warm iron max 150°C	 Lukewarm iron max 110°C	 Do not iron
---	---	--	---	--

 Dry cleaning	 Dry cleaning in all solvents	 Dry cleaning in perchlorethylene, petrol, pure alcohol, R 111 & R 113	 Dry cleaning in petrol, pure alcohol and R 113	 Do not dry clean
--	---	--	--	---

 Drying	 Flat	 On the line	 On clothes hanger	 high temperature  low temperature Tumble dry	 Do not tumble dry
--	---	--	--	---	--

Maintenance

1. Door seal

Check from time to time the door seal and eliminate eventual possible objects that could be trapped in the fold.

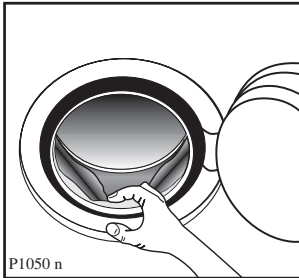

2. Bodywork

Clean the outside of the machine with warm water and a detergent used to handwash dishes. Rinse with clean water and dry with a soft cloth.

Important: do not use methylated spirits, solvents or similar products to clean the bodywork.

3. Detergent dispenser drawer

After a while, detergents and fabric softeners leave deposits in the drawer.

Clean the drawer from time to time by rinsing it under a running tap. To remove the drawer from the machine, press the button in the rear left-hand corner.

To facilitate cleaning, the top part of the additive compartments can be removed.

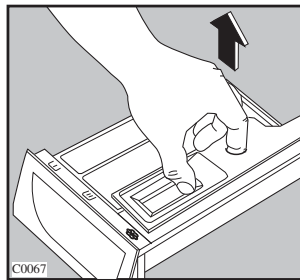
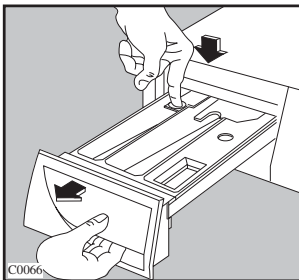

Detergent can also accumulate inside the drawer recess: clean it with an old toothbrush. Refit the drawer after cleaning.

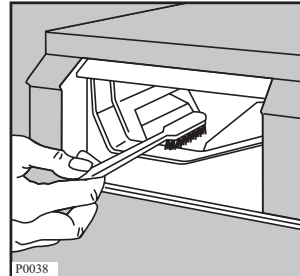

4. Drain pump

The pump should be inspected if

- the machine does not empty and/or spin
- the machine makes an unusual noise during draining due to objects such as safety pins, coins etc. blocking the pump.

Proceed as follows:

- Disconnect the appliance.
- If necessary wait until the water has cooled down.
- Open the pump door.

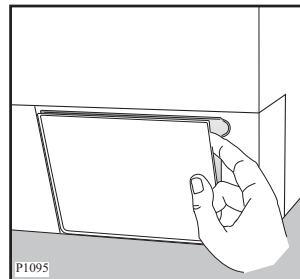

- Place a container close to the pump to collect any spillage.
- Release the emergency emptying hose, place it in the container and remove its cap.
- When no more water comes out, unscrew the pump and remove it. Always keep a rag nearby to dry up spillage of water when removing the pump.

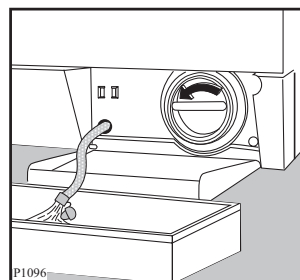

- Remove any objects from the pump impeller by rotating it.

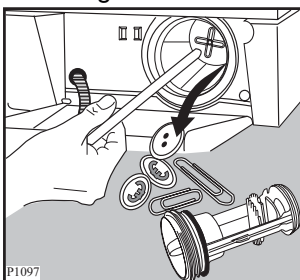

- Put the cap back on the emergency emptying hose and place the latter back in its seat.

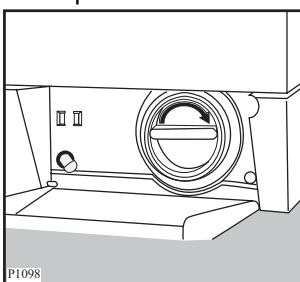

- Screw the pump fully in.
- Close the pump door.

5. Water inlet filter

If you notice that the machine is taking longer to fill, check that the filter in the water inlet hose is not blocked.

Turn off the water tap.

Unscrew the hose from the tap.

Clean the filter with a stiff brush.

Screw the hose back onto the tap.

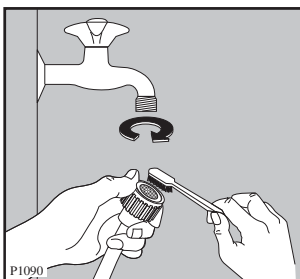

6. Emergency emptying out

If the water is not discharged, proceed as follows to empty out the machine:

- pull out the plug from the power socket;
- close the water tap;
- if necessary, wait until the water has cooled down;
- open the the pump door;
- place a bowl on the floor and place the end of the emergency emptying hose into the bowl. Remove its cap. The water should drain by gravity into the bowl. When the bowl is full, put the cap back on the hose. Empty the bowl. Repeat the procedure until water stops flowing out;
- clean the pump if necessary as previously described;
- replace the emergency emptying hose in its seat after having plugged it;
- screw the pump again and close the door.

7. Frost precautions

If the machine is installed in a place where the temperature could drop below 0°C, proceed as follows:

- Remove the plug from the socket.
- Close the water tap and unscrew the water inlet hose from the tap.
- Place the end of the emergency emptying hose and that of the inlet hose in a bowl placed on the floor and let water drain out.
- Screw the water inlet hose back on and reposition the emergency emptying hose after having put the cap on again.

By doing this, any water remaining in the machine is removed, avoiding the formation of ice and, consequently, breakage of the affected parts.

When you use the machine again, make sure that the ambient temperature is above 0°C.

Something not working?

Problems which you can resolve yourself.

During machine operation it is possible that one of the following alarm codes appears on the display:

- **E10** : problem with the water supply
- **E20** : problem with water draining
- **E40** : door open

Once the problem has been eliminated, press the Start/Pause button to restart the programme. If after all checks, the problem persists, contact your local Service Centre.

Problem	Possible cause
<ul style="list-style-type: none"> • The machine does not start up: 	<ul style="list-style-type: none"> • The door is not firmly closed. (E40) • The machine is not plugged in or there is no power at the socket. • The main fuse or the fuse in the plug has blown. • The type of fabric has not been selected by means of the relevant button. • The Start/Pause button has not been depressed. • The Delay Start option has been selected.
<ul style="list-style-type: none"> • The machine does not fill: 	<ul style="list-style-type: none"> • The water tap is closed. (E10) • The inlet hose is squashed or kinked. (E10) • The filter in the inlet hose is blocked. (E10) • The door is not properly closed. (E40)
<ul style="list-style-type: none"> • The machine fills then empties immediately: 	<ul style="list-style-type: none"> • The end of the drain hose is too low. Refer to relevant paragraph in "water drainage" section.
<ul style="list-style-type: none"> • The machine does not empty and/or does not spin: 	<ul style="list-style-type: none"> • The drain hose is squashed or kinked. (E20) • The option RINSE HOLD  has been selected. • The drain pump is clogged. (E20)
<ul style="list-style-type: none"> • There is water on the floor: 	<ul style="list-style-type: none"> • Too much detergent or unsuitable detergent (creates too much foam) has been used. • Check whether there are any leaks from one of the inlet hose fittings. It is not always easy to see this as the water runs down the hose; check to see if it is damp. • The drain hose is damaged. • The cap on the emergency emptying hose has not been replaced after cleaning the pump.
<ul style="list-style-type: none"> • Unsatisfactory washing results: 	<ul style="list-style-type: none"> • Too little detergent or unsuitable detergent has been used. • Stubborn stains have not been treated prior to washing. • The correct temperature was not selected. • Excessive laundry load.
<ul style="list-style-type: none"> • The machine vibrates or is noisy: 	<ul style="list-style-type: none"> • The transit bolts and packing have not been removed. • The support feet have not been adjusted. • The laundry is not evenly distributed in the drum. • Maybe there is very little laundry in the drum.
<ul style="list-style-type: none"> • The door will not open: 	<ul style="list-style-type: none"> • The water level is above the bottom edge of the door. • The machine is heating the water or drying clothes. • The drum is turning.

Problem	Possible cause
<ul style="list-style-type: none"> • Spinning starts late or the laundry is not spun enough: 	<ul style="list-style-type: none"> • The electronic unbalance detection device has cut in because the laundry is not evenly distributed in the drum. The laundry is redistributed by reverse rotation of the drum. This may happen several times before the unbalance disappears and normal spinning can resume. If, after few minutes, the laundry is still not evenly distributed in the drum, the machine will spin at a lower speed. If at the end of the programme the laundry is not spun enough, redistribute the load manually and select the spin programme.
<ul style="list-style-type: none"> • The machine will not dry or the laundry is not dry enough 	<ul style="list-style-type: none"> • The water tap is closed (E10). • The drain filter is clogged (E20). • The drying time or degree of dryness has not been selected. • An appropriate drying time or degree of dryness has not been chosen. • There is too much laundry inside the appliance.

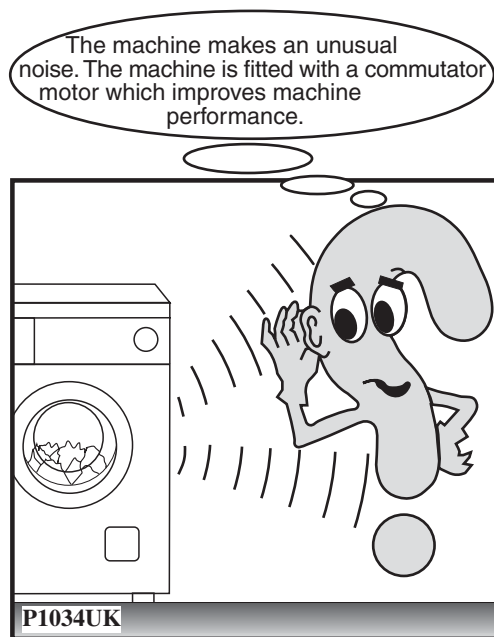
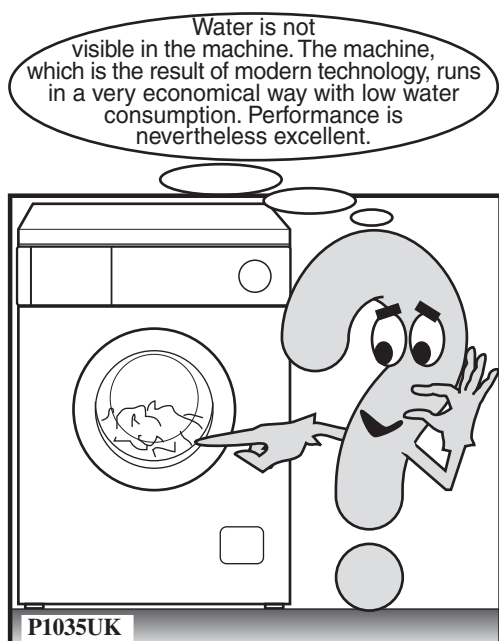

If you are unable to identify or solve the problem, contact our service centre. Before telephoning, make a note of the model, serial number and purchase date of your machine: the Service Centre will require this information.

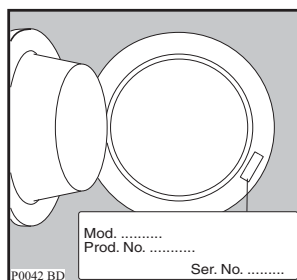



Electrolux Group. *The world's No. 1 choice.*

The Electrolux Group is the world's largest producer of powered appliances for kitchen, cleaning and outdoor use. More than 55 million Electrolux Group products (such as refrigerators, cookers, washing machines, vacuum cleaners, chain saws and lawn mowers) are sold each year to a value of approx. USD 14 billion in more than 150 countries around the world.

MADE IN ITALY