



IMI CORNELIUS INC.
One Cornelius Place
Anoka, MN 55303-6234
Telephone (800) 238-3600
Facsimile (763) 422-3246

INSTALLATION INSTRUCTIONS

DUAL DF/ED 2XX LID KIT FOR THE FOLLOWING ICE MAKERS: Cornelius Extreme 522 and Wilshire WCC 700

Dispenser	DF/ED 2XX	
Kit Number	629087947	

Components		Qty
1. Cover	620043547	2
2. Lid Assembly (XAC 522 Icemaker)	620046064	1
3. Lid Assembly (WCC 700 Icemaker)	620046060	1
4. Mounting Bracket	22127	4
5. Screw, #8 SM	70217	20
6. RTV	50904	1
7. Label	91957	2
8. Instructions	620919550	1
9. Nut, Nylon	620701902	4
10. Washer, Nylon	620701903	4
11. Washer, Sealing	620701901	4
12. Ice Baffle	620037003	2
13. Gasket Strip	620505802	2
14. Binstat Kit	631500109	1
15. Plate, Top Cover	620044644	1

1. Unpack kit. Refer to Figures 1 & 2 for component detail.
2. Attach the ice baffles (item 12) to the lid assemblies (items 2 & 3) using the gasket strips, washers and acorn nuts provided (figure 1).
3. Replace the center-mounting bracket supplied with the dual merchandiser kit with the top cover plate supplied with this kit (item 15). Failure to do this will prevent the adapter kit from functioning properly.
4. Set the lid assembly onto the dispenser. Using the slotted holes on the side of the lid as a template, drill four (4) 9/64" diameter holes at the bottom of the slots (Figure 2).

Note: Use extreme care not to drill into the hopper. Use a drill stop to ensure that the drill bit does not penetrate deeper than 1/4" past the sheet metal. Failure to do so could result in a hole in the hopper, greatly reducing the efficiency of both the dispenser and ice maker.

5. Fasten the lid to the dispenser with four (4) #8 sheet metal screws (item 5), two on each side.
6. Seal the ice maker to the top of the dispenser as follows:
 - A. Run beads of RTV (item 7) around the opening in the lid assembly and the inside of the perimeter of the ice maker outline so that the ice maker will set on the RTV. Make sure that some RTV is applied inside the nutserts on the lid assembly.
 - B. Set the ice maker onto the lid and position it as required.
 - C. Insert the thumbscrews (item 5) into the lid to attach the icemaker to the lid (Figure 3).
 - D. Wipe away the excess RTV.

7. Attach the mounting brackets (item 4) to the to the ice makers and lid assemblies with the the #8 sheet metal screws (item 5) (figure 2).
8. Follow the ice maker manufacturer's instructions to complete the installation of the ice maker.
9. Install the bin-stat (item 14) per the instructions provided with that kit.
10. Install the covers (item 1) into the slots on the lid assemblies (figure 3).
11. Apply the label (item 6) on the front of the cover.

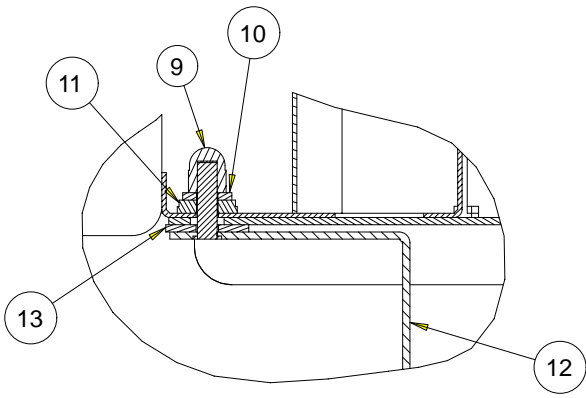

SECTION W-W
SCALE 0.625

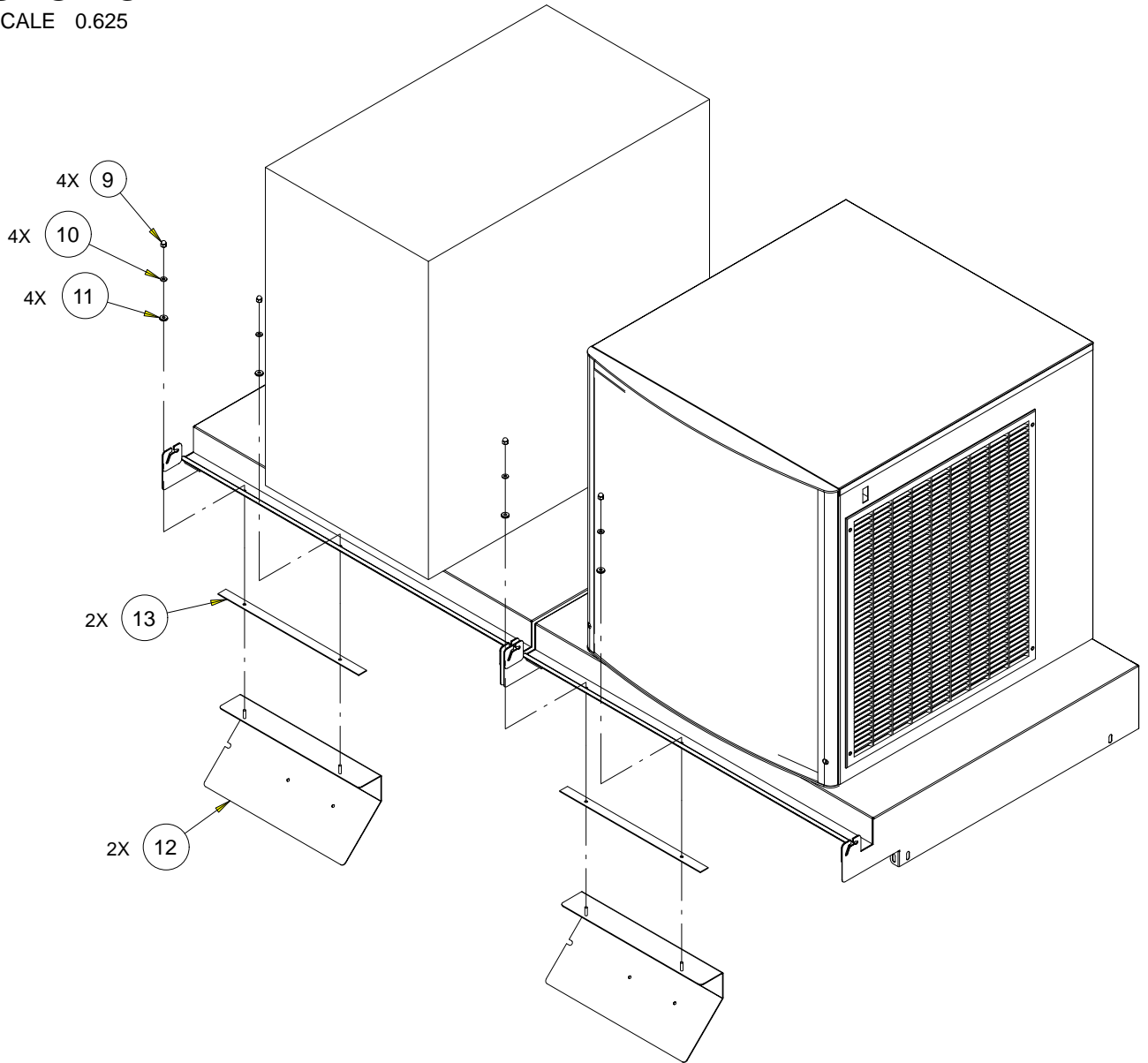
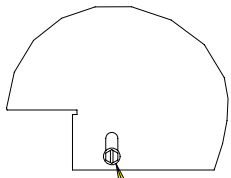

FIGURE 1. PARTS



DRILL \varnothing 9/64 (.140) HOLES
USING BOTTOM OF SLOTTED
HOLES AS A TEMPLATE.

VIEW X
SCALE 0.250

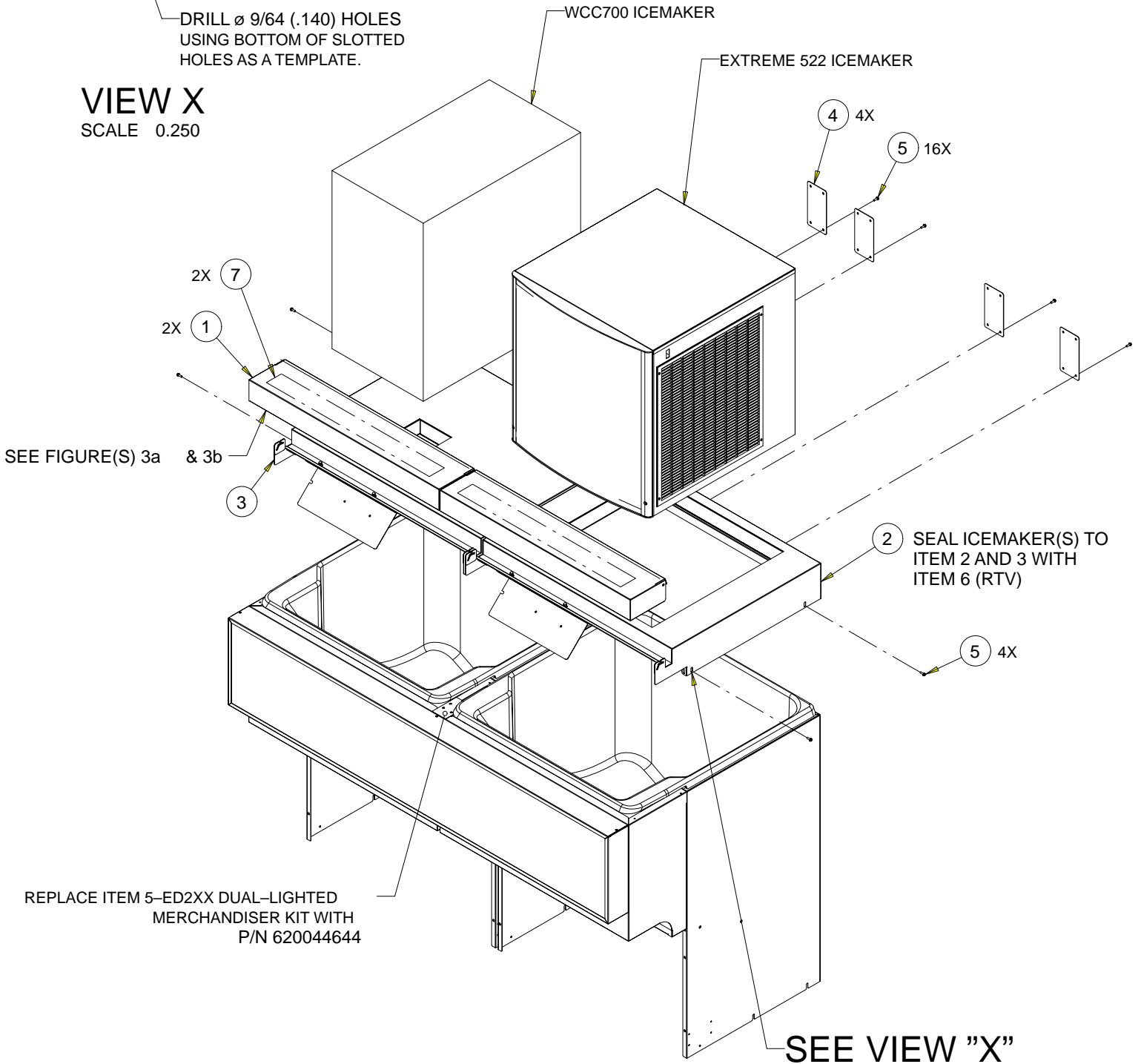

FIGURE 2. DISPENSER ASSEMBLY

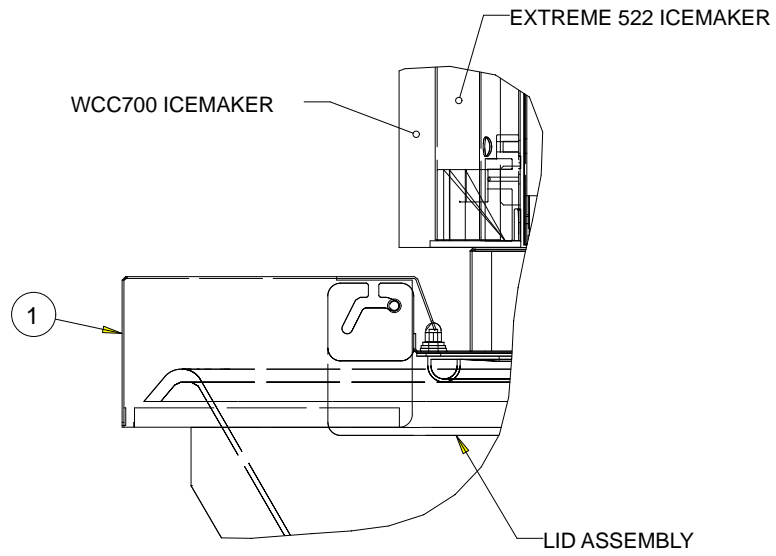

FIGURE 3a. CLOSED POSITION
SCALE 0.250

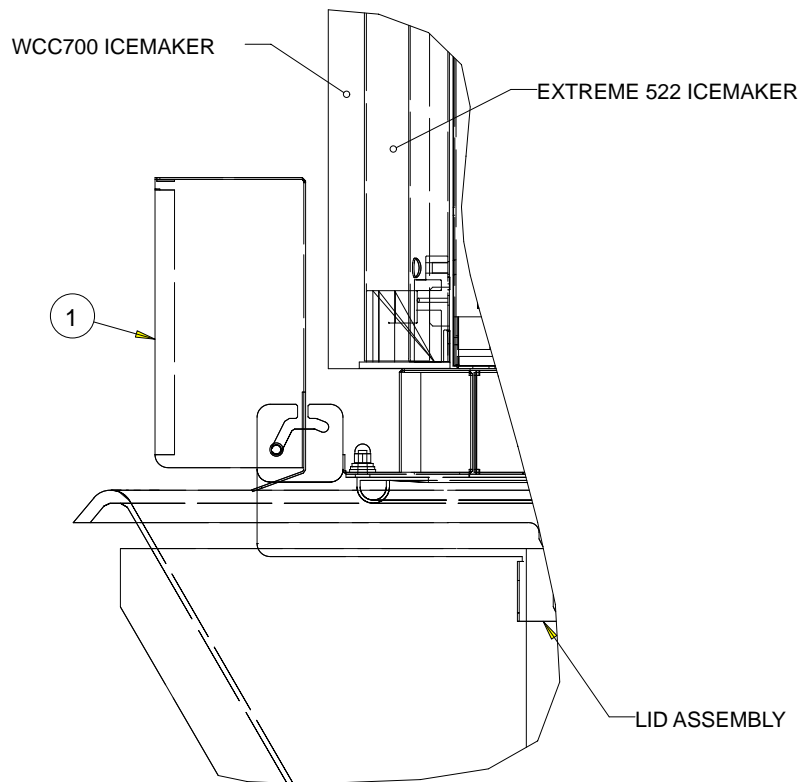

FIGURE 3b. OPEN POSITION
SCALE 0.250