

SAVE THESE INSTRUCTIONS

NOTE: Check ALL parts for shipping damage. In case of damage, DO NOT use. Contact Carrier/Dealer for further instruction.

SAFETY SUMMARY

The following recommendations are made for the safe use of the Rollators:

GENERAL WARNINGS

DO NOT install or use this equipment without first reading and understanding this instruction sheet. If you are unable to understand the Warnings, Cautions or Instructions, contact a healthcare professional, dealer or technical personnel before attempting to install this equipment - otherwise, injury or damage may occur.

Models 65700 and 65800 are NOT to be pushed while seated and/or used as a wheelchair.

Rollators are NOT intended to be self propelled while seated.

When using the transport feature of model 65900, an attendant MUST be present.

The transport feature of model 65900 is intended for use during periods of fatigue and/or resting. It is NOT intended as a replacement for a wheelchair. The transport feature may ONLY be used for short distances over smooth level surfaces - otherwise, injury or damage may occur.

DO NOT use the transport feature of model 65900 on a ramp or incline - otherwise, injury or damage may occur.

A physical/occupational therapist should assist in the placement and positioning of the push handles for maximum support and correct brake activation.

Care should be taken to ensure that ALL hand and height adjustments are secure, and that casters and moving objects are in good working order before using this or any mobility aid.

All wheels MUST be in contact with the floor at ALL TIMES during use. This will ensure the rollator is properly balanced.

The brakes MUST be in the locked position BEFORE using the seat.

Model 65700 only - Check crutch tips for rips, tears, cracks or wear. If any of these conditions exist, replace crutch tips immediately.

MODEL 65900 ONLY - DO NOT step or stand on the footrests when entering or exiting the rollator.

GENERAL WARNINGS CONTINUED

The Rollator basket has a weight limitation of 15 lbs. (6 kg.).

The Rollator can provide ambulatory assistance to an individual weighing up to 300 lbs. (136.08 kg) for model 65900, and 250 lbs. (113.4 kg) for models 65800 and 65700, INCLUDING the weight of the contents of the basket.

INSTALLATION WARNINGS

ALWAYS test to see that the rollator is properly and securely locked in the open position BEFORE using.

After installation and BEFORE use, ensure that ALL attaching hardware is securely tightened.

STABILITY WARNINGS

DO NOT attempt to reach objects if you have to move forward in the seat. Reaching for these objects will cause a change to the weight distribution of the rollator and may cause the rollator to tip, resulting in injury or damage.

BEFORE attempting to reach objects or pick them up from the floor by reaching down between your knees, place feet securely on the floor. Use EXTREME caution when reaching for any object.

OPENING/FOLDING THE ROLLATOR

NOTE: Refer to INSTALLATION WARNINGS in the SAFETY SUMMARY in this instruction sheet.

Opening the Rollator (FIGURE 1)

1. Remove the rollator from the carton.
2. Hold seat handle and push down on seat until an audible "click" is heard.
3. **MODELS 65800 AND 65700 ONLY:** If necessary, install the backrest. Refer to REMOVING/INSTALLING THE BACKREST in this instruction sheet.
4. Install backrest pad. Refer to REMOVING/INSTALLING THE BACKREST PAD in this instruction sheet.
5. Install push handles. Refer to INSTALLING/ADJUSTING THE PUSH HANDLES in this instruction sheet.

Folding the Rollator (FIGURE 1)

1. Hold seat handle and pull up.

NOTE: Model 65900 shown ONLY. Models 65800 and 65700 will open/fold the same way.

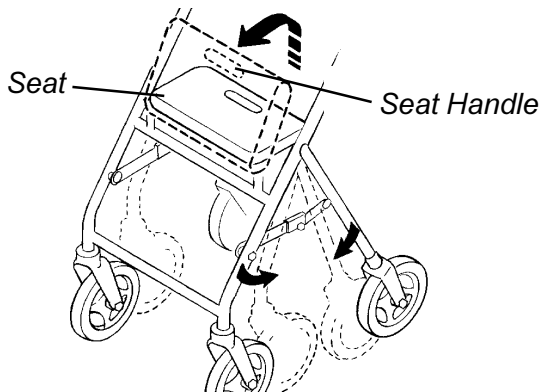

FIGURE 1 - OPENING/FOLDING THE ROLLATOR

INSTALLING/ADJUSTING THE PUSH HANDLES (FIGURE 2)

NOTE: Refer to INSTALLATION WARNINGS in the SAFETY SUMMARY in this instruction sheet.

Installing the Push Handles

1. Remove adjustment knobs and screws from both sides of the frame by turning COUNTERCLOCKWISE.
2. Insert push handles into frames as shown in FIGURE 2.
3. Refer to ADJUSTING THE PUSH HANDLES in this procedure of the instruction sheet.

Adjusting the Push Handles

NOTE: When making this adjustment, ensure the user's shoe height is the same as shoe style worn most frequently when using the rollator. This will provide the most comfortable push handle position.

1. Position the push handle so that when the user's arm is down to their side, the hand grip is at wrist height.

NOTE: This will ensure the arms are at an approximate 20° - 30° bend when using the rollator.

2. Install screw into one (1) of the six (6) adjustment holes.
3. Secure with adjustment knob by turning CLOCKWISE.
4. Repeat STEPS 1 - 3 for the other side.
5. Securely tighten.

NOTE: When securely tightened, the push handles should not move.

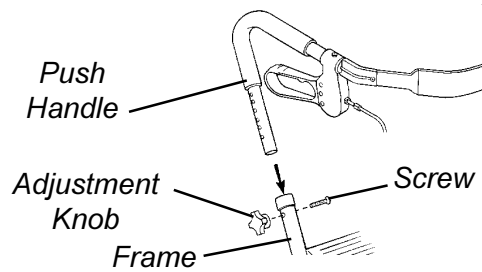

FIGURE 2 - INSTALLING/ADJUSTING THE PUSH HANDLES

INSTALLING THE BASKET

NOTE: Refer to INSTALLATION WARNINGS in the SAFETY SUMMARY in this instruction sheet.

Models 65900, 65800 and 65700 (FIGURE 3)

1. Install basket between the seat support tube and the support tube so the hooks are on the seat support tube as shown in FIGURE 3.

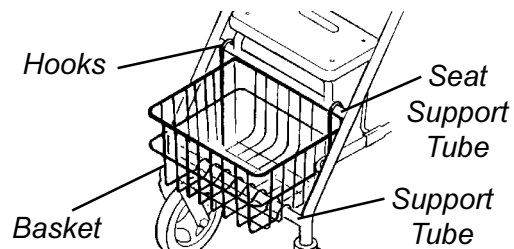

NOTE: Model 65900 shown.

FIGURE 3 - INSTALLING THE BASKET - MODELS 65900, 65800 AND 65700

INSTALLING THE TRAY (FIGURE 4)

NOTE: Refer to *INSTALLATION WARNINGS* in the *SAFETY SUMMARY* in this instruction sheet.

CAUTION

DO NOT sit on the seat with the tray installed, damage to the tray may occur.

1. Align the four (4) pins on the bottom of the tray with the four (4) holes in the seat.
2. Push down on tray to secure in place.

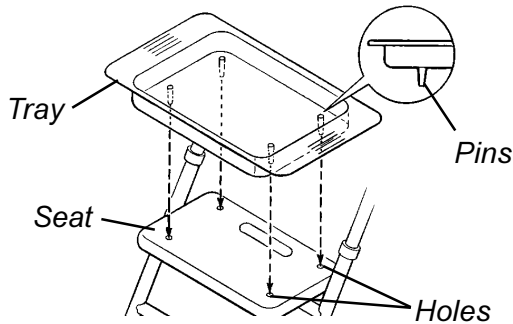
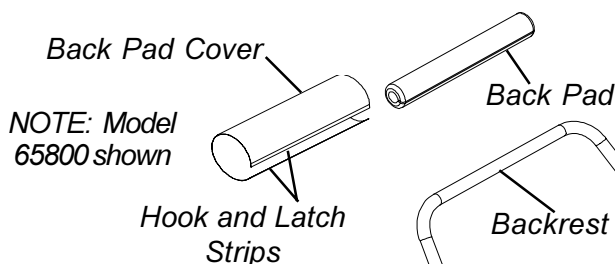

FIGURE 4 - INSTALLING THE TRAY

REMOVING/INSTALLING THE BACK SUPPORT PAD - MODELS 65900, 65800 AND 65700 (FIGURE 5)

NOTE: Refer to *INSTALLATION WARNINGS* in the *SAFETY SUMMARY* in this instruction sheet.

1. Separate the hook and latch strips and remove the back pad cover.
2. Remove the EXISTING back pad from the backrest.
3. Slide the NEW back pad over the backrest.
4. Reinstall the back pad cover and secure with hook and latch strips.



NOTE: Model 65800 shown

FIGURE 5 - REPLACING THE BACK SUPPORT PAD
- MODELS 65900, 65800 AND 65700 ONLY

REMOVING/INSTALLING THE BACKREST - MODELS 65800 AND 65700 ONLY (FIGURE 6)

NOTE: Refer to *INSTALLATION WARNINGS* in the *SAFETY SUMMARY* in this instruction sheet.

Removing the Backrest

1. Depress both the two (2) snap buttons and pull UP to remove the backrest from the backrest support tubes.

Installing the Backrest

1. Insert the backrest into the two (2) backrest support tubes.
2. Ensure the two (2) snap buttons fully protrude through the mounting holes of the backrest support tubes.

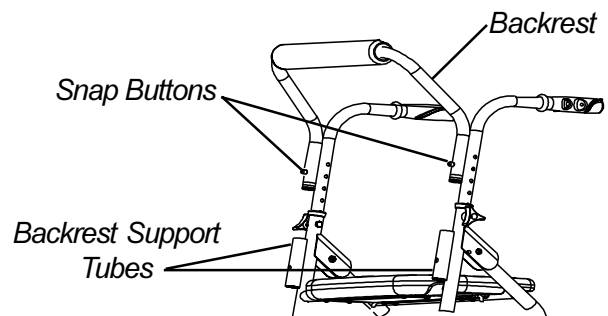

FIGURE 6- REMOVING/INSTALLING THE
BACKREST - MODELS 65800 AND 65700 ONLY

ADJUSTING THE HAND BRAKES - MODELS 65900 AND 65800 ONLY

NOTE: COUNTERCLOCKWISE/CLOCKWISE directions are determined by standing behind the rollator (user's position).

NOTE: Refer to INSTALLATION WARNINGS in the SAFETY SUMMARY in this instruction sheet.

Brake Handle (FIGURE 7)

1. Loosen the brake handle adjustment nut by turning CLOCKWISE.
2. Do one (1) of the following:
 - A. **Loosen brake handle tension** - turn brake handle nut COUNTERCLOCKWISE.
 - B. **Tighten brake handle tension** - turn brake handle nut CLOCKWISE.
3. Turn the brake handle adjustment nut CLOCKWISE to secure in place.
4. Do one (1) of the following:
 - A. **Acceptable tension** - repeat STEPS 1 - 3 for opposite side, if necessary.
 - B. **Unacceptable tension** - refer to CASTER HOUSING in this procedure of the instruction sheet.
5. Refer to LOCKING/UNLOCKING/USING HAND BRAKES in this instruction sheet.

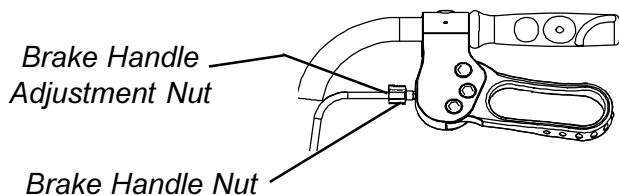

FIGURE 7 - BRAKE HANDLE

Caster Housing - MODELS 65900 ONLY (FIGURE 8)

1. Loosen the caster housing nut.
2. Do one (1) of the following:
 - A. To increase tension, turn the caster housing adjustment nut COUNTERCLOCKWISE.
 - B. To decrease tension, turn the caster housing adjustment nut CLOCKWISE.
3. Retighten the caster housing nut.
4. Repeat STEPS 1 - 3 until tension is acceptable.
5. Do one of the following:
 - A. Refer to LOCKING/UNLOCKING/USING HAND BRAKES in this instruction sheet.
 - B. Repeat ADJUSTING THE HAND BRAKES procedure for opposite side, if necessary.

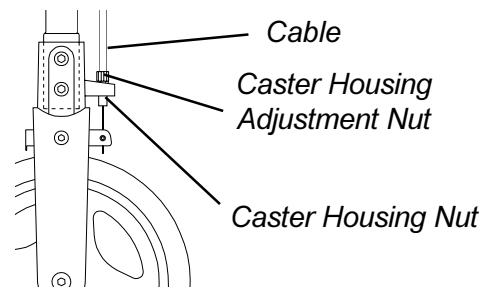

FIGURE 8 - CASTER HOUSING -
MODELS 65900 ONLY

Adjusting Cable Adjuster Unit - Wheel Assembly - MODEL 65800 ONLY (FIGURE 9)

NOTE: Adjusting the cable adjuster unit will increase/decrease the cable brake pressure on the wheels.

1. Loosen the cable brake adjuster unit locknut.
2. Do one (1) of the following:
 - A. To increase tension, turn the cable adjuster unit COUNTERCLOCKWISE.
 - B. To decrease tension, turn the cable adjuster unit CLOCKWISE.
3. Retighten the cable adjuster unit locknut.
4. Test the brake. If the tension of the brake handle is STILL too loose/tight, perform the following:
 - A. Repeat STEP 1.
 - B. Loosen the phillips screw on the brake clamp.
 - C. Pull the brake wire further through the brake clamp.

NOTE: There will be additional excess wire. It may be necessary to fold wire up to keep wire from interfering with brake action.

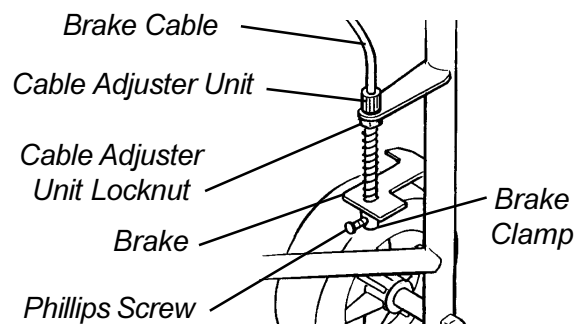

FIGURE 9 - ADJUSTING CABLE ADJUSTER UNIT -
WHEEL ASSEMBLY - MODEL 65800 ONLY

LOCKING/UNLOCKING/USING HAND BRAKES - MODELS 65900 AND 65800 ONLY

NOTE: Refer to INSTALLATION WARNINGS in the SAFETY SUMMARY in this instruction sheet.

Locking Hand Brakes (FIGURE 10)

1. Push DOWN on the bottom portion of the brake handle as shown in FIGURE 10 until an audible “click” is heard.
2. Refer to UNLOCKING HAND BRAKES in this procedure of the instruction sheet.

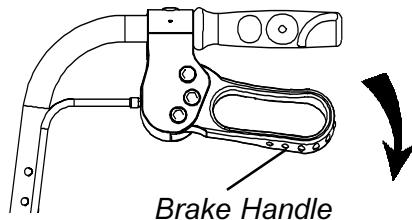

FIGURE 10 - LOCKING HAND BRAKES

Unlocking Hand Brakes (FIGURE 11)

1. Pull UP on the top portion of the brake handle to release as shown in FIGURE 11.
2. Release brake handle.

Using Hand Brakes (FIGURE 14)

1. Pull UP on the top portion of the brake handles towards the push handles.
2. Do one of the following:
 - A. **Remain stationary** - hold the brake handle UP.
 - B. **Continue mobility** - release the brake handle.

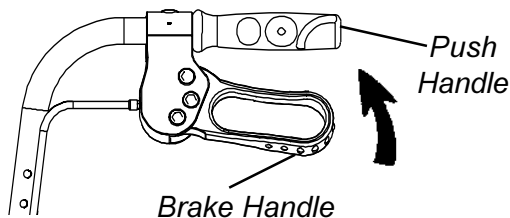

FIGURE 11- UNLOCKING/USING HAND BRAKES

USING BRAKES - MODEL 65700 ONLY (FIGURE 12)

NOTE: Refer to INSTALLATION WARNINGS in the SAFETY SUMMARY in this instruction sheet.

NOTE: The brakes on Model 65700 DO NOT lock. They will activate when seated with weight centered on the rollator seat or when the push handles are pushed downward.

1. Push DOWN on the push handles until the crutch tips contact the floor.
2. Do one of the following:
 - A. **Remain stationary** - continue pushing DOWN on the push handles.
 - B. **Continue mobility** - discontinue pushing DOWN on the push handles

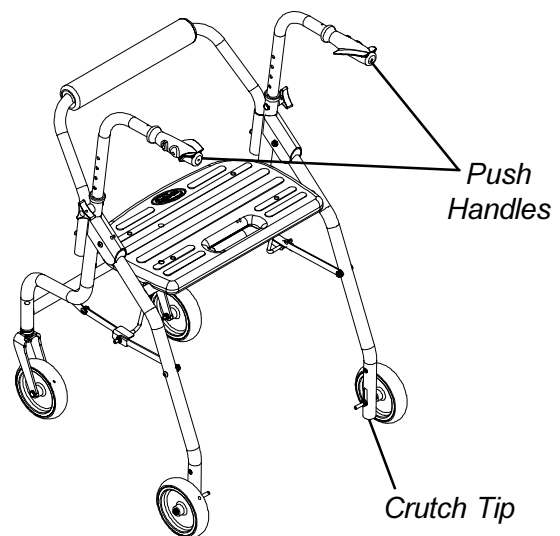

FIGURE 12 - USING BRAKES -
MODEL 65700 ONLY

TRANSPORT FEATURE - MODEL 65900 ONLY (FIGURE 13)

NOTE: Refer to INSTALLATION WARNINGS in the SAFETY SUMMARY in this instruction sheet.

1. Ensure both brakes are fully engaged in the locked position before sitting in the rollator. Refer to LOCKING/UNLOCKING/USING HAND BRAKES in this instruction sheet.
2. Ensure the occupants feet are firmly in place on the footrests.
3. Unlock the brakes. Refer to LOCKING/UNLOCKING/USING HAND BRAKES in this instruction sheet.
4. Grasp the transport handle to push the occupied rollator.

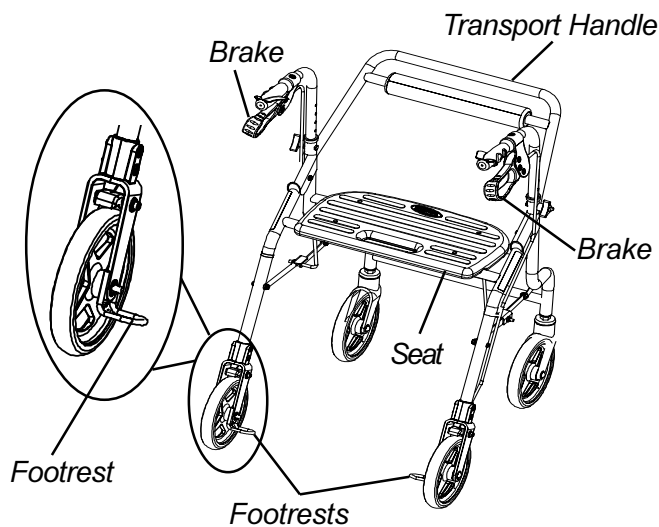

FIGURE 13 - TRANSPORT FEATURE - MODEL 65900 ONLY

REPLACING THE SEAT (FIGURE 14)

NOTE: Refer to INSTALLATION WARNINGS in the SAFETY SUMMARY in this instruction sheet.

1. Open the rollator. Refer to OPENING/FOLDING THE ROLLATOR in this instruction sheet.
2. Place on the floor with the underside of the seat facing up.
3. Remove the eight (8) screws and four (4) spacers that secure the seat to the frame.
4. Remove the EXISTING seat.

CAUTION

DO NOT overtighten hardware, damage to the seat may occur.

5. Position the NEW seat onto the frame as shown in FIGURE 14.
6. Reverse STEP 3 to install NEW seat onto frame using EXISTING screws, spacers and brackets. Tighten hardware against seat until snug.

MODELS 65900,65800 AND 65700

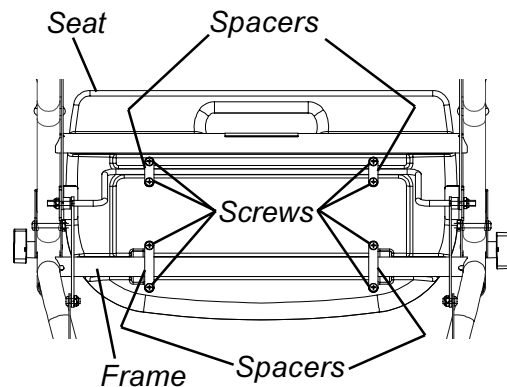

FIGURE 14- REPLACING THE SEAT

REPLACING WHEELS - MODELS 65900 ONLY (FIGURE 15)

NOTE: Refer to INSTALLATION WARNINGS in the SAFETY SUMMARY in this instruction sheet.

1. Remove the cap covers from both sides of the wheel.
2. Remove the mounting screw and locknut that secure the EXISTING wheel to the rollator.
3. Remove EXISTING wheel.
4. Install NEW wheel and secure with NEW mounting screw and NEW locknut.
5. Install NEW cap covers.

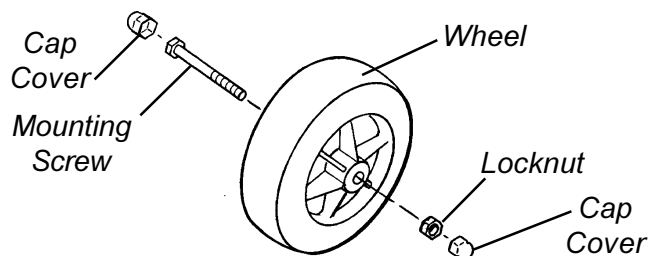

FIGURE 15 - REPLACING WHEELS - MODEL 65900 ONLY

REPLACING WHEELS - MODELS 65800 AND 65700 ONLY (FIGURE 16)

NOTE: Refer to INSTALLATION WARNINGS in the SAFETY SUMMARY in this instruction sheet.

Replacing Front Wheels

1. Remove the mounting screw, bushing and locknut that secure the EXISTING wheel to the rollator.
2. Remove EXISTING wheel.
3. Install NEW wheel and secure with NEW mounting screw, bushing and NEW locknut.

Replacing Rear Wheels

1. Remove the mounting screw, bushing, two (2) covered washers and locknut that secure the EXISTING wheel to the rollator.
2. Remove EXISTING wheel.
3. Install NEW wheel and secure with NEW mounting screw, bushing, two (2) covered washers and NEW locknut.

FRONT WHEELS

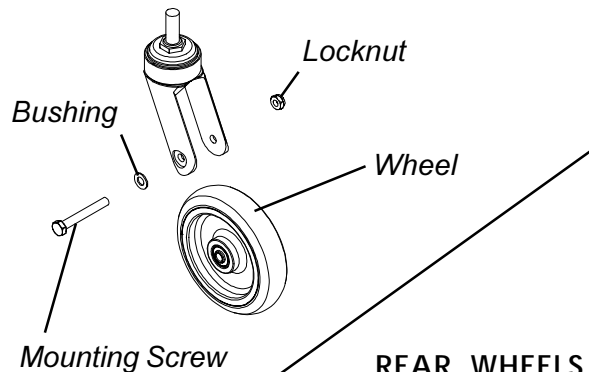

REAR WHEELS

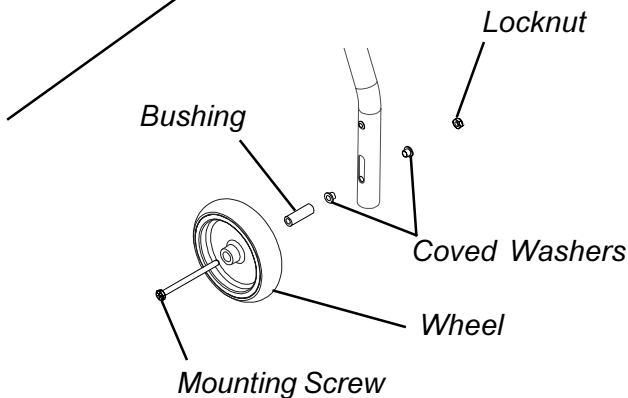

FIGURE 16 - REPLACING WHEELS - MODELS 65800 AND 65700 ONLY

REPLACING THE CRUTCH TIPS - MODEL 65700 ONLY (FIGURE 17)

NOTE: Refer to INSTALLATION WARNINGS in the SAFETY SUMMARY in this instruction sheet.

WARNING

Model 65700 only - Check crutch tips for rips, tears, cracks or wear. If any of these conditions exist, replace crutch tips immediately.

1. Pull to remove the EXISTING crutch tip from the rear frame tube.
2. Slide the NEW crutch tip onto the exposed end of the rear frame tube.

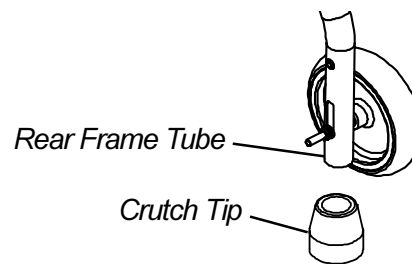

FIGURE 17 - REPLACING THE CRUTCH TIPS - MODEL 65700 ONLY

LIMITED WARRANTY

NOTE: THE WARRANTY BELOW HAS BEEN DRAFTED TO COMPLY WITH FEDERAL LAW APPLICABLE TO PRODUCTS MANUFACTURED AFTER JULY 4, 1975.

This warranty is extended only to the original purchaser/user of our product.

This warranty gives you specific legal rights and you may also have other legal rights which vary from state to state.

Invacare warrants the frame to be free from defects in materials and workmanship for the lifetime of the product, six (6) years on the hand brakes and one (1) year for all other remaining components, excluding tires/wheels for the original purchaser/user. If within such warranty period any such product shall be proven to be defective, such product shall be repaired or replaced, at Invacare's option. This warranty does not include any labor or shipping charges incurred in replacement part installation or repair of any such product. Invacare's sole obligation and your exclusive remedy under this warranty shall be limited to such repair and/or replacement.

For warranty service, please contact the dealer from whom you purchased your Invacare product. In the event you do not receive satisfactory warranty service, please write directly to Invacare at the address on the back cover, provide dealers name, address, date of purchase, indicate nature of the defect and, if the product is serialized, indicate the serial number. Do not return products to our factory without our prior consent.

LIMITATIONS AND EXCLUSIONS: THE FOREGOING WARRANTY SHALL NOT APPLY TO SERIAL NUMBERED PRODUCTS IF THE SERIAL NUMBER HAS BEEN REMOVED OR DEFACED; PRODUCTS SUBJECTED TO NEGLIGENCE, ACCIDENT, IMPROPER OPERATION, IMPROPER MAINTENANCE OR STORAGE, COMMERCIAL OR INSTITUTIONAL USE; PRODUCTS MODIFIED WITHOUT INVACARE'S EXPRESS WRITTEN CONSENT INCLUDING, BUT NOT LIMITED TO, MODIFICATION THROUGH THE USE OF UNAUTHORIZED PARTS OR ATTACHMENTS; PRODUCTS DAMAGED BY REASON OF REPAIRS MADE TO ANY COMPONENT WITHOUT THE SPECIFIC CONSENT OF INVACARE; OR TO A PRODUCT DAMAGED BY CIRCUMSTANCES BEYOND INVACARE'S CONTROL. SUCH EVALUATION WILL BE SOLELY DETERMINED BY INVACARE. THE WARRANTY SHALL NOT APPLY TO PROBLEMS ARISING FROM NORMAL WEAR OR FAILURE TO ADHERE TO THESE INSTRUCTIONS.

THE FOREGOING WARRANTY IS EXCLUSIVE AND IN LIEU OF ALL OTHER EXPRESS WARRANTIES. IMPLIED WARRANTIES, IF ANY, INCLUDING THE IMPLIED WARRANTIES OF MERCHANTABILITY AND FITNESS FOR A PARTICULAR PURPOSE, SHALL NOT EXTEND BEYOND THE DURATION OF THE EXPRESS WARRANTY PROVIDED HEREIN AND THE REMEDY FOR VIOLATIONS OF ANY IMPLIED WARRANTY SHALL BE LIMITED TO REPAIR OR REPLACEMENT OF THE DEFECTIVE PRODUCT PURSUANT TO THE TERMS CONTAINED HEREIN. INVACARE SHALL NOT BE LIABLE FOR ANY CONSEQUENTIAL OR INCIDENTAL DAMAGES WHATSOEVER. SOME STATES DO NOT ALLOW THE EXCLUSION OR LIMITATION OF INCIDENTAL OR CONSEQUENTIAL DAMAGE, OR LIMITATION ON HOW LONG AN IMPLIED WARRANTY LASTS, SO THE ABOVE EXCLUSIONS AND LIMITATIONS MAY NOT APPLY TO YOU.

Invacare Corporation www.invacare.com



Yes, you can.™

USA
One Invacare Way
Elyria, Ohio USA
44036-2125
800-333-6900

Canada
570 Matheson Blvd E Unit 8
Mississauga Ontario
L4Z 4G4 Canada
800-668-5324

Invacare is a registered trademark of
Invacare Corporation.
Yes, you can. is a trademark of Invacare
Corporation.
© 2001 Invacare Corporation
Part No. 1100867 Rev B 01/02