

Installing Front Riggings on the At'm

Assembly, Installation and Operating Instructions



Kit Numbers: 9153644014, 9153644018

Yes, you can:

SAVE THESE INSTRUCTIONS

NOTE: Check all parts for shipping damage. In case of damage, DO NOT use. Contact Carrier/Invacare for further instructions.

Safety Summary

To ensure the safe and proper installation and use of the front riggings on the At'm, these instructions **MUST** be followed:

⚠ WARNING

After ANY adjustments, repair or service and BEFORE use, make sure that all attaching hardware is tightened securely - otherwise injury or damage may result.

Invacare products are specifically designed and manufactured for use in conjunction with Invacare accessories. Accessories designed by other manufacturers have not been tested by Invacare and are not recommended for use with Invacare products.

Description of the Kit

Kit Numbers 9153644014 and 9153644018 for Red or Blue At'm Front Riggings contain:

PART NUMBER	DESCRIPTION	QUANTITY
1132651	Right Legrest Support Assembly	1
1132652	Left Legrest Support Assembly	1
1133151	Mounting Hardware Assembly	1
1134702	70° Complete Right Footrest Assembly	1
1134703	70° Complete Left Footrest Assembly	1

Installing Front Rigging Support Brackets

NOTE: For this procedure, refer to FIGURE 1.

NOTE: Perform the following steps one (1) side at a time.

1. Remove the plug button from the seat frame tube.
2. Note the orientation of the hardware that connects front seat support tube to the seat frame tube.
3. Remove the mounting screw, coved washers, spacers, washers and locknut securing front seat support tube to the seat frame tube. DO NOT discard.

**For more information regarding Invacare products, parts, and services,
please visit www.invacare.com**

4. Insert the proper (right or left) front rigging support bracket into the seat frame tube until two (2) of the four (4) mounting holes on the front rigging support bracket are aligned with the two (2) mounting holes in the seat frame tube.

CAUTION

Two (2) mounting screws are used to secure the front rigging support bracket to the seat frame tube for any mounting position used.

5. Install the existing mounting screw, coved washers, spacers, washers and locknut that secure front seat support tube to the seat frame tube in the orientation noted in STEP 2. DO NOT tighten locknut at this time.
6. Install the new mounting screw, spacer and locknut (hardware supplied) through the large mounting hole on the seat frame tube. Securely tighten.

NOTE: Make sure that the spacer is aligned with the large mounting hole in the seat frame tube and is properly seated against the front rigging support bracket during and after tightening. Refer to Detail "A" of FIGURE 1.

7. Tighten the locknut securing the front seat tube to the seat frame until it is snug and then turn an extra 1/8-turn. DO NOT over-tighten as this is a pivot joint when folding the seat.
8. Repeat STEPS 1-7 to install the front rigging support bracket on the other side.

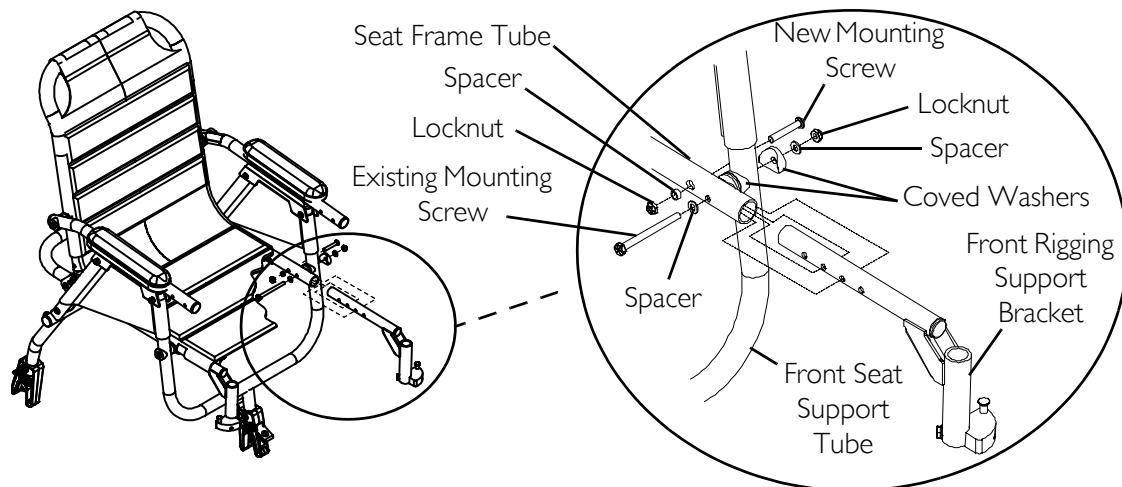

DETAIL "A"

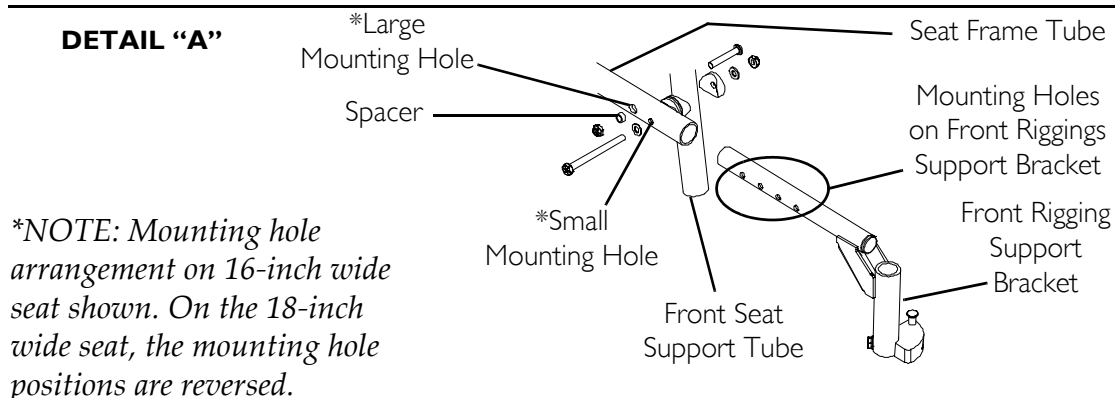

FIGURE I Installing Front Rigging Support Brackets

Installing/Removing the Front Rigging Assembly

NOTE: For this procedure, refer to FIGURE 2.

Installing

1. Turn the front rigging assembly to the side (open footrest is perpendicular to the wheelchair).
2. Insert the mounting pin on the front rigging assembly into the front rigging support bracket.
3. Rotate the front rigging assembly towards the inside of the wheelchair until it locks into place.

NOTE: The footplate will be facing the inside of the wheelchair when locked in place.

4. Repeat STEPS 1-3 for the other front rigging assembly.
5. If necessary, adjust the footrest height. Refer to [Adjusting Footrest Height](#) on page 4.

Removing

1. Push the front rigging release lever inward while rotating the front rigging assembly outward.
2. Lift the front rigging assembly out of the front rigging support bracket.
3. Repeat STEPS 1-2 for the other front rigging assembly, if necessary.

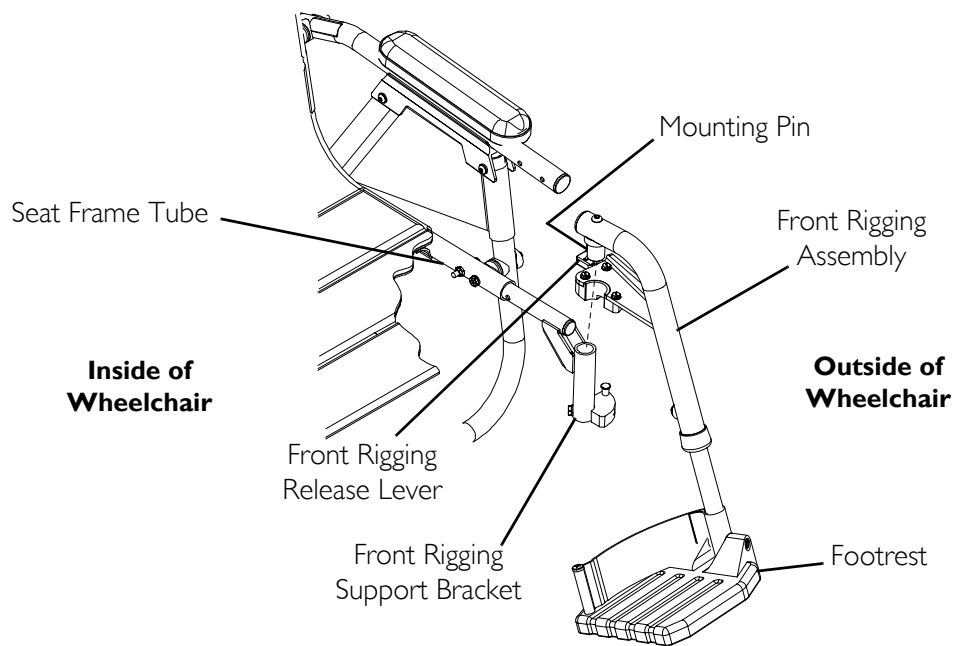

FIGURE 2 Installing/Removing the Front Rigging Assembly

Adjusting Footrest Height

NOTE: For this procedure, refer to FIGURE 3.

1. Remove the front rigging assembly. Refer to Installing/Removing the Front Rigging Assembly on page 3.
2. Remove the hex screw and coved spacer.
3. Move the footrest with slide tube up or down on its mounting tube until the desired footrest height is achieved.
4. Install the hex screw and coved spacer through the front rigging upper support and the slide tube. Securely tighten.
5. Install the front rigging assembly. Refer to Installing/Removing the Front Rigging Assembly on page 3.
6. Repeat STEPS 1-5 for the other side, if necessary.

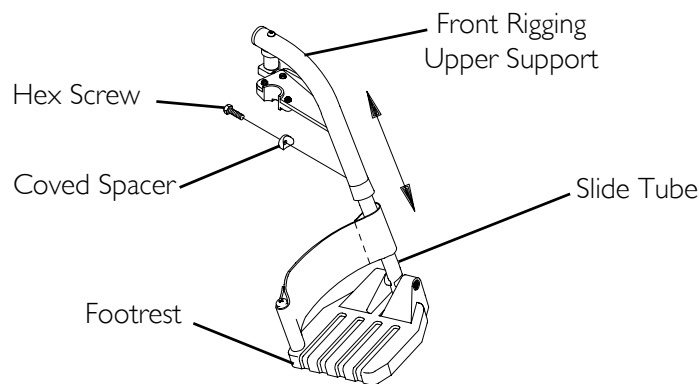

FIGURE 3 Adjusting Footrest Height



Invacare Corporation

www.invacare.com

USA

One Invacare Way
Elyria, Ohio USA
44036-2125
800-333-6900

Canada

570 Matheson Blvd E Unit 8
Mississauga Ontario
L4Z 4G4 Canada
800-668-5324

Invacare is a registered trademark of
Invacare Corporation.
Yes, you can. is a trademark of Invacare
Corporation
© 2005 Invacare Corporation

Part No 1130250

Rev A - 06/05