

**Experts In Home Cleaning™**



**USER'S GUIDE**  
87K1 SERIES 220-240V

- 2 Thank You
- 2 Product Registration
- 3 Safety Instructions
- 4 Product View
- 4 Assembly
- 5-6 Operations
- 6 Maintenance and Care
- 7 Troubleshooting
- 7 Replacement Parts
- 8 Warranty



## Thanks for buying a BISSELL Little Green Pet

We're glad you purchased a BISSELL Little Green Pet. Everything we know about floor care went into the design and construction of this complete, high-tech home cleaning system.

Your BISSELL Little Green Pet is well made, and we back it with a limited one year warranty. We also stand behind it with a knowledgeable, dedicated Consumer Services department, so, should you ever have a problem, you'll receive fast, considerate assistance.

My great-grandfather invented the floor sweeper in 1876. Today, BISSELL is a global leader in the design, manufacture, and service of high quality homecare products like your BISSELL Little Green Pet.

Thanks again, from all of us at BISSELL.

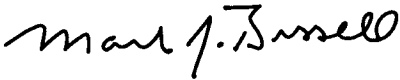

Mark J. Bissell  
Chairman, President & CEO

# IMPORTANT SAFETY INSTRUCTIONS

## When using an electrical appliance, basic precautions should be observed, including the following:

Read all instructions before using your Little Green™ Pet.

Always connect to a properly Earthed outlet. Unplug from outlet when not in use and before conducting maintenance or troubleshooting.

**⚠ WARNING:** To reduce the risk of fire, electric shock, or injury:

- Do not expose to rain. Store indoors
- Do not leave machine when it is plugged in
- Do not service machine when it is plugged in
- If the supply cord is damaged, it must be replaced by the manufacturer or its service agent in order to avoid a hazard
- Do not use machine if it has been dropped, damaged, left outdoors or dropped into water
- Do not pull or carry by cord, use cord as a handle, close door on cord, pull cord around sharp corners or edges, run appliance over cord, or expose cord to heated surfaces
- Do not carry the appliance while in use
- Do not unplug by pulling on cord; unplug by grasping plug not the cord
- Do not handle plug or appliance with wet hands
- Do not put any object into appliance openings, use with blocked opening or restrict air flow
- Do not expose hair, loose clothing, fingers or body parts to openings or moving parts
- Do not pick up hot or burning objects
- Do not pick up flammable or combustible materials (lighter fluid, petrol, kerosene, etc.) or use in the presence of explosive liquids or vapours
- Do not use appliance in an enclosed space filled with vapours given off by oil base paint, paint thinner, some moth proofing substances, flammable dust, or other explosive or toxic vapours
- Remove plug from electrical outlet before cleaning or maintaining the appliance
- Not intended for use by persons (including children) with reduced sensory or mental capabilities, or lack of experience and knowledge, unless they have been given supervision or instruction concerning use of the appliance by a person responsible for their safety

- Young children should be supervised to ensure that they do not play with the appliance
- Do not pick up toxic material (chlorine bleach, ammonia, drain cleaner, petrol, etc.)
- Do not modify the Earthed plug
- Do not use for any purpose other than described in this User's Guide
- Use only manufacturer's recommended attachments
- Use only cleaning products formulated by BISSELL for use in this appliance to prevent internal component damage
- Keep openings free of dust, lint, hair, etc.
- Keep appliance on a level surface
- Turn off all controls before unplugging
- Be extra careful when cleaning stairs
- Pay close attention when working around children
- This product produces a noise level of 80,0 dB(A).

## SAVE THESE INSTRUCTIONS.

This model is for household use only.

**⚠ WARNING:** This appliance must be Earthed.

**IMPORTANT** FOR OPERATION ON A 220-240 VOLT A.C. 50/60 Hz POWER SUPPLY ONLY.

If your appliance is fitted with a nonrewireable BS 1363 plug it must not be used unless a 13 amp (ASTA approved to BS 1362) fuse is fitted in the carrier contained in the plug. Spares may be obtained from your BISSELL supplier. If for any reason the plug is cut off, it must be disposed of, as it is an electric shock hazard should it be inserted into a 13 amp socket.

## Product view



## Assembly

**Assembling your Little Green Pet is a simple process.**

1. Take the flex hose clip and slide the back plate into the opening on the front of the unit. You will hear a "snap" when it is locked in place.
2. Take the vacuum flex hose storage bracket and slide the lower plate into the opening on the back of unit. Make sure the screw holes line up.
3. Insert screw and tighten with a screwdriver.
4. Wrap vacuum flex hose around the base of unit and place hose grip into bracket. Turn bracket latch counter clockwise to lock in place.

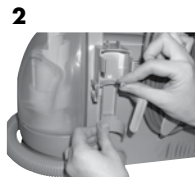

# Operations

## Getting ready

1. To fill the clean water/solution tank.
  - A. Remove the tank by lifting it straight up and then away from the unit.
  - B. Unscrew the black cap at the bottom of the clean water/solution tank and remove bottle insert.
  - C. Add BISSELL 2X compact formula to the FORMULA fill line (8 oz.) on the clean water/solution tank. Fill the clean water/solution tank with hot (NOT boiling) tap water to the WATER fill line. Replace the bottle insert and tighten the black cap.
  - D. Replace the clean water/solution tank by lining up the vertical guides on the left side of the unit with the indentations on the clean water/solution tank and gently slide it down into position.
2. Release vacuum flex hose by twisting the bracket latch clockwise. Unwrap flex hose completely from around the unit.
3. Attach the tough stain brush tool to the vacuum flex hose by pressing the tool onto the end of the hose grip firmly until the button lock snaps into hole. Make certain the tool is securely attached.
4. Twist the Quick Release cord wrap clockwise to unwrap the power cord completely from onboard cord storage and plug into proper outlet.
5. Press and hold spray trigger—spray will start in a few seconds. Raise the tool slightly to check for spray.

## Pre-treating

**Cleaning effectiveness will be enhanced if you pre-treat heavily stained or high-ly-soiled areas. Here's how to do it:**

1. Hold the cleaning tool just above the surface of the carpet or upholstery to be cleaned. Press the trigger to release a spray of cleaning solution directly onto the soiled area.
2. Wait 3-5 minutes before cleaning.

## **⚠ WARNING:**

Do not use an extension cord with this product. The use of an extension cord may result in a severe electrical shock, particularly if the extension cord does not have an electrical rating higher than that of the product, OR if the extension cord does not have a three-prong grounding plug and if the extension cord is not plugged into a circuit box with a ground fault circuit interrupter. Safety precautions such as keeping all connections off the ground and dry will not eliminate the danger.

## **⚠ WARNING:**

Use only BISSELL formulas for compact in your cleaner. Use of cleaning formulas which contain lemon or pine oil may damage this appliance and void the warranty. Chemical spot cleaners or solvent-based soil removers also should not be used. These products may react with the plastic materials used in your cleaner, causing cracking or pitting.

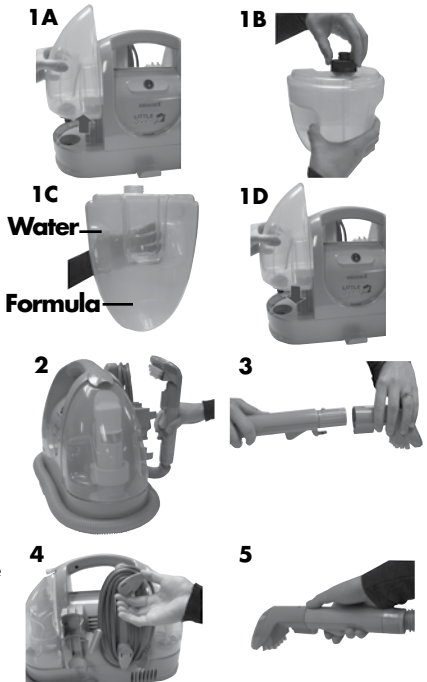

## **⚠ WARNING:**

Do not use this product while on any type of ladder. Do not place the product in a place where it will be stepped on or kicked while in use. Do not place the product on an elevated surface where it may be pulled off the surface while in use.

# Operations

## Cleaning with your Little Green Pet

1. Hold the tool approximately 2.5 cm above the soiled surface. Press the spray trigger to apply the cleaning solution to the soiled area.
2. Using the brush on the tool, gently scrub the area to be cleaned.
3. For thorough cleaning, spray additional solution while the brush and suction are in contact with the surface.
4. Apply downward pressure on the tool and pull it toward you. The suction will remove the dirt and cleaning solution. Continue until no more dirt can be removed.
5. As a final step, use "drying strokes" (by not pressing the spray trigger) to remove as much liquid/moisture as possible. Repeat this step as often as necessary.

### IMPORTANT:

Check the manufacturer's tag before cleaning upholstery. "W" or "WS" on the tag means you can use your Little Green Pet. If tag is coded with an "S" (with diagonal strike-through), or says "Dry Clean Only," do not proceed. If manufacturer's tag is missing or not coded, check with your furniture dealer.

### Tip:

If a significant amount of BISSELL compact formula/water remains, it is all right to leave it in the clean water/solution tank for your next cleaning task.

### Tip:

Check upholstery stuffing before cleaning. Colored stuffing may bleed through the fabric when it becomes wet.

## Maintenance and care

### After cleaning

1. Unplug power cord from outlet.
2. Empty and rinse the dirty water/collection tank after each use, OR when dirty water reaches the indicated maximum fill line. To remove the tank, lift up the dirty water/collection tank release latch and remove the tank from the unit.
3. Disconnect the cleaning tool from the hose grip by pushing down on button lock and pulling straight off.  
**(Do NOT twist tool to remove it)**
4. Once removed from the hose grip, clean tool by rinsing under running water.
5. Check spray nozzle for accumulated dirt or debris. If necessary, clean with soft bristle brush.

### Tip:

Before turning off the Little Green Pet, suction up clean water to thoroughly rinse out the interior of the flex hose. Then, lift the cleaning tool and point it upwards to drain any remaining water into the dirty water/collection tank.

### Machine storage

1. Wipe all surfaces with a soft cloth.
2. Wrap power cord around the cord wrap on the back of the Little Green Pet.
3. Wrap vacuum flex hose around the base of the unit and place hose grip into storage bracket. Turn bracket latch counterclockwise to lock into place.
4. Store unit in protected, dry area, at room temperature (4.4° to 43.3°C).

Tank Release Latch



### ⚠️ WARNING:

Keep spray away from face. Failure to do so may result in personal injury.

# Troubleshooting

## Reduced spray or no spray

### Possible causes

1. Spray nozzle clogged
2. Clean water/solution tank empty
3. Clean water/solution tank insert clogged
4. Pump needs priming

### Remedies

1. Clean spray nozzle
2. Check/fill tank
3. Clean insert at bottom of clean water/solution tank
4. Gently lift clean water/solution tank while depressing the spray trigger OR gently squeeze clean tank while depressing spray trigger

## Deep cleaner won't pick up cleaning solution

### Possible causes

1. Tank release latch is not closed properly
2. Poor upholstery/carpet tool position
3. Dirty water/collection tank is full
4. Upholstery/carpet tool brush worn
5. Excess solution in vacuum flex hose
6. Incorrect cleaning formula

### Remedies

1. Lift up the tank release latch and press down firmly to make sure it is in place
2. Reposition upholstery/carpet tool on surface, follow recommended cleaning procedures
3. Empty dirty water/collection tank
4. Replace with new brush
5. Lift hose and point upwards to allow water in hose to flow into the dirty water/collection tank
6. Use BISSELL 2X compact formulas only

**Other maintenance or service not included in the manual should be performed by an authorized service representative.**

## Replacement parts

Item	Part No.	Part Name
1	203-6651	Tough Stain Brush Tool
2	203-7646	Clean water/Solution Tank (includes cap and insert assembly)
3	203-7144	Dirty Water/Collection Tank (includes the airstack and float assembly)
4	203-7646	Quick Release Cord Wrap
5	203-7645	Vacuum Flex Hose Storage Bracket (includes screw for assembly)
6	203-7643	Vacuum Flex Hose Clip
7	203-5014	Bottle Cap & Insert Assembly

### CLEANING FORMULAS

8	79B9E	473 mL. 2X Concentrate Little Green™ Advanced Formula
9	74R7E	473 mL. 2X Concentrate Pet Stain for compact Advanced Formula

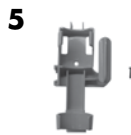

# Warranty - BISSELL Little Green®

This warranty gives you specific legal rights, and you may also have other rights which may vary from country to country. If you need additional instruction regarding this warranty or have questions regarding what it may cover, please contact BISSELL Consumer Services by telephone, or regular post as described below, or contact your local in country distributor.

## Limited One Year Warranty

Subject to the \*EXCEPTIONS AND EXCLUSIONS identified below, BISSELL Homecare, Inc., will replace (with new or remanufactured components), at BISSELL's option, free of charge from the date of purchase by the original purchaser, for one year any defective or malfunctioning part do to manufacturers defect.

This warranty applies to product used for personal, and not commercial or rental service. This warranty does not apply to fans or routine maintenance components such as filters, belts, or brushes. Damage or malfunction caused by negligence, abuse, or use not in accordance with the User's Guide is not covered.

### For UK inquiries:

Monday - Thursday 9 am — 5 pm  
Friday 9 am — 4 pm

### BISSELL Homecare (Overseas) Inc.

The Boat Yard  
105 Straight Road  
Old Windsor  
Berkshire, SL4 2SE  
United Kingdom  
Telephone: 0844-888-6644

### For New Zealand inquiries:

Monday - Friday 9 am — 5 pm

### Parex Industries Ltd.

5 Tolich Place  
Henderson 0610  
Auckland  
New Zealand  
Telephone: 0800-247-735

### For New Zealand inquiries:

Monday - Friday 9 am — 5 pm

### Parex Industries Ltd.

5 Tolich Place  
Henderson 0610  
Auckland  
New Zealand  
Telephone: 0800-247-735

### For Australian inquiries:

Monday - Friday 9 am — 5 pm

### BISSELL AUSTRALIA PTY LIMITED

42 Rocco Drive  
Scoresby 3179  
Victoria  
Australia  
Telephone: 1-800-811-183

### For Middle East & Africa inquiries:

Sunday - Thursday 8 am — 5 pm

### BISSELL Middle East & Africa

PO Box 61286  
Jebel Ali Free Zone  
Dubai  
United Arab Emirates

### For all other inquiries:

Monday - Friday 8 am — 4 pm

### BISSELL Homecare, Inc.

PO Box 1888  
Grand Rapids, MI 49501 USA  
Telephone: 01-616-453-4451  
Fax: 01-616-453-1383

**BISSELL HOMECARE INC. IS NOT LIABLE FOR INCIDENTAL OR CONSEQUENTIAL DAMAGES OF ANY NATURE ASSOCIATED WITH THE USE OF THIS PRODUCT. BISSELL'S LIABILITY WILL NOT EXCEED THE PURCHASE PRICE OF THE PRODUCT.**

**\*EXCEPTIONS AND EXCLUSIONS FROM THE TERMS OF THE LIMITED WARRANTY**

**THIS WARRANTY IS EXCLUSIVE AND IN LIEU OF ANY OTHER WARRANTIES EITHER ORAL OR WRITTEN. ANY IMPLIED WARRANTIES WHICH MAY ARISE BY OPERATION OF LAW, INCLUDING THE IMPLIED WARRANTIES OF MERCHANTABILITY AND FITNESS FOR A PARTICULAR PURPOSE, ARE LIMITED TO THE ONE YEAR DURATION FROM THE DATE OF PURCHASE AS DESCRIBED ABOVE.**



©2010 BISSELL Homecare, Inc.  
Grand Rapids, Michigan  
All rights reserved. Printed in China  
Part Number 120-4239  
Rev 10/10  
Visit our website at:  
[www.bissell.com](http://www.bissell.com)