

**Full Automatic Washing Machine
With Pump**

User's manual

Haier

This manual is for
HWM70-10

- Please read this manual carefully before using.
- Retain it for future reference.

The Haier logo consists of the word "Haier" in a white, sans-serif font, centered within a dark gray square background.

Contents

Specifications.....	the 2 nd cover
Names of the parts.....	1
Safety precautions	2
Installation and adjustment	4
Preparation before washing	8
Put in the laundries	9
Usage of the detergent	9
Use the operation buttons	10
Close the top lid	14
Finish washing	14
Disposal after washing	15
Trouble shooting • Answer to question.....	16
Packing list	17



Specifications

Water level/Water quantity (about)	1/18L、 2/21L、 3/27L、 4/32L、 5/35L、 6/38L、 7/41L、 8/44L、 9/47L、 10/51L
Water inlet pressure	0.03MPa-0.78MPa
Rated washing / spinning capacity	7.0kg

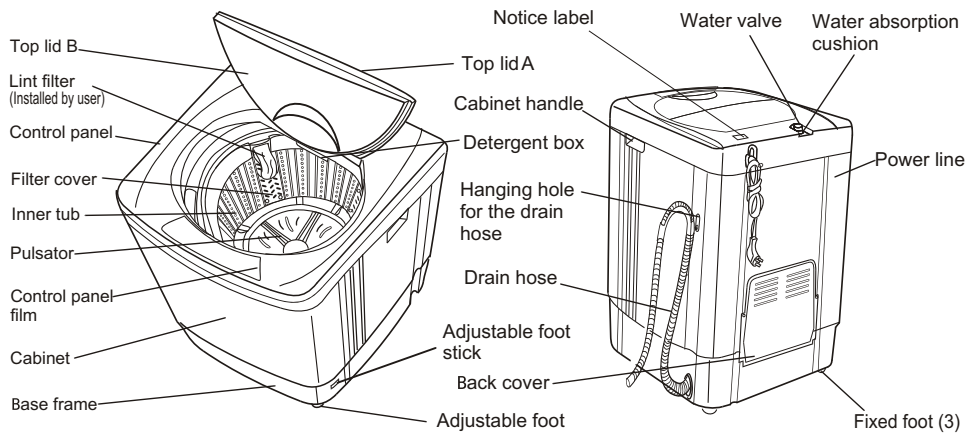
Names of the parts



Meaning and description of the symbols

<p>Warning sign</p> 	<p>Contents marked with that symbol are related to the safety of the product and the personal safety of the users. Please operate in strict conformity to the contents, otherwise it may cause damage of the machine or injure the personal safety of the user.</p>
<p>Forbidden sign</p> 	<p>Contents marked with that symbol are actions forbidden to perform. Performing of those actions may result in damage of the machine or injure the personal safety of the user.</p>

Safety precautions

Please plug the plug on special receptacle with rated voltage. Be sure to use single-phase three pins receptacle. Ensure the earthing prong of the power receptacle is earthed reliably. Use leakage protector if possible.



The power cord plug should be convenient to be plugged in or plugged out with hand while the washing machine runs normally. Be sure to pull the plug out and close the water tap when the machine is idle, when moving the machine, or when cleaning the machine. Do not use wet hand to insert or pull out the power plug.



Do not damage the power cord, bend, extend, twist, bind or alter it by force. Do not press or nip it with weight. If the power cord or the power plug is bad, or the power plug becomes flexible, to avoid risk it is required to have it replaced by the technicians of our special shop or the after-sale service department. Keep the pin of the power plug clean, if the power plug is polluted with dust, please wipe with dry cloth carefully.



Do not put the machine at damp place like the bathroom. Never wash it with water. Not put wet laundries on the control panel.

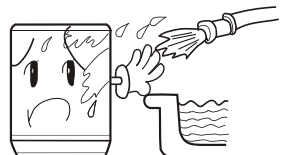

Do not use water hotter above 50°C.



In case the washing machine is installed on ground with carpet, do not block the ventilation hole with carpet.

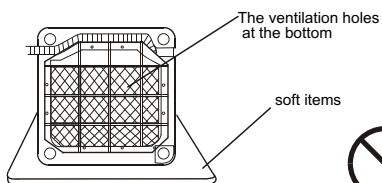

Do not wash water-proof laundries like the raincoat, bike covers etc. to avoid abnormal vibrations in spinning.



Do not let the machine share one receptacle with other electric appliances. If the power plug is damaged, or the plugging into the receptacle is loose, do not use the plug any more.

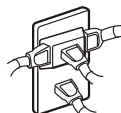

Safety precautions

Do not stretch hands into the working machine. It is dangerous even if the rotation is slow. Take special care of the children. Do not let the children climb the washing machine.



Do not decompose, repair or alter the machine by yourself.

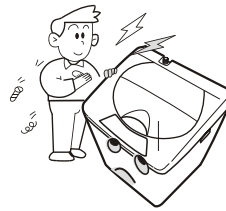

Do not put any hot or heavy items (such as the kettle with hot water) on the washing machine.



Do not wash laundries with volatile materials (such as thinner, petrol etc.)



The handicapped or children without care shall not use the machine.

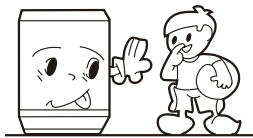

Keep the machine away from direct sunlight and heat source like the heater.

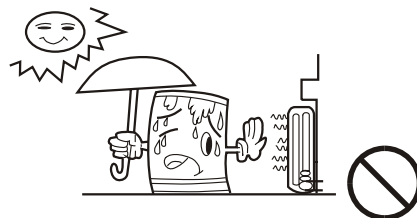

To prevent the lint inside the tub from blocking the cascade outlet during washing, please keep the lint filter in good condition, and install it to proper position. If the lint filter is lost or damaged, please contact the local after-sales service department of our company.

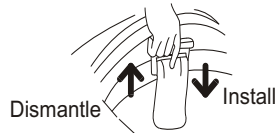

- To protect your laundries and washing machine, please take out all of the coins, buttons, sand, hairpin and other foreign materials before washing.

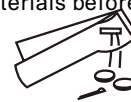

- Please check if the water faucet is open, and if the connection of the water inlet pipe is proper.
- It is suggested to use foamless washing powder.

Installation and adjustment

Please install and adjust the machine according to the requirement of the manual. It is very important to your security and correct operating the machine.

Install the lint filter

Push the lint filter downward to location for lint filter.

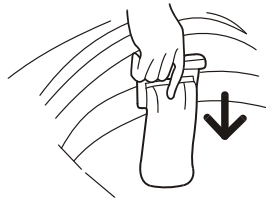

Install the bottom plate

After you open the package, please lean the washing machine gently down on soft items (like the towel cloth, blanket, etc.). Install the bottom plate to the bottom of the machine with the eight screws by a cross screwdriver, then lift the machine up gently. See to the figure:

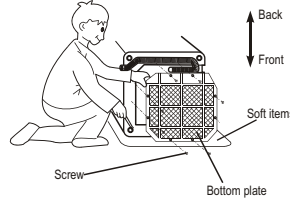

Adjust the installation position

The largest allowed slope of the shank base of the machine is 2° . The slanting or rough ground will result in unstable running or stoppage of the machine. Please adjust it with following methods:

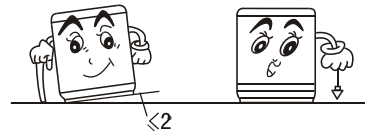

- **Adjust the adjustable foot:**

1. To twist the adjustable foot, please first lift up the side of the foot slightly, loosen the adjustable nut, and twist the foot.
2. Fasten the nut after adjustment.

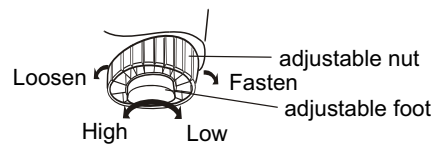



How to change the direction of the drain hose

1. Lean the machine down gently with the front surface facing the ground. Loosen the eight screws by a cross screwdriver.

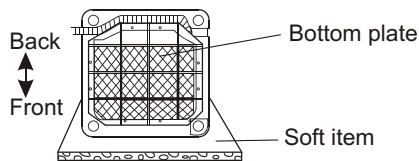

2. Pull out the drain hose from the groove at the right side.

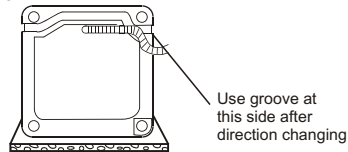

3. Extend the drain hose from the left side. Push the drain hose into the groove with hands.

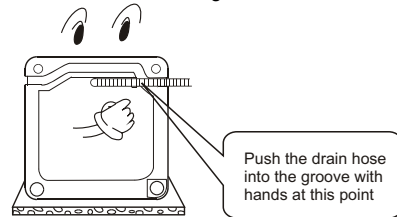

4. Install the bottom plate (as per indicated before), then lift the machine up gently.

Page 4

Usage of the drain hose

The drainage shall be smooth with the drain hose

1. Put the drain hose up to suitable position. Do not put it on ground.

Notes: the mouth of drain pipe should be higher than the water level of washing tub for avoiding to siphon phenomenon during drain.

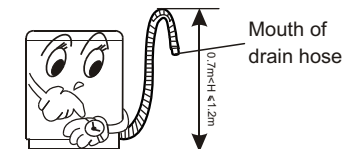

2. Do not tramp or press the drain hose.

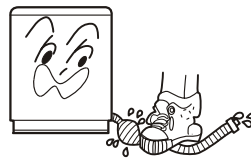

Install the water inlet hose

Confirm the water tap

Water tap, suitable



Outlet end surface

>10mm



Water tap, not suitable

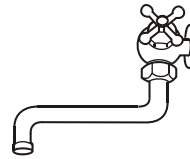

It is required that the front end shall be longer than 10mm. The outlet end surface of the tap shall be flat and smooth. If not please file it to avoid leakage.

Connection between the water inlet hose jointer and the water tap

1. Use the new water inlet hose provided with the machine to connect to the water faucet. Old hose sets should not be reused.
2. Press the lower end of the lock lever and push down the slider. Take off the water inlet hose jointer from the water inlet hose component. See to Figure 1.
3. Loosen the screw till the water tap can be accessed. Put the jointer of the water inlet hose on the tap. See to Figure 2. (If the tap diameter is too large and the jointer can not be set on the water tap, please loosen the four screws and take out the bushing in the jointer. See to the figure3.)

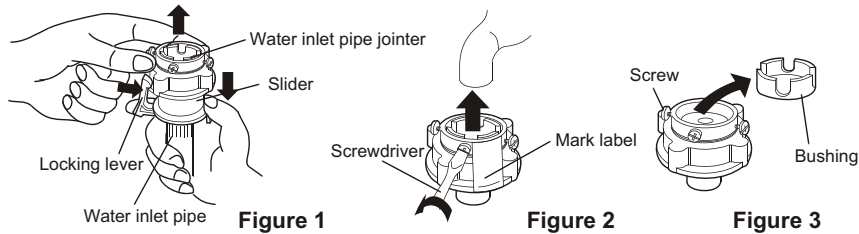

4. Fasten the four screws evenly. See to Figure 4.
5. Take off the nameplate. Twist the fastening nut as per the indication of the figure. See to Figure 5.

Remarks: Before twisting the fastening nut, the thread is 4mm above the upper surface of the nut. After twisting the fastening nut, the thread is 2mm above the upper surface of the nut. See to Figure 6.

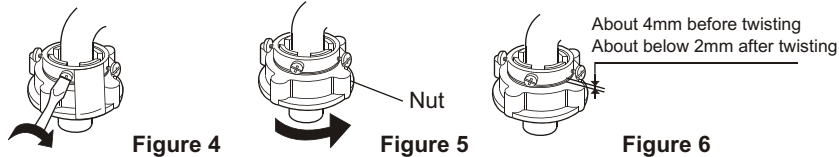



Connection between the water inlet hose and the washing machine

1. Do not take off the water absorption cushion. Please check if the cushion is dropped or damaged before each usage. If it happens please contact our after-sale department immediately.
2. Put the nut of the water inlet hose on the valve jointer.
3. Fasten the nut. Swaying it gently to confirm if it's suitable.

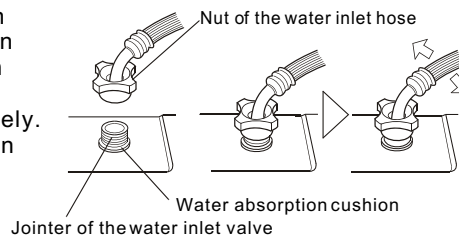

Connection between the jointer of the water inlet hose and the water inlet hose

1. Push down the slider. Insert the water inlet hose into the jointer.
2. Hang the lock lever to the jointer. Release the slider till a click sound is heard.

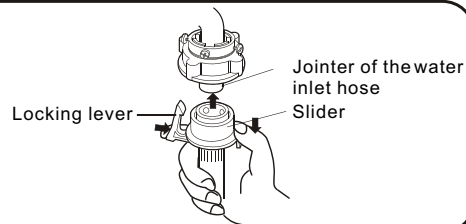

Check the connection between the jointer of the water inlet hose and the water tap

1. Swaying the hose gently to confirm if it is fastened stable.
2. After installation, open the tap to check if it leaks.
3. Do not bend the hose with overstrain.
4. Before each usage please check if the connection between the jointer of the water inlet hose and the water tap, and the installation of the water inlet hose are firm, so as to prevent dropping from improper installation position.

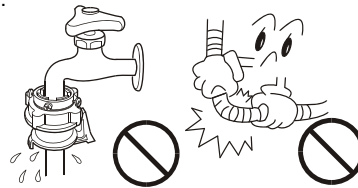

Take down the water inlet hose

1. Close the water tap.
2. Press the locking lever. Push down the slider. Then pull off the water inlet hose. If the machine is used more than once every week, the jointer of the water inlet hose can be kept on the tap to prevent damaging the fixing screw.

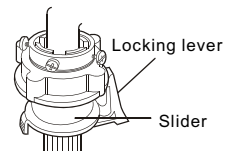

Preparation before washing







Preparation before washing

1. Connect the water inlet hose and open the water tap .
2. Confirm that the washing machine is earthed reliably . Then insert the power plug into the receptacle. Do not connect the earth terminal to the gas pipe and tap water pipe.
3. Hang up the drain hose.



Pay attention to followings before washing the laundries

<p>Confirm if there's special requirement for the laundries.</p>	<p>Clear the pocket. Take out the coins , sand, hairpins etc.</p> 	<p>Fasten the buttons and zippers.</p> 	<p>The quantity of the laundries shall not exceed the rated value. The big laundries like the jeans shall be put in loosely.</p> 	<p>When the pulsator is running , the buttons of the laundries may cause noise. For the sake of discretion, please put the laundries with buttons into other laundries.</p> 
<p>a. Please check if the laundries are applicable for washing. b. Separate those not colorfast from other laundries. c. For laundries not water absorbing, please put them into water with hands. d. For laundries with much soil, please remove the soil first. You can add detergent on the part with serious soil directly. It is much easier to remove the soil by that mean. e. For laundries likely to get lint ball or with long fiber, please first turn the inside out before putting them into the water. f. Do not put the laundries polluted with chemicals directly into the washing machine. g. For those small laundries ,laundries likely to be twisted or worn, and woolen laundries, please put them into mesh bag before washing.</p>				

Put in the laundries



- The capacity of washing and spinning of the machine refer to the largest weight of the standard laundries under dry condition that can be washed or spinned in one time. One time washing quantity shall be lower than the rated capacity.
- The thickness, size, type of the cloth will influence the actual washing capacity. It is suitable for one time washing to put in reasonable amount of laundries and the laundries can be turned round in washing.
- Do not select "4" water level for laundries less than 1.0kg, so as to avoid splashing of water.
- To wash thin laundries like the stocking, silk etc., please first put them into washing mesh bag (which can be purchased separately) before wash.

Usage of the detergent

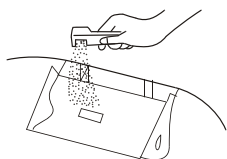

Inlet box of the detergent

How to use the whitener

- Fill water to decided level. Dilute the whitener with container. Pour it slowly into the washing tub.
- Avoid using whitener on laundries with color or pattern as they are prone to lose color.
- The whitener shall not touch the laundries directly.
- Refer to the user's manual for the usage and quantity of the whitener.
- For powder whitener, please dissolve it before use.

How to use the washing powder

- Direct dissolved in the machine
 - 1.Fill water to "Low" water level.
 - 2.Add the power. Run for 30 seconds to dissolve it completely.
 - 3.Put in the laundries. Select suitable water level.
- The instant dissolving of the washing powder:
 - 1.Prepare warm water of 30°C and a container.
 - 2.Add the powder while stirring to fully dissolve it.
- Put in the proper quantities detergent according to the water level and the laundries quantities .
- It is suggested not to use high sudsing detergent.
- Washing powder with poor quality or long time storage maybe caked. Please pay attention to cleaning the detergent box in time

Use the operation buttons

A. Description of the function of the buttons

Mode and meaning of indicator light

-
- : Flashing: indicate the running program
- On: indicate the program about to run, or indicate the selected mode

“WATER LEVEL SELECTION” button

- The use selects a suitable water level depending on the load.
- If “QUICK WASH” is selected, water level will indicate “2”. After water level reaches 2, it will wash while water filling, and wash normally upon the water level reaching “4”.
- After washing for 9 min, pressing WATER LEVEL button will enable supplemental water filling, which will stop automatically upon the water reaching overflow level.

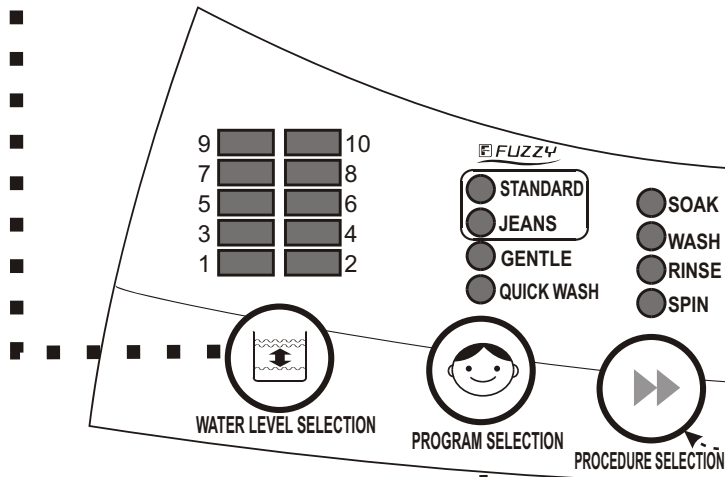

“PROGRAM SELECTION” button

- You can select from the following four programs.

Program	STANDARD	Normal wash
	JEANS	Large, thick or heavily soiled laundry
	GENTLE	Woolen textiles or underwear
	QUICK WASH	10 min quick wash for load below 2kg

“PROCEDURE SELECTION” button

- With it you can select one or several processes of soak, wash, rinse and spin.



“START/PAUSE” button

After the power is switched on, press it to start the machine.

- During working, push it to pause.
- During pause, push this button to restart and go on working.

“POWER ON/OFF” button

- Press “POWER ON/OFF” button to connect power supply.
- After power is connected, pressing this button will cut off the supply.

Numeral tube

- To indicate “-” during sensing.
- To indicate remaining min. During program running.
- To indicate remaining reserved time (hrs) during reservation period.
- To indicate fault symbols for abnormal conditions (see page 16)

Page 16

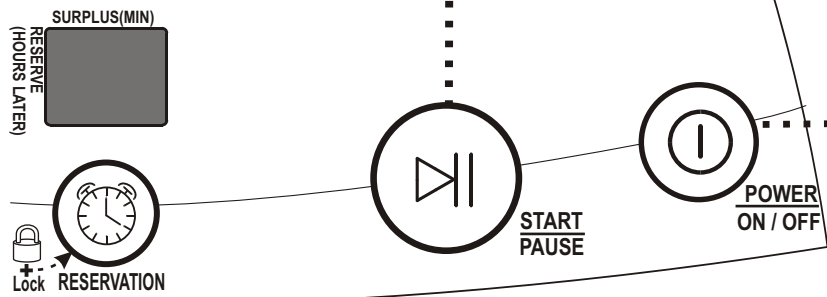

Child safety lock program

Start up: Push the RESERVATION and SPIN and POWER ON/OFF buttons at the same time. After 2 beep sounds, can set the other program. After all the program set is finished, push the START/PAUSE button, push and hold RESERVATION and SPIN buttons for more than 2 seconds at the same time. After a beep sound, the child safety lock program works; all buttons are locked and cannot be selected.

Release: push and hold RESERVATION and SPIN buttons for more than 2 seconds at the same time. After a beep sound, the child safety lock program is released.

“RESERVATION” button

- Push the button to select the reserve washing time from 2 to 24 hours.
- Pressing the button, the numeral tube displays the reserved hours to the wash cycle end. The point light flashes to indicate in-reservation.

Remarks: After pressing POWER ON/OFF to connect power supply, if the washing machine lasts idle more than 10 min, it would automatically shut off the supply.



B. Operating procedure and explanations for the buttons

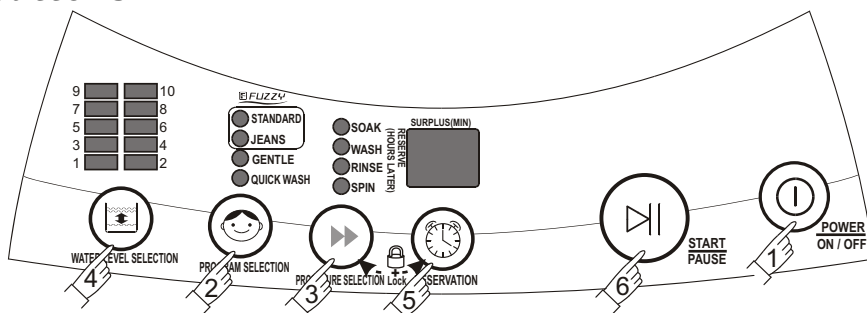

1. Push the POWER ON/OFF button to switch on the power



2. Push the PROGRAM SELECTION button to select the suitable automatic program



After switching on the power, the machine will set to STANDARD program automatically. To select other program, push the PROGRAM SELECTION button till the corresponding indicator is on. Refer to the PROGRAM SELECTION button in Page 10
For example: select QUICK WASH for the quick washing of the laundries with light dirt. 

- In selecting the STANDARD or JEANS programs, the machine will execute fuzzy program to control the complete procedure automatically according to the cloth, weight and water temperature to select water level current and washing time.

3. Push the PROCESS SELECTION button to select suitable programs



After switching on the power, the machine will set to wash-rinse-spin program automatically. That is the most common program. To select program, push the PROGRAM SELECTION button to select one or more programs among soak/wash/rinse/spin. Refer to the Selection method of the procedure programs for the selection. 



Attention

- Even there's no water in the tub, the spinning will start after a certain period.
- Do not use soak process for woolen laundries.
- Wash the laundries that are prone to lose colors separately from other laundries. The pulsator will not rotate unless the
- water is filled to selected water level.

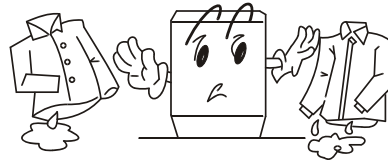

Selection method of the procedure programs

Times of pushing the "PROCEDURE SELECTION" button	Selected procedure selection	Applicable procedure	Contents (the nixie tube indicates the programs about to run)
0	Wash, rinse, spin	When the common laundries need washing, rinsing and spinning.	Soak <input type="radio"/> Wash <input type="radio"/> Rinse <input type="radio"/> Spin <input type="radio"/>
1	Wash (the washing liquid remains in the tub)	Repeat using the washing liquid	Soak <input type="radio"/> Wash <input type="radio"/> Rinse <input checked="" type="radio"/> Spin <input checked="" type="radio"/>
2	Wash, rinse (the rinsing liquid remains in the tub)	Repeat using the washing liquid	Soak <input type="radio"/> Wash <input type="radio"/> Rinse <input type="radio"/> Spin <input checked="" type="radio"/>
3	Rinse, spin	When the laundries need rinsing and spinning after manual washing	Soak <input checked="" type="radio"/> Wash <input checked="" type="radio"/> Rinse <input type="radio"/> Spin <input type="radio"/>
4	Spin (spin after drain)	When the laundries need only spinning after manual washing (first drain the spin)	Soak <input checked="" type="radio"/> Wash <input checked="" type="radio"/> Rinse <input checked="" type="radio"/> Spin <input type="radio"/>
5	Soak, wash, rinse, spin	If the laundries are very dirty, or the sleeve and collar are dirty, first soak then wash	Soak <input type="radio"/> Wash <input type="radio"/> Rinse <input type="radio"/> Spin <input type="radio"/>

- If you push the "PROCEDURE SELECTION" button for 6 times, it will resume the original mode, and it will circulate like that.
- The soak program can be used as fitting of the STANDARD & JEANS automatic programs. Soak with slight stirring before wash.

4. Push the WATER LEVEL button to select suitable water level

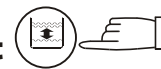

WATER LEVEL SELECTION

When the power is switched on, the washing machine will check the cloth automatically. After that, the water level is set automatically. To select other water level, push the button. Refer to the Standard usage quantity of the detergent and water quantity in Page 9 and WATER LEVEL SELECTION in Page 10 for the selection.

Page 10



Page 9





Time list of Each Program(minutes)

Program	Water level	Wash (minute)	Rinse (minute)	Spin (minute)	Total time (minute)
Standard	1~10	About 13~15	Rinse twice,each about 2	About 6	About 35~47
Jeans	1~10	About 13~15	Rinse twice,each about 2	About 6	About 35~47
Gentle	1~10	About 3	Rinse twice,each about 2	About 2	About 24
Quick wash	About 4	About 3	Rinse once, about 2	About 2	About 10

- * Total time: including the normal water inlet time and drain time.
- * Spin time: the time from intermittent running to finishing.
- * The STANDARD and JEANS automatic programs can be fitted with soaking. After water inlet, first soak for 15-45 minutes, then do wash.
- * The total washing time may be influenced by the water inlet pressure and water level.
- * When selecting QUICK WASH program,wash,rinse and spin are set automatically.。

5 .Push the " RESERVATION" button to select suitable reserve program



After switching on, the washing machine reserved wash program will be automatically set inactive. If you desire a wash cycle to end at a reserved time, you can press the "RESERVATION"button over 2 seconds to set a reserved wash program. Refer to The button of "RESERVATION" on page 11.

- Confirm the reserve program
- When "Reservation" becomes active, the nixie tube displays the time to the end of the reserved wash cycle, and the indicator turns on.
- To change the running program or cancel the reservation, you should cut off the supply and reselect.

Page 11



The washing will finish about 18 hours later

6 .Press the "START/PAUSE" button



Close the top lid

Except water filling and draining, if the top cover is opened, the washing machine will stop running and alarm.

Finish washing

The washing machine cuts off the power supply automatically when wash cycle ends.

Disposal after washing

- After using, please clean the lint and foreign materials of the lint filter etc. in time. Otherwise it may influence your using the machine.
- Please first pull off the power plug from the receptacle before cleaning.

Please rotate detergent box to control panel after clean it.

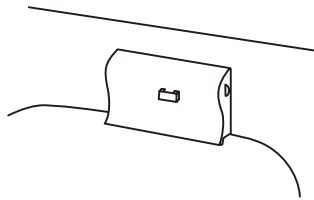

- The lint filter must be used during washing.
 - It must be cleaned in time after each using
- Lint filter:
1. Pull it up to dismantle.
 2. Push it down to install.
 3. Clean the filter screen after washing.

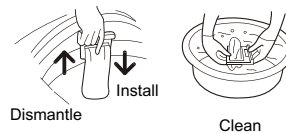

The filter screen of the water inlet valve is likely to be blocked by foreign materials and influence the water inlet. Please clean it

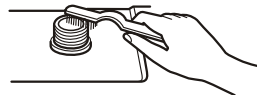

If the cabinet is dirty, wipe it with wet cloth

- Do not flush it directly with water.
- Wipe it with neutral detergent.
- Do not wipe it with thinner, petrol, alcohol etc.

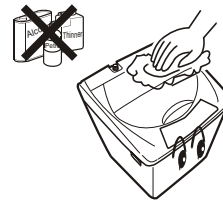

1. After washing, close the water faucet. (If needed, you can dismantle the water inlet hose).
2. Do not store water in the washing machine for a long period. Drain the water completely after each using.
3. Be sure to pull off the power plug before maintenance.
4. Hang up the power cord and drain hose.
5. Wipe off the water drops on the surface of the machine and inside the tub. Open the top lid for some time (about 1 hour), then close the top lid.

Trouble shooting • Answer to question





(If there's breakdown, please pull off the power plug before checking) The following phenomena are not breakdowns sometimes. Please confirm again before sending it to repair. If there are real breakdowns, please come to the special maintenance department or after-sale service department of our company. Do not repair it by yourself.

Phenomena	The reason	How to settle
After the reservation is started, it rings and the digital tub display "E0"	<ul style="list-style-type: none"> ● The top lid is not closed 	<ul style="list-style-type: none"> ● Close the top lid
The draining does not work, or the speed of draining is too slow. The digital tub displays "E1", and it rings.	<ul style="list-style-type: none"> ● Is the drain hose blocked by foreign material? ● Is the drain hose frozen? ● After long running of pump in the hot weather, power will be cut automatically for safe. 	<ul style="list-style-type: none"> ● Clean the foreign material. Open and close the top lid once. ● Clean the frozen material. Open and close the top lid once. ● Some minutes later the machine will continue to work.
Running pauses during spin. The digital tube displays "E2", and it rings.	<ul style="list-style-type: none"> ● The top lid is not closed 	<ul style="list-style-type: none"> ● Close the top lid
Safety switch acts, The spinning cannot work (after twice revising). The digital tube displays "E3", and it rings.	<ul style="list-style-type: none"> ● Are the laundries put slantingly? ● Is the machine slanting? 	<ul style="list-style-type: none"> ● Re-order the laundries. Close the top lid. Level the machine in right position. ● Open and close the top lid once.
It does not water inlet or the speed is slow (the water level is not reached after 15 minutes). The digital tube displays "E4", and it rings.	<ul style="list-style-type: none"> ● The water faucet open or is there water supply failure? ● The water inlet valve is blocked 	<ul style="list-style-type: none"> ● Open the water faucet. Open and close the top lid once. ● Clean the water inlet valve. Open and close the top lid once.
The machine does not act. (The indicators are off.)	<ul style="list-style-type: none"> ● Is there power failure? ● Is the power plug loose? 	<ul style="list-style-type: none"> ● Use it when the power is on ● Insert the power plug tightly.
There's abnormal sound inside the machine	<ul style="list-style-type: none"> ● Is the machine slanting? ● Are the laundries slanting in spinning? ● Is there metal material inside the washing machine? 	<ul style="list-style-type: none"> ● Level the machine properly. ● Re-order the laundries, close the top lid. ● Fasten the buttons and zipper.
The water faucet leaks	<ul style="list-style-type: none"> ● Is the jointer screw of the water inlet hose is loose or twisted awry? 	<ul style="list-style-type: none"> ● Fasten the jointer screw properly.

Common phenomena

Phenomena	Explanation
<ul style="list-style-type: none"> ● The spinning is intermittent when it starts. 	<ul style="list-style-type: none"> ● It is to balance the laundries to avoid slanting.
<ul style="list-style-type: none"> ● Pause during washing 	<ul style="list-style-type: none"> ● Supplemental water filled after fabric sensor has checked fabric (about 48 seconds).
<ul style="list-style-type: none"> ● Push the SPIN button, but it doesn't act. 	<ul style="list-style-type: none"> ● The program is setting the drain time. A certain period is needed before it starts spinning.
<ul style="list-style-type: none"> ● The pulsator pauses during water filling in washing and rinsing. 	<ul style="list-style-type: none"> ● It is to avoid splashing during water filling.
<ul style="list-style-type: none"> ● There may be some water flowing out of the drain hose in the first use of the machine. 	<ul style="list-style-type: none"> ● It is the water remained in the machine during the ex-factory performance inspection.

Packing list

Name	Quantity	Storage position
<ul style="list-style-type: none"> ● User's manual 	<ul style="list-style-type: none"> ● One piece 	<ul style="list-style-type: none"> ● Inside the document bag
<ul style="list-style-type: none"> ● Guarantee 	<ul style="list-style-type: none"> ● One piece 	<ul style="list-style-type: none"> ● Inside the document bag
<ul style="list-style-type: none"> ● Components of the water inlet hose 	<ul style="list-style-type: none"> ● One piece 	<ul style="list-style-type: none"> ● Inside the accessory bag
<ul style="list-style-type: none"> ● Lint filter 	<ul style="list-style-type: none"> ● One piece 	<ul style="list-style-type: none"> ● Inside the document bag
<ul style="list-style-type: none"> ● Bottom plate 	<ul style="list-style-type: none"> ● One piece 	<ul style="list-style-type: none"> ● Between the upper cushion of the washing machine package and the upper seal of the package carton
<ul style="list-style-type: none"> ● Tapping screws 	<ul style="list-style-type: none"> ● Eight piece 	<ul style="list-style-type: none"> ● Inside the document bag
<ul style="list-style-type: none"> ● Full automatic washing machine 	<ul style="list-style-type: none"> ● One set 	

0030807167