

Let's play follow
the leader!



FastForward User Guide

Siemens A56, S56, CT56, SL56 Phones



 cingular
fits you bestSM

Siemens Phones Supported



Wireless phone requires Cingular Service Plan

Welcome

Thank you for purchasing Cingular's *FastForward*. Now you can easily forward incoming calls made to your Cingular Wireless phone to your existing home or work phone.

This user guide will provide you with everything you need to set up and enjoy the convenience of seamless call forwarding from your wireless phone to another location.

There are numerous other benefits too. They are shared throughout this guide.

The phone book within your compatible handset must be set up prior to using the *FastForward* device.

Quick Start

Set Up

1. Plug the power supply into the back of the *FastForward* device and insert into an electrical outlet. **WARNING:** Do not plug the *FastForward* power connector directly into your handset. This could potentially damage your handset.
2. Place the device on a convenient flat surface with good wireless coverage.
3. Create a new phone book entry in your wireless phone with the name "Cf1" → see page 7 for complete instructions.
4. In the Cf1 entry location, store the phone number for the location to which you would like incoming wireless calls forwarded.
5. Place the Cf Selector Switch, located on the bottom of the device, into the Cf1 position.
6. The phone must be turned on for call forwarding to work.

That's it! Your *FastForward* is now ready for use.

To Start Call Forwarding

1. Simply insert your wireless phone into the *FastForward* device.
2. The Forward indicator on the device will illuminate indicating your incoming wireless calls are now forwarded. In order for the *FastForward* device to work properly, the handset should be turned on and not engaged with an active call when placed on the *FastForward* device.
3. An added bonus is that your wireless phone's battery will be charged while it is in the device.

NOTE: Any unanswered FastForward call will be treated as a normal landline call is treated today.

To Cancel Call Forwarding

1. With your wireless phone in the *FastForward* device, press the Cancel button on the front of the *FastForward* device. Your wireless handset should be turned on and not engaged with an active call while canceling call forwarding.
2. The Forward indicator will extinguish after several seconds.
3. You may now remove your wireless phone.

Contents

Features of the <i>FastForward</i>	5
Using <i>FastForward</i>	6
Setting Up Your Siemens Wireless Phone	7-8
Setting Up a 2nd <i>FastForward</i>	9-11
Making Calls on Your Wireless Phone While Call Forwarded	12
Canceling Call Forwarding from Your Wireless Phone	13
Warning Alerts	14-15
Frequently Asked Questions	16-17
Warranty	back cover
Additional Support	back cover

Features

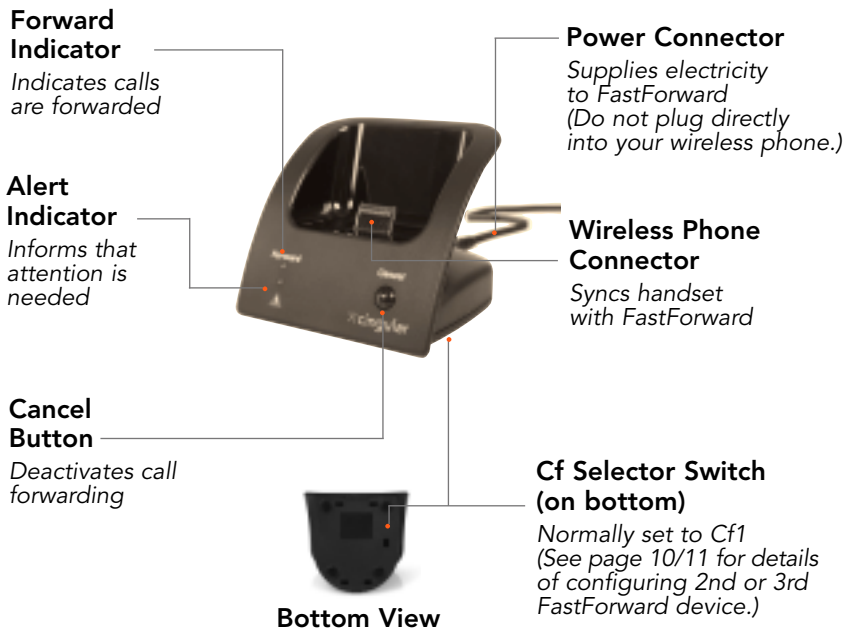

Using *FastForward*

FastForward allows you to forward your incoming wireless calls to your local home or office number. It's simple to use and easy to set up. Once you've established and set up your forwarding number (see page 7), just insert your wireless phone into the device cradle and your calls are now forwarded. To cancel call forward, simply press the Cancel button, wait for the Forward indicator to extinguish, and remove the handset from the device.

For example, when you walk in the door at home, insert your Cingular Wireless phone into the device, and calls that would have gone to your wireless phone will now ring all landline telephones in your home that operate on the forwarded-to number.

When leaving your home, simply press the Cancel button on the device, and incoming wireless calls are redirected to your wireless phone. *FastForward* works the same way when you're forwarding wireless calls to your office number.

FastForward is compatible with the Siemens A56, S56, CT56 and SL56 series of phones from Cingular Wireless.

Setting Up Your Siemens Wireless Phone

If you have the A56 or CT56 series phone or have the Phonebook selected as your default book on the S56 or SL56 series phone:

1. Select **Menu**
2. Scroll to **Phonebook** and press **Select**
3. Scroll to **New Entry** and press **Select**
4. Scroll to **Number**. Type in the number you would like your wireless calls to be forwarded to. For example, if you are setting up the device in your house and your home phone number is 404-555-1234, use the wireless phone's key pad to enter the number.
5. Scroll to **Name**. Using the wireless phone's key pad with corresponding alphabet letters, key in "Cf1."
 - Press the 2 key 3 times "**222**" for "C"
 - Press the 3 key 3 times "**333**" for "f"
 - Press the 1 key 2 times "**11**" for "1"
6. Select **Save**

Setting Up Your Siemens Wireless Phone *(cont'd)*

If you have the S56 or SL56 series phone and have the **Addressbook** selected as your default book:

1. Select **Menu**
2. Scroll to **Addressbook** and press **Select**
3. Scroll to **New Entry** and press **Select**
4. Scroll to **Last Name**. Using the wireless phone's key pad with corresponding alphabet letters, key in "Cf1."
 - Press the 2 key 3 times "222" for "C"
 - Press the 3 key 3 times "333" for "f"
 - Press the 1 key 3 times "111" for "1"
5. Scroll to **Phone**. Type in the number you would like your wireless calls to be forwarded to. For example, if you are setting up the device in your house and your home phone number is 404-555-1234, use the wireless phone's key pad to enter the number.
6. Select **Options**. Select **Save**

NOTE: The length of time to call forward depends on the total number of entries within the phone book. Please allow a few extra moments for the phone book to synchronize and locate the Cf entry.

Setting Up A 2nd FastForward

You may want to purchase a second *FastForward* for use at your office to forward your wireless calls to your business number. Follow the instructions below to set up additional devices.

If you have the A56 or CT56 series phone or have the **Phonebook** selected as your default book on the S56 or SL56 series phone:

1. Select **Menu**
2. Scroll to **Phonebook** and press **Select**
3. Scroll to **New Entry** and press **Select**
4. Scroll to **Number**. Type in the number you would like your wireless calls to be forwarded to.
5. Scroll to **Name**. Using the wireless phone's key pad with corresponding alphabet letters, key in "Cf2."
 - Press the 2 key 3 times "222" for "C"
 - Press the 3 key 3 times "333" for "f"
 - Press the 2 key 4 times "2222" for "2"
6. Select **Save**

Setting Up A 2nd *FastForward* (cont'd)

If you have the S56 or SL56 series phone and have the **Addressbook** selected as your default book:

1. Select **Menu**
2. Scroll to **Addressbook** and press **Select**
3. Scroll to **New Entry** and press **Select**
4. Scroll to **Last Name**. Using the wireless phone's key pad with corresponding alphabet letters, key in "Cf2."
 - Press the 2 key 3 times "222" for "C"
 - Press the 3 key 3 times "333" for "f"
 - Press the 2 key 4 times "2222" for "2"
5. Scroll to **Phone**. Type in the number you would like your wireless calls to be forwarded to.
6. Select **Options**. Select **Save**

Verify that Cf2 is present in the phone book and that the desired telephone number is programmed in the wireless phone's address book.

For the second device, slide the Cf Selector Switch (located on the bottom of the device) to the second position. Your second device is now ready to use.

A third device may be set up to forward wireless phone calls while at a vacation home or lake house in your local calling area. To set up your third *FastForward* device and location, follow the same steps as above using Cf3. Your wireless phone can work with up to three *FastForward* devices.

Making Wireless Calls While Call Forwarded

You may still place outgoing calls from your wireless phone while your incoming calls are forwarded to another number. Simply remove the wireless phone from the *FastForward* device without pressing the Cancel button. The *FastForward* device will sound and flash an alert to remind you that incoming calls are still forwarded. You may now place outgoing calls as normal.

This feature is great when the kids are on the home phone and you need to make a call. When you have completed your call, simply replace the handset back into the base. As always, when you are ready to stop forwarding calls, simply press the Cancel button and allow the Forward indicator to extinguish before removing the handset.

Canceling Call Forwarding From Your Wireless Phone

Canceling call forwarding is easy. Just press the Cancel button on the front of the *FastForward* device and wait for the Forward indicator to extinguish before removing the handset.

If your wireless phone is removed from the device without pressing the Cancel button, your wireless calls are still forwarded to the number you indicated. You can still cancel call forwarding from your wireless phone by pressing **##21# Send**.

When you arrive back at the *FastForward* device, the Forward indicator may still be illuminated. You may simply insert your wireless phone to re-establish call forwarding or press the Cancel button to extinguish the Forward indicator.



NOTE: GSM call forwarding indicator on your handset may not correlate with the Forward indicator on your FastForward device.

Warning Alerts

FastForward provides visual and audio warnings to alert you to conditions requiring your attention.



- The  indicator on the front provides visual warning while an internal speaker provides audio indications.

- The *FastForward* device will rapidly flash the  indicator and sound a high-low alert for 3 seconds if the wireless phone is removed without pressing the Cancel button. This alerts you that the phone is still call forwarded. Simply replace the phone in the device, press the Cancel button, and the Forward indicator will extinguish, indicating that call forwarding is deactivated and you may remove the wireless phone.
- The *FastForward* device will slowly flash the  indicator and sound a low alert for 5 seconds if there is no Cf1, Cf2, or Cf3 programmed into the wireless phone's address book – verify the Cf programming of the wireless phone and verify the position of the Cf switch on the bottom of the device.
- The *FastForward* device will flash the  indicator in an "On, On, Off" pattern and sound a high alert for 5 seconds if there is an issue with the device communicating with the wireless phone or the wireless network – verify that the wireless phone is turned on, there is good coverage, there is not an active call, and try re-inserting the wireless phone.

Frequently Asked Questions

Q: How many *FastForward* devices can I have with each wireless phone?

A: Up to three devices can be supported for each wireless phone.

Q: Will my wireless phone ring when placed in *FastForward*?

A: When your handset is placed on the device and the Forward indicator is on, the handset will not ring. All incoming wireless calls will now ring the forwarded number you've indicated. Also, if you remove your handset without pressing the Cancel button, your wireless phone will not ring. Until the Cancel button is pressed with the wireless phone inserted into the device cradle, all wireless calls are still forwarded.

Q: Will the distinctive ring calling feature work with *FastForward*?

A: Yes. In order for the distinctive ring feature to work properly, the distinctive ring number must be programmed into your phone book as the phone number you would like to forward to. Distinctive ring service is an optional feature typically offered by local phone companies for a monthly fee. Contact your local phone company for information, pricing, and availability.

Q: How do I cancel call forwarding from my *FastForward* device?

A: To cancel call forwarding with the wireless phone inserted into the device, press the Cancel button, wait for the Forward indicator to extinguish and then remove the phone from the device. (Pressing the Cancel button after the wireless phone has been removed will not deactivate call forwarding. The Cancel button must be pressed before removing the phone.)

Q: Can I forward my calls to a long-distance number?

A: No, wireless calls may only be forwarded to local landline numbers.

Q: Can I use any wireless phone in conjunction with *FastForward*?

A: No, only select Cingular Wireless phones can be used. See inside front cover of manual for compatible handsets.

Q: Can I send/receive a text message when my handset is in the *FastForward* device?

A: Yes. You can send or receive text messages on your wireless phone when it is in the device. Standard text messaging charges will apply.

One-Year Limited Warranty

What Is Covered: Cingular Wireless warrants to the first retail purchaser of this wireless accessory that should this product or any part be proved defective in materials or workmanship, from the date of proof of purchase for a period of one (1) year, then it will be subject to the terms of this one-year limited warranty. Such defects will be repaired, replaced or credit issued in an amount up to but in no event exceeding the sales price paid by the first retail purchaser at Cingular's option and sole discretion, without charge for parts or labor directly related to the defect.

Limitations and Exclusions: This warranty does not apply to any cost incurred for removal or reinstallation, or to any product or part thereof which has suffered through normal wear and tear, alteration, improper installation, physical abuse, misuse, neglect or accident. Nor does it cover defects caused by shipment to a Cingular Wireless service center, or repair or service of the product by anyone other than a Cingular Wireless service center. Damage resulting from an act of God, including but not limited to fire, flood, earthquake and other natural disasters, will be excluded. **This limited warranty is in lieu of all other warranties, express or implied either in fact or by operations of law, statutory or otherwise, including, but not limited to, any implied warranty of merchantability or fitness for a particular use.** Cingular Wireless does not authorize any other person to assume any liability beyond the warranty herein described. In no event, whether based in contract, tort or any other legal theory, shall Cingular Wireless or any of its agents or sellers be liable for incidental, consequential, indirect, special, or punitive damages of any kind resulting from the use of this product, including but not limited to interrupted or incomplete phone calls, or failure to forward calls even where such failure is the result of error, omission or negligence arising out of any breach of this warranty. In no event shall Cingular Wireless or its agents or sellers be liable for any damages however defined in an amount in excess of the purchase price.

Additional Support

For answers to questions or help in setting up or using your FastForward, please contact Cingular Wireless at:

- www.cingular.com
- *611 from your wireless phone
- 1-866-CINGULAR (1-866-246-4852)