

Installation Manual

5.8 GHz Expandable Digital Cordless Handset

Model No. **KX-TGA560**

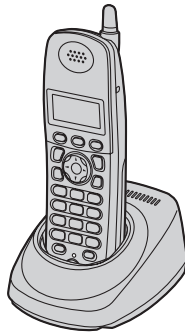

Thank you for purchasing a Panasonic cordless telephone.

This handset is an accessory handset for use with Panasonic base units KX-TG5622/KX-TG5632/KX-TG5633/KX-TG5652/KX-TG5672. You must register this handset with your base unit before it can be used. This installation manual describes only the steps needed to register and begin using the handset. Please read the base unit's operating instructions for further details.

Charge the battery for 7 hours before initial use.

Please read this Installation Manual before using the unit and save for future reference.

For assistance, visit our website:

<http://www.panasonic.com/phonehelp> for customers in the U.S.A. or Puerto Rico.

Accessory information

Included accessories

Accessory item	Order number	Quantity	
		KX-TGA560B	KX-TGA560M
Charger	PQLV30042ZB	1	–
	PQLV30042ZM	–	1
AC adaptor for charger	KX-TCA1-2 or PQLV256 ^{*1}	1	1
Battery	HHR-P104	1	1
Handset cover ^{*2}	PQYNTG5633BR	1	–
	PQYNTG5632MR	–	1

*1 Both of the AC adaptors function well with the charger.

*2 The handset cover comes attached to the handset.

Sales and support information

- To order replacement accessories, call 1-800-332-5368.
- TTY users (hearing or speech impaired users) can call 1-866-605-1277.

Setting up the handset

Connecting the charger

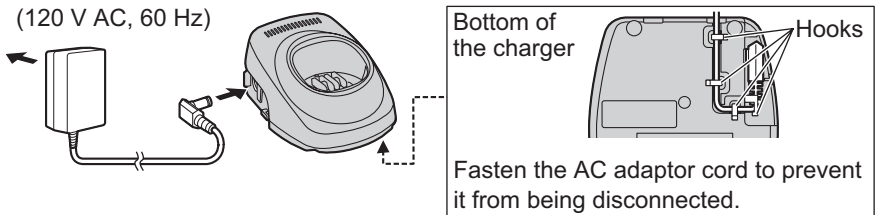

Note:

- Use only the included Panasonic AC adaptor KX-TCA1 or PQLV256.
- The AC adaptor must remain connected at all times. (It is normal for the adaptor to feel warm during use.)

- The AC adaptor should be connected to a vertically oriented or floor-mounted AC outlet. Do not connect the AC adaptor to a ceiling-mounted AC outlet, as the weight of the adaptor may cause it to become disconnected.

Battery installation

- 1 Press the notch of the handset cover firmly, and slide it in the direction of the arrow.



- 2 Insert the battery (1), and press it down until it snaps into the compartment (2). Then close the handset cover.

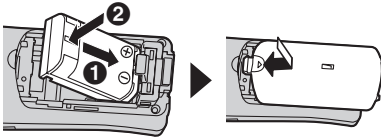

Attention:



A nickel metal hydride battery that is recyclable powers the product you have purchased.

Please call 1-800-8-BATTERY (1-800-822-8837) for information on how to recycle this battery.

Battery charge

Place the handset on the charger for **7 hours** before initial use.



Note:

- If you want to use the unit immediately, charge the battery for at least 15 minutes.
- To ensure that the battery charges properly, clean the charge contacts of the handset and charger with a soft, dry cloth once a month. Clean more often if the unit is subject to the exposure of grease, dust, or high humidity.

Panasonic battery performance

Operation	Operating time
While in use (talking)	Up to 5 hours
While not in use (standby)	Up to 11 days
While using the clarity booster feature	Up to 3 hours

Note:

- The handset can be left on the charger without any ill effect on the battery.
- The battery level may not be displayed correctly after you replace the battery. In this case, place the handset on the charger and let charge for 7 hours.

Registration

Register the handset to a KX-TG5622/KX-TG5632/KX-TG5633/KX-TG5652/KX-TG5672 base unit.

Important:

- If you accidentally assign another handset's extension number to the base unit, the originally assigned handset stops functioning. Confirm the extension number of a previously registered handset by placing it on the base unit or charger. Lift the handset from the charger before registering.

1 Base unit:

Select an unregistered extension number.

KX-TG5622:

Press and hold [**1**], [**2**], or [**3**] until the CHARGE indicator flashes.

KX-TG5632/KX-TG5633/KX-TG5652:

Press [**SELECT**] until the desired extension number (*H 1*, *H 2*, *H 3*, or *H 4*) is displayed on the base unit, then press and hold [**CALL**] until the CHARGE indicator flashes.

KX-TG5672:

Press and hold [**INTERCOM**] until the CHARGE indicator flashes, then press [**1**], [**2**], or [**3**].

- After the CHARGE indicator starts flashing, the rest of the procedure must be completed within 1 minute.

2 Handset:

Press [**OK**], then wait until the handset beeps.

Changing the display language

1 [**MENU**] → [**0**]**[8]**

2 Select the desired setting.

3 Press the right soft key to save. →
[OFF]

Headset (optional)

Connecting a headset to the handset allows hands-free phone conversations. Please use only a Panasonic KX-TCA60/KX-TCA86/KX-TCA88HA/KX-TCA91/KX-TCA92/KX-TCA98 headset. See page 2 for ordering information.



- Headset shown is KX-TCA86.

Note:

- To switch to the handset speakerphone, press [**☎**]. To return to the headset, press [**↶**].

Wall mounting

- 1 Drive the screws (not included) into the wall using the wall template as a guide.

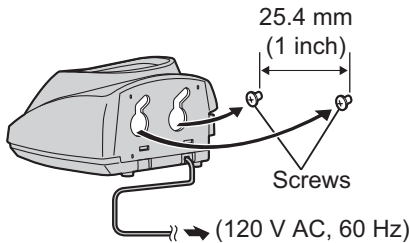

- 2 Mount the charger (1), then slide it down (2) and to the right (3) until it is secure.

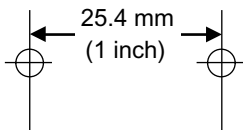
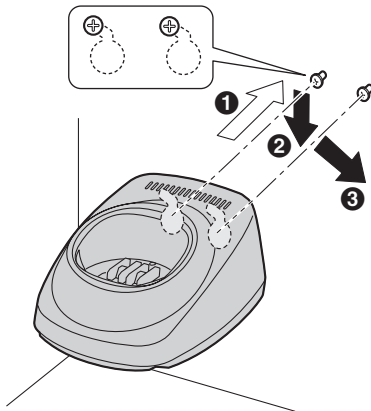

Specifications

General

Operating environment:

5 °C – 40 °C (41 °F – 104 °F)

Handset

Frequency:

5.76 GHz – 5.84 GHz

Dimensions:

Approx. height 173 mm x width 48 mm x depth 33 mm (6¹³/₁₆" x 1⁷/₈" x 1⁵/₁₆")

Mass (Weight):

Approx. 170 g (0.37 lb.)

Power output:

200 mW (max.)

Power supply:

Ni-MH battery (3.6 V, 830 mAh)

Charger

Dimensions:

Approx. height 51 mm x width 88 mm x depth 100 mm (2" x 3¹⁵/₃₂" x 3¹⁵/₁₆")

Mass (Weight):

Approx. 94 g (0.21 lb.)

Power consumption:

Standby: Approx. 0.8 W/0.3 W
(KX-TCA1/PQLV256)

Maximum: Approx. 3.6 W/2.4 W
(KX-TCA1/PQLV256)

Power supply:

AC adaptor (120 V AC, 60 Hz)

FCC and other information

This equipment is hearing aid compatible as defined by the FCC in 47 CFR Section 68.316.

When you hold the phone to your ear, noise might be heard in your Hearing Aid. Some Hearing Aids are not adequately shielded from external RF (radio frequency) energy. If noise occurs, use an optional headset accessory or the speakerphone option (if applicable) when using this phone. Consult with your audiologist or Hearing Aid manufacturer about the availability of Hearing Aids which provide adequate shielding to RF energy commonly emitted by digital devices.

WHEN PROGRAMMING EMERGENCY NUMBERS AND/OR MAKING TEST CALLS TO EMERGENCY NUMBERS:

- 1) Remain on the line and briefly explain to the dispatcher the reason for the call.
- 2) Perform such activities in the off-peak hours, such as early morning or late evenings.

This device complies with Part 15 of the FCC Rules. Operation is subject to the following two conditions:

(1) This device may not cause harmful interference, and (2) this device must accept any interference received, including interference that may cause undesired operation.

Privacy of communications may not be ensured when using this phone.

CAUTION:

Any changes or modifications not expressly approved by the party responsible for compliance could void the user's authority to operate this device.

NOTE:

This equipment has been tested and found to comply with the limits for a Class B digital device, pursuant to Part 15 of the FCC Rules. These limits are designed to provide reasonable protection against harmful interference in a residential installation. This equipment generates, uses, and can radiate radio frequency energy and, if not installed and used in accordance with the instructions, may cause harmful interference to radio communications. However, there is no guarantee that interference will not occur in a particular installation. If this equipment does cause harmful interference to radio or television reception, which can be determined by turning the equipment off and on, the user is encouraged to try to correct the interference by one or more of the following measures:

- Reorient or relocate the receiving antenna.
- Increase the separation between the equipment and receiver.
- Connect the equipment into an outlet on a circuit different from that to which the receiver is connected.
- Consult the dealer or an experienced radio/TV technician for help.

FCC RF Exposure Warning:

The product complies with FCC radiation exposure limits set forth for an uncontrolled environment. The handset may be carried and operated with only the specific provided belt-clip. Other non-tested belt-clips or similar body-worn accessories may not comply and must be avoided. The handset must not be collocated or operated in conjunction with any other antenna or transmitter.

CAUTION:

Installation

- Operating near 5.8 GHz electrical appliances may cause interference. Move away from the electrical appliances.
- The AC adaptor is used as the main disconnect device. Ensure that the AC outlet is installed near the product and is easily accessible.

Battery

To reduce the risk of fire or injury to persons, read and follow these instructions.

- Use only the battery(ies) specified.
- Do not dispose of the battery(ies) in a fire. They may explode. Check with local waste management codes for special disposal instructions.
- Do not open or mutilate the battery(ies). Released electrolyte is corrosive and may cause burns or injury to the eyes or skin. The electrolyte may be toxic if swallowed.
- Exercise care when handling the battery(ies). Do not allow conductive materials such as rings, bracelets or keys to touch the battery(ies), otherwise a short circuit may cause the battery(ies) and/or the conductive material to overheat and cause burns.

- Charge the battery(ies) provided, or identified for use with the product only, in accordance with the instructions and limitations specified in this manual.

WARNING:

- To prevent the risk of fire or electrical shock, do not expose the product to rain or any type of moisture.
- Unplug the product from power outlets if it emits smoke, an abnormal smell, or makes an unusual noise. These conditions can cause fire or electric shock. Confirm that smoke has stopped and contact the Panasonic Call Center at 1-800-211-PANA (1-800-211-7262).

Notice

- This product is designed for use in the United States of America. Sale or use of this product in other countries may violate local laws.
- Cet appareil est conçu pour être utilisé aux États-Unis d'Amérique. La vente ou l'emploi de cet appareil dans certains autres pays peut constituer une infraction à la législation locale.
- Este producto está diseñado para usarse en los Estados Unidos de América. La venta o el empleo de este producto en ciertos países puede constituir violación de la legislación local.
- この製品は、日本国外での使用を目的として設計されており、日本国内での使用は法律違反となります。従って、当社では日本国内においては原則として修理などのサービスは致しかねます。

Customer services

Customer Services Directory

Obtain Product Information and Operating Assistance; locate your nearest Dealer or Servicenter; purchase Parts and Accessories; or make Customer Service and Literature requests by visiting our Web Site at:

<http://www.panasonic.com/consumersupport>

or, contact us via the web at:

<http://www.panasonic.com/contactinfo>

You may also contact us directly at: 1-800-211-PANA (1-800-211-7262),
Monday-Friday 9 am-9 pm; Saturday-Sunday 10 am-7 pm, EST.

TTY users (hearing or speech impaired users) can call 1-877-833-8855.

Accessory Purchases

Purchase Parts, Accessories and Instruction Books online for all Panasonic Products by visiting our Web Site at:

<http://www.pasc.panasonic.com>

or, send your request by E-mail to:

npcparts@us.panasonic.com

You may also contact us directly at:

1-800-332-5368 (Phone) 1-800-237-9080 (Fax Only)

(Monday - Friday 9 am to 8 pm, EST.)

Panasonic Services Company

20421 84th Avenue South, Kent, WA 98032

(We Accept Visa, MasterCard, Discover Card, American Express, and Personal Checks)

TTY users (hearing or speech impaired users) can call 1-866-605-1277.

Service in Puerto Rico

Panasonic Puerto Rico, Inc.

San Gabriel Industrial Park, Ave. 65 de Infantería, Km. 9.5,

Carolina, Puerto Rico 00985

Phone (787)750-4300, Fax (787)768-2910

Warranty

**PANASONIC CONSUMER ELECTRONICS
COMPANY, DIVISION OF PANASONIC
CORPORATION OF NORTH AMERICA**
One Panasonic Way,
Secaucus, New Jersey 07094

PANASONIC PUERTO RICO, INC.
San Gabriel Industrial Park,
Ave. 65 de Infantería, Km. 9.5,
Carolina, Puerto Rico 00985

Panasonic Telephone Limited Warranty

Limited Warranty Coverage

If your telephone (identified in your Operating Instructions) does not work properly because of a defect in materials or workmanship, Panasonic Consumer Electronics Company or Panasonic Puerto Rico, Inc. (collectively referred to as "the warrantor") will, for the length of the period indicated on the chart below, which starts with the date of original purchase ("Limited Warranty period"), at its option either (a) repair your product with new or refurbished parts, or (b) replace it with a new or a refurbished product. The decision to repair or replace will be made by the warrantor.

Parts

One (1) Year

Labor

One (1) Year

 During the "Labor" Limited Warranty period there will be no charge for labor. During the "Parts" Limited Warranty period, there will be no charge for parts. You must mail-in your product prepaid during the Limited Warranty period. This Limited Warranty excludes both parts and labor for batteries, antennas, and cosmetic parts (cabinet). This Limited Warranty only applies to products purchased and serviced in the United States or Puerto Rico. This Limited Warranty is extended only to the original purchaser and only covers products purchased as new. A purchase receipt or other proof of the original purchase date is required for warranty service.

To obtain service in the USA please contact:

Panasonic Services Company, Panasonic Plus Department
20421 84th Avenue South
Kent, WA 98032
Tel: 1-800-833-9626 Fax: 1-800-237-9080

For assistance in Puerto Rico call Panasonic Puerto Rico, Inc. (787)-750-4300 or fax (787)-768-2910.

For Limited Warranty service for headsets if a headset is included with this product please call Panasonic Plus Department at 1-800-833-9626.

When shipping the unit carefully pack, include all accessories, and send it prepaid, adequately insured and preferably in the original carton. Include a letter detailing the complaint, a return address and a day time phone number where you can be reached.

Limited Warranty Limits And Exclusions

This Limited Warranty ONLY COVERS failures due to defects in materials or workmanship, and DOES NOT COVER normal wear and tear or cosmetic damage. The Limited Warranty ALSO DOES NOT COVER damages which occurred in shipment, or failures which are caused by products not supplied by the warrantor, or failures which result from accidents, misuse, abuse, neglect, bug infestation, mishandling, misapplication, alteration, faulty installation, set-up adjustments, misadjustment of consumer controls, improper maintenance, power line surge, lightning damage, modification, introduction of sand, humidity or liquids, commercial use such as hotel, office, restaurant, or other business or rental use of the product, or service by anyone other than a Factory Servicenter or other Authorized Servicer, or damage that is attributable to acts of God.

THERE ARE NO EXPRESS WARRANTIES EXCEPT AS LISTED UNDER “LIMITED WARRANTY COVERAGE”. THE WARRANTOR IS NOT LIABLE FOR INCIDENTAL OR CONSEQUENTIAL DAMAGES RESULTING FROM THE USE OF THIS PRODUCT, OR ARISING OUT OF ANY BREACH OF THIS LIMITED WARRANTY. (As examples, this excludes damages for lost time, lost calls or messages, cost of having someone remove or re-install an installed unit if applicable, travel to and from the servicer. The items listed are not exclusive, but are for illustration only.) **ALL EXPRESS AND IMPLIED WARRANTIES, INCLUDING THE WARRANTY OF MERCHANTABILITY, ARE LIMITED TO THE PERIOD OF THE LIMITED WARRANTY.**

Some states do not allow the exclusion or limitation of incidental or consequential damages, or limitations on how long an implied warranty lasts, so the exclusions may not apply to you.

This Limited Warranty gives you specific legal rights and you may also have other rights which vary from state to state. If a problem with this product develops during or after the Limited Warranty period, you may contact your dealer or Servicenter. If the problem is not handled to your satisfaction, then write to the warrantor's Consumer Affairs Department at the addresses listed for the warrantor.

PARTS AND SERVICE, WHICH ARE NOT COVERED BY THIS LIMITED WARRANTY, ARE YOUR RESPONSIBILITY.

If you need assistance with setup or operation

- 1** Visit our website: <http://www.panasonic.com/phonehelp>
- 2** Contact us via the web at: <http://www.panasonic.com/contactinfo>
- 3** Call us at: 1-800-211-PANA (1-800-211-7262) or 1-800-833-9626
TTY users (hearing or speech impaired users) can call 1-877-833-8855.

When you ship the product

- Carefully pack your unit, preferably in the original carton.
- Attach a letter, detailing the symptom, to the outside of the carton.
- Send the unit to Panasonic Services Company Customer Servicercenter, prepaid and adequately insured.
- Do not send your unit to Panasonic Consumer Electronics Company listed below or to executive or regional sales offices. These locations do not repair consumer products.

**Panasonic Consumer Electronics Company,
Division of Panasonic Corporation of North America**
One Panasonic Way, Secaucus, New Jersey 07094

Panasonic Puerto Rico, Inc.
San Gabriel Industrial Park, Ave. 65 de Infantería, Km. 9.5,
Carolina, Puerto Rico 00985

Copyright:

This material is copyrighted by Panasonic Communications Co., Ltd., and may be reproduced for internal use only. All other reproduction, in whole or in part, is prohibited without the written consent of Panasonic Communications Co., Ltd.
© 2005 Panasonic Communications Co., Ltd. All Rights Reserved.

Manual de instalación

Teléfono Inalámbrico Digital Expandible de 5,8 GHz

Modelo N°. **KX-TGA560**

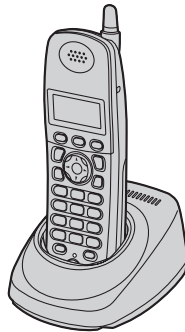

Gracias por adquirir un teléfono inalámbrico Panasonic.

Este auricular es un accesorio para usarse con las unidades base Panasonic KX-TG5622/KX-TG5632/KX-TG5633/KX-TG5652/KX-TG5672. Debe registrar este auricular en su unidad base antes de poder usarlo.

Este manual de instalación sólo describe los pasos necesarios para registrar y comenzar a usar el auricular. Lea las instrucciones de operación de la unidad base para obtener mayores detalles.

Cargue la batería durante 7 horas antes de utilizar por primera vez.

Lea este manual de instalación antes de usar la unidad y guárdelo para consultarlo en el futuro.

Para obtener ayuda, visite nuestro sitio web:

<http://www.panasonic.com/phonehelp> para clientes de Estados Unidos o Puerto Rico.

Información de los accesorios

Accesorios incluidos

Accesorio	Número de pedido	Cantidad	
		KX-TGA560B	KX-TGA560M
Carga	PQLV30042ZB	1	–
	PQLV30042ZM	–	1
Adaptador para corriente (para el cargador)	KX-TCA1-2 or PQLV256 ^{*1}	1	1
Batería	HHR-P104	1	1
Tapa del auricular ^{*2}	PQYNTG5633BR	1	–
	PQYNTG5632MR	–	1

*1 Los dos adaptadores para corriente funcionan bien con el cargador.

*2 La cubierta del auricular viene unida a él.

Información de ventas y respaldo

- Para pedir accesorios de repuesto, llame al 1-800-332-5368.
- Los usuarios TTY (usuarios con impedimentos auditivos o del habla) pueden llamar al 1-866-605-1277.

Instalación del auricular

Conexión del cargador

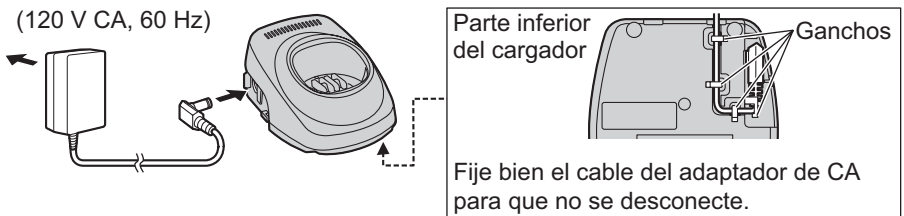

Nota:

- Use sólo el adaptador para corriente Panasonic KX-TCA1 o PQLV256 incluido.
- Los adaptadores para corriente deben permanecer conectados todo el tiempo. (Es normal que el adaptador se caliente durante su uso.)

- El adaptador para corriente debe estar conectado a un enchufe de corriente orientado verticalmente o en una toma de corriente alterna montada en el piso. No conecte el adaptador para corriente alterna a una toma de corriente montada en el techo, ya que el peso del adaptador puede hacer que se desconecte.

Instalación de la batería

- 1 Oprima firmemente el seguro de la cubierta del auricular y deslícelo en dirección de la flecha.

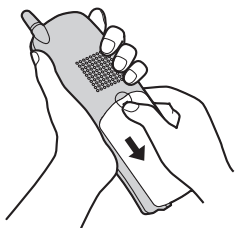

- 2 Inserte la batería (1), y presiónela hasta que encaje en el compartimiento (2). Después, cierre la tapa del auricular.

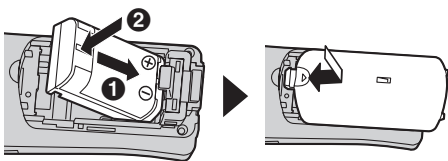

Carga de la batería

Coloque el auricular en el cargador durante **7 horas** antes de usarlo por primera vez.



Nota:

- Si desea utilizar la unidad de inmediato, cargue la batería durante un mínimo de 15 minutos.
- Para asegurarse de que la batería se cargue correctamente, limpie los contactos de carga del auricular y el cargador con un paño suave y seco una vez al mes. Límpielos con mayor frecuencia si la unidad está sujeta a grasa, polvo o un alto nivel de humedad.

Rendimiento de la batería Panasonic

Operación	Tiempo de funcionamiento
Mientras esté en uso (hablando)	Hasta 5 horas
Mientras no esten uso (en espera)	Hasta 11 días
Mientras use la función de amplificador de claridad	Hasta 3 horas

Nota:

- El auricular puede dejar en el cargador sin efectos dañinos para la batería.
- Es posible que el nivel de la batería no se muestre correctamente después de que la reemplace. En este caso, coloque el auricular en el cargador y permita que se cargue durante 7 horas.

Registro

Registre el auricular en una unidad base KX-TG5622/KX-TG5632/KX-TG5633/KX-TG5652/KX-TG5672.

Importante:

- Si por accidente le asigna el número de extensión de otro auricular a la unidad base, el auricular que asignó originalmente deja de funcionar. Confirme el número de extensión de un auricular previamente registrado colocándolo en la unidad base o el cargador. Levante el auricular del cargador antes de registrarlo.

1 Unidad base:

Seleccione un número de extensión sin registrar.

KX-TG5622:

Oprima y mantenga oprimido **[↵]**, **[↵]**, o **[↵]** hasta que el indicador de CHARGE parpadee.

KX-TG5632/KX-TG5633/KX-TG5652:

Oprima **[SELECT]** hasta que el número de extensión deseado (*H 1, H 2, H 3 o H 4*) aparezca en la unidad base, y después oprima y mantenga oprimido **[CALL]** hasta que el indicador de CHARGE parpadee.

KX-TG5672:

Oprima y mantenga oprimido **[INTERCOM]** hasta que el indicador de CHARGE parpadee, y después oprima **[↵]**, **[↵]**, o **[↵]**.

- Después de que el indicador de CHARGE comience a parpadear, debe completar el resto del procedimiento en menos de 1 minuto.

2 Auricular:

Oprima **[OK]**, y después espere hasta que el auricular de la unidad emita un pitido.

Para cambiar el idioma de la pantalla

1 **[MENU]** → **[0][8]**

2 Seleccione la configuración deseada.

3 Oprima la tecla de función derecha para guardar. → **[OFF]**

Audífono (opcional)

La conexión de un audífono al auricular permite tener conversaciones a manos libres. Por favor, utilice solamente un auricular KX-TCA60, KX-TCA86, KX-TCA88HA, KX-TCA91, KX-TCA92 o KX-TCA98 de Panasonic. Consulte la página 2 para obtener información acerca de cómo hacer un pedido.



- El modelo mostrado aquí es un KX-TCA86.

Nota:

- Para cambiar al altavoz del auricular, pulse **[↵]**. Para volver al audífono, oprima **[↵]**.

Montaje en la pared

- 1 Coloque los tornillos (no incluidos) en la pared usando como guía la plantilla para instalación.

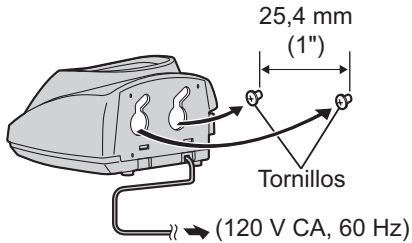

- 2 Coloque el cargador (1), y después deslícelo hacia abajo (2) y a la derecha (3) hasta que esté seguro.

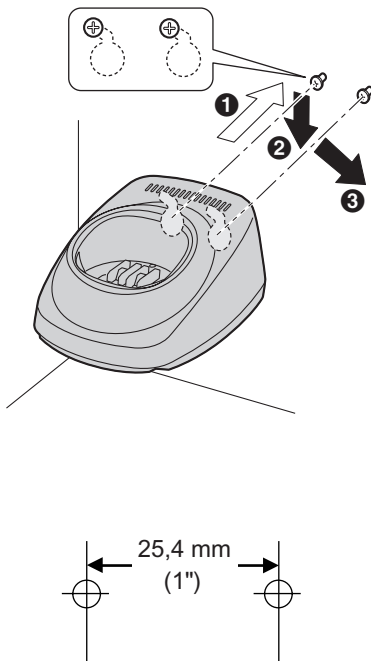



CallerIQ

www.openLCR.com

Instructions to Activate Caller IQ at www.openLCR.com

IMPORTANT:

NEITHER PANASONIC COMMUNICATIONS CO., LTD. NOR PANASONIC CORPORATION OF NORTH AMERICA IS IN ANY WAY AFFILIATED WITH, OR RESPONSIBLE FOR THE ACTS OR OMISSIONS OF, OPENLCR.COM, INC. NEITHER PANASONIC COMMUNICATIONS CO., LTD. NOR PANASONIC CORPORATION OF NORTH AMERICA NOR ANY OF THEIR EMPLOYEES OR AFFILIATES OR CUSTOMERS MAKE ANY WARRANTIES OR REPRESENTATIONS, EITHER EXPRESS OR IMPLIED, TO ANY CUSTOMER OR ANY OTHER THIRD PARTY WITH RESPECT TO ANY OF THE SERVICES PROVIDED BY OPENLCR.COM, INC., NOR ASSUME NOR CREATE ANY OTHER OBLIGATION OF ANY KIND ON BEHALF OF OPENLCR.COM, INC.

Download Services & Entertainment



www.openlcr.com

Available Caller IQ Services



Custom Ringtones/Melodies

Customize your ring pattern with your choice of ringtones/melodies at www.openlcr.com



Phonebook

Create and update your personal phonebook online, even import Microsoft® Outlook® names and numbers to your telephone at www.openlcr.com



Function Setup

Automatic date and time setup, answering machine and more can be conveniently setup online at www.openlcr.com



Information Content

Select your favorite sports, lotteries, horoscopes, stocks and cities for weather forecasts to be displayed on your telephone at www.openlcr.com

* Horoscope is for entertainment purposes only

If you have questions regarding the openLCR service, please visit www.openLCR.com or call openLCR customer service at 1-866-openLCR (1-866-673-6527).

<http://www.openlcr.com>

This unit is compatible with openLCR services. openLCR services allow you to select services and entertainment that can be used from this unit. Depending on unit model and location openLCR may offer the following services and entertainment.

Available Services and Entertainment

■ Custom Ringtones

Customize your ring pattern with your choice of melodies and ringtones.

■ Phonebook

Create and update your personal phonebook online, even import Microsoft® Outlook® names and numbers to this unit.

■ Function Setup

Automatic date and time setup, answering machine and more can be conveniently setup online.

■ Information Content

Select your favorite sports, lotteries, horoscopes, stocks and cities for weather forecasts to be displayed on your unit.

■ Low Cost Long Distance

Compare and save money with some of the lowest rates available in the industry. Visit www.openlcr.com to determine if this option is available for your area.

Note:

Service is only available in the United States.

Terms of Service are available at www.openlcr.com and must be read and accepted prior to registering for select openLCR services, fees may apply.

Trademarks:

- openLCR, openLCR.com, and the openLCR logo are the trademarks of openLCR.com, Inc.
- Microsoft and Outlook are either registered trademarks or trademarks of Microsoft Corp. in the United States and/or other countries.

openLCR service for the Caller IQ feature

This unit is compatible with service provided by openLCR.

- If you have any questions regarding the openLCR service, visit www.openLCR.com or call openLCR at 1-866-openLCR (1-866-673-6527).
- NEITHER PANASONIC COMMUNICATIONS CO., LTD. NOR PANASONIC CORPORATION OF NORTH AMERICA IS IN ANY WAY AFFILIATED WITH, OR RESPONSIBLE FOR THE ACTS OR OMISSIONS OF, OPENLCR.COM, INC. NEITHER PANASONIC COMMUNICATIONS CO., LTD. NOR PANASONIC CORPORATION OF NORTH AMERICA NOR ANY OF THEIR EMPLOYEES OR AFFILIATES OR CUSTOMERS MAKE ANY WARRANTIES OR REPRESENTATIONS, EITHER EXPRESS OR IMPLIED, TO ANY CUSTOMER OR ANY OTHER THIRD PARTY WITH RESPECT TO ANY OF THE SERVICES PROVIDED BY OPENLCR.COM, INC., NOR ASSUME NOR CREATE ANY OTHER OBLIGATION OF ANY KIND ON BEHALF OF OPENLCR.COM, INC.
- The Caller IQ feature can only be activated after registering with openLCR at www.openLCR.com. More information regarding the openLCR service is available on the Internet at www.openLCR.com.

Note:

- References in this leaflet to the "charger" are for models which have 2 or more handsets.

Activate openLCR services (need to start up)

Registering with www.openLCR.com

- 1 Visit www.openLCR.com from any computer connected to the Internet and click **[Register Now!]**.
- 2 Follow the on-screen instructions.

Note:

- Registration can be completed from any computer connected to the Internet.
- The description of www.openLCR.com is subject to change without notice.

Download openLCR data (computer NOT required)

After registering through the Internet, please download data.

- 1 **[MENU]** → "Caller IQ" → **[▶]** → **[Yes]**
 - If you live in Fort Collins, Colorado, press **[#]** before pressing **[Yes]**.
- 2 Follow the openLCR voice prompt.
 - DO NOT press **[OFF]** or place the handset on the base unit or charger. If either occur the download process will be terminated.
- 3 When download is complete, a beep sounds.

Note:

- While downloading from openLCR, "dL" flashes on the base unit display.
- If you have registered with openLCR service, the date and time will be automatically set.

openLCR service for Caller IQ

Available openLCR services

You can download the following to your unit by registering with www.openLCR.com.

- Phonebook
 - Ringer melodies (Custom ringtones)
 - Function setup for your unit
 - Information content (Weather forecast, lottery results, etc.)
-

To create data on the openLCR website

- 1 Access the openLCR's website at www.openLCR.com.
- 2 Enter your phone number and password, then click **[Go]**.
- 3 Follow the on-screen instructions.

Phonebook data:

- To create the phonebook data, enter a name (max. 16 characters), and a phone number (max. 32 digits).
- Ringer ID and light-up ID cannot be set to the phonebook data on the openLCR website.

Ringer melodies:

- Each handset can store 2 melodies. These melodies can be selected as the ringer tone heard when calls are received (page 6).

Function setup:

- See openLCR's website for function items available for download.

Information:

- You can select the information which you want to show on the handset display.

Note:

- The description of www.openLCR.com is subject to change without notice.
-

Download openLCR data (computer NOT required)

Each time you download data from openLCR, the information stored in your unit will be updated. To view up-to-date information, you will need to download it to your unit.

- 1 **[MENU]** → "Caller IQ" → **[▶]**
- 2 "Get new Info.?" → **[Yes]**
 - If you live in Fort Collins, Colorado, press **[#]** before pressing **[Yes]**.
- 3 Follow the openLCR voice prompt.
 - If you have rotary or pulse service, you need to press **[*]** to change the dialing mode temporarily to tone, before following the voice prompt.
 - DO NOT press **[OFF]** or place the handset on the base unit or charger. If either occur the download process will be terminated.
- 4 When download is complete, a beep sounds.

Note:

- You can also download openLCR data after pressing **[↶]** or **[↷]**.
 - Each handset can download its own data and base unit data.
 - While downloading from openLCR, "DL" flashes on the base unit display.
 - If registration is not completed openLCR will only download a sample of openLCR service(s). See page 5 for help with downloading openLCR services.
-

View openLCR downloaded contents using the handset

1 [MENU] → "Caller IQ" → [▶] → "View Info.?" → [Yes]

- If you have not yet downloaded to your unit, "Get new Info.?" will be displayed. To download information, see page 4.

2 Press [▲] or [▼] to view the desired information.

3 Press [OFF] when finished.

openLCR download help

– How can I customize the information downloaded to my unit?

- Register or login to your account at www.openLCR.com and follow the instructions on screen.

– The unit beeps 3 times and/or displays "Download incomplete. Try again."

- Try again, follow download instruction (page 4).
- If occurs again contact openLCR (page 3).

– The unit beeps 3 times and/or displays "Download incomplete. Phonebook full."

The phonebook in the unit does not have capacity to store existing plus new items.

1 Erase items that do not exist on the web from the phonebook of the unit.

2 Enter phonebook data from the web (www.openLCR.com).

3 Follow download instruction (page 4).

– While the unit is downloading data from openLCR, the Call Waiting service cannot be used.

Turning the Caller IQ off/on

1 [MENU] → "Caller IQ" → [▶]

2 To turn off:

"Turn CIQ off?" → [Yes]

To turn on:

"Turn CIQ on?" → [Yes]

3 [OFF]

- When Caller IQ is on, "[CIQ]" is displayed while talking.

Programming via direct commands

You can program each feature directly by using feature codes.

1 [MENU]

2 Enter the desired feature code.

3 Enter the desired setting code.

- This step may vary depending on the feature being programmed.

4 [Save] → [OFF]

Direct commands chart

Feature	Feature code	Setting code	Page
Ringer tone (Handset)	[1] [2]	[1]–[3]: Tone pattern 1–3 [4]–[7]: Melody pattern 1–4 [8]–[9]: Downloaded melody pattern 1–2* ¹	page 4
Activate Caller IQ ^{*2}	[7]	–	page 3
View information ^{*3}	[7] [2] ^{*4}	Go to step 2 on page 5, "View openLCR downloaded contents using the handset".	–
Get new information	[7] [3] ^{*4}	Go to step 3 on page 4, "Download openLCR data (computer NOT required)".	–
Turn Caller IQ off	[7] [4] ^{*4}	–	page 5
Turn Caller IQ on	[7] [5] ^{*4}	–	page 5

*1 You need to first download melody data from openLCR website.

*2 This feature can be used to active Caller IQ.

*3 If information is not downloaded to your unit, "Get new Info.?" will be displayed. To download information, see page 4.

*4 After pressing [7], make sure "View Info.?" is displayed, then press the next command. If Caller IQ is turned off, "Turn CIQ on?" is displayed.

Note:

- If you make a mistake or enter the wrong code, press [OFF], then start again by pressing [MENU].

Troubleshooting

openLCR service for Caller IQ

Problem	Cause & solution
When you try to download the data from openLCR, the voice prompt is not announced from the handset while "Listen & follow phone guidance." is being displayed.	<ul style="list-style-type: none"> • Check the settings. • Dialing to openLCR may have been disconnected. Try again. • If you cannot solve a problem, consult openLCR (see below).
For more information about Caller IQ	<ul style="list-style-type: none"> • Call openLCR's customer service department at 1-866-openLCR (1-866-673-6527). • Visit openLCR's website: www.openLCR.com