

SANYO KATANA 6600 USERS MANUAL

Your Phone

Your Phone



Key Functions

1. Earpiece lets you hear the caller and automated prompts.
2. Signal Strength Indicator represents the signal strength by displaying bars. The more bars displayed, the better the signal strength.
3. Main LCD (display) displays all the information needed to operate your phone, such as the call status, the Contacts list, the date and time, and the signal and battery strength.
4. Side Volume Key allows you to adjust the ringer volume in standby mode (with the phone open) or adjust the voice volume during a call. The volume key can also be used to scroll up or down to navigate through the different menu options. Press and hold to make a voice dial or redial with the flip closed.
5. Navigation Key scrolls through the phone's menu options and acts as a shortcut key from standby mode.
6. Soft key (left) lets you select soft key actions or menu items corresponding to the bottom left line on the Main LCD.
7. Camera Key lets you access the Pictures menu and take pictures.
8. MENU/OK lets you access the phone's menus and selects the highlighted choice when navigating through a menu.
9. TALK Key allows you to place or receive calls, answer Call Waiting, use Three-Way Calling, or activate VoiceDial.

10. SPEAKER Key lets you place or receive calls in speaker phone mode.

11. Charger Jack connects the phone to the Travel Charger, or a USB cable.

12. Microphone allows other callers to hear you clearly when you are speaking to them.

13. Internal Antenna facilitates reception and transmission. To maximize call performance, do not obstruct the internal antenna area.

14. Monaural Headset Jack allows you to plug in an optional monaural headset for convenient, hands-free conversations. **CAUTION!** Inserting an accessory into the incorrect jack may damage the phone.

15. Keypad lets you enter numbers, letters, and characters, and navigate within menus. Press and hold keys 2-9 for speed dialing.

16. END/POWER Key lets you turn the phone on or off, end a call, or return to standby mode. While in the main menu, it returns the phone to standby mode and cancels your input. When you receive an incoming call, press to enter silent mode and mute the ringer.

17. BACK Key deletes characters from the display in text entry mode. When in a menu, pressing the Back key returns you to the previous menu. This key also allows you to return to the previous screen in a data session.

18. Soft key (right) lets you select soft key actions or menu items corresponding to the bottom right line on the Main LCD.

19. Side Camera Key lets you activate the camera mode by pressing and holding. Press to take pictures. You can also press and hold to end a call with the flip closed while you are using the speaker phone mode.

20. Battery Strength Indicator represents the amount of remaining battery charge currently available in your phone. When all bars are displayed in the battery icon, the phone's battery is fully charged. When no bars are displayed, the phone's battery is completely discharged or empty.

21. Camera Lens, as part of the built-in camera, lets you take pictures.

22. Sub LCD lets you monitor the phone's status and see who's calling without opening the phone.

23. LED Indicator shows your phone's connection status at a glance.

24. Battery powers your phone (Lithium-Ion [Li-Ion] battery included).

25. Speaker lets you hear the different ringers and sounds.

Viewing the Display Screen

Your phone's display screen provides a wealth of information about your phone's status and options. This list identifies some of the symbols you'll see on your phone's display screen:

Tip: To view a list your phone's icons and descriptions, from the main menu, select **Settings > Phone Info > Icon Glossary**.

- indicates your current signal strength. The more lines you have, the stronger your signal.
- indicates your phone cannot find a signal.
- indicates the call is on hold.
- indicates a call is in progress.
- indicates you are "roaming"
- indicates you have missed voice calls.
- indicates you have scheduled events or call alarms.
- indicates you have alarm clock and/or countdown notifications.
- indicates you have picture messages, Voicemail messages, and text messages.
- indicates you have urgent messages.
- indicates you have two or more different types of missed calls, scheduled events, call alarms, or alarm clock notifications.
- indicates the Bluetooth feature is enabled (blue icon).
- indicates the handset is connected to a Bluetooth device (green icon).
- indicates the handset is discoverable by another Bluetooth device.
- indicates the handset is communicating with a Bluetooth device.
- indicates your access to a secure site.
- indicates the battery charge level. The more black you see, the more power you have left. (The icon is animated while the battery is charging.)
- indicates your battery is charging in "Power Off" state.
- indicates the vibrate feature is set.
- indicates volume level 8 or 1 and vibrate feature are set.
- indicates 1-beep feature is set.
- indicates the voice call ringer setting is off.
- indicates all the sound settings are off.
- indicates the Location feature of your phone is enabled.
- indicates the Location feature of your phone is disabled.
- indicates you have a new caller's message.
- indicates the Screen Call Auto setting is on.
- indicates your phone is in TTY mode.
- indicates the headset mode is set and a headset is connected.
- indicates the alarm clock and/or countdown setting is on.
- indicates the speakerphone mode is set to on.
- indicates the Bluetooth device is set to on.
- indicates the wired car kit device is set to on.
- indicates the wired headset device is set to on.

CONTINUED ON OTHER SIDE

Turning Your Phone On and Off

Turning Your Phone On

To turn your phone on:

- ▶ Press **END/OK**.

Once your phone is on, it may display "Looking for service....," which indicates that your phone is searching for a signal. When your phone finds a signal, it automatically enters standby mode – the phone's idle state. At this point, you are ready to begin making and receiving calls.

Turning Your Phone Off

To turn your phone off:

- ▶ Press and hold **END/OK** for two seconds until you see the powering down animation on the display screen.

Your screen remains blank while your phone is off (unless the battery is charging).

Using Your Phone's Battery and Charger

USE ONLY APPROVED OR MANUFACTURER-APPROVED BATTERIES AND CHARGERS WITH YOUR PHONE. THE FAILURE TO USE A APPROVED OR MANUFACTURER APPROVED BATTERY AND CHARGER MAY INCREASE THE RISK THAT YOUR PHONE WILL OVERHEAT, CATCH FIRE, OR EXPLODE, RESULTING IN SERIOUS BODILY INJURY, DEATH, OR PROPERTY DAMAGE.

Installing the Battery

To install the Li-Ion battery:

1. Insert the battery into the opening on the back of the phone at a 45-degree angle, making sure to line up the gold contacts. Gently press down until the battery snaps into place.
2. Install the protective cover by lining up the tabs at a 45-degree angle, and gently press down until the cover snaps into place.



Removing the Battery

To remove your battery:

1. Make sure the power is off so that you don't lose any stored numbers or messages. Remove the protective cover by pressing the release latch and pulling up on the back of the cover.
2. Use your thumbnail to lift and then remove the battery as indicated in the diagram.

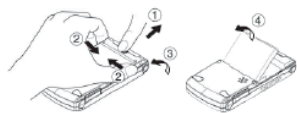

Making and Answering Calls

Making Calls

Placing a call from your wireless phone is as easy as making a call from any landline phone. Just enter the number, and press **TALK**.

To make a call using your keypad:

1. Make sure your phone is on.
2. Enter a phone number from standby mode. (If you make a mistake while dialing, press **BACK** to erase one digit at a time. Press and hold **BACK** to erase the entire number.)
3. Press **TALK** or **SPEAKER**.
4. Press **END/OK** or close the phone when you are finished.

Answering Calls

To answer an incoming call with the phone open:

1. Make sure your phone is on. (If your phone is off, incoming calls go to voicemail.)
2. Press **TALK** or **SPEAKER** to answer an incoming call.

To answer an incoming call with the phone closed:

1. Make sure your phone is on. (If your phone is off, incoming calls go to Voicemail.)
2. When your phone rings or vibrates, press and hold the Side Volume key (**◀ ▶**) on the left side of the phone. (The call will be answered in speakerphone mode.)
– or –
Open the phone to use the earpiece.

Taking Pictures

Taking pictures with your phone's built-in camera is as simple as choosing a subject, pointing the lens, and pressing a button. You can activate the phone's camera mode whether the phone is open or closed.

To take a picture with the phone open:

1. Press **MENU** > **Pictures** > **Camera** to activate camera mode. (Additional camera options are available through the camera mode Options menu.)
2. Using the phone's Main LCD as a viewfinder, aim the camera lens at your subject.
3. Press **Capture** (left softkey), **OK**, **END/OK**, or the side camera key until the shutter sounds. (The picture will automatically be saved in the In Camera folder.)
 - ▶ To return to camera mode to take another picture, press **OK**.
4. Press **Next** (right softkey) for more options:
 - ▶ **Take New Picture** to return to camera mode to take another picture.

Turning Bluetooth On and Off

By default, your phone's Bluetooth feature is turned off. Turning Bluetooth on makes your phone "available" to other in-range Bluetooth devices. To make your phone visible to other devices you must also set your phone's visibility to other than **Hidden**.

To turn Bluetooth on:

1. Press **MENU** > **Settings** > **Bluetooth** > **Enable/Disable**.
2. Select **Enable** to enable Bluetooth.

To turn Bluetooth off:

1. Press **MENU** > **Settings** > **Bluetooth** > **Enable/Disable**.
2. Select **Disable** to disable Bluetooth.

Using SMS Text Messaging

With SMS Text Messaging, you can use other people's phone numbers to send instant text messages from your phone to their messaging-ready phones – and they can send messages to you. When you receive a new message, it will automatically display on your phone's screen.

Sending a Text Message

To compose an SMS Text message:

1. Press **MENU** > **Messaging** > **Send Message** > **Text** and select the entry method you prefer:
 - ▶ **Phone Book Entry** to select a recipient from your internal Contacts. (Qualifying Contacts entries must contain a phone number or an email address.)
 - ▶ **Phone#** to use the keypad to enter the phone number of the person to whom you wish to send a message.
2. Press **OK** to save the recipient. (You may include up to 16 recipients per message.)

3. Press **Next** (left softkey) when you have finished selecting and entering recipients.
4. Compose a message or use the preset messages or smileys (icons).
 - ▶ To type a message, use your keypad to enter your message. Press **Mode** (right softkey) to select a character input mode.
5. Scroll down to select the message priority (**Ordinary** or **Urgent**), set the callback number, or set the signature.
6. Review your message and press **Send** (left softkey).

Using Voicemail

Setting Up and Using Your Voicemail

All unanswered calls to your phone are automatically transferred to your voicemail, even if your phone is in use or turned off. Therefore, you will want to set up your voicemail and personal greeting as soon as your phone is activated.

Voicemail Notification

There are several ways your phone alerts you to a new message:

- By displaying a message on the screen.
- By sounding the assigned ringer type.
- By the LED blinking red.
- By displaying **VM** at the top of your screen.

Clearing the Message Icon

Your phone may temporarily continue to display the message icon after you have checked your messages.

To clear the icon from the display screen:

1. Press **MENU** > **Messaging** > **Voicemail** > **Clear Count**.
2. Select **Yes**.