



# ELECTRIC BASS

## OWNER'S MANUAL

### CONTENTS

CARE AND MAINTENANCE .....	2
TUNING MACHINE TENSION ADJUSTMENT .....	3
SETTING THE STRING ACTION .....	4
INTONATION ADJUSTMENT .....	5
PICKUP HEIGHT ADJUSTMENT .....	6
TRUSS ROD ADJUSTMENT .....	6
CORRECT USE AND HANDLING OF BATTERIES .....	7

*Congratulations on your choice of the Yamaha electric bass. With reasonable care, your Yamaha electric bass will age gracefully and provide many years of superlative musical service.*

## CARE AND MAINTENANCE

- \* When connecting or disconnecting cables, turn off the amplifier and other equipment or reduce the volume.
- \* After playing, wipe the entire guitar down, including strings, with a good polishing cloth. This will remove corrosive skin oils and acids, and protect the plating, finish, and strings.
- \* Avoid exposing the guitar to direct sunlight and extremes of heat and humidity.

## TUNING MACHINE TENSION ADJUSTMENT

The tuning machines have spring-loaded mechanisms which automatically take up wear, preventing backlash. However, it is possible to adjust the amount of pressure required to turn the machines. Each machine has a tension adjustment screw, as illustrated.

Clockwise rotation tightens the machine. The tuning machines should be adjusted to the extent that they are firm, but can turn smoothly. This adjustment is normally unnecessary, and excessive tightening can lead to premature tuning machine wear.

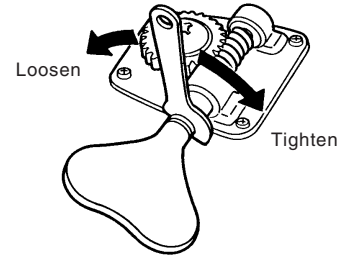
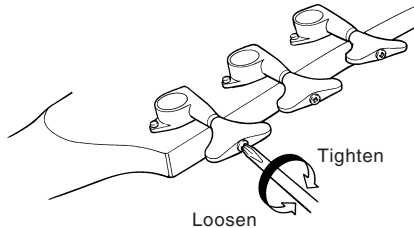
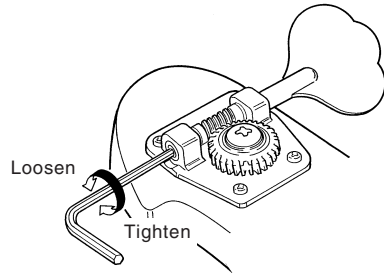

## SETTING THE STRING ACTION

Set one end of the 15cm rule on top of the Final fret with the flat side of the rule against the string and measure the space between the top of the Final fret and bottom of each open string. The recommended height for each string should be as above.

Individual height adjustments for each string are provided in the form of two set screws on each saddle. Clockwise rotation raises saddle height and counter-clockwise lowers the saddle.

4-string bass	STRING 5-string bass	6-string bass	TUNING	HEIGHT
—	—	1st	High C	2.6 mm
1st	1st	2nd	G	2.7 mm
2nd	2nd	3rd	D	2.8 mm
3rd	3rd	4th	A	2.9 mm
4th	4th	5th	E	3.0 mm
—	5th	6th	Low B	3.1 mm

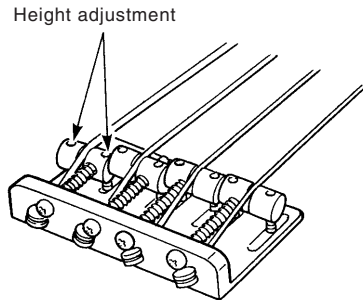

**NOTE:** Be sure to perform any necessary adjustments to the truss rod before performing the following adjustments.

## INTONATION ADJUSTMENT

When the string gauge and/or bridge height is changed, or the truss rod is adjusted, it is usually necessary to reintonate the bridge saddles. If the bass plays out of tune in the higher registers, this adjustment is needed. Check each string in the following way:

To check intonation, compare the harmonic tone (12th fret) to the fretted tone (12th fret). Because the 12th fret is the midway point between the nut and the bridge, a harmonic tone one octave higher than the fretted tone can be generated. This is done by barely touching the string directly above the 12th fret (left hand) and simultaneously plucking the same string (right hand). If the fretted tone is exactly the same pitch as the harmonic tone, no adjustments to the bridge saddles are necessary. However, if the fretted tone is higher in pitch (sharp) or lower in pitch (flat) than the harmonic tone, apply the appropriate adjustment as shown below. Repeat the same procedure for each string.

If the fretted note is pitched higher than the harmonic, turn the corresponding saddle adjustment screw clockwise, increasing the active string length.

Conversely, if the fretted note is pitched lower than the harmonic, turn the corresponding saddle adjustment screw counter-clockwise, reducing the active string length.

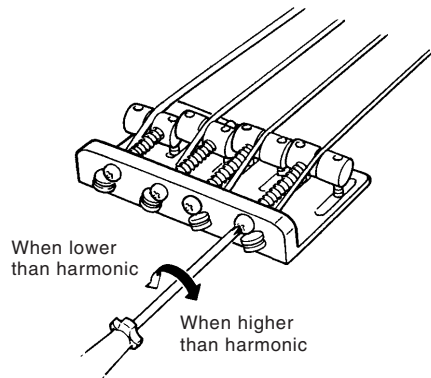

## PICKUP HEIGHT ADJUSTMENT

Proper pickup adjustment ensures maximum output level and uniform response on all strings. To make adjustments, follow the directions below:

Using your left hand, depress each string at the last fret, while setting one end of the 15cm rule on top of the pickup section directly under each string. The flat side of the rule should be against the string. The space between the bottom of each string and the top of the corresponding pickup section should be 2mm.

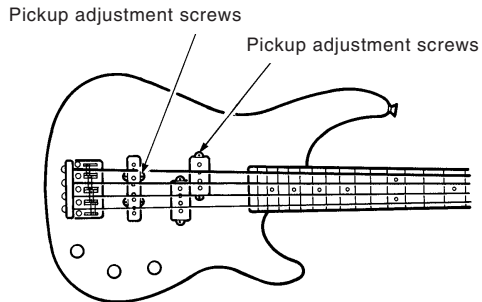

## TRUSS ROD ADJUSTMENT

The curvature of the neck should be slightly concave. Clockwise rotation of the nut tightens the rod and corrects for too much concave bow. Counterclockwise rotation of the nut loosens the rod and corrects for too much convex bend. Make any adjustments gradually. Allow five to ten minutes for setting, and check the curvature after each 1/2 turn of the truss rod nut.

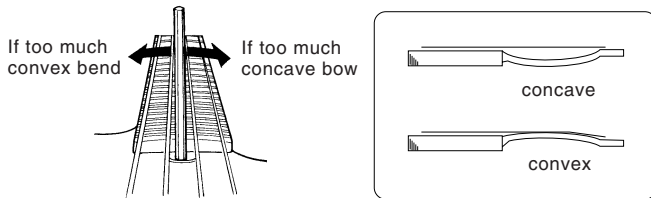

**NOTE:** Unless you have experience with truss rods, we suggest that you entrust this adjustment to your dealer.

# CORRECT USE AND HANDLING OF BATTERIES

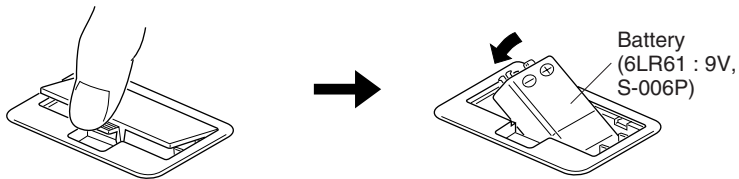
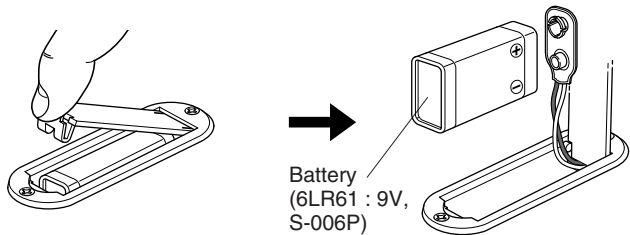

\* When changing batteries, pay close attention to the +/- polarity markings as shown in the illustration above.

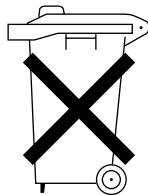

When these run out, don't just throw them away, but dispose of them as minor chemical waste.

## SERVICE

If your guitar should need any parts or service, or if you need any information, including the address of your nearest YAMAHA dealer, contact:

**售后服务** 如果您的吉他需要任何配件或维修, 或者您需要任何信息, 请找到离您最近的YAMAHA分销商并与之联系。

### **YAMAHA CORPORATION OF AMERICA Guitar Service Department**

6600 Orangethorpe Avenue  
Buena Park, Calif. 90620 Calif. U.S.A.  
TEL: 714 522 9433

### **YAMAHA EUROPA G.M.B.H.**

2084 Rellingen, b. Hamburg  
Siemensstr. 22/34 Germany  
TEL: 04101 30 30

### **YAMAHA-KEMBLE MUSIC (U.K.) LTD.**

Sherbourne Drive, Tilbrook,  
Milton Keynes MK7 8BL, England  
TEL: 0908-366 700

### **YAMAHA MUSIQUE FRANCE S.A.**

Parc D'activités De Paris Est  
Rue Ambroise Croizat  
77183 Croissy Beaubourg France  
TEL: 64 61 4000

### **YAMAHA CANADA MUSIC LTD.**

135 Milner Avenue Scarborough  
Ontario MIS 3R1 Canada  
TEL: 416 298 1311

### **YAMAHA DE MEXICO S.A. DE C.V.**

Apdo. Postal No.28-207  
Mexico 1, D.F., Mexico  
TEL: 686 0033

### **YAMAHA MUSIC LATIN AMERICA CORP.**

6303 Blue Lagoon Drive, Suite 330  
Miami Florida 33126 U.S.A.  
TEL: 305 264 2581

### **YAMAHA SCANDINAVIA A.B.**

Box 300 53 400 43 Göteborg, Sweden  
TEL: 031 496090

### **YAMAHA-HAZEN ELECTRONICA MUSICAL S.A.**

Jorge Juan 30, 28001 Madrid Spain  
TEL: 593 2554

### **YAMAHA MUSICA ITALIA S.P.A.**

Viale Italia 88, 20020 Lainate (Milano)  
Italia  
TEL: 2 93577 1

### **YAMAHA MUSIC AUSTRALIA PTY., LTD.**

17-33 Market Street  
South Melbourne, Vic. 3205 Australia  
TEL: 699 2388

### **雅马哈乐器音响(中国)投资有限公司**

上海市静安区南京西路1468号  
中欣大厦25楼200040  
TEL: 021-6247-2211





QC69320

YAMAHA CORPORATION  
P.O.Box 1, Hamamatsu, Japan

Printed in China