

Mobile Phone user manual

Some contents in this manual may differ from your phone depending on the software of the phone or your service provider.

Bluetooth QD ID : B015089

www.samsungmobile.com

Printed in Korea
Code No.: GH68-22219A
English (SEA), 03/2009, Rev. 1.0



Safety warnings

Keep your phone away from small children and pets

Keep your phone and all accessories out of reach from small children and pets. Small parts may cause choking or serious injury if swallowed.

Protect your hearing



Listening to a headset at high volumes can damage your hearing. Use only the minimum volume setting necessary to hear your conversation or music.

Install mobile phones and equipment with caution

Ensure that any mobile phones or related equipment installed in your vehicle are securely mounted. Avoid placing your phone and accessories near or in an air bag deployment area. Improperly installed wireless equipment can cause serious injury when air bags inflate rapidly.

Protect batteries and chargers from damage

- Avoid exposing batteries to very cold or very hot temperatures (below 0° C/32° F or above 45° C/113° F). Extreme temperatures can reduce the charging capacity and life of your batteries.
- Prevent batteries from contacting metal objects, as this can create a connection between the + and – terminals of your batteries and lead to temporary or permanent battery damage.
- Never use a damaged charger or battery.

Handle your phone carefully and sensibly

- Do not allow your phone to get wet—liquids can cause serious damage. Do not handle your phone with wet hands. Water damage to your phone can void your manufacturer's warranty.
- Avoid using or storing your phone in dusty, dirty areas to prevent damage to moving parts.
- Your phone is a complex electronic device—protect it from impacts and rough handling to avoid serious damage.
- Do not paint your phone, as paint can clog moving parts and prevent proper operation.
- Avoid using the phone's camera flash or light close to the eyes of children or animals.
- Your phone and memory cards may be damaged by exposure to magnetic fields. Do not use carrying cases or accessories with magnetic closures or allow your phone to come in contact with magnetic fields for extended periods of time.

Correct disposal of this product

(Waste Electrical & Electronic Equipment)



(Applicable in the European Union and other European countries with separate collection systems)

This marking shown on the product or its literature, indicates that it should not be

disposed with other household wastes at the end of its working life.

To prevent possible harm to the environment or human health from uncontrolled waste disposal, please separate this from other types of wastes and recycle it responsibly to promote the sustainable reuse of material resources.

Household users should contact either the retailer where they purchased this product, or their local government office, for details of where and how they can take this item for environmentally safe recycling.

Business users should contact their supplier and check the terms and conditions of the purchase contract. This product should not be mixed with other commercial wastes for disposal.

Handle and dispose of batteries and chargers with care

- Use only Samsung-approved batteries and chargers specifically designed for your phone. Incompatible batteries and chargers can cause serious injuries or damage to your phone.
- Never dispose of batteries or phone in a fire. Follow all local regulations when disposing used batteries or phone.
- Never place batteries or phones on or in heating devices, such as microwave ovens, stoves, or radiators. Batteries may explode when overheated.
- Never crush or puncture the battery. Avoid exposing the battery to high external pressure, which can lead to an internal short circuit and overheating.

Avoid interference with pacemakers

Maintain a minimum of 15 cm (6 inches) between mobile phones and pacemakers to avoid potential interference, as recommended by manufacturers and the independent research group, Wireless Technology Research.

If you have any reason to suspect that your phone is interfering with a pacemaker or other medical device, turn off the phone immediately and contact the manufacturer of the pacemaker or medical device for guidance.

Avoid interference with other electronic devices

Your phone emits radio frequency (RF) signals that may interfere with unshielded or improperly shielded electronic equipment, such as pacemakers, hearing aids, medical devices, and other electronic devices in homes or vehicles. Consult the manufacturers of your electronic devices to solve any interference problems you experience.



Important usage information

Use your phone in the normal position

Avoid contact with your phone's internal antenna.

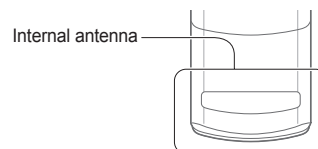

Allow only qualified personnel to service your phone

Allowing non-qualified personnel to service your phone may result in damage to your phone and will void your warranty.

Correct disposal of batteries in this product

(Applicable in the European Union and other European countries with separate battery return systems.)



This marking on the battery, manual or packaging indicates that the batteries in this product should not be disposed of with other household waste at the end of their working

life. Where marked, the chemical symbols Hg, Cd or Pb indicate that the battery contains mercury, cadmium or lead above the reference levels in EC Directive 2006/66. If batteries are not properly disposed of, these substances can cause harm to human health or the environment.

To protect natural resources and to promote material reuse, please separate batteries from other types of waste and recycle them through your local, free battery return system.

Turn off the phone in potentially explosive environments

Do not use your phone at refueling points (service stations) or near fuels or chemicals. Turn off your phone whenever directed by warning signs or instructions. Your phone could cause explosions or fire in and around fuel or chemical storage, transfer areas and blasting areas. Do not store or carry flammable liquids, gases, or explosive materials in the same compartment as the phone, its parts, or accessories.

Reduce the risk of repetitive motion injuries

When sending text messages or playing games on your phone, hold the phone with a relaxed grip, press the buttons lightly, use special features that reduce the number of buttons you have to press (such as templates and predictive text), and take frequent breaks.

CE 0168

Ensure maximum battery and charger life

- Avoid charging batteries for more than a week, as overcharging may shorten battery life.
- Over time, unused batteries will discharge and must be recharged before use.
- Disconnect chargers from power sources when not in use.
- Use batteries only for their intended purpose.

Handle SIM cards and memory cards with care

- Do not remove a card while the phone is transferring or accessing information, as this could result in loss of data and/or damage to the card or phone.
- Protect cards from strong shocks, static electricity, and electrical noise from other devices.
- Frequent writing and erasing will shorten the life span of memory cards.
- Do not touch gold-coloured contacts or terminals with your fingers or metal objects. If dirty, wipe the card with a soft cloth.

Ensure access to emergency services

Emergency calls from your phone may not be possible in some areas or circumstances. Before traveling in remote or areas without signal coverage, plan an alternate method of contacting emergency services personnel.

Specific Absorption Rate (SAR) certification information

Your phone conforms to European Union (EU) standards that limit human exposure to radio frequency (RF) energy emitted by radio and telecommunications equipment. These standards prevent the sale of mobile phones that exceed a maximum exposure level (known as the Specific Absorption Rate, or SAR) of 2.0 watts per kilogram of body tissue.

During testing, the maximum SAR recorded for this model was 0.673 watts per kilogram. In normal use, the actual SAR is likely to be much lower, as the phone has been designed to emit only the RF energy necessary to transmit a signal to the nearest base station. By automatically emitting lower levels when possible, your phone reduces your overall exposure to RF energy.

The Declaration of Conformity of this manual demonstrates your phones compliance with the European Radio & Terminal Telecommunications Equipment (R&TTE) directive. For more information about the SAR and related EU standards, visit the Samsung mobile phone website.

Phone layout

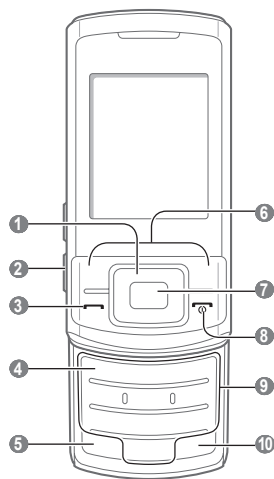

1
4-way navigation key
In Idle mode, access user-defined menus (depending on your service provider, pre-defined menus may differ); In Menu mode, scroll through menu options

2
Volume key
In Idle mode, adjust the key tone volume; Send an SOS message
▶ Activate and send an SOS message

3
Dial key
Make or answer a call; In Idle mode, retrieve recently dialed, missed, or received numbers

4
Voice mail service key
In Idle mode, access voice mails (press and hold)

5
Pause key
Enter a dial pause (press and hold)

6
Softkeys
Perform actions indicated at the bottom of the display

7
Confirm key
In Idle mode, access Menu mode; In Menu mode, select the highlighted menu option or confirm an input

8
Power/Menu exit key
Turn the phone on and off (press and hold); End a call; In Menu mode, cancel input and return to Idle mode

9
Alphanumeric keys

10
Silent profile key
In Idle mode, activate or deactivate the silent profile (press and hold)

Your phone accepts microSD™ memory cards up to 8 GB (depending on memory card manufacturer and type).

Your phone displays the following status indicators on the top of the screen:

Icon	Description	Icon	Description
	Signal strength		Bluetooth activated
	GPRS network connected		New message
	EDGE network connected		New voice mail message
	Call in progress		Music playback in progress
	Call diverting active		FM radio on
	SOS message feature activated		Memory card inserted
	Alarm activated		Normal profile activated
	Connecting to secured web page		Silent profile activated
	Synchronised with PC		Battery power level
	Roaming (outside of normal service area)		Current time

Instructional icons

	Note: notes, usage tips, or additional information
	Followed by: the order of options or menus you must select to perform a step; for example: In Menu mode, select Messages → Create message (represents Messages , followed by Create message)
	Square brackets: phone keys; for example: [Power/Menu exit key] (represents the Power/Menu exit key)
	Angled brackets: softkeys that control different functions at each screen; for example: < OK > (represents the OK softkey)

Turn your phone on or off

- Slide open the phone.
- To turn your phone on, press and hold [**Power/Menu exit key**].
- To turn your phone off, press and hold [**Power/Menu exit key**].

Access menus

To access your phone's menus,

- In Idle mode, press the **Confirm key** to access **Menu mode**.
- Use the navigation key to scroll to a menu or option.
- Press <**Yes**>, <**Save**>, or the **Confirm key** to confirm the highlighted option.
- Press <**Back**> to move up one level; Press [**Power/Menu exit key**] to return to Idle mode.

- Enter the message text.
For sending as a text message, skip to step 5.
For attaching multimedia, continue with step 4.
- Press <**Options**> → **Add multimedia** and add an item.
- Press the **Confirm key** to send the message.

To view text or multimedia messages

- In Menu mode, select **Messages** → **Inbox**.
- Select a text or multimedia message.

Activate the mobile tracker

This feature helps track your phone when it is stolen or when someone tries to use your phone using other SIM card, the phone will automatically send the preset tracking message to family or friends. This feature may be unavailable due to certain features supported by your service provider.

- In Menu mode, select **Settings** → **Security** → **Mobile tracker 2.0**.
- Enter a new 4- to 8-digit password and press <**OK**>.
- Enter the new password again and press <**OK**>.
- Select **Settings**.
- Enter a new 8-digit password for the mobile tracker and press <**OK**>.
- Enter the new password again and press <**OK**>.
- Scroll left or right to **On**.
- Scroll down and press the **Confirm key** to open the recipient list.

Make a call

- In Idle mode, enter an area code and a phone number.
- Press [**Power/Menu exit key**] to dial the number.
- To end the call, press [**Power/Menu exit key**].

Answer a call

- When a call comes in, press [**Power/Menu exit key**].
- To end the call, press [**Power/Menu exit key**].

Adjust the volume

To adjust the volume of the ringtone

- In Menu mode, select **Settings** → **Phone profiles**.
- Scroll to the phone profile you are using.
- Press <**Options**> → **Edit**.
- Select **Call alert volume**.
- Scroll left or right to adjust the volume level.
- Press <**Select**>.
- Press <**Save**>.

To adjust the volume of voice during a call

While a call is in progress, press the **Volume key** up or down to adjust the earpiece volume.

Change your ringtone

- In Menu mode, select **Settings** → **Phone profiles**.
- Scroll to the phone profile you are using.

- Press <**Options**> → **Phonebook** to open your contact list.
- Scroll to a contact and press the **Confirm key**.
- Select a number (if necessary).
- When you are finished selecting contacts, press <**Select**> to return to the recipient list.
- Press <**Options**> → **OK** to save the recipients.
- Scroll down and enter the sender's name.
- Press <**Options**> → <**Save**> → <**Accept**>.

The first time you access the mobile tracker, you will be asked to accept the end user agreement to activate the mobile tracker.

Activate and send an SOS message

In an emergency, you can send SOS messages to your family or friends for help.

To activate the SOS message

- In Menu mode, select **Messages** → **Settings** → **SOS messages** → **Sending options**.
- Scroll left or right to **On**.
- Scroll down and press the **Confirm key** to open the recipient list.
- Press <**Options**> → **Phonebook** to open your contact list.
- Scroll to a contact and press the **Confirm key**.
- Select a number (if necessary).
- When you are finished selecting contacts, press <**Select**> to return to the recipient list.

- Press <**Options**> → **Edit**.
- Select **Voice call ringtone**.
- Select a ringtone category → a ringtone.
- Press <**Save**>.

Call a recently dialed number

- In Idle mode, press [**Power/Menu exit key**].
- Scroll left or right to select a call type.
- Scroll up or down to select a number or name.
- Press the **Confirm key** to view details of the call or [**Power/Menu exit key**] to dial the number.

Enter text

To change the text input mode

- Press and hold [**Star key**] to switch to an input mode. Depending on your region, you may be able to access an input mode for your specific language.
- Press [**Star key**] to change case.
- Press and hold [**Hash key**] to switch to Symbol mode.

T9 mode

- Press the appropriate alphanumeric keys to enter an entire word.
- When the word displays correctly, press [**Hash key**] to insert a space. If the correct word does not display, select an alternate word from the list that appears.

ABC mode

Press the appropriate alphanumeric key until the character you want appears on the display.

- Press <**Options**> → **Save** to save the recipients.
- Scroll down and set the number of times to repeat the SOS message.
- Press <**Save**> → <**Yes**>.

To send an SOS message

- With the phone closed and the keys locked, press the **Volume key** down four times to send an SOS message to preset numbers.
The phone switches to SOS mode and sends the preset SOS message.
- To exit SOS mode, press [**Power/Menu exit key**].

Use the Bluetooth messenger

Learn to chat with your family or friends instantly via the Bluetooth wireless feature.

- In Menu mode, select **Messages** → **Bluetooth messenger**.
- Press <**Yes**> to turn on the Bluetooth wireless feature (if necessary).
- Press <**Options**> → **Search Bluetooth contact** → **Search for new devices**.
- Scroll to a device and press <**Select**>.
- Enter a PIN for the Bluetooth wireless feature or the other device's Bluetooth PIN, if it has one, and press <**OK**>.
When the owner of the other device enters the same PIN or accepts the connection, pairing is complete.
- Enter your message and press the **Confirm key**.

Install the SIM card and battery

- Remove the battery and cover then insert the SIM card.

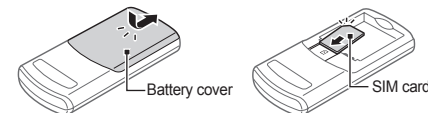

- Insert the battery and cover.

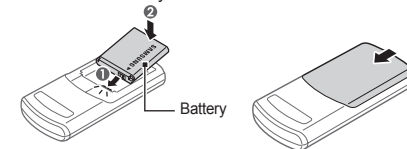

Charge the battery

- Plug the supplied travel adapter.



- When charging is finished, unplug the travel adapter.

Do not remove the battery while the phone is connected to the travel charger. Otherwise, the phone may be damaged.

Number mode

Press the appropriate alphanumeric key to enter a number.

Symbol mode

Press the appropriate alphanumeric key to select a symbol.

- To move the cursor, press the navigation key.
- To delete characters one by one, press <**Clear**>. To delete all of the characters, press and hold <**Clear**>.
- To insert a space between characters, press [**Hash key**].
- To enter punctuation marks, press [1].

Add a new contact

- In Idle mode, enter a phone number and press <**Options**>.
- Select **Save contact** → a memory location (phone or SIM) → **New**.
- Select a number type (if necessary).
- Enter contact information.
- Press the **Confirm key** or <**Options**> → **Save** to add the contact to memory.

Send and view messages

To send a text or multimedia message

- In Menu mode, select **Messages** → **Create message**.
- Enter a destination number and scroll down.

Use the camera

Capture photos

- In Menu mode, select **Camera**.
- Rotate the phone anti-clockwise to landscape view.
- Aim the lens at the subject and make any adjustments.
- Press the **Confirm key** to take a photo.
- Press [**Camera key**] to take another photo (step 3).

View photos

In Menu mode, select **My files** → **Images** → **My photos** → a photo file.

Listen to music

- In Menu mode, select **Music player**.
- Select a music category → a music file.
- Control playback using the following keys:

Key	Function
Confirm	Pause or resume playback
Volume	Adjust the volume
Navigation	<ul style="list-style-type: none"> Left: Restart playback; Skip backward (press within 3 seconds); Scan backward in a file (press and hold) Right: Skip forward; Scan forward in a file (press and hold) Up: Open the playlist Down: Stop playback

If you select **My files** → **Memory card** → a music file, you cannot skip forward or backward during playback.