

Distributed by  
**HOMEDICS®**

# Ultrasonic Cool Mist Humidifier with Built-In SoundSpa



**Instruction Manual and  
Warranty Information**

HUM-PED1

El manual en español empieza  
a la página 13

**1** year  
limited warranty

**Designed with Baby in Mind**

Thank you for purchasing the HoMedics® Ultrasonic Cool Mist Humidifier with Built-In SoundSpa. This humidifier combines the soothing comfort of cool mist with 4 rhythmic sounds to create the perfect, calming environment to lull your baby or toddler to sleep.

## IMPORTANT SAFETY INSTRUCTIONS:

WHEN USING ELECTRICAL PRODUCTS, ESPECIALLY WHEN CHILDREN ARE PRESENT, BASIC SAFETY PRECAUTIONS SHOULD ALWAYS BE FOLLOWED, INCLUDING THE FOLLOWING:

### READ ALL INSTRUCTIONS BEFORE USING

## DANGER – TO REDUCE THE RISK OF ELECTRIC SHOCK:

- Always place humidifier on a firm, flat, level surface. A waterproof mat or pad is recommended for use under the humidifier. Never place it on a rug or carpet, or on a finished floor that may be damaged by exposure to water or moisture.
- Always unplug the appliance from the electrical outlet immediately after using and before cleaning.
- DO NOT reach for an appliance that has fallen into water. Unplug it immediately.
- DO NOT use while bathing or in shower.
- DO NOT place or store appliance where it can fall or be pulled into a tub or sink.
- DO NOT place in or drop into water or other liquid.
- NEVER use pins or other metallic fasteners with this appliance.
- DO NOT use water above 86° Fahrenheit.

## WARNING - TO REDUCE THE RISK OF BURNS, FIRE, ELECTRIC SHOCK OR INJURY TO PERSONS:

- An appliance should never be left unattended when plugged in.

- Close supervision is necessary when this appliance is used by or near children, invalids or disabled persons.
- Use this appliance only for its intended use as described in this manual. Do not use attachments not recommended by HoMedics; specifically any attachments not provided with the unit.
- NEVER drop or insert any object into any opening.
- DO NOT operate where aerosol (spray) products are being used or where oxygen is being administered.
- Please hold the water tank firmly with both hands when carrying a full tank of water.
- NEVER use humidifier in an environment where explosive gases are present.
- DO NOT place the humidifier near heat sources, such as a stove and do not expose the humidifier to direct sunlight.
- DO NOT carry this appliance by the power cord or use cord as handle.
- To disconnect, turn all controls to the "OFF" position, then remove plug from outlet.
- This appliance is designed for personal, non-professional use only.
- DO NOT use outdoors. For indoor use only.

### SAVE THESE INSTRUCTIONS

## CAUTION – PLEASE READ ALL INSTRUCTIONS CAREFULLY BEFORE OPERATION.

- Never cover the appliance when it is in operation.
- Always keep the cord away from high temperature and fire.
- If the cord sustains damage, you must stop using this product immediately and contact HoMedics Consumer Relations. (See the warranty section for HoMedics Consumer Relations address.)
- Perform regular maintenance of the Ultrasonic Nebulizer.
- Avoid contact with detergent to your mouth and eyes. If contact occurs, use clean water to wash immediately. If serious, contact poison control or seek medical treatment.
- Never use detergent to clean the Ultrasonic Nebulizer that is not recommended by the manufacturer.
- Never scrape the Ultrasonic Nebulizer with a hard object to clean.

## Operation and Maintenance

- Do not repair or adjust the unit. Servicing must be performed by professional or qualified personnel.
- Stop use if there is an unusual noise or smell. Servicing should be performed by qualified personnel only.
- Humidifier should be unplugged when not in use for a long period of time.
- Do not touch the water in the main unit or the parts in the water when the unit is on.
- Never operate unit without water in the tank. Only use water in the tanks.
- Never add any additive to the water that is not produced or under the supervision of the manufacturer.
- Do not wash, adjust or move the humidifier without first unplugging the unit from its electrical outlet.
- Keep the appliance out of reach from children. Do not allow children to use the appliance without supervision.

## Unique Features and Specifications

### Ultrasonic Technology

This humidifier uses ultrasonic high frequency technology to convert the water into 1-5 million super particles that are dispersed into the air evenly, moistening the air.

### SoundSpa

Plays 4 soothing, rhythmic sounds with adjustable volume and 30 minute auto shut-off to help calm and lull baby to sleep.

### Night Light

A useful night light feature is included for your convenience.

### Auto Shutoff Protection

When the tank is empty the unit will shut off automatically

### Ultrasonic Nebulizer

The humidifier utilizes special spray techniques and the ultrasonic nebulizer is easy to clean for lifetime use.

### Voltage

110-120V/60Hz

### Watts

25

### Tank Capacity

1 gallon – 3.78 liter

## Ultrasonic Cool Mist Humidifier With Built-In SoundSpa

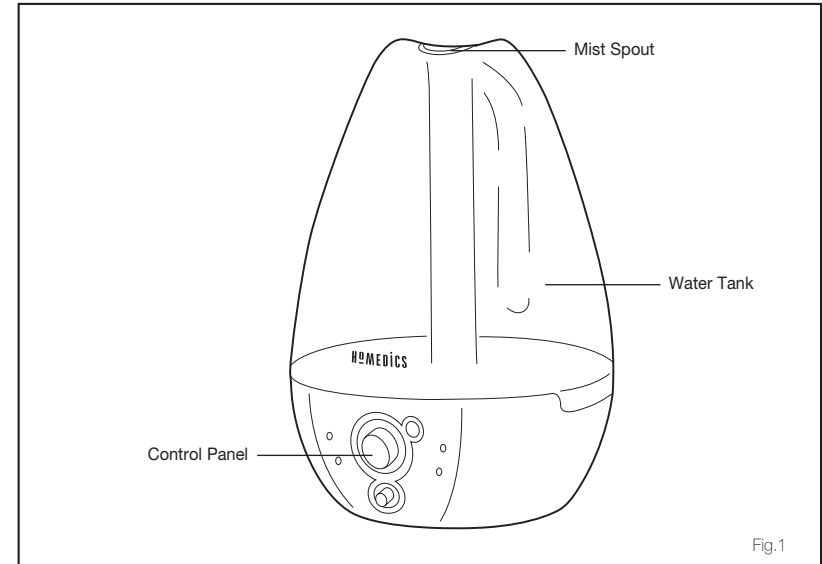

## How To Use

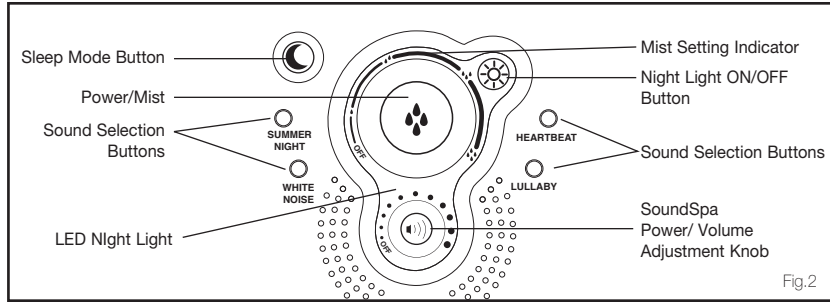

### Power Knob

Plug unit into a 120 volt AC electrical outlet. Turn the **POWER /MIST** (💧) knob clockwise to turn it on.

**ATTENTION:** When the water in the tank is almost empty, the humidifying function will power off to indicate to the user to refill water.

### Mist Adjustment Setting

Mist adjusts from **MINIMUM** (💧) mist to **MAXIMUM** (💧) mist. To increase the mist output, turn the **MIST** knob clockwise. To decrease mist output, turn the **MIST** knob counter-clockwise.

### Night Light

Press the **NIGHT LIGHT** (☀️) button to turn on the night light. The light ring around the Mist Adjustment and SoundSpa knob control will glow with a soft, illuminating, light.

### SoundSpa

**NOTE:** The SoundSpa feature operates independently of the humidifier. It will continue to operate even if the humidifying function is not operating.

There are 4 soothing, rhythmic sounds included with the SoundSpa feature: Summer Night, Heartbeat, White Noise and Lullaby.

- To turn the SoundSpa on, turn the **SOUNDSPA POWER/ VOLUME** (🔊) knob clockwise. The default sound, Summer Night, will begin to play.
- To adjust the volume, turn the **SOUNDSPA POWER/ VOLUME** (🔊) knob clockwise to increase the volume and counter-clockwise to decrease the volume.
- Choose any one of the 4 sounds by pressing the appropriate sound button.
- To turn the SoundSpa off, turn the **SOUNDSPA POWER/ VOLUME** (🔊) knob counter-clockwise until a click is heard and the sound stops.

### Sleep Mode

This humidifier includes a Sleep Mode feature. The Sleep Mode will allow the SoundSpa to operate for 30 minutes, then shut off automatically.

- To turn the Sleep Mode function on, first press the desired Sound Selection button.
- Once the Sound Selection has been made, press the **SLEEP** (🌙) button. This will begin the 30 minute sleep cycle. When the 30 minutes cycle is over, the SoundSpa will automatically stop producing sound and power off.
- To power the SoundSpa back on for normal operation after the 30 minute SLEEP MODE cycle is over, turn the **SOUNDSPA POWER/VOLUME** knob counter-clockwise to the OFF position, then back ON. When the SoundSpa is turned back on, the default SUMMER NIGHT sound will begin playing.
- To return to normal operation once the Sleep Mode has been activated, and before it shuts off, simply press another Sound Selection button. The sleep mode will turn off, and the new sound selection will run continuously until either the **SLEEP** (🌙) button is pressed, or the SoundSpa is powered off.

**NOTE:** The humidifier will continue to operate if it is functioning when the Sleep Mode automatically powers off the SoundSpa feature.

## How to Fill

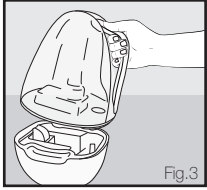

1. Grasp tank handle and lift up from humidifier base

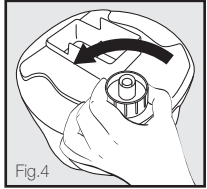

2. Turn the tank upside down—remove the tank cap by turning it counter-clockwise.

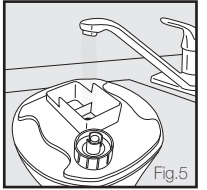

3. Fill the water tank with clean, cool (not cold) tap water. We recommend using distilled water if you live in a hard water area.

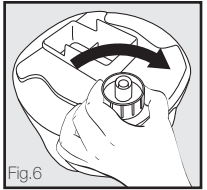

4. Replace the tank cap by turning clockwise until tight

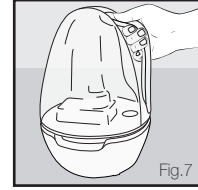

5. Install the tank back on the base of the unit. Make sure the tank is firmly seated.

**CAUTION:** Before filling unit with water, turn power off and unplug unit from the outlet.

## About White Dust

Use of high-mineral content hard water may cause a white mineral residue to accumulate on room surfaces near the humidifier. The mineral residue is commonly called "white dust". The higher the mineral content (the harder your water is), the greater the potential for white dust. The white dust is not caused by a defect in the humidifier, but is due only to minerals suspended in the water.

## Demineralization Cartridge

The HoMedics demineralization cartridge will help reduce the potential for white dust, a deposit of minerals left behind from using hard water in your humidifier. The cartridge should be replaced every 30-40 fillings. The cartridge may need to be replaced more often when very hard water is used. When the cartridge needs to be changed, white dust will form around the humidifier. If white residue still forms around the humidifier after a new cartridge has been inserted, please make sure that the water you are using is untreated. **If you live in a hard water area, or use a water softener, we recommend the use of distilled water for better results from the humidifier. Do not use with water softeners.**

## Installing Instructions

1. Remove demineralization cartridge from packaging and let it soak in water for 10 minutes.
2. Remove the tank from humidifier base. (Fig. 3)
3. **Place 1 demineralization cartridge down into left side matching slot in the humidifier base.** (Fig 9)
4. Place the tank back on the base, making sure the tank is firmly seated. (Fig. 7)

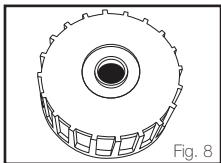

Fig. 8

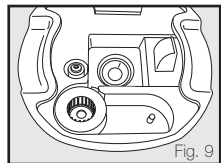

Fig. 9

## Cleaning and Care

**CAUTION:** Before cleaning the unit, turn power off and unplug unit from the outlet.

### Tank Cleaning

Remove the water tank from the humidifier base by lifting it by the handle from the main unit. Unscrew the tank cap; wipe the tank with a soft cloth then rinse it with clean water. (Fig. 10)

Suggestion: Clean the water tank once every two to three weeks, depending on your water conditions.

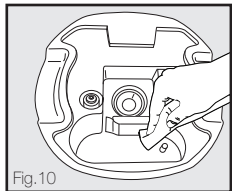

Fig.10

### Ultrasonic Nebulizer Cleaning

Put small amount of mild dish soap on the surface of the ultrasonic nebulizer, then pour in some water and soak for 5 minutes. Brush clean with soft bristle brush (not included) and rinse. (Fig. 11)

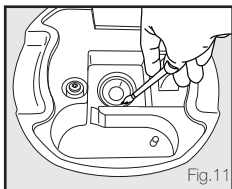

Fig.11

### Surface Cleaning

Clean the surface of the unit with a clean damp soft cloth. (Fig. 12)

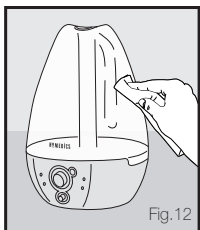

Fig.12

## Troubleshooting

PROBLEM	POSSIBLE CAUSE	SOLUTION
Power Light is off	<ul style="list-style-type: none"> <li>•Unit is not plugged in</li> <li>•No power at unit</li> </ul>	<ul style="list-style-type: none"> <li>•Plug unit in</li> <li>•Press the POWER button to turn the power on</li> <li>•Check circuits, fuses, try a different outlet</li> </ul>
SoundSpa will not turn on	<ul style="list-style-type: none"> <li>•Unit is not plugged in</li> <li>• Volume is down too low</li> <li>• No sound selection has been made</li> <li>• Sleep Mode cycle is over</li> </ul>	<ul style="list-style-type: none"> <li>• Plug unit in</li> <li>• Turn the SOUNDSPA POWER/VOLUME knob clockwise to increase volume</li> <li>• Press a sound selection button to choose a sound</li> <li>• Use the SOUNDSPA POWER/VOLUME knob to turn the SoundSpa OFF, then back ON again.</li> </ul>
Peculiar Odor	<ul style="list-style-type: none"> <li>•If new unit</li> <li>•If unit is in use, the odor may be a dirty tank or old tank water</li> </ul>	<ul style="list-style-type: none"> <li>•Open the water tank cap and keep it in a shady and cool place for 12 hours</li> <li>•Empty the old water, clean the tank and fill with clean water</li> </ul>
Excessive Noise	<ul style="list-style-type: none"> <li>•Unit is not level</li> <li>•Low water level</li> </ul>	<ul style="list-style-type: none"> <li>•Place unit on a flat, even surface</li> <li>•Check the water level. Refill the tank if the water is low</li> </ul>
White Dust Accumulation	<ul style="list-style-type: none"> <li>•Hard water used</li> <li>•Demineralization Cartridge needs replacement</li> </ul>	<ul style="list-style-type: none"> <li>•Use distilled water and a Demineralization Cartridge</li> <li>•Replace Demineralization Cartridge</li> </ul>

## LIMITED ONE YEAR WARRANTY

HoMedics sells its products with the intent that they are free of defects in manufacture and workmanship for a period of one year from the date of original purchase, except as noted below. HoMedics warrants that its products will be free of defects in material and workmanship under normal use and service. This warranty extends only to consumers and does not extend to Retailers.

To obtain warranty service on your HoMedics product, mail the product and your dated sales receipt (as proof of purchase), postpaid, to the following address:

HoMedics Service Center  
Dept. 168, Suite 3  
43155 West Nine Mile Rd  
Novi, MI 48375

No COD's will be accepted.

### Mail To:

**HoMedics Service Center  
Dept. 168, Suite 3  
43155 West Nine Mile Rd  
Novi, MI 48375**

### e-mail:

**cservice@homedics.com**

HoMedics does not authorize anyone, including, but not limited to, Retailers, the subsequent consumer purchaser of the product from a Retailer or remote purchasers, to obligate HoMedics in any way beyond the terms set forth herein. This warranty does not cover damage caused by misuse or abuse; accident; the attachment of any unauthorized accessory; alteration to the product; improper installation; unauthorized repairs or modifications; improper use of electrical/power supply; loss of power; dropped product; malfunction or damage of an operating part from failure to provide manufacturer's recommended maintenance; transportation damage; theft; neglect; vandalism; or environmental conditions; loss of use during the period the product is at a repair facility or otherwise awaiting parts or repair; or any other conditions whatsoever that are beyond the control of HoMedics.

This warranty is effective only if the product is purchased and operated in the country in which the product is purchased. A product that requires modifications or adoption to enable it to operate in any other country than the country for which it was designed, manufactured, approved and/or authorized, or repair of products damaged by these modifications is not covered under this warranty.

THE WARRANTY PROVIDED HEREIN SHALL BE THE SOLE AND EXCLUSIVE WARRANTY. THERE SHALL BE NO OTHER WARRANTIES EXPRESS OR IMPLIED INCLUDING ANY IMPLIED WARRANTY OF MERCHANTABILITY OR FITNESS OR ANY OTHER OBLIGATION ON THE PART OF THE COMPANY WITH RESPECT TO PRODUCTS COVERED BY THIS WARRANTY. HOMEDICS SHALL HAVE NO LIABILITY FOR ANY INCIDENTAL, CONSEQUENTIAL OR SPECIAL DAMAGES. IN NO EVENT SHALL THIS WARRANTY REQUIRE MORE THAN THE REPAIR OR REPLACEMENT OF ANY PART OR PARTS WHICH ARE FOUND TO BE DEFECTIVE WITHIN THE EFFECTIVE PERIOD OF THE WARRANTY. NO REFUNDS WILL BE GIVEN. IF REPLACEMENT PARTS FOR DEFECTIVE MATERIALS ARE NOT AVAILABLE, HOMEDICS RESERVES THE RIGHT TO MAKE PRODUCT SUBSTITUTIONS IN LIEU OF REPAIR OR REPLACEMENT.

This warranty does not extend to the purchase of opened, used, repaired, repackaged and/or resealed products, including but not limited to sale of such products on Internet auction sites and/or sales of such products by surplus or bulk resellers. Any and all warranties or guarantees shall immediately cease and terminate as to any products or parts thereof which are repaired, replaced, altered, or modified, without the prior express and written consent of HoMedics.

This warranty provides you with specific legal rights. You may have additional rights which may vary from country to country. Because of individual country regulations, some of the above limitations and exclusions may not apply to you.

For more information regarding our product line in the USA, please visit: [www.homedics.com](http://www.homedics.com)