

TABLE TOP GRILL/GRIDDLE



Model Number:
169110
UPC: 681131691109

Customer Assistance

1 877 207 0923 (US)
1 877 556 0973 (Canada)

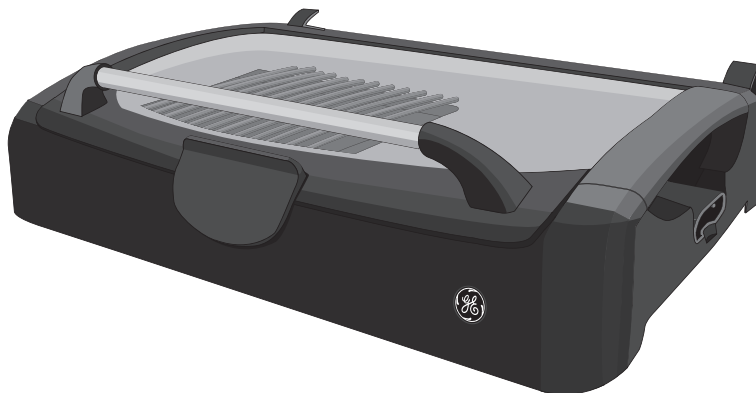

Thank you for purchasing a small GE appliance.

In keeping with the GE ecomagination initiative, please consider the option to recycle the packaging material and donate the appliance you are no longer using.

To read more about GE's ecomagination commitment, visit:
ge.ecomagination.com

IMPORTANT SAFEGUARDS

When using electrical appliances, basic safety precautions should always be followed to prevent the risk of fire, electric shock, burns, or other injuries or damages. This appliance is for household use only.

- **Read all instructions before use.**
- Do not touch hot surfaces. Use handles or knobs.
- To protect against electrical shock do not immerse cord, plugs, or the temperature control probe in water or other liquids.
- Close supervision is necessary when any appliance is used by or near children.
- Unplug from outlet when not in use and before cleaning. Allow it to cool before putting on or taking off parts.
- Do not operate appliance with a damaged cord or plug, or after the appliance malfunctions or has been dropped or damaged in any manner. Call our toll-free customer assistance number for information on examination, repair, or adjustment.
- The use of accessory attachments not recommended by the appliance manufacturer may cause injuries.
- Do not use outdoors.
- Do not let cord hang over edge of table or counter, or touch hot surfaces.
- Do not place on or near a hot gas or electric burner, or in a heated oven.
- Extreme caution must be used when moving an appliance containing hot oil or other hot liquids.
- Always attach plug to appliance first, then plug cord into the wall outlet. To disconnect, turn every control to "OFF", then remove plug from wall outlet.
- Do not use this appliance for anything other than its intended use.
- Fuel, such as charcoal briquettes, is not to be used with appliance.
- Do not operate unit without the drip tray.
- **Hot surface!** Do not touch the glass cover during use.

SAVE THESE INSTRUCTIONS!

ADDITIONAL SAFEGUARDS

This appliance is for **HOUSEHOLD USE ONLY**.

DO NOT OPERATE APPLIANCE IF THE LINE CORD SHOWS ANY DAMAGE, OR IF APPLIANCE WORKS INTERMITTENTLY OR STOPS WORKING ENTIRELY.

Extension cord use

A short power-supply cord (or detachable power-supply cord) is to be provided to reduce the risk resulting from becoming entangled in or tripping over a longer cord. Longer detachable power-supply cords or extension cords are available and may be used if care is exercised in their use. If a longer detachable power-supply cord or extension cord is used,

- 1) The marked electrical rating of the cord set or extension cord should be at least as great as the electrical rating of the appliance, and
- 2) The cord should be arranged so that it will not drape over the countertop or tabletop where it can be pulled on by children or tripped over unintentionally.

Polarized plug

This appliance has a polarized plug (one blade is wider than the other). To reduce the risk of electric shock, this plug is intended to fit into a polarized outlet only one way. If the plug does not fit fully into the outlet, reverse the plug. If it still does not fit, contact a qualified electrician. Do not attempt to modify the plug in any way.

PARTS



- | | |
|------------------------------|---------------------------------------|
| 1. Handle | 9. Control knob |
| 2. Clip | 10. Temperature control release lever |
| 3. Glass cover | 11. Polarized plug |
| 4. Handle of cooking plate | 12. Grill cooking plate |
| 5. Socket (in the plate) | 13. Griddle cooking plate |
| 6. Power cord | 14. Drip tray |
| 7. Temperature control probe | 15. Frame |
| 8. Power-on indicator light | |

ASSEMBLY & USE

Before first use

- Remove all packaging materials and any labels or stickers from your grill.
- Check if all parts (↳ *Parts*) have been included.
- Before using your grill for the first time, clean it thoroughly (↳ *Cleaning*).

NOTE: The first time you use your table grill, it may emit a slight odor and smoke. This is normal and not a malfunction.

Assembly

- Place the table grill on a clean and flat surface.
- Put the drip tray (14) with the higher edge to the back into the frame (15).
- Put the cooking plate (12/13) on the frame (15) above the drip tray (14).
- Insert the temperature control probe (7) with control knob (9) facing up into the socket (5) of the plate on the right side. Insert the plug (11) into power outlet.

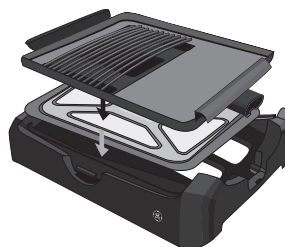

NOTE: Do not press the release lever while inserting the temperature control probe into the socket.

Using the table grill

- Apply a little vegetable oil on the cooking plate (12/13). We recommend the use of a good quality oil to enhance the flavor of your food.
- Turn the temperature control knob (9) to the desired temperature level:



Temperature range	Setting	Function
less than 300°F / 150°C	low	keep warm
300 - 350°F / 150 - 175°C	medium	slow cooking; fish, bacon
350 - 400°F / 175 - 205°C	high	marinated meats, teriyaki, pancakes
400 - 450°F / 205 - 230°C	max	sear meats, preheat

- The power-on indicator light (8) will illuminate blue to show power is on. Depending on the selected temperature, it might take a few minutes to reach the desired cooking temperature. When the thermostat has reached the desired temperature,

ASSEMBLY & USE

the indicator light **(8)** will go off. The grill is now ready to use. Before using, preheat unit until the indicator light **(8)** goes off. The cooking plate **(12/13)** has a non-stick surface and is divided in two parts:

- The griddle **(13)** side has a smooth surface and is perfect for bacon, eggs, pancakes, french toast, and toasted sandwiches.
- The grill **(12)** side has a ribbed surface and is intended for grilling steaks, hamburgers, chicken, seafood, and vegetables.
- Use a wooden spatula. Do not use sharp or plastic utensils to place food on the cooking plate or to remove food as these can damage the non-stick surface of the cooking plate.
- You may vary the setting of the control knob **(9)** at any time during operation.
- The indicator light **(8)** will continue to go on and off as the temperature is adjusted during operation.

CAUTION: The handles will get hot during use. Do not remove the cooking plate **(12/13)** from the frame. Allow the appliance to cool for at least 30 minutes before handling. Use the frame **(15)** to carry or move the unit. When doing so, do not use the handle of the glass cover **(1)** or that of the cooking plate **(4)**.

WARNING: This appliance generates heat and steam during use. Proper precautions must be taken to prevent the risk of burns, fires, or other injury to persons or damage to property.

- When you are finished, turn the temperature control knob **(9)** to the **OFF** position and the indicator light **(8)** will go off.
- Unplug the table grill from the wall outlet and press lever **(10)** to remove the temperature control probe **(7)**.

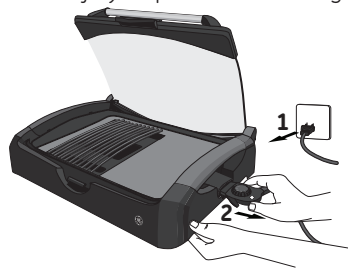

CLEANING

CAUTION: Before cleaning, unplug the table grill to prevent electric shock and let the table grill cool down completely.

Clean the table grill after every use. Do not use chemicals, abrasive cleaners, steel wool, or scouring pads. The non-stick surface or glass cover may become damaged or scratched. There are no user serviceable parts.

CLEANING

- Turn the temperature control knob **(9)** to the position **OFF**.
- Unplug the table grill from the wall outlet and press lever **(10)** to remove the temperature control probe **(7)**.
- Remove cover **(3)**, cooking plate **(12/13)**, and drip tray **(14)**.
- Clean cooking plate **(12/13)** with a soft sponge and warm water.
- Clean cover **(3)**, frame **(15)**, and drip tray **(14)** with dishwashing detergent and a soft sponge.
- Dry cooking plate **(12/13)**, drip tray **(14)** and frame **(15)**, and reassemble. The inner part of the socket must be completely dry before reinserting the temperature control probe. To dry the socket, wipe its inner part with a dry cloth. If necessary, shake out excess water first.

TROUBLESHOOTING

Problem	Solution
Table grill is not working.	<ul style="list-style-type: none"> ◆ Check power connection. ◆ Check if the temperature control probe (7) is correctly inserted in the socket (5).
Table grill emits smoke.	<ul style="list-style-type: none"> ◆ Check if there is food stuck in the table grill.

If additional assistance is needed, please contact Customer Assistance at 1.877.207.0923 (U.S.) or 1.877.556.0973 (Canada).

TECHNICAL DATA

Rated voltage:	120V ~60Hz
Rated current:	12.5A
Rated power input:	1500W

CUSTOMER ASSISTANCE

If you have a claim under this warranty, please call our Customer Assistance Number. For faster service, please have the model number and product name ready for the operator to assist you. This number can be found on the bottom of your appliance and on the front page of this manual.

Model Number: _____ **Product Name:** _____

Customer Assistance Number 1.877.207.0923 (U.S.) or 1.877.556.0973 (Canada).

Keep these numbers for future reference!

For more information, please visit us at WWW.GEHOUSEWARES.COM

Two-year limited warranty

What does your warranty cover?

- Any defect in material or workmanship.

For how long after the original purchase?

- Two years.

What will we do?

- Provide you with a new one.
- For those items still under warranty but no longer available, WAL-MART reserves the right to replace with a similar GE branded product of equal or greater value.

How do you make a warranty claim?

- Save your receipt.
- Properly pack your unit. We recommend using the original carton and packing materials.
- Return the product to your nearest WAL-MART store or call Customer Assistance at 1-877-207-0923 (U.S.) or 1-877-556-0973 (Canada).

What does your warranty not cover?

- Parts subject to wear, including, without limitation, glass parts, glass containers, cutter/strainer, blades, seals, gaskets, clutches, motor brushes, and/or agitators, etc.
- Commercial use or any other use not found in printed directions.
- Damage from misuse, abuse, or neglect, including failure to clean product regularly in accordance with manufacturer's instructions.

How does state law relate to this warranty?

- This warranty gives you specific legal rights, and you may also have other rights which vary from state to state or province to province.
- This warranty is in lieu of any other warranty or condition, whether express or implied, written or oral, including, without limitation, any statutory warranty or condition of merchantability or fitness for a particular purpose.
- WAL-MART, GE and the product manufacturer expressly disclaim all responsibility for special, incidental, and consequential damages or losses caused by use of this appliance. Any liability is expressly limited to an amount equal to the purchase price paid whether a claim, however instituted, is based on contract, indemnity, warranty, tort (including negligence), strict liability, or otherwise. Some states or provinces do not allow this exclusion or limitation of incidental or consequential losses, so the foregoing disclaimer may not apply to you.

What if you encounter a problem with this product while using it outside the country of purchase?

- The warranty is valid only in the country of purchase and if you follow the warranty claim procedure as noted.



is a trademark of General Electric Company and is used under the license by Wal-Mart Stores Inc., Bentonville, AR 72716

Marketed in Canada by:

Wal-Mart Canada Corp.
1940 Argentia Road, Mississauga,
Ontario L5N1P9