

# SYMPHONY 13

AQUATIC

**SYMPHONY SERIES MODEL # -- SEE BELOW**

AIIS7236LSY / AIIS7236LSYTO (LEFT DRAIN) / AIIS7236RSY / AIIS7236RSYTO (RIGHT DRAIN)

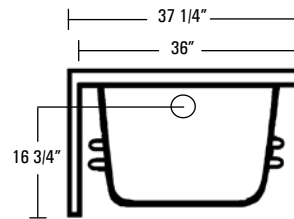
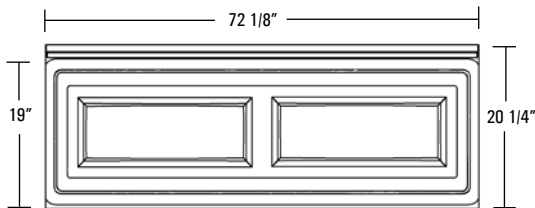
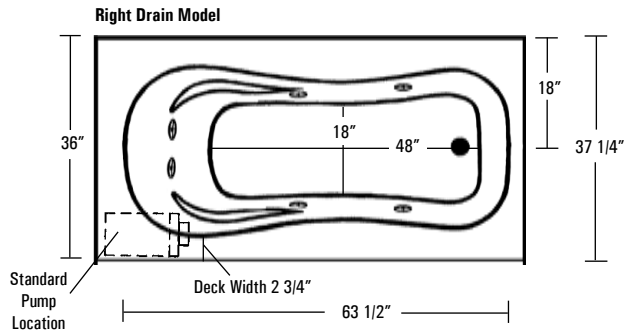

Note: Tub only model does not include access panels unless ordered as an option.

**Rough-In Plumbing Measurements**

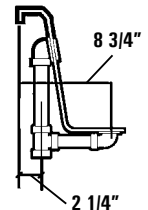

## SPECIFICATIONS:

### GENERAL SPECIFICATIONS:

Tub Size	72 1/8" x 36" x 20 1/4"
	183 cm x 91 cm x 51 cm
Bathing Well	48" long
	18" wide
	17" interior depth
Maximum Water Depth	13 3/4"
Shipping Weight	125 lbs. / 57 kg
Tub Weight Filled	652 lbs. / 296 kg
Tub Only Weight	86 lbs. / 39 kg
Gallons to Overflow	68 gal. / 257 L
Gallons to Operate	51 gal. / 193 L

### ELECTRICAL SPECIFICATIONS:

Pump	.80 HP; 5.5 AMP; 110V
Requirement	15 AMP; 110V, separate circuit required protected w/ Class A GFCI

### STANDARD EQUIPMENT:

- 6 Hydrotherapy Jets including:**
- 2 Spinning Back Jets
  - 4 Directional Jets
- Aquatic Quality Features:**
- .80 HP Run-Dry Pump
  - Bath-Side On/Off Air Switch
  - "Quiet Pad" Anti-Vibration Pump Mount for Quiet Pump Operation
  - Heat-bent Rigid PVC Piping for Optimum Sanitary Conditions
  - 2 Arm Rests
  - Integrally Molded Tile Flange
  - Color Matched Integral Skirt with Removable Access Panels
  - Color Matched Trim and Jets (Select Colors)
  - Right or Left Hand Drain
  - Durable, Easy to Clean, Lucite® Cast Acrylic Surface
  - Available in 8 Standard No-Charge Colors
- UL and IAPMO Listed, Factory Tested**  
**Limited 10 Year Warranty**

### OPTIONAL EQUIPMENT:

- Comfort Pillow--Oval or Rectangle
- Lift & Turn Waste and Overflow
  - Chrome, Polished Brass, Gold, Satin Nickel, Polished Nickel or Oil Rubbed Bronze
- Cable Drive Waste and Overflow
  - Chrome, Polished Brass, Gold, Satin Nickel, Polished Nickel, Oil Rubbed Bronze or Color Matched (Bone, White and Biscuit Only)
- Removable Access Panels (Tub Only)

*All acrylic colors featured by Aquatic match the industry's leading fixture manufacturers.*

**Fax-On-Demand  
Document # 1281**

