

**CADET 6' X 42" ELITE  
WHIRLPOOL  
Model No. 2774E**

*American Standard*

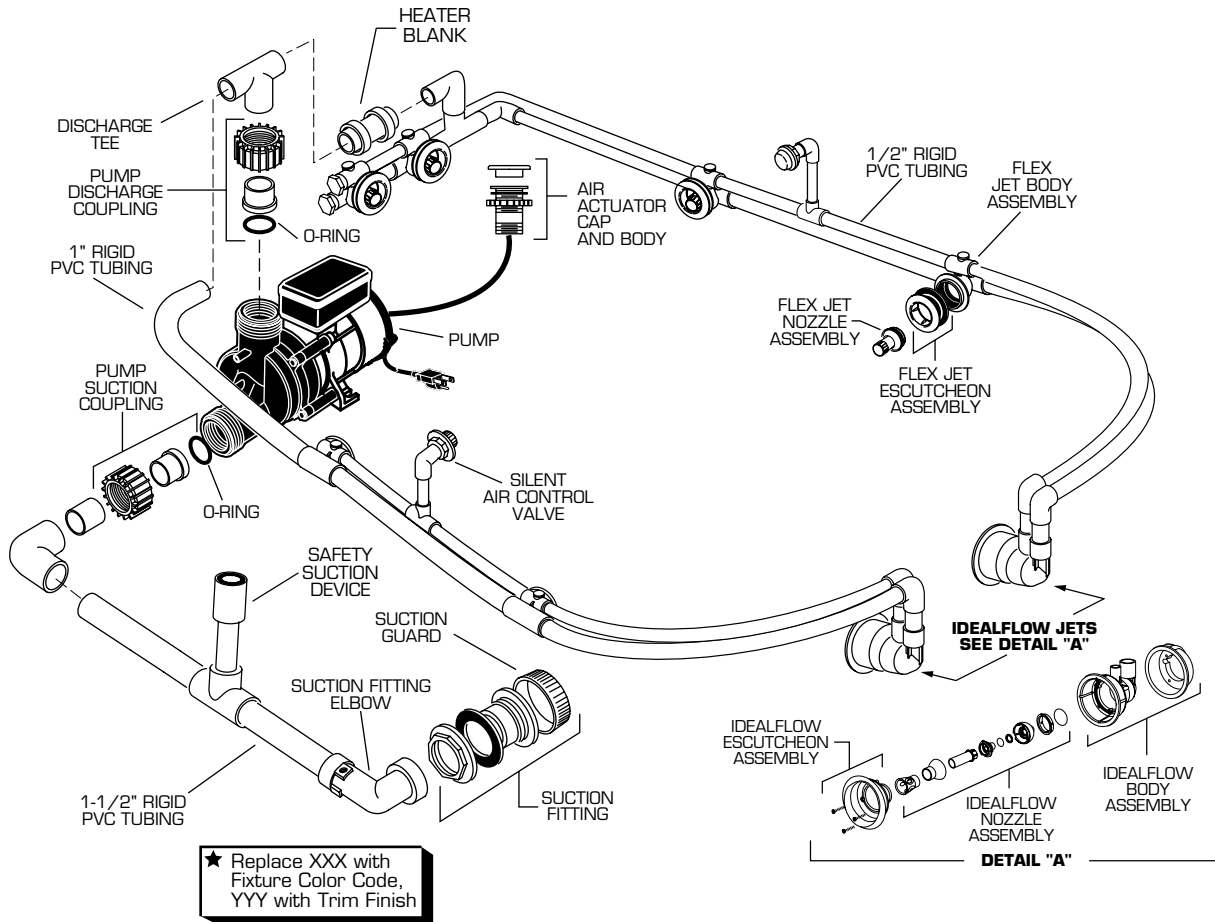

★ Replace XXX with Fixture Color Code, YYY with Trim Finish

DESCRIPTION	PART NUMBER	PKG QTY
Pump Suction Coupling	047186-0070A	1
O-Ring	047187-0070A	1
Pump Discharge Coupling	047186-0070A	1
★ Silent Air Control Valve	752855-XXX0A	1
★ Flex Jet Nozzle Assembly Δ	752851-XXX0A	1
★ Flex Jet Escutcheon Assembly ○	752850-XXX0A	1
Flex Jet Body Assembly	752849-0070A	1
★ Idealflow Nozzle Assembly	752407-XXX0A	1
★ Idealflow Escutcheon Assembly	752408-XXX0A	1
Idealflow Body Assembly	752409-0070A	1
★ Suction Guard	047463-XXX0A	1
★ Suction Fitting	047550-XXX0A	1
Suction Fitting Elbow	751186-0070A	1
★ Discharge Tee	047438-0070A	1
Pump (2.1 H.P.)	752857-0070A	1
Air Switch	752388-0070A	1
★ Air Actuator Cap and Body	752439-XXX0A	1
Air Actuator Tubing	047602-0070A	3 ft.
Safety Suction Device 8 Lb.	752205-1000A	1

**NOTE:** Schedule 40 Rigid PVC Piping available through local plumbing supply outlets.

- ★ Replace XXX with Fixture Color Code, YYY with Trim Finish
- Δ Removal/installation requires tool part no. 752905-0070A
- Removal/installation requires tool part no. 752906-0070A