

HappyLite® Mini | **PLUS**

Sunshine Supplement Light System

VT01

Job#: 0.0612	Title: VT01 Manual
Date: 04/22/09	Version: VT01-MAN-Rev5v3



Dear Customer,

Thank you for purchasing the Verilux® HappyLite® Mini Plus Sunshine Supplement Light System. You have received an innovative and quality manufactured product, backed by a one-year limited warranty. As a Verilux® customer, your satisfaction means everything to us. We look forward to serving you now and in the future.

This product brings healthful Natural Spectrum® Daylight into your home or office. Many other healthy lighting products are available through our catalog and online. To request a free copy of our catalog, call our toll-free number 1-888-544-4865. You may also visit us on the web at www.Verilux.com to learn more about all our quality Verilux® products.

Have a Bright Day!

A handwritten signature in black ink that reads "Nicholas Harmon". The signature is written in a cursive, flowing style.

Nicholas Harmon
President, Verilux, Inc.

Contents

Warnings and Precautions	4
Features	5
Set-up Instructions	6
Package Contents.	6
Bulb Installation.	7
Diffuser Installation	8
Selecting a Location	9
Operation.	10
Instructions for Use	10
Recommended Usage	11
Bulb Removal and Replacement	12
Troubleshooting	13
Care and Cleaning.	13
Disclaimer	14
Technical Specifications	14
Warranty	15

Job#: 0.0612	Title: VT01 Manual
Date: 04/22/09	Version: VT01-MAN-Rev5v3

Warnings and Precautions

- Please read these instructions before using this lamp.
- For indoor use only.
- Do not place near any heat sources such as radiators, heat registers, stoves, or other apparatus (including amplifiers) that produce heat.
- Do not block any ventilation openings.
- Do not defeat the safety purpose of the polarized plug. A polarized plug has two blades with one wider than the other. The wider blade is provided for your safety. If the provided plug does not fit in your outlet, consult an electrician for replacement of the obsolete outlet.
- Protect the power cord from being walked on or pinched, particularly at plugs, convenience receptacles and the point where the power cord exits the lamp.
- Unplug this lamp during lightning storms or when unused for long periods.
- If the lamp has been damaged in any way, such as the power-supply cord or plug is damaged, liquid has been spilled or objects have fallen onto the lamp, the lamp has been exposed to rain or moisture, does not operate normally, or has been dropped, it should not be operated. *There are no user serviceable parts in this lamp.*
- Do not use with power supply voltage other than 120V AC.
- Avoid placing the lamp in areas that are dusty, humid/moist, lack ventilation or are subject to constant vibration.
- Not for use with light dimmers, timers, motion detectors, voltage transformers or extension cords.
- Close supervision is recommended when this lamp is used by or near children, or others who may not understand the need for these precautions.
- Do not leave the lamp unattended during use.
- Do not use a lubricating agent in bulb assembly.

Warnings and Precautions continued



WARNING: TO REDUCE THE RISK OF FIRE, ELECTRIC SHOCK OR PERSONAL INJURY:

- Turn off/unplug and allow to cool before replacing bulb or cleaning.
- Light bulbs get hot quickly! Do not touch the bulb while the lamp is on.
- Do not look directly at the lighted bulb without the diffuser being in place.
- Do not operate the lamp in close proximity to flammable or combustible vapors, such as aerosol spray products, or where oxygen is being administered.
- Use only the type of bulb and maximum wattage indicated by Verilux®.
- Never cover the lamp when it is in operation.
- To prevent risk of shock or personal injury when cleaning lamp, make sure you have turned off and unplugged the lamp, and allow sufficient time for the bulb to cool.

SAVE THESE INSTRUCTIONS

Features

Your new Verilux® HappyLite® Sunlight Supplement Light System is a remarkable product with features that include:

- Natural sunlight delivered to your home, office, dorm room or apartment, with no dangerous UV rays.
- Up to 2,500 LUX of bright Natural Spectrum® light to lift spirits, sharpen concentration and improve energy levels.
- Activates your body's own energy enhancers to make you more alert and productive.
- Compact design makes it easy to place in a convenient spot.
- Energy-efficient, cool-burning 26-Watt 10,000-hour bulb.
- Convenient on-off power switch on cord.
- Best-in-class power system with electronic ballast and Flicker Elimination Technology™ assure no-buzz operation and instant-on, flicker-free illumination.

Job#: 0.0612	Title: VT01 Manual
Date: 04/22/09	Version: VT01-MAN-Rev5v3

Package Contents

Unpacking

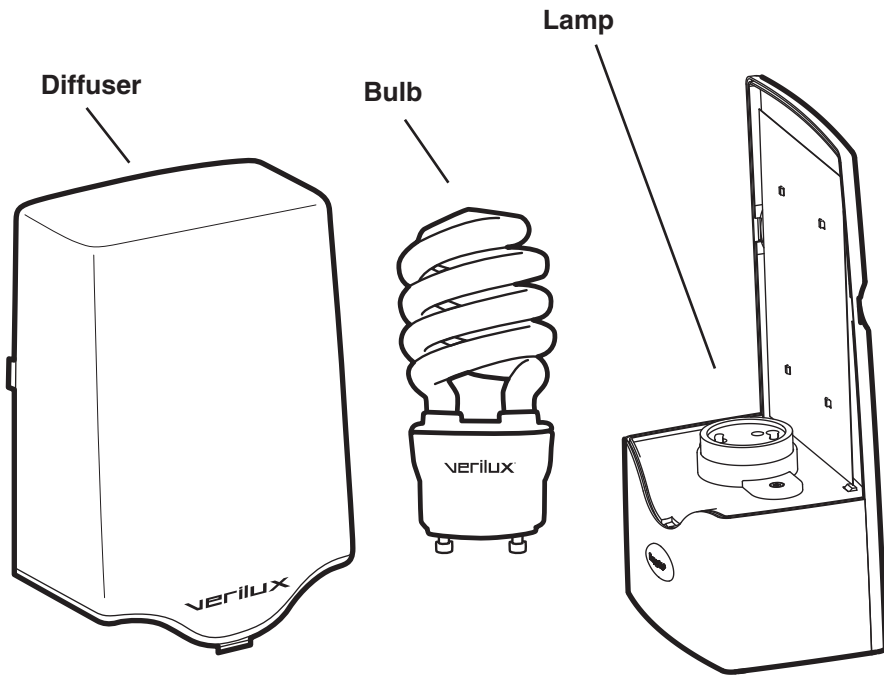

Set-up Instructions

Bulb Installation

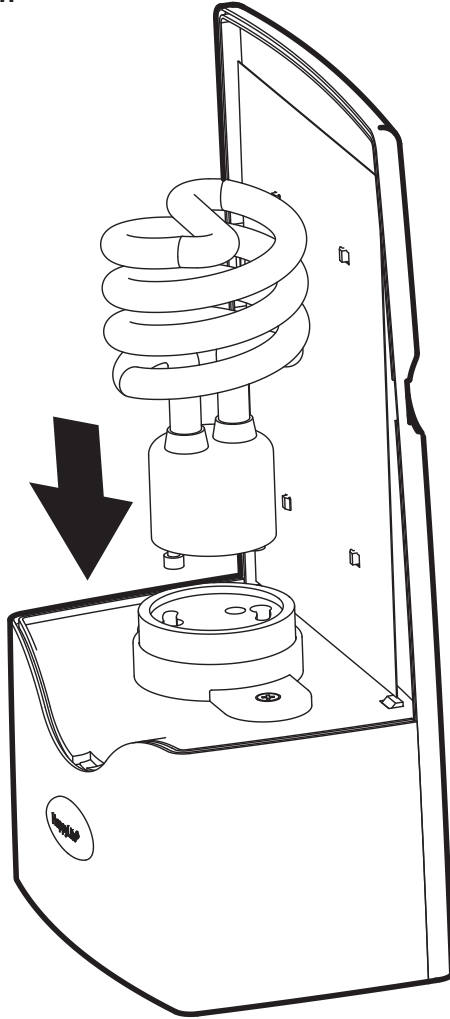

To install the bulb, insert bulb into lamp by firmly holding bulb base and pushing down and rotating slightly in a clockwise direction to seat properly.

Job#: 0.0612	Title: VT01 Manual
Date: 04/22/09	Version: VT01-MAN-Rev5v3

Set-up Instructions continued

Diffuser Installation

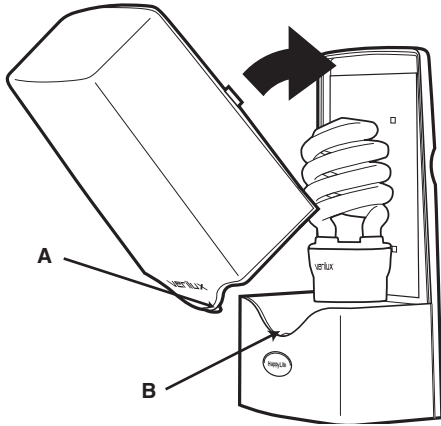

1. Attach the diffuser to the lamp body by first inserting the tab located at the bottom of the diffuser (A) into the opening of the lamp base (B).

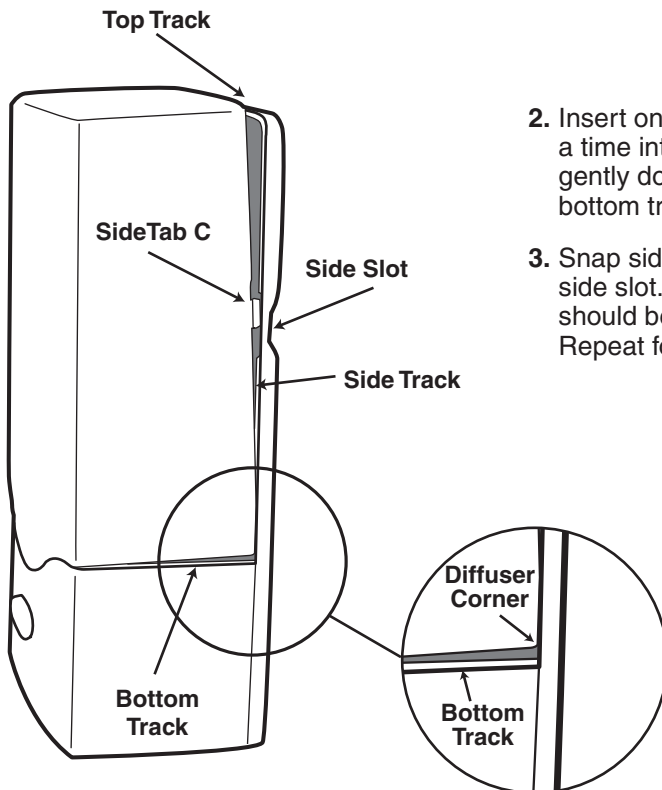

2. Insert one diffuser corner at a time into the side track and gently down into place into the bottom track.
3. Snap side tab into place on side slot. Entire side of diffuser should be seated into the track. Repeat for other side of diffuser.

Note: Alignment of diffuser corner into side track

Set-up Instructions continued

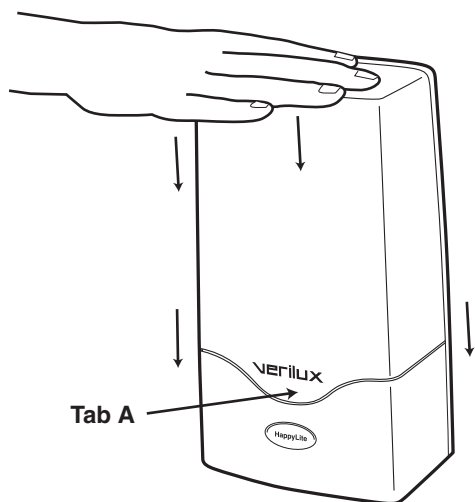

4. Firmly push lens down until Tab A snaps into place. Align top of lens in top track as necessary.

Selecting a Location

- Place your Verilux® HappyLite® Mini Plus Sunshine Supplement Light System on a table or other flat surface.
- For best performance, place the lamp within 18 inches of you.

Note: Avoid placing this lamp in areas that are exposed to direct sunlight or close to heat-radiating products, such as heaters. Do not place the lamp on the top of appliances that radiate heat.



WARNING: DO NOT BLOCK VENTS

Vents are necessary for proper function of the electronic ballast; blocking them may cause overheating of the electronics and increase risk of fire.

Operation

Instructions for Use

Light therapy consists of sitting close to the HappyLite® Mini with your eyes open. While staying oriented toward the light, feel free to engage in other activities such as reading, writing, hobbies and crafts, sewing, needlepoint, applying makeup, painting, or working at your computer or desk.

1. Turn on the lamp and allow a few minutes for the bulb to achieve full brightness.
2. The HappyLite® Mini should be positioned 5-18 inches from your eyes, and should be slightly offset from center (see diagram) **Note:** *It is not necessary to stare directly at the light.*

The light from the HappyLite® Mini must be directed at your eyes; therefore, your eyes must be open to achieve the full benefit. **Note:** *Tinted glasses reduce the amount of light reaching your eyes.*

When you are feeling sluggish and lethargic, spend more time with the light, sit closer to the light, or add more lighting devices to increase the intensity. If you experience edginess, or are over stimulated, move the light further away or reduce usage time.

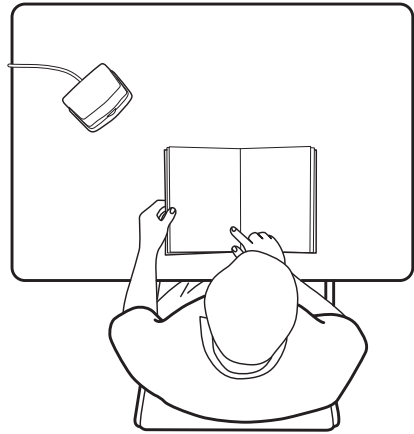

Operation continued

Recommended Usage

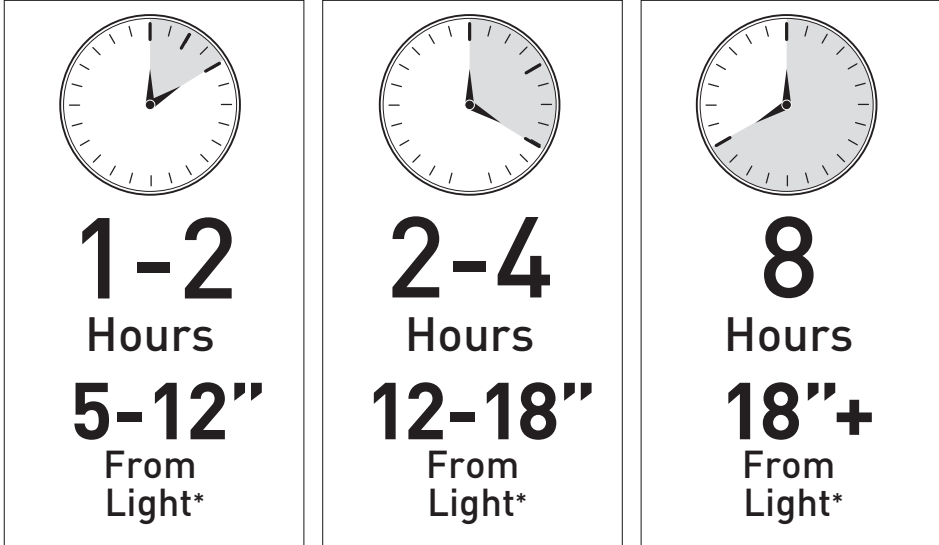

Recommended exposure time is a function of output and distance
Individual results may vary
*2,500 LUX at 5"

Optimum time depends upon how your body uniquely responds to light. Typical recommended usage time is 1 to 6 hours per day. Ideally, the HappyLite® should be used first thing in the morning. **Note:** *We recommend limiting use during the evening.*

Different exposure strategies work best for different people. It is important to establish a distance and schedule that is comfortable for you. We recommend you use the light regularly and at about the same time each day. It is not necessary to sit in front of the lamp continuously. You can divide the time into several mini sessions. Continue to use the HappyLite® daily until you feel an improvement in your mood and activity level.

Bulb Removal and Replacement

Your HappyLite® uses a bulb manufactured only by Verilux®. To order a replacement bulb, please call Verilux®, toll-free, at 1-800-454-4408.

To Replace the Bulb:

1. Unplug the lamp from power outlet.
2. To access the bulb, remove the plastic diffuser by pressing the tabs (D) and lifting out the diffuser.
3. Firmly hold the bulb base (B) (do not hold the glass portion of the bulb) and turn bulb in a slight counter-clockwise direction until it releases from the socket.
4. To re-install bulb and plastic diffuser, see instructions on pages 6 and 7.

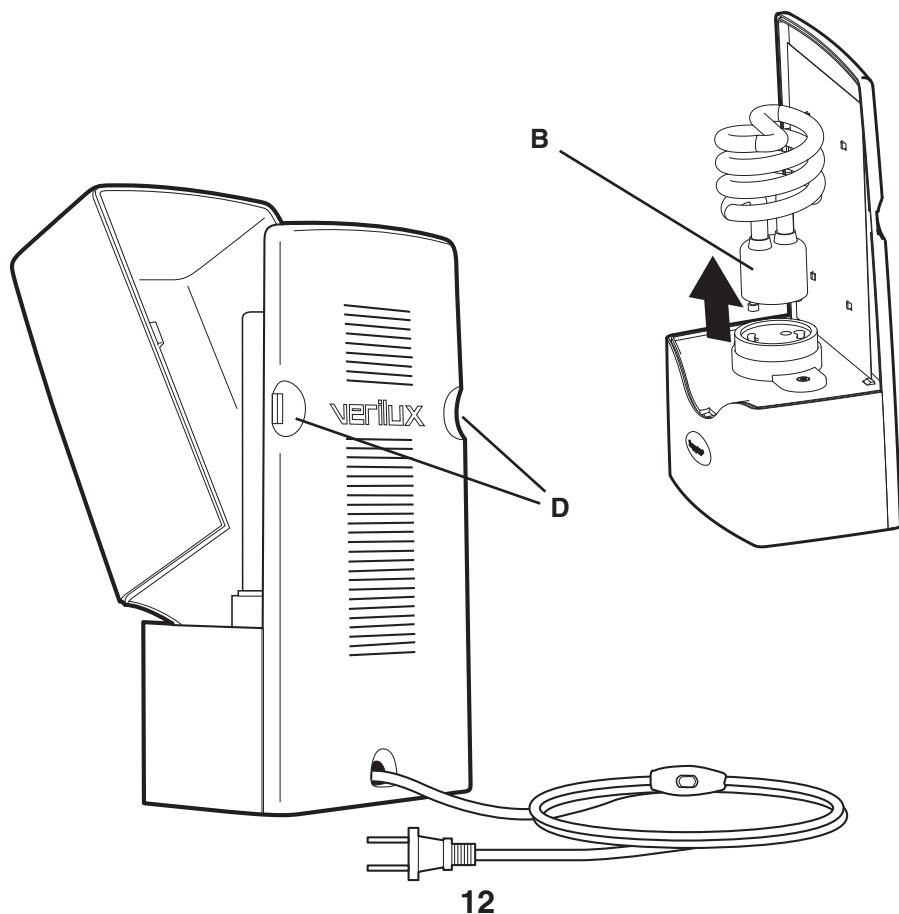

Troubleshooting

Before requesting service on your Verilux® lamp, please read the following:

- Make sure all power connectors, cords, and plugs are inserted fully and securely.
- Be sure the bulb is securely seated in the socket. (See pages 6 and 7)
- Make sure there is power to the wall outlet or try another outlet – one that is not connected to a dimmer.

PROBLEM	CHECK	SOLUTION
Light won't come on	Has the plug come loose?	Insert plug securely into wall outlet.
	Is the bulb old?	Check bulb for blackening/darkening at bottom of spiral where it joins the base (an indicator of bulb life) and replace bulb.
	Is the bulb connected securely into socket?	Be sure the bulb is securely seated into socket, repeat the bulb installation process.
Blackening/darkening at ends of bulb	Is the bulb new?	Sometimes when a new bulb is turned on for the first time the tube will darken, but this will fade after a few minutes.
	Is the bulb old?	With older bulbs darkening of the tube indicates end of bulb life. (This doesn't affect operation except to reduce the amount of light available since the phosphor in that area has become inactive). Bulb replacement is recommended.
Light Flickers	Has the plug come loose?	Insert plug securely into wall outlet.
	Is the bulb connected securely to the socket?	Be sure the bulb is securely seated into socket, repeat the bulb installation process.
	Is the lamp connected to a dimmer switch?	Connect lamp plug only to wall outlet without dimmer switch.

Care and Cleaning

Your Verilux® lamp is made from high quality materials that will last for many years with a minimum of care.

Clean only with a soft dry cloth – **DO NOT USE SOLVENTS OR CLEANERS CONTAINING ABRASIVES OR AMMONIA**



WARNING: To prevent risk of shock or personal injury when cleaning lamp, make sure you have turned off and unplugged the lamp, and allow sufficient time for the bulb to cool.

Disclaimer

Verilux® does not make any medical claims regarding the use of this product. This product is solely intended for use as portable supplemental lighting; and is not listed as a medical device. Always consult a qualified health care professional before using light therapy. It is especially advisable that you contact a doctor if:

- You are hypersensitive to light and/or experience eye discomfort.
- You are currently taking any medication that might increase your sensitivity to light.
- There is no improvement after using the product for two weeks, or if you feel uncomfortable after using the product.
- You have a history of eye disease including, but not limited to, cataracts or macular degeneration.

Each individual's sensitivity to light is different. Each person must use his/her own judgment when determining the length of time spent exposed to the light. The use of this product is the sole responsibility of the consumer.

Note: *The bulb used in this lamp does not emit any harmful levels of UV.*

Technical Specifications

HAPPYLITE® MINI PLUS

Environment

Operating Temperature: 15°C to 35°C; 56°F to 95°F

Storage Temperature: 0°C to 40°C; 32°F to 104°F

Relative Humidity: 5% to 95% non-condensing

Bulb

Replacement bulb: 26-Watt 10,000-hour bulb (replace with Verilux® brand only, Model number CFS26GU24VLX)

Power

Input Power: AC 120V~60Hz

UL Listed

Warranty

One-Year Limited Warranty

ATTENTION! ONCE OPENED, PLEASE **DO NOT** RETURN THIS PRODUCT TO THE STORE WHERE IT WAS PURCHASED FOR REPAIR OR REPLACEMENT!

Many questions may be answered by visiting www.Verilux.com, or you may call our customer service department at 1-888-544-4865

This limited warranty is provided by:

Verilux, Inc., 340 Mad River Park, Waitsfield, VT 05673

Verilux® warrants this product to be free from defects in material and workmanship for a period of one year from the date of the original retail purchase. During the limited warranty period, Verilux, Inc. will, at its option, repair or replace defective parts of this product, at no charge to the customer, subject to the following limitations. This limited warranty does not include any postage, freight, insurance or delivery fees. This warranty does not cover damage, defect or failure caused by or resulting from accident, external destruction, alteration, modification, abuse, misuse, or misapplication of this product.

If, during the first year of ownership, this product fails to operate properly, it should be returned as specified below:

Please pack the defective product in its original protective packing and box, with a copy of your sales receipt, name, address and telephone number, along with \$9.95 (check or money order to cover shipping and handling), and send to:

**For U.S. Postal Service Only:
Verilux® Warranty
Service Center, c/o WTB**

P.O. Box 119, West Redding, CT 06896

**For Fed Ex & UPS Only:
Verilux® Warranty
Service Center, c/o WTB**

32 Henry Street, Bldg 17A, Bethel, CT 06801

Please allow 4-6 weeks before you receive the repaired or replaced product.

ATTENTION: When returning a product, be aware that damage during shipping is the responsibility of the purchaser and will void any warranty claim. We recommend that you insure the shipment by shipper when returning this product or any parts. Be sure to return product in original packaging.

Note: Verilux® recommends using a quality surge suppressor on all electronics equipment. Voltage variations and spikes can damage electronic components in any system. A quality suppressor can eliminate the vast majority of failures attributed to surges and may be purchased at electronics stores.

Due to ongoing improvements, actual product may have slight variations from the product described in this manual.

Job#: 0.0612	Title: VT01 Manual
Date: 04/22/09	Version: VT01-MAN-Rev5v3

**Please visit our web site at:
www.Verilux.com
or call our Customer Service Department at
1-888-544-4865**

Representatives are available 8 a.m. – 10 p.m. M – S, 9 a.m. – 8 p.m. Sunday EST

verilux[®]

340 Mad River Park, Waitsfield, VT 05673