



**PTO Generator Trailer
ITEM # 165959
For use on 13000, 27500, and
60000 PTOG North Star
Generators or Other PTO
Generators up to 60kW.**

M165959A

PLACE MANUAL NAMEPLATE HERE

OWNER'S MANUAL

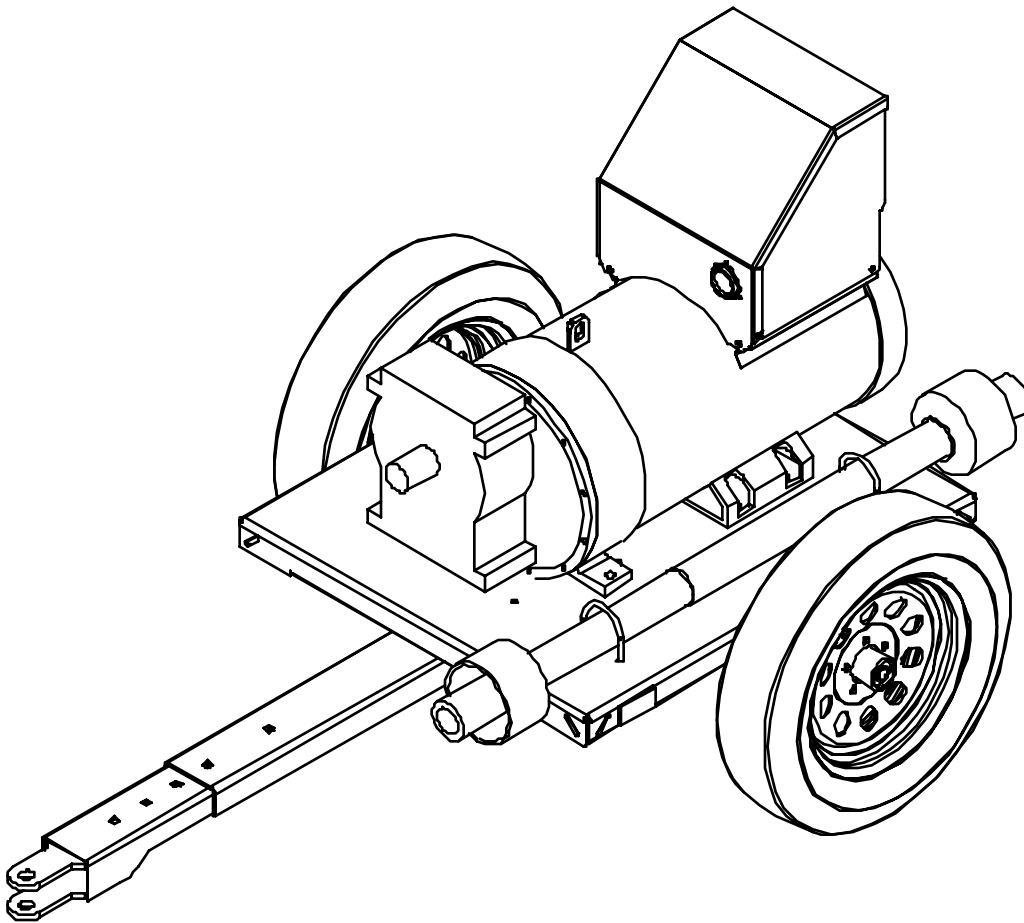

00641

**Any Questions, Comments, or Problems?
Call Customer Service at 1-800-270-0810
Hours: Monday - Friday 7:30 AM to 5:30 PM
Saturday 7:30 to 11:30 AM CST**

THANK YOU

Thank you for purchasing a NorthStar PTO Trailer. Your trailer is designed for long life, dependability, and the top performance you demand. Please take time now to read through this manual so you can better understand the machine's operation and safety precautions. Everyone who uses this trailer must read and understand this manual. Enjoy the exceptional performance of your NorthStar PTO Trailer.

IMPORTANT

Make certain the operator:

- Reads and understands the manuals pertaining to this trailer and generator.
- Is instructed in safe and proper operation of this trailer and generator.

NOTICE

K-BAR Industries Incorporated reserves the right to make improvements in design and/or changes in specifications at any time without incurring any obligation to install them on units previously sold.

WARNINGS

NEVER load the trailer with more than 1200 lbs.

NEVER use this trailer for PTO Generators over 60 kW.

NEVER exceed 30 mph with this trailer.

ALWAYS replace damaged reflectors.

ALWAYS read your owners manual before operating.

ALWAYS check for loose fasteners before each use.

ALWAYS engage PTO while tractor is idling.

ALWAYS read your PTO Generator manual before operating.

STEP 1

- Open hardware bag and separate the components.

FASTENERS (actual size)

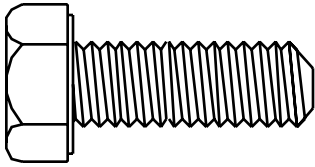

1/2-13 X 1.25" Long
Hex Head Bolt Qty. 8

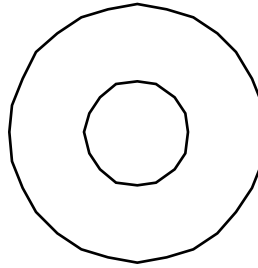

1/2" Flat Washer
Qty. 18

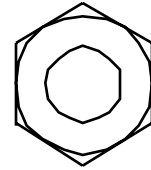

1/2-13 Ny-Loc Nut
Qty. 10

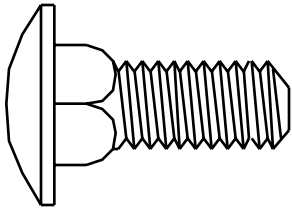

1/2-20 X 1.25" Long
Carriage Bolt Qty. 2

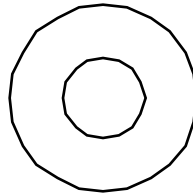

3/8" Flat Washer
Qty. 6

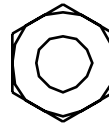

3/8-16 Hex Nut
Qty. 2

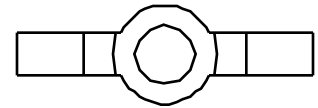

3/8-16 Ny-Loc Wing Nut
Qty. 6

MISCELLANEOUS COMPONENTS (not actual size)

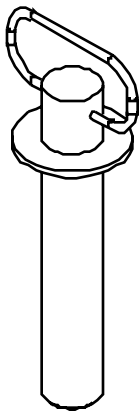

Hitch Pin With Chain
and Lynch Pin
Qty. 1



Lug Bolts
Qty. 10

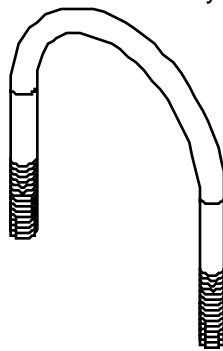

PTO Implement
Shaft Retainer
Qty. 2

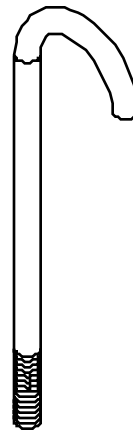

Cord Hooks
Qty. 2

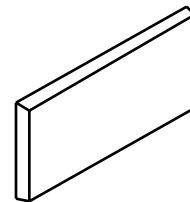

Red Reflector
Qty. 2

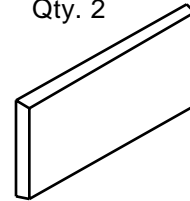

Amber Reflector
Qty. 2

00672

STEP 2

- Remove remaining components from the box. Discard unpainted shipping bracket. Place trailer Base on two supports at least twelve(12) inches high.

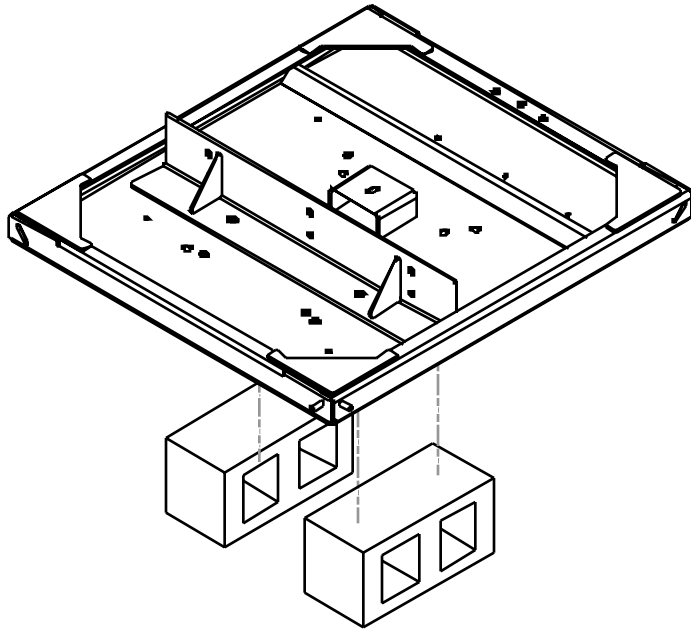

00673

STEP 3

- Bolt the Axle to the Base with (6) 1/2"-13 x 1.25 hex head bolts, (12) 1/2" flat washers, and (6) 1/2-13 Ny-Loc nuts.

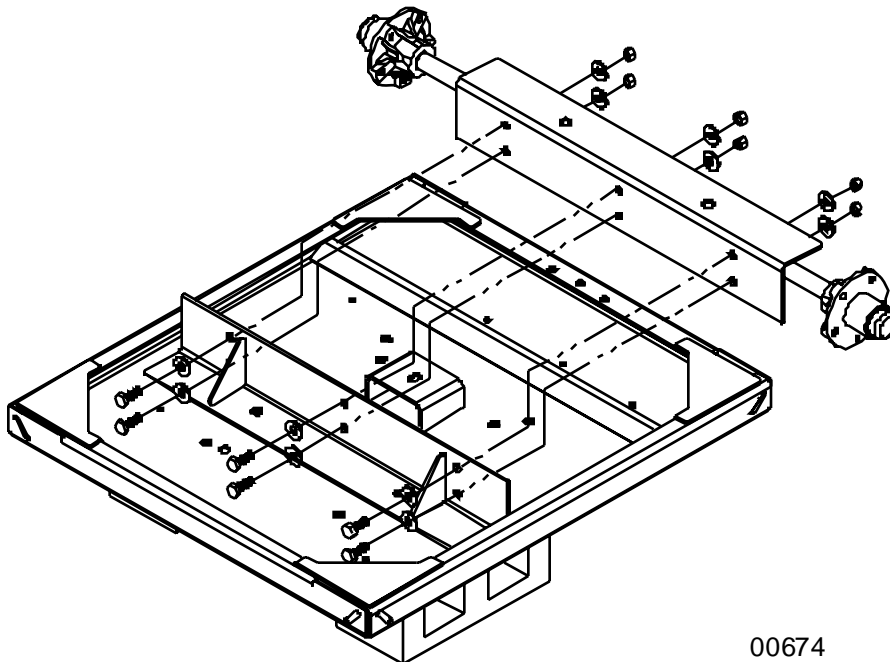

00674

STEP 4

- Assemble Tongue Arm to Base with (2) 1/2-13 X 1.25" hex head bolts, (4) 1/2 Flat Washers, and (2) 1/2-13 Ny-Loc Nuts. Assemble Tongue to Tongue Arm with (2) 1/2-13 X 1.25 Carriage bolts, (2) 1/2 flat washers, and (2) 1/2-13 Ny-Loc nuts. Note: The Tongue Arm and Tongue is adjustable to fit many different PTO Generators and PTO Implement Shafts. You may need to adjust the Tongue to fit your implement shaft. The Tongue Arm pivots and is adjustable to fit different PTO Generators, if you have a NorthStar PTO Generator use the center hole.

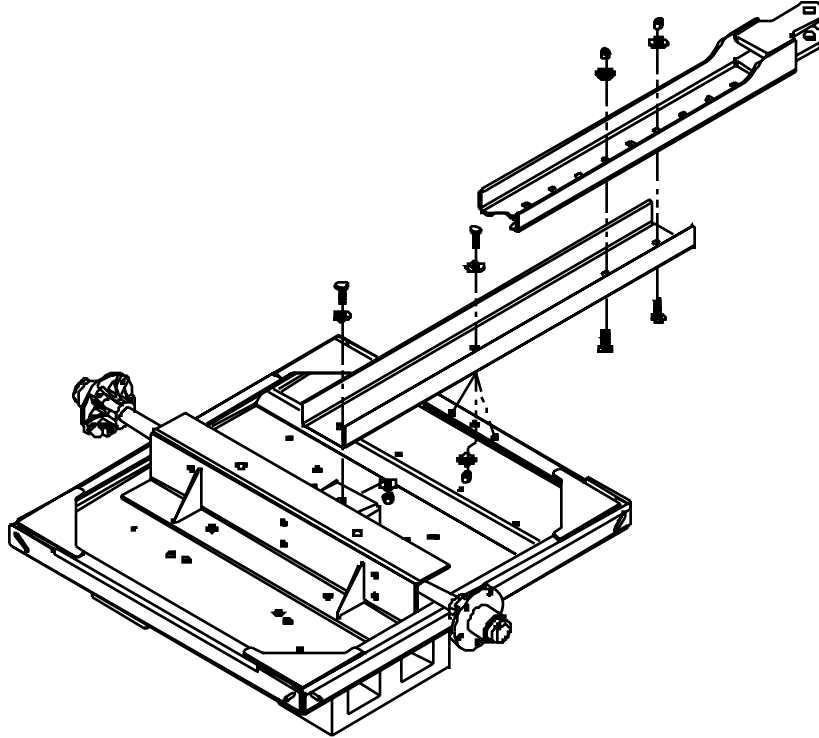

00675

STEP 5

- Assembly wheels to hubs with the 10 lug bolts.

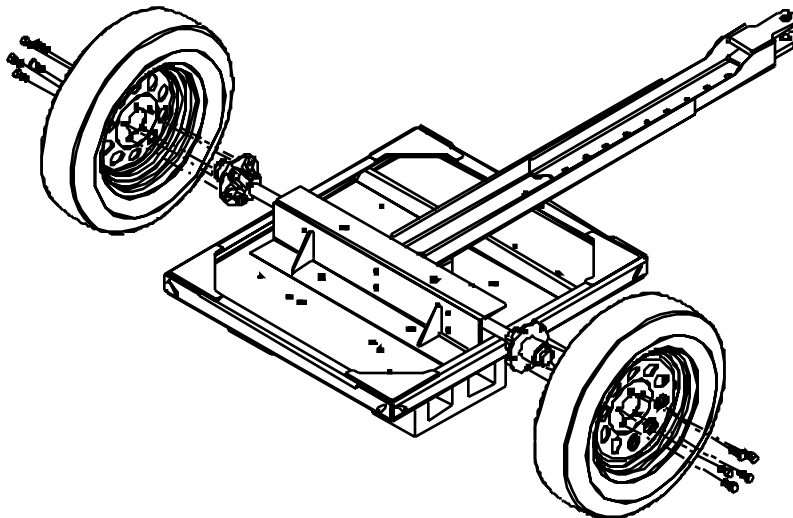

00676

STEP 6

- Apply the (2) red reflectors to the rear of the trailer and (2) amber reflectors to front sides of the trailer as shown. Assemble the (2) cord hooks to the trailer with (2) 3/8-16 hex nuts, (2) 3/8 flat washers, and (2) 3/8-16 Ny-Loc wing nuts. Assemble the (2) PTO Implement shaft retainer to the trailer with (4) 3/8 flat washers, and (4) 3/8-16 Ny-Loc wing nuts. Discard any remaining fasteners.

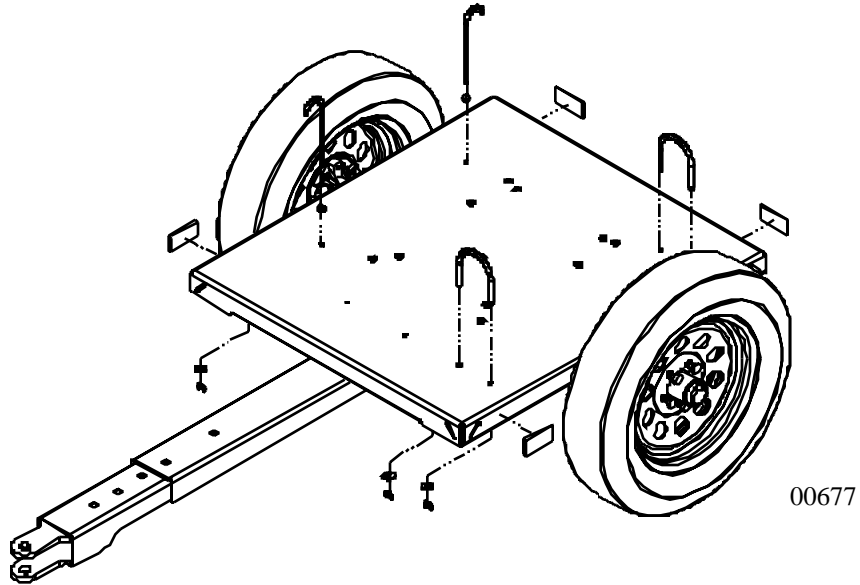

STEP 7

- Mount NorthStar PTO Generators to trailer using one of the three following bolt patterns. For other PTO Generators you may need to drill mounting holes.

NorthStar Item
#165929

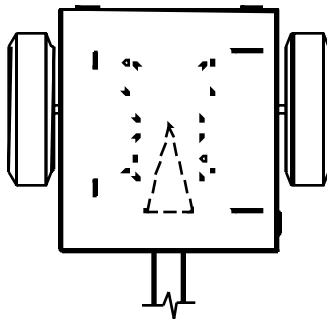

NorthStar Item
#165949

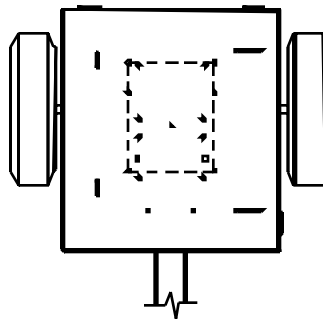

NorthStar Item
#165937A

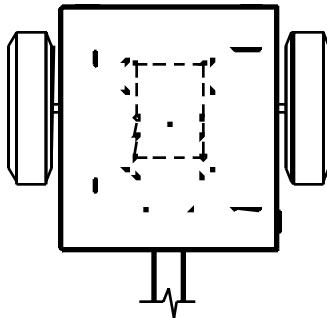

NorthStar
Item
#165937B &
C

