

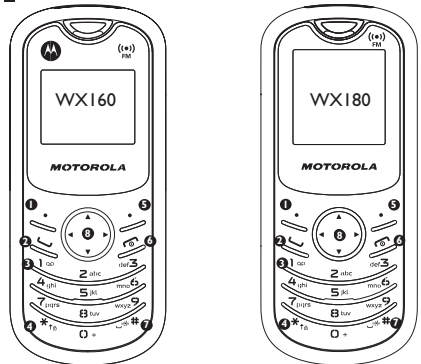

MOTO™ WX160/ WX180

Caution: Before using your phone for the first time, please read the important legal and safety information

Your mobile



- 1 Left softkey
- 2 Pick up/Send call
- 3 Call memory
- 4 Voicemail
- 5 Lock/Unlock
- 6 Right softkey
- 7 Switch on/ Switch off
- 8 End call
- 9 Vibration alert
- 10 Navigation key (1)
- 11 Menu/Confirm an option
- 12 Messages
- 13 Directory
- 14 FM radio
- 15 Alarm

Caution: Prolonged exposure to music at full volume on the music player may damage the listener's hearing. Set your phone volume safely. Use only the recommended headphones

WX160
WX180

(1) Depending on your network operator.

1.1 Keys

- Navigation key
Confirm an option (press the middle of the key)
Access "Templates" in "Messages" (1)
(long keypress in main screen)
Access favorite contact(s) (2) (long keypress in main screen)
- Pick up
Send a call
Access call memory (Redial) (short keypress)
- Switch on/Switch off the telephone
(long keypress)
End call
Return to the main screen
- Left softkey
- Right softkey
- Access your voicemail (long keypress)
- In edit mode
- Short keypress: access the language list
- Long keypress: enter zero
- In Edit mode:
- Short keypress: change input methods
- Long keypress: access the Symbols table
- From main screen
- Short keypress: #
- Long keypress: activate/deactivate the vibrator
In edit mode:
- Short keypress: (space)
- Long keypress: add a word

(1) WX160 only.
(2) WX180 only.

1.2 Main screen icons

- Battery charge level.**
- Vibration alert:** your phone vibrates, but neither rings nor beeps except for the alarms.
- Headset connected.**
- Call forwarding activated:** your calls are forwarded.
- Alarm clock programmed.**
- Voicemail message arrived.**
- FM radio is on.**
- Unanswered calls.**
- Roaming.**
- Line switching (3):** indicates the selected line.
Shown only in no ciphering mode while calling, sending/receiving SMS.
- Level of network reception.**
- Silence mode (4):** your phone neither rings, beeps nor vibrates except for the alarms.
- Message unread.**
- Keypad locked**
- Stopwatch is active**
- Ringtone alert**
- Vibration and ringtone alert**

(1) WX160 only.
(2) WX180 only.
(3) Depending on your network operator.

2 Getting started

Caution: See battery use & safety information.

2.1 Set-up

Removing and installing the back cover

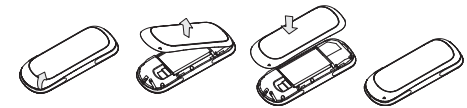

Installing and removing the battery



Inserting and removing the SIM Card



Place the SIM card with the chip facing downwards and slide it into its housing. Make sure that it is correctly inserted. To remove the card, press it and slide it out.

2.2 Power on your phone

Hold down the key until the phone powers on.

2.3 Power off your phone

Hold down the key from the main screen.

3 Calls

3.1 Making a call

Dial the desired number then press the key to place the call. If you make a mistake, you can delete the incorrect digits by pressing the right softkey.

To hang up the call, press the key.

Making an emergency call

If your phone is covered by the network, dial emergency number and press the key to make an emergency call. This works even without a SIM card and without typing the PIN code or unlocking the keypad.

3.2 Calling your voicemail (1)

To access your voicemail, hold down the key.

3.3 Receiving a call

When you receive an incoming call, press the key to talk and then hang up using the key.

3.4 Available functions during the call

During a call, you can use your directory, short messages, etc. without losing your correspondent.

(1) Contact your network operator to check service availability.

4 Call register

4.1 Call memory

You can access your call memory by pressing the key from the main screen.

4.2 My numbers

Type in or modify your telephone number or the number to access your voicemail and confirm by pressing . Your telephone number is usually written on your SIM card.

4.3 Billing

You can access different items with this option: Amount, Duration.

4.4 Call settings

You can access a number of items with this option: Call waiting, Call forwarding, Call barring, Answer mode, Auto redial...

4.5 Call control (1)

The menu serves you the dual purposes of cost monitoring and controlling during a call by the settings of "By cost" and "By duration".

(1) Depending on your network operator.

5 Directory

5.1 Consulting your directory

To access the **directory** from the main screen, press the key and select the icon from the menu.

5.2 Creating a file

Select the directory in which you wish to create a file, press the "Options" softkey, select "Create file" then .

Note: Maximum length of the field Name in the Phone Book is 16 characters except if some national characters (UCS2) are used in which case the length is 7.

6 Messages

6.1 Create message

From the main menu select "Messages" to create text message. You can type a message, and you're also able to insert a pre-defined message from "Templates". While writing a message, select "Options" to access all the messaging options. You can save your messages that you send often to "Drafts".

(1) WX160 only.
(2) WX180 only.
(3) Depending on the model.

7 Display (1)

7.1 Wallpaper

The wallpaper is displayed when you switch on your telephone.

7.2 Power On/Off (2)

You can customise your welcome animation or image that appears when you switch on your phone. You can also customise your OFF screen with an image or animation.

7.3 Brightness

You may adjust black level with respect to LCD display by pressing the key.

8 Settings

From the main screen, select the icon menu and select the function of your choice in order to customise your telephone: Display (3), Clock, Keys, Dictionary, More settings...

9.1 Organizer

Once you enter this menu from "Tools", there is a monthly-view calendar for you to keep track of important meetings, appointments, etc. Days with events entered will be marked in color.

9.2 Stopwatch

StopWatch is simple application for measuring time with possibility to register several results and suspend/resume measurement.

9.3 Alarm

Your mobile phone has a built-in alarm clock with a snooze feature.

9.4 Calculator

Hold down the key to get the decimal point. Confirm with the key or the left softkey.

9.5 Converter

Unit converter and Currency converter.

9.6 My shortcuts

Access the shortcuts already programmed. To programme new shortcuts: select "My shortcuts" if you want to create a quick access to a function, Directory, etc.

10 Games

Your phone may include some games.

10.1 Game settings

It allows you to manage settings, in which you may set background music and vibration alert.

11 FM radio (1), (2)

Your phone is equipped with an FM radio with RDS functionality. You can use the application as a traditional FM radio with automatic tuning and saved channels or with parallel visual information related to the radio program on the display, if you tune to stations that offer Visual Radio service. You can listen to it while running other applications.

(1) The quality of the radio depends on the coverage of the radio station in that particular area.
(2) A compatible headset model AP1701AE7X3 needs to be attached to the device for proper functionality.

12 Profiles

With this menu, you may personalise ringtones for different events and environments.

13 Latin input mode

To write messages, there are two writing methods:

- Normal: this mode allows you to type a text by choosing a letter or a sequence of characters associated with a key. Press the key several times until the desired letter is highlighted. When you release the key the highlight character is inserted into the text.
- Predictive with the Zi mode: this mode speeds up the writing of your text. Write the word by pressing a key between and and . Press the key once and the word will be modified each time you press a key. As you go on, the word will keep changing. Example: For "Tomorrow", press on the following keys: = Toom -> -> tomorrow
- + key in edit mode
Short keypress: access the language list
Long keypress: enter zero

Legal and Safety

Battery Use & Safety

Important: Handle and store batteries properly to avoid injury or damage. Most battery issues arise from improper handling of batteries, and particularly from the continued use of damaged batteries.

- DON'Ts**
- **Don't disassemble, crush, puncture, shred or otherwise attempt to change the form of your battery.**
- **Don't let the phone or battery come in contact with water.** Water can get into the phone's circuits, leading to corrosion. If the phone and/or battery get wet, have them checked by your carrier or contact Motorola, even if they appear to be working properly.
- **Don't allow the battery to touch metal objects.** If metal objects, such as jewellery, stay in prolonged contact with the battery contact points, the battery could become very hot.
- **Don't place your battery near a heat source.** Excessive heat can damage the phone or the battery. High temperatures can cause the battery to swell, leak or malfunction. Therefore:
- **Do not dry a wet or damp battery with an appliance or heat source, such as a hair dryer or microwave oven.**
- Avoid leaving your phone in your car in high temperatures.
- DOs**
- **Do avoid dropping the battery or phone.** Dropping these items, especially on a hard surface, can potentially cause damage.
- **Do contact your service provider or Motorola if your phone or battery has been damaged by being dropped or by high temperatures.**

Important: Use Motorola Original products for quality assurance and safeguards. To aid consumers in identifying authentic Motorola batteries from non-original or counterfeit batteries (that may not have adequate safety protection), Motorola provides holograms on its batteries. Consumers should confirm that any battery they purchase has a "Motorola Original" hologram.

