

ASSEMBLY  
PLANTING  
STARTING

QUESTIONS?

Call: 1-800-476-9669

Email: [customerservice@aerogrow.com](mailto:customerservice@aerogrow.com)

Visit Our Website: [www.aerogrow.com/help](http://www.aerogrow.com/help)

# Simple Steps

To Get Your  
*AeroGarden™* Mini  
Up and Growing

## Quick Start Guide



*AeroGarden™* Mini

# IMPORTANT SAFETY INSTRUCTIONS

(SAVE THESE INSTRUCTIONS)

When using this AeroGarden Mini electrical furnishing, basic precautions should always be followed, including the following:

**Read all directions before using this AeroGarden Mini furnishing.**

1. To reduce the risk of electric shock, the AeroGarden Mini has a specific plug. Do not change the plug in any way.

**DANGER** – to reduce risk of electric shock:

2. Always unplug the AeroGarden Mini from the electrical outlet before cleaning or changing the Grow Bulb.

**WARNING** – to reduce risk of burns, fire, electric shock, or injury to persons:

3. Unplug AeroGarden Mini from outlet before putting on or taking off parts.
4. Close supervision is necessary when the AeroGarden Mini is used by or near children, invalids, or disabled persons.
5. Use the AeroGarden Mini only for its intended use as described in the instructions. Do not use attachments not recommended by the manufacturer.
6. Never operate the AeroGarden Mini if it has a damaged cord or plug, if it is not working properly, if it has been dropped and damaged, or dropped into water, contact your supplier for instructions.
7. Keep the cord away from heated surfaces.
8. Never operate the AeroGarden Mini with the air openings blocked or covered.
9. Never drop or insert any object into any electrical openings.
10. Do not use outdoors.
11. Do not operate where aerosol (spray) products are being used or where oxygen is being administered.
12. Do not touch moving parts or hot parts such as pumps, bulb, reflective surfaces, and the like.
13. To disconnect, remove plug from outlet.
14. Do not place or submerge the base, cord, plug, or lamp hood in water or other liquid to clean it.
15. Do not allow water to contact hot lamp bulb.
16. Use only approved and supplied parts and accessories. Use only lamp model #100340 Grow Bulb (light bulb) with this AeroGarden Mini unit. Replacement parts can be ordered from your supplier.
17. Do not use the AeroGarden Mini for other than intended purpose.
18. This product is intended for household, residential and office use only. This product is not approved for commercial applications.
19. Read and follow all important notices on the AeroGarden Mini and in the accompanying literature.
20. If the supply cord is damaged, it must be replaced by the manufacturer, its service agent, or similarly qualified technician in order to avoid a hazard.
21. The electrical wiring must be in accordance with local regulations.

## LIMITED WARRANTY

**What Is Covered** – This warranty covers any defects in materials or workmanship, with the exceptions stated below.

**How Long Coverage Lasts** – This warranty runs for one (1) year on the AeroGarden Mini and six (6) months on the Grow Bulb, from the date of original purchase, for the original purchaser/user.

**What is Not Covered** – The warranty shall not apply to problems arising from: normal wear; failure to adhere to enclosed operating instructions; serial numbered products if the serial number has been removed or defaced; products subject to negligence, accident, improper use, maintenance or storage; products damaged by circumstances beyond AeroGrow International, Inc.'s control; loss or damage to removable parts; or products modified (including, but not limited to, modifications through the use of unauthorized parts or attachments) or repaired by anyone other than AeroGrow International, Inc., or its designee. This warranty excludes all incidental or consequential damages.

**What AeroGrow Will Do** – AeroGrow, at its option, will repair any defects in materials or workmanship or will replace these products with ones of similar features and price. AeroGrow's sole obligation and your exclusive remedy under this warranty shall be limited to such repair or replacement.

**To Return This Product** – If you have questions or concerns with your AeroGarden Mini, please do not return to retailer. Call Customer Service at 1-800-476-9669 for return authorization and instructions. Unauthorized returns, as well as C.O.D. shipments will be refused.

*Due to continuing improvements, actual product may differ slightly from the product described herein.*

*Some states do not allow the exclusion or limitation of incidental or consequential damages, so the above limitation or exclusion may not apply to you.*

*This warranty gives you specific legal rights, and you may have other legal rights that vary from state to state.*

If you have any questions please feel free to contact our customer service representatives at [customerservice@aerogrow.com](mailto:customerservice@aerogrow.com).

AeroGrow International, Inc.  
P.O. Box 18750, Boulder, CO 80308

### CAUTION

You are cautioned that any changes or modifications not expressly approved in this manual could void your authority to operate this equipment.

### NOTE:

This equipment has been tested and found to comply with the limits for a Class B digital device, pursuant to Part 15 of the FCC Rules. These limits are designed to provide reasonable protection against harmful interference in a residential installation. This equipment generates, uses, and can radiate radio frequency energy and, if not installed and used in accordance with the instructions, may cause harmful interference to radio communications. However, there is no guarantee that interference will not occur in a particular installation. If this equipment does cause harmful interference to radio or television reception, which can be determined by turning the equipment off and on, the user is encouraged to try to correct the interference by one or more of the following measures: Reorient or relocate the receiving antenna; Increase the separation between the equipment and receiver; Connect the equipment into an outlet on a circuit different from that to which the receiver is connected; or, Consult the dealer or an experienced radio/TV technician for help.

# 1 Quick Start Assembly (No tools required)

## A Unpack Your AeroGarden Mini

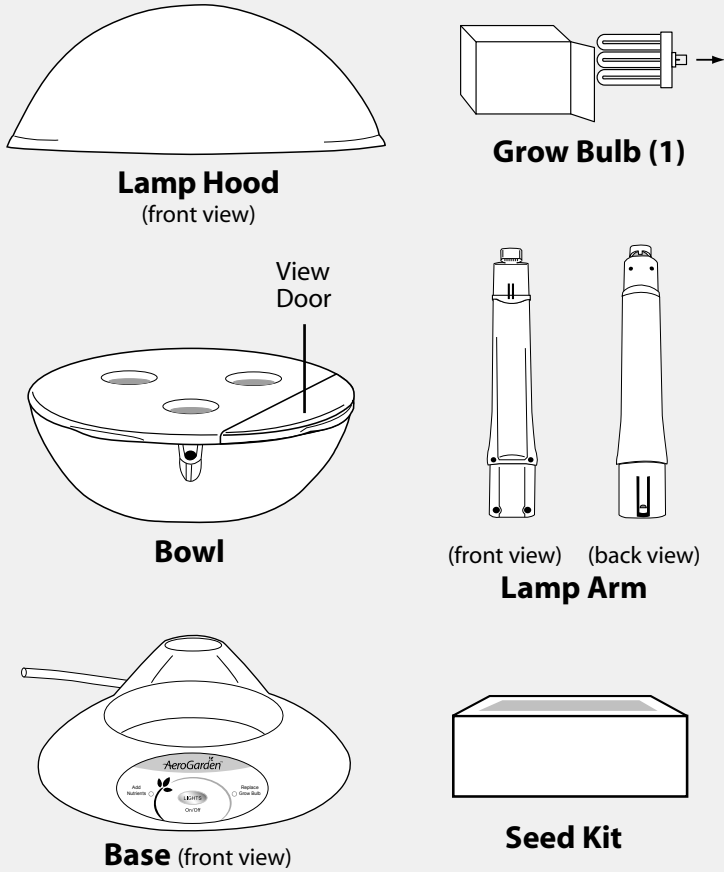

## B Insert Lamp Arm into Base

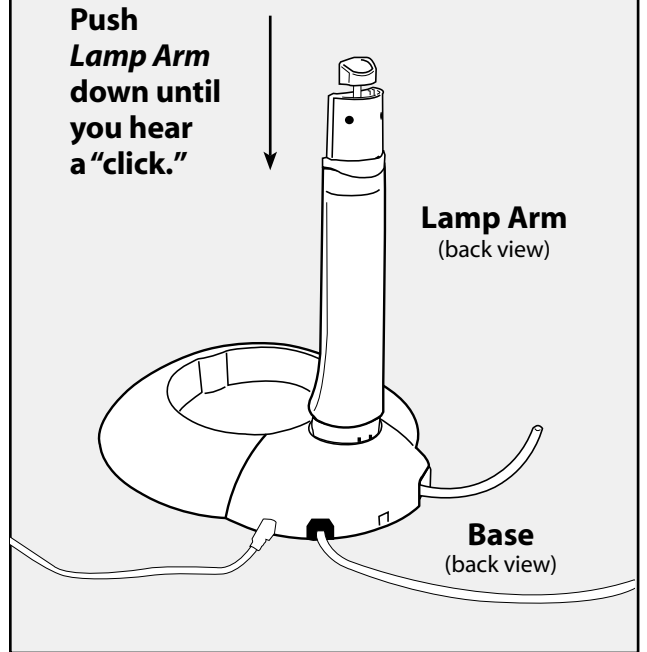

## D Plug Lamp Cord into Lamp Hood

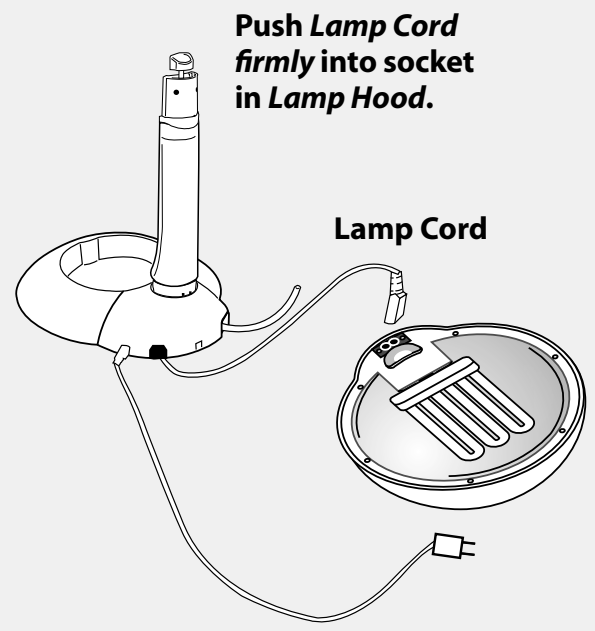

## C Insert Grow Bulb into Lamp Hood

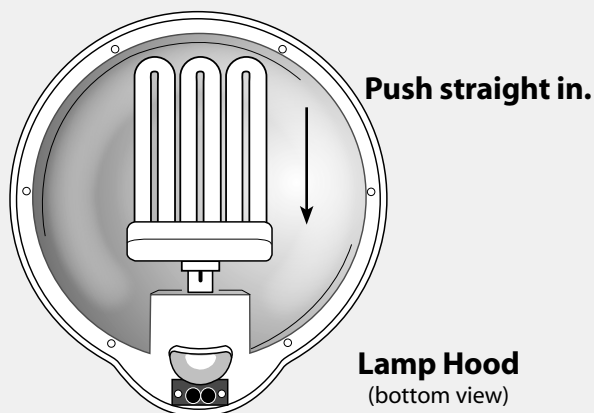

**DO NOT TWIST BULB!**

# 1 Quick Start Assembly (Continued)

## E Insert Lamp Hood into Lamp Arm

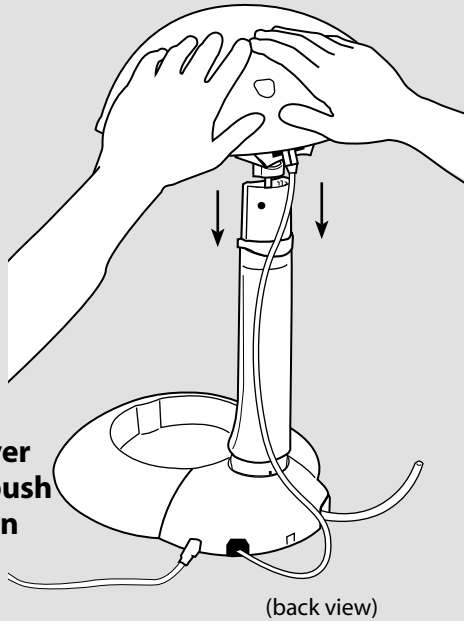

## F Set Bowl into Base

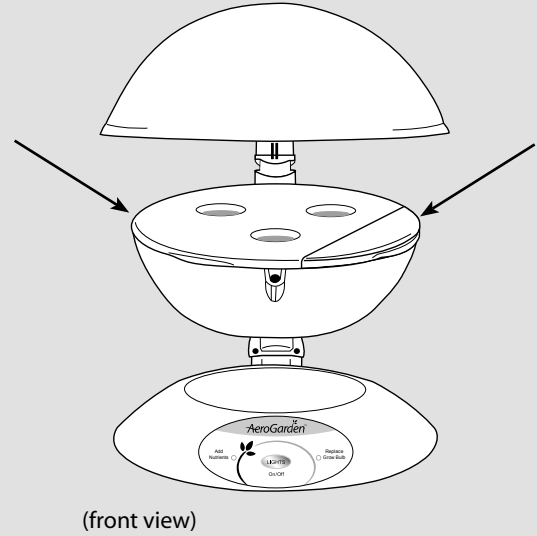

## G Insert Air Hose

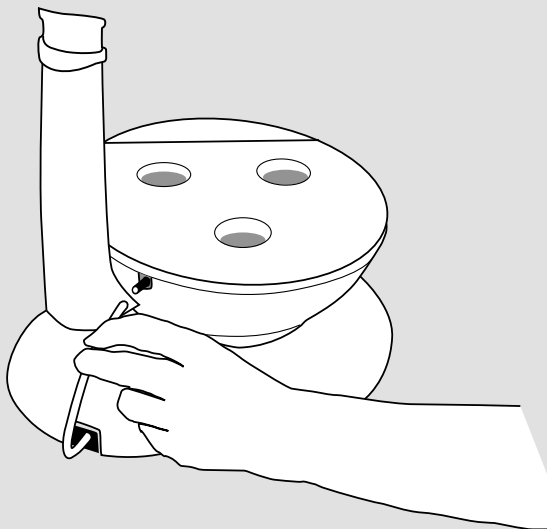

## H Moving Your AeroGarden Mini

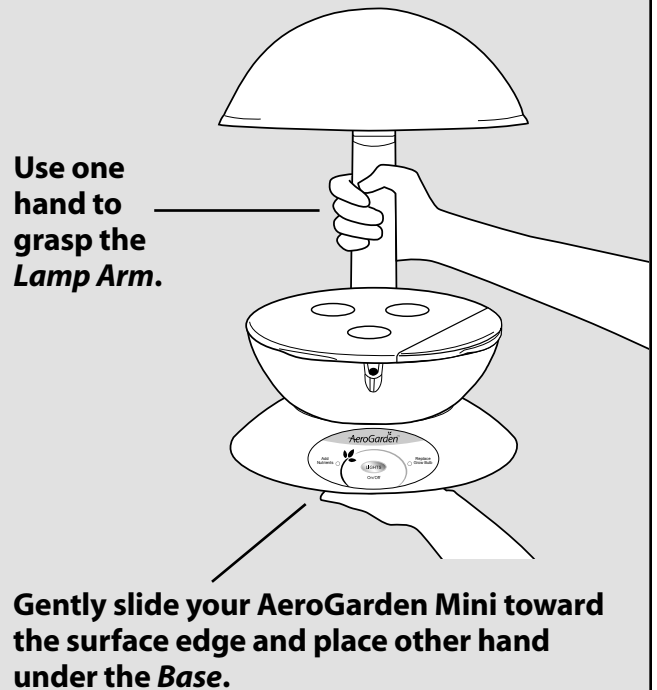

## I Place Your Garden

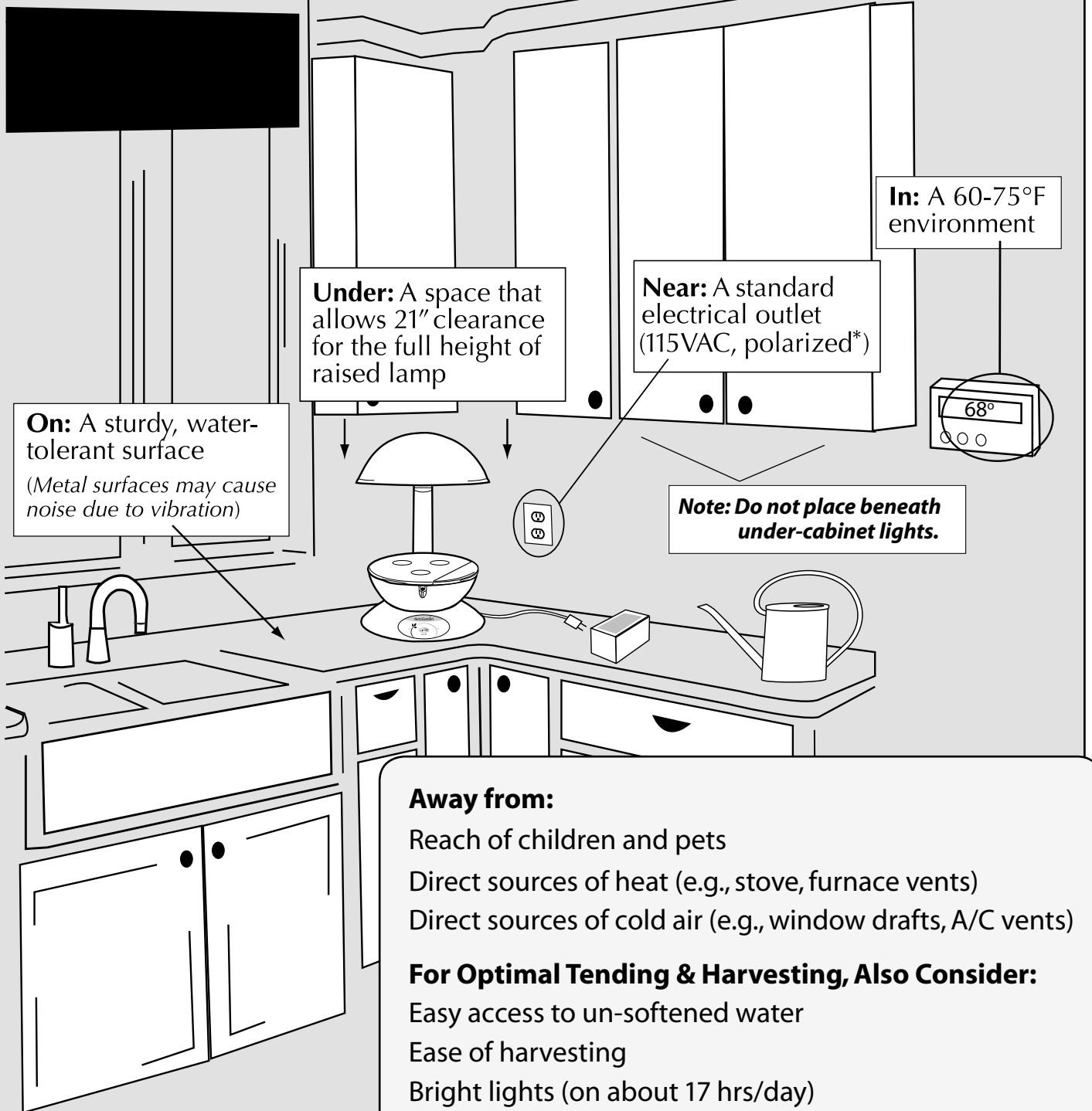

# 2 Planting Your Garden

## A Add Water Using a Spouted Container

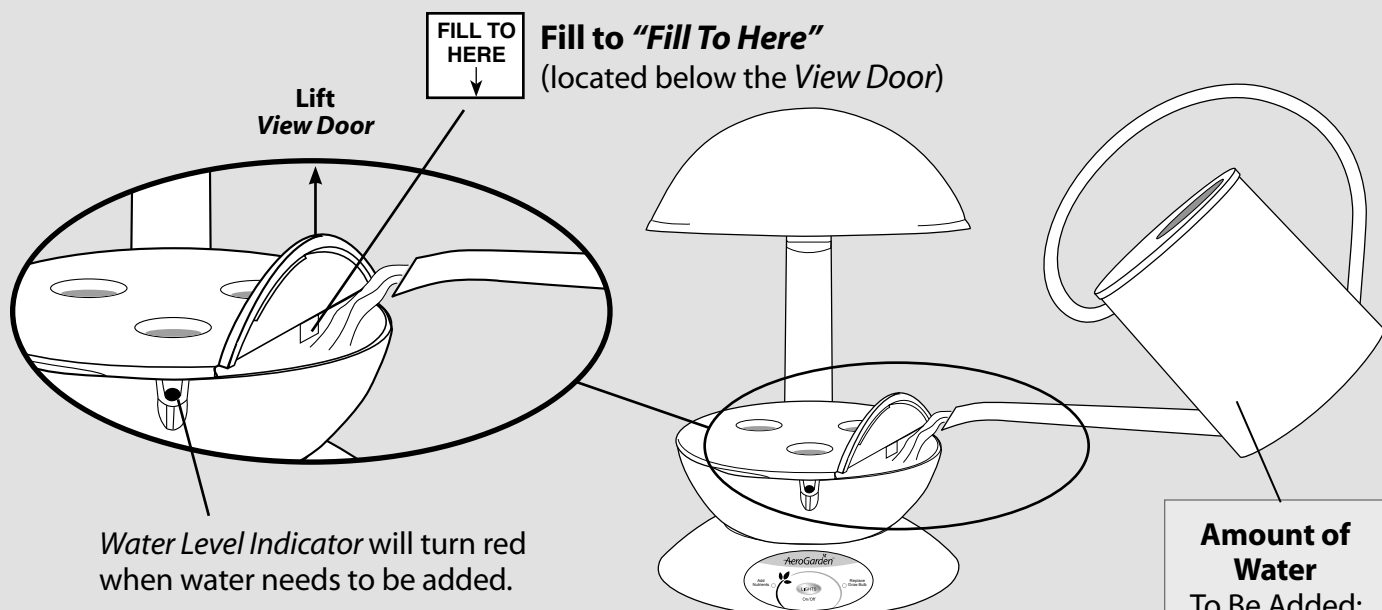

Use *room temperature* municipal tap, bottled or purified water. **Do not** use well or softened water.

## B Plant Your Garden

Insert *Seed Pods* into *Grow Surface* openings.

Check to see that:

- There is a *Seed Pod* or *Plant Spacer* in every opening.
- *Seed Pod Labels* are facing forward.
- *Seed Pods* are pressed *firmly* in place.

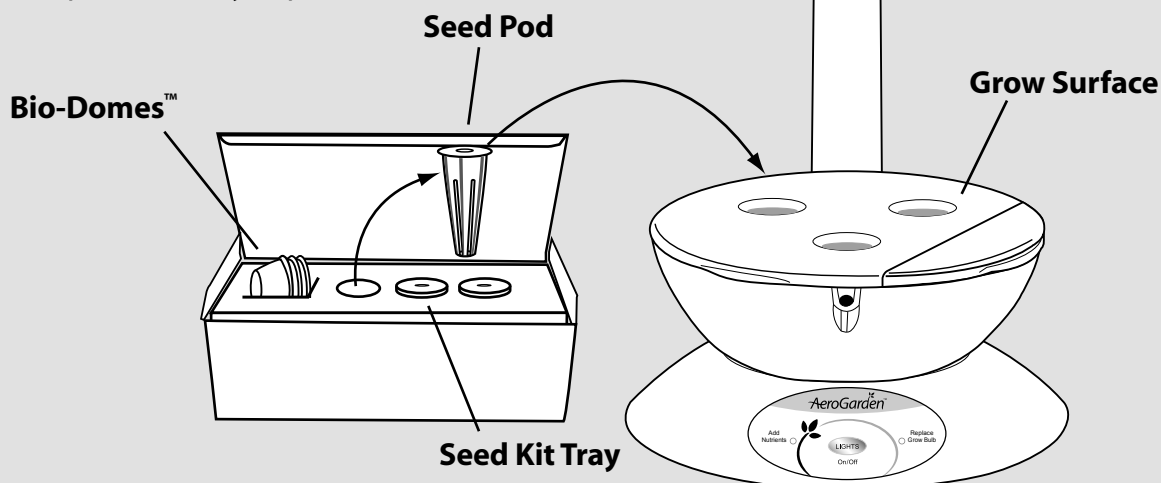

## C Place Bio-Domes on Seed Pods

- Place a *Bio-Dome* on each *Seed Pod*.
- Press *Bio-Dome* down until its rim almost touches *Grow Surface*.

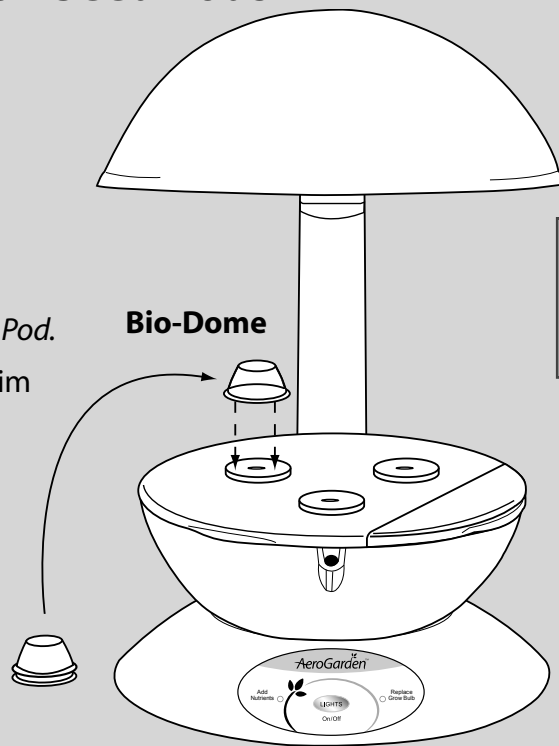

**Note: Do not remove Bio-Domes until seeds have sprouted. NEVER REMOVE SEED POD LABELS.**

## D Add Starting Nutrient Tablet and Record Planting Date

### Record Planting Date

Record the date you planted your AeroGarden Mini on the front cover of the Tending & Harvesting Guide.



**Add 1 tablet from the "Starting Nutrients" bag directly into the *Bowl*.**

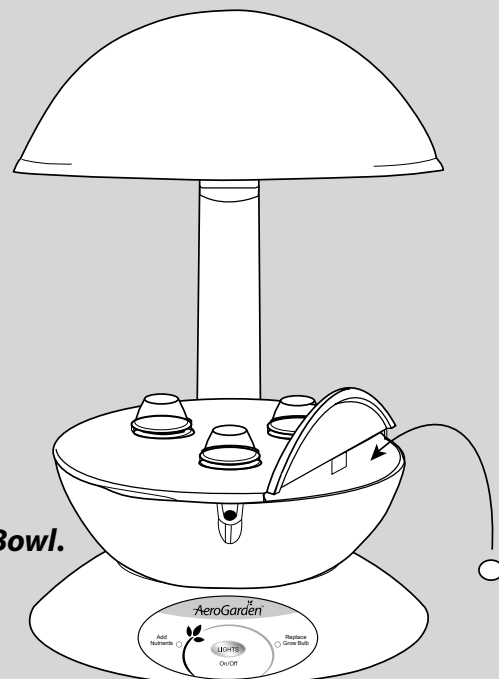

# 3 Starting Your Garden

## A Plug Cord in Wall Socket

### What will happen...

- 1** *Grow Bulb* will come on.  
*Look under Lamp Hood to check bulb is lit.*  
**If not**, check to see if:
  - *Grow Bulb* (light) is properly inserted into *Lamp Hood*. (See step 1C)
  - *Lamp Cord* is plugged into *Lamp Hood*. (See step 1D)
  - You are getting power through the electrical outlet.
- 2** Pump will turn on.  
*Lift the View Door.* You should see bubbles in the water as the pump cycles on and off.

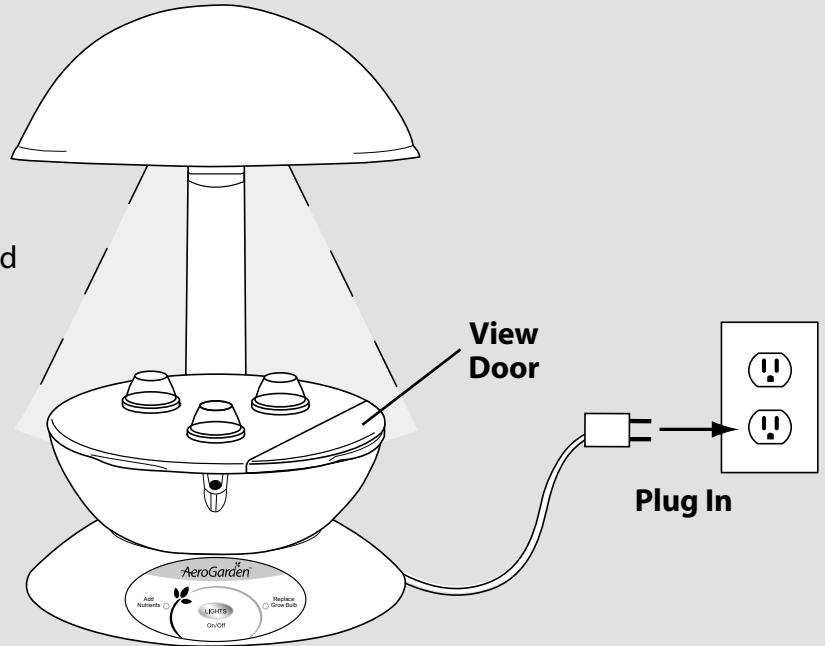

## B Your Light Timer

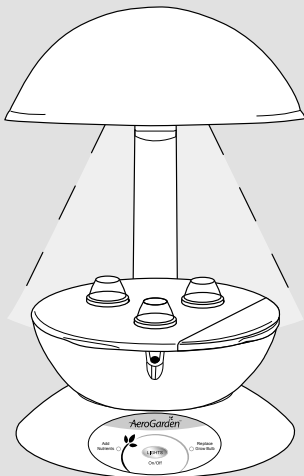

- Your lights will stay on for **17 hours** and will shut off for **7 hours**.
- Your lights will come on every day at the time you plugged in your AeroGarden Mini.

**1** Your Light Timer is Set To Start Growing Your Plants...  
*Starting Now!*

**2** If You Would Like to Change the Time of Day Your Lights Go On...

See Page 8.



# 4 Enjoy it!

## Personalize Your Light Timer (optional)

### Your Built-In Light Timer

Your AeroGarden Mini has a built-in timer that automatically provides your plants with the optimal amount of "sunlight" (17 hours) and "night" (7 hours).

As long as your plants get this amount of light, it does not matter when the light is turned off.\* Many people find it convenient to

have the light go on in the morning and off at night to match their own wake and sleep schedule.

***\*The exceptions to this are flowering and fruiting plants. They require a daily dark period in order to produce flowers. If your plants will receive any room light during the day (either natural or artificial) we recommend that you set your AeroGarden Mini lights to be on during the day.***

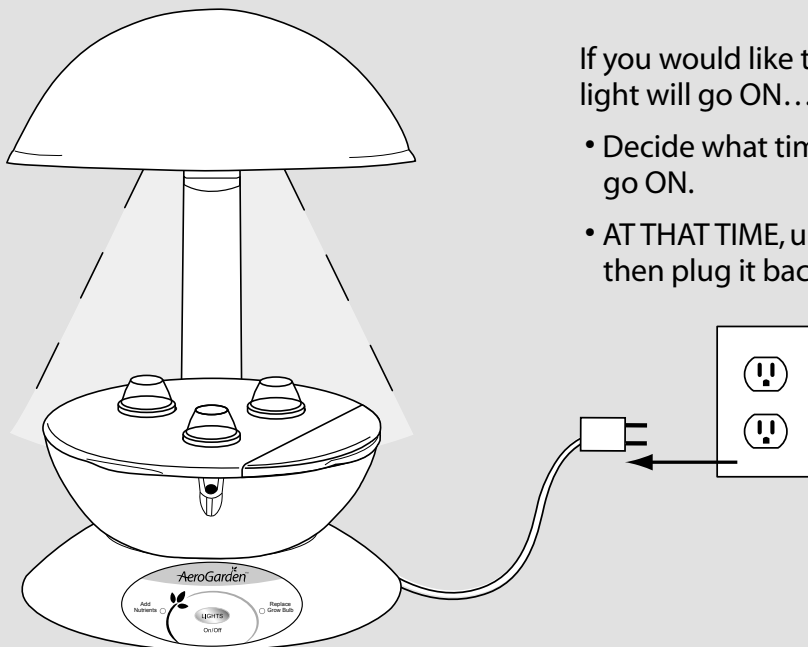

If you would like to change the time of day your light will go ON...

- Decide what time of day you want the light to go ON.
- AT THAT TIME, unplug your AeroGarden Mini, and then plug it back in.

### Now, each day, your AeroGarden Mini lights will automatically

- Turn on at the time you plugged in your AeroGarden Mini
- Remain on for 17 hours
- Turn off for 7 hours

**You can reset your timer as often as you want.**

***If the reflection from your AeroGarden Mini light is visible from your bedroom, you may want to set the light to go off about the time you usually go to bed, so as not to disturb your sleep.***

***In case of power failure, your AeroGarden Mini has a backup system that stores your nutrient and grow bulb timer settings. You will need to manually reset the Off-On cycle for your light (see above) to return to your previously selected light setting.***

# 5 Basic Reminders About Your AeroGarden

## The AeroGarden Mini Control Panel

See *Tending & Harvesting Guide* for "Kit-Specific" information

### LIGHTS ON/OFF

Use to *occasionally* override the built-in light timer. Once pushed, lights will stay off/on until the next time built-in light timer is set to go on/off. This will not affect the timing of your light cycle and *occasional use* of this feature will not harm your plants.

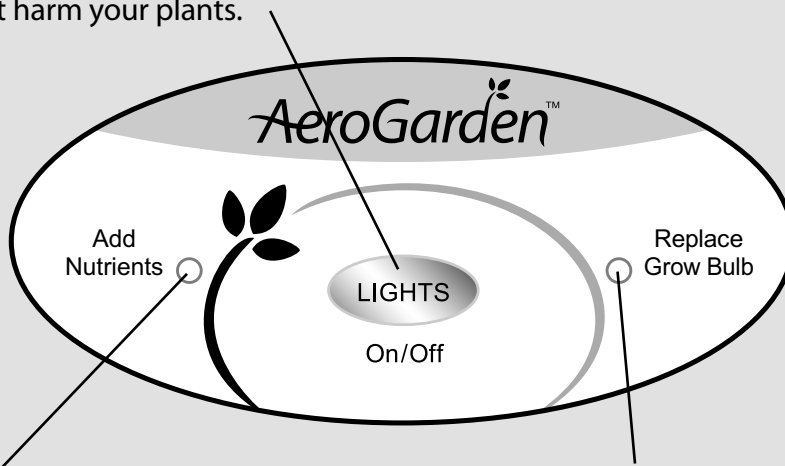

### ADD NUTRIENTS

When the "Add Nutrients" light is red (every 2 weeks):

- 1 Add 1 nutrient tablet and fill the *Bowl* with water up to "Fill To Here."
- 2 PRESS AND HOLD the "Lights" button until the "Add Nutrients" light begins flashing (about 3 seconds).
- 3 Release the "Lights" button, then IMMEDIATELY press and release the "Lights" button again to restart the timer.

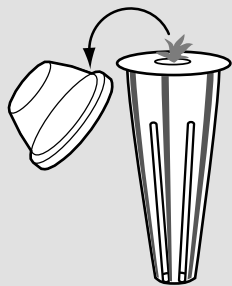

### REMOVE BIO-DOMES

When plants appear through the hole in the *Seed Pod Labels*, remove *Bio-Domes* and discard or recycle. Do not remove label.

### REPLACE GROW BULB

When the "Replace Grow Bulb" light is red (after 180 days of use):

- 1 It is time to replace your *Grow Bulb*. Replacement bulbs can be ordered from our website at: [www.aerogrow.com](http://www.aerogrow.com).
- 2 After replacing *Grow Bulb*, PRESS AND HOLD the "Lights" button until the "Replace Grow Bulb" light begins flashing (about 3 seconds).
- 3 Release the "Lights" button, then IMMEDIATELY press and release the "Lights" button again to restart the timer.

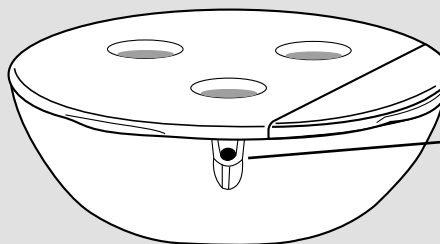

### WATER LEVEL LOW

When *Water Level indicator* is RED, add water to "Fill To Here."

## Raise Lamp Hood/Lamp Arm

As plants grow, raise the *Lamp Hood/Arm* one notch at a time, keeping the plants about **1" from the lights**. Be sure the *Arm* is set to the lowest position when you start your AeroGarden Mini.

- 1 Unplug the AeroGarden Mini.
- 2 Disconnect *Air Hose* from back of *Bowl*.
- 3 Remove *Bowl* from *Base*.
- 4 Raise *Lamp Arm/Lamp Hood*:
  - Hold *Lamp Arm*.
  - With other hand, support the *Lamp Hood* and use thumb to push in *Locking Button*.
  - Release *Locking Button* while pulling up on *Lamp Arm*.
  - *Locking Button* will automatically click into next notch.
- 5 Replace *Bowl* on *Base*.
- 6 Insert *Air Hose* from back of *Base* into *Bowl* (see step 1-G).
- 7 Plug in the AeroGarden Mini.

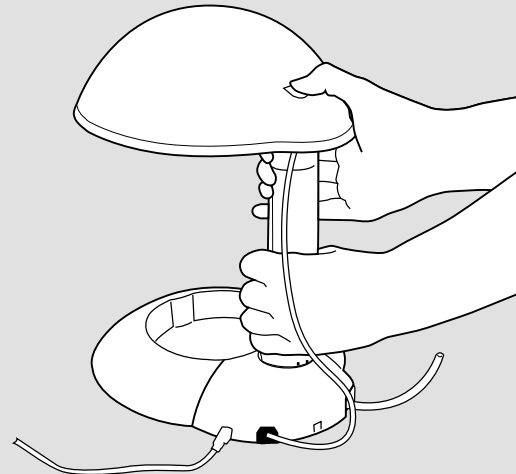
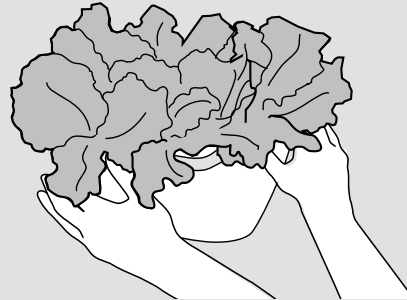

**Note:** When lowering Lamp Hood, be sure to hold Lamp Arm to avoid crushing plants.

**AeroGarden™ Mini**

© 2007 AeroGrow International, Inc.

300291 AA 9/4/07 Patents Pending

**NEED ADDITIONAL HELP?**

Call: 1-800-476-9669

Email: [customerservice@aerogrow.com](mailto:customerservice@aerogrow.com)

Visit Our Website: [www.aerogrow.com/help](http://www.aerogrow.com/help)