

1.200x965x473 mm

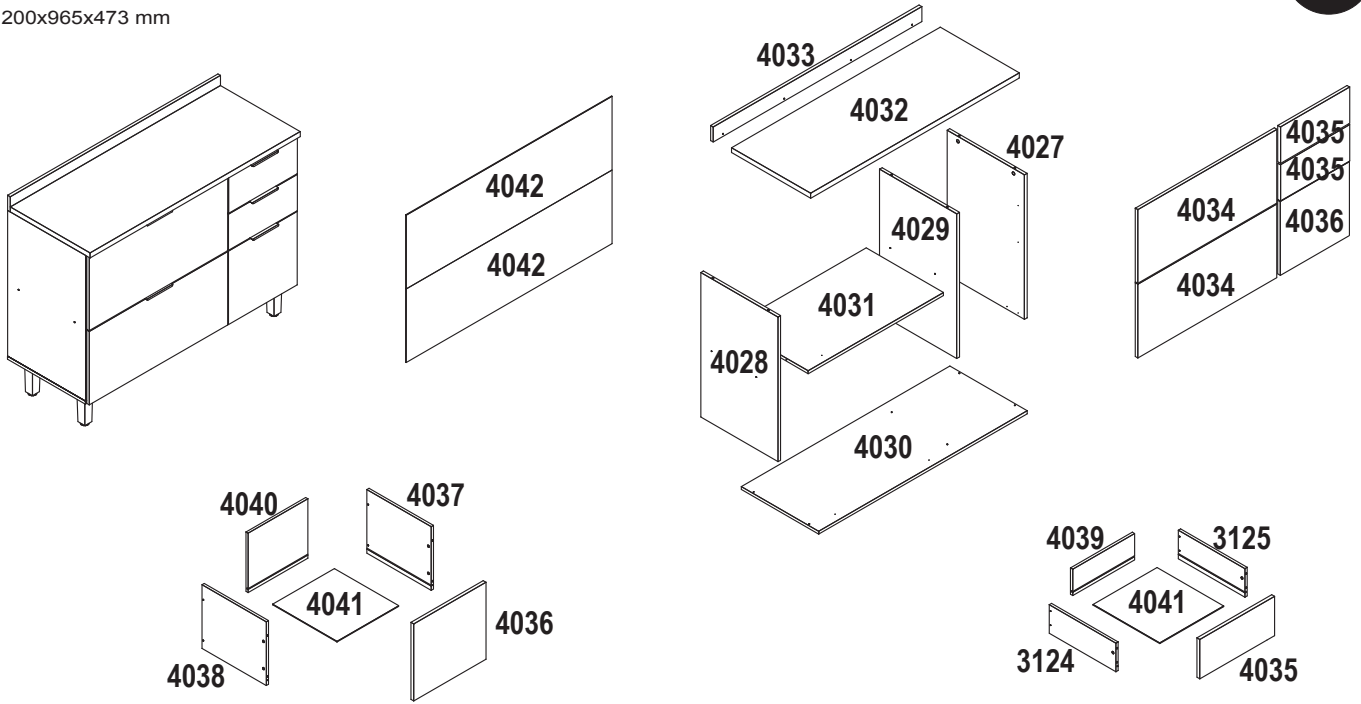

CÓDIGO	DESCRIÇÃO DAS PEÇAS	QTD.	DIMENSÃO = MM
3124	LATERAL ESQUERDA DE GAVETA	02	130X350X12
3125	LATERAL DIREITA DE GAVETA	02	130X350X12
4027	LATERAL DIREITA	01	445X720X15
4028	LATERAL ESQUERDA	01	445X720X15
4029	LATERAL INTERNA	01	445X720X15
4030	BASE INFERIOR	01	445X1.200X15
4031	BASE INTERMEDIÁRIA	01	445X779X15
4032	TAMPO	01	445X1.200X25
4033	MOLDURA TRASEIRA	01	75X1.200X25
4034	PORTA	02	363X790X15
4035	FRENTE DE GAVETA	02	179x393X15
4036	FRENTE MAIOR DE GAVETA	01	363X393X15
4037	LATERAL MAIOR DE GAVETA DIREITA	01	300X350X12
4038	LATERAL MAIOR DE GAVETA ESQUERDA	01	300X350X12
4039	CONTRA-FUNDO	02	120X325X12
4040	CONTRA-FUNDO MAIOR	01	280X325X12
4041	FUNDO DE GAVETA	03	350X336X3
4042	FUNDO TRASEIRO	02	370X1.194X3

accessories

acessorios

accessoires

acessórios

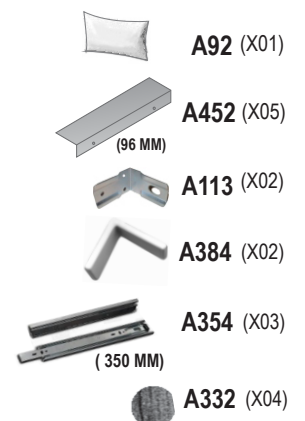
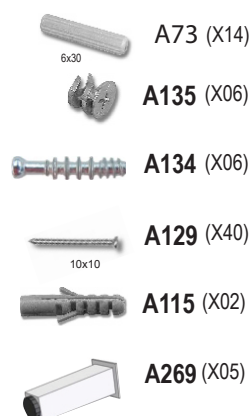
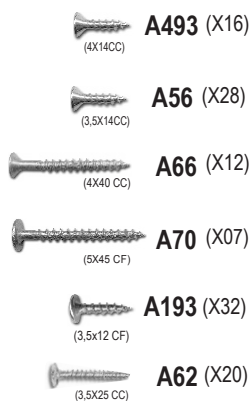

Para separar, presione a trava.  
 Para separar los rieles presione la traba de seguridad.  
 In order to detach the sliding, press the safety stopper device.  
 Pour separer appuyez sur le loquet.

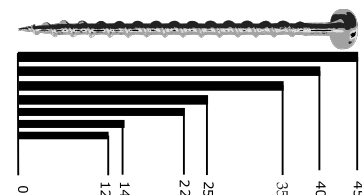
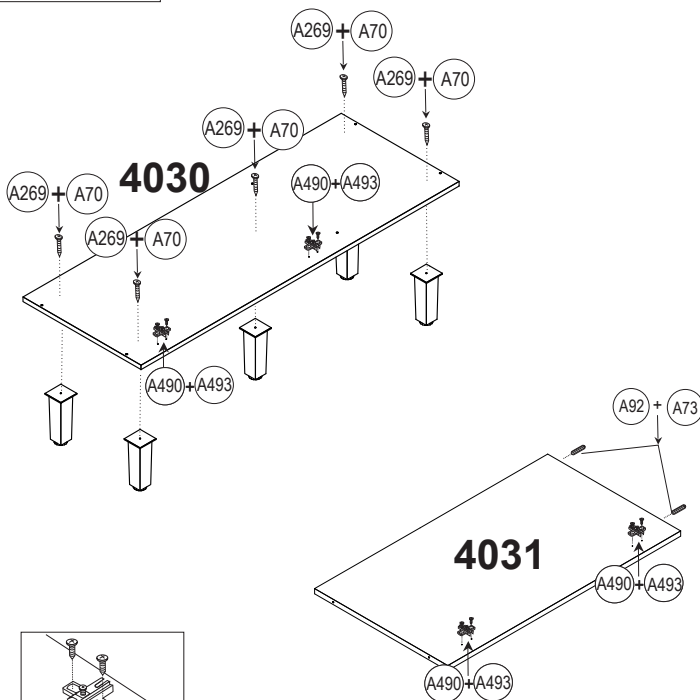
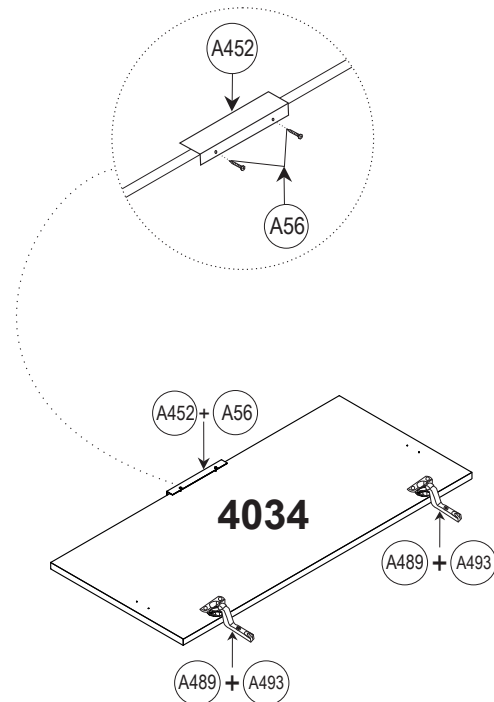
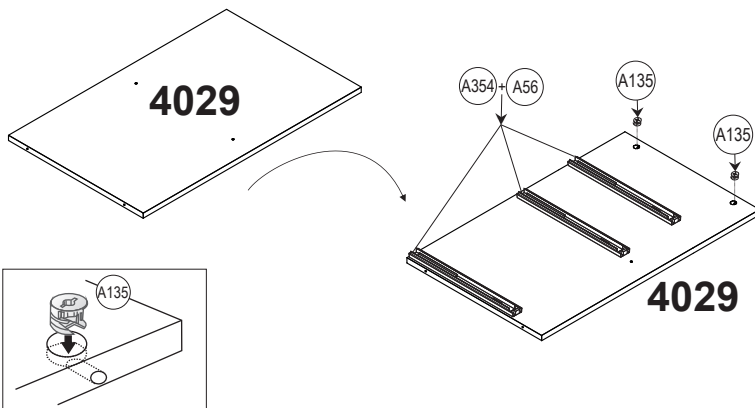
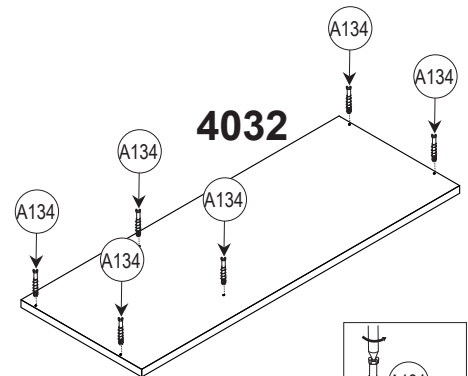
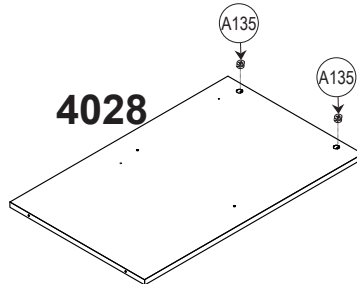
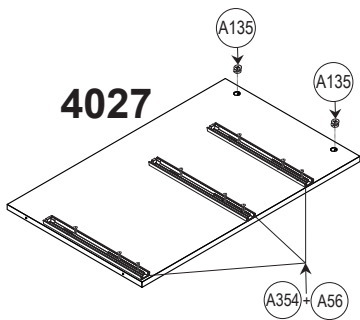
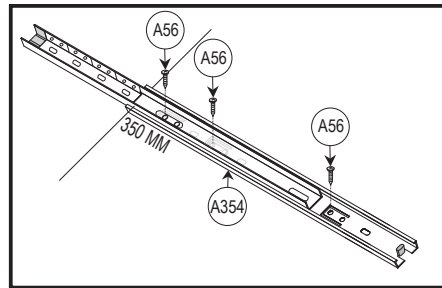
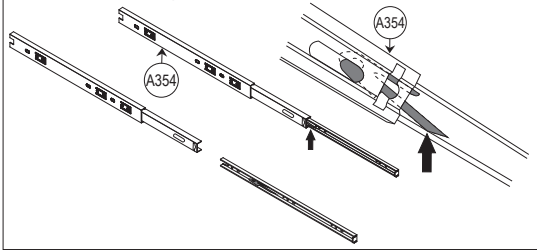

Scale (mm)  
 Balanza (mm)  
 Echelle (mm)  
 Escala (mm)

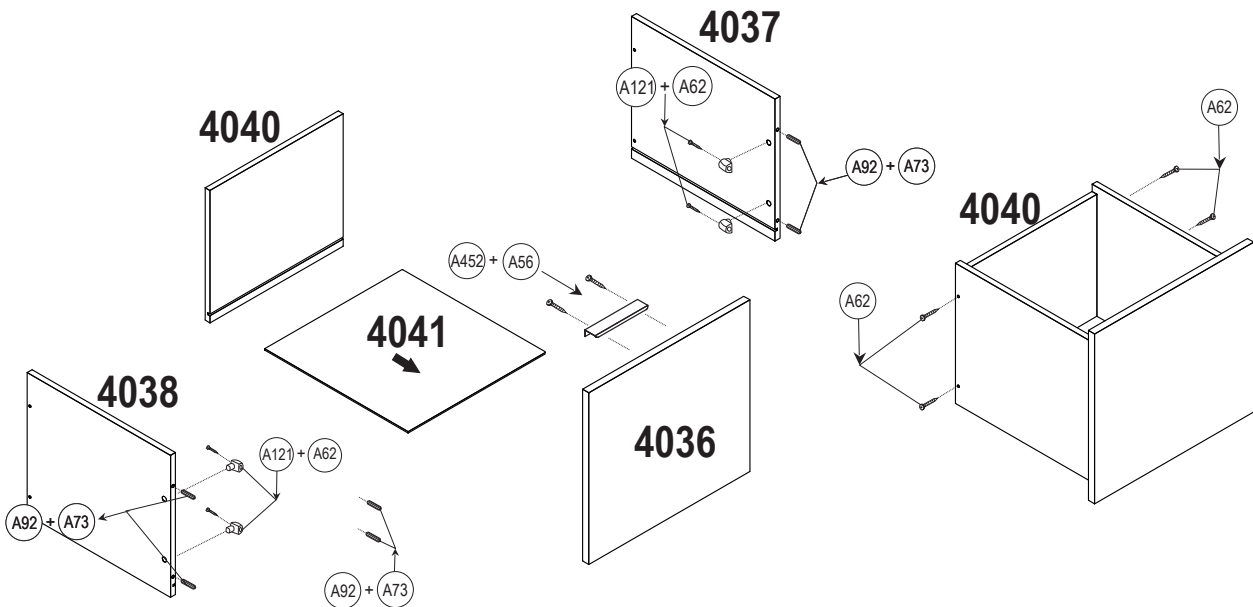
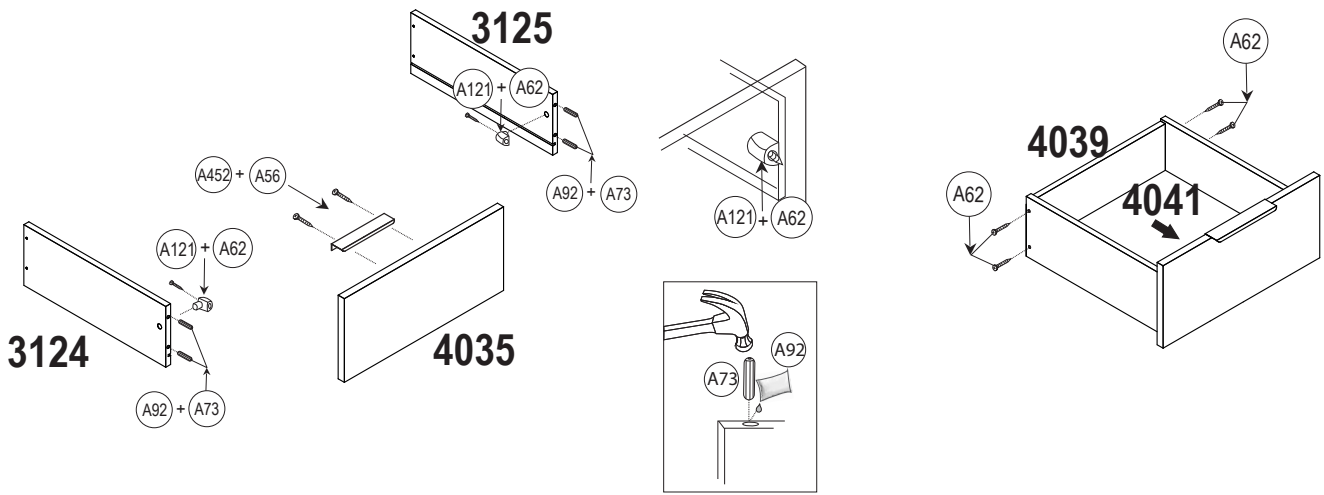

assembly instruction    manual de instrucciones    manuel des instructions    manual de instruções

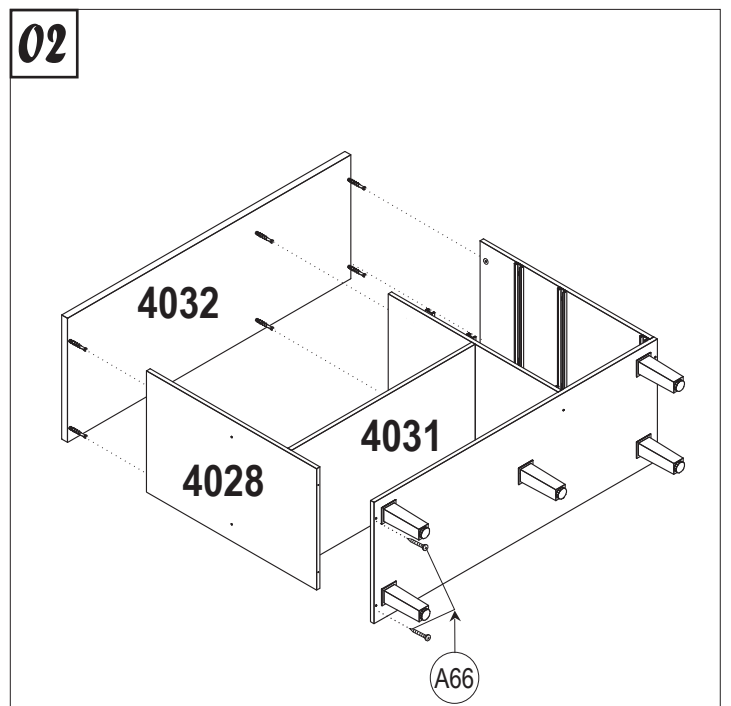
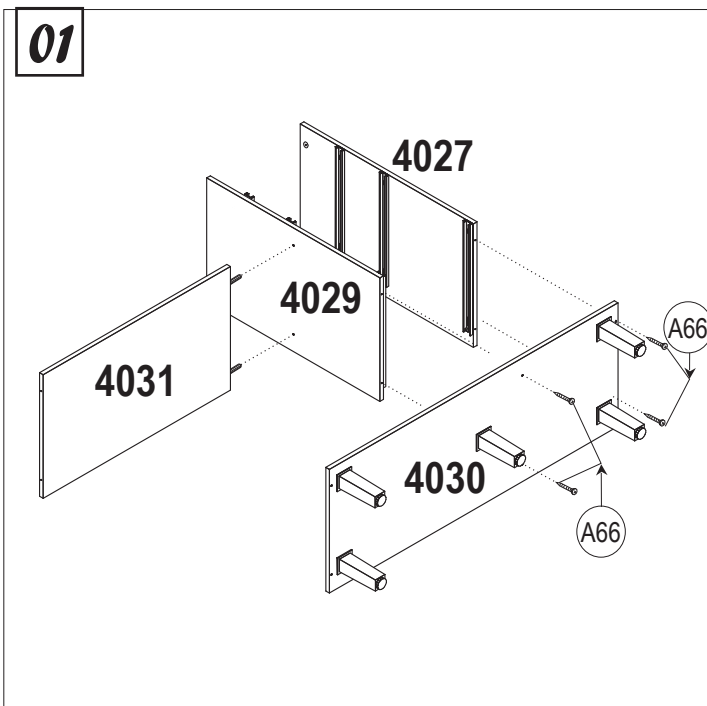

03

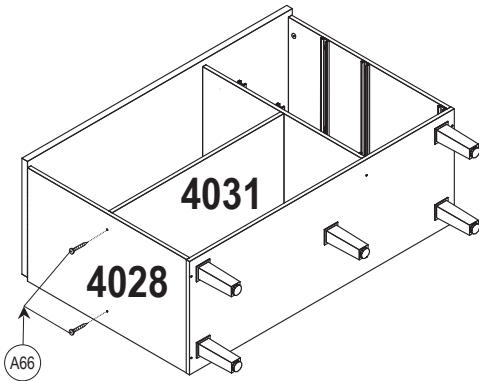

04

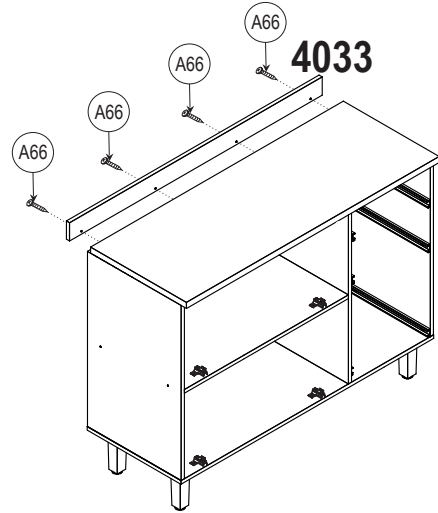

05

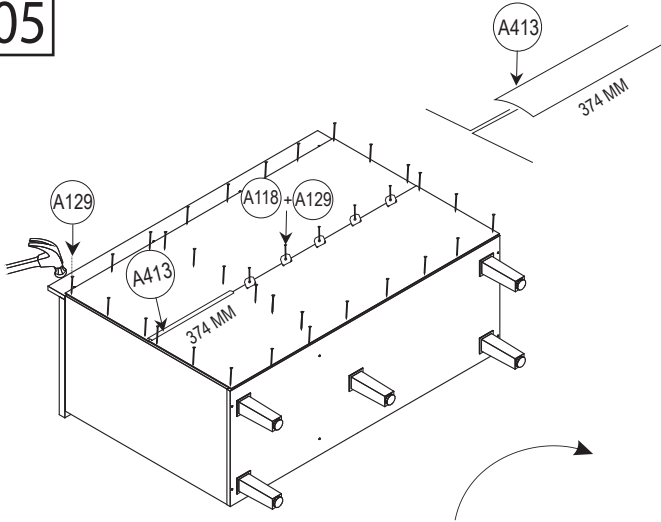

06

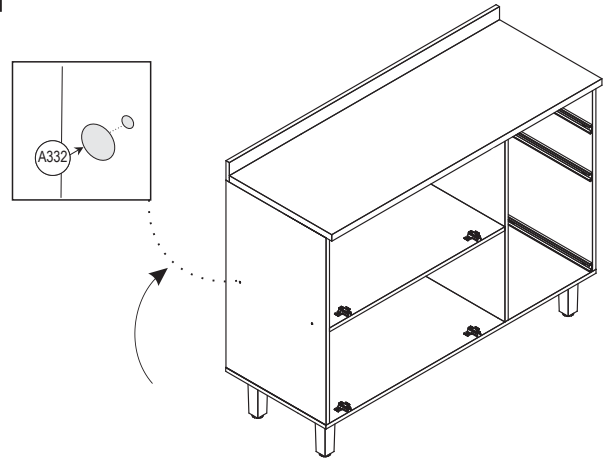

07

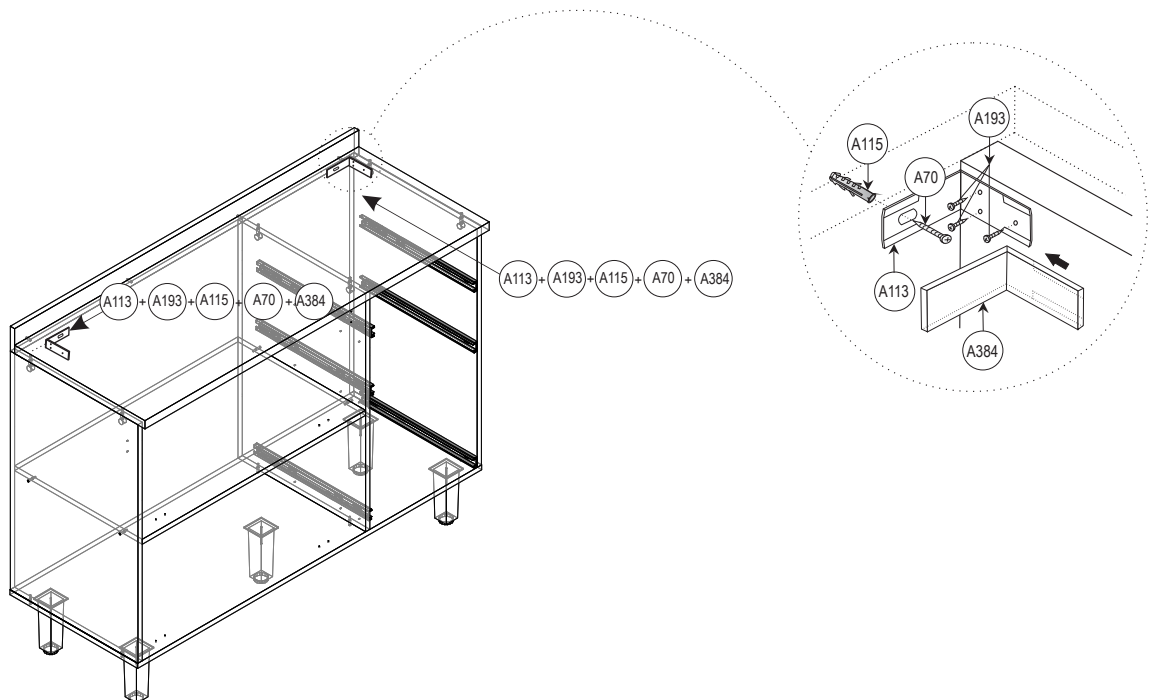

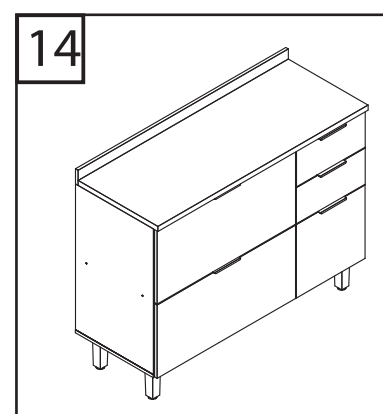
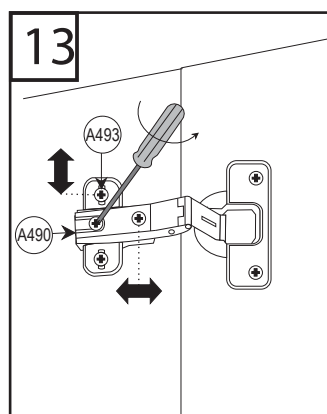
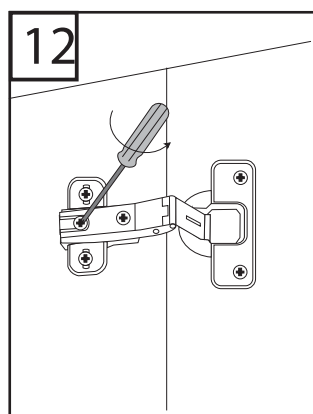
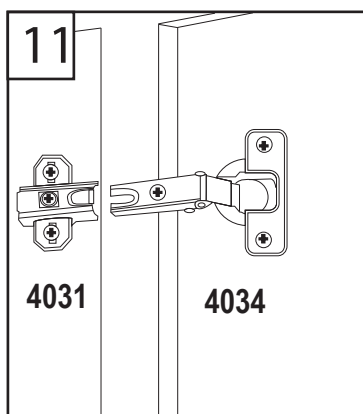
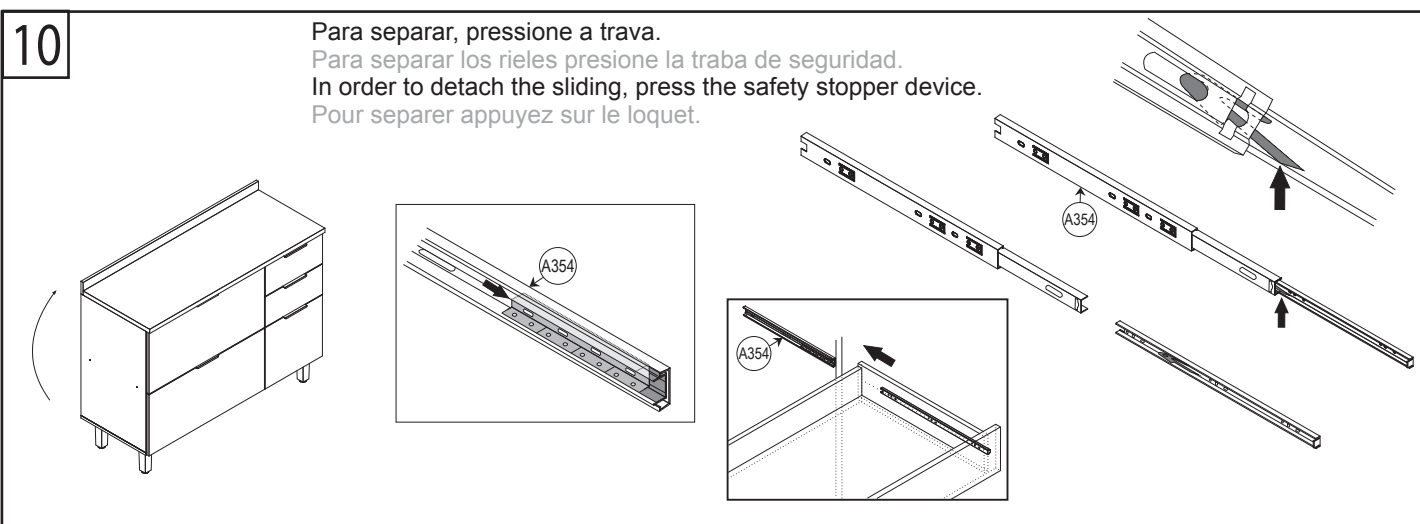
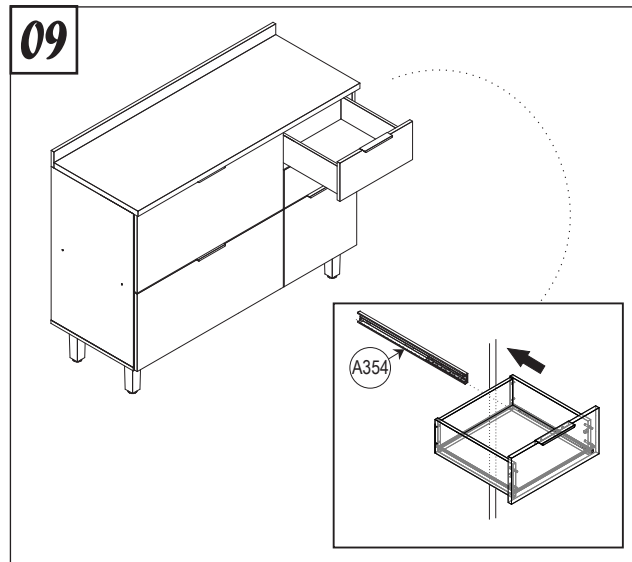
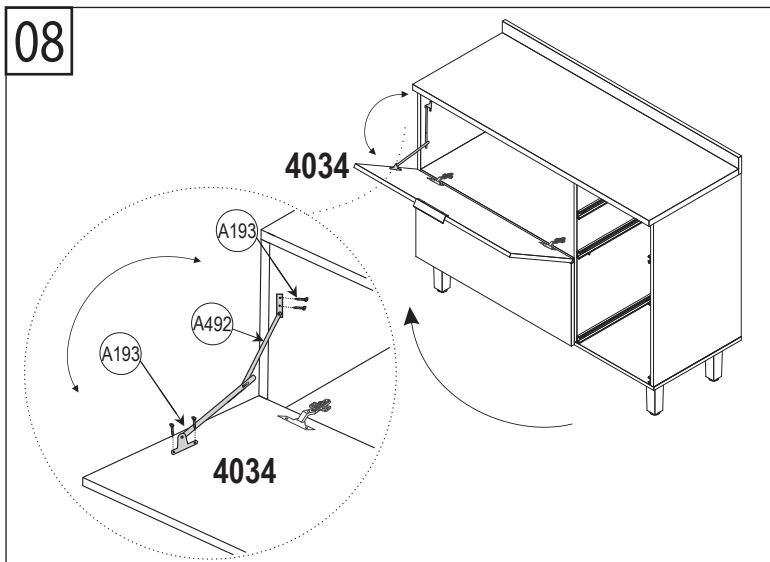

- In order to adjust correctly the door, please observe the picture. In order that the doors stay at the same level the adjustment should be done through the screw A493 from A490 accessory.
- Para ajustar correctamente la puerta, por favor observe la imagen. Para la permanencia de puertas en el mismo nivel el ajuste deberá ser hecho por el tornillo A493 del accesorio de A490.
- Pour ajuster correctement la porte, observez s'il vous plaît l'image. Afin que les portes soient au même niveau l'ajustement devrait être fait par la vis A493 de l'accessoire A490.
- Para o ajuste ideal das portas, observe a foto em destaque. Para que as portas fiquem no mesmo nível, o ajuste deverá ser feito através do parafuso A493 do acessório A490.

**peça    piece    pièce    pieza**

- Em caso de problemas técnicos com o móvel, favor informar o número de lote e data de fabricação, identificados nas bordas de alguns componentes dos móveis, para o rastreamento interno do produto e solução do problema.
- If technical problems happened, please find the lot number and manufacturing date, identified on borders of some furniture's pieces, to internal tracking and problem's solution.
- Dans le cas de problèmes technique avec le meuble, informer le numéro de lot et la date de fabrication, identifie dans le cadre de quelque composant des meubles, permettant à nous identifier le produit et le problème.
- En caso de problemas técnicos, por favor informe el N° del lote y la fecha de fabricación identificada en el borde de algunas de las partes del mueble para la identificación interna del producto y la solución del problema.

