

1.150X1.128X453 MM

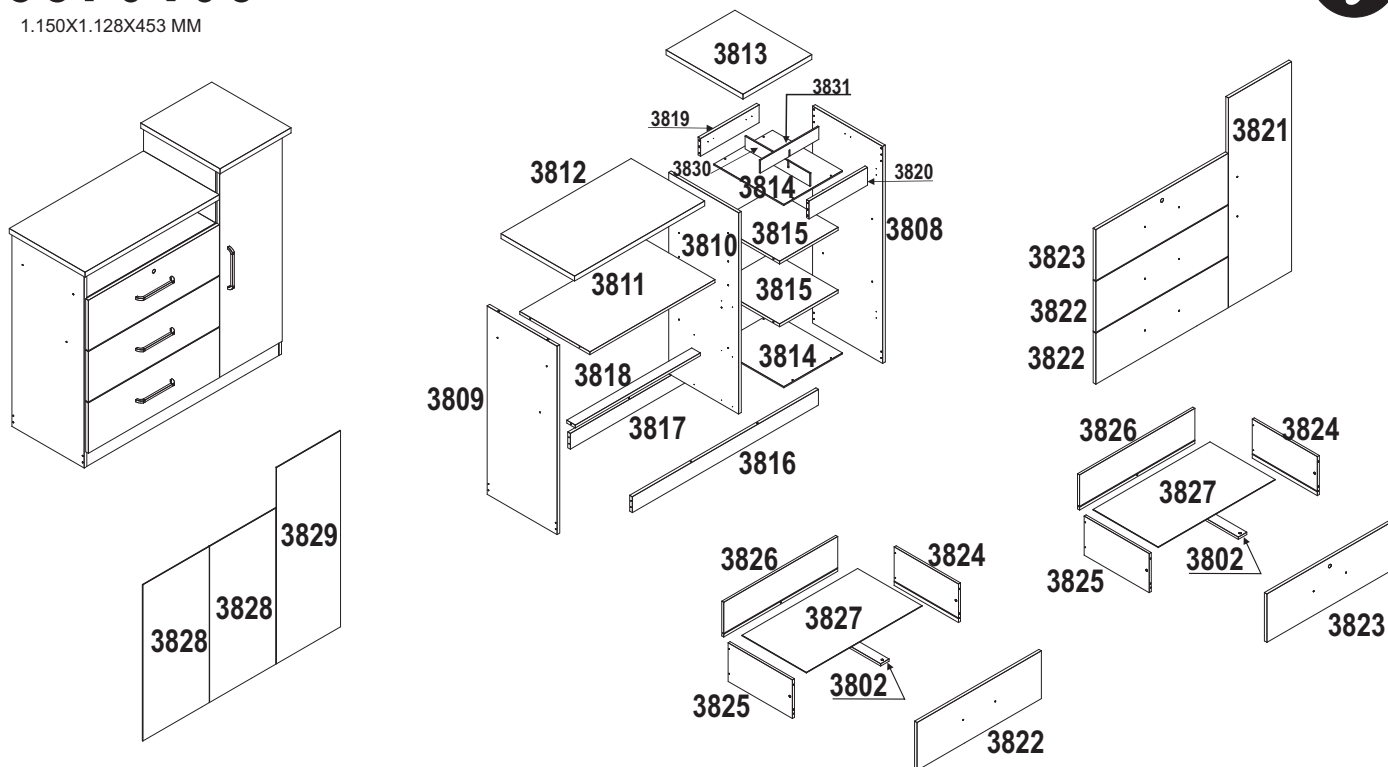

CÓDIGO	DESCRIÇÃO DAS PEÇAS	QTD.	DIMENSÃO = MM
3808	LATERAL DIREITA	01	410X1.100X15
3809	LATERAL ESQUERDA	01	410X955X15
3810	LATERAL INTERNA	01	410X1.020X15
3811	TAMPO DO DVD	01	410X732X15
3812	TAMPO	01	430X762X25
3813	TAMPO BASCULANTE	01	403X450X25
3814	BASE DA SAPATEIRA	02	343X410X6
3815	PRATELEIRA	02	343X385X15
3816	RODAPÉ	01	80X1.090X15
3817	RODAPÉ TRASEIRO	01	80X1.090X15
3818	TRAVAMENTO	01	50X732X15
3819	BATENTE TRASEIRO	01	90X343X15
3820	BATENTE FRONTAL	01	90X343X15

CÓDIGO	DESCRIÇÃO DAS PEÇAS	QTD.	DIMENSÃO = MM
3821	PORTA	01	352X1.020X15
3822	FRENTE DE GAVETA	02	248X744X15
3823	FRENTE DE GAVETA COM CHAVE	01	248X744X15
3824	LATERAL DIREITA DE GAVETA	03	200X385X12
3825	LATERAL ESQUERDA DE GAVETA	03	200X385X12
3826	CONTRA-FUNDO	03	180X682X12
3802	TRAVAMENTO DE GAVETA	03	50X373X12
3827	FUNDO DE GAVETA	03	385X692X3
3828	FUNDO TRASEIRO	02	373X760X3
3829	FUNDO DA SAPATEIRA	01	359X955X3
3830	DIVISÓRIA MAIOR DO PORTA JÓIA	01	65X379X6
3831	DIVISÓRIA MENOR DO PORTA JÓIA	01	65X343X6

accessories accesorios accessoires acessórios				
A54 (X45) (3,5X12 CC)	A129 (X50) 10x10	A134 (X06) (6X35 MM)	A335 (X04) (192 MM)	A114 (X12)
A62 (X29) (3,5X25 CC)	A368 (X02) 	A135 (X06) (15 MM)	A121 (X09) 	A94 (X06)
A63 (X08) (3,5X25 CF)	A369 (X02) 	A354 (X03) (350 MM)	A116 (X02) (3x12)	A118 (X06)
A67 (X24) (4X40 CF)	A370 (X02) 	A273 (X01) 	A238 (X01) 	A192 (X02)
A59 (X02) (4X16 CF)	A371 (X02) 	A187 (X02) 	A380 (X01) 	
A64 (X03) (4X35 CC)	A73 (X22) 	A458 (X01) (735 mm)	A381 (X02) 	
A374 (X16) (3,5X12 CP)	A92 (X01) 	A459 (X01) 	A382 (X01) 	

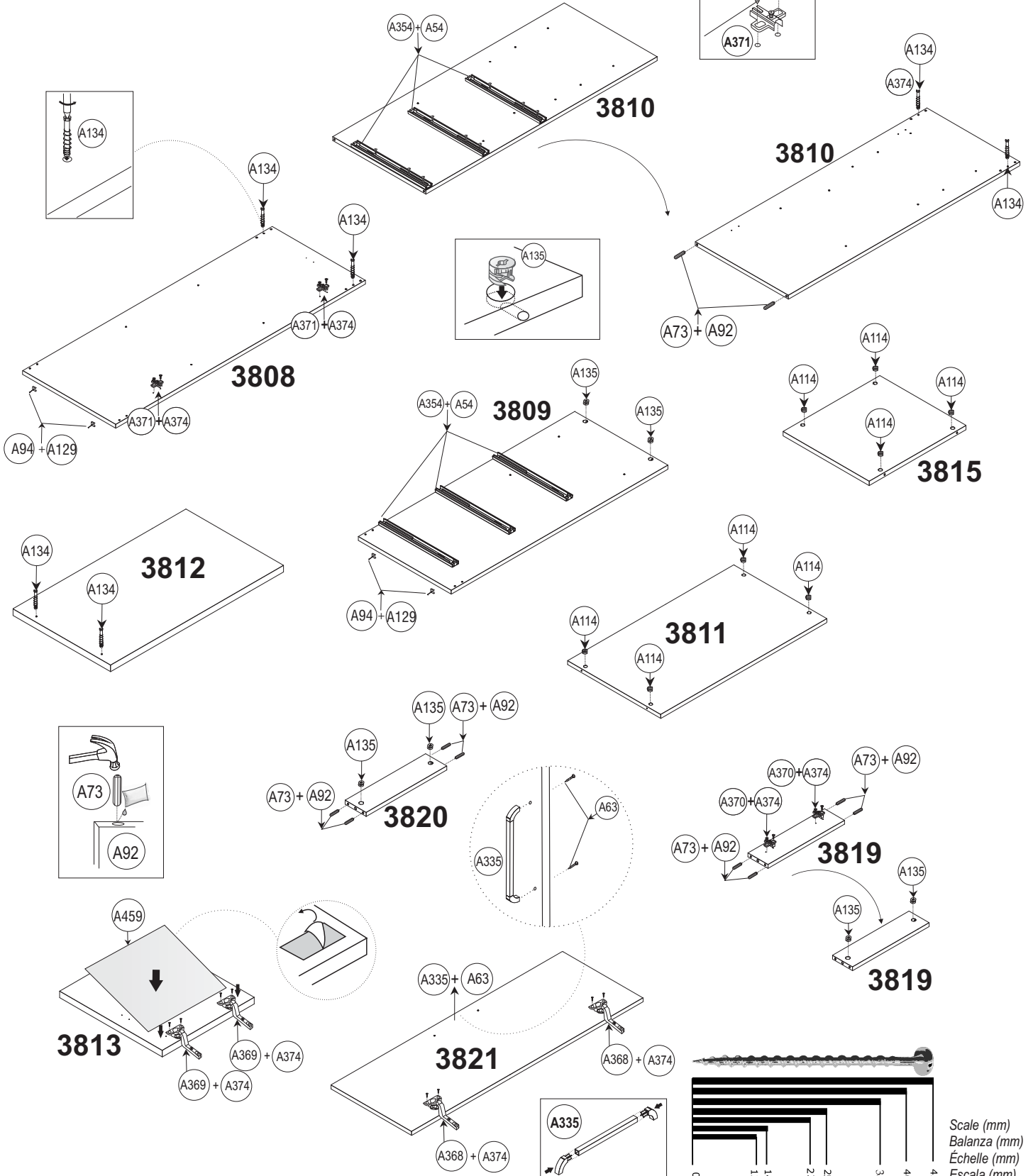
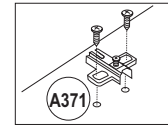
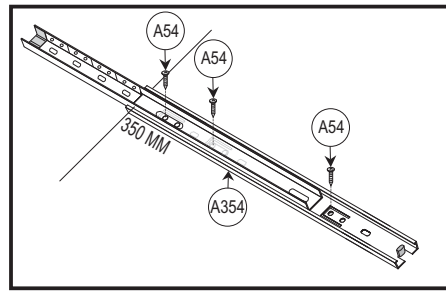
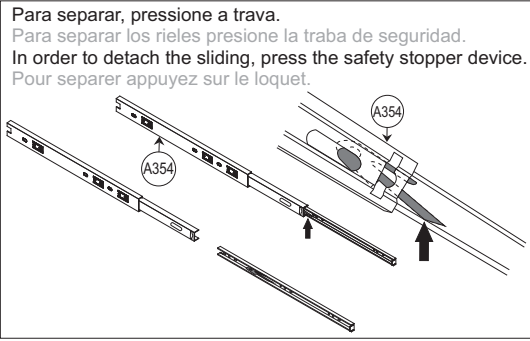

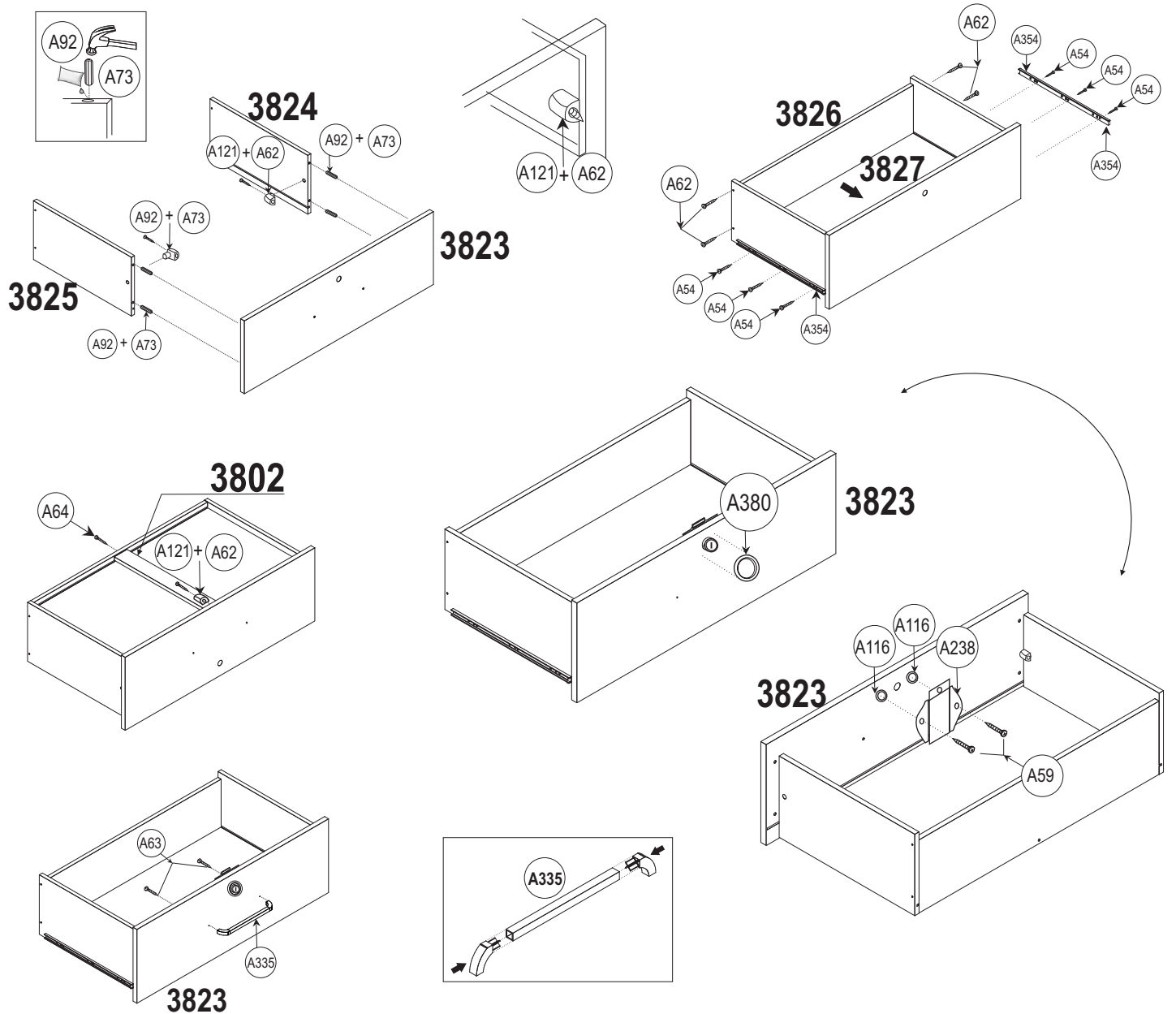
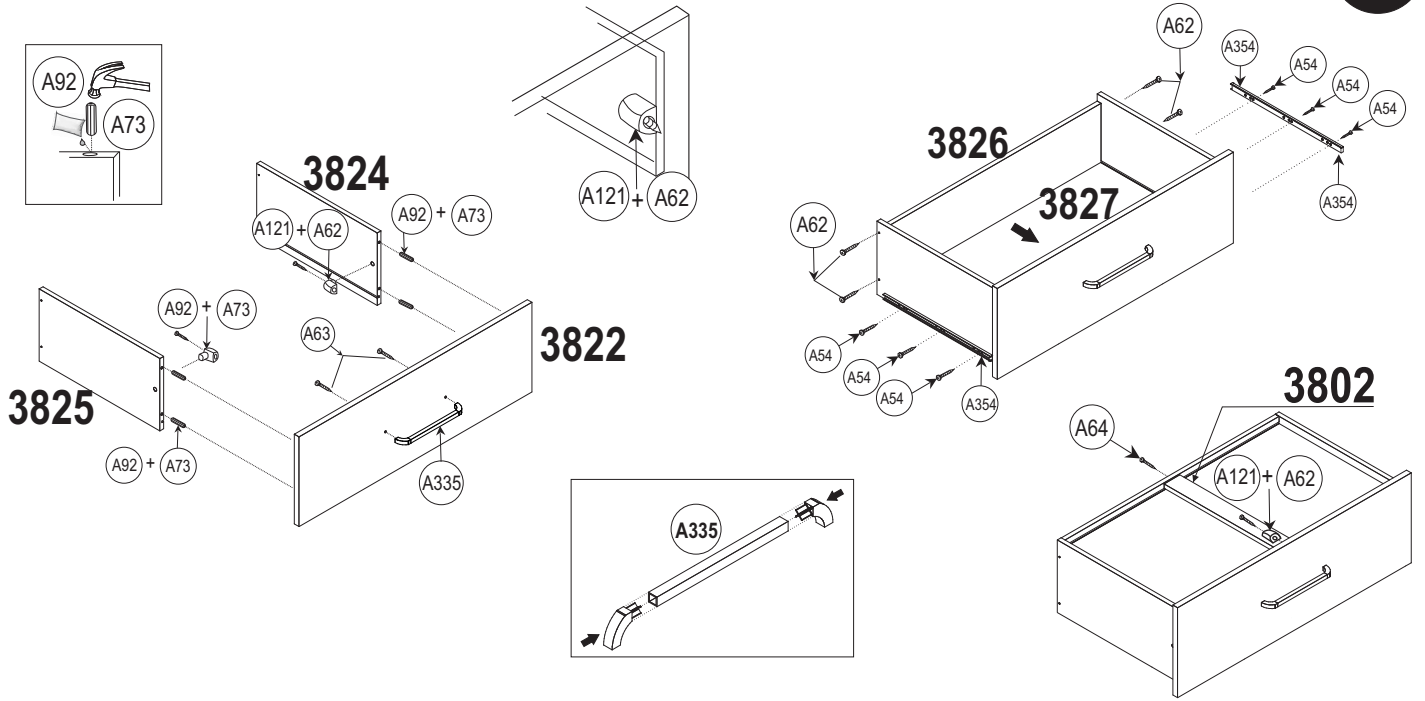

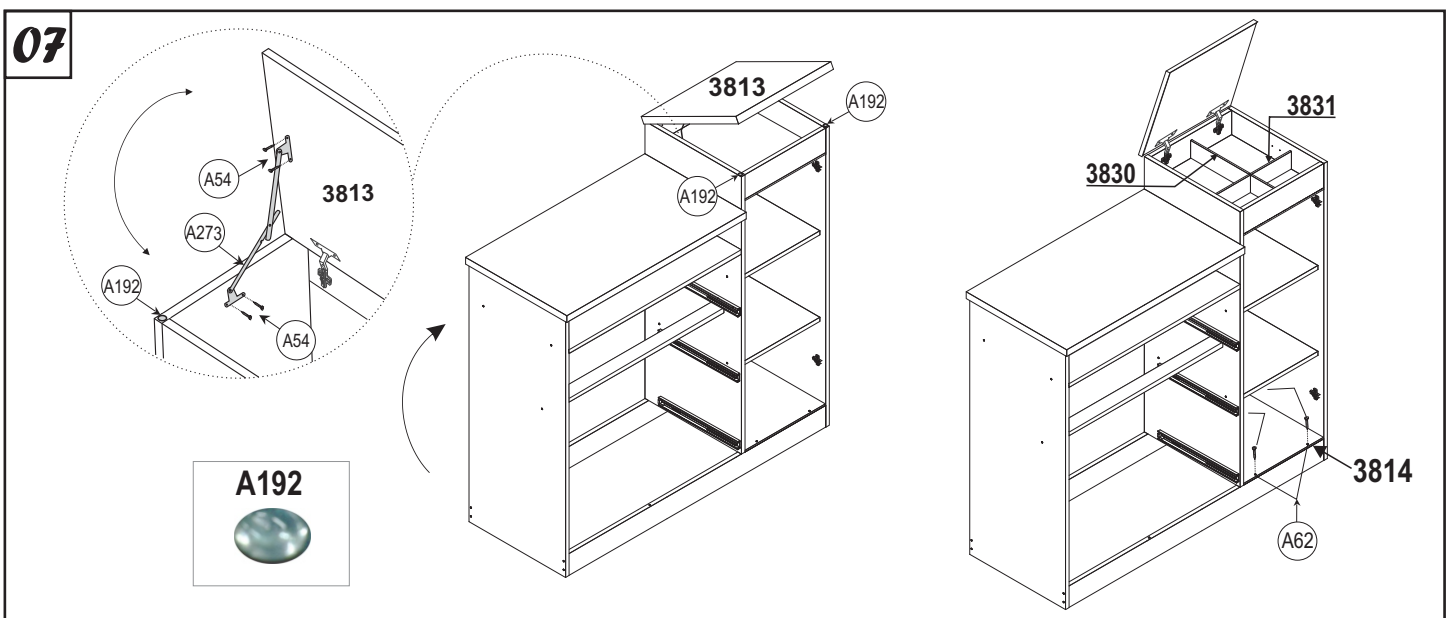
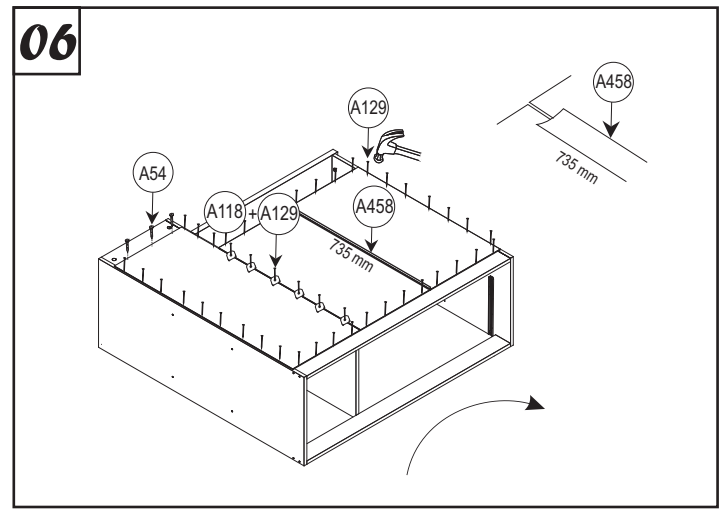
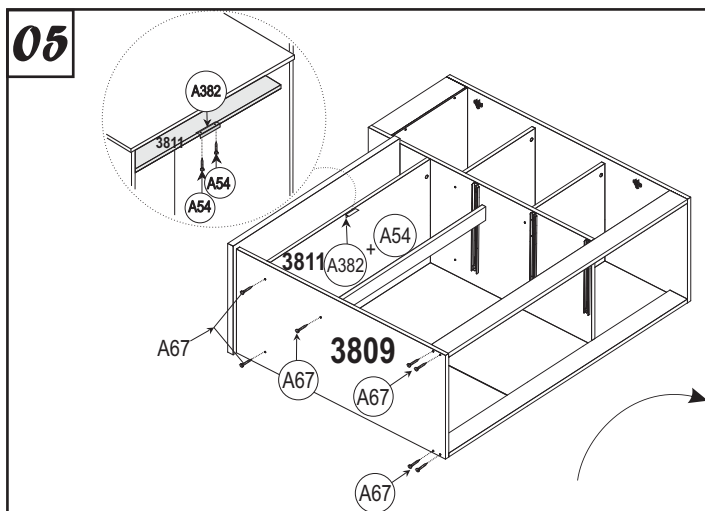
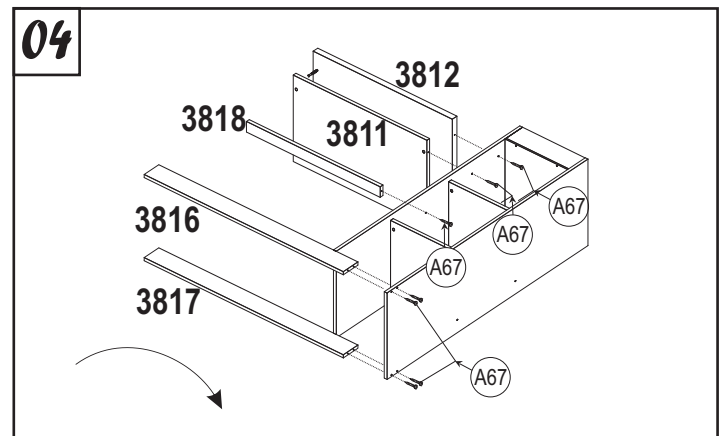
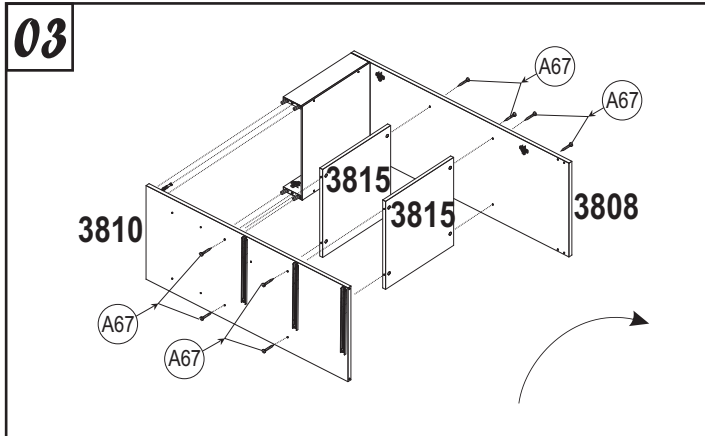
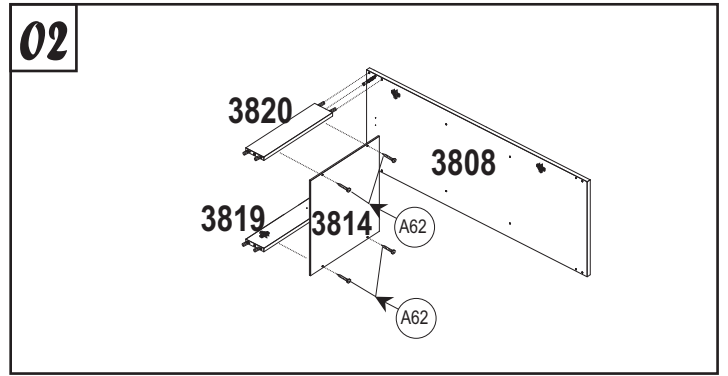
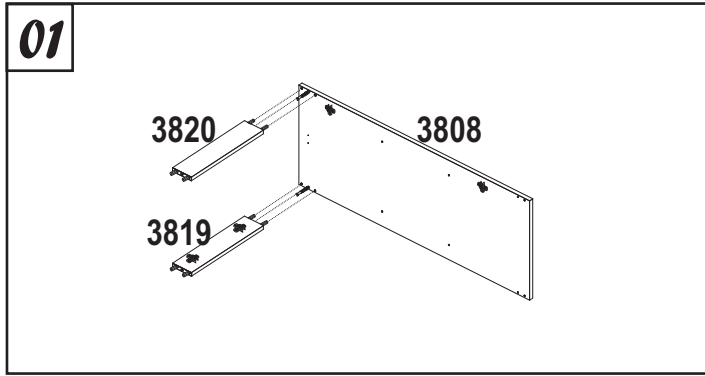

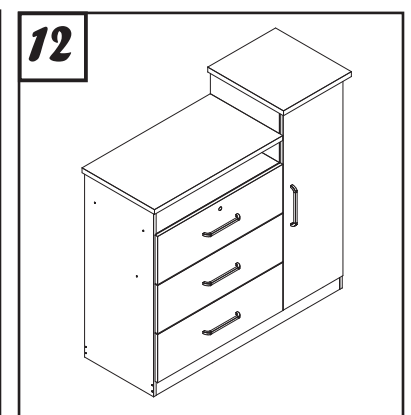
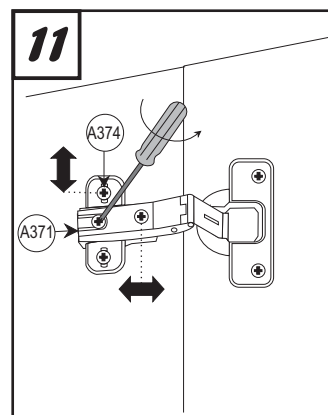
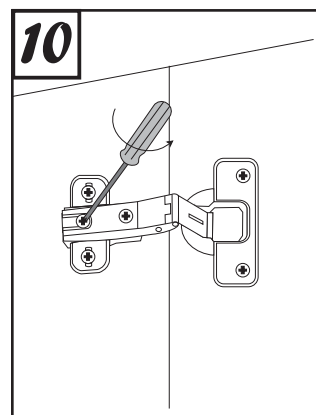
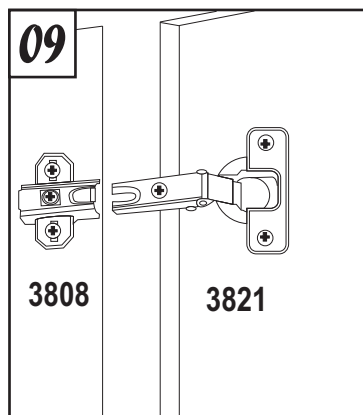
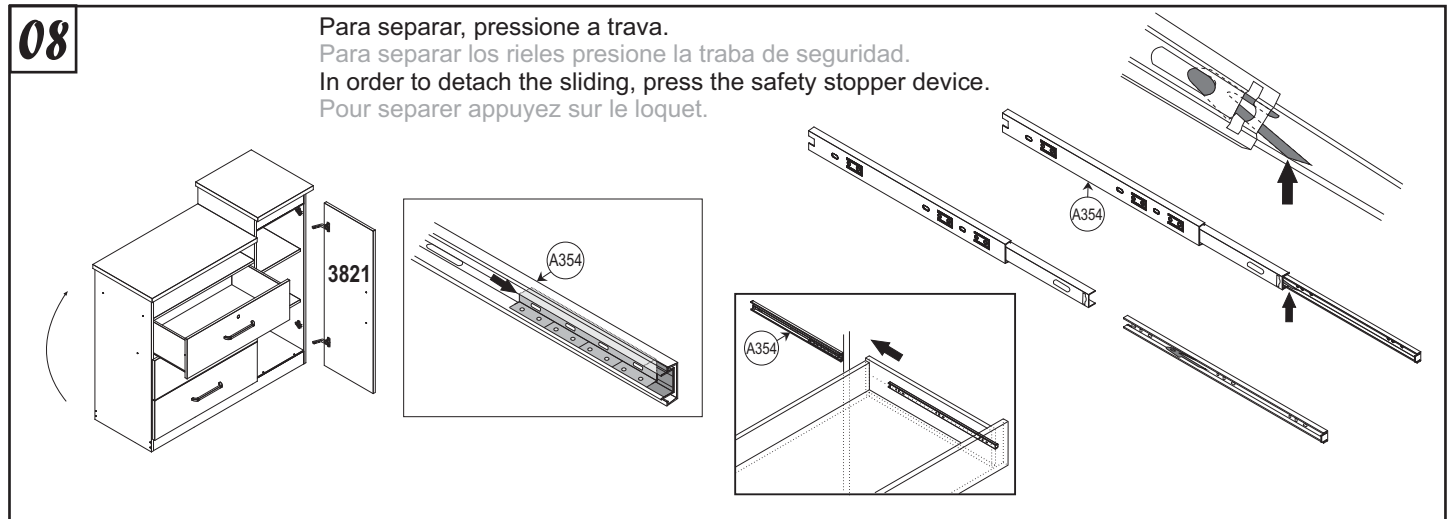

- In order to adjust correctly the door, please observe the picture. In order that the doors stay at the same level the adjustment should be done through the screw A374 from A371 accessory.
- Para ajustar correctamente la puerta, por favor observe la imagen. Para la permanencia de puertas en el mismo nivel el ajuste deberá ser hecho por el tornillo A374 del accesorio de A371.
- Pour ajuster correctement la porte, observez s'il vous plaît l'image. Afin que les portes soit au même niveau l'ajustement devrait être fait par la vis A374 de l'accessoire A371.
- Para o ajuste ideal das portas, observe a foto em destaque. Para que as portas fiquem no mesmo nível, o ajuste deverá ser feito através do parafuso A374 do acessório A371.

peça piece pièce pieza

* Em caso de problemas técnicos com o móvel, favor informar o número de lote e data de fabricação, identificados nas bordas de alguns componentes dos móveis, para o rastreamento interno do produto e solução do problema.

* If technical problems happened, please find the lot number and manufacturing date, identified on borders of some furniture's pieces, to internal tracking and problem's solution.

* Dans le cas de problèmes technique avec le meuble, informer le numéro de lot et la date de fabrication, identifie dans le cadre de quelque composant des meuble, permettant a nous identifier le produit et le problème.

* En caso de problemas técnicos, por favor informe el N° del lote y la fecha de fabricación identificada en el borde de algunas de las partes del mueble para la identificación interna del producto y la solución del problema.

