

# BRAUN

## Cordless Pocket Styler

### GCS 70



98826974/X-08

**Type 4560**

# Important Information

The following information is provided to allow you to enjoy safe and easy use of your Braun styler.

## Caution

- Please read the use instructions carefully before use.
- Do not use hair spray during styling.
- **When igniting the styler please ensure it is held away from the hair, face and clothing. Do not ignite the styler whilst it is in the hair.** Do not cover the brush end (heating rod) of your styler with your hand during the start-up procedure as there may be a gas accumulation and a short ignition flash.
- During use, care should be taken not to allow the hot tong to touch the skin.
- Contains flammable butane gas under pressure.
- Keep away from flames (burning cigarettes as well).
- Do not expose to temperatures of more than 50 °C (e.g. glove compartment of cars).
- Do not expose to direct sunlight for long periods of time.
- Keep out of the reach of children.
- Do not take apart puncture or incinerate.
- When hot, do not place on surfaces which are not heat-resistant.
- Do not allow the styler to become wet.
- Use only on hair that has been dried.
- Do not use on hair that is heavily bleached or damaged.
- Use Braun energy cells only.
- If the appliance is damaged, stop using it immediately. For repairs refer to authorised Braun Service Agents only.

## Air travel

When travelling by air, please note that no more than one device may be carried by each crew member or passenger aboard an aircraft. Ensure that the protective cover is secured over the heating element. Separate gas refills are not permitted. We suggest you check with your airline whether the appliance should be carried in hand luggage or checked-in luggage.

## Before using

Follow these instructions carefully to insert or change the Braun energy cell. Never insert or change it near an open fire or flame.

- 1 The switch must be set at the «0» (= off) position.

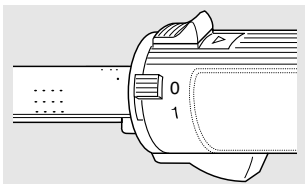

- 2 Remove the end cap by turning in the direction of the arrow.

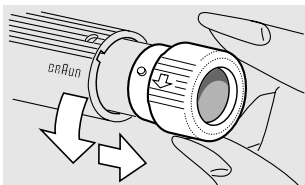

- 3 Insert the Braun energy cell into the styler handle. **Important:** The arrows on the energy cell indicate which way it should be inserted.

Push the cell firmly up into the styler handle. Replace the end cap and turn it in the opposite direction to the arrow, which should end in line with the dot.

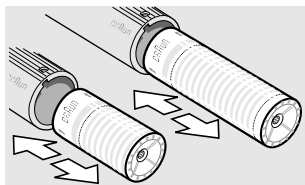

Use only Braun energy cells which are specially designed for your styler. They are available in two sizes (maxi = 25 ml and mini = 12.5 ml) from the store where your Braun gas styler was purchased, as well as from authorised Braun Service Agents. The energy cells can be changed at any time, even if they are only partly filled.

Important: For the maxi size energy cell, use the long end cap (b), use the short end cap (a) for the mini energy cell.

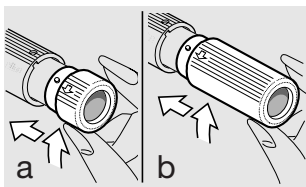

- 4 Before each use, look through the translucent end to check the gas level. Change the energy cell when empty (see instructions above).

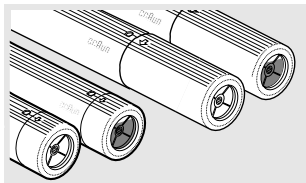

## How to use

- 5 Remove the protective cover and place on the handle to make the handle longer. Important: The protective cover cannot be used as a handle extension together with the long end cap, i.e. not with the maxi Braun energy cell.

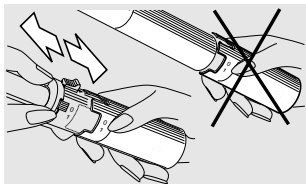

The cool tip is released when the protective cover is removed. The cool tip allows you to hold the appliance at either end when rolling-up a curl without burning yourself.

- 6 To use as a styling tong: remove the brush by pressing the tab and pulling the brush off. To put back on: slip the brush over the barrel and push the tab firmly into the slot, until it clicks into place.

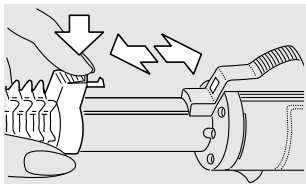

- 7** Turn on the gas flow by setting the switch to the «1» position. Wait for 5 seconds.

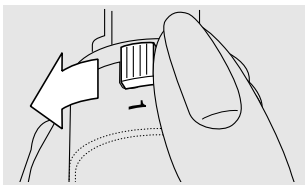

- 8** Pull the starter back until you hear an audible «click». The on/ready indicator will then light up, confirming that the heating system is on. The on/ready indicator consists of two illuminated dots on the tong.

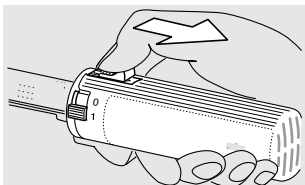

**Note:** Do not ignite the appliance in your hair and do not cover the brush end (heating barrel) of your styler with your hand during the start-up procedure or there may be a short ignition flash.

- 9** The styler heats up fast and after approximately 60 seconds the on/ready indicator will turn off. The product has now reached the optimal styling temperature and is ready for use.

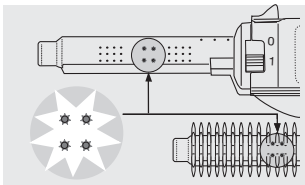

A thermostat maintains the optimal styling temperature – curl after curl. The «ready» sign may briefly flash during styling, whenever the appliance is heated up again to maintain the constant temperature.

In the unlikely case that the styler does not heat up, make sure the gas is on and push the starter again.

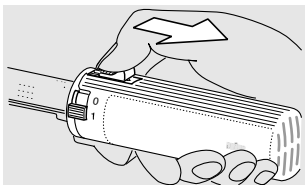

## When you have finished

- 10** Turn off the styler by moving the switch to the «0» position and push the handle of the styler out of the protective cover, as indicated.

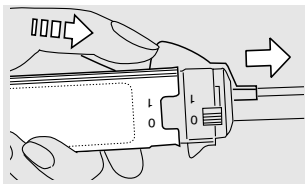

Turn the protective cover around and place it firmly over the styler. The protective cover is heat resistant – it is not necessary to wait for the styler to cool down first.

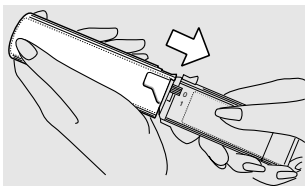

## Main points to remember

- After turning on the gas flow, wait for 5 seconds before activating the starter (see steps 7 and 8).
- Before each use, check the gas level (see step 4).
- Only use Braun energy cells.
- Use the right end cap for each size of Braun energy cell (see step 3).
- When the «ready» sign goes off, the appliance has the right temperature (see step 9).

## Cleaning

Make sure the appliance is switched off and cold.

If necessary, wipe the handle, protective cover and heating barrel with a soft damp cloth. Never immerse the styler in water.

Pull off the brush and scrub gently in warm, soapy water. When dry, snap the brush back firmly into place.

This product conforms to the EMC-Directive 2004/108/EC.



Subject to change without notice.

# Guarantee

We grant 2 years guarantee on the product commencing on the date of purchase. Within the guarantee period we will eliminate, free of charge, any defects in the appliance resulting from faults in materials or workmanship, either by repairing or replacing the complete appliance as we may choose.

This guarantee extends to every country where this appliance is supplied by Braun or its appointed distributor.

This guarantee does not cover: damage due to improper use, normal wear or use as well as defects that have a negligible effect on the value or operation of the appliance. The guarantee becomes void if repairs are undertaken by unauthorised persons and if original Braun parts are not used.

To obtain service within the guarantee period, hand in or send the complete appliance with your sales receipt to an authorised Braun Customer Service Centre.

## **For UK only:**

This guarantee in no way affects your rights under statutory law.



### **Helpline**

Should you require any further assistance please call Braun (UK) Consumer Relations on **0800 783 70 10**



### **Helpline**

**1 800 509 448**