

# HELLOMOTO

Introducing your new **MOTOSLVR™** L9 GSM wireless phone. Here's a quick anatomy lesson.

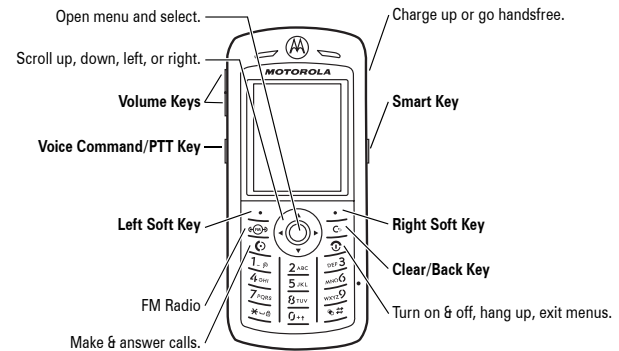



To change your **Keypad Lock** setting, see page 66.

For Push to Talk (PTT) details, see page 28.

1

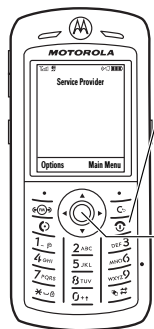
Home Screen





1 Press and hold the **Power Key**  for a few seconds or until the display lights up to turn on your phone.

2 Press the **Centre Key**  to open the **Main Menu**.

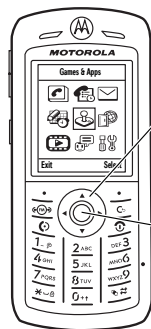
Main Menu

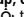

3 Press the **Navigation Key**  **up, down, left, or right**  to highlight a menu feature.

4 Press the **Centre Key**  to select it.

2

[www.hellomoto.com](http://www.hellomoto.com)

Certain mobile phone features are dependent on the capabilities and settings of your service provider's network. Additionally, certain features may not be activated by your service provider, and/or the provider's network settings may limit the feature's functionality. Always contact your service provider about feature availability and functionality. All features, functionality, and other product specifications, as well as the information contained in this user's guide are based upon the latest available information and are believed to be accurate at the time of printing. Motorola reserves the right to change or modify any information or specifications without notice or obligation.

MOTOROLA and the Stylised M Logo are registered in the US Patent & Trademark Office. All other product or service names are the property of their respective owners. The Bluetooth trademarks are owned by their proprietor and used by Motorola, Inc. under licence. Java and all other Java-based marks

are trademarks or registered trademarks of Sun Microsystems, Inc. in the U.S. and other countries. Microsoft, Windows and Windows Me are registered trademarks of Microsoft Corporation; and Windows XP is a trademark of Microsoft Corporation.

© Motorola, Inc., 2006.

**Caution:** Changes or modifications made in the radio phone, not expressly approved by Motorola, will void the user's authority to operate the equipment.

### Software Copyright Notice

The Motorola products described in this manual may include copyrighted Motorola and third-party software stored in semiconductor memories or other media. Laws in the United States and other countries preserve for Motorola and third-party software providers certain exclusive rights for copyrighted software, such as the exclusive rights to distribute or reproduce the copyrighted software. Accordingly, any copyrighted software contained in the Motorola products may not be modified,

3

reverse-engineered, distributed, or reproduced in any manner to the extent allowed by law. Furthermore, the purchase of the Motorola products shall not be deemed to grant either directly or by implication, estoppel, or otherwise, any licence under the copyrights, patents, or patent applications of Motorola or any third-party software provider, except for the normal, non-exclusive, royalty-free licence to use that arises by operation of law in the sale of a product.

While Products specifications and features may be subject to change without notice, we are making every possible effort to ensure that user manuals are updated on a regular basis to reflect product functionality revisions. However, in the unlikely event that your manual version does not fully reflect the core functionality of your product, please let us know. You may also be able to access up-to-date versions of our manuals in the consumer section of our Motorola web site, at <http://www.motorola.com>.

# contents

---

<b>basics</b> . . . . .	<b>53</b>	<b>calls</b> . . . . .	<b>71</b>	<b>SAR Data</b> . . . . .	<b>101</b>
display . . . . .	53	turn off a call alert . . . . .	71	<b>WHO Information</b> . . . . .	<b>103</b>
text entry . . . . .	56	delay answering . . . . .	71	<b>index</b> . . . . .	<b>104</b>
volume . . . . .	60	recent calls . . . . .	71		
navigation key . . . . .	61	redial . . . . .	73		
smart key . . . . .	61	return a call . . . . .	73		
voice commands . . . . .	61	caller ID . . . . .	74		
handsfree speaker . . . . .	64	emergency calls . . . . .	74		
codes & passwords . . . . .	65	voicemail . . . . .	74		
lock & unlock phone . . . . .	65	<b>other features</b> . . . . .	<b>76</b>		
lock & unlock keypad . . . . .	66	advanced calling . . . . .	76		
<b>customise</b> . . . . .	<b>67</b>	contacts . . . . .	79		
aeroplane mode . . . . .	67	messages . . . . .	84		
ring style . . . . .	67	instant messaging . . . . .	87		
time & date . . . . .	68	personalising . . . . .	88		
wallpaper . . . . .	69	call times & costs . . . . .	90		
screen saver . . . . .	69	handsfree . . . . .	91		
display appearance . . . . .	70	data calls . . . . .	92		
answer options . . . . .	70	network . . . . .	93		
		personal organiser . . . . .	94		
		security . . . . .	96		
		fun & games . . . . .	97		

<b>menu map</b> . . . . .	<b>7</b>	<b>essentials</b> . . . . .	<b>21</b>	<b>main attractions</b> . . . . .	<b>28</b>
<b>safety information</b> . . . . .	<b>9</b>	about this guide . . . . .	21	push to talk (PTT) . . . . .	28
<b>FCC Notice</b> . . . . .	<b>16</b>	SIM card . . . . .	21	Bluetooth™ wireless . . . . .	33
<b>use and care</b> . . . . .	<b>18</b>	battery . . . . .	22	digital audio player . . . . .	37
<b>EU Conformance</b> . . . . .	<b>19</b>	turn it on & off . . . . .	24	stereo FM radio . . . . .	39
<b>recycling information</b> . . . . .	<b>20</b>	make a call . . . . .	25	photos . . . . .	41
		answer a call . . . . .	25	videos . . . . .	44
		store a phone		text messages . . . . .	46
		number . . . . .	25	memory card . . . . .	48
		call a stored phone		talking phone . . . . .	49
		number . . . . .	26	cable connections . . . . .	50
		your phone number . . . . .	26	phone updates . . . . .	52
		Motorola SETUP . . . . .	27		

# menu map

## main menu

- ✉ **Messages**
  - New Message
  - Message Inbox
  - Voicemail
  - Outbox
  - Drafts
  - Email Msgs
  - Info Services \*
  - Browser Msgs
  - Templates
- ☎ **Recent Calls**
  - (press the **[\*]** or **[#]** to scroll through the call lists)
- 📁 **Contacts**
- 📺 **Multimedia**
  - Radio
  - Voice Record
  - Camera
  - Video Camera
  - Pictures
  - Sounds
  - Videos
- 🎮 **Games & Apps**
- 🌐 **WebAccess \***
  - Browser
  - Bookmarks
  - Google \*
  - Stored Pages
  - History
  - Go to Page
  - Browser Setup
  - Web Sessions \*
- 🔧 **Tools**
  - IM \*
  - SIM Applications \*
  - Calculator
  - Datebook
  - Alarm Clock
  - Dialling services
    - Fixed Dial \*
    - Voice Dial
    - Service Dial \*
    - Quick Dial
  - Activation List \*
  - World Clock
- 📶 **Connection**
  - Bluetooth Link
  - USB Settings
  - MOTOSYNC \*
- ⚙️ **Settings**
  - (see next page)

\* optional features

This is the standard main menu layout. **Your phone's menu may be different.**

**Tip:** Press **[\*]** to exit the current menu, or **[#]** to exit all menus.

## settings menu

- 👤 **Personalise**
  - Home screen
  - Main Menu
  - Voice Dial setup \*
  - Skin
  - Greeting
  - Wallpaper
  - Screen Saver
  - Sound Settings
- 🔊 **Ring Styles**
  - Style
  - (style) Detail
- 📞 **Call Divert \***
  - Voice Calls
  - Fax Calls
  - Data Calls
  - Cancel All
  - Divert Status
- 📱 **In-Call Setup**
  - In-Call Timer
  - Call Cost Setup \*
  - My Caller ID
  - Talk and Fax
  - Answer Options
  - Call Waiting
- 📅 **Initial Setup**
  - Time and Date
  - Speed Dial
  - Auto Redial
  - Display Timeout
  - Backlight
  - Scroll
  - Text Marquee
  - Language
  - Brightness
  - DTMF
  - Master Reset
  - Master Clear
- 📶 **Phone Status**
  - My Tel. Numbers
  - Credit Info/Available \*
  - Active Line \*
  - Battery Meter
  - Download Location
  - Storage Devices
  - Software Update \*
  - Other Information
- 🎧 **Headset**
  - Auto Answer
  - Voice Dial
- 🚗 **Car Settings**
  - Auto Answer
  - Auto Handsfree
  - Power-off Delay
  - Charger Time
- ✈️ **Airplane Mode**
  - Airplane Mode
  - Prompt At Power Up
- 🌐 **Network**
  - New Network
  - Network Setup
  - Available Networks
  - My Network List \*
  - Service Tone \*
  - Network Jingle \*
  - Call Drop Tone
- 🔒 **Security**
  - Phone Lock
  - Keypad Lock
  - Lock PTT Key \*
  - Lock Application
  - Fixed Dial \*
  - Restrict Calls \*
  - Call Barring \*
  - SIM PIN
  - New Passwords
  - Certificate Mgmt \*
- 📞 **PTT Settings \***
  - PTT Service
- 📱 **Java Settings**
  - Java App Loader
  - Java System
  - Delete All Apps
  - App Vibration
  - App Volume
  - App Priority \*

\* optional features

## Safety and General Information

**This section contains important information on the safe and efficient operation of your mobile device. Read this information before using your mobile device.<sup>1</sup>**

### Exposure to Radio Frequency (RF) Energy

Your mobile device contains a transmitter and receiver. When it is ON, it receives and transmits RF energy. When you communicate with your mobile device, the system handling your call controls the power level at which your mobile device transmits.

---

1. The information provided in this document supersedes the general safety information in user's guides published prior to May 1, 2006.

Your Motorola mobile device is designed to comply with local regulatory requirements in your country concerning exposure of human beings to RF energy.

### Operational Precautions

For optimal mobile device performance and to be sure that human exposure to RF energy does not exceed the guidelines set forth in the relevant standards, always follow these instructions and precautions.

#### External Antenna Care

If your mobile device has an external antenna, use only a Motorola-supplied or approved replacement antenna. Use of antennas, modifications or attachments could damage the mobile device and/or may result in your device not complying with local regulatory requirements in your country.

DO NOT hold the external antenna when the mobile device is IN USE. Holding the external antenna affects call quality and may cause the mobile device to operate at a higher power level than needed.

#### Product Operation

When placing or receiving a phone call, hold your mobile device just like you would a landline phone.

If you wear the mobile device on your body, always place the mobile device in a Motorola-supplied or approved clip, holder, holster, case or body harness. If you do not use a body-worn accessory supplied or approved by Motorola, keep the mobile device and its antenna at least 2.5 centimetres (1 inch) from your body when transmitting.

When using any data feature of the mobile device, with or without an accessory cable, position the mobile device and its antenna at least 2.5 centimetres (1 inch) from your body.

Using accessories not supplied or approved by Motorola may cause your mobile device to exceed RF energy exposure guidelines. For a list of Motorola-supplied or approved accessories, visit our Web site at: [www.motorola.com](http://www.motorola.com).

### RF Energy Interference/Compatibility

Nearly every electronic device is subject to RF energy interference from external sources if inadequately shielded, designed or otherwise configured for RF energy compatibility. In some circumstances your mobile device may cause interference with other devices.

### Follow Instructions to Avoid Interference Problems

Turn off your mobile device in any location where posted notices instruct you to do so. These locations include hospitals or health care facilities that may be using equipment that is sensitive to external RF energy.

In an aircraft, turn off your mobile device whenever instructed to do so by airline staff. If your mobile device offers an airplane mode or similar feature, consult airline staff about using it in flight.

#### Pacemakers

If you have a pacemaker, consult your doctor before using this device.

Persons with pacemakers should observe the following precautions:

- ALWAYS keep the mobile device more than 20 centimetres (8 inches) from your pacemaker when the mobile device is turned ON.

- DO NOT carry the mobile device in the breast pocket.
- Use the ear opposite the pacemaker to minimise the potential for interference.
- Turn OFF the mobile device immediately if you have any reason to suspect that interference is taking place.

#### Hearing Aids

Some mobile devices may interfere with some hearing aids. In the event of such interference, you may want to consult your hearing aid manufacturer or doctor to discuss alternatives.

#### Other Medical Devices

If you use any other personal medical device, consult your doctor or the manufacturer of your device to determine if it is adequately shielded from RF energy.



## Driving Precautions

Check the laws and regulations on the use of mobile devices in the area where you drive. Always obey them.

When using your mobile device while driving, please:

- Give full attention to driving and to the road. Using a mobile device may be distracting. Discontinue a call if you cannot concentrate on driving.
- Use handsfree operation, if available.
- Pull off the road and park before making or answering a call if driving conditions so require.

Responsible driving practices can be found in the “Smart Practices While Driving” section at the end of this guide and/or at the Motorola Web site: [www.motorola.com/callsmart](http://www.motorola.com/callsmart).

Symbol	Definition
	Do not let your battery, charger or mobile device get wet.
	Listening at full volume to music or voice through a headset may damage your hearing.

## Choking Hazards

Your mobile device or its accessories may include detachable parts, which may present a choking hazard to small children. Keep your mobile device and its accessories away from small children.

## Operational Warnings

Obey all posted signs when using mobile devices in public areas, such as health care facilities or blasting areas.

### Automobile Air Bags

Do not place a mobile device in the air bag deployment area.

### Potentially Explosive Atmospheres

Areas with potentially explosive atmospheres are often but not always posted and can include fuelling areas such as below decks on boats, fuel or chemical transfer or storage facilities or areas where the air contains chemicals or particles, such as grain, dust or metal powders.

When you are in such an area, turn off your mobile device and do not remove, install or charge batteries. In such areas, sparks can occur and cause an explosion or fire.

## Glass Parts

Some parts of your mobile device may be made of glass. This glass could break if the product is dropped on a hard surface or receives a substantial impact. If glass breaks, do not touch or attempt to remove. Stop using your mobile device until the glass is replaced by a qualified service centre.

## Seizures/Blackouts

Some people may be susceptible to epileptic seizures or blackouts when exposed to flashing lights, such as when playing video games. These may occur even if a person has never had a previous seizure or blackout.

If you have experienced seizures or blackouts or if you have a family history of such occurrences, please consult with your doctor before playing video games or enabling a flashing-lights feature (if available) on your mobile device.

## Damaged Products

If your mobile device or battery has been submerged in water, punctured or subjected to a severe fall, do not use it until you take it to a Motorola Authorised Service Centre. Do not attempt to dry it with an external heat source, such as a microwave oven.





## Batteries and Chargers

If jewellery, keys, beaded chains or other conductive materials touch exposed battery terminals, this could complete an electrical circuit (short circuit), become very hot and could cause damage or injury. Be careful when handling a charged battery, particularly when placing it inside a pocket, purse or other container with metal objects. **Use only Motorola Original batteries and chargers.**



**Caution:** To avoid risk of personal injury, do not dispose of your battery in a fire.

Your battery, charger or mobile device may contain symbols, defined as follows:

Symbol	Definition
	Important safety information follows.
	Do not dispose of your battery or mobile device in a fire.
	Your battery or mobile device may require recycling in accordance with local laws. Contact your local regulatory authorities for more information.
	Do not throw your battery or mobile device in the trash.
	Your mobile device contains an internal lithium ion battery.

Discontinue use and consult a doctor if any of the following symptoms occur: convulsion, eye or muscle twitching, loss of awareness, involuntary movements or disorientation. It is always a good idea to hold the screen away from your eyes, leave the lights on in the room, take a 15-minute break every hour and stop use if you are very tired.

## Caution About High Volume Usage



Listening at full volume to music or voice through a headset may damage your hearing.

## Repetitive Motion

When you repetitively perform actions such as pressing keys or entering finger-written characters, you may experience occasional discomfort in your hands, arms, shoulders, neck or other parts of your body. If you continue to have discomfort during or after such use, stop use and see a doctor.

## FCC Notice To Users

---

**The following statement applies to all products that have received FCC approval. Applicable products bear the FCC logo, and/or an FCC ID in the format FCC-ID:xxxxxx on the product label.**

Motorola has not approved any changes or modifications to this device by the user. Any changes or modifications could void the user's authority to operate the equipment. See 47 CFR Sec. 15.21.

This device complies with part 15 of the FCC Rules. Operation is subject to the following two conditions: (1) This device may not cause harmful interference, and (2) this device must accept any interference received, including interference that may cause undesired operation. See 47 CFR Sec. 15.19(3).

If your mobile device or accessory has a USB connector, or is otherwise considered a computer peripheral device whereby it can be connected to a computer for purposes of transferring data, then it is considered a Class B device and the following statement applies:

This equipment has been tested and found to comply with the limits for a Class B digital device, pursuant to part 15 of the FCC Rules. These limits are designed to provide reasonable protection against harmful interference in a residential installation. This equipment generates, uses and can radiate radio frequency energy and, if not installed and used in accordance with the instructions, may cause harmful interference to radio communications. However, there is no guarantee that interference will not occur in a particular installation. If this equipment does

cause harmful interference to radio or television reception, which can be determined by turning the equipment off and on, the user is encouraged to try to correct the interference by one or more of the following measures:

- Reorient or relocate the receiving antenna.
- Increase the separation between the equipment and the receiver.
- Connect the equipment to an outlet on a circuit different from that to which the receiver is connected.
- Consult the dealer or an experienced radio/TV technician for help.

## Use and Care

---

To care for your Motorola phone, please keep it away from:



### liquids of any kind

Don't expose your phone to water, rain, extreme humidity, sweat, or other moisture.



### dust and dirt

Don't expose your phone to dust, dirt, sand, food, or other inappropriate materials.



### extreme heat or cold

Avoid temperatures below -10°C/14°F or above 45°C/113°F.



### cleaning solutions

To clean your phone, use only a dry soft cloth. Do not use alcohol or other cleaning solutions.



### microwaves

Don't try to dry your phone in a microwave oven.



### the ground

Don't drop your phone.



# European Union Directives Conformance Statement

---

**CE** Hereby, Motorola declares that this product is in compliance with:

- The essential requirements and other relevant provisions of Directive 1999/5/EC
- All other relevant EU Directives

You can view your product's Declaration of Conformity (DoC) to Directive 1999/5/EC (to R&TTE Directive) at [www.motorola.com/rtte](http://www.motorola.com/rtte). To find your DoC, enter the product Approval Number from your product's label in the "Search" bar on the Web site.

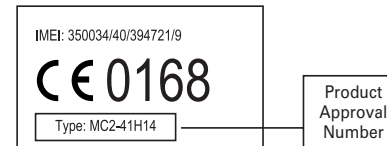

The above gives an example of a typical Product Approval Number.

## Caring for the Environment by Recycling

---



This symbol on a Motorola product means the product should not be disposed of with household waste.

## Recycling Mobile Phones and Accessories

---





Please do not dispose of mobile telephones or electrical accessories, such as chargers or headsets, with your household waste. In some countries or regions, collection systems have been set up to handle waste electrical and electronic items. Please contact your regional authorities for more details. If no suitable scheme exists, you may return unwanted mobile telephones and electrical accessories to any Motorola Approved Service Centre in your region.



## about this guide

This guide shows how to open a menu feature as follows:

**Find it:**  >  **Messages** > **New Message**

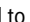
This means that, from the home screen:

- 1 Press the *centre key*  to open the menu.
- 2 Press the *navigation key*  to scroll to  **Messages**, and press the *centre key*  to select it.
- 3 Press the *navigation key*  to scroll to **New Message**, and press the *centre key*  to select it.

symbols	
	This means a feature is network, SIM card, or subscription dependent and may not be available in all areas. Contact your service provider for more information.
	This means a feature requires an optional accessory.

## SIM card

**Caution:** Don't bend or scratch your SIM card. Keep it away from static electricity, water, and dirt.

Your *Subscriber Identity Module* (SIM) card contains personal information like your phone number and contacts entries.

**Turn off your phone and remove your battery before you install or remove a SIM card.**

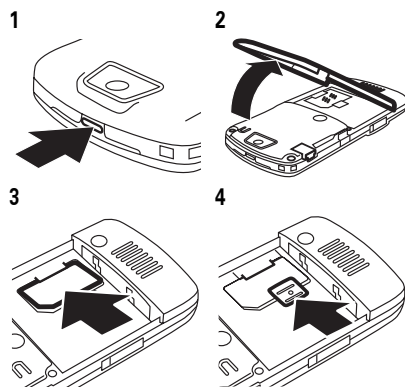

To insert and use a **memory card**, see page 48.

## battery

### battery installation

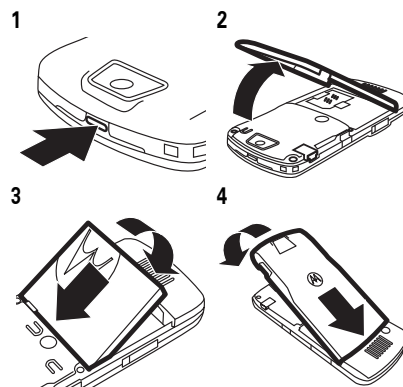

## battery charging

New batteries are not fully charged. Plug the battery charger into your phone and an electrical outlet. Your phone might take several seconds to start charging the battery. When finished, your display shows **Charge Complete**.

**Tip:** Relax, you can't overcharge your battery. It will perform best after you fully charge and discharge it a few times.

You can charge your battery by connecting a **cable** from your phone's mini-USB port to a USB port on a computer. Both your phone and the computer must be turned on, and your computer must have the correct

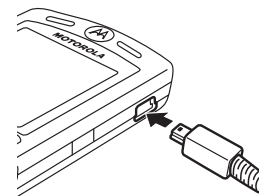

software drivers installed. Cables and software drivers are available in Motorola Original data kits, sold separately.

If your battery is completely dead and you plug in a **cable** to charge it, your keypad and display might not light up. Your battery will still charge.

## battery tips

Battery life depends on the network, signal strength, temperature, features, and accessories you use.

- Always use Motorola Original batteries and chargers. The warranty does not cover damage caused by non-Motorola batteries and/or chargers.



- New batteries or batteries stored for a long time may take more time to charge.
- When charging your battery, keep it near room temperature.  
When storing your battery, keep it uncharged in a cool, dark, dry place.
- Never expose batteries to temperatures below -10°C (14°F) or above 45°C (113°F). Always take your phone with you when you leave your vehicle.
- It is normal for batteries to gradually wear down and require longer charging times. If you notice a change in your battery life, it is probably time to purchase a new battery.



Contact your local recycling centre for proper battery disposal.

**Warning:** Never dispose of batteries in a fire because they may explode.

Before using your phone, read the battery safety information in the “Safety and General Information” section included in this guide.

## turn it on & off

**Caution:** Some phones ask for your SIM card PIN code when you turn them on. If you enter an incorrect PIN code three times before the correct code, your SIM card is disabled, and your display shows **SIM Blocked**. Contact your service provider.

- 2 Press the **Done** key to store the number. To **edit** or **delete** a **Contacts** entry, see page 81.  
To store an **email** address from the home screen, follow the steps above and enter the new contact’s name and **Email** information.  
**Shortcut:** Enter a phone number in the home screen, then press the **Store** key to create a contact. To choose whether your phone stores these contacts in your phone’s memory or on your SIM card, go back to the home screen and press **•••** > **Contacts**, then press **Options** > **Setup** > **Default Storage** > **Phone** or **SIM Card**.

## call a stored phone number

**Find it:** **•••** > **Contacts**

- 1 Scroll to the contacts entry.

**Shortcut:** In the contacts, press keypad keys to enter the first letters of an entry you want.

- 2 Press **☎** to call the entry.

**Note:** You can show contacts stored in your phone’s memory or on your SIM card. To choose which contacts you see, press **•••** > **Contacts**, then press **Options** > **View**. You can select **Phone & SIM Card**, **SIM Card**, or **Phone Contacts**.

## your phone number

From the home screen, press *the clear key* **☎** then **#** to see your number.

**Tip:** Want to see your phone number while you’re on a call? Press **Options** > **My Tel. Number**.

You can edit the name and phone number stored on your SIM card. From 

**To turn on your phone,** press and hold **☎** for a few seconds or until the keypad or display lights up. If prompted, enter your eight-digit SIM card PIN code and/or four-digit unlock code.

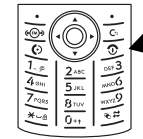

**To turn off your phone,** press and hold **☎** for a few seconds.

## make a call

**To make a call,** enter a phone number and press **☎**. To “hang up,” press **☎**.

## answer a call

**To answer a call** when your phone rings and/or vibrates, press **☎**. To “hang up,” press **☎**.

the home screen, press **☎** **#**, select an entry, press the **View** key, press the **Options** key, and select **Edit**. If you don’t know your phone number, contact your service provider.

## Motorola SETUP

Use **Motorola SETUP** to quickly and easily set up your Internet connection and MMS messaging. 

**Note:** Motorola SETUP may not be available on your phone. Contact your service provider for more information.

- 1 Press **•••** > **Games & Apps** > **Motorola Setup**.
- 2 At the Motorola SETUP screen press **Options** > **Start**.

**Note:** Your phone cannot receive data over an EDGE network while it is playing videos or some sound files. The EDGE  status indicator appears at the top of your display when you can receive data over an EDGE network.

## store a phone number

You can store a phone number in your **Contacts**:

**Find it:** **•••** > **Contacts**, then press **Options** > **Create New** > **Phone Contact** or **SIM Contact**

**Note:** You can store new contacts in your **phone’s memory** or on your **SIM card**. Contacts on the SIM card only have a **Name** and **Number**.

- 1 Enter a name and other details for the phone number. To select a highlighted item, press the *centre key* **•••**.

- 3 Your phone’s setup is verified:
  - If your phone is already set up the message “**Setup Complete**” is displayed. Press **Done** and you are finished.
  - If your phone is not set up, press **Yes** to set up your phone now.
- 4 Follow the on-screen instructions. You will need to select your service provider and may need to select your payment plan.
- 5 Wait until the **Settings Sent** screen is displayed, press **Exit**.
- 6 Two text messages with your settings will be sent to your phone. Open the text messages and press **Options** > **Insert**. You are now ready to use the Internet and MMS messaging.

**Note:** Data charges may apply for certain applications. Contact your service provider for more information.

# main attractions

You can do much more with your phone than make and receive calls!

## push to talk (PTT)

*Push to Talk* (PTT) lets you talk walkie-talkie style with other PTT subscribers. You can talk to one person or a group.

PTT and the other related features indicated are network and subscription dependent features, and are not available in all areas. PTT connectivity requires PTT-compatible phones.

**Note:** To lock your PTT key or turn PTT on or off, see page 32.

## make a PTT call

When  appears at the top of your home screen, you can make and receive PTT calls. To make a PTT call:



1 Enter a PTT subscriber's phone number in your home screen, or select a contact or group from a list:

- **PTT Contacts** (press the PTT key to open the list)



**Note:** If you change your **Open** to setting, your PTT key does not open the contacts list (see page 32).

- **PTT Quick Group** (press the PTT key and **Options > Quick Group**) This lets you select more than one contact for the call.

To send a stored picture, press

 >  **Multimedia > Pictures**, scroll to the picture, and press the PTT key.

To take a photo and send it, press

 >  **Multimedia > Camera, Capture** the photo, and press the PTT key.

Your phone plays a tone when the picture transfer completes. To speak after the picture transfers, hold the PTT key and speak after the tone.

## PTT contacts and groups

You can store **PTT Contacts** to make one-to-one calls, or you can store **PTT Groups** to make group calls.

To store a contact, press **PTT key**, then **Options > Add New Contact**. Enter the contact's **Name** and phone number (**No.**), then press the **Done** key. Your network stores the contact and your

- **PTT Groups** (press the PTT key and **Options > Go To Groups**)

2 Hold the PTT key and speak after you hear the tone. Release the PTT key to let others speak.

To speak during a PTT call, hold your PTT key and speak after the tone. Only one person can speak at a time.

To end the call, press . If nobody speaks for 20 seconds, the call ends (actual timing varies between PTT servers).

To send a **PTT alert** instead of a standard PTT call, scroll to a PTT contact in **PTT Contacts** and press the **Alert** key. The contact's phone rings or vibrates, and the contact can speak first. If the contact does not respond, the call ends. You cannot send alerts to groups.

## answer a PTT call

**Note:** Your phone cannot receive PTT calls while it is recording videos, and may not receive PTT calls while it is playing videos or some sound files. The PTT indicator  appears at the top of your display when you can receive PTT calls.

When you receive a PTT call, you hear a tone or alert followed by conversation from the caller.

- To speak when the caller stops speaking, hold your PTT key and speak after the tone. Only one person can speak at a time.
- To end the call, press .

If you change your **My Answer Mode** setting to **Manual**, your phone does not automatically answer as described (see page 32).

When you receive a PTT alert, press the PTT key and speak after the tone. You can also press the **Ignore** key to cancel the call.

Your display shows **Missed Call** if you miss a PTT alert. It does not show **Missed Call** when you miss a standard PTT call unless you set **My Answer Mode** to **Manual** (see page 32).

## send a picture with push to view (PTV)

You can send a picture during a PTT call, or you can open a picture and start a PTT call to send it.

**Note:** You cannot send pictures in group calls or while someone is speaking. You can send pictures only to phones with push to view (PTV) capability.

To send a picture during a PTT call, press **Options**, then select **Camera** to capture a new picture or **Pictures** to send a stored picture.



phone returns to the **PTT Contacts** list with the new contact shown.

To create a group of contacts that you can call at the same time, press **PTT key**, then **Options > Go To Groups**, then **Options > Add New Group**. Enter the group's **Name** and select the **Members**, then press the **Done** key. Your network stores the group and your phone returns to the **PTT Groups** list with the new group shown.

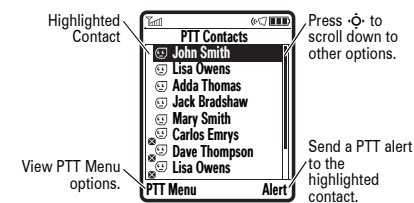
To see PTT contacts, press the PTT key. Scroll to a contact and press **Options** to **View**, **Edit**, or **Delete** it.

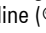
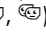
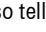
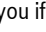

To see PTT groups, press the PTT key and **Options > Go To Groups**. Scroll to a group and press **Options** to **View** or **Delete** it. You cannot edit a group, but you can delete it and create a new one with the members you want.

Icons in the PTT contact and group lists indicate if someone is online (, ) or offline (, ). They also tell you if a contact is blocked (.

To block a contact, scroll to the contact and press **Options > Edit > Block Mode > On**. To unblock the contact, scroll to it and press the **Unblock** key.

To set an **online alert**  to tell you when a contact comes online, scroll to the contact and press **Options > Enable Online Alert**. You can turn online alert tones on or off in your **PTT Setup** menu (see page 32).

To refresh the contact or group list from your network, press **Options > Refresh List**.

To see only your frequently used contacts or groups, press **Options > Frequently Used**.

## PTT settings

To turn **PTT on or off** from your home screen, press **☰ > Settings > PTT Settings > PTT Service > On/Off**.

To prevent accidental PTT calls, you can **lock your PTT key** and keypad. To lock your keypad, long press the **[X]** key. To unlock your keypad press **Unlock > [X]**. If you do not press the PTT key within a minute of unlocking it, it re-locks.

You can change your PTT menu and call preferences.

**Find it:** Press **PTT key**. In the **PTT Menu**, select **PTT Setup > Personalise**

options	
<b>Open to</b>	From the home screen, the PTT key can open the PTT menu ( <b>PTT Menu</b> ), or your contacts list sorted by name ( <b>Contacts</b> ), or most recent call ( <b>Last Contact Called</b> ).
<b>Sort by</b>	Sort your contacts and groups by <b>Name</b> , online <b>Status</b> , or call <b>Frequency</b> .
<b>My Answer Mode</b>	Set the mode for incoming PTT calls to <b>Manual</b> (press the PTT key to answer), <b>Auto-Accept</b> (standard mode that accepts all calls), or <b>Do Not Disturb</b> (accepts no calls).

options	
<b>Tone Volume</b>	Set the volume for the tone you hear when it is your turn to speak.
<b>PTT Speaker</b>	Turn the speakerphone <b>On</b> or <b>Off</b> for PTT calls.
<b>Set Online Alert Tone</b>	You can set an online alert to tell you when a contact or group comes online (scroll to the entry in your <b>PTT Contacts</b> or <b>PTT Groups</b> and press <b>Options &gt; Enable Online Alert</b> ).  This setting tells your phone whether to play these alert tones ( <b>On</b> ) or not ( <b>Off</b> ).

options	
<b>PTT Button Lock</b>	Lock your PTT key to avoid making accidental PTT calls. If this is <b>On</b> , your PTT key locks when your keypad is locked, or when you do not press it within one minute of unlocking it. If this is <b>Off</b> , your PTT key is unlocked all the time.

## Bluetooth™ wireless

Your phone supports Bluetooth wireless connections. You can connect your phone with a Bluetooth headset or car kit to make handsfree calls. You can also connect your phone with a phone or computer that supports Bluetooth connections to exchange files.

**Note:** The use of wireless phones while driving may cause distraction. Discontinue a call if you can't concentrate on driving. Additionally, the use of wireless devices and their accessories may be prohibited or restricted in certain areas. Always obey the laws and regulations on the use of these products.

**For maximum Bluetooth security**, you should always connect Bluetooth devices in a safe, private environment.

## use a headset or handsfree car kit

**Before you try to connect your phone with a handsfree device**, make sure the device is **on** and **ready** in *pairing* or *bonding* mode (see the user's guide for the device). You can connect your phone with only one device at a time.

**Find it:** **☰ > Connection > Bluetooth Link > [Add Audio Device]** 

Your phone lists the devices it finds within range.

- 1 Scroll to a device in the list and press the **centre key** **☰**.
- 2 Press the **Yes** or **Ok** key to connect to the device.
- 3 If necessary, enter the device passkey (such as **0000**) and press the **Ok** key.

When your phone is connected, the Bluetooth indicator **ⓑ** appears in the home screen.

**Shortcut:** When your phone's Bluetooth power is on, your phone can automatically connect to a handsfree device you have used before. Just turn on the device, or move it near the phone. If the device doesn't connect, turn it off and back on.

**Tip:** Want to know more about your headset or car kit? For specific information about a device, refer to the instructions that came with it.

## copy files to another device

You can copy a media file, contacts entry, datebook event, or Web shortcut from your phone to a computer or other device. 

**Note:** You can't copy some copyrighted objects.

- 1 On your phone, scroll to the object that you want to copy to the other device.
- 2 Press **Options**, then select:
  - **Manage > Copy** for media files.
  - **Send Contact** for contacts entries.
  - **Send** for datebook events.

- 3 Select a recognised device name, or **[Look for devices]** to search for the device where you want to copy the file.

**If your phone could not copy the file to the other device**, make sure the device is **on** and **ready** in *discoverable* mode (see the user's guide for the device). Also, make sure the device is not busy with another similar Bluetooth connection.

**Note:** Once you connect your phone to a Bluetooth device, that device can start similar Bluetooth connections with your phone. Your display shows the Bluetooth indicator **ⓑ** at the top when there is a Bluetooth connection.

## receive files from another device

If you do not see the Bluetooth indicator **ⓑ** at the top of your phone display, turn on your phone's 

Bluetooth feature by pressing

•◂ > Connection > **Bluetooth Link** > **Setup** > **Power** > **On**.

- 1 Place your phone near the device, and send the file from the device.

If your phone and the sending device don't recognise each other, place your phone in discoverable mode so the sending device can locate it: press •◂ > Connection > **Bluetooth Link** > **Find Me**.

- 2 Press the **Accept** key on your phone to accept the file from the other device.

Your phone notifies you when file transfer is complete. If necessary, press the **Store** key to save the file.

## 36 main attractions

previous ◀, or press •◂ right for next ▶. To pause the song, press the **Pause** key.

**Note:** To change repeat , shuffle , and other settings, press the **Options** key.

Use the volume keys on the left side of your phone to control volume.

Your phone also has a **Sounds** player that can play songs and ring tones, but it cannot store **Artists** or other song information. To use the **Sounds** player, press •◂ > **Multimedia** > **Sounds** and select the file you want to play.

## load music files

To download songs to your phone, see page 98. To copy files between your phone and a computer, see page 50.

**Note:** Your phone may not play audio files that have a bit rate higher than 128 kbps. If you try to download or play one of these files, your phone might show you an error or ask

## 38 main attractions

## send files to a printer

You can use a Bluetooth connection to send a picture, message, contacts entry, or datebook event from your phone to a printer.

**Note:** You cannot print message **Templates** or a contacts **Mailing List**.

- 1 On your phone, scroll to the object that you want to print, then press **Options** > **Print**.
- 2 If available, choose additional objects or print options.
- 3 Select a recognised printer name listed in the **Printers** menu, or [**Look for devices**] to search for the printer where you want to print the object.

**Note:** If you see **Service not supported** when you try to print, select **Options** > **Manage**

you to delete the file. Metadata information is **not** supported for **MP4** formatted files.

## create a playlist

**Find it:** •◂ > **Games & Apps** > **Digital Audio Player** > **Playlists** > **New Playlist**

- 1 Enter a name for the play list.
- 2 Press the **Done** key. Your display shows a list of song titles.
- 3 Press the *centre key* •◂ to select songs for the playlist.
- 4 Press the **Done** key to store the list. Your display shows the songs in the playlist.

To reorder the songs in this list: Press the *centre key* •◂ to select a song, then press •◂ to move it up or down in the order. When you have it in the right spot, press •◂ again.

- 5 Press the **Done** key to store the list.

> **Copy** > **Bluetooth** instead. Always use this option to print 4x6 photos.

## digital audio player

Your phone can play and store MP3 and AAC song files. You can use a removable memory card with your phone to store more songs (see page 48).

**Note:** You cannot use the audio player with a USB cable connected to your phone.

**Find it:** •◂ > **Games & Apps** > **Digital Audio Player**

Press •◂ up or down to scroll to an option, and press the *centre key* •◂ to select it:

options	
<b>Playlists</b>	Create or play a playlist (see page 38).

To hear your playlist, highlight it under **Playlists** and press **Options** > **Play**.

## stereo FM radio

You can use your phone to listen to FM radio stations. You can listen to the radio through the Motorola Original EMU stereo headset included with your phone, or through the phone's handsfree speaker.

**Note:** You must plug the stereo headset into the mini-USB port on your phone to use the FM radio. The headset acts as a radio antenna to receive radio signals. You can't listen to the radio over a Bluetooth wireless headset.

**Find it:** •◂ > **Multimedia** > **Radio**

options	
<b>Songs</b>	Show and play individual songs. <b>Note:</b> All of your phone's songs appear in the <b>Songs</b> list. Some songs do not have any <b>Artist</b> , <b>Album</b> , or <b>Genre</b> information stored, so they don't appear in those lists.
<b>Albums</b>	Select an album to show or play its songs.
<b>Artists</b>	Select an artist to show or play their songs.
<b>Genres</b>	Select a type of music to show or play songs.
<b>About</b>	Show audio player version information.

When you select a song, press the *centre key* •◂ for play ▶, press •◂ left for

## main attractions 37

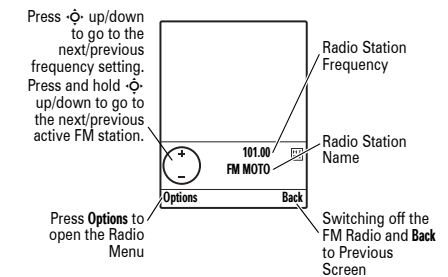

The radio shows current song information at the top of the display, if the information is broadcast by the radio station.

To **store a preset** station, press and hold a number key. This will assign the number to the current tuned station.

To **change a preset** station, press a number key representing the station you want.

## main attractions 39

Or

Press **Options** > **Station Presets**, scroll to the number you want to change, then press **Options**. You can change the station, rename it, delete it, or reorder the preset list.

To go to the next preset station, press **[#]**. If the radio is currently playing a non-preset station, the radio goes to the first preset station.

Press **Options** > **Hide** to hide the radio and go to the home screen. The radio continues to play. When the radio is hidden, press **[FM Radio]** or **[Multimedia]** > **Radio** to return to the radio display.

From the radio display, press **Options** to open the **Radio Menu**. The menu can include the following options.

options	
<b>Hide</b>	The radio is hidden but still on.
<b>Mute/Unmute</b>	Mute or unmute the radio.
<b>Use Speaker/Use Headset</b>	Switch sound to your phone speaker, or to the attached headset.  <b>Shortcut:</b> Press <b>[X]</b> to switch between the speaker and headset in the radio display.
<b>Scan</b>	Briefly hear each station your phone can receive. Press <b>Stop</b> to stop the scan. Manual FM tuning will be at 50kHz intervals.

options	
<b>Scan Presets</b>	Briefly hear each stored preset station. Press <b>Stop</b> to stop the scan.
<b>Station Presets</b>	See the list of preset stations.

To turn off the radio, press **[Back]** or **Back** in the radio display.

## photos

### take & store or send photos

Your camera lens is on the back of your phone. **To get the clearest pictures, wipe the lens clean with a dry cloth before you take a picture.**

1 Press **[Multimedia]** > **Camera** to see the camera viewfinder.

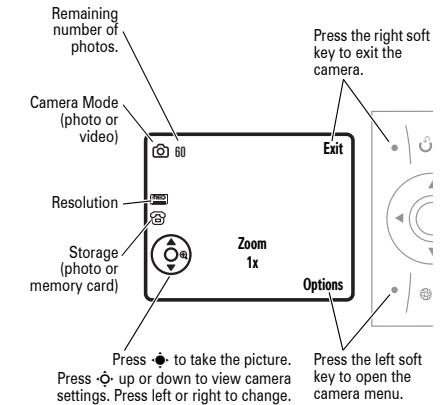

**Note:** Adjusting the exposure affects the brightness of both the viewfinder display and the captured photo.

**Note:** To change from portrait mode to landscape mode, press **[Landscape]** or select the **Options** key.

2 Press the **centre key** **[Shutter]** to take the photo in the viewfinder. You can:

- Press the **Options** key to store the photo. If you press **Options** > **Print**, you can print the picture over a Bluetooth™ connection (see page 36).
- Press the **Send** key to send the photo in a message.

Your phone might tell you that this is a **Multimedia Msg**, since it has a picture in it. Some other phones or networks do not support picture messages. Press the **Yes** key to send the message.

- Press **[Discard]** to discard the photo and return to the active viewfinder.

Before you capture the photo, you can press **Options** to open the camera menu:

options	
<b>Go to Pictures</b>	See stored pictures and photos.
<b>Go To Video Mode</b>	Switch to the video camera.
<b>Auto-Timed capture</b>	Set a timer for the camera to take a photo.
<b>Camera Setup</b>	Open the setup menu to adjust photo settings.
<b>Switch storage device</b>	Choose to store pictures on your phone or a memory card. <b>[Storage]</b>

options	
<b>Switch to Landscape/Switch to Portrait</b>	Change from portrait mode to landscape mode or from landscape mode to portrait mode.
<b>Free Space</b>	See how much memory remains.  <b>Note:</b> Your service provider may store some content in user memory before you receive the phone.

### see stored photos

Find it: **[Multimedia]** > **Pictures** > *picture name*

- To **delete** a picture, scroll to it in the list and press **Options** > **Manage** > **Delete**.

- To **edit** a picture, scroll to it and press **Options** > **Edit**. You can choose settings such as **Brightness** and **Contrast**, or effects such as **Blur** and **Mirror**. You cannot edit some copyrighted files. **[Edit]**
- To **copy or move** a picture from your memory card **[Memory Card]** to your phone memory **[Phone]**, scroll to it in the list and press **Options** > **Manage** > **Copy** or **Move** > **Phone**. You cannot copy or move some copyrighted files. **[Copy/Move]**

**Tip:** After you open a picture, you can press **Options** > **View Full Screen** to see the picture at the full display size (press any key to return to the regular view).



## send a stored photo in a message

**Find it:** > > **Messages** > **New Message** > **New Message**, then press **Options** > **Insert** > **Picture**

- 1 Scroll to the picture you want and press **Insert**.
- 2 Enter the message text and press **Send To**.
- 3 Scroll to a recipient address and press the **centre key**.
- 4 Press the **Send** key to send the message.

Your phone might tell you that this is a **Multimedia Msg**, since it has a picture in it. Some other phones or networks do not support picture messages. Press the **Yes** key to send the message.

## 44 main attractions

- Press to discard the video and return to the active viewfinder.

## play stored video clips

**Find it:** > > **Multimedia** > **Videos** > *video name*

- To **delete** a file, scroll to it in the list and press **Options** > **Manage** > **Delete**.
- To **copy or move** a file from your memory card () to your phone memory () or vice versa, scroll to it in the list and press **Options** > **Manage** > **Copy** or **Move** > **Phone**. You cannot copy or move some copyrighted files.

**Tip:** While a video is playing, you can press **Options** > **Play Full Screen** to see the video at the full display size (press any key to return to the regular view).

## 46 main attractions

## videos

### record video clips

Your camera lens is on the back of your phone. **To get the clearest videos, wipe the lens clean with a dry cloth before you capture a video.**

Press > > **Multimedia** > **Video Camera** to see the video viewfinder.

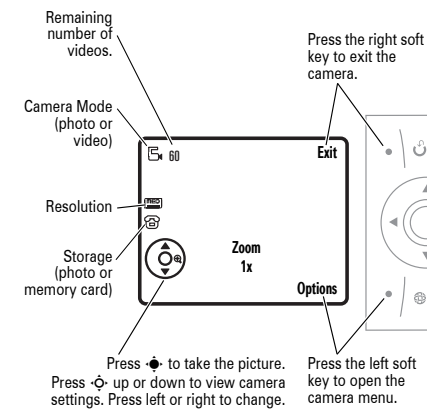

**Note:** The number of minutes remaining is an estimate.

To insert a **picture, sound, or other object** on the page, press **Options** > **Insert**. Select the file type and the file.

To insert **another page** in the message, enter text or objects on the current page and press **Options** > **Insert** > **New Page**. You can enter more text and objects on the new page.

- 2 When you finish the message, press the **Send To** key.
- 3 Scroll to a recipient and press the **centre key**. Repeat to add other recipients.

To enter a **new** number or email address, press the **Options** key and select **Enter Number** or **Enter Email**.

- 4 Before you send a message, you can press **Options** to choose **Save to Drafts**, **Cancel Message**, or open **Sending Options** (such as message **Subject** or **CC** addresses).

**Tip:** If you want to send your video in a message, the video length must be set to **MMS**. To set length, press **Options** > **Video Camera Setup** > **Video length**.

- 1 Press the **centre key** to start recording the video in the viewfinder.
- 2 Press the **Stop** key to stop recording the video. You can:

- Press the **Options** key to preview, store, or discard the video.
- Press the **Send** key, then select **Send in Message** to send the video in a message.

Enter text and press **Send To**, then scroll to a recipient address and press the **centre key** to select it. Press the **Options** key to enter a new number. To send the message, press the **Send** key.

**Note:** Some other phones or networks do not support messages with videos.

## main attractions 45

## text messages

To create a group mailing list, see page 83. For more message features, see page 84.

### send a text message

A text message can contain text and pictures, sounds, or other media objects. You can add multiple pages to a message, and you can put text and media objects on each page. You can send a message to other compatible phones or to email addresses.

**Find it:** > > **Messages** > **New Message** > **New Message**

- 1 Press keypad keys to enter text on the page (for details about text entry, see page 56).

- 5 To **send** the message, press the **Send** key.

Your phone might tell you that this is a **Multimedia Msg**, if it has multiple pages or media objects in it. Some other phones or networks do not support multimedia messages. Press the **Yes** key to send the message.

### receive a text message

When you receive a message, your phone plays an alert, and the display shows **New Message** with a message indicator, such as . Press the **Read** key to open the message.

To see all of your text messages:

**Find it:** > > **Messages** > **Message Inbox**

If a multimedia message contains media objects:

- Photos, pictures, and animations show as you read the message.

## main attractions 47

- A sound file plays when its slide shows. Use the volume keys to adjust the sound volume.
- Attached files are added to the end of the message. To open an attachment, scroll to the file indicator/filename and press the **View** key (image), **Play** key (sound), or **Open** key (contacts vCard, datebook vCalendar entry, or unknown file type).

## memory card

You can use a removable memory card with your phone to store and retrieve multimedia objects (such as photos and sounds).

Your phone supports memory cards up to 2GB.

**Note:** If you download a copyrighted file and store it on your memory card, you can use the

**48** main attractions

enter them to make a call. To turn these features on or off:

**Find it:** > **Settings** > **Personalise** > **Sound Settings** > **Talking Phone**

Your phone speaks the name for any caller stored in your **Contacts**, or speaks the digits for numbers not stored in your **Contacts**.

**Note:** If you turn on **Talking Phone**, your phone **does not use** your **Ring Style** for incoming calls.

## cable connections

Your phone has a mini-USB port so you can connect it to a computer to transfer data.

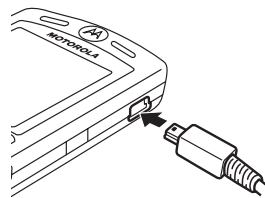

**50** main attractions

file only while your memory card is inserted in your phone. You cannot send, copy, or change copyrighted files.

## install or remove a memory card

Press the card in until it clicks into place.

**To remove the memory card,** push it in until it clicks again. It begins to slide out, and you can slide it the rest of the way out.

Do not remove your memory card while your phone is using it or writing files on it.

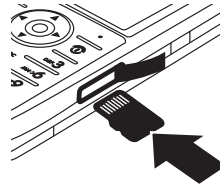

**Note:** Motorola Original USB data cables and supporting software are sold separately. Check your computer or hand-held device to determine the type of cable you need. To **transfer data** between your phone and computer, you might need to install the software included with the Motorola Original data kit. See the data kit user's guide for more information. To make **data calls** through a connected computer, see page 92.



## connect your memory card to a computer

You can use a cable connection to access your phone's memory card with a PC.

**Note:** When your phone is connected to a computer, you can only access the memory card through the computer.

## see and change memory card information

To **see the files** stored on your memory card and on your phone, open a file list, such as **Pictures** (see page 43). Icons can indicate if a file is stored in your phone memory () or on your memory card (). To copy or move a file from your phone to your memory card, highlight it in the list and press **Options** > **Manage** > **Copy** or **Move** > **Memory Card**. You cannot copy or move some copyrighted files.

To **copy files** between your memory card and a computer, you can use a cable connection (see page 50) or a Bluetooth™ connection (see page 35).

To see your **memory card name, available memory,** and other information about the card:

**Find it:** > **Settings** > **Phone Status** > **Storage Devices**

On your phone:

**Disconnect the cable** from your phone, if it is connected, then press > **Connection** > **USB Settings** > **Default Connection** > **Memory Card**.

This directs the USB connection to your memory card.

**Connect the cable** to your phone and to an available USB port on your computer. Then follow these steps:

On your computer:

- 1 Open your "My Computer" window, where your phone's memory card appears as a "Removable Disk" icon.
- 2 Click on the "Removable Disk" icon to access the files on your phone's memory card.
- 3 To store the desired files onto the memory card, drag and drop them as follows:

- 1 Press to scroll to the memory card that is installed.
- 2 Press the **centre key** to see the memory card information. Your phone stores any content that you add, like ring tones or games, in *user memory*. Your service provider may store some content in user memory before you receive the phone.

or

Press **Options** to see the **Storage Dev. Menu**, which lets you **Format** or **Rename** the memory card.

## talking phone

When you receive calls, your phone can "speak" the caller's number or name rather than ringing. Also, your phone can read names to you when you scroll through your **Contacts**, and can speak digits to you as you

main attractions **49**

**audio files:** > mobile > audio  
**screen savers:** > mobile > picture  
**wallpapers:** > mobile > picture  
**video clips:** > mobile > video

- 4 When you finish, disconnect your phone by selecting the "Safely Remove Hardware" icon in the system tray at the bottom of your computer screen. Then disconnect the "USB Mass Storage Device."
- 5 Disconnect the cable from your phone and computer.

On your phone:

To return to **Data** as your USB default connection, press > **Connection** > **USB Settings** > **Default Connection** > **Data connection**.

main attractions **51**

## phone updates

Sometimes we think of ways to make your phone's software faster or more efficient after you've purchased your phone. You can find out if your phone can be updated at: <http://hellomoto.com/update>



**Note:** Software updates do not affect your contacts entries or other personal entries. If you receive a software update but choose to install it later, see page 94.

# basics

See page 1 for a basic phone diagram.

## display

The *home screen* appears when you turn on the phone.

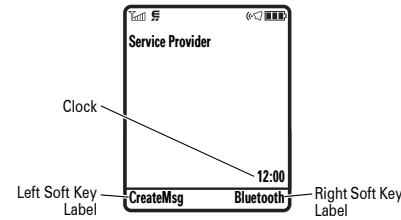

**Note:** Your home screen might look different from the one shown, depending on your service provider.

To dial a number from the home screen, press number keys and .

Press up, down, left, or right in the home screen to open basic menu features.

Press the *centre key* to open the menu. *Soft Key Labels* show the current soft key functions. For soft key locations, see page 1.

Status indicators can show at the top of the home screen:

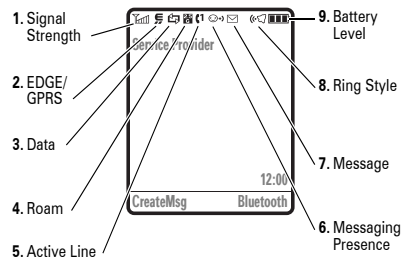

**1 Signal Strength Indicator** – Vertical bars show the strength of the network connection. You can't make or receive calls when or appears.

**Note:** You will see when Aeroplane mode is on. For Aeroplane mode details, see page 67.

**2 EDGE/GPRS Indicator** – Shows when your phone is using a high-speed *Enhanced Data for GSM Evolution* (EDGE) or *General Packet Radio Service* (GPRS) network connection. Indicators can include:

- GPRS PDP context active
- EDGE
- GPRS packet data available

**3 Data Indicator** – Shows connection status.

- secure / unsecure packet data transfer
- secure/unsecure application connection
- secure/unsecure *Circuit Switch Data* (CSD) call

Bluetooth™ connection is active

**4 Roam Indicator** – Shows when your phone is seeking or using a network outside your home network.

**5 PTT / Active Line Indicator** – Shows when you can make and receive PTT calls () or both PTT calls and Instant Messages (). This also shows to indicate an active phone call, or to indicate when call diverting is on. Indicators for dual-line-enabled SIM cards can include:

- line 1 active
- line 1 active, call divert on
- line 2 active
- line 2 active, call divert on

**6 Messaging Presence Indicator** – Shows when Instant Messaging (IM) is active. Indicators can include:

- IM active
- invisible to IM
- busy
- offline

When a Java™ application is active, can show here.

If you set a reminder for a datebook event, can appear here.

**7 Message Indicator** – Shows when you receive a new message. Indicators can include:

- text message
- voice message
- voice & text message
- IM message

**8 Ring Style Indicator** – Shows the ring style setting.

- 🔔 loud ring     📳 vibrate & ring
- 🔔 soft ring    📳 vibrate then ring
- 🔔 vibrate       📴 silent

**9 Battery Level Indicator** – Vertical bars show the battery charge level. Recharge the battery when your display shows **Low Battery**.

## text entry

Some features let you enter text.

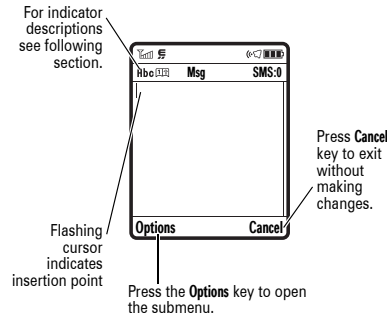

Press **#** in a text entry view to select an entry mode:

entry modes	
<b>1</b> or <b>1</b>	Your <b>Primary</b> text entry mode can be set to any iTAP™ <b>1</b> or tap <b>1</b> mode.
<b>2</b> or <b>2</b>	Your <b>Secondary</b> text entry mode can be set to any iTAP™ <b>2</b> or tap <b>2</b> mode, or set to <b>None</b> if you don't want a secondary entry mode.
<b>123</b>	<b>Numeric</b> mode enters numbers only.
<b>@%</b>	<b>Symbol</b> mode enters symbols only.

To set your primary and secondary text entry modes, press **Options > Text Setup** in a text entry view and select **Primary Text** or **Secondary Text**.

iTAP™ and tap mode tips

- Press **0** in a text entry view to change text case to all capital letters (**ABC**), no capitals (**abc**), or next letter capital (**Abc**).
- To enter numbers quickly, press and hold a number key to temporarily switch to numeric mode. Press the number keys to enter the numbers you want. Enter a space to change back to iTAP or Tap mode.
- Press **1** to enter punctuation or other characters.
- Press **◀** to move the flashing cursor to enter or edit message text.
- Press **⌫** to delete the character to the left of the cursor. Hold **⌫** to delete the word.
- To cancel your message, press **⌫**.

## iTAP™ mode

Press **#** in a text entry view to switch to iTAP mode. If you don't see **1** or **2**, press **Options > Text Setup** to set iTAP mode as your primary or secondary text entry mode.

iTAP mode lets you enter words using one keypress per letter. The iTAP software combines your keypresses into common words and predicts each word as you enter it.

For example, if you press **7 7 6 4**, your display shows:

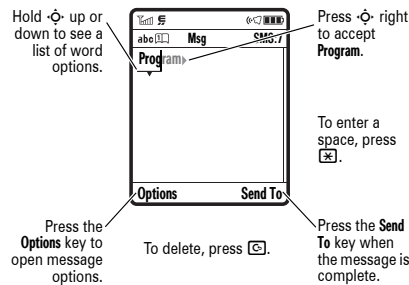

If you want a different word (such as **Progress**), continue pressing keypad keys to enter the remaining letters.

**Tip:** Don't worry if you forget how iTAP works. In a text entry display, you can press **Options > Text Setup > Text Tutorial** to see an explanation.

## tap and tap extended modes

Press **#** in a text entry view to switch to tap mode. If you don't see **Abc 1** or **Abc 2**, press **Options > Text Setup** to set tap mode as your primary or secondary text entry mode.

To enter text in **TAP** mode, press a keypad key repeatedly to cycle through the letters and number on the key. Repeat this step to enter each letter. The **Tap Extended** mode works the same way, but includes more special characters and symbols.

For example, if you press **7** one time, your display shows:

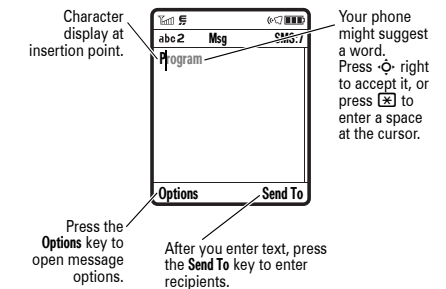

The first character of every sentence is capitalised. If necessary, press **◀** down to change the character to lowercase before the cursor moves to the next position.

## numeric mode

Press **#** in a text entry view until you see **123**. Press the number keys to enter the numbers you want.

**Shortcut:** You can press and hold a number key to temporarily switch to numeric mode from iTAP™ or Tap modes. Press the number keys to enter the numbers you want. Enter a space to change back to iTAP mode.

## symbol mode

Press **#** in a text entry view until your display shows a list of symbols. Scroll to the symbol you want, then press the **centre key** .

## volume



Press the volume keys to:

- turn off an incoming call alert
- change the earpiece volume during calls
- change the ringer volume from the home screen

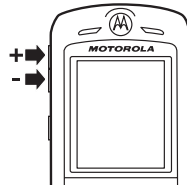
**Tip:** Sometimes silence really is golden. That's why you can quickly set your ringer to **Vibrate** or **Silent** by holding the down volume key while you are in the home screen. You can also switch to **Silent** or back by holding **#** in the home screen.



## navigation key

Press the **navigation key**  up, down, left, or right to scroll to items in the display. When you scroll to an item, press the **centre key**  to select it.

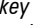

## smart key

The smart key gives you another way to do things. For example, when you scroll to a menu item, you can press the smart key to select it (instead of pressing the **centre key** ). The smart key usually does the same thing as pressing the **centre key** . To find the smart key, see page 1. To change what the smart key does in the home screen, see page 90.

## voice commands

You can use voice commands to tell your phone what to do. To find the Voice Command Key refer to page 1.

**Note:** This option is available only when the phone language supports voice commands. Voice names will be used when voice commands are not supported.

- 1 Press and release the **voice command key** on the right side of your phone.  
Your phone says "Say a command."
- 2 Say a voice command from the list (replace *555-1212* with a phone number, and replace *John Smith* with a contacts entry name):

voice commands
"Call 555-1212"
"Call John Smith"

voice commands
"Send Email John Smith"
"Send Voice Note 555-1212"
"Send Voice Note John Smith"
"Send Message 555-1212"
"Send Message John Smith"
"Lookup John Smith"
"PTT Connect John Smith"
"Go to Voicemail"
"Go to Camera"
"Go to Redial"
"Go to Received Calls"
"Check Status"
Your phone tells you its battery strength, network signal strength, and whether its coverage is normal or roaming.
"Check Battery"

voice commands
"Check Signal"
"Check Network"
"Check My Phone Number"
"Turn Prompts Off"
Your phone turns off the sound on your voice command prompts (such as "Say a command."). To turn prompts on again, say "Turn Prompts On." Your phone confirms by saying "Voice prompts on."

### Tip:

- You can say a contacts entry's name and number type together. For example, say "Call John Smith Mobile" to call the Mobile number stored for John Smith.

- Speak numbers at a normal speed and volume, pronouncing each digit distinctly. Don't pause between digits.
- For voice command help, press the **voice command key**, then press the **Help** key.

## voice command setup

You can change voice command settings.

- 1 Press and release the **voice command key** on the right side of the phone.
- 2 Press the **Settings** key.

- 3 Choose one of the settings below:

voice command settings	
<b>Choice Lists</b>	Turn choice lists on or off. Your phone uses choice lists to confirm voice commands by asking "Did you say..." followed by a choice list item.
<b>Sensitivity</b>	Make your phone more or less likely to reject a voice command.
<b>Digit Dialling</b>	Train your phone to recognise how you say digits.
<b>Sound</b>	Adjust the sound settings for your voice commands.
<b>About</b>	See voice command software information.

## record a voice name

To add a **Voice Name** scroll to the desired contact, press the **Options** key and select **Add to Voice Dial**. Press the **Record** key and say the contact's name (within six seconds).

**Note:** The **Voice Name** option isn't available for entries stored on the SIM card.

You can use voice dial to call an entry in your contacts.

- 1 Press and release the voice command key on the right side of your phone.

Your phone says "Say a name in your phonebook".

**Note:** Phonebook in Voice Commands refers to your Contacts on the handset.

- 2 Say the entry's voice dial name.

## handsfree speaker

You can use your phone's handsfree speaker to make calls without holding the phone to your ear.

To turn the handsfree speaker on during a call, press the **Speaker** key (if available), or **Options > Spkrphone On**. Your display shows **Spkrphone On** until you turn it off or end the call.

**Note:** The handsfree speaker won't work when your phone is connected to a handsfree car kit or headset.

## codes & passwords

Your phone's four-digit **unlock code** is originally set to **1234**. The six-digit **security code** is originally set to **000000**. If your service provider didn't change these codes, you should change them:

**Find it:**  >  **Settings > Security > New Passwords**

You can also change your **SIM PIN** password.



**If you forget your unlock code:** At the **Enter Unlock Code** prompt, try entering 1234 or the last four digits of your phone number. If that doesn't work, press  and enter your six-digit security code instead.



**If you forget other codes:** If you forget your security code, SIM PIN code, PIN2 code, or call barring password, contact your service provider.

## lock & unlock phone

You can lock your phone to keep others from using it. To lock or unlock your phone, you need the four-digit unlock code.

To **manually lock** your phone:



Press  >  **Settings > Security > Phone Lock > Lock Now**.

To **automatically lock** your phone whenever you turn it off: Press  >  **Settings > Security > Phone Lock > Automatic Lock > On**.

**Note:** You can make emergency calls on a locked phone (see page 74). A locked phone still rings or vibrates for incoming calls or messages, **but you need to unlock it to answer**.

## lock & unlock keypad

You can lock your keypad to prevent accidental key presses. To lock your keypad, go to the home screen and hold  for two seconds. To unlock it, press the **Unlock** key (right soft key), then the **Ok** key (left soft key).

You can also set your phone to **automatically lock** the keypad when you're not using it. To set how long your phone waits before it locks your keypad, press  >  **Settings > Security > Keypad Lock > Timer > a time interval or Off**.

**Note:** Incoming calls unlock the keypad.

# customise

The ring style profile's indicator appears at the top of your home screen. To choose your profile:

**Find it:** > **Settings** > **Ring Styles**  
> **Style:** *style name*

**Shortcut:** To change your ring style profile from the home screen, press the volume keys up or down. You can also just hold the key to switch to **Silent** and back.

## change alerts in a ring style

You can change the alerts for incoming calls and other events. Your changes are saved in the current ring style profile.

**Find it:** > **Settings** > **Ring Styles**  
> *style* **Detail**

**Note:** *Style* represents the current ring style. You can't set an alert for the **Silent** ring style setting.

- 1 Scroll to **Calls** (or **Line 1** or **Line 2** for dual-line phones), then press the **Change** key to change it.
- 2 Scroll to the alert you want, then press the **centre key** .
- 3 Press the **Back** key to save the alert setting.

## time & date

Your phone can automatically update your time zone, time, and date. It uses the time and date for the datebook.

To **synchronise** the time zone, time, and date with the network:   
Press > **Settings** > **Initial Setup** > **Time and Date** > **Autoupdate** > **Time & Time Zone**. If you don't want your phone to automatically update your time zone and date, choose **Time Only** instead.

## aeroplane mode

You can switch your phone to aeroplane mode to prevent it from communicating with the network. This lets you use games or other applications, or use the digital audio player to listen to music while you are on an aeroplane, without interfering with aeroplane communications.

**Note:** Your phone cannot make Bluetooth™ connections when **Airplane Mode** is on.

**Find it:** > **Settings** > **Airplane Mode** > **Airplane Mode**  
> **On**

You can make the aeroplane mode option appear whenever you turn on your phone:

> **Settings** > **Airplane Mode** > **Prompt At Power Up** > **On**

## ring style

**Note:** If you turn on **Talking Phone**, your phone **does not use** your **Ring Style** for incoming calls.

Each ring style profile uses a different set of sounds or vibrations for incoming calls and other events. Here are the profiles you can choose:

- |                |                        |
|----------------|------------------------|
| <b>Loud</b>    | <b>Vibe &amp; Ring</b> |
| <b>Soft</b>    | <b>Vibe then Ring</b>  |
| <b>Vibrate</b> | <b>Silent</b>          |

To **manually** set the time zone, time, and date, turn off **Autoupdate**, then:

Press > **Settings** > **Initial Setup** > **Time and Date** > **Time Zone**, *time* or *date*. To jump to a city in the time zone list, enter the first letter of its name by pressing keypad keys.

**Tip:** To choose three time zones for easier access, press > **Tools** > **World Clock**. When you open **World Clock**, you can press the **Options** key to see the **Map View** of time zones.

To choose an **analogue** or **digital** clock for your home screen, press > **Settings** > **Personalise** > **Home screen** > **Clock**.

## wallpaper

Set a photo, picture, or animation as a wallpaper (background) image in your home screen.

**Find it:** > **Settings** > **Personalise**  
> **Wallpaper**

options	
<b>Picture</b>	Press  up or down to select a picture, or select <b>None</b> for no wallpaper.
<b>Layout</b>	Select <b>Centre</b> to centre the image in the display, <b>Tile</b> to repeat the image across the display, or <b>Fit-to-screen</b> to stretch the image across the display.

## screen saver

Set a photo, picture, or animation as a screen saver image. The screen saver appears when no activity is detected for a specified time.

**Tip:** To extend battery life, turn off the screen saver.



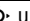

Find it:  >  **Settings** > **Personalise** > **Screen Saver**



options	
<b>Picture</b>	Press  up or down to select a picture or animation, or select <b>None</b> for no screen saver.
<b>Delay</b>	Select the length of inactivity before the screen saver appears.

## display appearance

To choose a phone **skin** that sets the look and feel of your phone's display: Press

 >  **Settings** > **Personalise** > **Skin**.

To set your display **brightness**: Press

 >  **Settings** > **Initial Setup** > **Brightness**.

To save battery life, your keypad **backlight** turns off when you're not using your phone. The backlight turns on when you press any

key. To set how long your phone waits before the backlight turns off:

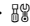
Press  >  **Settings** > **Initial Setup** > **Backlight**.

To save battery life, the **display** can turn off when you're not using your phone. The display turns back on when you press any key. To set how long your phone waits before the display turns off:

Press  >  **Settings** > **Initial Setup** > **Display Timeout**.

## answer options

The **Multi-key** option lets you answer incoming calls by pressing any key.

Find it:  >  **Settings** > **In-Call Setup** > **Answer Options** > **Multi-key**

# calls

To make and answer calls, see page 25.

## turn off a call alert

You can press the volume keys to turn off a call alert before answering the call.

## delay answering

If you want to answer a call, but need to step outside first, you can delay answering the call.

When your phone rings, press the **Delay** key. Your phone stops ringing and plays a brief message for the caller, such as "Please hold, your call will be answered in a moment." The call remains on hold until you press the **Talk** key.

To turn **Delayed Answer** on, or record your **Delayed Answer** message (up to 10 seconds), press **Settings** > **In-Call Setup** > **Answer Options** > **Delayed Answer**

## recent calls

Your phone keeps lists of incoming and outgoing calls, even for calls that didn't connect. The most recent calls are listed first. The oldest calls are deleted as new calls are added.

**Shortcut:** Press **Recent Calls** from the home screen to see a list of dialed calls.

**Find it:** Press **Recent Calls**, then press **Dialled Calls**, **Received Calls**, or **Missed Calls**

Scroll to a call. A ✓ next to a call means the call connected.

- To call the number, press **Call**.
- To see call details (like time and date), press the **centre key**.
- To see the **Last Calls Menu**, press **Options**. This menu can include:

options	
<b>Store</b>	Create a contacts entry with the number in the <b>No.</b> field. <b>Store</b> does not appear if the number is already stored.
<b>Delete</b>	Delete the entry.
<b>Delete All</b>	Delete all entries in the list.
<b>Show ID</b>	Show your caller ID for the next call.
<b>Hide ID</b>	Hide your caller ID for the next call.

options	
<b>Send Message</b>	Open a new text message with the number in the <b>To</b> field.
<b>Send Voice Msg</b>	Record and send a voice message to the number.
<b>Add Digits</b>	Add digits after the number.
<b>Attach Number</b>	Attach a number from the contacts or recent calls lists.
<b>Send Tones</b>	Send the number to the network as DTMF tones. <b>Note:</b> This option appears only <b>during a call</b> .
<b>Talk then Fax</b>	Talk and then send a fax in the same call
<b>Filter by</b>	Select all, dialled, received, or missed calls.

options	
<b>Notepad</b>	Open the number in a text editor.
<b>Call Times</b>	Open your call time information.
<b>Call Cost</b>	Open your call cost information.
<b>Data Times</b>	See how much time you have spent on data transfers.
<b>Data Volumes</b>	See how much data you have transferred.

## redial

- 1 Press **Call** from the home screen to see a list of recent calls.
- 2 Scroll to the entry you want to call, then press **Call**.

If you hear a **busy signal**, and you see **Call Failed**, you can press **Call** or the **Retry** key to redial the number. When the call goes through, your phone rings or vibrates one time, shows **Redial Successful**, and connects the call.

## return a call

Your phone keeps a record of your unanswered calls, and shows **X Missed Calls**, where **X** is the number of missed calls.

- 1 Press the **View** key to see the received calls list.
- 2 Scroll to the call you want to return, then press **Call**.

## caller ID

*Calling line identification* (caller ID) shows the phone number for an incoming call in your display.



Your phone shows the caller's name and picture when they're stored in your contacts, or **Incoming Call** when caller ID information isn't available.

You can set your phone to play a different ringer ID for an entry stored in your contacts (see page 81).

To show or hide **your phone number** from the next person you call, enter the phone number and press **Options > Hide ID/Show ID**.

## emergency calls

Your service provider programs one or more emergency phone numbers, such as 999, that you can call under any circumstances, even

when your phone is locked or the SIM card is not inserted.

**Note:** Emergency numbers vary by country. Your phone's preprogrammed emergency number(s) may not work in all locations, and sometimes an emergency call cannot be placed due to network, environmental, or interference issues.

- 1 Press the keypad keys to dial the emergency number.
- 2 Press  to call the emergency number.

## voicemail

Your network stores the voicemail messages you receive. To listen to your messages, call your voicemail number.



**Note:** Your service provider may include additional information about using this feature.

When you **receive** a voicemail message, your phone shows the voicemail message indicator  and **New Voicemail**. Press the **Call** key to listen to the message.



To **check** voicemail messages:

**Find it:**  >  **Messages > Voicemail**

Your phone may prompt you to store your voicemail phone number. If you don't know your voicemail number, contact your service provider.

**Note:** You can't do the following: **Insert Pause** (pause), **Insert Wait** (wait), or **Insert 'n'** (number) character in this number. If you want to store a voicemail number with these characters, create a contacts entry for it. Then you can use the entry to call your voicemail.



To **change** your voicemail number or turn off voicemail notification, press



 >  **Messages**, then press the **Options** key and select **Setup > Voicemail Setup**.





# other features









## advanced calling

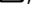





features
<b>attach a phone number</b> 
Dial an area code or prefix for a contacts number, then press <b>Options &gt; Attach Number</b> .









features
<b>notepad</b>
 >  <b>Recent Calls</b> , press the <b>Options</b> key, then > <b>Notepad</b>
<ul style="list-style-type: none"><li>To call the number, press .</li><li>To create a contacts entry with the number in the <b>No.</b> field, press the <b>Store</b> key.</li><li>To open the <b>Dialling Menu</b> to attach a number or insert a special character, press <b>Options</b>.</li></ul>

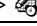

features
<b>international calls</b> 
If your phone service includes international dialling, press and hold  to insert your local international access code (indicated by +). Then, press the keypad keys to dial the country code and phone number.
<b>hold a call</b>
Press <b>Options &gt; Hold</b> to put all active calls on hold.
<b>mute a call</b>
Press the <b>Mute</b> key (if available) or <b>Options &gt; Mute</b> to put all active calls on mute.

features
<b>call waiting</b> 
When you're on a call, you'll hear an alert if you receive a second call.
Press  to answer the new call.
<ul style="list-style-type: none"><li>To switch between calls, press the <b>Switch</b> key.</li><li>To connect the two calls, press <b>Options &gt; Link</b>.</li><li>To end the call on hold, press <b>Options &gt; End Call on Hold</b>.</li></ul>
To turn the call waiting feature on or off:
 >  <b>Settings &gt; In-Call Setup &gt; Call Waiting &gt; On or Off</b>

features
<b>conference call</b> 
During a call: Dial the next number, press  , and press <b>Options &gt; Link</b> .
<b>transfer a call</b> 
During a call: <b>Options &gt; Transfer</b> , dial transfer number, press 
<b>call diverting</b> 
Set up or cancel call diverting:  >  <b>Settings &gt; Call Divert</b>
<b>restrict calls</b> 
Restrict outgoing or incoming calls:  >  <b>Settings &gt; Security &gt; Restrict Calls</b>
Tell your phone to allow <b>All</b> , <b>None</b> , or only the calls from your <b>Contacts</b> .



features
<b>call barring</b> 
Restrict outgoing or incoming calls:  >  <b>Settings &gt; Security &gt; Call Barring</b>
<b>change phone line</b> 
If you have a dual-line-enabled SIM card, you can change your line to make and receive calls from your other phone number.
 >  <b>Settings &gt; Phone Status &gt; Active Line</b>

features
<b>fixed dial</b> 
When you turn on fixed dialling, you can call only numbers stored in the fixed dial list.
Turn fixed dialling on or off:  >  <b>Settings &gt; Security &gt; Fixed Dial</b>
Use the fixed dial list:  >  <b>Tools &gt; Dialling services &gt; Fixed Dial</b>
<b>quick dial</b> 
Dial preprogrammed phone numbers:  >  <b>Tools &gt; Dialling services &gt; Quick Dial</b>

features
<b>DTMF tones</b>
Activate DTMF tones:  >  <b>Settings &gt; Initial Setup &gt; DTMF</b>
To send DTMF tones during a call, just press number keys or scroll to a number in the contacts or recent calls lists and press <b>Options &gt; Send Tones</b> .

## contacts

To store and call contacts entries, see page 25.

**Note:** You can show contacts stored in your phone's memory or on your SIM card. To choose which entries you see, press  >  **Contacts**, then press **Options > View**.

You can select **Phone & SIM Card**, **SIM Card**, or **Phone Contacts**.

features
<b>assign a speed dial key to a contacts entry</b> You can assign the keys [1] to [9] to contacts entries. Then, when you press and hold a key, your phone calls the entry. <b>Note:</b> Your service provider might assign some keys, such as [1] for your voicemail number. Press <b>☎</b> > <b>☰</b> <b>Contacts</b> and scroll to the contacts entry. Then, press <b>Options</b> > <b>Add to Speed Dial</b> and pick a speed dial key.
<b>use the speed dial key for a contacts entry</b> To <b>use a speed dial key</b> that you assigned to a contacts entry, just press and hold the key while in your home screen.

features
<b>edit your speed dial keys</b> <b>☎</b> > <b>☰</b> <b>Contacts</b> , then press <b>Options</b> > <b>Manage Contacts</b> > <b>Speed Dial</b>
<b>choose a speed dial key list</b> You can set speed dial to call the entries in your phone memory contacts or your Fixed Dial list:  <b>☎</b> > <b>☰</b> <b>Settings</b> > <b>Initial Setup</b> > <b>Speed Dial</b> > <b>Phone Memory</b> or <b>Fixed Dial</b> .

features
<b>edit or delete a contacts entry</b> Edit a number stored in the contacts: <b>☎</b> > <b>☰</b> <b>Contacts</b> , scroll to the contacts entry, and press <b>Options</b> . You can select <b>Edit Contact</b> , <b>Delete Contact</b> , or other options. <b>Shortcut:</b> In the contacts, press keypad keys to enter the first letters of an entry you want. You can also press <b>[*]</b> and <b>[#]</b> to see the entries in your categories or entries you used recently.

features
<b>set ringer ID for a contacts entry</b> Assign a ring alert (ringer ID) to an entry: <b>☎</b> > <b>☰</b> <b>Contacts</b> > <i>entry</i> , then press <b>Options</b> > <b>Edit Contact</b> > <b>Ringer ID</b> > <i>ringer name</i> <b>Note:</b> The <b>Ringer ID</b> option isn't available for entries stored on the SIM card. To copy an entry from SIM to phone memory, see page 83. To activate ringer IDs: <b>☎</b> > <b>☰</b> <b>Settings</b> > <b>Ring Styles</b> > <i>style Detail</i> > <b>Ringer IDs</b> > <b>On</b>

features
<b>set picture ID for a contacts entry</b> Assign a photo or picture to show when you receive a call from an entry: <b>☎</b> > <b>☰</b> <b>Contacts</b> > <i>entry</i> , then press <b>Options</b> > <b>Edit Contact</b> > <b>Picture</b> > <i>picture name</i> <b>Note:</b> The <b>Picture</b> option isn't available for entries stored on the SIM card. To copy an entry from SIM to phone memory, see page 83.
<b>set category for a contacts entry</b> <b>☎</b> > <b>☰</b> <b>Contacts</b> > <i>entry</i> , then press <b>Options</b> > <b>Edit Contact</b> > <b>Category</b> > <i>category name</i> <b>Note:</b> The <b>Category</b> option isn't available for entries stored on the SIM card. To copy an entry from SIM to phone memory, see page 83. When you open your contacts, press <b>[*]</b> or <b>[#]</b> to see your categories.

features
<b>set category view for contacts</b> <b>☎</b> > <b>☰</b> <b>Contacts</b> , then press <b>Options</b> > <b>Filter by</b> > <b>Category</b> > <i>category name</i> You can show all entries, entries in a predefined category ( <b>Business</b> , <b>Personal</b> , <b>General</b> , <b>VIP</b> ), or entries in a category you create. <b>Shortcut:</b> When you open your contacts, press <b>[*]</b> or <b>[#]</b> to see your categories.
<b>create a new category</b> <b>☎</b> > <b>☰</b> <b>Contacts</b> , then press <b>Options</b> > <b>Manage Contacts</b> > <b>Edit Phone Categories</b> > <b>[New Category]</b> Enter the category name, and select its members from your contacts entries.

features
<b>edit a category</b> <b>☎</b> > <b>☰</b> <b>Contacts</b> , then press <b>Options</b> > <b>Manage Contacts</b> > <b>Edit Phone Categories</b> Scroll to the category name and press <b>Options</b> > <b>Edit Category</b> . You can edit the category name, members, ringer ID, or picture. Your phone uses the ringer ID and picture whenever you receive calls from numbers in the category.
<b>create group mailing list</b> You can put several contacts entries in a group mailing list, then send a message to the list. To create a list: <b>☎</b> > <b>☰</b> <b>Contacts</b> , then press <b>Options</b> > <b>Create New</b> > <b>Message List</b> <b>Note:</b> A <b>Message List</b> cannot include entries stored on the SIM card. To copy an entry from SIM to phone memory, see page 83.

features
<b>sort contacts list</b> Set the order in which entries are listed: <b>☎</b> > <b>☰</b> <b>Contacts</b> , then press <b>Options</b> > <b>Setup</b> > <b>Sort by</b> > <b>First Name</b> or <b>Last Name</b>
<b>copy one contacts entry</b> Copy an entry from the phone to the SIM card, or from the SIM card to the phone: <b>☎</b> > <b>☰</b> <b>Contacts</b> , scroll to the entry, press <b>Options</b> > <b>Copy to SIM Card</b> or <b>Copy to Phone</b>
<b>copy multiple contacts entries</b> Copy multiple contacts entries between the phone and SIM card: <b>☎</b> > <b>☰</b> <b>Contacts</b> , then press <b>Options</b> > <b>Select Multiple to</b> , and select <b>Copy Phone to SIM</b> or <b>Copy SIM to Phone</b>

features
<p><b>send contacts entry to another device</b></p> <p>Send a contacts entry to another phone, computer, or device:</p> <p>• &gt;  <b>Contacts</b>, scroll to the entry, press <b>Options</b> &gt; <b>Send Contact</b></p>
<p><b>print contacts entry over Bluetooth™ connection</b> </p> <p>You can use a Bluetooth wireless connection to send a contacts entry from your phone to a printer.</p> <p>• &gt;  <b>Contacts</b></p> <p>Scroll to the entry you want to print, and press <b>Options</b> &gt; <b>Print</b>.</p> <p>You cannot print a <b>Mailing List</b>. For more about Bluetooth connections, see page 33.</p>

## messages

For basic text message features, see page 46.

features
<p><b>send email</b> </p> <p>• &gt;  <b>Messages</b> &gt; <b>New Message</b> &gt; <b>New Email</b></p>
<p><b>send voice message</b> </p> <p>• &gt;  <b>Messages</b> &gt; <b>New Message</b> &gt; <b>New Voice Msg</b></p> <p>Your phone starts recording the voice message. To stop recording, press the <b>Stop</b> key. Your phone inserts the voice recording into a message and lets you enter email addresses or phone numbers of the recipients.</p>

features
<p><b>use a message template</b> </p> <p>• &gt;  <b>Messages</b> &gt; <b>Templates</b> &gt; <b>Text Templates</b> or <b>Multimedia Templates</b></p> <p>Select a template to create a new message based on the template.</p>
<p><b>read and manage messages</b> </p> <p>• &gt;  <b>Messages</b> &gt; <b>Message Inbox</b></p> <p>Icons next to each message indicate if it is read  or unread . Icons can also indicate if the message has an attachment , might be SPAM , or is locked , urgent , or low priority .</p> <p>To <b>Reply</b>, <b>Forward</b>, <b>Lock</b>, or <b>Delete</b> a message, scroll to it and press <b>Options</b>.</p> <p>To open a message, press •. Then, you can press <b>Options</b> to use or store any phone numbers, email addresses, Web sites, or files in the message.</p>

features
<p><b>read and manage email</b> </p> <p>• &gt;  <b>Messages</b> &gt; <b>Email Msgs</b></p> <p>To <b>Reply</b>, <b>Forward</b>, <b>Lock</b>, or <b>Delete</b> a message, scroll to it and press <b>Options</b>.</p> <p>To open a message, press •. Then, you can press <b>Options</b> to use or store any phone numbers, email addresses, Web sites, or files in the message.</p>
<p><b>store message objects</b> </p> <p>Go to a multimedia message page, or scroll to an object in a message, then:</p> <p><b>Options</b> &gt; <b>Store</b></p>

features
<p><b>print message over Bluetooth™ connection</b> </p> <p>You can use a Bluetooth wireless connection to send a message from your phone to a printer.</p> <p>• &gt;  <b>Messages</b> &gt; <b>Message Inbox</b>, <b>Email Msgs</b>, <b>Outbox</b>, or <b>Drafts</b></p> <p>Scroll to the message you want to print and press <b>Options</b> &gt; <b>Print</b>.</p> <p>You cannot print message <b>Templates</b>. For more about Bluetooth connections, see page 33.</p>



features
<p><b>store text messages on your SIM card</b> </p> <p>To store incoming text messages on your SIM card, press:</p> <p>• &gt;  <b>Messages</b>, then press <b>Options</b> &gt; <b>Setup</b> &gt; <b>Message Setup</b> &gt; <b>Text Msg Setup</b> &gt; <b>Default Storage</b> &gt; <b>SIM Card</b></p>

features
<p><b>edit email settings</b> </p> <p>You can edit the settings for your Email connections. To use email, you need to store your email <b>User ID</b> and <b>Password</b>.</p> <p>• &gt;  <b>Messages</b>, then press <b>Options</b> &gt; <b>Setup</b> &gt; <b>Email Msg Setup</b> &gt; <b>Account Settings</b></p> <p>If you have more than one email account, select an account to edit.</p> <p>Your phone shows a list of email settings. Here is where you store your email <b>User ID</b> and <b>Password</b>.</p> <p><b>Note:</b> To create a new account, select <b>[New Entry]</b> in the <b>Account Settings</b> list. Your display shows a folder for each email account under • &gt;  <b>Messages</b> &gt; <b>Email Msgs</b>.</p>





features
<p><b>browser messages</b> </p> <p>Read messages received by your micro-browser:</p> <p>• &gt;  <b>Messages</b> &gt; <b>Browser Msgs</b></p>
<p><b>info services</b> </p> <p>Read subscription-based information services messages:</p> <p>• &gt;  <b>Messages</b> &gt; <b>Info Services</b></p>

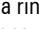



## instant messaging





features
<p><b>log in</b> </p> <p>• &gt;  <b>Tools</b> &gt; <b>IM</b></p> <p>Select an IM account to log in, or select <b>[New Account]</b> to set up an IM account.</p>



features
<p><b>log in automatically</b> </p> <p>• &gt;  <b>Tools</b> &gt; <b>IM</b>, press the <b>Options</b> key, then &gt; <b>Offline settings</b></p> <p>Turn on <b>Auto-Login</b> to start the IM login whenever you select • &gt; <b>IM</b>. Turn on <b>Power-on Login</b> to start the IM login whenever you turn on your phone.</p>
<p><b>set IM ring style</b> </p> <p>Select a ring or vibration for new IM messages and contact alerts.</p> <p>• &gt;  <b>Settings</b> &gt; <b>Ring Styles</b> &gt; <i>style Detail</i> &gt; <b>IM</b></p>

## personalising

features
<p><b>language</b></p> <p>Set menu language:</p> <p>• &gt;  <b>Settings</b> &gt; <b>Initial Setup</b> &gt; <b>Language</b></p>
<p><b>scroll</b></p> <p>Set the scroll bar to <b>Up/Down</b> or <b>Wrap Around</b> in menu lists:</p> <p>• &gt;  <b>Settings</b> &gt; <b>Initial Setup</b> &gt; <b>Scroll</b></p>
<p><b>text marquee</b> </p> <p>Set the speed for scrolling text in your display:</p> <p>• &gt;  <b>Settings</b> &gt; <b>Initial Setup</b> &gt; <b>Text Marquee</b></p>

features
<p><b>activate ringer IDs</b></p> <p>Activate ringer IDs assigned to contacts entries and categories:</p> <p>• &gt;  <b>Settings</b> &gt; <b>Ring Styles</b> &gt; <i>style Detail</i> &gt; <b>Ringer IDs</b></p>
<p><b>ring volume</b></p> <p>• &gt;  <b>Settings</b> &gt; <b>Ring Styles</b> &gt; <i>style Detail</i> &gt; <b>Ring Volume</b></p>
<p><b>keypad volume</b></p> <p>• &gt;  <b>Settings</b> &gt; <b>Ring Styles</b> &gt; <i>style Detail</i> &gt; <b>Key Volume</b></p>
<p><b>reminders</b></p> <p>Set a reminder for when you have not responded to an incoming call, message, or other event:</p> <p>• &gt;  <b>Settings</b> &gt; <b>Ring Styles</b> &gt; <i>style Detail</i> &gt; <b>Reminders</b></p>

features
<p><b>menu view</b></p> <p>Show the main menu as graphic icons or as a text-based list:</p> <p>• &gt;  <b>Settings</b> &gt; <b>Personalise</b> &gt; <b>Main Menu</b> &gt; <b>View</b></p>
<p><b>main menu</b></p> <p>Reorder your phone's main menu:</p> <p>• &gt;  <b>Settings</b> &gt; <b>Personalise</b> &gt; <b>Main Menu</b> &gt; <b>Reorder</b></p>
<p><b>show/hide menu icons</b> </p> <p>Show or hide menu feature icons in the home screen:</p> <p>• &gt;  <b>Settings</b> &gt; <b>Personalise</b> &gt; <b>Home screen</b> &gt; <b>Home Keys</b> &gt; <b>Icons</b></p>

features
<p><b>change home keys</b> </p> <p>Change features for the soft keys, navigation key, and smart key in the home screen:</p> <p>• &gt;  <b>Settings</b> &gt; <b>Personalise</b> &gt; <b>Home screen</b> &gt; <b>Home Keys</b></p>
<p><b>master reset</b></p> <p>Reset all options <b>except</b> unlock code, security code, and lifetime timer:</p> <p>• &gt;  <b>Settings</b> &gt; <b>Initial Setup</b> &gt; <b>Master Reset</b></p>







features
<p><b>master clear</b></p> <p><b>Caution:</b> Master clear <b>erases all information you have entered</b> (including contacts and datebook entries) <b>and content you have downloaded</b> (including photos and sounds) stored in your phone's memory. After you erase the information, you can't recover it.</p> <p>• &gt;  <b>Settings</b> &gt; <b>Initial Setup</b> &gt; <b>Master Clear</b></p>

## call times & costs

**Network connection time** is the elapsed time from the moment you connect to your service provider's network to the moment you end the call by pressing . This time includes busy signals and ringing.

**The amount of network connection time you track on your resettable timer may not equal**



**the amount of time for which you are billed by your service provider. For billing information, contact your service provider.**

features
<p><b>call times</b> </p> <p>Show call timers:</p> <p>• &gt;  <b>Recent Calls</b>, press the <b>Options</b> key, then &gt; <b>Call Times</b></p>
<p><b>in-call timer</b> </p> <p>Show time or cost information during a call:</p> <p>• &gt;  <b>Settings</b> &gt; <b>In-Call Setup</b> &gt; <b>In-Call Timer</b></p>
<p><b>call cost</b> </p> <p>Show call cost trackers:</p> <p>• &gt;  <b>Recent Calls</b>, press the <b>Options</b> key, then &gt; <b>Call Cost</b></p>

## handsfree





**Note:** The use of wireless phones while driving may cause distraction. Discontinue a call if you can't concentrate on driving. Additionally, the use of wireless devices and their accessories may be prohibited or restricted in certain areas. Always obey the laws and regulations on the use of these products.

features
<p><b>speakerphone</b> </p> <p>Activate the speakerphone during a call:</p> <p>Press the <b>Speaker</b> key (if available), or <b>Options</b> &gt; <b>Spkrphone On</b>.</p>

features
<b>auto answer</b> (car kit or headset)  Automatically answer calls when connected to a car kit or headset: • > ⚙ Settings > Car Settings or Headset > Auto Answer
<b>voice dial</b> (headset)  Enable voice dial with headset send/end key: • > ⚙ Settings > Headset > Voice Dial
<b>auto handsfree</b> (car kit)  Automatically route calls to a car kit when connected: • > ⚙ Settings > Car Settings > Auto Handsfree

## data calls

To connect your phone with a USB cable, see page 50.

features
<b>send data</b>  Connect your phone to the device, then place the call through the device application.
<b>receive data or fax</b>  Connect your phone to the device, then answer the call through the device application.
<b>talk then fax</b>  Connect your phone to the device, enter fax number, press <b>Options</b> > <b>Talk then Fax</b> , then press  to make the call.

features
<b>set up Exchange ActiveSync</b>  You can use the Internet to synchronise your phone's contacts and datebook entries with an email account on a Microsoft® Exchange 2003 Server. You need to know the email account's <b>user name</b> and <b>password</b> , the Microsoft® Exchange <b>server name</b> , and the <b>user domain name</b> . Confirm that the <b>Mobility</b> option is enabled on the email account, and that <b>data service</b> is activated with your phone service provider. To <b>set up</b> an ActiveSync partner, press • > ☎ Connection > MOTOSYNC > Exchange, press the <b>Options</b> key, then > <b>Setup</b> . Enter the server details, including <b>Server Name</b> , <b>Domain</b> , and the <b>Web Session</b> to use. To set up a <b>Web Session</b> , see page 99.

features
<b>use Exchange ActiveSync</b>  Once you set up an Exchange ActiveSync partner, you can schedule your phone to synchronise with the account automatically. To <b>schedule</b> synchronisation, press • > ☎ Connection > MOTOSYNC > Exchange, press the <b>Options</b> key, then > <b>Auto Sync Setup</b> . Enter the time and days you want your phone to synchronise.

## network

features
<b>network settings</b>  See network information and adjust network settings: • > ⚙ Settings > Network

92 other features—data calls

other features—network 93

features
<b>software update</b>  Your service provider can send updated phone software over the air to your phone. When your phone receives a software update, you can choose to download it and install it later. To install a software update you downloaded: • > ⚙ Settings > Phone Status > Software Update > Update Now

## personal organiser

features
<b>set alarm</b> • > ⚙ Tools > Alarm Clock

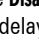
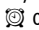
features
<b>turn off alarm</b> When an alarm happens: To turn off the alarm, press the <b>Disable</b> key or  . To set an eight-minute delay, press the <b>Snooze</b> key. <b>Note:</b> The <b>Snooze</b> key is available only if the phone is already powered on when the alarm sounds.
<b>add new datebook event</b> • > ⚙ Tools > Datebook, scroll to the day, press •, scroll to <b>Create New Event</b> , and press •.
If you set a reminder for a datebook event,  can appear at the top of your screen.

features
<b>see datebook event</b> See or edit event details: • > ⚙ Tools > Datebook, scroll to the day, and press •. Scroll to the event and press •. To edit the details, press <b>Options</b> > <b>Edit</b> . <b>Tip:</b> Keeping up with life can be tough work. To see a list of your upcoming events, open the datebook and press <b>Options</b> > <b>View</b> > <b>Organised Events</b> .
<b>event reminder</b> When an event reminder happens: To see reminder details, press the <b>View</b> key. To close the reminder, press the <b>Exit</b> key.

features
<b>send datebook event to another device</b> Send a datebook event to another phone, computer, or device: • > ⚙ Tools > Datebook, scroll to the day, press •, scroll to the event, press <b>Options</b> > <b>Send</b> > <b>with Bluetooth</b>
<b>print datebook month, week, or day over Bluetooth™ connection</b>  You can use a Bluetooth wireless connection to send a datebook month, week, or day from your phone to a printer. • > ⚙ Tools > Datebook Go to the month, week, or day view and press <b>Options</b> > <b>Print</b> . For more about Bluetooth connections, see page 33.

94 other features—personal organiser

other features—personal organiser 95



features
<p><b>create voice record</b></p> <p>☛ &gt;  <b>Multimedia</b> &gt; <b>Voice Record</b></p> <p>Press ☛. When prompted, speak into the phone.</p> <p><b>Note:</b> Recording phone calls is subject to varying Laws regarding privacy and recording of conversations. Always obey the laws and regulations on the use of this feature.</p>
<p><b>play voice record</b></p> <p>Play back a voice record:</p> <p>☛ &gt;  <b>Multimedia</b> &gt; <b>Sounds</b>, scroll to the voice record, and press the <i>centre key</i> ☛.</p>
<p><b>calculator</b></p> <p>☛ &gt;  <b>Tools</b> &gt; <b>Calculator</b></p>

features
<p><b>currency converter</b></p> <p>☛ &gt;  <b>Tools</b> &gt; <b>Calculator</b>, then press <b>Options</b> &gt; <b>Exchange Rate</b></p> <p>Enter exchange rate, press the <b>Ok</b> key, enter amount, and press <b>Options</b> &gt; <b>Convert Currency</b>.</p>

## security

features
<p><b>SIM PIN</b></p> <p><b>Caution:</b> If you enter an incorrect PIN code three times before the correct code, your SIM card is disabled and your display shows <b>SIM Blocked</b>.</p> <p>Lock or unlock the SIM card:</p> <p>☛ &gt;  <b>Settings</b> &gt; <b>Security</b> &gt; <b>SIM PIN</b></p>

96 other features—security

features
<p><b>delete or manage sound files</b></p> <p>☛ &gt;  <b>Multimedia</b> &gt; <b>Sounds</b></p> <p>To <b>delete</b> a file, scroll to it in the list and press <b>Options</b> &gt; <b>Manage</b> &gt; <b>Delete</b>.</p> <p>To <b>copy or move</b> a file from your memory card () to your phone memory () or vice versa, scroll to it in the list and press <b>Options</b> &gt; <b>Manage</b> &gt; <b>Copy</b> or <b>Move</b> &gt; <b>Phone</b>. You cannot copy or move some copyrighted files.</p>
<p><b>create ring tones</b></p> <p>Create ring tones that you can use with your phone:</p> <p>☛ &gt;  <b>Multimedia</b> &gt; <b>Sounds</b> &gt; <b>[New Melody]</b></p>
<p><b>start micro-browser</b></p> <p>Press ☛ &gt;  <b>WebAccess</b> &gt; <b>Browser</b>.</p>

features
<p><b>download objects from Web page</b> </p> <p>Download a picture, sound, or other object from a Web page:</p> <p>Press ☛ &gt;  <b>WebAccess</b> &gt; <b>Browser</b>, go to the page that links to the file, scroll to the link, and select it. Follow the same steps to use Progressive Downloading and Video Streaming.</p> <p>To activate downloaded copyrighted files, press ☛ &gt;  <b>Tools</b> &gt; <b>Activation List</b> &gt; <i>file type</i> &gt; <i>file</i>. You can see file's <b>Status</b>, <b>Type</b>, <b>Activation</b>, and <b>999 Remaining</b>.</p>

98 other features—fun & games

features
<p><b>lock feature</b></p> <p>☛ &gt;  <b>Settings</b> &gt; <b>Security</b> &gt; <b>Lock Application</b></p>
<p><b>manage certificates</b> </p> <p>Enable or disable Internet access certificates stored on your phone:</p> <p>☛ &gt;  <b>Settings</b> &gt; <b>Security</b> &gt; <b>Certificate Mgmt</b></p> <p>Certificates are used to verify the identity and security of Web sites when you download files or share information.</p>

## fun & games

For basic information on the camera, see page 41.

features
<p><b>listen to sound files</b></p> <p>☛ &gt;  <b>Multimedia</b> &gt; <b>Sounds</b></p> <p>Scroll to a file and select it to listen.</p> <p><b>Note:</b> Your phone cannot receive PTT calls or data over an EDGE network while it is playing some sound files. Indicators appear at the top of your display when you can receive PTT  or EDGE  data.</p>

other features—fun & games 97

features
<p><b>store downloaded files in your phone or memory card</b></p> <p>You can choose to store your downloaded files on your phone or your memory card you download choose where to store the files you download:</p> <p>☛ &gt;  <b>Settings</b> &gt; <b>Phone Status</b> &gt; <b>Download Location</b> &gt; <b>Memory Card</b> or <b>Phone</b></p> <p>To see how much memory is available on your phone or memory card, see page 49.</p>
<p><b>Web sessions</b> </p> <p>A <i>Web Session</i> stores settings that your phone uses to access the Internet. To select or create a Web session:</p> <p>☛ &gt;  <b>WebAccess</b> &gt; <b>Web Sessions</b></p>

features
<p><b>clear micro-browser history</b> </p> <p>Clear the micro-browser's history, cache, or cookies:</p> <p>☛ &gt;  <b>WebAccess</b> &gt; <b>Browser Setup</b> &gt; <b>Clear History</b>, <b>Reset Cache</b>, or <b>Clear Cookies</b></p>
<p><b>download game or application</b> </p> <p>You can download a Java™ game or application the same way you download pictures or other objects:</p> <p>Press ☛ &gt;  <b>WebAccess</b> &gt; <b>Browser</b>, go to the page that links to the file, scroll to the link, and select it.</p>

other features—fun & games 99

## features

### start game or application



Start a Java™ game or application:

•• >  **Games & Apps**, scroll to the game or application, press the *centre key* ••

**Note:** To install and run games stored on your memory card, press •• >  **Games & Apps** > **[Install New]**.

## Specific Absorption Rate Data

---

### **This model meets international guidelines for exposure to radio waves.**

Your mobile device is a radio transmitter and receiver. It is designed not to exceed the limits for exposure to radio waves recommended by international guidelines. These guidelines were developed by the independent scientific organization ICNIRP and include safety margins designed to assure the protection of all persons, regardless of age and health.

The guidelines use a unit of measurement known as the Specific Absorption Rate, or SAR. The ICNIRP SAR limit for mobile devices used by the general public is 2 W/kg and the highest SAR value for this device when tested at the ear was 1.02 W/kg.<sup>1</sup> As

mobile devices offer a range of functions, they can be used in other positions, such as on the body as described in this user guide.<sup>2</sup> In this case, the highest tested SAR value is 0.68 W/kg.<sup>1</sup>

As SAR is measured utilising the device's highest transmitting power, the actual SAR of this device while operating is typically below that indicated above. This is due to automatic changes to the power level of the device to ensure it only uses the minimum level required to reach the network.

While there may be differences between the SAR levels of various phones and at various positions, they all meet the governmental requirements for safe exposure. Please note that improvements to this product model could cause differences in the SAR value for later products; in all cases, products are designed to be within the guidelines.

The World Health Organization has stated that present scientific information does not indicate the need for any special precautions for the use of mobile devices. They note that if you want to reduce your exposure then you can do so by limiting the length of calls or using a "hands-free" device to keep the mobile phone away from the head and body.

Additional Information can be found on the websites of the World Health Organization (<http://www.who.int/emf>) or Motorola, Inc. (<http://www.motorola.com/rfhealth>).

- 
1. The tests are carried out in accordance with international guidelines for testing. The limit incorporates a substantial margin for safety to give additional protection for the public and to account for any variations in measurements. Additional related information includes the Motorola testing protocol, assessment procedure, and measurement uncertainty range for this product.
  2. Please see the Safety and General Information section about body worn operation.

## Information from the World Health Organisation

---

Present scientific information does not indicate the need for any special precautions for the use of mobile phones. If you are concerned, you may want to limit your own or your children's RF exposure by limiting the length of calls or by using handsfree devices to keep mobile phones away from your head and body.

Source: WHO Fact Sheet 193

Further information:  
<http://www.who.int./peh-emf>

# index

---

## A

accessories 21, 91  
accessory connector port 1  
activation list 98  
active line indicator 55  
active line, changing 78  
ActiveSync 93  
aeroplane mode 67  
alarm clock 94  
alert  
  set 60, 67, 68  
  turn off 60, 71  
answer a call 25, 70  
attach a number 72, 76  
audio player 37

## 104 index

Incoming Call message 74  
information services 87  
instant messaging. See IM  
international access code 77  
iTAP text entry mode 58

## J

Java applications 99  
Java indicator 55

## K

keypad 66, 89

## L

language 88  
linking. See Bluetooth  
  connection  
lock  
  application 97  
  keypad 66  
  phone 65

## 106 index

## B

backlight 70  
battery 22, 23  
  extending battery life 23  
battery indicator 56  
battery life, extending 69, 70  
Bluetooth connection  
  contacts entries 84  
  datebook entry, printing  
  95  
  datebook entry, sending  
  95  
  description 33  
  messages, printing 86  
blur photo setting 43  
brightness 70  
browser messages 87  
browser. See micro-browser

SIM card 96  
Low Battery message 56

## M

make a call 25  
master clear 90  
master reset 90  
memory card 48, 49  
menu 2, 21, 53, 88, 89  
menu icons 53, 89, 90  
message 84, 85, 86  
message indicator 47, 55  
message reminders 89  
micro-browser 87, 98, 99  
mirror photo setting 43  
Missed Calls message 73  
MMS, defined 46  
Motorola SETUP 27  
MOTOSYNC 93  
MP3 sound files 37, 38  
multimedia message 46, 85,  
  86

## C

cables 50  
calculator 96  
call  
  answering 25, 70  
  barring 78  
  diverting 78  
  end 25  
  making 25  
  timers 91  
  waiting 77  
call divert indicator 55  
caller ID 72, 74, 82  
camera 41  
car kit 91  
categories 82, 83  
centre key 1, 61  
centre select key 21

music 97, 98  
mute a call 77

## N

navigation key 1, 21, 61  
network settings 93  
notepad 76  
number. See phone number  
numeric entry mode 60

## O

object exchange 35  
1-touch dial 80  
optional accessory 21  
optional feature 21

## P

pairing. See Bluetooth  
  connection  
passwords. See codes  
personalise 88

certificate management 97  
clock 68  
codes 65  
conference call 78  
contacts 72, 76, 79, 80  
copy files 35  
copyrighted files, activating  
  98  
costs, tracking 91

## D

data call 92  
data indicator 54  
date, setting 68  
datebook 94, 95  
delayed answer 71  
dial a phone number 25, 79  
dialled calls 71  
digital audio 37  
display 2, 53, 70  
divert calls 78  
downloaded files

phone number 26, 78  
photo 41, 43  
picture ID 74, 82  
PIN code 25, 65, 96  
PIN2 code 65  
power key 1, 25  
printing 36  
PTT 28  
  calls, answering 29  
  calls, making 28  
  contacts and groups 30  
  icons 31  
  indicator 55  
  Quick Groups 28  
  sending pictures 30  
  settings 32  
  turning on or off 32  
PTV 30  
Push to Talk. See PTT

## Q

quick dial 79

activating 98  
  from Web pages 98  
  in messages 85  
  storage location 99  
drafts folder 47  
DTMF tones 72, 79

## E

earpiece volume 60  
EDGE indicator 54  
email  
  reading and managing 85  
  sending 84  
  settings 87  
emergency number 74  
end a call 25  
end key 1, 25  
Enter Unlock Code message  
  65

## R

radio 39  
received calls 71  
recent calls 71  
redial 73  
reminders 89  
restrict calls 78  
return a call 73  
ring style indicator 56  
ring style, setting 60, 67  
ring tone 97, 98  
ringer ID 74, 81, 89  
ringer volume 60, 89  
roam indicator 55

## S

screen saver 69  
scrolling 88  
security code 65  
send key 1, 25  
signal strength indicator 54

## F

fax call 72, 92  
fixed dial 79  
FM radio 39

## G

games 99  
GPRS indicator 54  
group mailing list 83

## H

handsfree speaker 64  
headset 91  
headset jack 1  
hold a call 77  
home screen 2, 53, 89, 90

## I

IM 87  
IM indicators 55  
in-call indicator 55

## index 105

silent answer 71  
SIM Blocked message 24, 96  
SIM card 21, 25, 65, 86, 96  
skin 70  
smart key 61, 90  
soft keys 1, 53, 90  
software update 94  
speakerphone 91  
speed dial 80  
store your number 26  
symbol entry mode 60  
synchronising 93

## T

tap text entry mode 59  
telephone number. See  
  phone number  
text entry 56  
text marquee 88  
text message 85, 86  
time zone 68  
time, setting 68

## index 107

timers 91  
transfer a call 78  
turn on/off 24

## U

unlock  
    application 97  
    keypad 66  
    phone 25, 65  
    SIM card 96  
unlock code 65  
USB cables 50

## V

video clip 46  
videos 45  
voice commands 61  
voice dial 61, 92  
voice message 84  
voice record 96  
voicemail 74

**108** index

voicemail message indicator  
    55, 75  
volume 60, 89

## W

wallpaper 69  
Web pages 98  
Web sessions 99  
WHO information 103

## Y

your phone number 26

6803563F08