Service Manual

Horizontal Freezer

S 40/08

Model	S 40/08	
Version	8507 946 71000	Page
	Technical data	2
	Spare part list	3
	Exploded view	4
	Circuit and Wiring diagram	5

Technical data

Dimensions

Height	88.4	cm
Width	112	cm
Depth	64.2	cm

Capacity

gross	390	l
-------	-----	---

Electrical connection

Voltage	220 - 240	V
Frequency	50	Hz

Compressor

Type	B 1119 Z	
Capacity (CECOMAF)	130	W

Refrigerant

Type	R 134 a	
Quantity	145	g

Thermostat switching value

Switch on temperature min.	- 14	°C
Switch on temperature max.	- 23.5	°C
Switch off temperature min.	- 20	°C
Switch off temperature max.	- 29.5	°C

Spare part list

Model S 40/08
Service No. 850794671000
Version 850794671000

Pos. No.	12NC Code	Description	from	to
012 0	4819 528 78036	Foot		
040 0	4819 417 19607	Hinge		
040 7	4819 462 58187	Cover,hinge		
040 8	4819 462 58354	Cover,hinge		
070 7	4819 458 58384	Grid,air		
101 0	4819 442 69321	Door,freezer		
111 0	4819 498 78301	Handle		
111 1	4819 462 79907	Cover		
111 2	4819 462 79908	Cover		
130 2	4819 417 38023	Lock		
130 3	4819 401 18332	Hook		
130 5	4819 462 79912	Cover		
130 6	4819 404 49425	Bracket		
191 4	4819 468 18201	Gasket		
204 3	4819 442 78199	Separator		
241 0	4819 458 68203	Basket		
252 0	4819 464 18155	Casing		
301 0	4819 459 48842	Frame		
321 0	4819 381 18108	Lens red		
321 1	4819 381 18246	Lens		
335 0	4819 411 28789	Knob thermostat		
350 0	4819 134 48513	Pilot lamp		
402 0	4819 360 38615	Compressor B 1119 Z		
442 0	4819 361 78227	Propeller,motor		
442 1	4819 404 79496	Bracket		
443 0	4819 515 38001	Fan wheel 220V		
491 0	4819 462 79046	Lid f. connection block		
561 0	4819 282 28594	Protect,motor		
561 2	4819 290 68198	Connectionblock		
566 2	4819 271 28766	Thermostat A 1082 R4523		
614 0	4819 280 68047	Service relay		
740 0	4819 511 48648	Condenser		
740 4	4819 404 49922	Bracket		
764 0	4819 480 28144	Dryer		
781 0	4819 462 48421	Panel		
934 2	4819 492 68431	Spring		

Exploded view

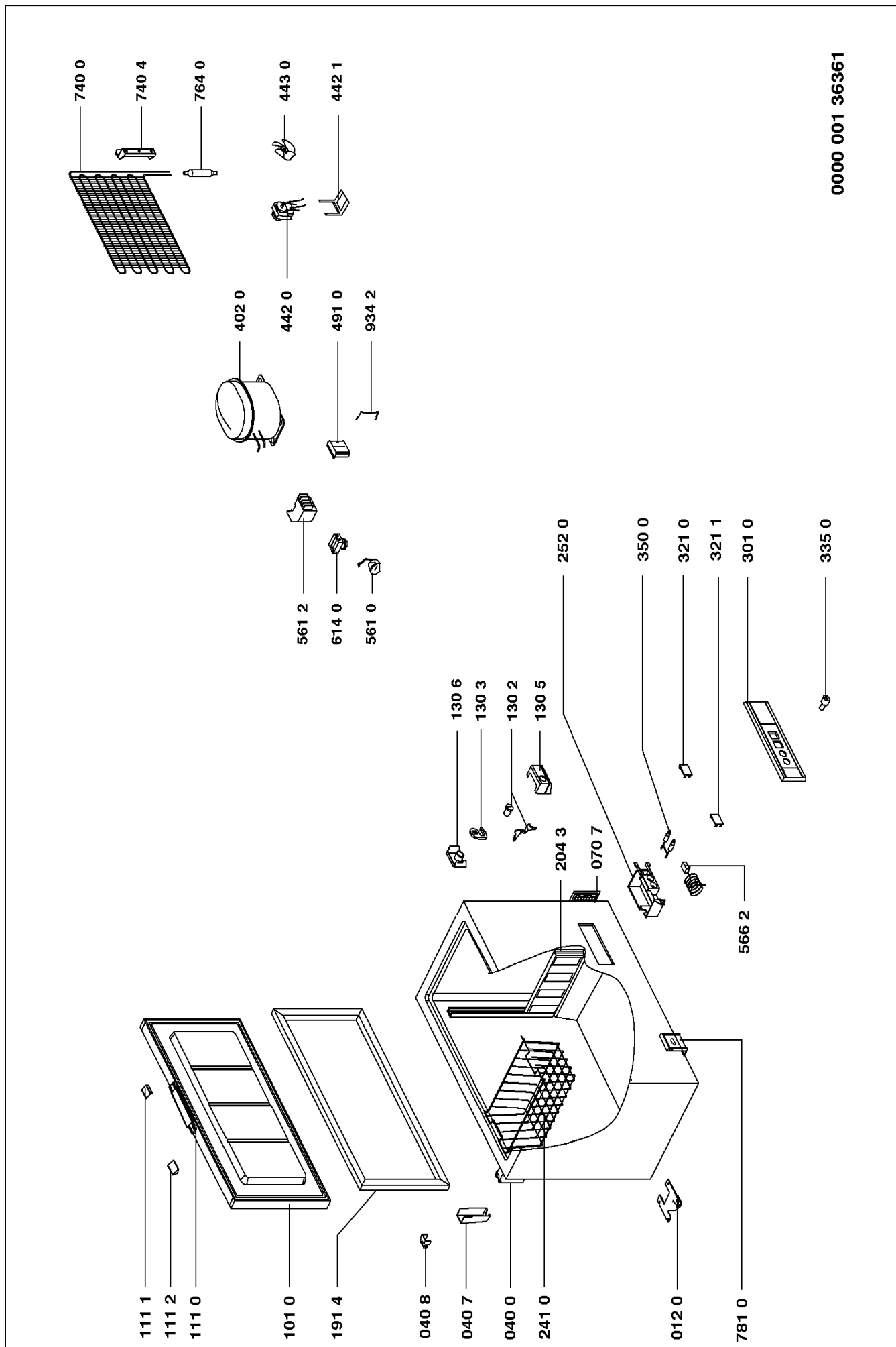

0000 001 36361

Circuit and Wiring diagram

