

JUKI®

COMPUTER SEWING MACHINE

HZL-G Series

SERVICE MANUAL

6-2 Adjusting the needle entry point

- Remove the face cover.

Adjustment procedure

1. Select the straight stitch using the pattern selecting button. Choose center needle position.
2. Assemble a needle #14 into the needle bar, loosen the setscrew in the eccentric collar and adjust the feed bar eccentric collar so that the needle meets the center of the needle slot in the throat plate when it reaches the top face of the throat plate by turning the hand wheel.

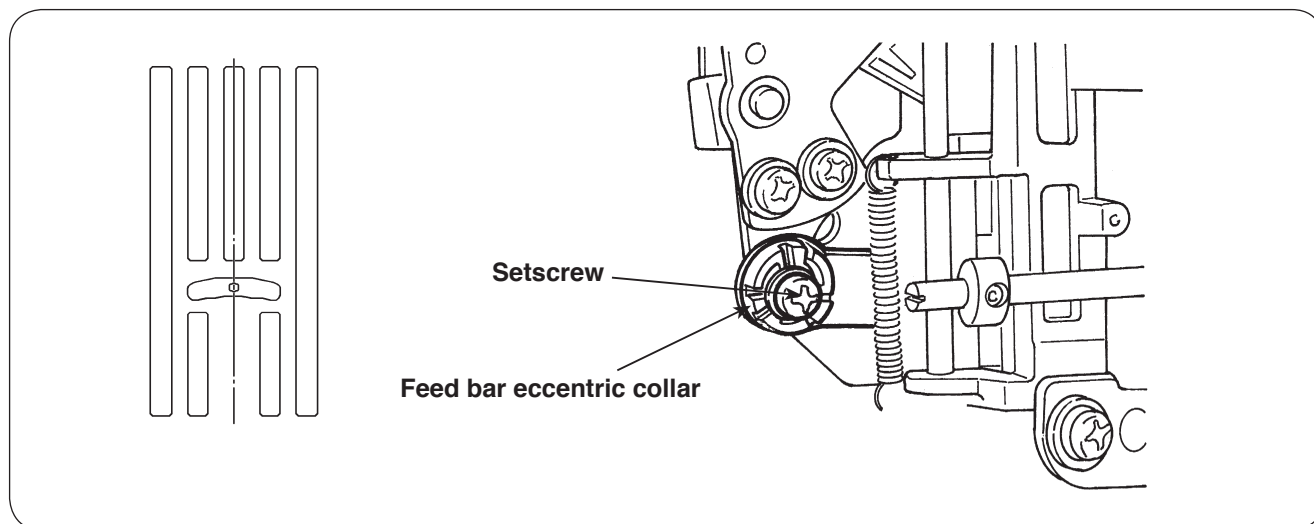

6-3 Feed dog height

- Do not remove the throat plate.

Adjustment procedure

1. Set the amount of feed to 0 (zero).
2. Turn the hand wheel to bring the feed dog to its highest dead point.
3. Using a tapered-head slotted screwdriver, turn shaft a on the left side and shaft b on the right side.
4. Adjust the feed dog height so that the front and rear ends of the feed dog are spaced 1.0 ± 0.1 mm from the throat plate surface. Adjust the rear end height of the feed dog with shaft a, and front end height with shaft b.

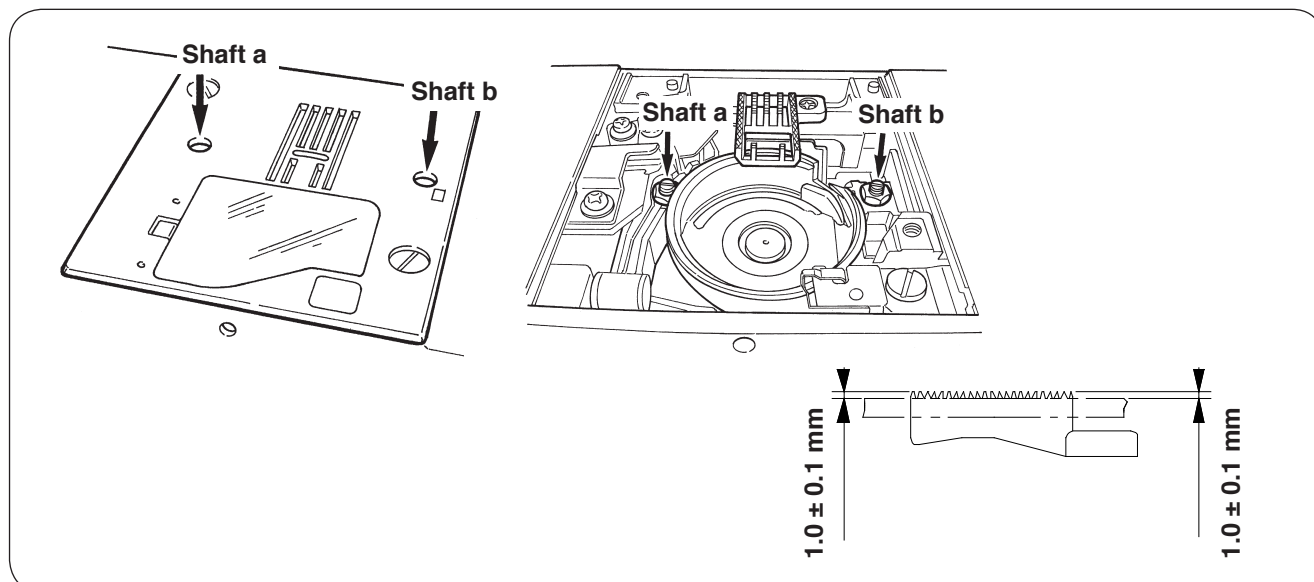

CONTENTS

| | |
|---|----|
| [1] Specifications of HZL-G Series | 1 |
| [2] Search by trouble (related to mechanical components) | 3 |
| [3] Principal parts | 4 |
| [4] Disassembling the machine covers | 5 |
| [5] PCB connection diagram | 9 |
| [6] Adjustment | 13 |
| 6-1 Adjusting the needle bar height | 13 |
| 6-2 Adjusting the needle entry point | 14 |
| 6-3 Feed dog height | 14 |
| 6-4 Timing belt | 15 |
| 6-5 Feed timing | 15 |
| 6-6 Timing between the needle and the hook | 16 |
| 6-7 Clearance between the needle and the blade point of hook | 17 |
| 6-8 Position of the hook rotation stopper plate | 18 |
| 6-9 Adjusting the bobbin thread tension | 18 |
| 6-10 Adjusting the disk opening amount | 19 |
| 6-10-1 Adjusting the tension release adjusting plate | 19 |
| 6-10-2 Tension disk opening amount | 19 |
| 6-10-3 Base tension opening amount | 20 |
| 6-10-4 Adjusting the disk opening amount at the time of thread trimming (HZL-G210) | 21 |
| 6-11 Adjusting the needle thread tension | 21 |
| 6-12 Vertical position of the needle threading hook | 22 |
| 6-13 Adjusting the presser foot lifting switch | 23 |
| 6-14 Adjusting the presser bar height | 23 |
| 6-15 Motor belt | 24 |
| 6-16 Automatic thread trimming (HZL-G210) | 25 |
| 6-16-1 Lateral position of the thread trimming mechanism base | 25 |
| 6-16-2 Phase of the catching unit driving cam | 26 |
| 6-16-3 Replacing the thread trimming blade | 27 |
| 6-17 Longitudinal feed | 28 |
| 6-18 Buttonhole | 29 |
| 6-19 Service mode | 30 |
| 6-20-1 Service mode screen | 30 |
| 5-20-2 Service-mode items and descriptions | 30 |



CAUTION:

Be sure to observe the following to protect against a fire, electrical shock, injury or damaged components.

- * Be sure to unplug the machine before disassembly, assembly or adjustment of the machine.
- * Be sure to carefully prevent electric cords from being caught, coated surfaces from being damaged as well as wrong wiring during assembly.
- * Be sure to use the proper genuine parts when changing any of the machine parts.

[1] Specifications of HZL-G Series

(1) Power switch

- 220-240V AC common to 50/60 Hz
- 120V AC common to 60 Hz

(2) Power consumption

- 65 W

(3) Dimensions and weight

- Dimensions Main unit: 445 (width) x 210 (depth) x 290.5 (height) (mm)
 Case set: 510 (width) x 257 (depth) x 305 (height) (mm)
- Weight Main unit: G210 9.4 kg G110 8.9 kg

(4) Revolution control

- Slide style speed control
 - Straight stitch 80 ~ 900 sti/min (SPM)
 - Pattern stitch 80 ~ 750 sti/min (SPM)
 - Reverse stitch 80 ~ 110 sti/min (SPM)
 80 ~ 900 sti/min (SPM) (when the speed controller is used)
 - Bobbin winding 1500 ~ 3000 sti/min (RPM)
 - Low-speed start 80 ~ 110 sti/min (SPM) (approx. 1 second only when the power switch is turned ON)
- Foot controller
 - Even when the foot controller is used, the speed control function by means of the slider is effective.
 - To stop the machine, either release the foot controller or press start/stop button.
 - The number of revolutions is controlled in the way same with the case of the slide speed control.
 - Thread trimming switch (Press heel side of foot controller.)
- Safety control
 - When the motor shaft of the sewing machine is accidentally constrained, the power supply to the motor is stopped within two seconds.
 - When the motor is overheated, the built in thermal switch stops the power to the motor.
 - Note that the machine can be restarted once the motor spontaneously cools down.

(5) Stop position

- Upon finishing sewing, the machine stops according to the preset needle stop position (with its needle up or down).
- Upon finishing reverse stitching, the machine stops with its needle down.
- In the case the machine is started with the presser foot lifting lever raised, the machine stops with its needle up.
- Needle moves down when the machine has preset so that the needle stops at its up position and needle up/down button is pressed.
- Needle moves up when the machine has preset so that the needle stops at its down position and needle up/down button is pressed.
- In the case of fault, the machine stops immediately (stop position varies).

(6) Zigzag width

- Max. 7 mm depending on the pattern selected

(7) Amount of feed

- The amount of feed is changed in increments of 0.2 mm by the stitch length adjusting dial.
(For the parallel parts of a buttonhole and satin stitches, the amount feed is changed in increments of 0.1 mm.)
Default setting: 2.4 mm (for straight stitching)

(8) Pattern selection

- Selection of three different kinds of patterns; Selection of number shifts
- Segment type LCD

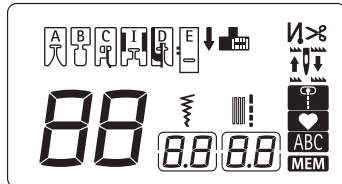

(9) Number of patterns

- 180

(10) Automatic threading device

- The hook section makes a turn by lowering the threading lever, and automatically returns to its original position after completion of threading.

(11) Automatic lock stitch

When the backtacking switch is turned ON:

- Straight stitch: Three stitches are sewn in normal direction and three stitches are sewn in reverse direction at the beginning and end (the reverse switch is turned ON) of sewing.
Amount of feed: Same with the preset amount of feed
- Other patterns: Zero-feed is inserted and one each stitch is sewn in the normal and reverse directions at the beginning and end (the reverse switch is turned ON) of sewing.
Amount of feed: Fixed at 0.6 mm

(12) Buttonholing

Auto-return type full automatic buttonholing

Buttonholing size detection

[2] Search by trouble (related to mechanical components)

| Phenomenon | Item to be checked |
|--|---|
| Faulty thread tension | 6-8: Position of the hook rotation stopper plate 6-9: Adjusting the bobbin thread tension 6-10-2: Tension disk opening amount 6-10-3: Base tension opening amount 6-11: Adjusting the needle thread tension |
| Stitch skipping | 6-1: Adjusting the needle bar height 6-2: Adjusting the needle entry point 6-5: Feed timing 6-6: Timing between the needle and the hook 6-7: Clearance between the needle and the blade point of hook |
| Thread breakage | 6-1: Adjusting the needle bar height 6-6: Timing between the needle and the hook 6-8: Position of the hook rotation stopper plate |
| Hitch stitch | 6-2: Adjusting the needle entry point |
| Faulty material feed | 6-3: Feed dog height 6-14: Adjusting the presser bar height |
| Contact between needle and throat plate or hook. | 6-2: Adjusting the needle entry point 6-5: Feed timing 6-6: Timing between the needle and the hook |
| Faulty pattern shape | 6-3: Feed dog height 6-17: Longitudinal feed |
| Faulty automatic thread trimming | 6-10-4: Adjusting the disk opening amount at the time of thread trimming 6-16-1: Lateral position of the thread trimming mechanism base 6-16-2: Phase of the catching unit driving cam 6-16-3: Replacing the thread trimming blade |
| Faulty operating noise | 6-4: Timing belt 6-15: Motor belt |
| Fault buttonholing | 6-18: Buttonhole |
| Needle threader | 6-12: Vertical position of the needle threading hook |
| Fails to start sewing | 6-13: Adjusting the presser foot lifting switch |

[3] Principal parts

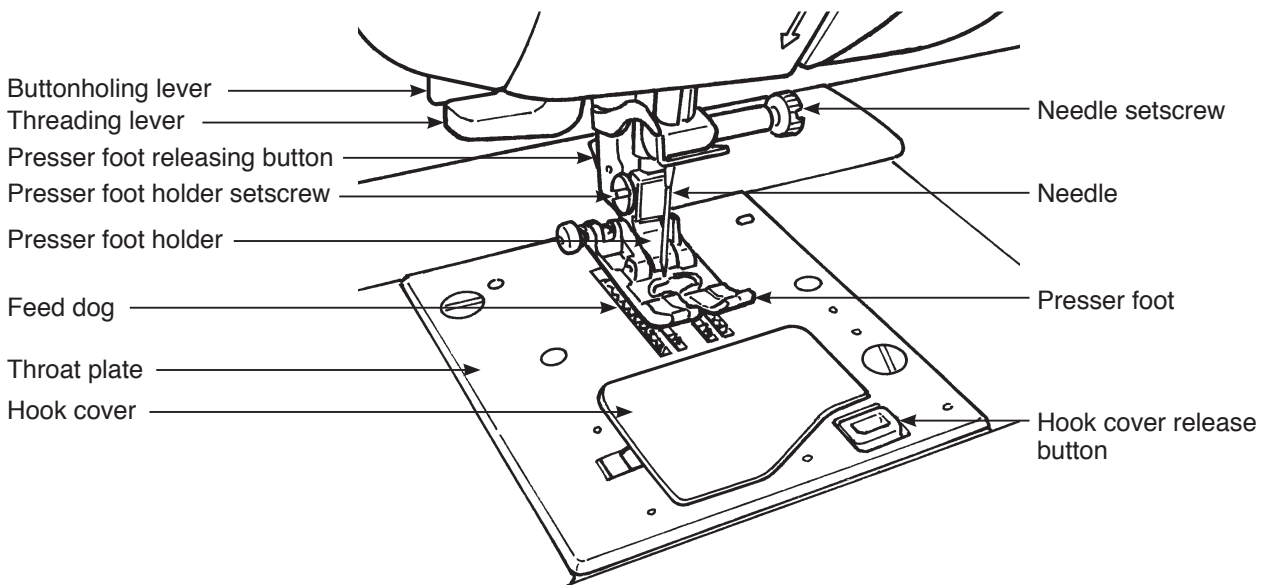
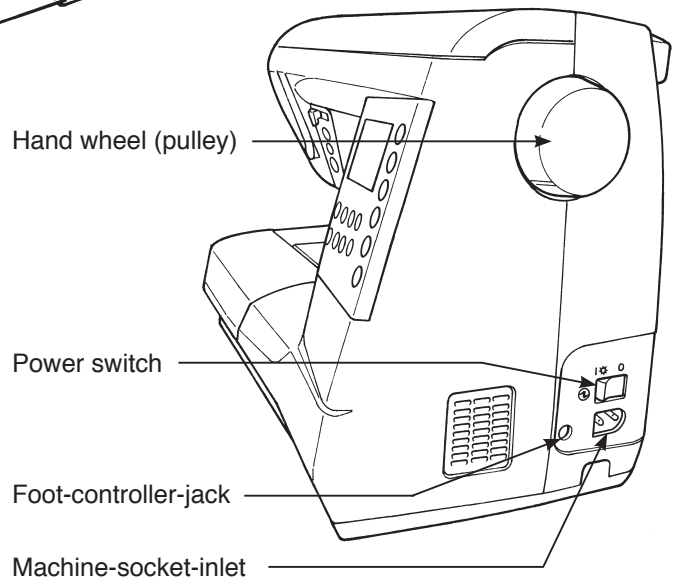
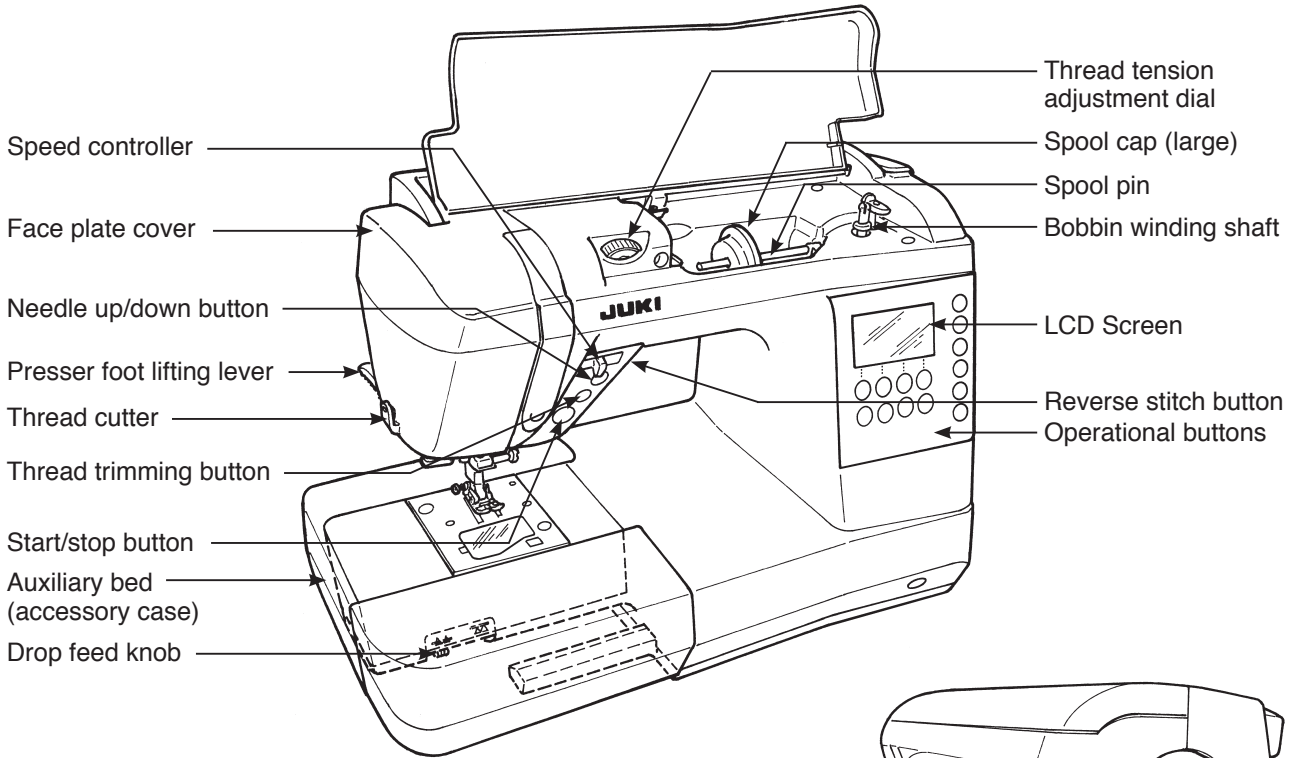

[4] Disassembling the machine covers

1) Top cover

- To remove the top cover, bow the hinge section of the right side of the cover.

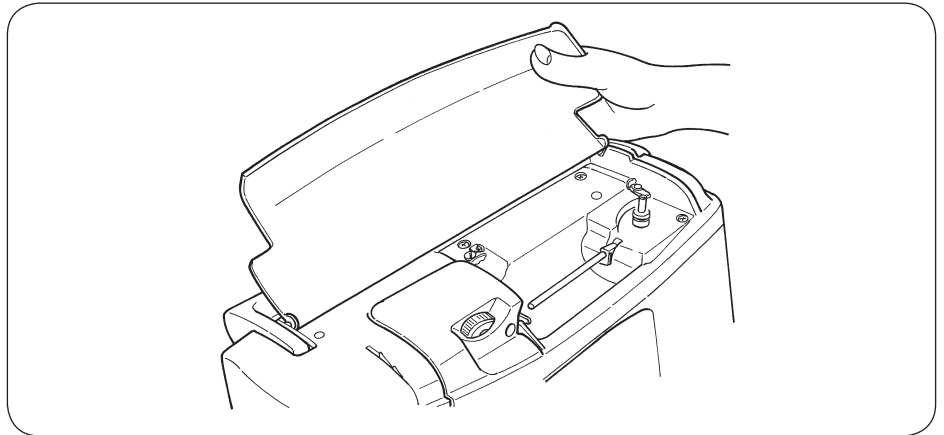

2) Face cover

- Remove setscrews **1** from the cover. Then, remove the cover.

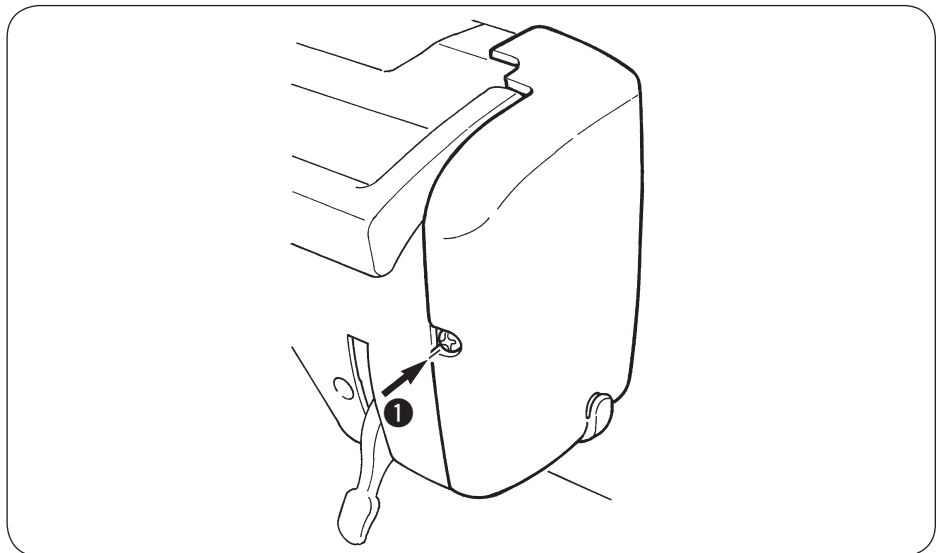

3) Throat plate

- Remove setscrews **2** and **3** from the throat plate. Then remove the throat plate.

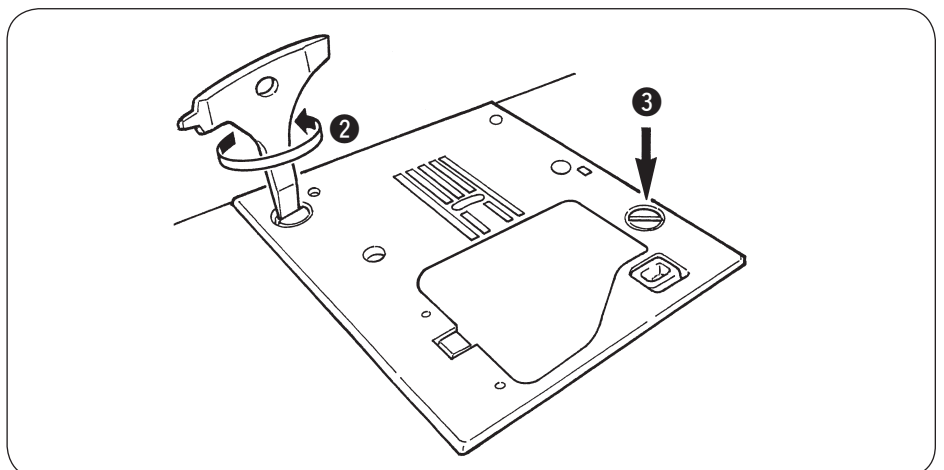

4) Spool cover

- Remove setscrew **4** from the thread tension cover.
Remove the thread tension cover.
- Remove setscrews **5** to **8** from the spool cover.
- Pull out the cable of bobbin winder motor from the microcomputer PCB.
Loosen the setscrew of the grounding wire. Remove the grounding wire.
- Remove the spool cover from the main unit of the machine, paying attention to the base tension.

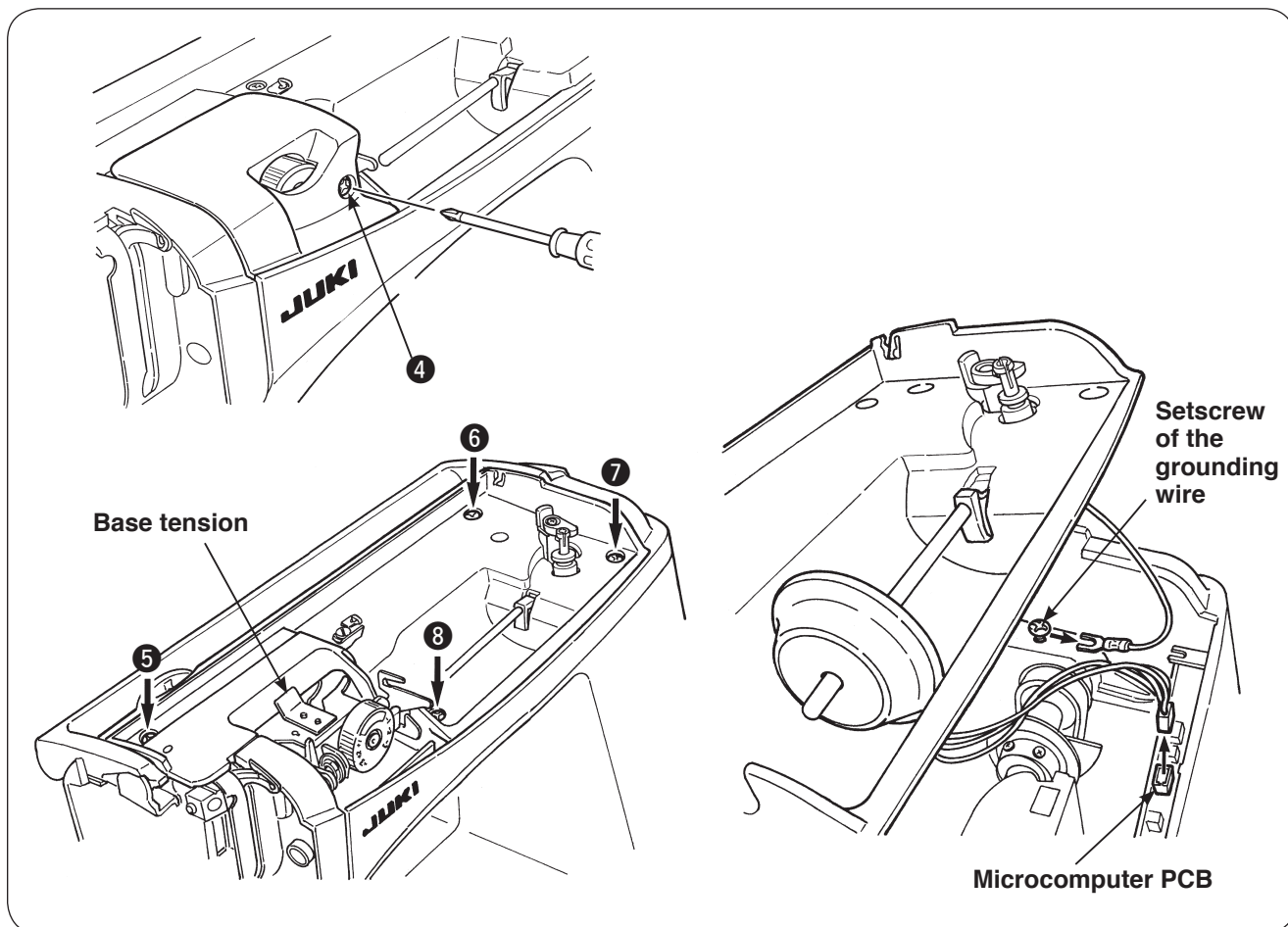

5) Bottom cover of the free arm

- Remove setscrews **9** and **10** from the bottom cover of the free arm.
Remove the bottom cover.

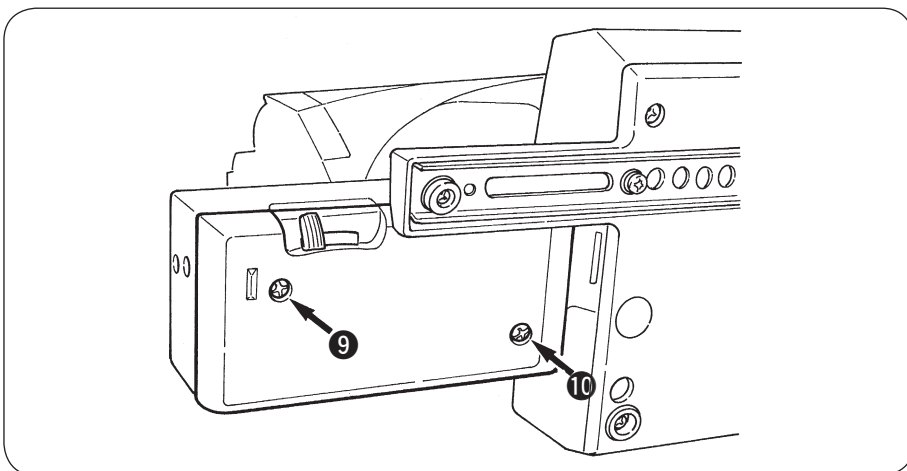

6) Bed cover

- Remove setscrews **11** to **13** from the rubber cushion of the bed cover. Remove setscrew **14** from the bed cover. Remove setscrews **15** and **16** from the metal plate. Remove the bed cover.

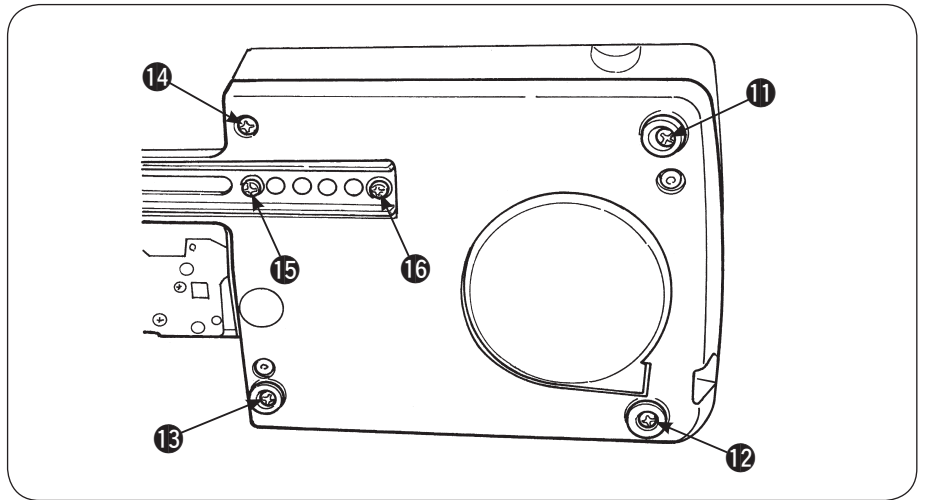

7) Upper cover of the free arm

- Remove setscrew **17** from the upper cover of the free arm. Remove the cover.

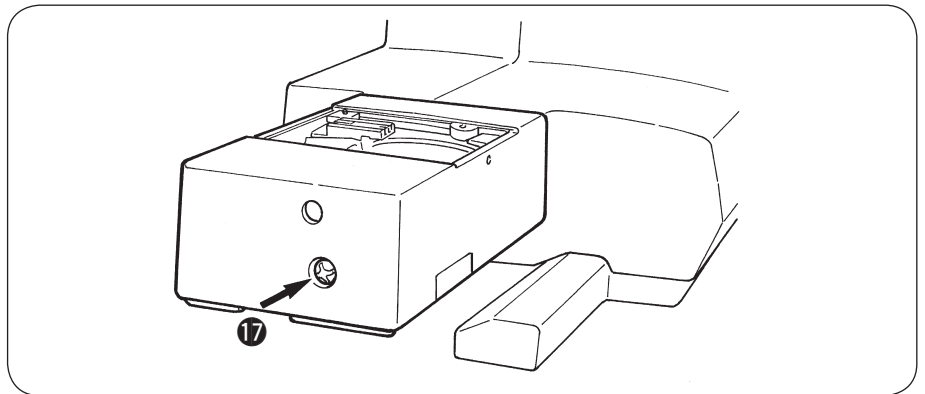

8) Face plate cover

- Remove setscrews **18** and **19** from the face plate cover. Remove the face plate cover.

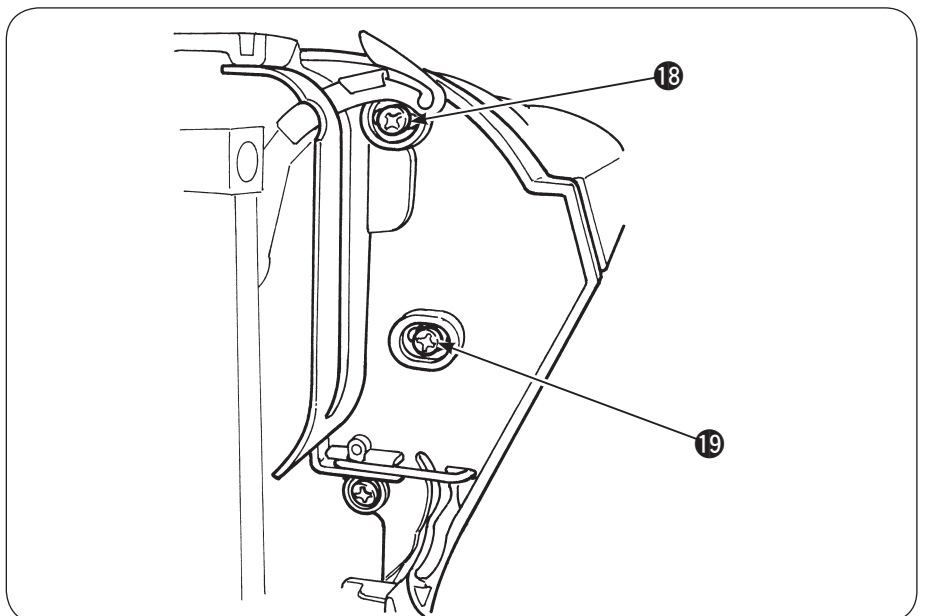

9) Front panel

- Remove setscrews 20 and 21 from the front panel.
- Put a thin screwdriver in the notch in the rising section under the arm and pry off the front panel and hook A of the rear panel.
- Opening the right side of the front panel in the direction of the arrow, tap Z section with your hand to remove hook B located at the bed surface.
- Lastly, remove hook C located at the lower side of the machine jaw.
- Remove connectors for SUMI-card, start switch and LED lamp from the microcomputer PCB when necessary.

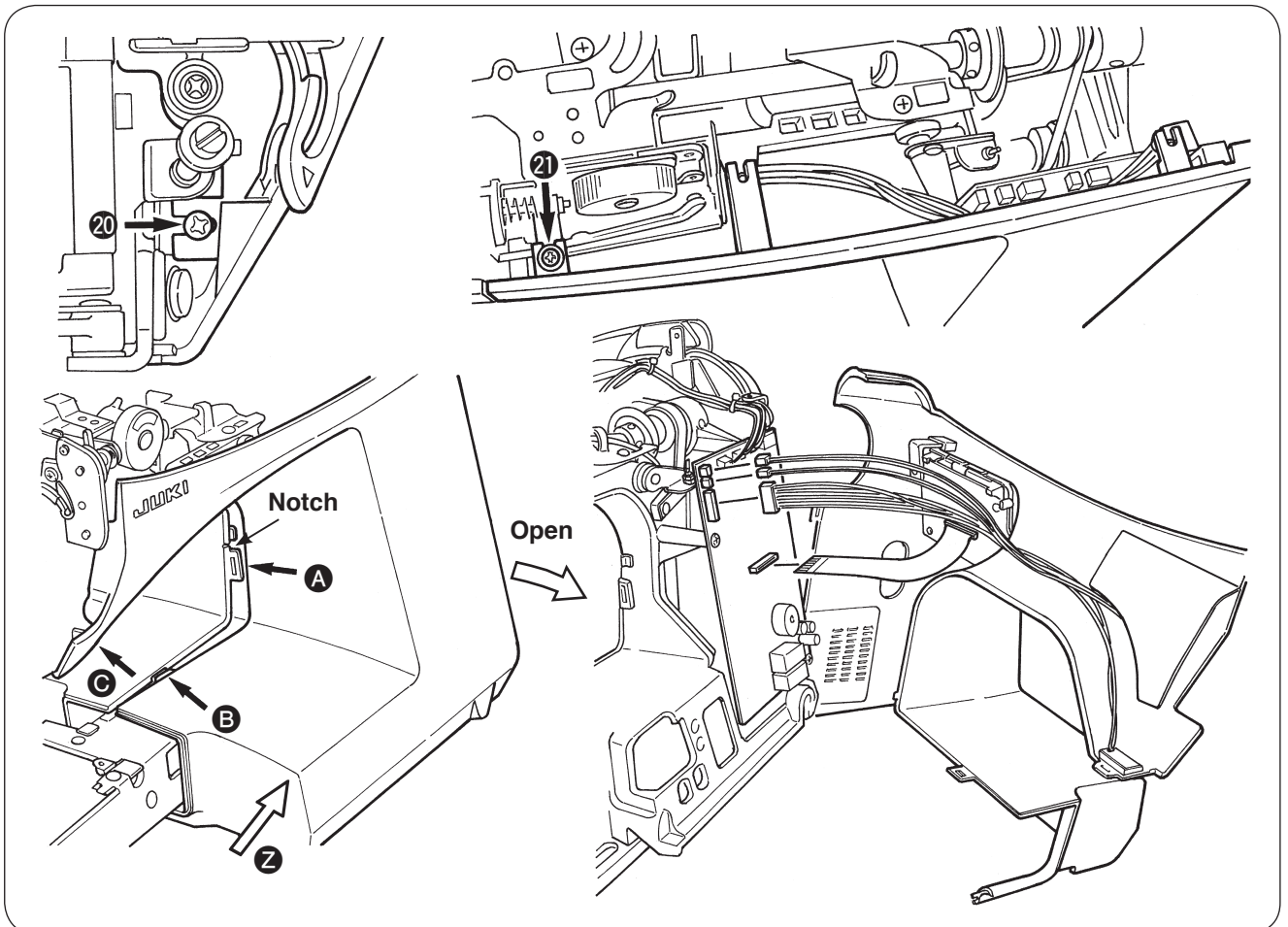

10) Rear panel

- Remove setscrews 22, 23 and 24 from the rear panel.
Remove the rear panel with the presser foot lifting lever raised.

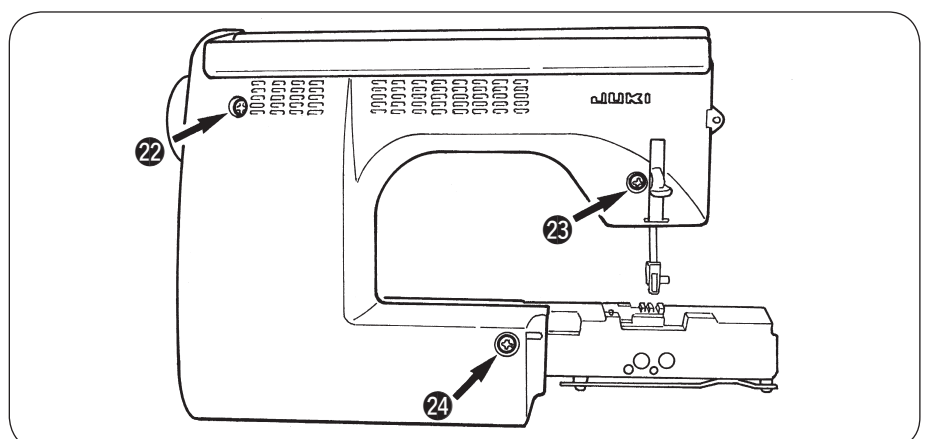

[5] PCB connection diagram

• Microcomputer PCB

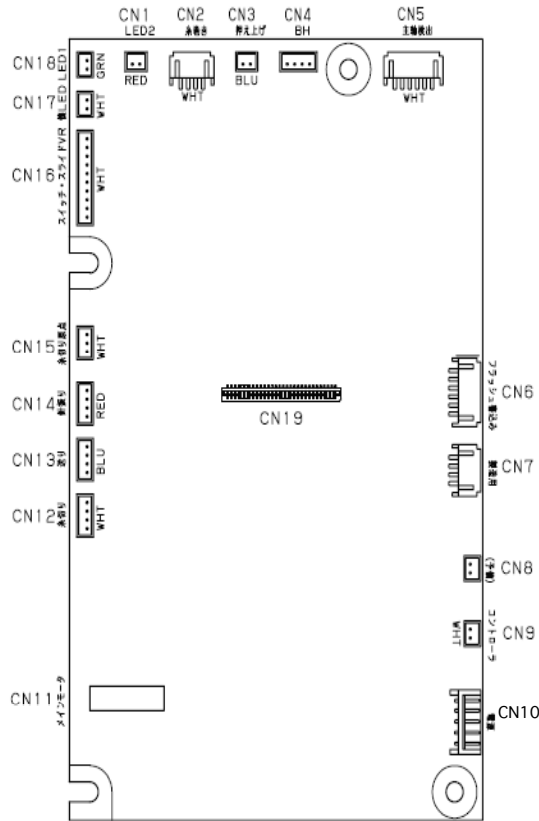

| Connector No. | Destination | Terminal No. | |
|---------------|---|--------------|-------------------------------|
| CN1 | ON_HAND_LED_CIRCUIT_BOARD_2 (Not installed) | 1 | 5V |
| CN2 | BOBBIN_WINDING_MOTOR | 1 | Bobbin winder switch |
| | | 2 | GND |
| | | 3 | Bobbin winder motor (+) (29V) |
| | | 4 | Bobbin winder motor (-) |
| CN3 | OST SW | 1 | Presser foot lifting switch |
| | | 2 | GND |
| CN4 | BH_SW | 1 | GND |
| | | 2 | BHR SW |
| | | 3 | BHS SW |
| | | 4 | 5V |
| CN5 | MAIN_SHAFT_DETECTION_CIRCUIT_BOARD | 1 | 5V |
| | | 2 | Motor pulse |
| | | 3 | S1 |
| | | 4 | S2 |
| | | 5 | S3 |
| | | 6 | GND |
| CN6 | FLASH MEMORY INTERFACE | 1 | 5V |
| | | 6 | GND |
| CN7 | FOR FACTORY | 2 | GND |
| | | 4 | GND |
| CN8 | RESERVE (Not installed) | 1 | 5V |
| | | 3 | GND |
| CN9 | CONTROLLER_SOCKET | 1 | GND |
| | | 2 | CONTROLLER |

| Connector No. | Destination | Terminal No. | |
|---------------|--|--------------|---------------------------------------|
| CN10 | POWER_SUPPLY_RELAY_LEAD_WIRE | 1 | 30V |
| | | 2 | 30V |
| | | 3 | NC |
| | | 4 | GND |
| | | 5 | GND |
| CN11 | MAIN MOTOR | 1 | MAIN MOTOR (+) (29V) |
| | | 2 | MAIN MOTOR (-) |
| CN12 | THREAD_TRIMMING_STM | 1 | \bar{A} |
| | | 2 | A |
| | | 3 | B |
| | | 4 | \bar{B} |
| CN13 | FEED_STM | 1 | \bar{A} |
| | | 2 | A |
| | | 3 | B |
| | | 4 | \bar{B} |
| CN14 | NEEDLE_THROW_STM | 1 | \bar{A} |
| | | 2 | A |
| | | 3 | B |
| | | 4 | \bar{B} |
| CN15 | THREAD_TRIMMING_STM_ORIGINAL_POINT_CIRCUIT_BOARD | 1 | |
| | | 2 | Detection signal |
| | | 3 | GND |
| CN16 | SW/SLIDE_VOLUME_CIRCUIT_BOARD | 1 | LED G |
| | | 2 | LED R |
| | | 3 | Thread trimming/needle up/down switch |
| | | 4 | Reverse stitch switch |
| | | 5 | S/S switch |
| | | 6 | |
| | | 7 | 5V |
| | | 8 | Speed control variable resistor |
| | | 9 | GND |
| CN17 | UNDER_ARM_LED_CIRCUIT_BOARD (Not installed) | | |
| CN18 | ON_HAND_LED_CIRCUIT_BOARD_1 | 1 | 5V |
| | | 2 | |
| CN19 | PANEL_CIRCUIT_BOARD | 1 - 3 | NC |
| | | 4 - 7 | Switch strobe |
| | | 8, 9 | 5V |
| | | 10, 11 | GND |
| | | 12 | LCD signal |
| | | 13, 14 | 3.3V PU |
| | | 15, 16 | LCD signal |
| | | 17 | 3.3V |
| | | 18 | GND |
| | | 19 - 22 | NC |
| | | 23 - 26 | Switch data |
| | | 27 - 29 | NC |
| | | 30 | GND |

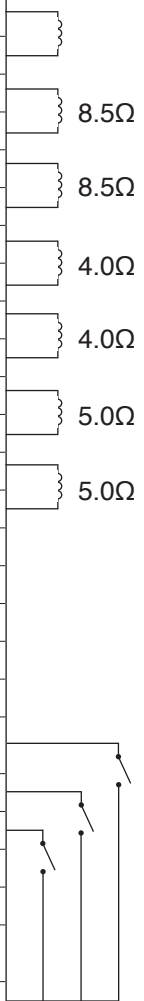

• Display PCB

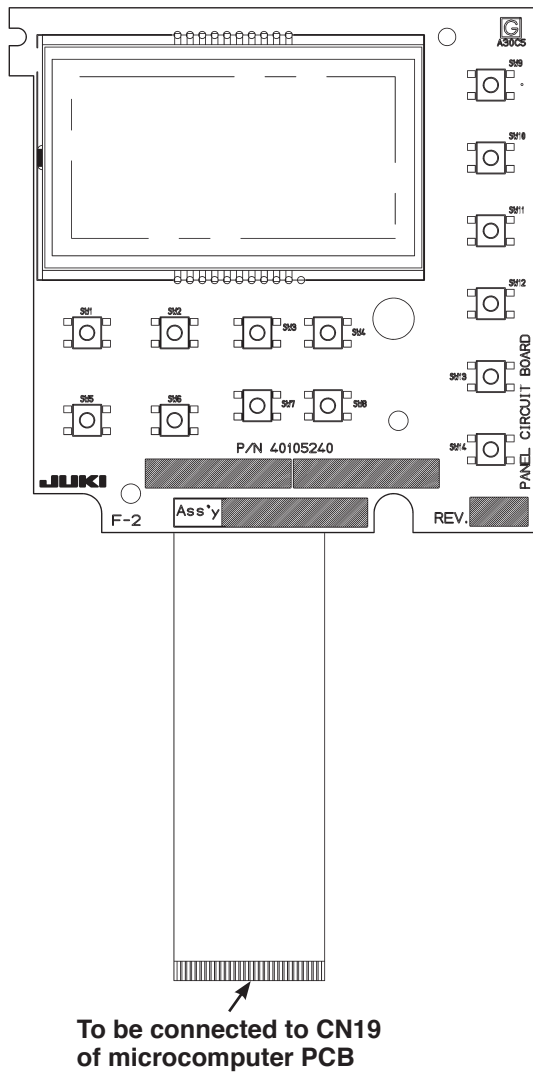

• Power PCB

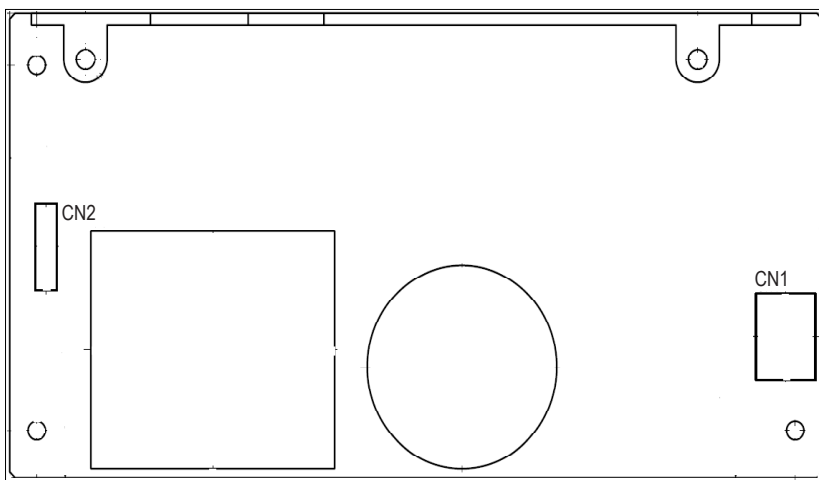

| Connector No. | Destination | Check |
|---------------|------------------------------|----------------------------|
| CN1 | POWER SW | AC input |
| CN2 | POWER_SUPPLY_RELAY_LEAD_WIRE | 1-2PIN 29V, 4-5PIN GND(FG) |

• Connection block diagram

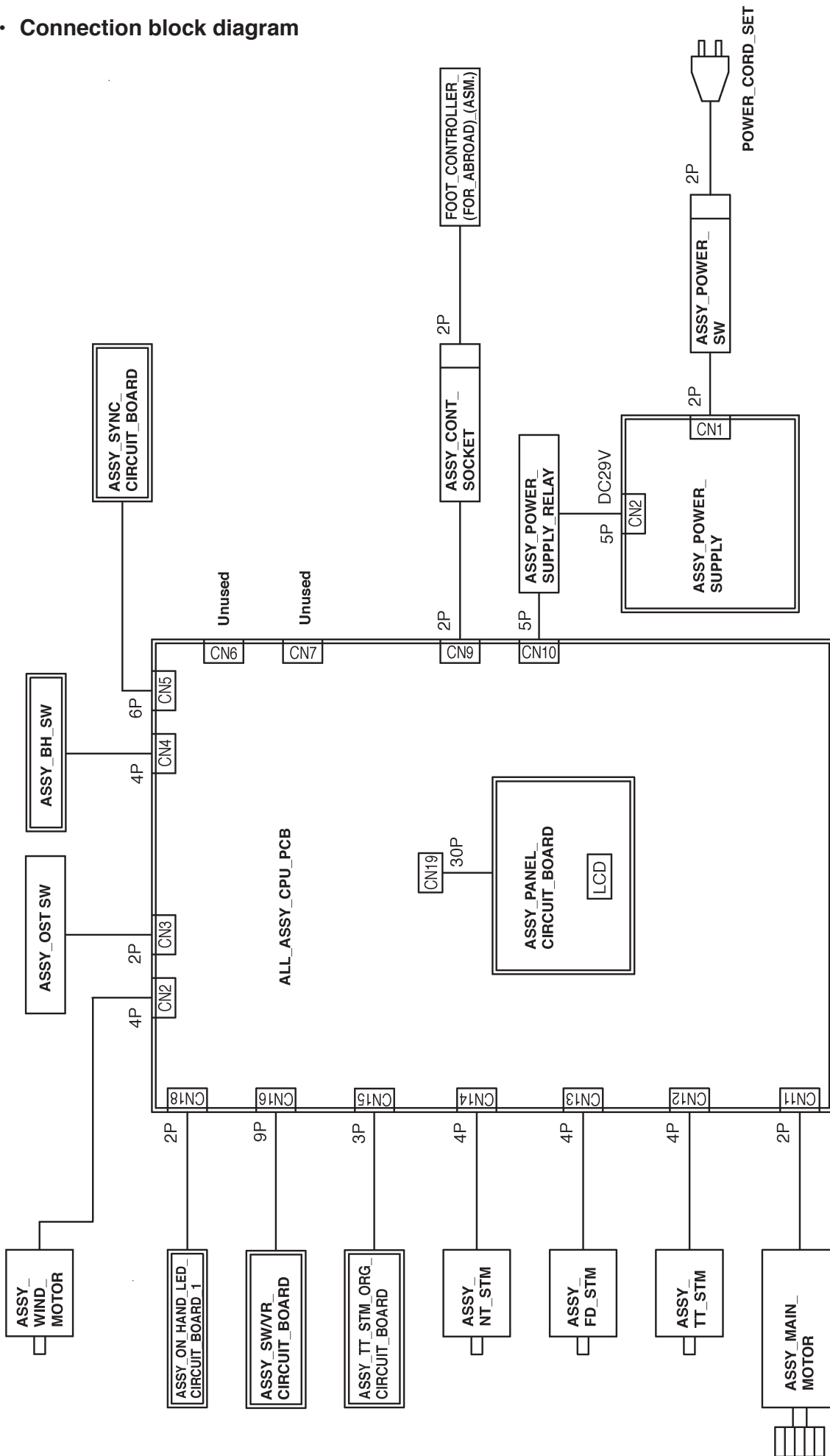

[6] Adjustment

6-1 Adjusting the needle bar height

- Remove the face cover.

Adjustment value:

- Distance from the bottom end of the pin inside needle bar surface to the top surface of the throat plate: 19 mm
- When the needle is mounted, the needle eye tilts rightward by 2 degrees.

Adjustment procedure 1.

1. Select the straight stitch using the pattern selecting button. Choose center needle position.
2. Make a gauge needle by cutting a household needle HA x 1 to dimension A. Fit the gauge needle into the needle bar.
3. Prepare an appropriate metal plate of thickness B. ($A = 19 \text{ mm} - B$)
4. Bring the needle bar to its lowest dead point. Slightly loosen needle bar connecting stud setscrew ❶ as long as the needle does not slip off from the connecting stud.
5. Place the metal plate on the throat plate. Move the needle bar up and down by hand to adjust so that the cut surface of the gauge needle aligns with the top surface of the metal plate. Then, turn the needle bar by two degrees of an angle as illustrated in the sketch below.
6. Temporarily tighten needle bar connecting stud setscrew ❶ and reconfirm that the needle bar is correctly adjusted. Then, securely tighten the setscrew.

Adjustment procedure 2.

1. Assemble a household HA x 1 needle #14 into the needle bar, bring the needle bar to its highest dead point. Move the needle bar in the same way as described in procedure 1 to adjust the needle bar height so that the needle tip is spaced 15.5 mm from the top face of the throat plate.

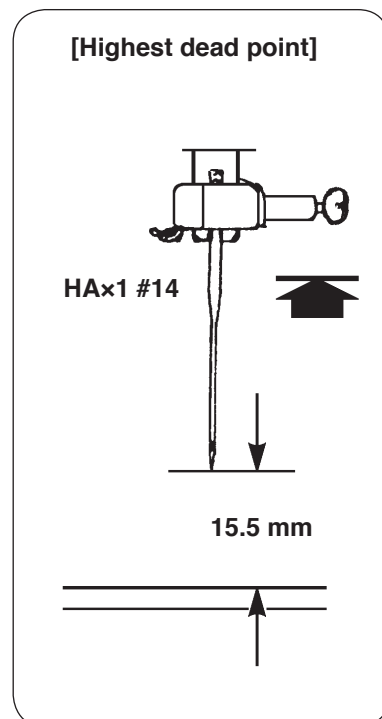
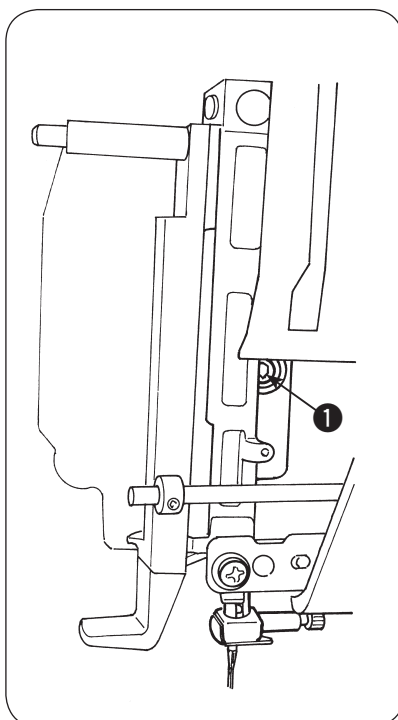
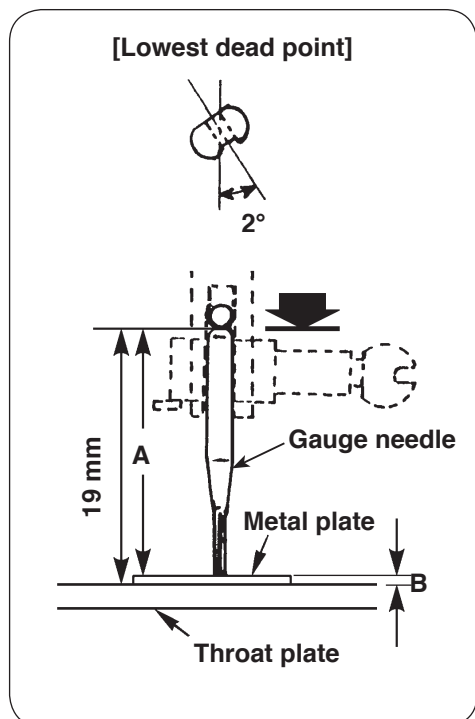

6-4 Timing belt

- Remove the front panel and the microcomputer PCB.

Adjustment procedure

1. Loosen the setscrew in the idler mounting base and loosen the timing belt.
2. Turn the hand wheel to bring the needle bar to its lowest dead point.
3. Turn the hook driving shaft to bring the feed dog to its lowest dead point.
4. Carefully keeping the condition described in steps 2 and 3, set the timing belt on the hook driving shaft pulley (by temporarily tightening the setscrew in the idler mounting base) so that the setscrew No. 2 in the pulley is brought to just underside of the pulley.
5. Applying 1.96 ± 0.29 N force to the idler by means of a spring scale, securely tighten the setscrew.

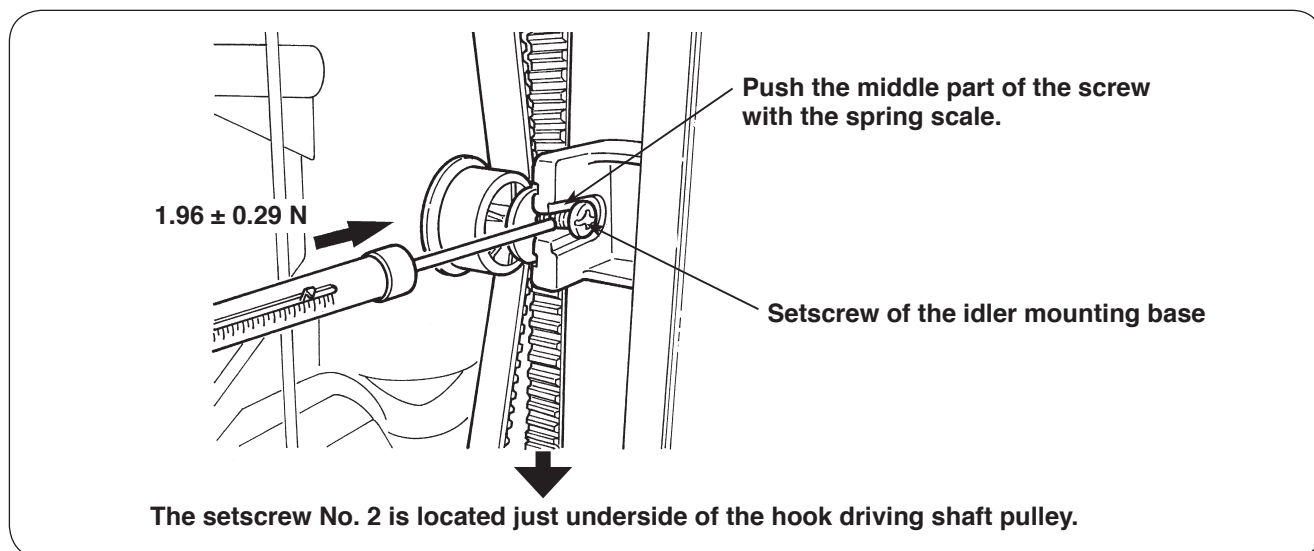

6-5 Feed timing

- After checking the feed dog height and the needle bar height, carry out adjustment of the feed timing.

Adjustment procedure

1. Assemble a HA x 1 needle #14 into the needle bar.
2. Loosen setscrew No. 2 in the hook driving shaft pulley.
3. Loosen setscrew No. 1 in the hook driving shaft pulley. Adjust the pulley so that the lower end of the needle eye in the descending needle #14 is aligned with the top surface of the throat plate when the top face of the descending feed dog is aligned with the top surface of the throat plate by turning the hand wheel toward you. After adjustment, tighten the setscrew No. 2.
4. Turn the main shaft by one revolution to confirm the timing.

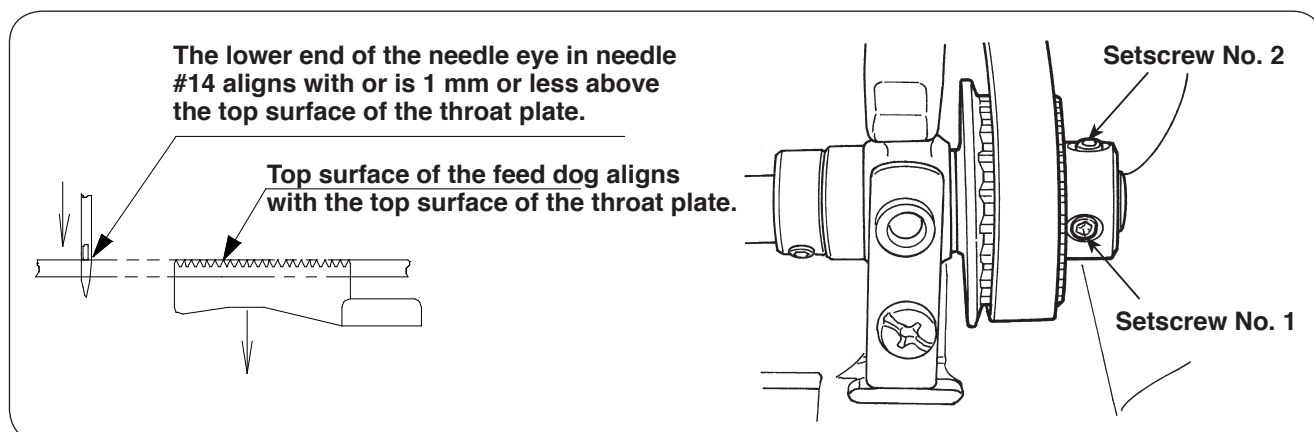

6-6 Timing between the needle and the hook

- Remove the throat plate, the bed cover and the bottom cover of the free arm.

Method for checking

1. Check to be sure that the needle entry point and needle bar height are correct.
2. Select the straight stitch. Select the right needle position by using the zigzag width adjusting dial.
(The needle entry point is shifted to the rightmost side.)
3. Now, turn the hand wheel by hand to bring the needle bar to its lowest dead point.
4. Turn the hand wheel further to gradually lift the needle bar until point C where the needle center is aligned with the tip of blade point of the hook is reached.
5. At this time, check to be sure that the distance D from the tip of blade point of the hook to the upper end of the needle eye is 3.1 to 3.3 mm. If this distance is not correctly provided, carry out the following adjustment.

Adjustment procedure

1. Loosen the setscrew in the hook driving gear which is not visible from underside of the sewing machine when the needle center aligns with the tip of blade point of the hook.
2. Select the straight stitch and the right needle position. Move the hook driving gear in the rotational direction to adjust distance D of 3.1 to 3.3 mm is provided between the tip of blade point of the hook and the upper end of the needle eye when the needle bar is lifted by 1.6 mm from the lowest dead point by turning the hand wheel by hand.

At this time, the backlash between the hook driving gear and the gear on the hook side may change depending on the location of the hook driving gear on the hook driving shaft. Adjustment should, therefore, be carried out with the visible setscrew temporarily tightened, while carefully observing the hook driving gear in both the rotational direction and axial direction. Adjust the backlash to 0.2 to 0.7 mm on the periphery of the rotating hook.

3. After confirming the timing between the needle and hook is correctly adjusted, securely tighten both setscrews.

Caution: After adjustment of the hook, the hook race surface and the bobbin case holder may be stained with dirt, oil or grease. Wipe them off with alcohol where necessary.

If those parts are left stained, chattering or thread slip-off noise of the bobbin case holder can occur.

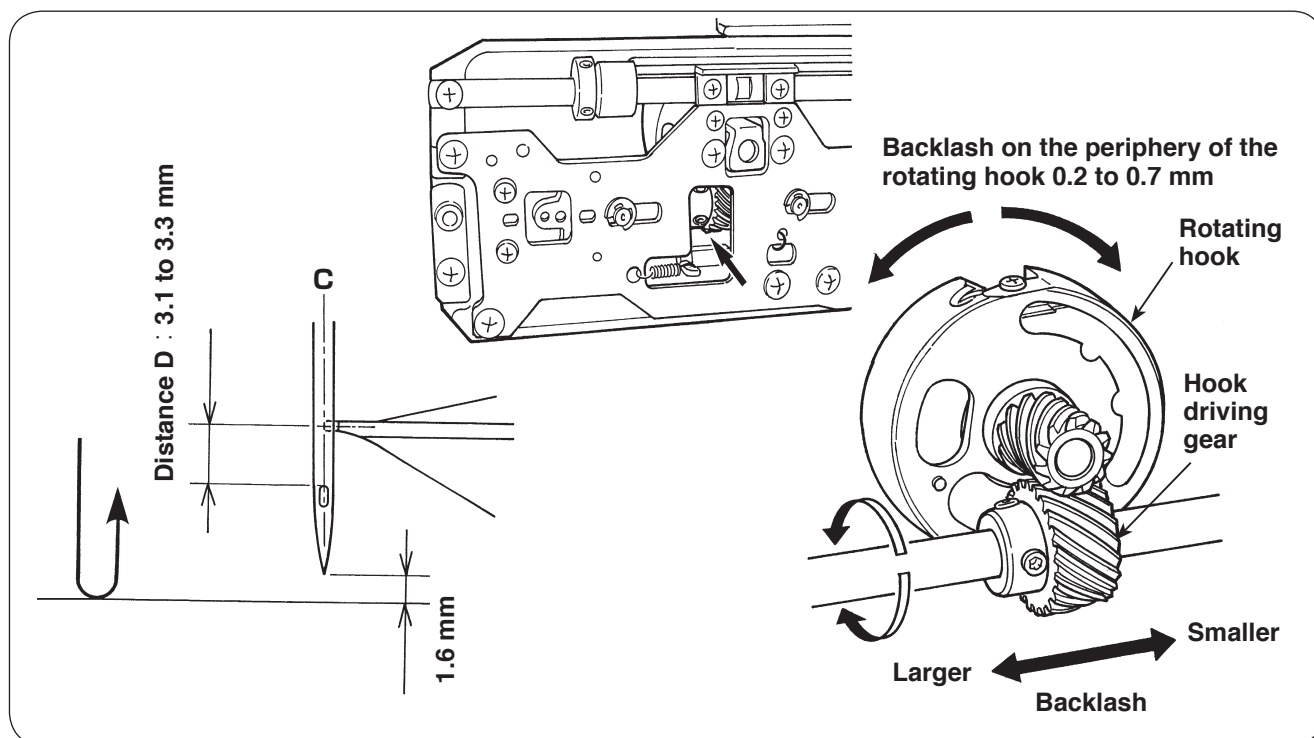

6-7 Clearance between the needle and the blade point of hook

- Remove the face cover and the throat plate.

Adjustment procedure

1. Loosen screw ①. Adjust the clearance between the needle and the blade point of the hook to 0.02 to 0.07 mm by turning adjusting shaft ②.

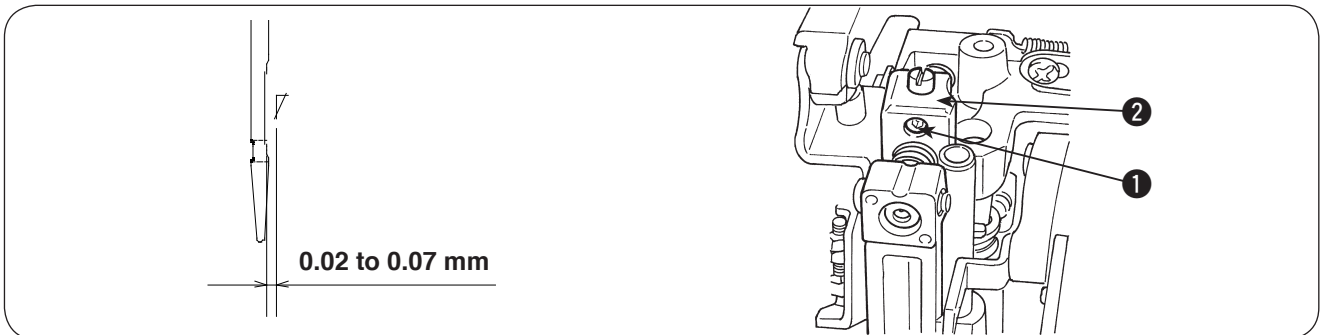

Adjusting the balance of the clearances at the right and left needle entry points

1. Select the zigzag pattern and set the zigzag width to 7 mm. Adjust the balance of the clearances provided between the needle and the blade point of the hook at the right and left needle entry points.

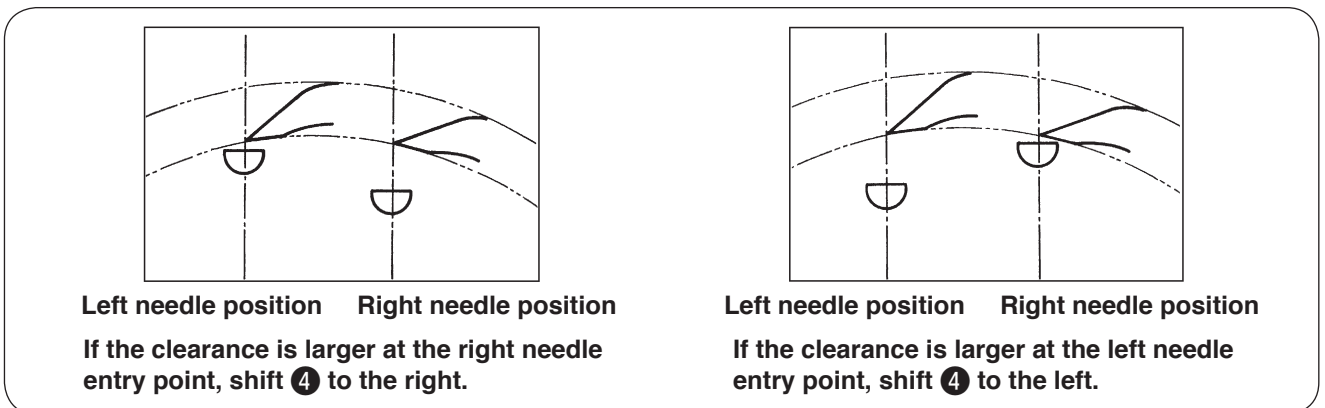

Adjustment procedure

1. Select No. 2 of the service mode.
2. Gradually turn adjusting shaft ② to find a position where the needle deviates slightly. Now, temporarily tighten screw ①.
3. Slightly loosen setscrew ③. Adjust the lateral balance of the needle bar by slightly moving right-left adjuster ④ while carefully listening to the noise produced when the needle deviates at the right and left needle entry points. Then, securely tighten setscrew ③.
4. Additionally turn shaft ② and securely tighten screw ① at the position where the needle does not deviate.
5. Lightly tap P section with fingers. If you hear a needle deviation noise at the right and left needle entry points, the optimum clearance is provided between the needle and the hook.

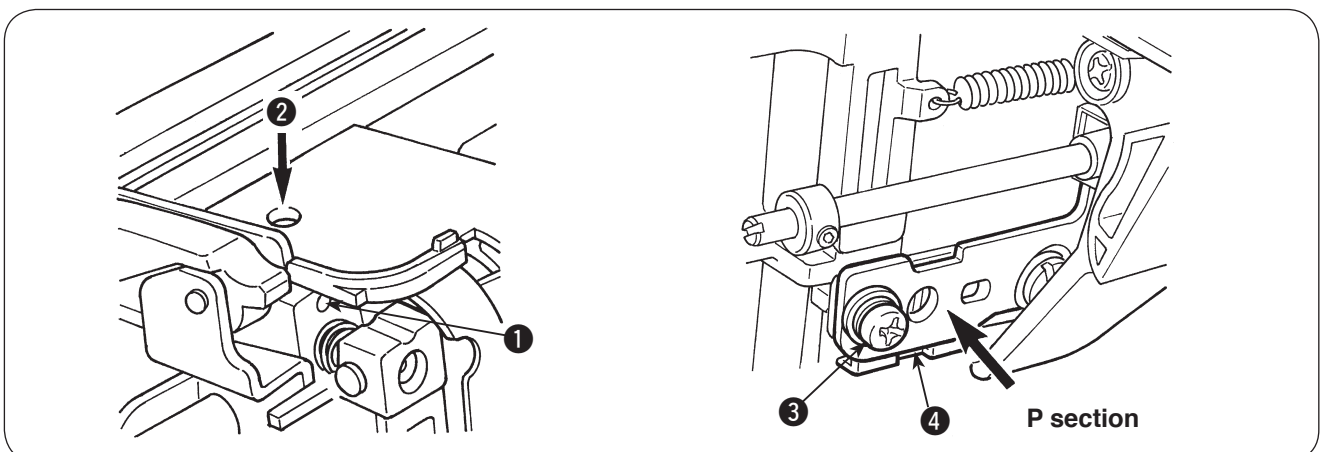

6-8 Position of the hook rotation stopper plate

- Remove the throat plate.

Adjustment procedure

1. When the bobbin case holder is placed inside the rotating hook, loosen the setscrew and determine the longitudinal position of the rotation stopper plate so that the projection of the bobbin case holder and the leaf spring of the rotation stopper plate are located as illustrated in the enlarged partial view. To adjust the lateral position of the rotation stopper plate, press the plate in the right direction by the amount of play and secure with the setscrew.

* The hook race surface and the bobbin case holder may be stained with dirt, oil or grease. Wipe them off with an alcohol-soaked cloth where necessary.

If those parts are left stained, chattering or thread slip-off noise of the bobbin case holder can occur.

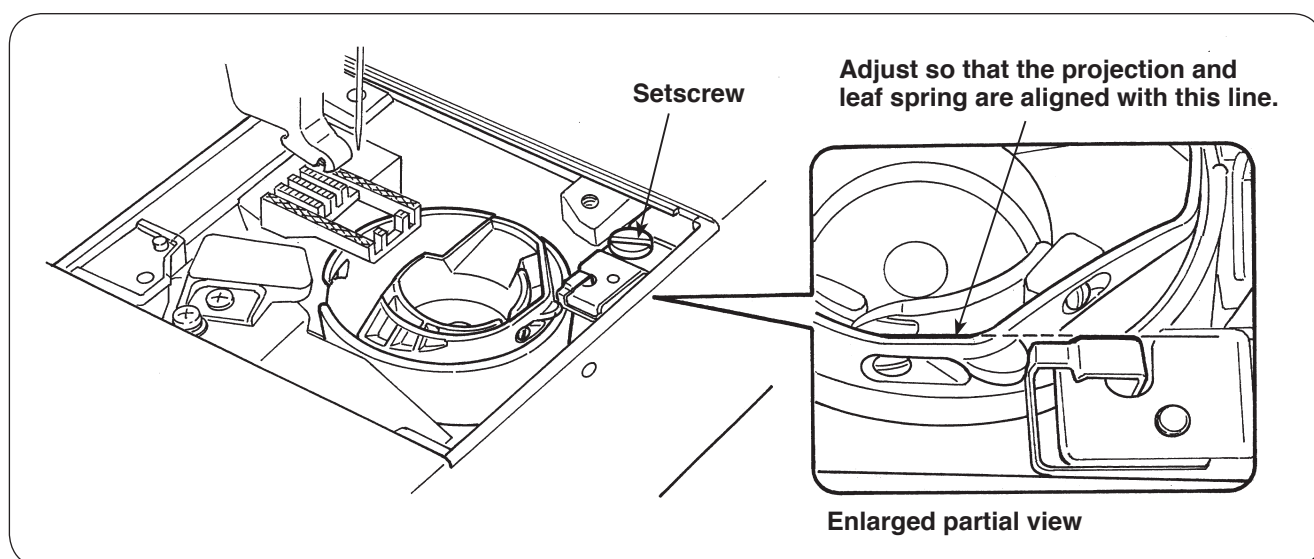

6-9 Adjusting the bobbin thread tension

- Remove the throat plate.

Adjustment procedure

1. Position the bobbin case holder and a tension gauge as illustrated in the sketch below. Using SHAPPE Span thread #60, adjust the bobbin thread tension to 0.13 ± 0.02 N with the adjusting screw.

At this time, carefully prevent the bobbin thread from coming in contact with the throat plate or other related parts.

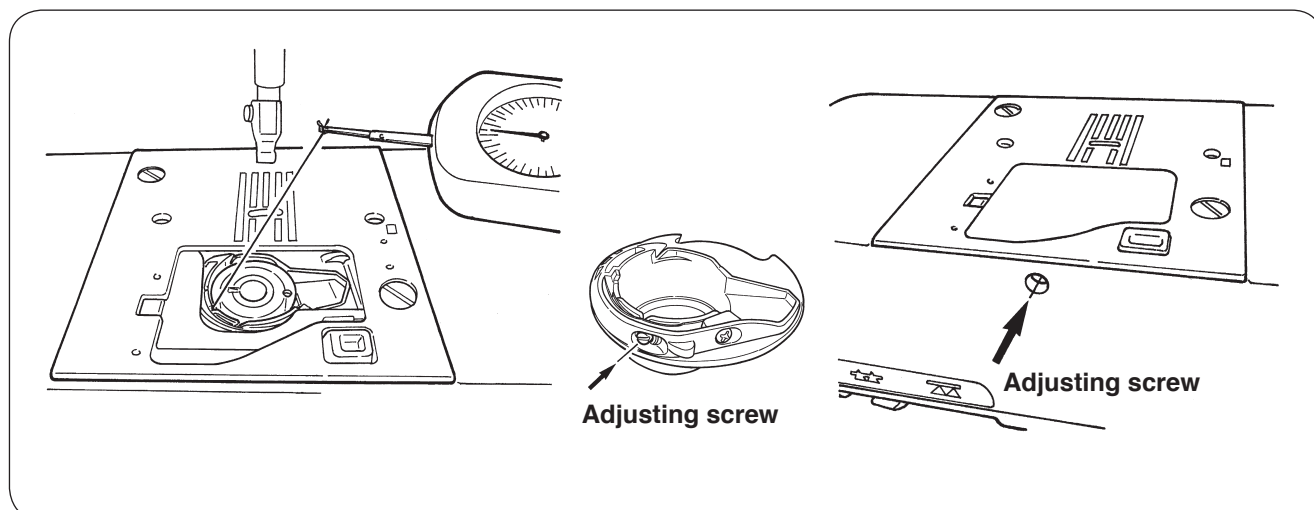

6-10 Adjusting the disk opening amount

6-10-1 Adjusting the thread tension release adjusting plate

- Remove the face cover, the thread tension cover and the spool cover.

Adjustment procedure

1. Raise the presser foot lifting lever.
2. Loosen the adjusting screw and adjust the thread tension release adjusting plate so that the top end of claw of the opening arm aligns with the marker dot on the thread releasing arm.

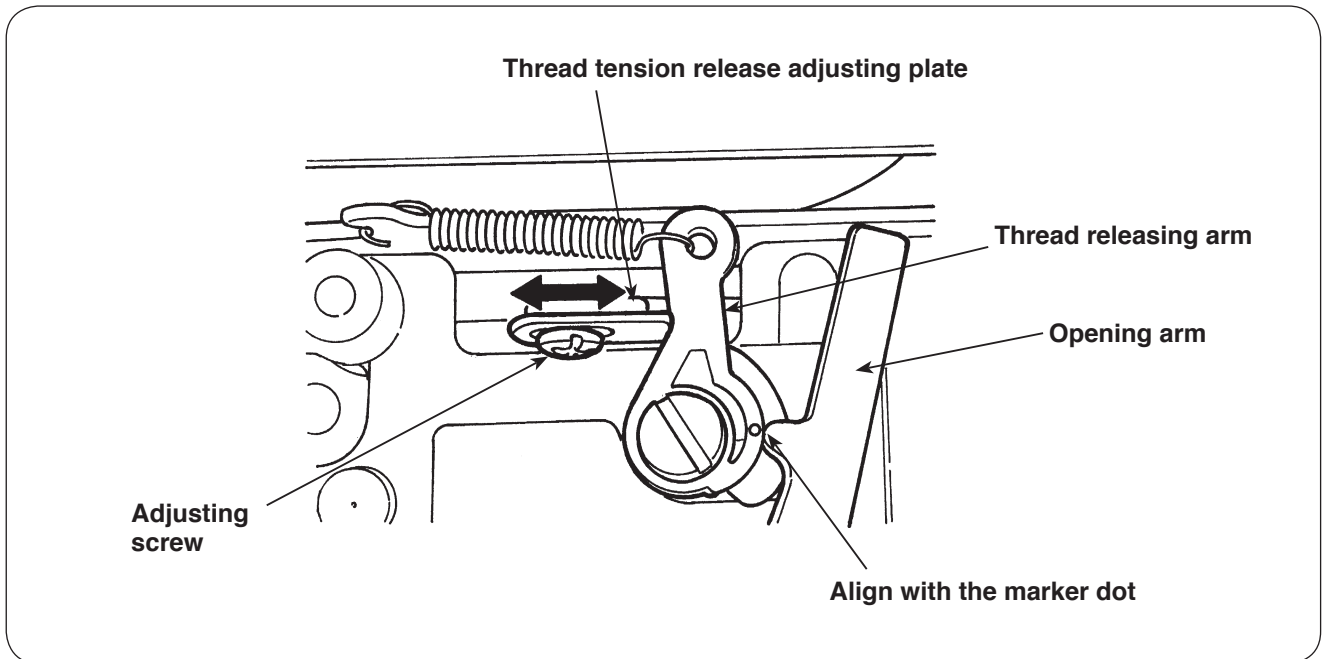

6-10-2 Tension disk opening amount

- Remove the face cover, thread tension cover and the spool cover.

Adjustment procedure

1. Maximize the tension with the thread tension adjustment dial. Raise the presser foot lifting lever.
2. Adjust the clearance between tension disks (A) and (B) to 1 mm by turning the thread tension float adjusting screw.

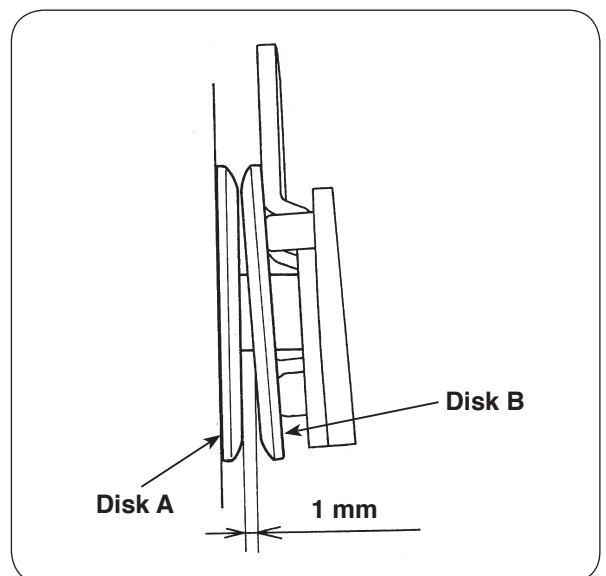

6-10-3 Base tension opening amount

- Remove the face cover, the thread tension cover and the spool cover.

Adjustment procedure

1. Raise the presser foot lifting lever.
2. Adjust the base tension opening amount to 1 mm by turning the base tension adjusting screw.

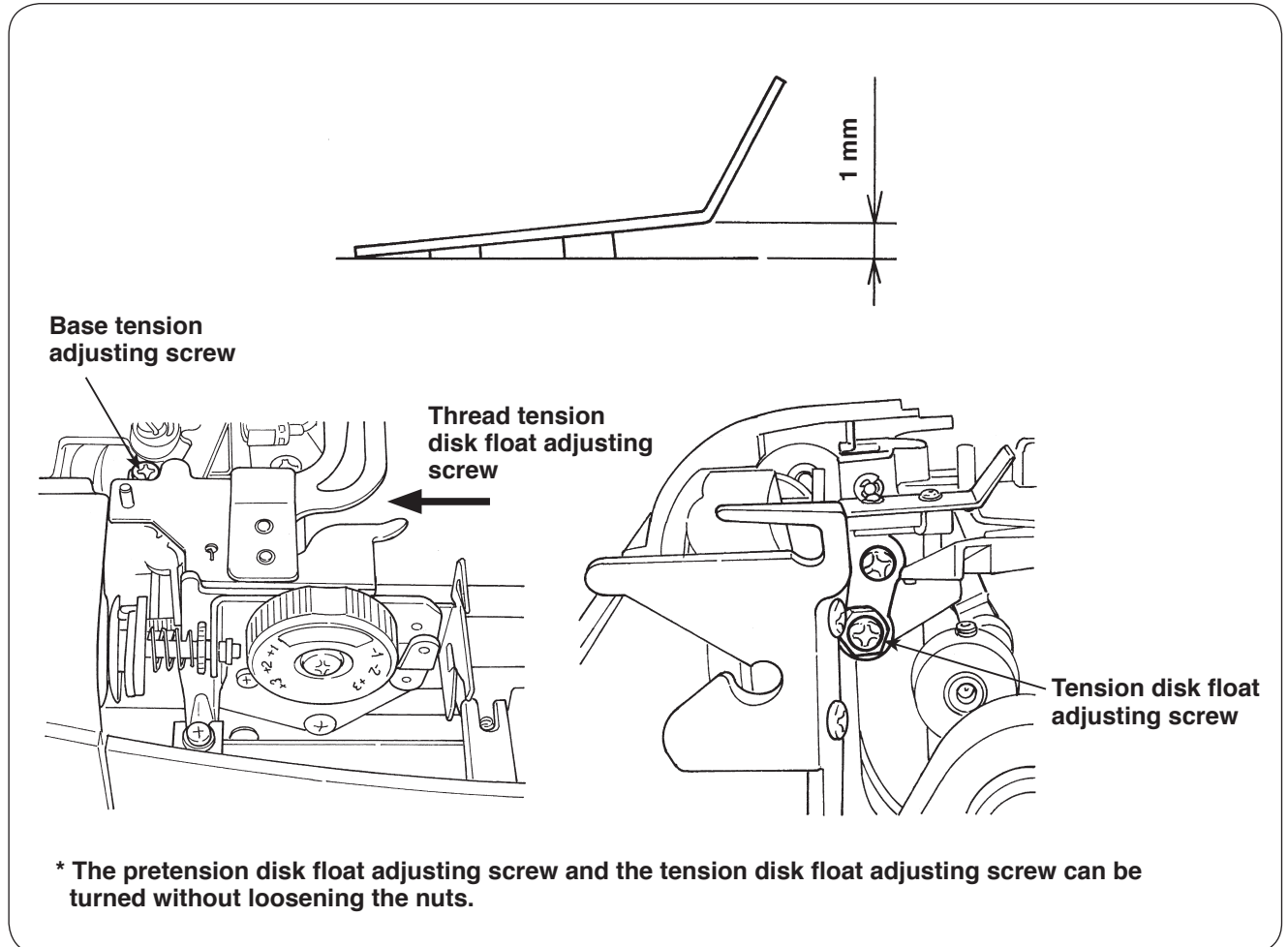

6-10-4 Adjusting the disk opening amount at the time of thread trimming (HZL-G210)

Adjustment procedure

1. Lower the presser foot lifting lever.
2. Select No. 9 (meaning: tension release) of the service mode.
3. Loosen the locknut. Turn the adjusting nut to adjust the retracting amount of the thread tension releasing link plate so that the top end of claw of the opening arm is aligned with the marker dot on the thread tension releasing arm.
4. At this time, check to be sure that the opening amounts of the pretension disk, thread tension disk and base tension are same as those provided when the presser foot lifting lever is raised.

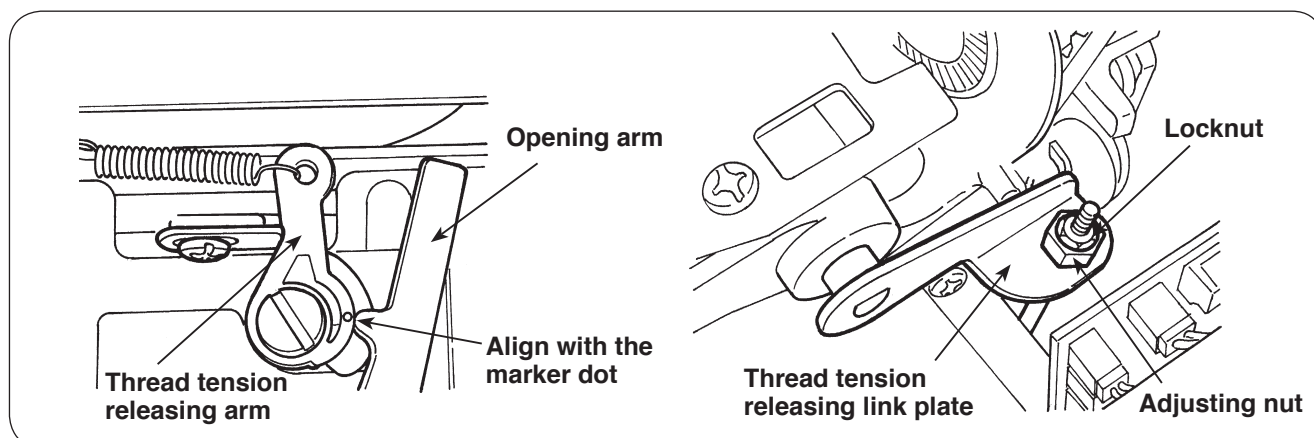

Caution: After adjustment of the opening amounts of each tension control part, lower the presser foot lifting lever or return the thread tension releasing link plate to its home position to make sure that those tension control parts are closed.

6-11 Adjusting the needle thread tension

- Remove the thread tension controller cover.

Adjustment procedure

1. Raise the presser foot lifting lever.
2. Turn the thread tension adjustment dial to bring its "AUTO" section to the top.
3. Prepare SHAPPE Span thread #60 and a tension gauge. Thread the base tension and the tension disk.
4. Lower the presser foot lifting lever. Turn the adjusting nut to adjust the tension so that the tension gauge gives a reading of 0.49 to 0.59 N.

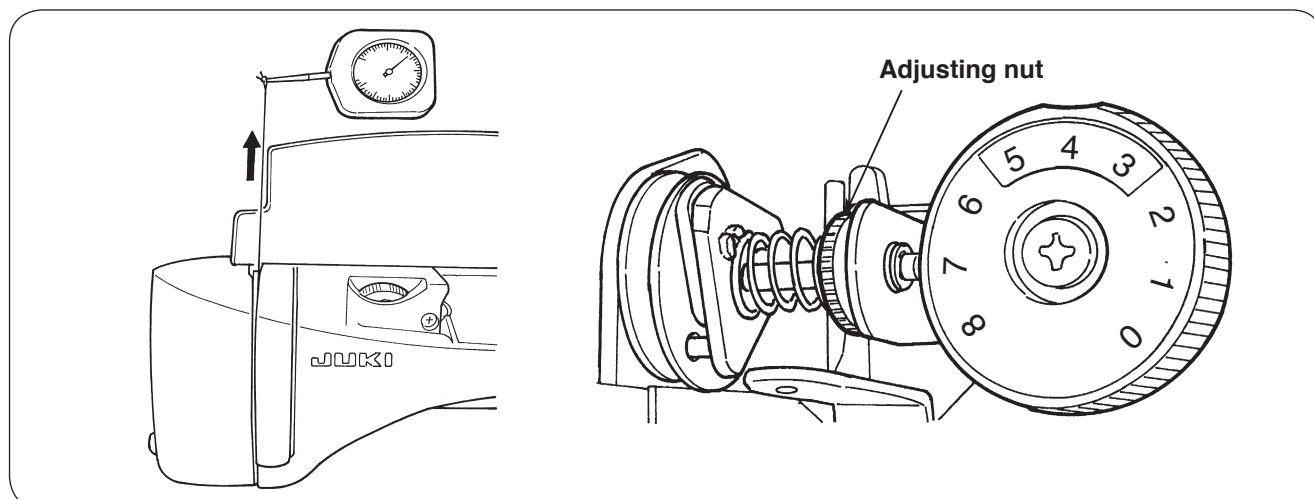

6-12 Vertical position of the needle threading hook

- Remove the frame cover.

Adjustment procedure

1. Assemble a household HA x 1 needle #11 into the needle bar.
2. Turn the hand wheel to bring the needle bar near its highest dead point and stop the hand wheel when the needle bar reaches the location where the setscrew in the needle bar guide is visible.
3. Lower the threading lever to its lowest dead point. Check whether a clearance of 0 to 0.1 mm is provided between the top end of the needle threading hook and the upper end of the needle eye.
(If the clearance is not 0 to 0.1 mm, the needle may not be threaded depending on the size of the needle used.)
4. Fit a hexagonal wrench on the needle bar guide setscrew to loosen it slightly.
If the needle threading hook position is too low -> Move the needle bar guide upward and temporarily tighten the setscrew.
If the needle threading hook position is too high -> Move the needle bar guide downward and temporarily tighten the setscrew.
Adjust the needle threading hook carefully, checking its position with respect to the needle eye.
When the needle threading hook enters and exits from the needle eye, the needle should never be bent by the hook.
If the needle threading hook position deviates to the right or left, correct the bend in the needle threading hook with the tip of a thin screwdriver or change the needle threading hook with a new one.
5. When the needle threading hook is correctly positioned, fully tighten the setscrew.

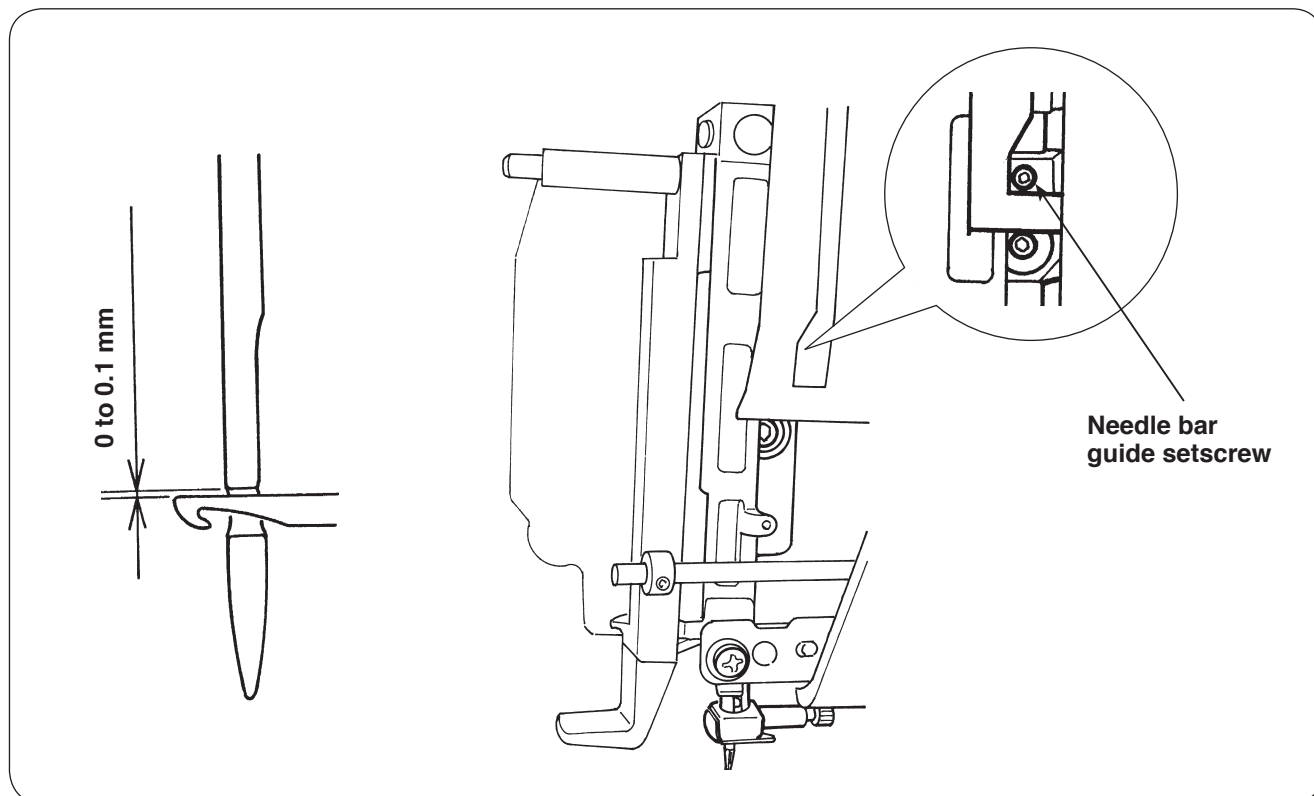

6-13 Adjusting the presser foot lifting switch

- Remove the face cover, the thread tension cover and the spool cover.

Adjustment procedure

1. Loosen the adjusting screw of the presser foot lifting switch. Adjust the position of the presser foot lifting switch so that the sewing machine stops when the presser foot lever is raised by 5 mm or more while the machine is in operation.

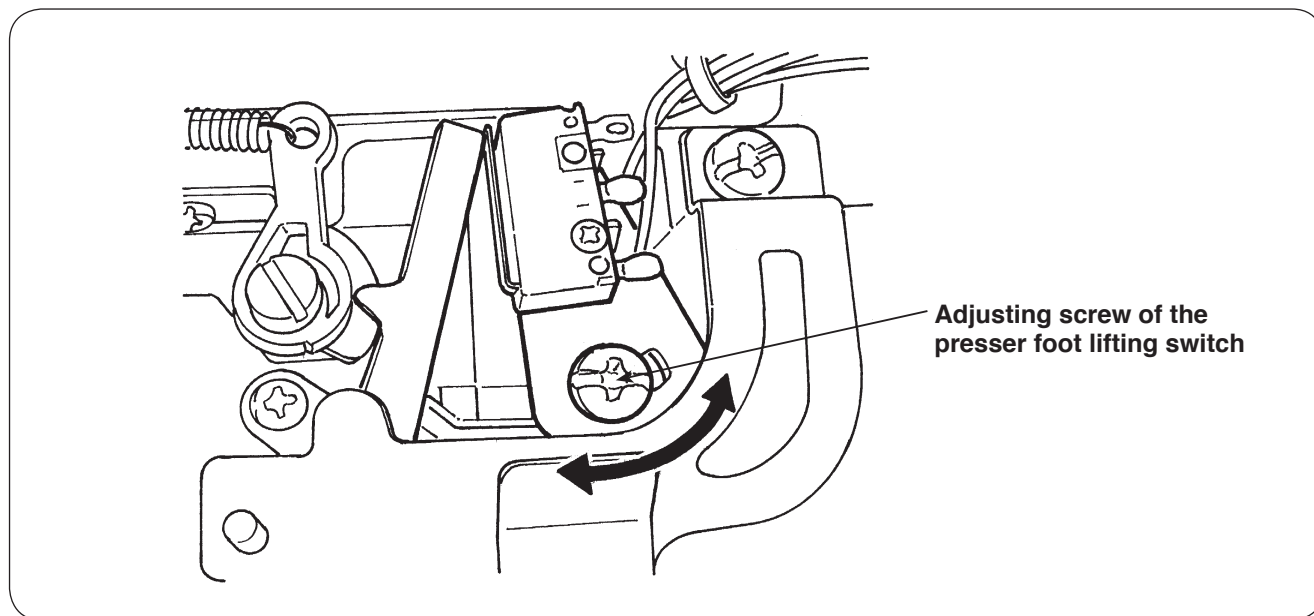

6-14 Adjusting the presser bar height

- Remove the frame cover.

Adjustment procedure

1. Assemble the standard presser foot in the presser foot holder. Raise the presser foot lifting lever.
2. Loosen the setscrew of the presser bar position bracket. Adjust the distance from the top surface of the throat plate to the bottom face of the standard presser foot to 6 ± 0.3 mm. At this time, check the direction of the presser bar so that the standard presser foot is in parallel to the feed dog groove and so that the needle hole in the throat plate is nearly aligned with the slot in the standard presser foot.

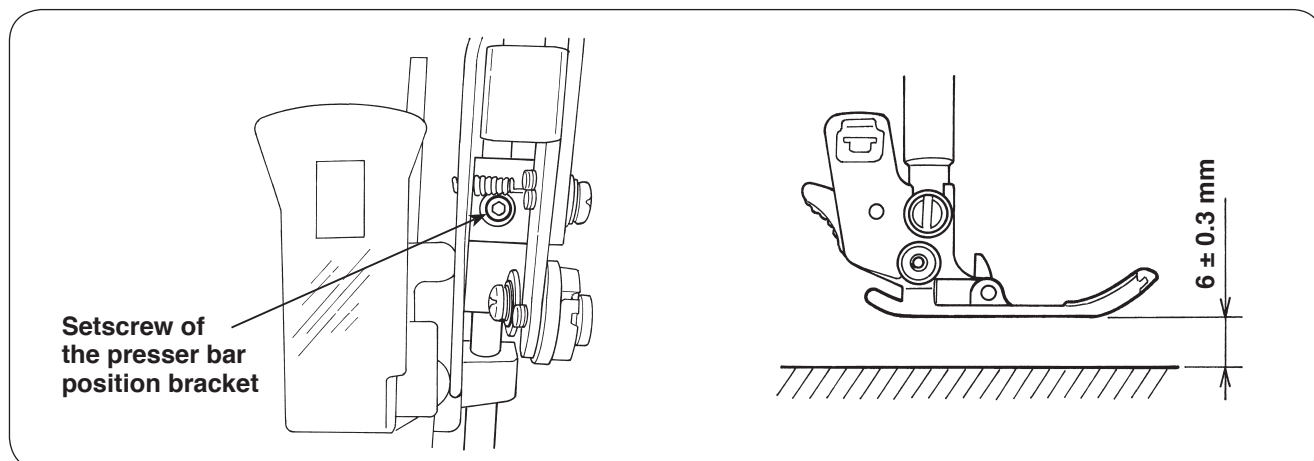

6-15 Motor belt

- Remove the front panel.

Adjustment procedure

1. Set the motor timing belt to the motor pulley and the motor shaft pulley.
2. Adjust the motor bracket so that the belt deflection amount becomes 6 ± 1 mm when pressing the center of the belt with a force of 0.98 N. After completion of adjustment, tighten the setscrew in the motor bracket.

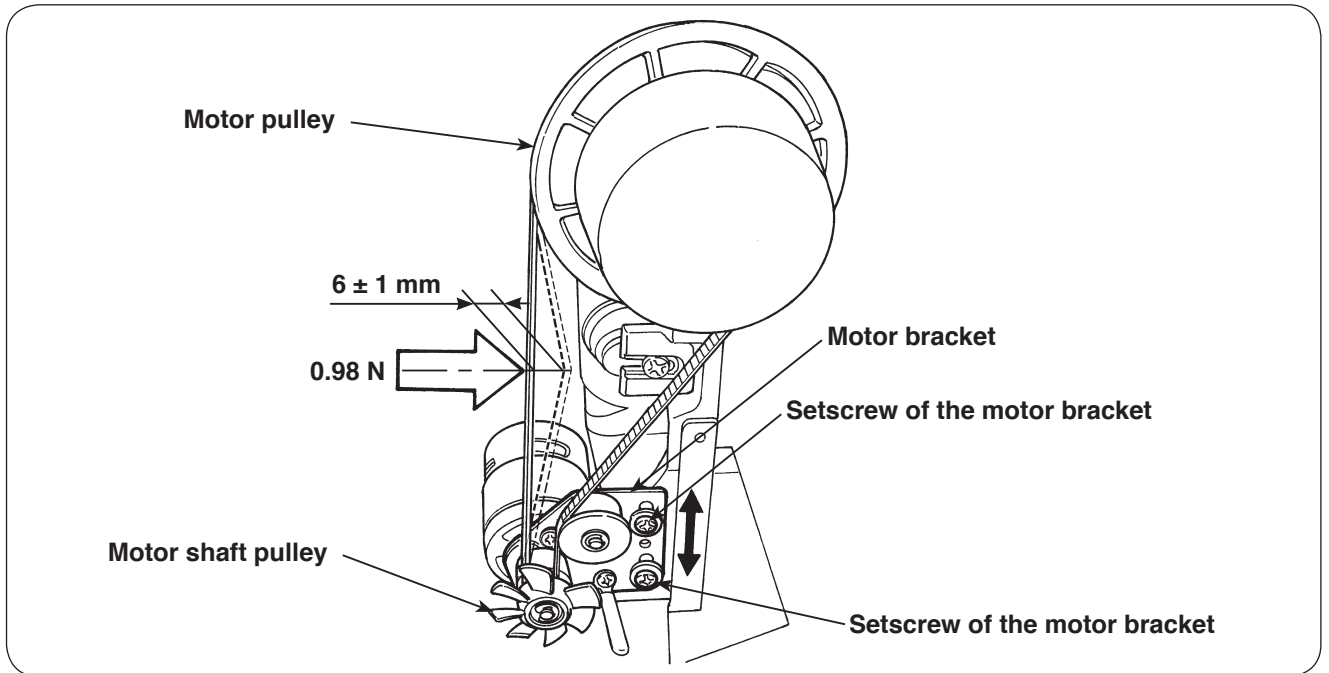

6-16 Automatic thread trimming (HZZ-G210)

6-16-1 Lateral position of the thread trimming mechanism base

Adjustment procedure

1. Turn the power switch OFF. Then, turn the power switch ON with the reverse stitch button and the thread trimming button held pressed simultaneously.
2. The Service mode screen is displayed. Select "12".
3. Press the automatic back-tack thread trimming button to activate the thread trimming mechanism.
4. In the aforementioned state, loosen two adjusting screws and move the thread trimming mechanism base laterally with pressed in P direction until the rear end of the catching unit is aligned with the marker line. Then, tighten the adjusting screws.

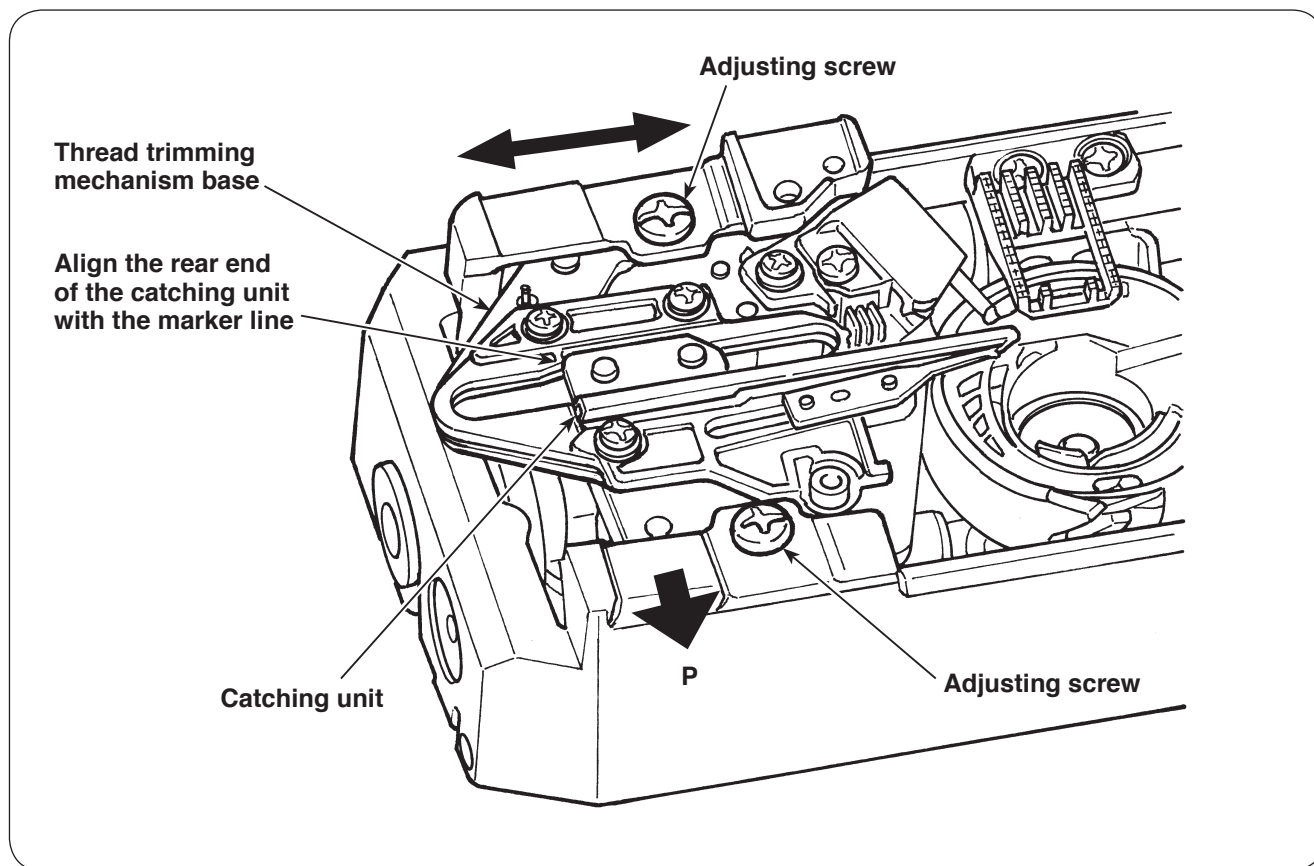

Caution: If the thread trimming mechanism base is inclined, a malfunction can be caused. Be sure to press the mechanism base toward P direction so that it will not tilt.

6-16-2 Phase of the catching unit driving cam

○ Carry out the adjustment with the power OFF.

Adjustment procedure

1. Loosen setscrews ❶ and ❷.
2. Turn the cam driving shaft in the direction of the arrow as shown in Fig. A, and the catching unit driving cam will rotate in the direction as shown in Fig. B. Turn the cam until it comes in contact with the pin.
3. Turn the intermediate gear in the direction of the arrow as shown in Fig. A until it comes in contact with the pin. (See Fig. C.)
4. In the aforementioned state, securely tighten setscrew ❶ while removing a thrust play between the cam driving shaft and the cam driving gear, right as shown Fig. D.
5. The aforementioned step connects the shaft and the gear. Then, turn the intermediate gear so that setscrew ❷ is brought to the front side. Then, securely tighten setscrew ❷.

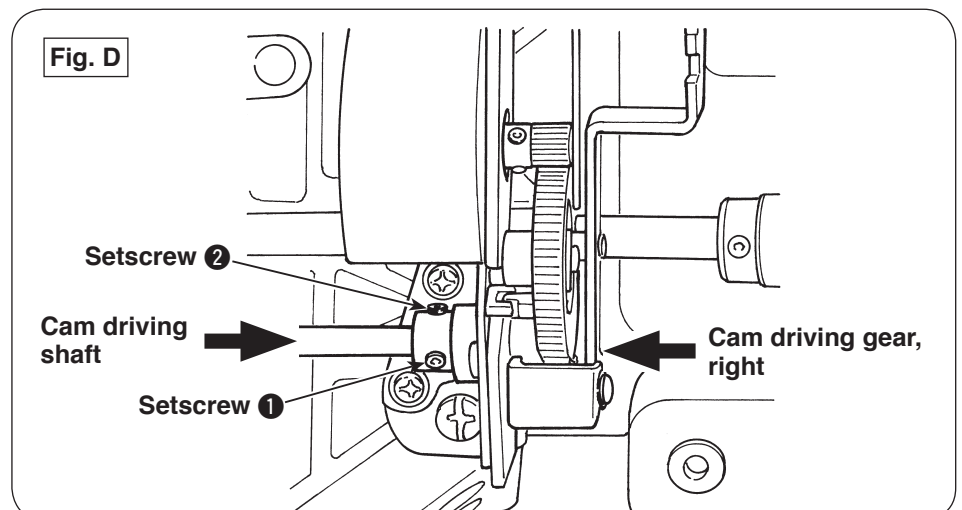
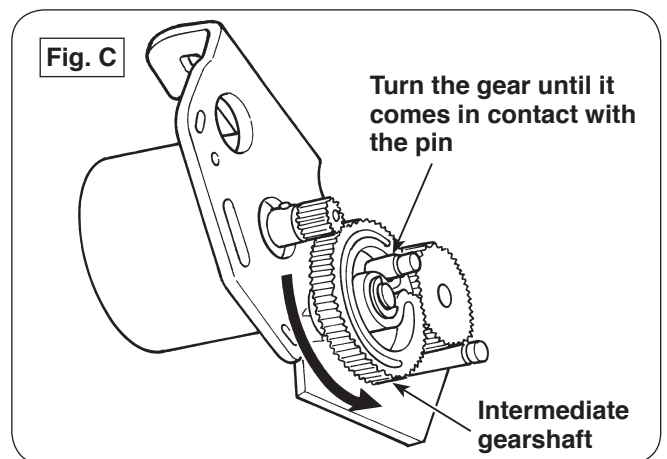
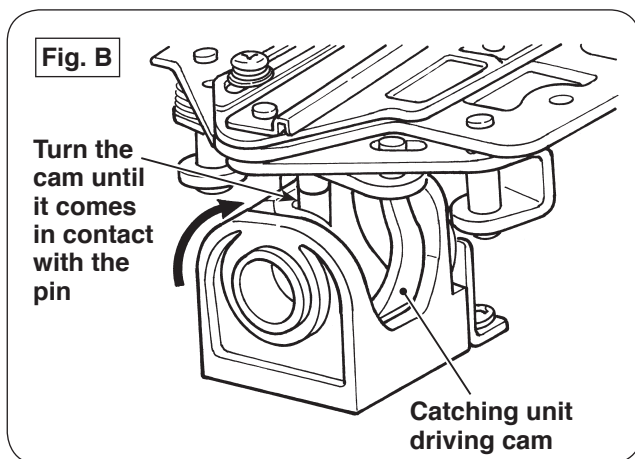
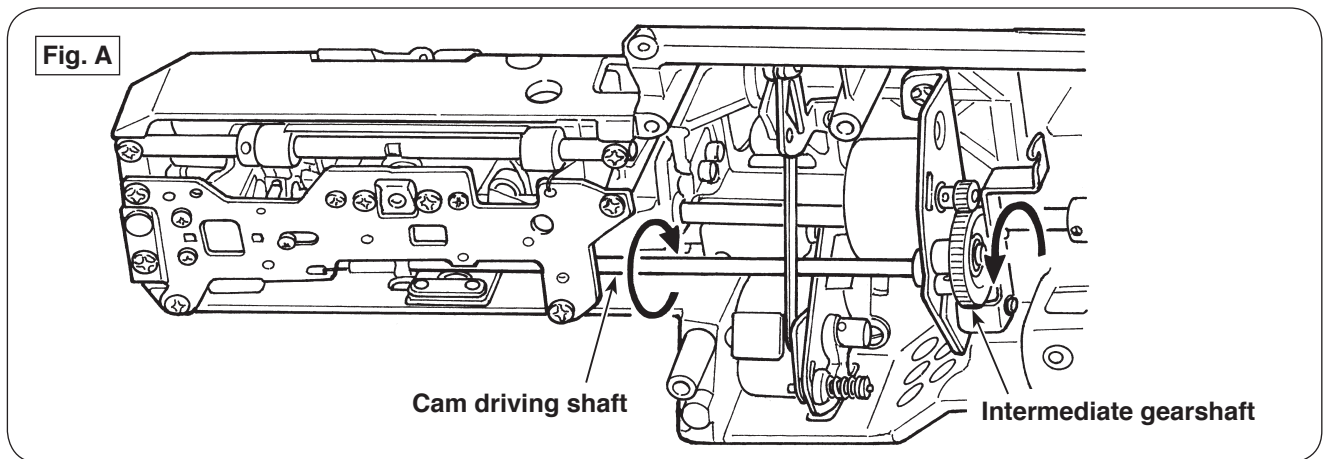

6-16-3 Replacing the thread trimming blade

Changing the thread trimming knife

1. Remove the throat plate.
2. Remove the setscrew of the thread trimming knife cover. Remove the thread trimming knife cover, the thread trimmer grasping unit and the thread trimming knife.
3. Reversing the disassembly procedure, assemble the parts. (Refer to the Caution below.)

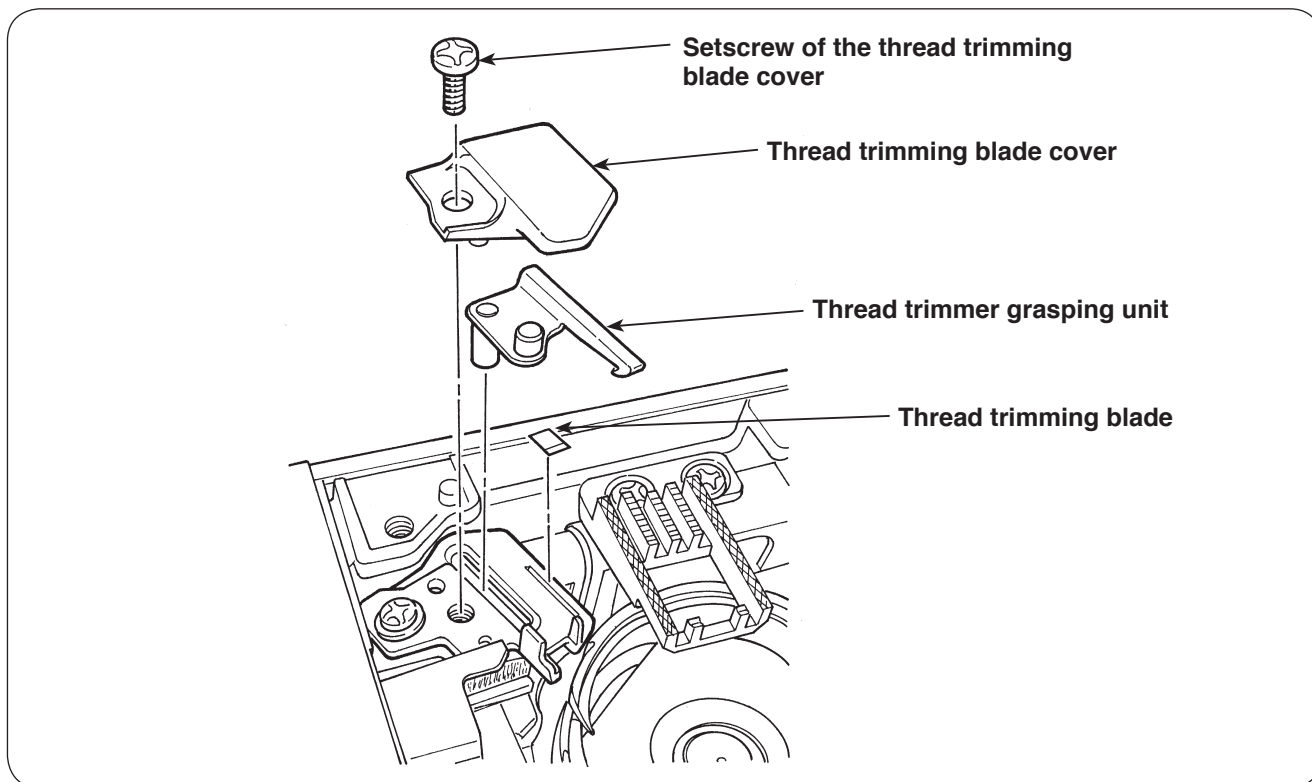

Caution: When assembling the thread trimmer grasping unit, put its pin into the slit in the thread trimmer link at the lower side of the mechanism section as illustrated below.

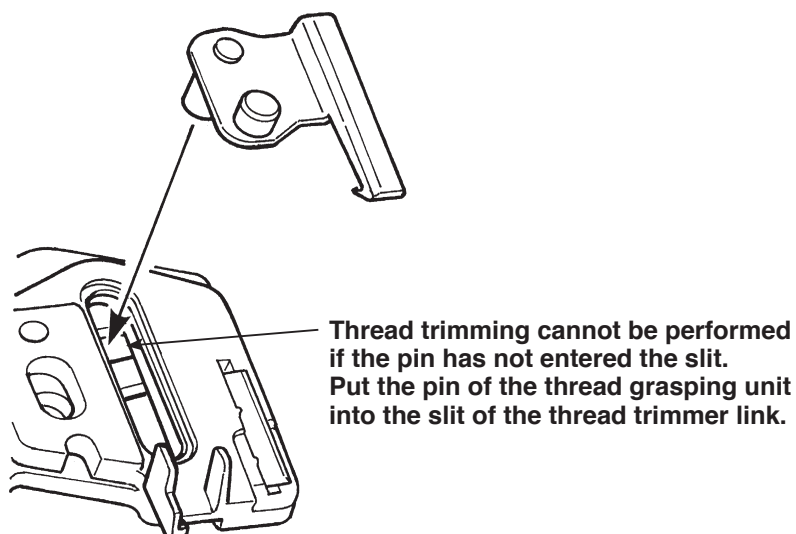

6-17 Longitudinal feed

Preparation for adjustment

Turn OFF the power switch. Keep pressing both the reverse stitch button and thread trimming button simultaneously and turn ON the power switch. The service mode screen appears on the display. Select "No. 3" to change over the screen to the sewing pattern for adjusting darning.

Adjustment procedure

Sew a darning sewing pattern three times under the aforementioned sewing conditions.

Adjust the third pattern as shown Fig. A by means of the feed adjusting button so that the lower end of the inner left line and the lower end of the right line of the replicating part of the pattern lie on the same line (reference error 0 ± 1 mm). (Refer to Fig. B for the direction of the adjustment.)

Fig. A

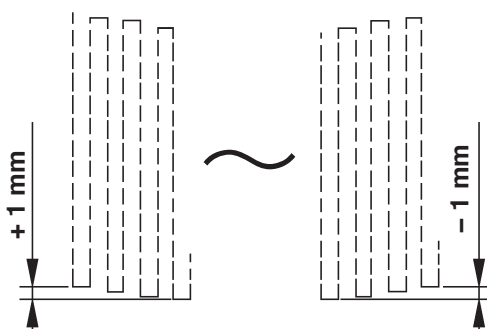
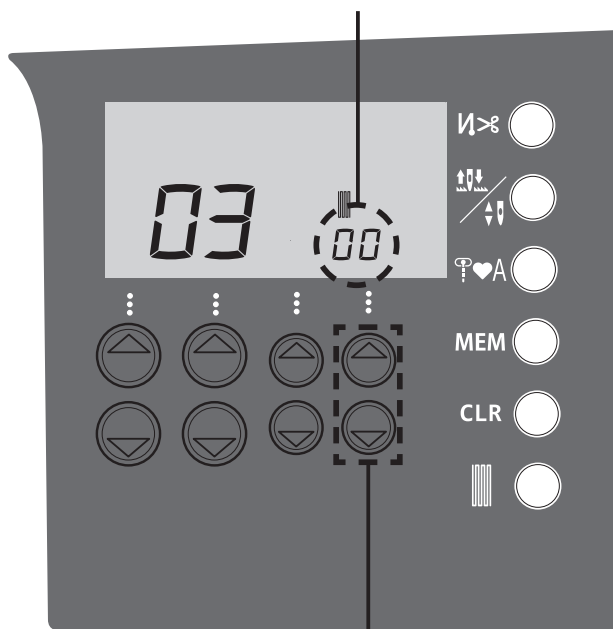

Fig. B

Lengthwise feed adjustment value



Feed adjusting button

Direction of adjustment of lengthwise feed

- In the case the lower end of the right line is higher than the lower end the inner left line

⇒ Adjust in + direction

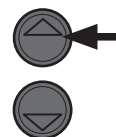
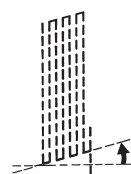

- In the case the lower end of the right line is lower than the lower end the inner left line

⇒ Adjust in - direction

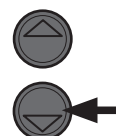
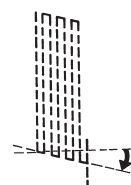

6-17 Buttonhole

Adjustment procedure

Lower the buttonholing lever to bring it in contact with the projecting part of the buttonholing foot.

In this state, loosen the screws and adjust the buttonholing switch so that its standby-side contact point is placed at the center of the range of movement of the lever.

The stitches at the beginning of sewing must be hidden under the bartacking part and circular part.

The side stitches at the end of sewing must not overrun from the bartacks or the former must not be spaced from the latter.

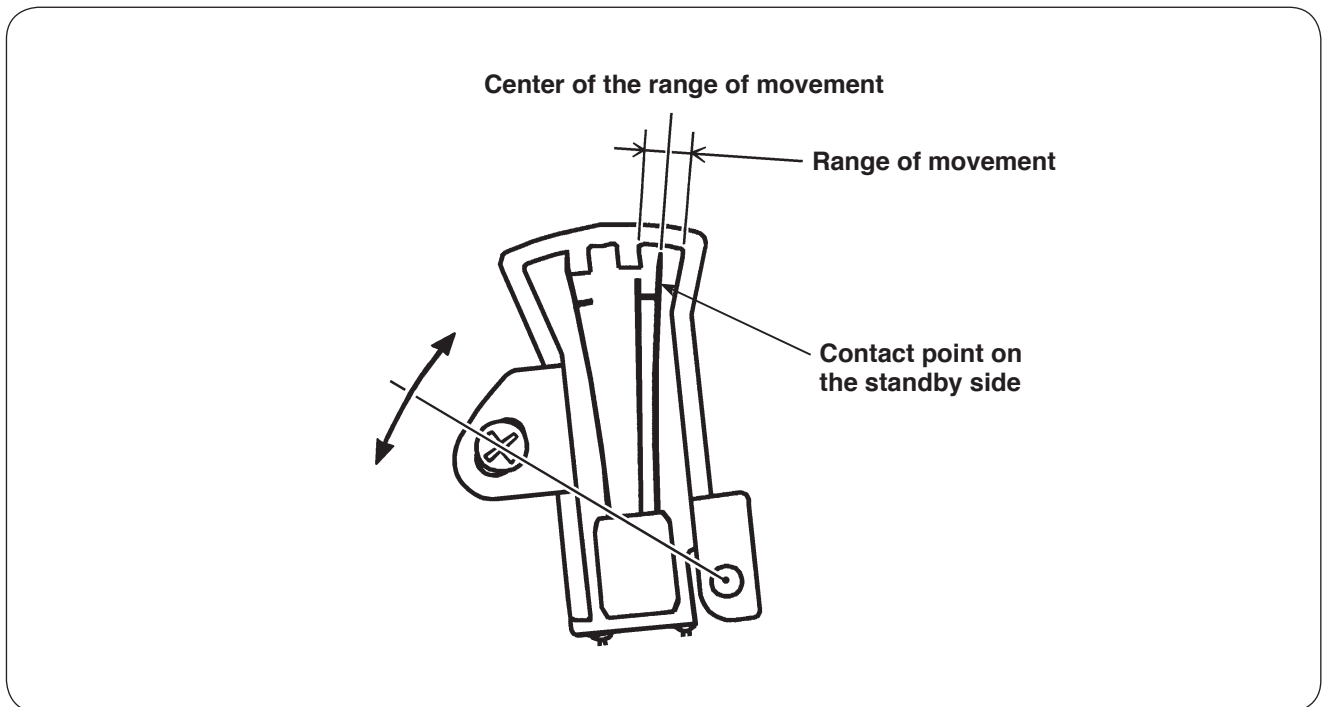



6-19 Service mode

6-19-1 Service mode screen

[How to select the service mode]

1. Turn the power switch OFF. In this state, turn the power switch ON with the two buttons (see the description below) held pressed simultaneously.
 - HZL-G210: Reverse stitch button and thread trimming button
 - HZL-G110: Reverse stitch button and needle up/down button
2. The service mode screen appears on the display. Select the number corresponding to the service item to operate.

* To select the corresponding number, advance or return the item one by one by means

of the pattern selection button  .

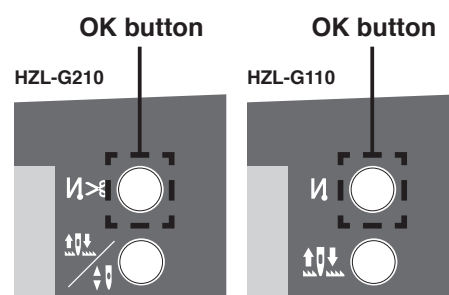

6-19-2 Service-mode items and descriptions

| No. | Item name | Description |
|-----|--------------------|---|
| 0 | Version check mode | The version is displayed when the sewing machine enters the Service Mode. Press the OK button to display the model; i.e., "210" or "110". |
| 1 | FEED 0 MODE | Select the straight stitch pattern and set the amount of feed at 0 (zero). Press the "OK" button to initialize the pattern to set the amount of feed to zero (0). |
| 2 | FAGOTT | Select the fagoting pattern. Set the zigzag width at 7.0 mm. The fagoting pattern can be sewn. |
| 3 | DARNING | Select the darning pattern and adjust the lengthwise feed. Darning pattern can be sewn with the initial value. |
| 4 | ZIG ZAG | Select the zigzag pattern. Zigzag pattern can be sewn with the initial value. |
| 5 | KIKKOU | Select the Kikkou pattern. Kikkou pattern can be sewn with the initial value. |
| 6 | OVERCASTING | Adjust the needle entry point for overcasting. Slide the needle entry points toward the needle throwing direction entirely by the specified number of pulses. The sliding amount can be adjusted with the "zigzag width adjusting" button. The adjustable range of the sliding amount is [-4 to 4]. Adjustment is made in increments of 1. |
| 7 | BLIND STITCH | Adjust the needle entry points on the left side of the blind stitch. Slide the needle entry points toward the needle throwing direction entirely by the specified number of pulses. The sliding amount can be adjusted with the "zigzag width adjusting" button. The adjustable range of the sliding amount is [-4 to 4]. Adjustment is made in increments of 1. |

| No. | Item name | Description |
|-----|--|---|
| 8 | THREAD TRIM CHECK | Thread trimming condition can be checked. Perform thread trimming halfway by using the "OK" button. From this condition, manually turn the main shaft to carry out the thread trimming sequence in order. |
| 9 | Tension release | Bring the disks to the floating condition. Operate the "OK" button, and the disks will float. |
| 10 | STRAIGHT 500STI/MIN | The maximum sewing speed is 500 sti/min (SPM) when the straight stitch pattern is selected. |
| 11 | LCD FLASH TEST | Indications on the LCD can be checked. Every time the "OK" button is pressed, the LCD lights up entirely and goes out entirely. |
| 12 | For adjusting the thread trimming mechanism base | Press the OK button to carry out thread trimming partway. When the thread trimming operation stops, check the lateral position of the thread trimming mechanism base. |
| 13 | Reserved | |
| 14 | FEED PULSE TEST1 | A straight line can be sewn with the amount of feed determined by the number of pulses. The straight stitch is selected as the sewing pattern. The number of pulses of feed can be adjusted using the "feed amount adjusting" button. The straight stitch pattern can be sewn with the feed amount determined by the adjusted number of pulses. |
| 15 | FEED PULSE TEST2 | Zigzag stitch can be sewn with the amount of feed determined by the number of pulses. The zigzag stitch is selected as the sewing pattern. The number of pulses of feed can be adjusted using the "feed amount adjusting" button. The zigzag stitch pattern can be sewn with the feed amount determined by the adjusted number of pulses. |
| 16 | Reserved | |
| 17 | WIND PWM | Output value of PWM for the bobbin winder is set. The PWM output value can be adjusted using the "zigzag width adjusting" button. It is possible to make adjustment while rotating the bobbin winder under the service mode. (The larger the value is, the faster the speed becomes.) The adjustable range of PWM output value is [15.0 to 79.1]. (Default is 54.0. Adjustment is made in increments of 0.5. Note that the indication is given in increments of 0, 1. |
| 18 | Reserved | |
| 19 | Reserved | |

JUKI®

JUKI CORPORATION
SEWING MACHINERY BUSINESS UNIT
2-11-1, TSURUMAKI, TAMA-SHI,
TOKYO, 206-8551, JAPAN
PHONE : (81)42-357-2371
FAX : (81)42-357-2380
<http://www.juki.com>

