

Digital freezers 1400 lt

The Electrolux HD-Line offers one of the most comprehensive choices of refrigerated storage cabinets available. Constructed internally and externally in stainless steel, operating over refrigeration or freezer temperature ranges, with solid or glass doors, and in a choice of either 650 or 1400 liter capacity. The freezer model detailed on this sheet has a capacity of 1400 liters.



728425

EASY TO INSTALL

- Mounted on adjustable stainless steel feet, with castors available as an option.
- Choice of doors to suit varying kitchen requirements.
- Operating temperature that can be adjusted from -15 °C to -24 °C.
- Suitable for ambient temperatures up to +43 °C.

EASY TO CLEAN

- Constructed from the highest quality AISI 304 stainless steel with radiused corners to the interior base, which is pressed from a single sheet.
- Evaporator unit is inset into the top of the refrigerated chamber to provide an obstruction free interior.

EASY TO USE

- Forced air circulation for rapid cool down and even temperature uniformity.
- Accommodates GN 2/1 containers or shelves on anti-tilt runners.
- External temperature display.
- Interior light.
- Lockable door.



Electrolux

**Electrolux HD-Line
Digital freezers 1400 lt**

EASY TO MAINTAIN

- Heavy-duty construction that avoids use of any plastic parts.
- Single refrigeration unit (compressor, condenser and evaporator) that can be removed in a single piece from either the top or back.
- Evaporator cover is easily removable for maintenance.

EASY ON THE ENVIRONMENT

- 20% reduction in energy consumption compared to previous models.
- Cabinet fitted with up to 75 mm thickness of cyclopentane insulation for best insulating performance with 100% environmental protection.

- Refrigerant type: R404a.
- CFC and HCFC free.
- All models comply with the standards required by the main international approval bodies and are H marked.

	RH14FD2F 728425
TECHNICAL DATA	
Operating temperature - min/max °C	-24/-15
Operating mode	Ventilated
External material	
panels	304 AISI
Gross capacity (D.I.N. 8952) - l.	1400
Cooling unit	Built-In
Control type	Digital
External dimensions - mm	
width	1500
depth/with open doors	810, 1463
height	2050
N° and type of door	2
Door hinges	1 Left+1 Right
N° and type of grids (included)	8, GN 2/1
Compressor power - HP	1
N° defrost in 24 hrs.	4/28'
Refrigerant type	R404a
Refrigerant quantity - g.	400
Refrigeration power - W	1150
Refrigerant power	
at evaporation temperature - °C	-34
Power - kW	
installed-electric	0.96
Net weight - kg.	248

HAB050

2009-10-20

Subject to change without notice

**Electrolux HD-Line
Digital freezers 1400 lt**

	RH14FD2F 728425
INCLUDED ACCESSORIES	
2 S/S RUNNERS FOR 600-650/1300-1400L.REF	8
2/1 GN GREY "RILSAN" GRID	8
ACCESSORIES	
1/1 GN RILSAN STEEL WIRE BASKET H=150 MM	881043
2 S/S RUNNERS FOR 600-650/1300-1400L.REF	881456
2/1 GN AISI 304 S/S GRID	881067
2/1 GN CHROME BASKET+2 RUNNERS H200	881468
2/1 GN GREY "RILSAN" GRID	880720
2/1 GN GREY RILSAN GRID W/ 2 RUNNERS	881454
2/1 GN PVC CONTAINER W/LID AND 2 RUNNERS	881462
3 GREY RILSAN CENTRAL GRIDS FOR 1400 L	881452
4 SWIVELLING WHEELS (2 W/ BRAKE)	880178
ENERGY FREE ALARM DEVICE	881089
GN 1/1 PLASTIC CONTAINER+FALSE BOTTOM	880705
GN 2/1 WIRE BASKET-H-150 MM+SIDE RUNNERS	881467
HACCP ADV.CONN.10 UNITS-DIG.REF.(ID9XX)	880119
HACCP ADV.CONN.80 UNITS-DIG.REF.(ID9XX)	880132
HACCP ADV.CONN.PER UNIT-DIG.REF.(ID9XX)	880133
KIT HACCP EKIS	922166
KIT PLINTH TO INSTALL HD REF. 1200/1400	880207
KIT TO FIT 11 PASTRY TRAYS (400X600 MM)	881031
MEAT RAIL FOR 650-1400 L REFRIGERATORS	881451
PEDAL OPENING FOR 1200/1400 L REFRIGER.	881459
PERFORATED SHELF GN 2/1	881042
PRINTER FOR HACCP BASIC VERSION REFRIG.	881457
SET OF 8-1/1 GN PVC CONTAINERS FOR FISH	881461

HAB050

2009-10-20

Subject to change without notice

Electrolux HD-Line
Digital freezers 1400 lt

728425

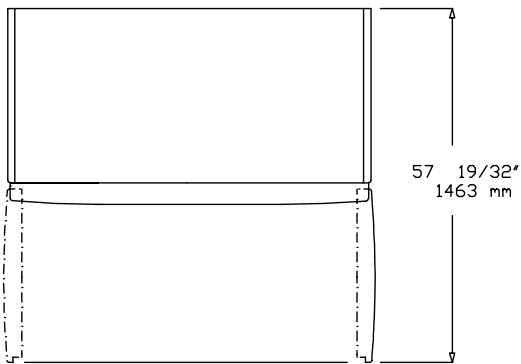
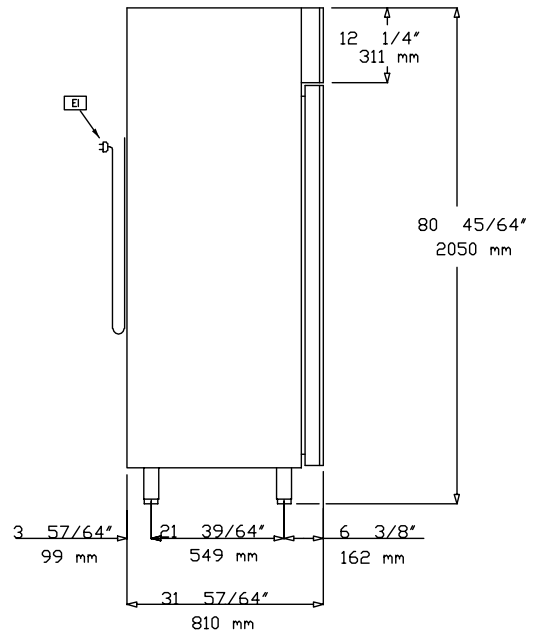
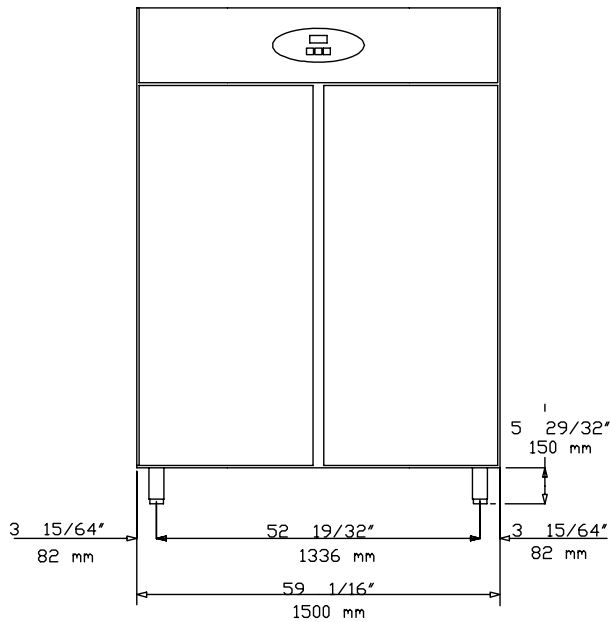

589729100

LEGEND

EI - Electrical connection

**RH14FD2F
728425**

230 V, 1N, 50

HAB050

2009-10-20

Subject to change without notice