

ARCTIS

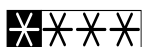

G 78850-4 i

Freezer
Operating Instructions

Dear customer,

Before **switching** on your new **appliance** please read these operating instructions carefully. They contain important information for safe use, for installation and for care of the appliance.

Please keep these operating instructions for future reference. Pass them on to possible new owners of the appliance.

These operating instructions are for use with several technically comparable models with varying accessories. Please observe the notes which apply to your model.



Notes which are important for your safety or for the proper functioning of the appliance are stressed with a warning triangle and/or with signal words (**Warning!**, **Caution!**, **Important!**). Please observe the following carefully.

1. This symbol guides you step by step in the operation of the appliance.
2.



Supplementary information regarding operation and practical applications of the appliance appear after this symbol.



Tips and notes concerning economical and environmentally sound use of the appliance are marked with the cloverleaf.

The operating instructions contain instructions for the correction of possible malfunctions by the user in the section "What to do if ...". If these instructions should not be sufficient, contact your local Service Force Centre.

Printed on paper manufactured with environmentally sound processes
he who thinks ecologically acts accordingly...

Contents

Important Safety Instructions	4
Disposal	6
Appliance Packaging Information	6
Disposal of Old Appliances	6
Remove Transport Packaging	7
Installation	7
Installation Location	7
Your Freezer Needs Air	8
Building-in	8
Power Supply	12
Electrical Connection	13
Description of the Appliance	14
View of the Appliance	14
Ice Pack	15
Prior to Initial Start-Up	15
Operating and Indicator Panel	16
Warning System	17
Starting Up and Temperature Regulation	18
Switching Off the Appliance	18
Freezing and Storing Frozen Food	19
Storage Goods Symbol/Freezing Calendar	20
Preparation of Ice Cubes	21
Defrosting	21
Cleaning and Care	22
Magnetic Door Seal	23
Energy Saving Tips	23
What to do if	24
Correcting Malfunctions	24
Noises During Operation	26
Regulations, Standards, Guidelines	26
Technical Terminology	27
Customer Care Department	28
Guarantee Conditions	29



Important Safety Instructions

These warnings are provided in the interests of your safety. Ensure you fully understand them before installing or using the appliance. Your safety is of paramount importance. If you are unsure about the meaning of these warnings contact the Customer Care Department for assistance.

Intended use

- The freezer is intended for use in the home. It is suitable for freezing of fresh food and storing frozen food, as well as for making ice. If the appliance is used for purposes other than those intended or used incorrectly, no liability can be accepted by the manufacturer for any damage that may be caused.
- Alterations or changes to the freezer are not permitted for reasons of safety.
- If you use the freezer in a commercial environment or for purposes other than the freezing or frozen storage of foods, the manufacturer accepts no liability for any damages which may occur.

Prior to initial start-up

- Check the appliance for transport damage. Under no circumstance should a damaged appliance be plugged in. In the event of damage, please contact your supplier.
- Ensure that the appliance does not stand on the electrical supply cable. **Important:** if the supply cable is damaged, it must be replaced by a cable available from the manufacturer or your local Service Force Centre.

Refrigerant

The refrigerant isobutane (R600a) is contained within the refrigerant circuit of the appliance, a natural gas with a high level of environmental compatibility, which is nevertheless flammable.

- During transportation and installation of the appliance, be certain that none of the components of the refrigerant circuit become damaged.
- If the refrigerant circuit should become damaged:
 - avoid open flames and sources of ignition;
 - thoroughly ventilate the room in which the appliance is situated.

Safety of children

- Packaging (e.g. wraps, polystyrene) can be dangerous for children. There is a risk of suffocation! Keep packaging material away from children!

- Please make old appliances unusable prior to disposal. Pull out the mains plug, cut off the mains cable, break or remove spring or bolt catches, if fitted. By doing this you ensure that children cannot lock themselves in the appliance when playing (there is risk of suffocation!) or get themselves into other dangerous situations.
- Often children cannot recognise the hazards present in household appliances. It is therefore important that you ensure adequate supervision and never let children play with the appliance!

Daily Operation

- Containers with flammable gases or liquids can leak at low temperatures. There is a risk of an explosion! Do not store any containers with flammable materials such as spray cans, fire extinguisher refill cartridges etc in the refrigerator/freezer.
- Bottles and cans must not be placed in the freezer. They can burst when the contents freeze, high carbonate content drinks can even explode! Never store lemonade, juices, beer, wine, sparkling wine etc. in the freezer. Exception: high alcohol content spirits can be stored in the freezer.
- Do not put ice creams or ice cubes in the mouth immediately after removal from the freezer. Very cold ice can freeze to the lips or tongue and cause injury.
- Do not touch frozen food with wet hands. Your hands could stick to the food causing skin abrasions.
- **Warning** - Do not operate any electrical appliances in the refrigerator and/or freezer (e.g. electric ice cream makers, mixers etc.).
- **Warning** - In order not to impair the function of the appliance, never cover or obstruct the ventilation openings.
- **Warning** - Do not damage the cooling circuit.
- **Warning** - Do not use any mechanical devices or other artificial means to speed up defrosting unless they are recommended by the manufacturer.
- Before cleaning the appliance, always switch off the appliance and unplug it, or disconnect from the electricity supply.
- When unplugging always pull the plug from the mains socket, do not pull on the cable.

In case of malfunction

- If a malfunction occurs on the appliance, please look first in the "What to do if ..." section of these instructions. If the information given there does not help, please do not perform any further repairs yourself.

- This product should be serviced by an authorised engineer and only genuine spare parts should be used.
- Under no circumstances should you attempt to repair the appliance yourself. Repairs carried out by inexperienced persons may cause injury or serious malfunctioning. Contact your local Service Force Centre.

Disposal

Appliance Packaging Information

All materials are environmentally sound! They can be disposed of or burned at an incinerating plant without danger.

About the materials: The plastics can be recycled and are identified as follows:

>PE< for polyethylene, e.g. the outer covering and the bags in the interior.

>PS< for polystyrene foam, e.g. the pads, which are all free of chloro-fluorocarbon.

The carton parts are made from recycled paper and should be disposed of at a waste-paper recycling collection location.

Disposal of Old Appliances

For environmental reasons, refrigeration appliances must be disposed of properly. This applies to your old appliance, and – at the end of its service life – for your new appliance as well.



Warning! Before disposing of old appliances make them inoperable. Remove plug from mains, sever the power cable, remove or destroy any snap or latch closures. This ensures **blue children** do not lock themselves inside the appliance (danger of suffocation!) or place themselves into other life-endangering situations.

Disposal:

- The appliance may not be disposed of with domestic waste or bulky refuse.
- The refrigerant circuit, especially the heat exchanger at the back of the appliance, must not be damaged.
- The symbol  on the product or on its packaging indicates that this product may not be treated as household waste. Instead it shall be handed over to the applicable collection point for the recycling of electrical and electronic equipment. By ensuring this product is

disposed of correctly, you will help prevent potential negative consequences for the environment and human health, which could otherwise be caused by inappropriate waste handling of this product. For more detailed information about recycling of this product, please contact your local city office, your household waste disposal service or the shop where you purchased the product.

Remove Transport Packaging

The appliance and the interior fittings are protected for transport.

1. Pull off the adhesive tape on the left and right side of the door.
2. Remove all adhesive tape and packing pieces from the interior of the appliance.

Installation

Installation Location

The appliance should be set up in a well ventilated, dry room.

Energy use and efficient performance of the appliance is affected by the ambient temperature.

The appliance should therefore

- not be exposed to direct sunlight;
- not be installed next to radiators or other sources of heat;
- only be installed at a location whose ambient temperature corresponds to the climate classification, for which the appliance is designed.

The climate classification can be found on the serial plate, which is located at the left on the inside of the appliance.

The following table shows which ambient temperature is correct for each climate classification:

Climate classification	for an ambient temperature of
SN	+10 to +32 °C
N	+16 to +32 °C
ST	+18 to +38 °C
T	+18 to +43 °C

Installation directly under a hob is not allowed. The temperatures of the hob, which in part are quite high, may damage the appliance. If a hob is installed near the appliance, the corresponding installation

and safety instructions must be adhered to. Considering the numerous installation conditions which are possible, there is no way of providing detailed information here.

It is necessary to avoid overheating of the refrigerator by maintaining adequate distances from heat sources and by the use of a suitable thermal insulation plate. Proper ventilation of the appliance must also be ensured.

Your Freezer Needs Air

Integratable models (i-appliances)

The integrated door of the furniture cabinet largely seals the installation recess. i-appliances must therefore be provided with ventilation by having an opening in the furniture plinth. The warmed air must be able to be exhausted upwards through the air shaft on the furniture back. The ventilation cross-sections should be at least 200 cm².

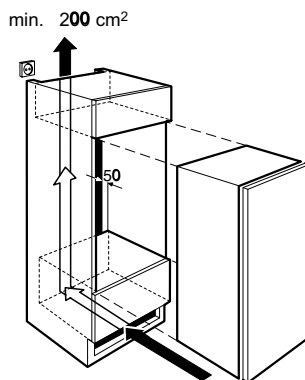

Warning - To ensure the appliance functions correctly, never cover or obstruct the ventilation openings.

Building-in

Please check whether, after installing your appliance and especially after reversing the door, the door seal seals right round. A badly fitting door seal may lead to heavy frosting and thereby to a higher power consumption (see also „What to do if...“).

Dimensions of the recess

Height of housing 880 mm

Depth of housing 550 mm

Width of housing 560 mm

It is necessary that the cabinet has a ventilation recess (at least 200 cm²).

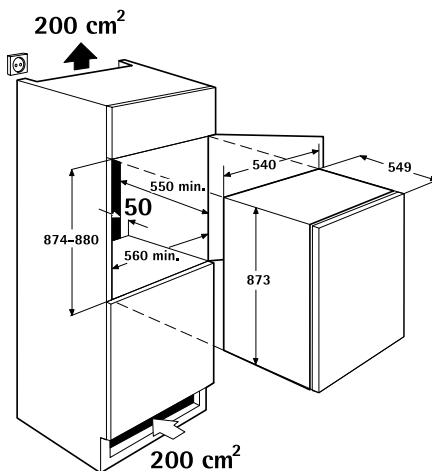

1. The appliance's door has been locked in position for transport by means of pins on both sides. According to the door opening direction, remove relevant pins at the top and at the bottom.

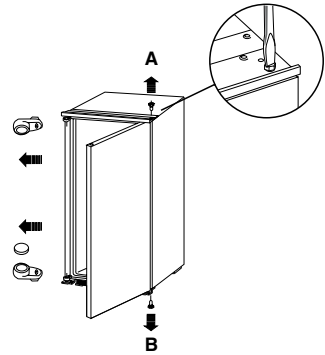

2. Press in the joint covers between the appliance and the kitchen furniture.

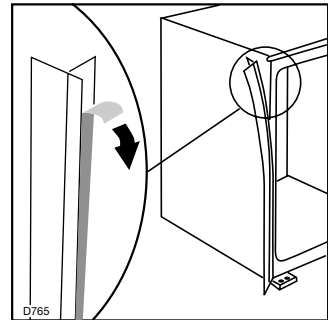

3. Push the appliance into the housing until stop strip (A) touches the kitchen unit.

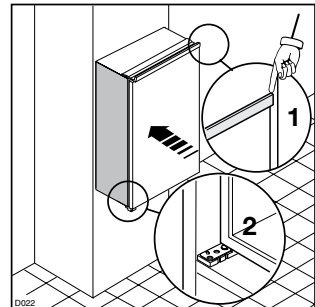

4. Fasten the appliance with 4 screws provided in the kit included with the appliance. (I = short)

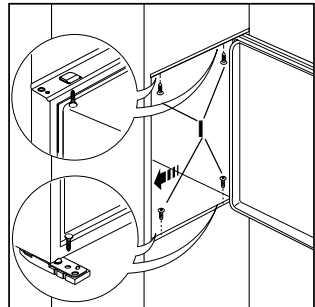

5. Apply covers (C-D) into the relevant holes. Snap ventilation grille (B) and hinge cover (E) into position.

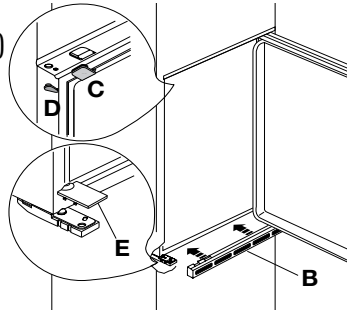

6. Separate parts Ha, Hb, Hc, Hd as shown in the figure.

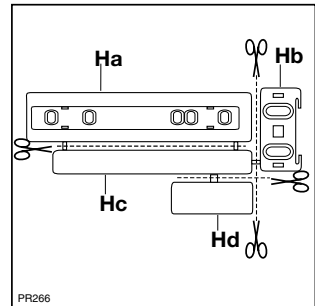

7. Place guide (Ha) on the inside part of the furniture door, upper and lower positions as shown in the figure and mark the position of external holes. After having drilled holes, fix the guide with the screws supplied.

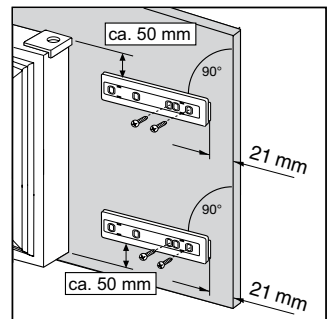

8. Fix cover (Hc) on guide (Ha) until it clips into place.

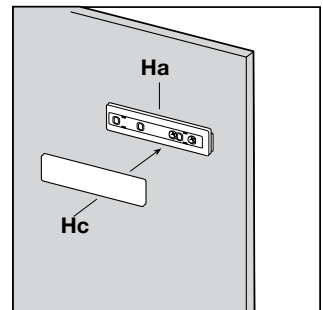

9. Open the appliance door and the furniture door at 90°. Insert the small square (Hb) into guide (Hb). Put together the appliance door and the furniture door and mark the holes as indicated in the figure.

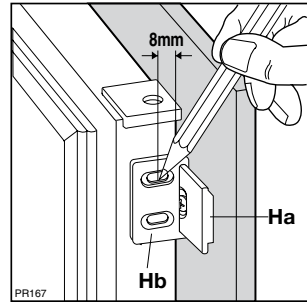

10. Remove the brackets and mark a distance of 8 mm from the outer edge of the door where the nail must be fitted (K).

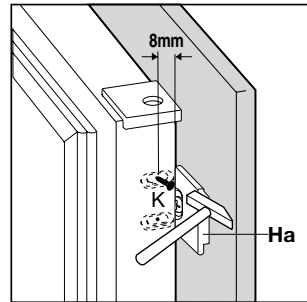

11. Place the small square on the guide again and fix it with the screws supplied.

At the end of installation/adjusting, it is necessary to check if the door of the furniture closes properly.

Should adjustment of the furniture door be necessary, use the clearance of slots.

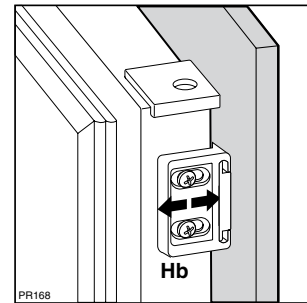

12. Fix cover (Hd) on guide (Hb) until it clips into place.

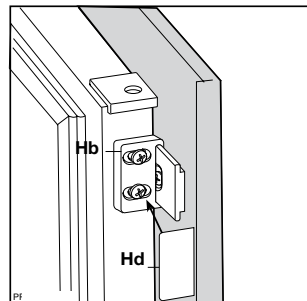

Power Supply

A correctly installed, earthed socket is required for the electrical supply. The supply must have a fuse rating of at least 13 Amps. If the socket is not accessible once the appliance is built in, the electrical installation must include suitable means of isolating the appliance from the mains (e.g. a fused spur).

Before initial start-up, refer to the appliance rating plate to ascertain if supply voltage and current values correspond with those of the mains at the installation location.

e.g.: AC 220 ... 240 V 50 Hz or
220 ... 240 V ~50 Hz

(i.e. 220 to 240 volts alternating current, 50 Hertz)

The rating plate is inside the appliance on the left.

The mains cable may only be changed by a qualified electrician or competent person. If your appliance needs repairing, please contact your local [Service Force Centre](#).

Electrical Connection

Any electrical work required to install this appliance should be carried out by a qualified electrician or competent person.



WARNING – THIS APPLIANCE MUST BE EARTHED

The manufacturer declines any liability should these safety measures not be observed.

Before switching on, make sure the electricity supply voltage is the same as that indicated on the appliance rating plate. The rating plate is inside, on the left.

The appliance is supplied with a 13 amp plug fitted. In the event of having to change the fuse in the plug supplied, a 13 amp ASTA approved (BS 1362) fuse must be used.

Important

The wires in the mains lead are coloured in accordance with the following code:

Green and Yellow:	Earth
Blue:	Neutral
Brown:	Live

As the colours of the wires in the mains lead of this appliance may not correspond with the coloured markings identifying the terminals in your plug, proceed as follows:

1. The wire coloured green and yellow must be connected to the terminal marked with the letter "E" or by the earth symbol or coloured green and yellow.
2. The wire coloured blue must be connected to the terminal "N" or coloured black.
3. The wire coloured brown must be connected to the terminal marked "L" or coloured red.
4. Upon completion there must be no cut, or stray strands of wire present and the cord clamp must be secure over the outer sheath.

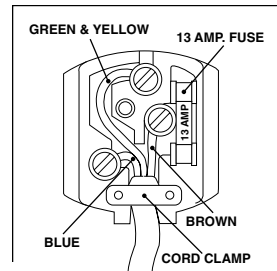

Warning! A cut-off plug inserted into a 13 amp socket is a serious safety (shock) hazard. Ensure that the cut-off plug is disposed of safely.

Description of the Appliance

View of the Appliance

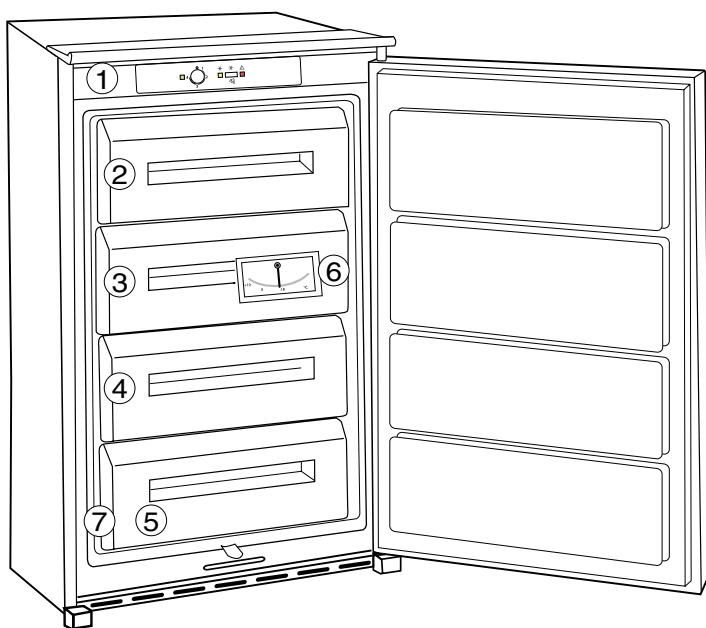

1 = Control panel

2 = Drawer (for storing frozen food and freezing fresh produce)

3 = Drawer (for storing frozen food and freezing fresh produce)

4 = Drawer (for storing frozen food only)

5 = Drawer (for storing frozen food only)

6 = Temperature display

7 = Rating plate

The freezer has stops to prevent the drawers from falling out when fully extended.

To remove the drawers (e.g. for cleaning purposes), pull them out as far as the stops, lift and extract.

Ice Pack

There is an ice pack in one drawer of the freezer.

Refer to the section "Prior to Initial Start-Up" concerning freezing of the ice pack.



In the event of a power failure or malfunction, the ice pack will lengthen the amount of time it takes for the frozen food to defrost by several hours.

The ice pack can only fulfil this task if it is placed in the uppermost drawer, at the front, above the frozen food.

You can use the ice pack for cooling cold bags.

Prior to Initial Start-Up

1. Please clean the appliance interior and all accessories prior to initial start-up (see section: "Cleaning and Care").
2. Remove the ice pack from the appliance.
3. Only put the ice pack to freeze in the top drawer after the optimum storage temperature of -18°C has been reached.
4. Re-freeze thawed ice pack in the same way, e. g. after cleaning the appliance.

Operating and Indicator Panel

Important! Only use the appliance when built-in!

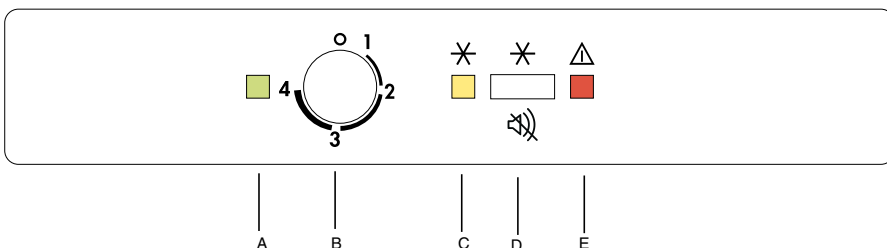

- A Pilot light (green)
- B Thermostat control knob
- C Fast freeze light (yellow)
- D Fast freeze button, also used to switch off the warning tone
- E Warning light (red)

The **green pilot light (A)**, which comes on switching the temperature regulator to a number position, the refrigerating unit automatically operates by system control a sound is on only for 2 sec.

The **green pilot light (4)**, which comes on when the appliance is switched on and the mains voltage is available. In this switch position, the refrigerating unit operates automatically.

The **thermostat control knob (B)** can be used for the variable setting of the storage temperature for your frozen food.

The optimum storage conditions occur at -18°C and can be checked at the **thermometer (fig.)**.

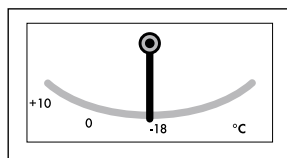

The **fast-freeze button (D)** with its **yellow pilot light (C)**. The yellow pilot light comes on when the switch (D) has been operated. The refrigerating unit then operates continuously.

The **red temperature warning light (3)** blinks when:

- the appliance has been started up but the storage temperature has not yet been reached;
- the minimum storage temperature is no longer being maintained ;
- excessive amounts of fresh food are placed inside; or
- if the appliance door is open for too long.

Important note: if you operate the **fast freeze** button or adjust the temperature control knob, your appliance's refrigeration motor may

not start immediately, but does after some time. This does not mean that your appliance has a fault.

After adjusting the temperature, leave the appliance to set temperature and allow 24 hours for the temperature to stabilise before making further changes.

1. Turn the thermostat control knob to the desired setting with the aid of a coin.
2. The compressor starts and then runs automatically. The green pilot light illuminates.

Important! Wait until the freezer compartment has reached a temperature of -18°C , or the red warning light has gone out, before storing frozen food.

Warning System

The warning system comprises of an optical warning light (red) and an acoustic warning tone. The red warning light and the warning tone signal an alarm if the temperature in the freezer compartment is too warm.

Temperature Warning

The red warning light blinks and the warning tone sounds if the temperature in the freezer compartment is warmer than -12°C .

An increase in the temperature in the freezer compartment may be caused by

- frequent or extended opening of the door;
- storing large quantities of warm food;
- a high ambient temperature;
- a malfunction in the cooling system.

1. Switch off the warning tone by pressing the fast freeze button. The yellow fast freeze light illuminates. The red warning light blinks until the required temperature has been reached again.
2. After the storage temperature has been reached, press the fast freeze button again to switch off the fast freeze function. The yellow light goes out.

Note: when the appliance is switched on for the first time, the warning light and the warning tone signal an alarm because the necessary storage temperature in the freezer compartment has not yet been reached.

Starting Up and Temperature Regulation

1. Turn the thermostat regulator knob (B) in the direction of "1", a sound is on only for 2 sec. The compressor starts and then runs automatically.
2. The red lamp (E) blinks and the sound alarm signal. Reset the sound alarm signal pushing the switch (D) . The red light continuously blinks. Operate the fast-freeze switch (D) once again. The yellow pilot lamp (C) comes on.
3. Only when the red light (E) has gone out should you reset the fast-freeze button (D). The yellow light (C) goes out and the audible warning mode is activated again.
The temperature regulator (B) can be used to set the required storage temperature, -18°C or colder.

Setting "1" means:

highest, warmest internal temperature

Setting "4" means:

lowest, coldest internal temperature

Recommended regulator setting:

1.5 to 2.

Important: Regularly check on the red temperature pilot light (E) and the thermometer that the required storage temperature is being maintained.

Switching Off the Appliance

To switch off the appliance, turn the thermostat control knob to position "0" .

If the appliance is not going to be used for an extended period:

1. Remove all deep-frozen packages as well as ice-trays.
2. Switch off the appliance by turning the temperature regulator to position "0".
3. Remove the mains plug or switch off or disconnect from the electricity supply.
4. Defrost freezer and clean thoroughly (see section: "Defrosting and Cleaning").
5. Leave the door open to avoid the build up of odours.

Freezing and Storing Frozen Food

You can use your freezer for freezing fresh food yourself.

Important!

- The temperature in the freezer compartment must be -18°C or colder before freezing food.
 - Please observe the freezing capacity given on the rating plate. The freezing capacity is the maximum quantity of fresh food that can be frozen within a period of 24 hours. If you wish to freeze food several days in a row, please observe a maximum capacity of only $\frac{2}{3}$ to $\frac{3}{4}$ of that on the rating plate. The quality of the food is best preserved when it is frozen right through to the core as quickly as possible.
 - Allow warm food to cool down before freezing. The warmth will cause increased ice formation and increase the power consumption.
 - Please note the maximum storage times specified by the manufacturer.
 - Thawed foods which have not been processed further (cooked into meals) may not under any circumstances be frozen a second time.
 - Containers with flammable gases or liquids can leak at low temperatures. There is a risk of an explosion! Do not store any containers with flammable materials such as, for example, spray cans, fire extinguisher refill cartridges etc in the refrigerator/freezer.
 - Bottles and cans must not be placed in the freezer. They can burst when the contents freeze, high carbonate content drinks can even explode! Never store lemonade, juices, beer, wine, sparkling wine etc. in the freezer.
1. Press the fast freeze button for the freezing of fresh food. The yellow light illuminates.

To utilise the maximum rated freezing capacity, switch on the fast freeze switch 24 hours before freezing is due to start (the yellow light illuminates). For smaller amounts the fast freeze switch should be switched on 4 - 6 hours in advance. If the quick-freezing function is not ended manually, the appliance switch off the quick-freezing function after 52 hours. The yellow light goes out.

2. All foods must be packed air tight prior to freezing, so that they do not dry out or lose their flavour, and so that no flavour contamination of other frozen goods occurs.

Caution! Do not touch frozen food with wet hands. Your hands could stick to the food and cause skin abrasions.

3. Place the packed food in the drawers. Place food to be frozen in the appliance's two top drawers (2) and (3) equipped with their own refrigerated shelves. Unfrozen food must not touch items already frozen, otherwise the frozen food could begin to defrost. Freezer drawers (4) and (5) should only be used for storage of frozen food.



Place frozen food in the drawers sorted by type, as far as possible.

4. Once the food has frozen, press the fast freeze button again. The yellow light goes out.

Tips:

- The following are suited for the packaging of frozen goods:
 - freezer bags and polyethylene wraps;
 - special containers for frozen goods;
 - extra-thick aluminium foil.
- The following are suitable for sealing bags and wrap: plastic clips, rubber bands or tape.
- Smooth the air out of the bag before sealing; air makes it easier for the frozen food to dry out.
- Make flat packages, because these freeze more quickly.
- Do not fill containers for frozen goods to the brim with liquid or paste-like goods, because liquids expand during freezing.

Storage Goods Symbols/Freezing Calendar

- The symbols on the drawers show different types of frozen goods.
- The numbers indicate storage times in months for the appropriate types of frozen goods. Whether the upper or lower value of the indicated storage time is valid depends on the quality of the foods and pre-treating before freezing. The lower value applies to foods with high fat content.

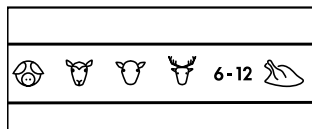

Preparation of Ice Cubes

1. Fill the ice cube tray 3/4 full with cold water, place it in the freezer compartment and leave to freeze.
2. To loosen the frozen cubes, either bend the ice cube tray or hold it under running water for a few seconds.

Important! Never try to free an ice tray that is frozen to the freezer compartment using pointed or sharp edged objects. Use the ice scraper supplied.

Defrosting

During use and when the door is opened, moisture is deposited as frost inside the appliance, particularly on the evaporator. This frost must be removed from time to time using the soft plastic scraper supplied. Under no circumstances use hard or pointed objects for this purpose.

The freezer should always be defrosted when the layer of frost has reached a thickness of approx. 4 millimetres. Defrost should be carried out once a year regardless of the amount of frost that has built up. A good time for defrosting is when the appliance is empty or contains only a small amount of food.

Each temperature rise reduces the keeping qualities of your frozen food. Around 12 hours before defrosting your freezer, switch over to [fast freeze](#) to build up a low temperature reserve in the frozen food.



Warning!

- Do not use electrical heating appliances or any other mechanical or artificial devices to speed up the defrosting process.
- Do not use defrosting sprays, they can be hazardous to your health and/or contain substances that damage plastics.

Caution! Do not touch frozen food with wet hands. Your hands could stick to the food and can cause skin abrasions.

1. Switch on the [fast freeze](#) function a few hours before defrosting to make sure frozen food remains sufficiently frozen.
2. Remove frozen food, wrap it in several layers of newspaper and store it, covered, in a cool place.
3. Switch off the appliance and unplug it, or disconnect from the electricity supply.

4. Remove all drawers. Insert the plastic scraper in the special location to act as an extension channel and place a basin underneath to collect the defrost water.

Tip: To speed up the defrosting process, place a **plastic bowl** with warm water in the appliance and close the door. Remove pieces of ice that have fallen before they completely defrost.

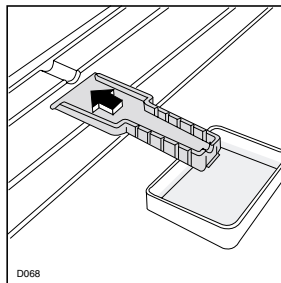

5. After defrosting, thoroughly clean the freezer compartment and interior fittings (see "Cleaning and Care" section).
6. Do not forget to switch the **fast freeze** function off again.

Cleaning and Care

For hygienic reasons the appliance interior, including interior accessories, should be cleaned regularly.



Warning!

- The appliance must not be connected to the mains during cleaning. Danger of electrical shock! Before cleaning switch the appliance off and remove the plug from the mains, or switch off or turn out the circuit breaker or fuse.
- Never clean the appliance with a steam cleaner. Moisture could accumulate in electrical components and there is a danger of an electric shock. Hot vapours can lead to the damage of plastic parts.
- The appliance must be dry before it is **switched back on**.

Important!

- Ethereal oils and organic solvents can attack plastic parts, e.g.
 - lemon juice or the juice from orange peel;
 - butyric acid;
 - cleansers which contain acetic acid.

Do not allow such substances to come into contact with appliance parts.

- Do not use any abrasive cleansers.

1. Remove frozen food and wrap it in several layers of newspaper. Store it in a cool place, well covered.
2. Defrost the appliance prior to cleaning (see "Defrosting" section).
3. Switch off the appliance and unplug it.

4. Clean the appliance and the interior accessories with a cloth and luke-warm water. A mild solution of washing up liquid and water may also be used.

5. After cleaning wipe with fresh water and rub dry.



To guarantee a safe operation of the fridge, once a year remove the ventilation grill at the base and clean the air channels with a vacuum cleaner.

6. After everything is dry, switch to fast freeze. After running the appliance for two or three hours, it is ready again for storing frozen food.

Magnetic Door Seal

After opening and closing the door of your freezer whilst it is in operation, you will not immediately be able to open the door again because a vacuum will have developed inside, keeping the door closed until the pressures inside and outside the door have equalised. After a few minutes you can easily reopen the door.



Energy Saving Tips

- Do not install the appliance near boilers, radiators or other sources of heat. High ambient temperatures cause longer, more frequent operation of the compressor.
- Ensure sufficient air circulation and exhaust at the appliance base and at the back wall of the appliance. Never cover air vent openings.
- Do not place warm foods into the appliance. Allow warm foods to cool first.
- Do not leave the door open any longer than necessary.
- Do not set temperature any colder than necessary.
- Check the storage temperature in the freezer on the thermometer.
- Put frozen food in the fridge to defrost. The cold in the frozen food will then be used to cool the fridge.

What to do if ...

Correcting Malfunctions

Please check whether the pilot lights come on, the refrigerating unit operates, and the internal temperature is being maintained. Do not perform any other work on the appliance if the following information does not provide assistance in your specific case.

 **Important!** Repairs to refrigerators/freezers may only be performed by competent service engineers. Improper repairs can give rise to significant hazards for the user. If your appliance needs repairing, please contact your specialist dealer or your local Service Force Centre.

 If the freezer system has stopped working and the freezer is full, the reserve in the cold accumulator and in the deep frozen food itself will give the food a hold over time of about 30 hours. If the freezer is without a cold accumulator the hold over time will be reduced to about 20 hours.

Symptom	Possible Cause	Remedy
Appliance does not work, no pilot light is illuminated.	Appliance is not switched on.	Switch on the appliance.
	Mains plug is not plugged in or is loose.	Insert mains plug.
	Fuse has blown or is defective	Check fuse, replace if necessary.
	Socket is defective.	Mains malfunctions are to be corrected by an electrician.
Green light does not light up, yellow light lights up when the fast freeze function is activated.	Green light faulty.	Please inform your local Service Force Centre.
Yellow light does not light up, when the fast freeze function is activated, appliance is on.	Yellow light faulty.	Please inform your local Service Force Centre.
Appliance cools too much.	Temperature is set too cold.	Turn the temperature control knob to a warmer setting temporarily.

Symptom	Possible Cause	Remedy
The compressor runs continuously	Temperature is set too cold.	Turn the thermostat control knob to a warmer setting temporarily.
The freezer temperature is not sufficient, red light lights up, temperature alarm signal sounds.	Temperature is not properly adjusted.	Please look in the "Initial Start Up" section.
	Door was open for an extended period.	Open the door only as long as necessary. Press the fast freeze button.
	A large quantity of warm food placed in the appliance within the last 24 hours.	Press the fast freeze button.
	The appliance is near a heat source.	Please look in the "Installation Location" section.
Heavy build up of frost, possibly also on the door seal.	Door seal is not airtight (possibly after reversing the door).	Carefully warm the leaking sections of the door seal with a hair dryer (on a cool setting). At the same time shape the warmed door seal by hand such that it sits correctly.
The compressor does not start immediately after changing the temperature setting.	This is normal, no error has occurred.	The compressor starts after a period of time.
Appliance works , green light blinks	technical Problem	Please inform your customer service

Important: regularly check on the red temperature pilot light and thermometer to establish that the storage temperature is being maintained.

Noises During Operation

The following noises are characteristic of refrigeration appliances:

- **Clicks**

Whenever the compressor switches on or off, a click can be heard.

- **Humming**

As soon as the compressor is in operation, you can hear it humming.

- **Bubbling/Splashing**

When refrigerant flows into thin tubes, you can hear bubbling or splashing noises. Even after the compressor has been switched off, this noise can be heard for a short time.

Regulations, Standards, Guidelines

This appliance was designed for household use and was manufactured in accordance with the appropriate standards. The necessary measures in accordance with appliance safety legislation regulations (GSG), accident prevention regulations for refrigeration appliances (VBG 20) and the regulations of the German Society of Electrical Engineers (VDE) were observed in the manufacture of this appliance.

The refrigerant circuit has been checked for leaks.

CE This appliance is in accordance with the following EU guidelines:

- 73/23/EEG dated 19 February 1973 - low voltage guidelines.
- 89/336/EEG dated 3 May 1989
(including guideline change notice 92/31/EEG) - EMV guideline

Technical Terminology

- **Refrigerant**

Liquids that can be used to generate a cooling effect are known as refrigerants. They have a relatively low boiling-point, indeed so low, that the warmth from the food stored in the fridge or freezer can cause the refrigerant to boil and vaporise.

- **Refrigerant Circuit**

Closed circulation system that contains the refrigerant. The refrigerant circuit comprises primarily of an evaporator, a compressor, a condenser and pipe work.

- **Evaporator**

The refrigerant is evaporated in the evaporator. Similar to all other liquids, refrigerant requires heat to evaporate. This heat is removed from the interior of the appliance, as a result the interior is cooled. The evaporator is therefore located inside the appliance or placed in foam immediately behind the inner wall and thus not visible.

- **Compressor**

The compressor looks like a small drum. It is driven by a built-in electric motor and is mounted on the base of the appliance at the rear. The task of the compressor is to draw in vaporised refrigerant from the evaporator, to compress it, and to pass it on to the condenser.

- **Condenser**

The condenser normally has the form of a grid. The refrigerant compressed in the compressor is liquefied in the condenser. During this process, heat is released to the surrounding air at the surface of the condenser. The condenser is mounted on the base of the appliance.

Service and Spare Parts

In the event of your appliance requiring service, or if you wish to purchase spare parts, please contact your local Service Force Centre by telephoning:

0870 5 929929

Your telephone call will be automatically routed to the Service Force Centre covering your post code area.

For address of your local Service Force Centre and further information about Service Force, please visit the website at www.serviceforce.co.uk.

Before calling out an engineer, please ensure you have read details under the heading "Something Not Working".

When you contact the Service Force Centre you will need to give following details:

1. Your name, address and post code
2. Your telephone number
3. Clear and concise details of the fault
4. The model and serial number of the appliance. (found on the rating plate).
5. The purchase date

Please note that a valid purchase receipt or guarantee documentation is required for in-guarantee service calls.

Customer Care Department

For general enquiries concerning your AEG-Electrolux appliance or for further information on AEG-Electrolux products, please contact our Customer Care Department by letter or telephone at the address below or visit our website at www.aeg-electrolux.co.uk.

Customer Care Department
AEG-Electrolux Major Appliances
Addington Way
Luton
Bedfordshire
LU4 9QQ

Tel: 08705 350 350*

*calls to this number may be recorded for training purposes

GUARANTEE CONDITIONS

Standard guarantee conditions

We, AEG-Electrolux, undertake that if within 12 months of the date of the purchase this AEG-Electrolux appliance or any part thereof is proved to be defective by reason only of faulty workmanship or materials, we will, at our discretion repair or replace the same FREE OF CHARGE for labour, materials or carriage on condition that:

- The appliance has been correctly installed and used only on the electricity or gas supply stated on the rating plate.
- The appliance has been used for normal domestic purposes only, and in accordance with the manufacturer's operating and maintenance instructions.
- The appliance has not been serviced, maintained, repaired, taken apart or tampered with by any person not authorised by us.
- All service work under this guarantee must be undertaken by a Service Force Centre. Any appliance or defective part replaced shall become the Company's property.
- This guarantee is in addition to your statutory and other legal rights.
- Home visits are made between 8.30am and 5.30pm Monday to Friday. Visits may be available outside these hours in which case a premium will be charged.

Exclusions

This guarantee does not cover:

- Damage or calls resulting from transportation, improper use or neglect, the replacement of any light bulbs or removable parts of glass or plastic.
- Costs incurred for calls to put right an appliance which is improperly installed or calls to appliances outside the United Kingdom.
- Appliances found to be in use within a commercial environment, plus those which are subject to rental agreements.
- Products of AEG-Electrolux manufacture which are not marketed by AEG-Electrolux.

European Guarantee

If you should move to another country within Europe then your guarantee moves with you to your new home subject to the following qualifications:

- The guarantee starts from the date you first purchased your product.
- The guarantee is for the same period and to the same extent for labour and parts as exists in the new country of use for this brand or range of products.
- This guarantee relates to you and cannot be transferred to another user.
- Your new home is within the European Community (EC) or European Free Trade Area.
- The product is installed and used in accordance with our instructions and is only used domestically, i.e. a normal household.
- The product is installed taking into account regulations in your new country.

Before you move please contact your nearest Customer Care centre, listed below, to give them details of your new home. They will then ensure that the local Service Organisation is aware of your move and able to look after you and your appliances.

France	Senlis	+33 (0)3 44 62 29 29
Germany	Nürnberg	+49 (0)800 234 7378
Italy	Pordenone	+39 (0)800 117511
Sweden	Stockholm	+46 (0)8 672 53 60
UK	Luton	+44 (0) 8705 350 350

 **From the Electrolux Group.** The world's No.1 choice.

The Electrolux Group is the world's largest producer of powered appliances for kitchen, cleaning and outdoor use. More than 55 million Electrolux Group products (such as refrigerators, cookers, washing machines, vacuum cleaners, chain saws and lawn mowers) are sold each year to a value of approx. USD 14 billion in more than 150 countries around the world.

AEG Hausgeräte GmbH
Postfach 1036
D-90327 Nürnberg

<http://www.aeg.hausgeraete.de>

© Electrolux plc 2005

2222 737-78 -00- 1006

Subject to change without notice