



THE SMARTPHONE
WITHOUT LIMITS.

Welcome

MOTOROLA MILESTONE™ gives you a premium browsing and messaging experience with the very latest from Google™, all in a thin touch QWERTY slider.

- **Browsing.** Get more from the Web, with a huge screen and full HTML. Search, browse, everything you want to do, all made easier.
- **Organization.** Unify your work and personal life with calendar, email, and contacts.



Your phone

Four simple keys and a great touchscreen—that's pretty much all you need.

- **Back:** Go back a screen.
- **Menu:** Open menu options.
- **Home:** Go to the home screen.
- **Search:** Search the internet.



If you want a full keyboard (great for texting, or searching in your **Contacts** list), just turn and slide—the screen rotates to stay right-side up.

Note: This phone supports data-intensive apps and services. It is strongly recommended that you purchase a data plan that meets your needs. Contact your service provider for details.



Let's go

Let's get you up and running.

Tip: Your phone comes with a microSD memory card already installed.

Caution: Before assembling, charging or using your phone for the first time, please read the important **Safety, Regulatory & Legal** information provided with your phone.

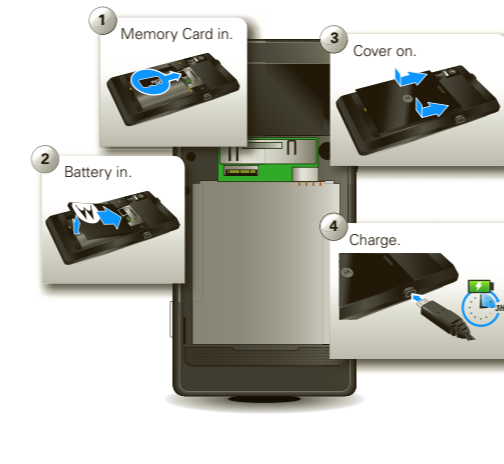

When you turn on your phone for the first time, you're asked to set up your Gmail account. You can create one if you don't already have one.

Tip: Write down your username and password, and keep them in a safe place. Like right here:

username: _____@gmail.com

password: _____



Touch

It's all in the touch:

- **Touch:** Choose an menu item or option.
- **Touch & Hold:** Open options or grab an object that you want to move.
- **Drag:** Scroll or move slowly.
- **Flick:** Scroll or move quickly. (Touch to stop.)
- **Double-touch:** Zoom in or out when you view when you view maps or web pages.

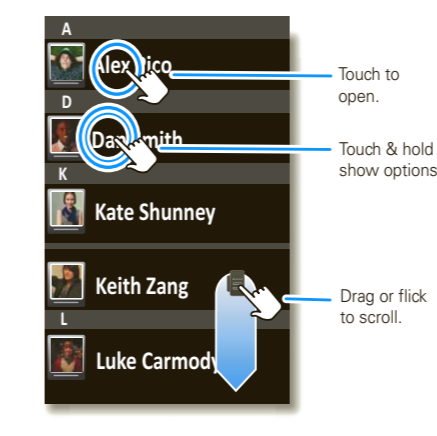

Home

The home screen gives you all your latest information in one place. It's what you see when you turn on the phone or touch Home (Home icon) from a menu.

Use the widgets, shortcuts and panels to see what's important to you—whether it's home, work or play.



Personalize

Go ahead, add your personal touch. Change your widgets, wallpaper, ringtone, and more.

Home screen. Touch and hold an empty spot on the home screen until you see **Add to Home screen**.

Ringtones & sounds. Touch Menu (Menu icon) > **Settings** > **Sound & display** > **Phone ringtone** or **Notification ringtone**.

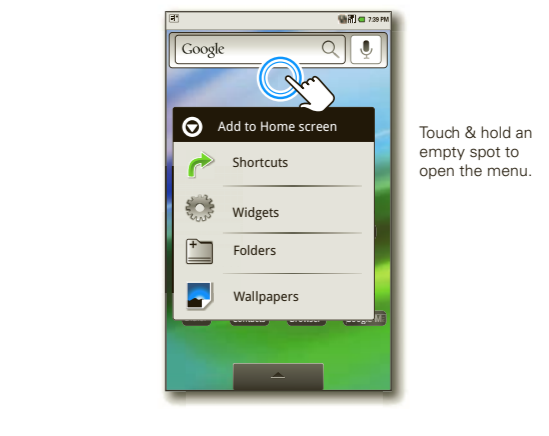

www.motorola.com

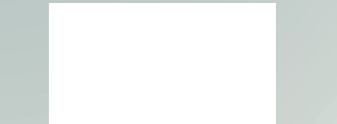

MOTOROLA and the Stylized M Logo are registered in the US Patent & Trademark Office. The Bluetooth trademarks are owned by their proprietor and used by Motorola, Inc. under license. Google, YouTube, Gmail, and the Google logo are trademarks of Google, Inc. All other product or service names are the property of their respective owners. © 2010 Motorola, Inc. All rights reserved.

68000202772-B



Apps



You can find all of your applications in one place. From the home screen, just touch  to see the app menu. To open an app, just touch it.

Want more? No problem: To check out Android Market™ and download more apps, touch Home  >  >  **Market**.



Calls

Your dialpad and call lists are just a touch or two away—no menus needed. To make a call, just touch  **Phone** from the home screen.

Tip: You can touch Home  or Back  to hide the active call display. To reopen it, touch  **Phone**, then **Return to call in progress**.



Call Log
Lists all recent outgoing & incoming calls.

Favorites
Lists your most frequently called numbers.

Call
Enter a phone number & touch here to call it.

Call Controls

Contacts

Now you have contacts like you've never had before. View, search, and use them your way. Touch  **Contacts** in the home screen.

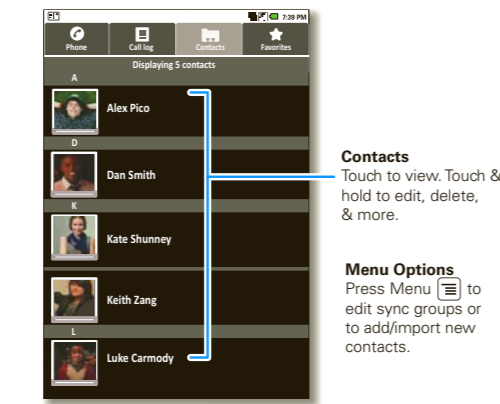

Tip: When you flick or drag this list, a scroll bar appears on the right. Drag the scroll bar to move the list faster. To search the list, just open your phone and type a name.





Contacts
Touch to view. Touch & hold to edit, delete, & more.

Menu Options
Press Menu  to edit sync groups or to add/import new contacts.

Messages

Text messaging and email like never before. Touch Home  >  **Messaging**.

To set up your email, touch Home  >  >  **Email**. An easy "setup wizard" will guide you.

Tip: To type in a message, open your phone or touch a text field to open the touchscreen keypad.

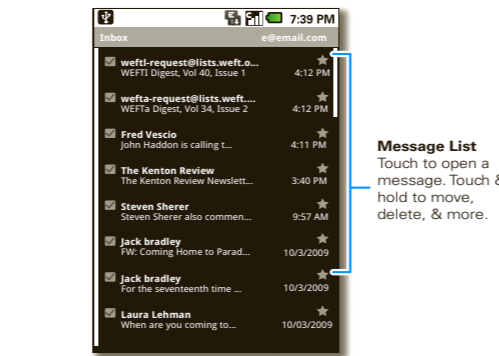

Message List
Touch to open a message. Touch & hold to move, delete, & more.

Locks

To keep your phone safe, you can set an unlock pattern to lock your screen.

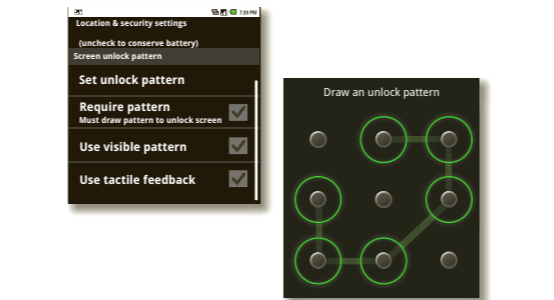

To see this and other locking options, touch Menu  > **Settings** > **Location & security**



Media

See it, capture it, share it! You'll even have time to relax to some music

Note: Be sure that your memory card is installed.

• **Photos:** Press Camera  on the side of your phone, aim, and press Camera  again.

• **Videos:** Press Camera  on the side of your phone, then drag the switch up.

• **Music:** Touch Home  >  >  **Music**, and touch a category.

Tip: To share photos, touch **Share**. To see your photos, touch Home  >  >  **Gallery**.

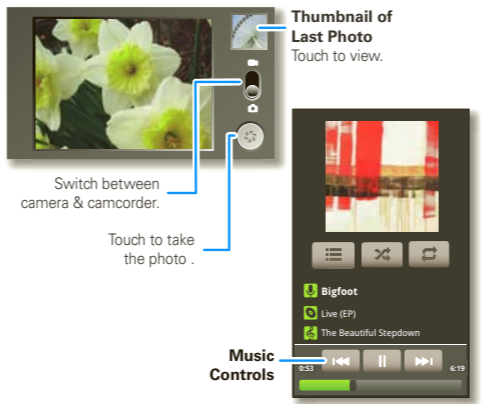

Thumbnail of Last Photo
Touch to view.

Switch between camera & camcorder.

Touch to take the photo.

Music Controls

Accessories

You can easily expand how use your phone.

• **Car Mount Phone Holder:** With your phone secured to your windshield or dash, use Google Maps to show you the way.

• **Multimedia Station:** Dock your phone, then sit back and enjoy a multimedia experience.



Wireless

Lose the wires—Touch Menu  > **Settings** > **Wireless & networks**.

• **Bluetooth:** For handsfree calls and wireless music, touch **Bluetooth settings** and connect to your accessory.

• **Wi-Fi:** For access to a Wi-Fi computer network, touch **Wi-Fi settings** and connect to a home, office or hotspot network.

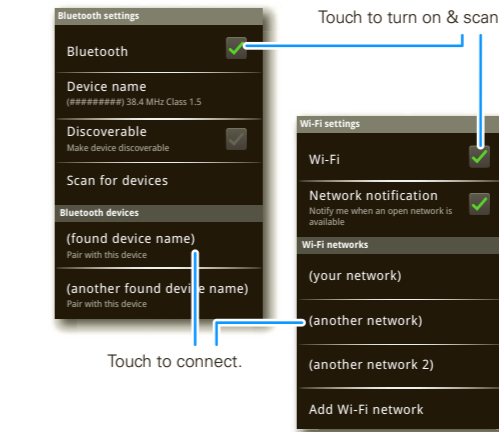

Touch to turn on & scan.

Touch to connect.

Tips

Here are some good things to know:

• **Add widget:** Use the Home Screen Menu. Touch Menu  > **Add** > **Widgets**.

• **Transfer files to & from a PC:** Connect to a computer with a USB data cable. Touch your phone's status bar and drag down. Touch **USB connection** > **Memory card management**. Then, use your computer to move files to your phone.



More

• **Answers:** Touch  > **Help Center**.

• **On the Web:** Find a full user guide and other helpful information at www.motorola.com/support.

• **Accessories:** Find accessories for your phone at www.motorola.com/products.

