

Power Lift & Recline Chair and Power Recline Only Chair

SERVICE GUIDE



Proudly Manufactured in the USA 



401 Bridge Street
Old Forge, Pa. 18518
Phone 866-793-5100
Fax 866-255-9962
www.ultracomfort.net

Table of Contents

About the Lift Chair Service Guide.....	2
Lift Chair Components.....	2-4
General Trouble Shooting.....	5
Tools Required.....	5
Models Quick Reference.....	6
Replacement Instructions.....	7-14
Smart Tek Hand Control.....	7
Hand Control Extension Wire.....	7
Back Assembly.....	8
Control Box.....	8
Lift Motor.....	8
Lift Frame.....	9
Arm Assembly.....	9-10
Scissor Mechanism.....	11-12
Recline Bar.....	12
Seat Assembly.....	13-14
Recline Straps.....	14
Scissor Mechanism Parts.....	15
Electrical Systems.....	16-20
Single Motor.....	16
Dual Motor.....	17
Heat and Massage.....	18
Stellar Comfort.....	19
UC480 Heat and Massage.....	20
Trouble Shooting with <i>SMART TEK</i>	21
LIFT FRAMES.....	23-37
LM5000C.....	23-25
LM5100.....	26-28
LM5120.....	29-31
LM6111.....	32-34
LM5200M-RO.....	35-37
Stellar Comfort Recline Mechanism.....	38
Power Connections.....	39
Back Installation.....	39
Hand Controls.....	40-43
Grease Points.....	44
Lift Chair Cut Away.....	45
Lift Chair Boxing Instructions.....	46-47
UC540M-26 Boxing Instructions.....	48-49

About the Lift Chair Service Guide

This service guide provides you with the information necessary to repair the UltraComfort 3-position, 2-position, and Stellar recline lift chairs. The troubleshooting scenarios in this manual consist of procedures that enable you to systematically trace and correct faults in the system, replacement procedures, and exploded views of available parts. Most replacement instructions apply to all the lift chairs in this service manual, but some of them are specific to individual chairs.

Before troubleshooting, check the following:

- Make sure that the lift chair is plugged into a working wall outlet.
- Check the wall outlet circuit breaker.
- Visually check terminals for corrosion.
- Check wires for missing insulation.
- Check connectors for unseated pins.
- Ensure LED lights are on. (Refer to “Trouble Shooting with *SMART TEK*” on page 19).

Information required prior to making a service call:

- Serial Number
- Date of Purchase
- Description of the problem with the lift chair

Lift Chair Components

Lift chairs are powered by 24V DC transformers that plug into standard wall outlets and operate on standard 120V AC electricity. The lift chair control system is made up of the following components:

- | | | |
|------------------|------------------------|-----------------|
| • Motor(s) | • Transformer | • Massage Unit* |
| • Hand Control | • Battery Backup Wire* | • Control Unit* |
| • Extension Wire | • Heat Unit* | • Junction Box* |

**Only on selected models*

Component: Motor

Location: Between the lift frame and the seat.

Function: Provides lift and recline.

Connections: Each motor is physically connected to the chair through the lift frame and the recline straps. Each motor is electrically connected to either a control unit or directly to the hand control.

Failure Signs: Chair will not lift and/or recline. Motor may become noisy just before failure.

Tests: See “Trouble Shooting with *SMART TEK*” on page 19.

Expected Readings: See “Trouble Shooting with *SMART TEK*” on page 19.

Serviceable: Must be replaced.

Component: Hand Control (Lift/Recline or Recline Only)

Location: On the arm of the chair.

Function: Provides user interface for lift/recline or recline only.

Connections: Connected to either the control unit or the motor.

Failure Signs: Chair will not lift and/or recline.

Tests: See “Trouble Shooting with *SMART TEK*” on page 19.

Expected Readings: See “Trouble Shooting with *SMART TEK*” on page 19.

Serviceable: Must be replaced.

Component: Extension Wire

Location: Between the lift frame and the chair frame.

Function: Provides connection from the hand control to the motor or control box.

Connections: From the quick disconnect in the pocket to the motor or control box.

Failure Signs: Chair will not lift/recline.

Tests: Test continuity.

Expected Readings: Open Circuit

Serviceable: Must be replaced.

Component: Transformer

Location: Next to chair.

Function: Converts AC to DC. Also provides power during a power failure.

Note: Power during a power failure only applies to the lift/recline or recline only functions.

Connections: Wall outlet and either control box or motor.

Failure Signs: Chair will not operate.

Tests: Test for voltage at connection to chair.

Expected Readings: Approximately 27VDC.

Serviceable: Must be replaced.

Component: Control Box (500-lb. chair only)

Location: On the lift frame.

Function: Provides connectivity for motors, hand control, and transformer.

Connections: Connected to the motor(s), hand control, and transformer.

Failure Signs: Chair will not lift and/or recline.
Clicking noise. Motors out of sync.

Tests: AC Voltage

Expected Readings: 27 - 32 VAC. See figure 1.

Serviceable: Must be replaced.

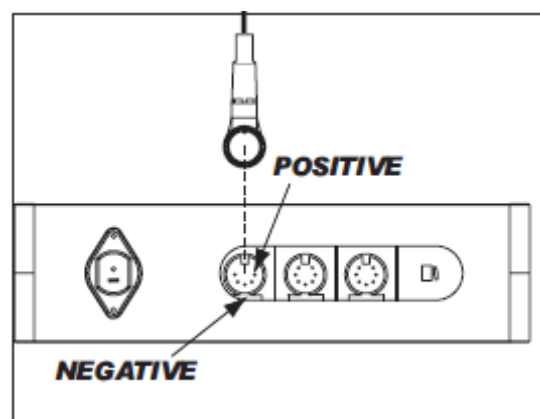

Figure 1. Control Box

Component: Heat Pad

Location: On the chair seat.

Function: Provides heat.

Connections: Connected to the control box.

Failure Signs: No heat.

Tests: Resistance.

Expected Readings: (Far Infrared Heat only, 1 - 6 ohms across the two connector pins).

Serviceable: Must be replaced.

Component: Massage Unit

Location: On the seatback or the seat.

Function: Vibrates to provide massage.

Connections: Connected to the junction box.

Failure Signs: Massage will not work when selected.

Tests: Check for DC voltage

Expected Readings: Approximately 13.8 DC Volts

Serviceable: Must be replaced.

Component: Hand Control (Heat/Massage or Infrared Heat Only)

Location: On the arm of the chair.

Function: Provides user interface for heat/massage or Infrared heat only.

Note: Model UC480 uses the “All in one” hand control, which controls heat, massage, and lift/recline.

Connections: Connected to the control box.

Failure Signs: Heat/Massage or Infrared Heat Only will not work.

Note: Model UC480, Chair will not lift and/or recline or Heat/Massage will not work.

Tests: See “Hand Controls” on pages 38-39. For a more complete guide, refer to manufacturer’s owner’s manual.

Expected Readings: See “Hand Controls” on pages 38-39. For a more complete guide, refer to manufacturer’s owner’s manual.

Serviceable: Must be replaced.

Battery Back Up System

1. Batteries should be replaced after one use.
2. Batteries should be changed yearly.

For a complete explanation of the battery back up system, refer to the UltraComfort owner’s manual.

General Trouble Shooting

Problem: 1

Chair is in the lift position and will not descend, or chair is in the recline position and will not lift.

Solution:

If the chair is stuck in the lift position, press the down button; if the chair is stuck in the recline position, press the up button. While pressing the appropriate button, listen to hear if the motor is running.

Ensure LED lights are on. (Refer to "Trouble Shooting with *SMART TEK*" on page 19).

Problem 2

If you don't hear the motor running, follow these steps.

- A) Check to see if the chair is securely plugged in.
- B) See if the outlet is activated by a wall switch.
- C) Try plugging the chair into a different outlet. (Sometimes the socket is worn and will not handle the amps needed for operation.)
- D) Check wiring on both power cord for motor and switch cord for breakage or fraying.
- E) Plug the new hand control into motor or into extension and try for chair response.
- F) If still no response, see "Trouble Shooting with *SMART TEK*" on page 19.

Problem 3

If you hear the motor running, but the chair won't move or partially moves, check for the following:

- A) Inspect lift frame for possible breakage.
- B) Inspect push tube or gear casing for breakage.
- C) Gears may be stripped in gear casing in motor assembly.
- D) Push tube may be stripped or the fork head may be broken.

Tools Required:

The following tools are needed to service **Ultra Comfort** lift chairs.

- # 8, 9 or 10 flat head screw driver
- P2 & P3 Phillips head screw driver
- T30 torx bit
- Wired or wireless drill Note: Driver bits can be used to speed up the repair process.
- Chair stand
- Spare hair pins
- Zip ties
- 7/16 box head wrench
- 3/8 box head wrench
- 1/2 box head wrench
- Needle nose pliers
- Volt meter
- Clippers or scissors
- Retracto knife
- Spare rags
- Large vice grip
- White lithium grease and Zep 2000

If servicing a lift chair with the StellarComfort mechanism, you will also need:

- 7/16 & 3/8 ratchet wrench
- 5/32 Allen wrench

Models Quick Reference

Model	Series	Size	Lift Frame	Motor	Transformer	Hand Control	Recline Mechanism
UC211	Leisure	Medium	LM5000C	Single	Standard US	UC 2 Button	2 way
UC320	Leisure	Medium	LM5100	Single	Standard US	UC 2 Button	3 way
UC330	Leisure	Large	LM5120	Single	Standard US	UC 2 Button	3 way
UC540-SAA	Montage	Small	LM5100	Single	Standard US	UC 2 Button	3 way
UC540-M	Montage	Medium	LM5100	Single	Standard US	UC 2 Button	3 way
UC540-L	Montage	Large	LM5120	Single	Standard US	UC 2 Button	3 way
UC540M-26	Montage	Wide	LM6111	Dual	Standard US	UC 2 Button	3 way HD
UC480	Tranquility	Medium	LM5100	Single	Standard US	All in one	3 way
UC660	Tranquility	Medium	LM5100	Single	Standard US	UC 2 Button	3 way
UC770	Tranquility	Medium	LM5120	Single	Standard US	UC 2 Button	3 way
UC550-S	Stellar Comfort	Small	LM5100	Stellar	Standard US	*Auto Drive 6 Button	Stellar
UC550-M	Stellar Comfort	Medium	LM5100	Stellar	Standard US	*Auto Drive 6 Button	Stellar
UC550-L	Stellar Comfort	Large	LM5120	Stellar	Standard US	*Auto Drive 6 Button	Stellar
UC552	Stellar Comfort	Medium	LM5100	Stellar	Standard US	*Auto Drive	Stellar
UC556	Stellar Comfort	Medium	LM5120	Stellar	Standard US	*Auto Drive	Stellar
UC551-S	Power Recline	Small	LM5200M-RO	Stellar	Standard US	*Auto Drive 6 Button	Stellar
UC551-M	Power Recline	Medium	LM5200M-RO	Stellar	Standard US	*Auto Drive 6 Button	Stellar
UC551-L	Power Recline	Large	LM5200M-RO	Stellar	Standard US	*Auto Drive 6 Button	Stellar
UC553	Power Recline	Medium	LM5200M-RO	Stellar	Standard US	*Auto Drive 6 Button	Stellar
UC557	Power Recline	Medium	LM5200M-RO	Stellar	Standard US	Auto Drive	Stellar

* Hand Control models currently being used.

Replacement Instructions

Smart Tek Hand Control Replacement

Tools Needed: None

1.  **WARNING Unplug the transformer from the wall outlet.**
2. Unplug the motor power cable.
3. Reach down into the pocket until you feel the disconnect latch on the extension cable.
4. Pull back on the disconnect latch.
5. Put one hand on the back of the extension wire plug base and one on the hand control plug base and pull the two pieces apart.
6. Plug in the new Smart Tek hand control to the extension cable.
7. Push forward on the disconnect latch. Make sure it engages fully with the hand control plug base.
8. Reconnect the motor power cable.
9. Plug the transformer into the wall outlet and test the hand control.

Hand Control Extension Wire Replacement

Tools Needed: Phillips head screwdriver, wire cutter, staple remover, stapler, zip ties, and a chair stand.

1.  **WARNING Unplug the transformer from the wall outlet.**
2. Unplug the transformer from the battery backup cable.
3. Reach down into the chair's side pocket until you feel the disconnect latch on the hand control extension.
4. Pull back on the disconnecting latch.
5. Put one hand on the back of the extension wire plug base and one on the hand control plug base and pull the two pieces apart.
6. Gently push the chair over onto the footrest, turn it upside down or, gently push it over onto its side, opposite of the hand control.
7. Use a Phillips screwdriver to remove the wire clamp used to secure the extension cable to the bottom of the armrests. Make sure you save the clamp and screw.
8. Remove a few staples on the arm assembly to allow the extension wire to be pulled out through the fabric pocket.
9. Pull the extension cable through the fabric pocket.
10. Locate the zip ties that hold the extension wire to the lift frame. Note their location.
11. Cut these ties.
12. Unplug the extension cable from the control box.
13. Plug the new extension cable into the control box.
14. Secure it to the lift frame with zip ties. Use the same locations as the old extension cable.
15. Insert the extension cable into the fabric pocket.
16. Reinstall the staples that were removed in step 8.
17. Reinstall the wire clamp.
18. Turn the chair back over onto its legs.
19. Plug in the Smart Tek hand control to the extension cable.
20. Push forward on the disconnecting latch. Make sure it engages fully with the hand control plug base.
21. Clip the Smart Tek hand control to the black plastic hook on the side of the chair arm.
22. Plug the battery backup back into the transformer.
23. Plug the transformer back into the wall outlet and test.

Back Assembly Replacement (500-lb. and 3-position)

Tools needed: 7/16 inch socket wrench

1. Press the Up Button on the hand control until the footrest is about parallel to the floor.
2.  **WARNING Unplug the transformer from the wall outlet.**
3. Using the 7/16 inch socket wrench, remove the two (2) flange lock nuts located on both sides of the back.
4. Pull the back flap away from the Velcro.
5. Work the back assembly out one side at a time pulling the threaded studs out of the scissor mechanisms.
6. Install new back.

Control Box Replacement (500-lb. only)

Tools needed: wire cutters, replacement zip ties, and a chair stand.

1.  **WARNING Unplug the transformer from the wall outlet.**
2. Unplug the battery backup cable from the transformer.
3. Gently push the chair over onto the footrest, turn it upside down or, gently push it over onto its side, opposite of the hand control.
4. Unplug the motor(s), hand control extension, and battery backup from the control box.
5. Cut the wire ties that fasten the control box and the motor(s) to the lift frame and remove it.
6. Use wire ties to fasten a new control box onto the lift frame.
7. Plug the motor(s), hand control extension, and battery backup into the new control box.
8. Gently turn the chair back over.
9. Plug the battery backup cable into the transformer.
10. Plug the transformer into the wall outlet and test.

Lift Motor Replacement

Tools needed: needle nose pliers, zip ties, and a chair stand.

1.  **WARNING Unplug the transformer from the wall outlet.**
2. Unplug the battery backup cable from the transformer.
3. Gently push the chair over onto the footrest, turn it upside down or, gently push it over onto its side, opposite of the hand control.
4. Unplug the motor(s) from the control unit (540M26) or from the hand control extension and the transformer.
5. Remove the hitch pin and the clevis pin that fastens the bottom of the motor(s) to the lift frame.
6. Remove the hitch pin, the clevis pin, washers, and spacers that fasten the top of the motor(s) to the recline straps.
7. Use the hitch pin and clevis pin to fasten the bottom of the new motor to the lift frame.
8. Use the hitch pin, clevis pin, washers, and spacers to fasten the top of the lift motor to the recline straps.
9. Connect the new motor(s) to the control unit.
10. Turn the chair over onto the lift frame.
11. Plug the battery backup cable into the transformer.
12. Plug the transformer into the wall outlet and test.

Lift Frame Replacement

Tools needed: Needle nose pliers, T30 Torx screw bit, wire cutters, replacement zip ties, and a chair stand.

1.  **WARNING Unplug the transformer from the wall outlet.**
2. Unplug the battery backup cable from the transformer.
3. Gently push the chair over onto the footrest, turn it upside down or, gently push it over onto its side, opposite of the hand control.
4. Unplug the motor(s), hand control extension, and battery backup from the control box.
5. Cut the wire ties that fasten the control box to the lift frame and remove it (500-lb. only.)
6. Remove the eight (8) T30 lag screws that hold the lift frame to the arm assembly.
7. Cut the wire ties that hold the hand control extension wire to the frame and place the wire to the side.
8. Remove the hitch pin(s), the clevis pin(s), and the washers that fasten the recline strap(s) to the recline bar.
9. Lift the lift frame out of the chair shell.

Note: When installing the new lift frame the footboard must be completely closed when you fasten the lift frame to the armrest assembly or the footboard will not close properly.

10. Cut the wire ties that fasten the motor cables to the lift frame.
11. Remove the hitch pin(s) and the clevis pin(s) that fasten the bottom of the motor(s) to the lift frame.
12. Remove the hitch pin(s), the clevis pin(s), spacers, and washers that fasten the recline straps(s) to the lift frame.
13. Use the hitch pin(s), the clevis pin(s), spacers, and washers to fasten the recline strap(s) to the new lift frame.
14. Use the hitch pin(s) and the clevis pin(s) to fasten the bottom of the motor(s) to the new lift frame.
15. Place the new lift frame onto the chair shell.
16. Use the hitch pin(s), the clevis pin(s), and the washers to fasten the recline strap(s) to the recline bar.
17. Use the eight (8) T30 lag screws to fasten the lift frame to the arm assembly.
18. Use two wire ties to fasten the hand control extension to the lift frame.
19. Use wire ties to fasten the control box to the lift frame.
20. Plug the motor(s), hand control extension, and battery backup into the control box.
21. Gently push the chair back over.
22. Plug the battery backup cable into the transformer.
23. Plug the transformer into a wall outlet and test.

Arm Assembly Replacement

Tools needed: Needle nose pliers, P2 Phillips screwdriver, T30 screw bit, wire cutters, zip ties, 3/8 inch socket, a stool or stand for placing the chair upside down.

1.  **WARNING Unplug the transformer from the wall outlet.**
2. Unplug the battery backup cable from the control box.
3. Reach down into the chair's side pocket until you feel the disconnect latch on the hand control extension.
4. Pull back on the disconnecting latch.
5. Put one hand on the back of the extension wire plug base and one on the hand control plug base and pull the two pieces apart.
6. Gently push the chair over onto the footrest, turn it upside down or, gently push it over onto its side, opposite of the hand control.

7. Use a Phillips screwdriver to remove the wire clamp used to secure the extension cable to the bottom of the armrests. Make sure you save the clamp and screw.
8. Remove a few staples on the arm assembly to allow the extension wire to be pulled out through the fabric pocket.
9. Pull the extension cable through the fabric pocket.
10. Remove the eight (8) T30 lag screws that hold the lift frame to the arm assembly.
11. Remove the hitch pin(s), the clevis pin(s), and the washers that fasten the recline strap(s) to the recline bar.
12. Lift the lift frame out of the chair shell and place it off to the side.
13. Use the 3/8 inch socket to remove the four (4) bolts that fasten each scissor mechanism to the arm assembly.



WARNING While this next step can be done alone, it does require extra attention. You must remove the arm assembly without twisting the frame. Excessive twisting will cause the board holding the arms together to snap.

14. Stand behind the chair and pull the arms away from the chair being careful not to get the material snagged in the scissor mechanisms.
15. Place the arm assembly to the side.
16. Place the new arm assembly in place so that the bolt holes in the scissor mechanisms line up with the bolt holes in the armrest.
17. Install the four (4) bolts that fasten each scissor mechanisms to the new arm assembly.
18. Make sure the footboard is completely closed.

Note: When installing the lift frame the footboard must be completely closed when you fasten the lift frame to the armrest assembly or the footboard will not close properly.

19. Place the lift frame onto the chair shell.
20. Use the hitch pin(s), the clevis pin(s), and the washers to fasten the recline strap(s) to the recline bar.
21. Use the eight (8) T30 lag screws to fasten the lift frame to the arm assembly.
22. Reinstall the staples that were removed in step 8.
23. Reinstall the wire clamp.
24. Gently turn the chair back over onto its legs.
25. Plug in the Smart Tek hand control to the extension cable.
26. Push forward on the disconnecting latch. Make sure it engages fully with the hand control plug base.
27. Clip the Smart Tek hand control to the black plastic hook on the side of the chair arm.
28. Plug the battery backup back into the control box.
29. Plug the transformer back into the wall outlet and test.

Scissor Mechanism Replacement

Tools needed: Needle nose pliers, P2 Phillips screwdriver, T30 screw bit, wire cutters, zip ties, 3/8 inch socket, a stool or stand for placing the chair upside down.



1. **WARNING** Unplug the transformer from the wall outlet.
2. Unplug the battery backup cable from the transformer.
3. Reach down into the chair's side pocket until you feel the disconnect latch on the hand control extension.
4. Pull back on the disconnecting latch.

5. Put one hand on the back of the extension wire plug base and one on the hand control plug base and pull the two pieces apart.
6. Gently push the chair over onto the footrest, turn it upside down or, gently push it over onto its side, opposite of the hand control.
7. Unplug the transformer and the hand control extension from the motor or control box.
8. Remove the eight (8) T30 lag screws that hold the lift frame to the arm assembly.
9. Remove the hitch pin(s), the clevis pin(s), and the washers that fasten the recline strap(s) to the recline bar.
10. Remove the hand control extension wire clamp.
11. Lift the lift frame out of the chair shell and place it off to the side.
12. Use the 3/8 inch socket to remove the four (4) bolts that fasten each scissor mechanism to the arm assembly.



WARNING While this next step can be done alone, it does require extra attention. You must remove the arm assembly without twisting the frame. Excessive twisting will cause the board holding the arms together to snap.

13. Stand behind the chair and pull the arms away from the chair being careful not to get the material snagged in the scissor mechanisms.
14. Place the arm assembly to the side.
15. Use the Phillips screwdriver to remove the screws that fasten the scissor mechanism to the footboard.
16. Use the 3/8 inch socket to remove the bolts that fasten the scissor mechanism to the seat and to the footboard.
17. Use the 3/8 inch socket to install the bolts that fasten the new scissor mechanism to the seat and the footboard.
18. Use the Phillips screwdriver to install the screws that fasten the new scissor mechanism to the footboard.
19. Place the arm assembly in place so that the bolt holes in the scissor mechanisms line up with the bolt holes in the armrest.
20. Install the four (4) bolts that fasten each scissor mechanisms to the arm assembly.
21. Make sure the footboard is completely closed.

Note: When installing the lift frame the footboard must be completely closed when you fasten the lift frame to the armrest assembly or the footboard will not close properly.

22. Place the lift frame onto the chair shell.
23. Use the hitch pin(s), the clevis pin(s), and the washers to fasten the recline strap(s) to the recline bar.
24. Use the eight (8) T30 lag screws to fasten the lift frame to the arm assembly.
25. Reinstall the hand control extension wire clamp.
26. Plug the transformer and hand control extension into the motor or control box.
27. Plug the battery backup back into the transformer.
28. Plug the transformer back into the wall outlet and test.
29. Reinstall the seatback if removed.

Recline Bar Replacement

Tools needed: Needle nose pliers, P2 Phillips screwdriver, T30 screw bit, wire cutters, zip ties, 3/8 inch socket, a stool or stand for placing the chair upside down.

1.  **WARNING Unplug the transformer from the wall outlet.**
2. Unplug the battery backup cable from the transformer.
3. Reach down into the chair's side pocket until you feel the disconnect latch on the hand control extension.
4. Pull back on the disconnecting latch.
5. Put one hand on the back of the extension wire plug base and one on the hand control plug base and pull the two pieces apart.
6. Gently push the chair over onto the footrest, turn it upside down or, gently push it over onto its side, opposite of the hand control.
7. Remove the eight (8) T30 lag screws that hold the lift frame to the arm assembly.
8. Remove the hitch pin(s), the clevis pin(s), and the washers that fasten the recline strap(s) to the recline bar.
9. Remove the hand control extension wire clamp.
10. Lift the lift frame out of the chair shell and place it off to the side.
11. Use the 3/8 inch socket to remove the four (4) bolts that fasten each scissor mechanism to the arm assembly.

 **WARNING While this next step can be done alone, it does require extra attention. You must remove the arm assembly without twisting the frame. Excessive twisting will cause the board holding the arms together to snap.**

12. Stand behind the chair and pull the arms away from the chair being careful not to get the material snagged in the scissor mechanisms.
13. Place the arm assembly to the side.
14. Use the 1/2 inch socket to remove the bolts that fasten the recline bar to the seat.
15. Use the 1/2 inch socket to install the bolts that fasten the new recline bar to the seat.
16. Place the arm assembly in place so that the bolt holes in the scissor mechanisms line up with the bolt holes in the armrest.
17. Install the four (4) bolts that fasten each scissor mechanisms to the arm assembly.
18. Make sure the footboard is completely closed.

Note: *When installing the lift frame the footboard must be completely closed when you fasten the lift frame to the armrest assembly or the footboard will not close properly.*

19. Place the lift frame onto the chair shell.
20. Use the hitch pin(s), the clevis pin(s), and the washers to fasten the recline strap(s) to the recline bar.
21. Use the eight (8) T30 lag screws to fasten the lift frame to the arm assembly.
22. Reinstall the hand control extension wire clamp.
23. Plug the battery backup back into the transformer.
24. Plug the transformer back into the wall outlet and test.

Seat Assembly Replacement

Tools needed: Needle nose pliers, P2 Phillips screwdriver, T30 screw bit, wire cutters, zip ties, 3/8 inch socket, a stool or stand for placing the chair upside down.

1.  **WARNING Unplug the transformer from the wall outlet.**
2. Unplug the battery backup cable from the transformer.
3. Reach down into the chair's side pocket until you feel the disconnect latch on the hand control extension.
4. Pull back on the disconnecting latch.
5. Put one hand on the back of the extension wire plug base and one on the hand control plug base and pull the two pieces apart.
6. Gently push the chair over onto the footrest, turn it upside down or, gently push it over onto its side, opposite of the hand control. You can also remove the seat back.
7. Remove the eight (8) T30 lag screws that hold the lift frame to the arm assembly.
8. Remove the hitch pin(s), the clevis pin(s), and the washers that fasten the recline strap(s) to the recline bar.
9. Remove the hand control extension wire clamp.
10. Lift the lift frame out of the chair shell and place it off to the side.
11. Use the 3/8 inch socket to remove the four (4) bolts that fasten each scissor mechanism to the arm assembly.

 **WARNING While this next step can be done alone, it does require extra attention. You must remove the arm assembly without twisting the frame. Excessive twisting will cause the board holding the arms together to snap.**

12. Stand behind the chair and pull the arms away from the chair being careful not to get the material snagged in the scissor mechanisms.
13. Place the arm assembly to the side.
14. Use the Phillips screwdriver to remove the screws that fasten the scissor mechanism to the footboard.
15. Use the 3/8 inch socket to remove the bolts that fasten the scissor mechanism to the seat and to the footboard.
16. Use the 1/2 inch socket to remove the bolts that fasten the recline bar to the seat.
17. Use the 1/2 inch socket to install the bolts that fasten the recline bar to the new seat.
18. Use the 3/8 inch socket to install the bolts that fasten the scissor mechanism to the new seat and the footboard.
19. Use the Phillips screwdriver to install the screws that fasten the new scissor mechanism to the footboard.
20. Place the arm assembly in place so that the bolt holes in the scissor mechanisms line up with the bolt holes in the armrest.
21. Install the four (4) bolts that fasten each scissor mechanisms to the arm assembly.
22. Make sure the footboard is completely closed.

Note: *When installing the lift frame the footboard must be completely closed when you fasten the lift frame to the armrest assembly or the footboard will not close properly.*

23. Place the lift frame onto the chair shell.
24. Use the hitch pin(s), the clevis pin(s), and the washers to fasten the recline strap(s) to the lift frame.
25. Use the eight (8) T30 lag screws to fasten the lift frame to the arm assembly.
26. Reinstall the hand control wire clamp.

27. Plug the motor(s), hand control extension, and battery backup into the control box.
28. Plug the battery backup back into the transformer.
29. Plug the transformer back into the wall outlet and test.

Recline Straps

Tools needed: Needle nose pliers, zip ties, and a chair stand.

1.  **WARNING Unplug the transformer from the wall outlet.**
2. Unplug the battery backup cable from the transformer.
3. Gently push the chair over onto the footrest, turn it upside down or, gently push it over onto its side, opposite of the hand control.
4. Remove the hitch pin, clevis pin(s), and washers that fasten the recline straps to the lift frame.
5. Remove the hitch pin(s), clevis pin(s), and washers that fasten the recline straps to the recline bar.
6. Use the hitch pin(s), clevis pin(s), and washers to fasten the new recline straps to the recline bar.
7. Use the hitch pin(s), clevis pin(s), and washers to fasten the new recline straps to the lift frame.
8. Use hitch pin(s), clevis pin(s), washers, and spacers to fasten the top of the motor to the new recline straps.
9. Turn the chair over onto the lift frame.
10. Plug the battery backup cable into the transformer.
11. Plug the transformer into the wall outlet and test.
12. Reinstall the seatback if removed.

SCISSOR MECHANISM PARTS

Component	Description
RM621	3-Way Recliner Mechs
RM8300	2-Way Recliner Mechs
RM620	Stellar Comfort Mechs

We do recommend both sides be replaced.

RM8300

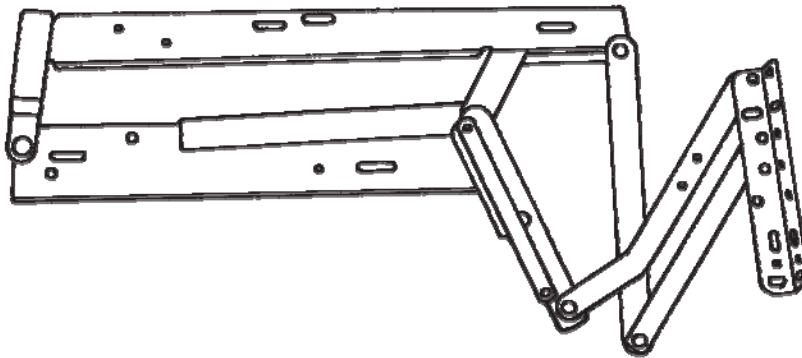

RM621

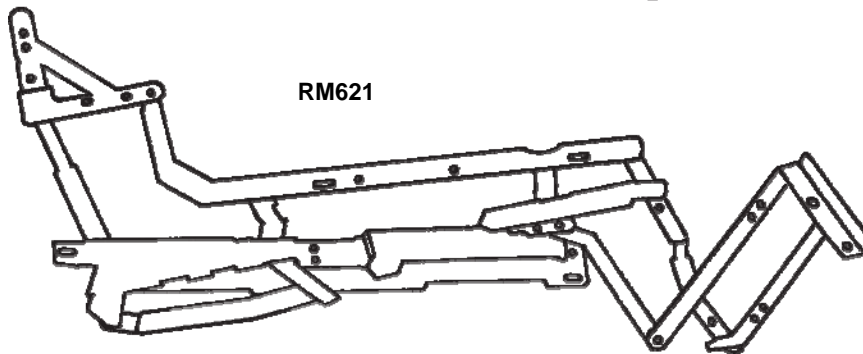

RM620

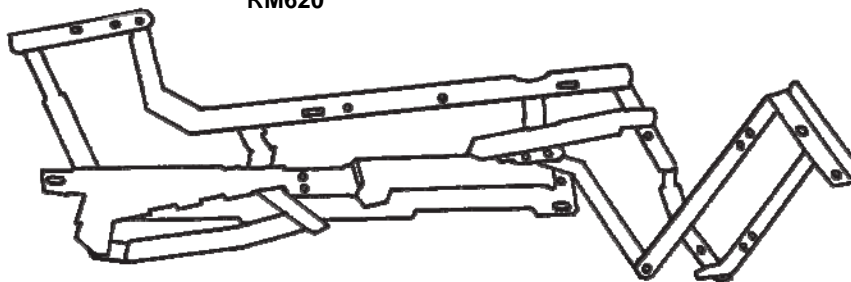

SINGLE MOTOR ELECTRICAL SETUP

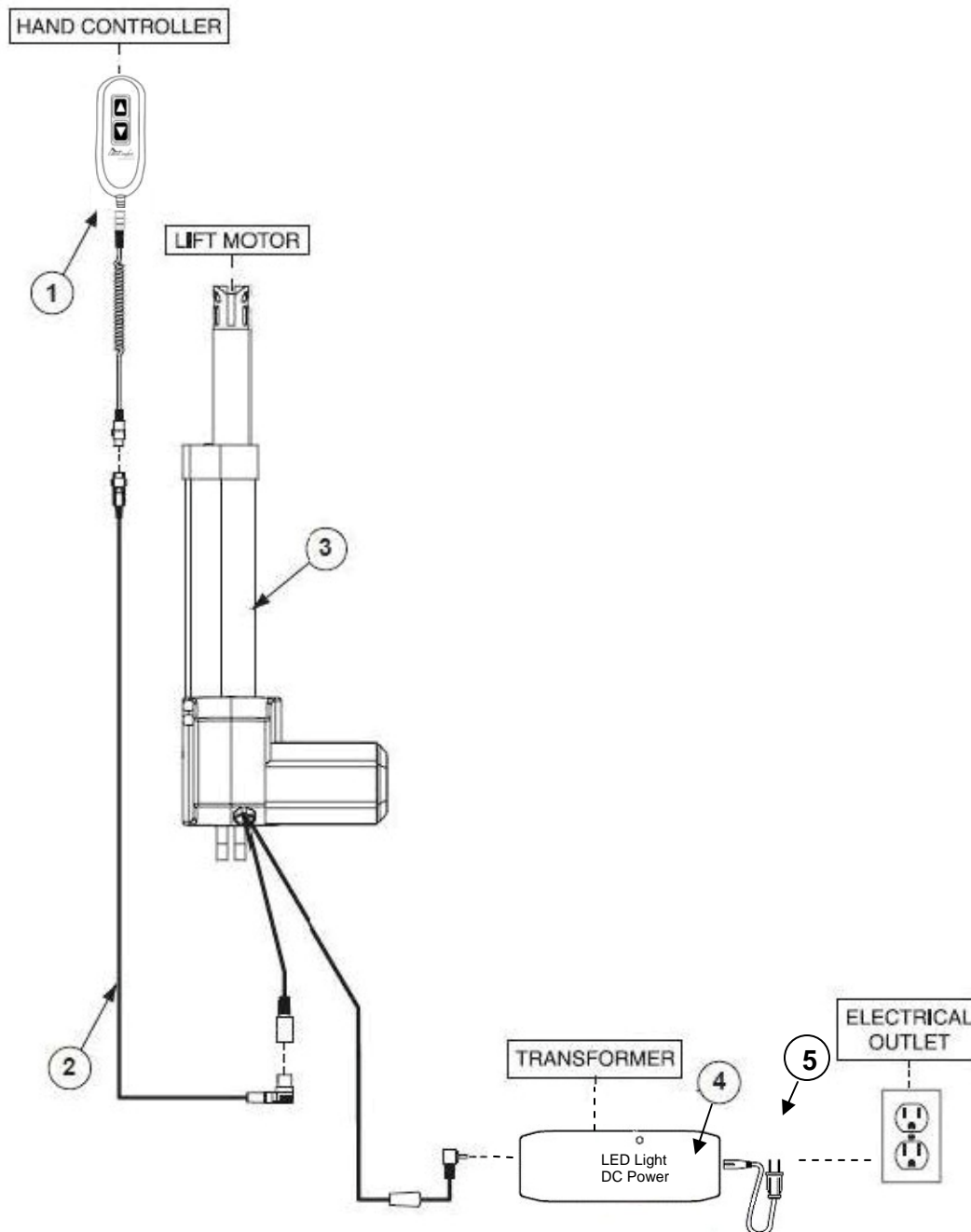

REF #	PART NUMBER	DESCRIPTION	QTY.
1*	ZKUC-20	Hand Wand, Standard 2 Button Ultra Comfort	1
1	ZKUC-10	Hand Wand, Standard 2 Button Ultra Comfort	1
2*	ZKUC-20-EXT	Hand Control Extension 62" Long	1
2	ZKUC-10-EXT	Hand Control Extension 62" Long	1
3	GM1500-LM	Motor Chair Led Non Transformer	1
4	GM1501-A	Motor Chair Transformer	1
5	GM1501-APUS	Transformer Cord	1

Smart Tek System

Models: UC211, UC320, UC330, UC540-SAA, UC540-M, UC540-L, UC660, and UC770

Note: UC480 uses the "All in one" hand control when configured with heat and massage.

* Asterisk designates the current style.

DUAL MOTOR ELECTRICAL SETUP

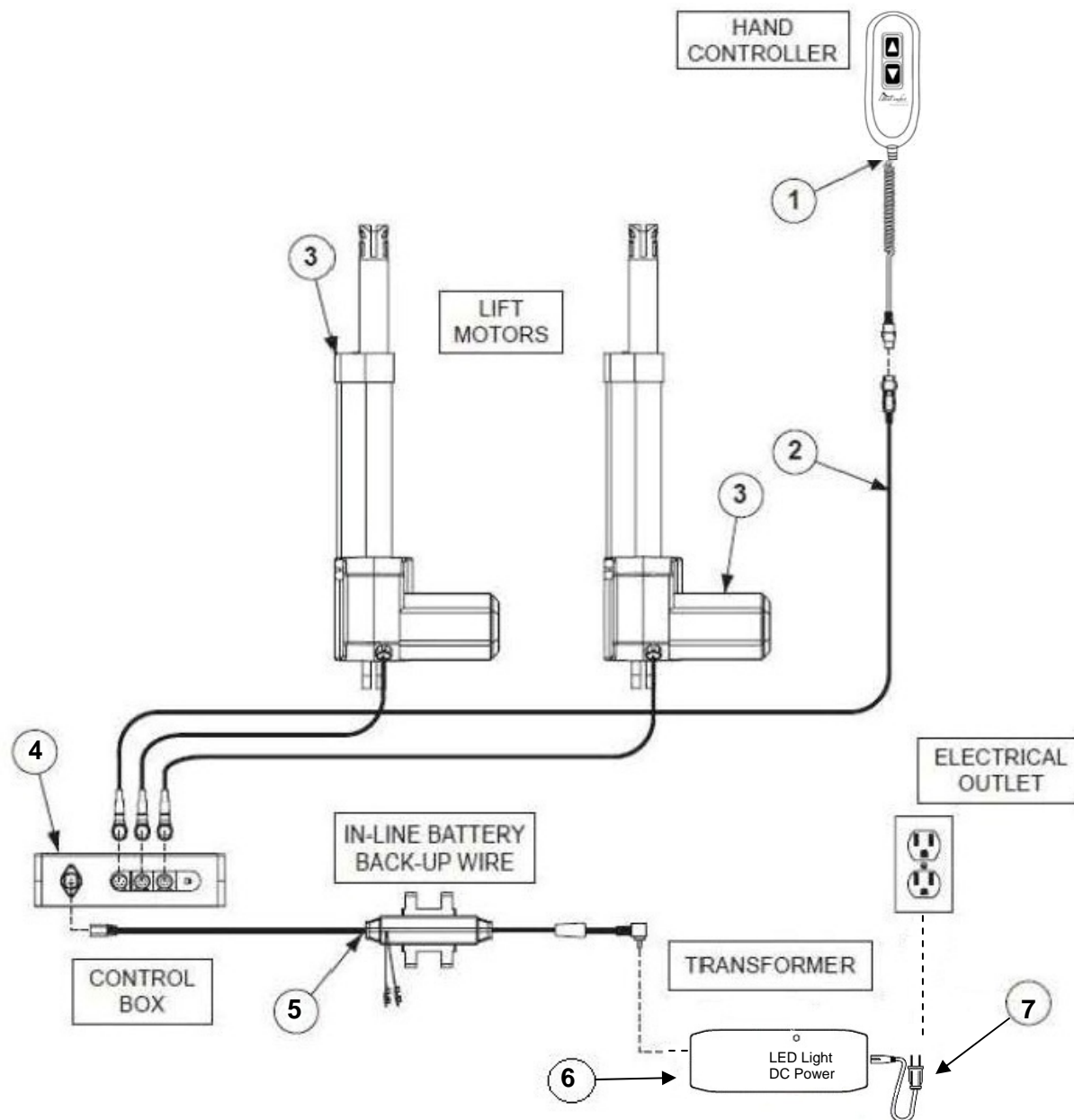

REF #	PART NUMBER	DESCRIPTION	QTY.
1*	ZKUC-20	Hand Wand, Standard 2 Button Ultra Comfort	1
1	ZKUC-10	Hand Wand, Standard 2 Button Ultra Comfort	1
2*	ZKUC-20-EXT	Hand Control Extension 62" Long	1
2	ZKUC-10-EXT	Hand Control Extension 62" Long	1
3	GMOKI-28W	Okin 26-28 Wide Motor	2
4	GMOKI-CB	Motor Chair Okin 26-28Wide Control Box 4/2003	2
5	GM1502L	Motor Chair Battery Back Up Wire with LED	1
6	GM1501-A	Motor Chair Transformer	1
7	GM1501-APUS	Transformer Cord	1

Smart Tek System
Model: UC540M-26

* Asterisk designates the current style.

HEAT and MASSAGE ELECTRICAL SETUP

HV3000 COMPLETE
RELAXOR DHV SYSTEM →

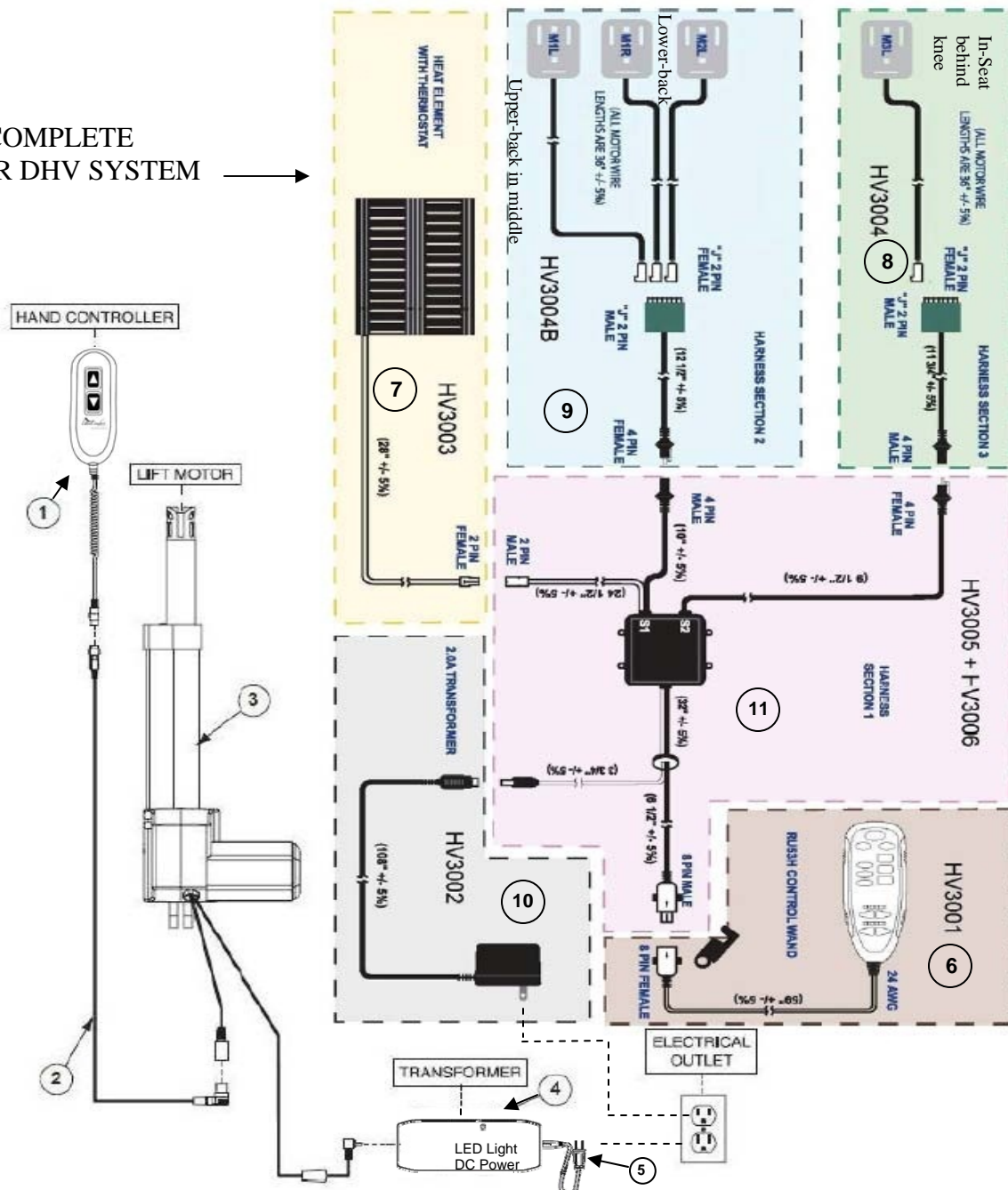

REF #	PART NUMBER	DESCRIPTION	QTY.
1*	ZKUC-20	Hand Wand, Standard 2 Button Ultra Comfort	1
1	ZKUC-10	Hand Wand, Standard 2 Button Ultra Comfort	1
2*	ZKUC-20-EXT	Hand Control Extension 62" Long	1
2	ZKUC-10-EXT	Hand Control Extension 62" Long	1
3	GM1500-LM	Motor Chair Led Non Transformer	1
4	GM1501-A	Motor Chair Transformer	1
5	GM1501-APUS	Transformer Cord	1
6	HV3001	DHV Hand Control	1
7	HV3003	Heat Unit	1
8	HV3004	Massage Seat	1
9	HV3004B	Massage Back	3
10	HV3002-2	Transformer	1
11	HV3005	DHV Control Box	1

Smart Tek System

Models: UC211, UC320, UC330, UC540-SAA, UC540-M, UC540-L, UC540-26, UC660, UC770

* Asterisk designates the current style.

STELLAR COMFORT ELECTRICAL SETUP

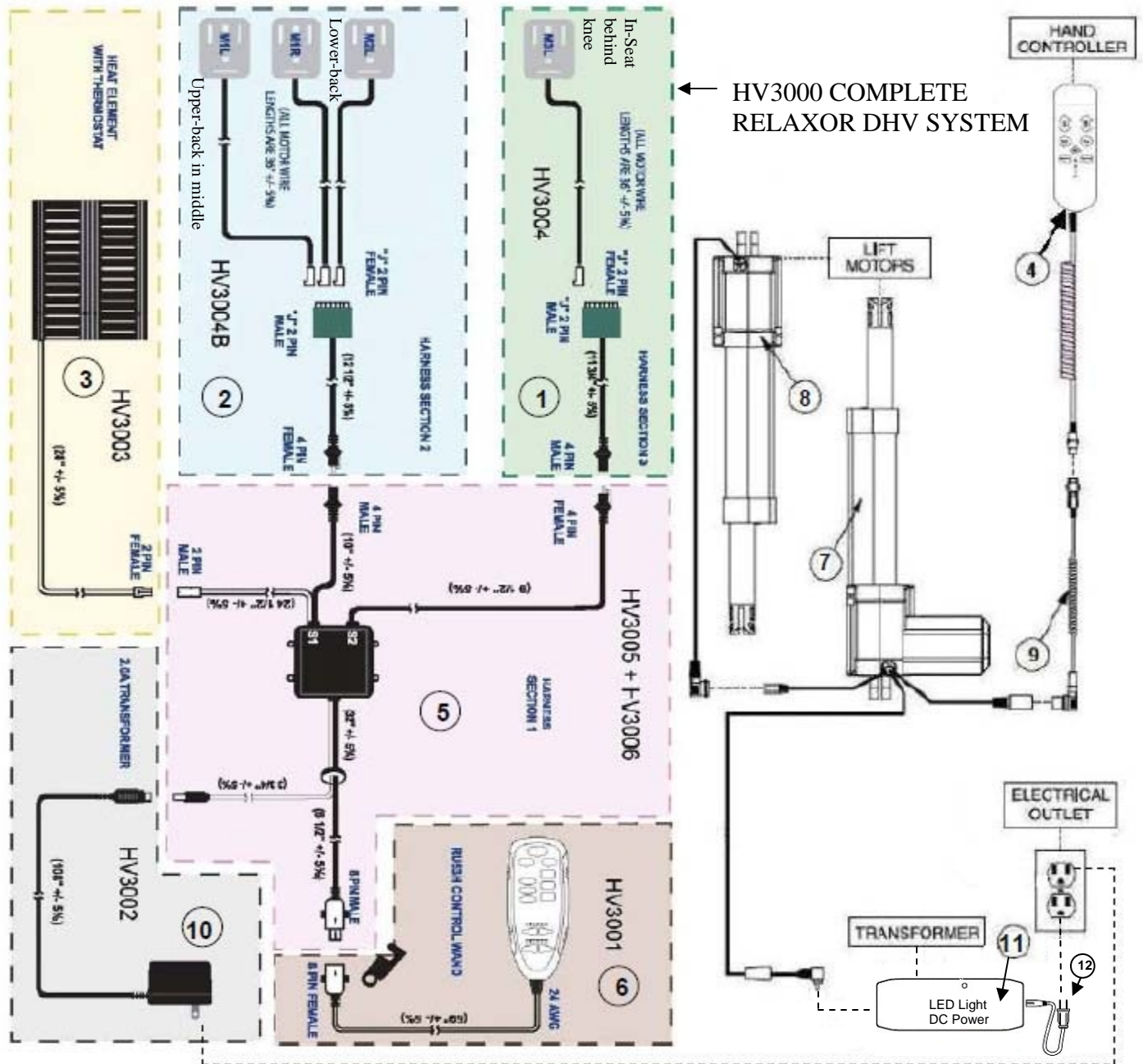

REF #	PART NUMBER	DESCRIPTION	QTY.
1	HV3004	Massage Unit Assembly, Seat	1
2	HV3004B	Massage Unit Assembly, Back	3
3	HV3003	Heat Pad	1
4	ZKAD-1	Hand Wand Auto Drive for Lift Chairs	1
5	HV3005	Control Box	1
6	HV3001-UC	Heat Massage Deluxe Hand Control Ultra Comfort Line	1
7	GM1500-LM	Motor Chair Okin Maxi Lift Motor	1
8	GM756R	Motor Chair Okin Maxi Recline Motor	1
9	ZK1100-EXT	Hand Control Extension	1
10	HV3002-2	Box Transformer 3 x 3 1/2 x 10	1
11	GM1501-A	Motor Chair Transformer	1
12	GM1501-APUS	Transformer Cord	1

Smart Tek System

Models: UC550-S, UC550-M, UC550-L, UC552, UC556, UC551-S, UC551-M, UC551-L, UC553, UC557

HEAT and MASSAGE ELECTRICAL SETUP

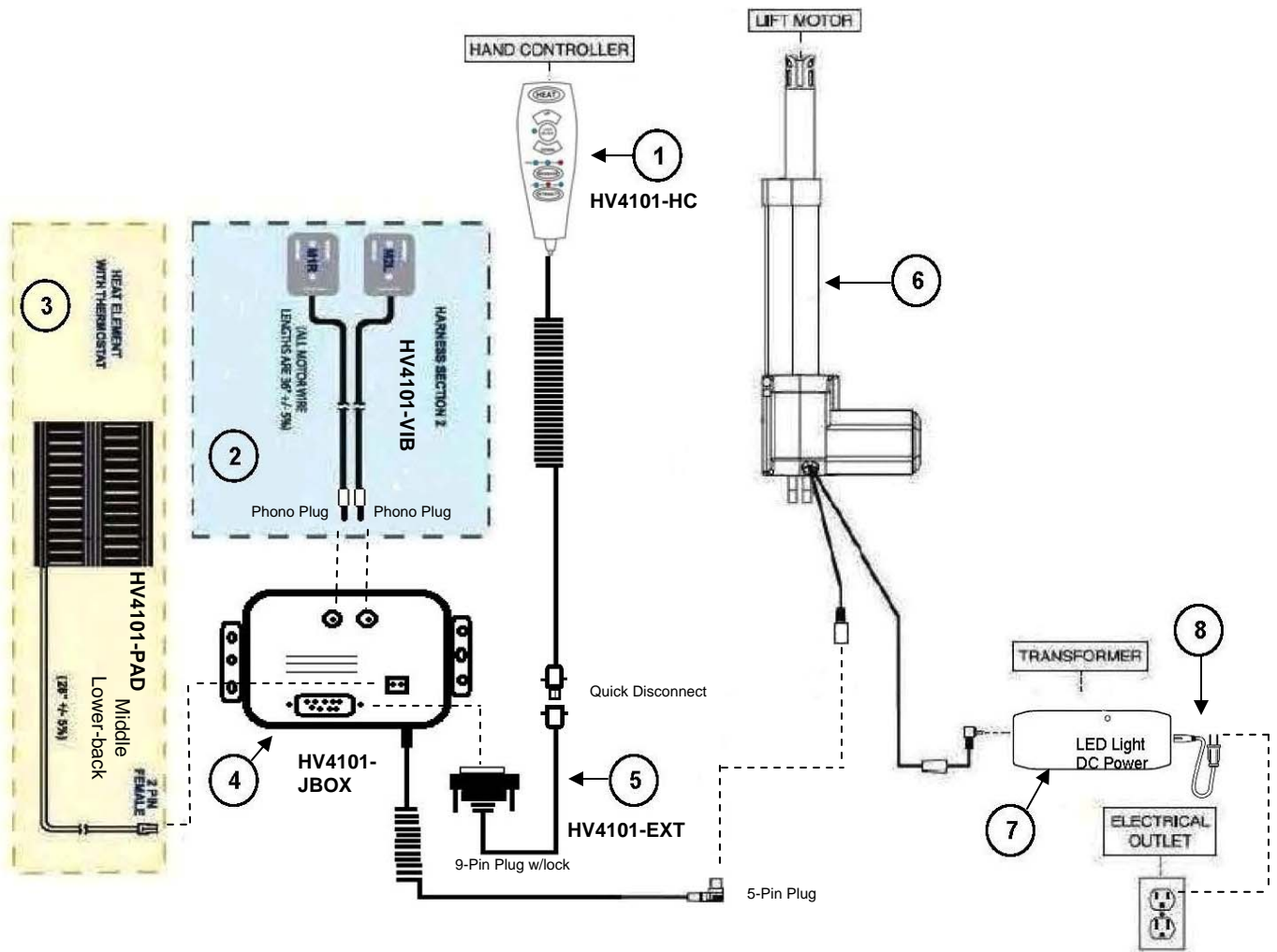

REF #	PART NUMBER	DESCRIPTION	QTY.
1*	HV4101-HC	Hand Wand, Heat and Massage and Lift	1
2*	HV4101-VIB	Massage Back	2
3*	HV4101-PAD	Heat Unit	1
4*	HV4101-JBOX	Junction Box	1
5*	HV4101-EXT	Extension	1
6	GM1500-LM	Motor Chair Led Non Transformer	1
7	GM1501-A	Motor Chair Transformer	1
8	GM1501-APUS	Transformer Cord	1

Smart Tek System
Model: UC480 only.

Note: The above drawing is for units manufactured after May 2012.

* Asterisk designates the current style.

HEAT and MASSAGE ELECTRICAL SETUP

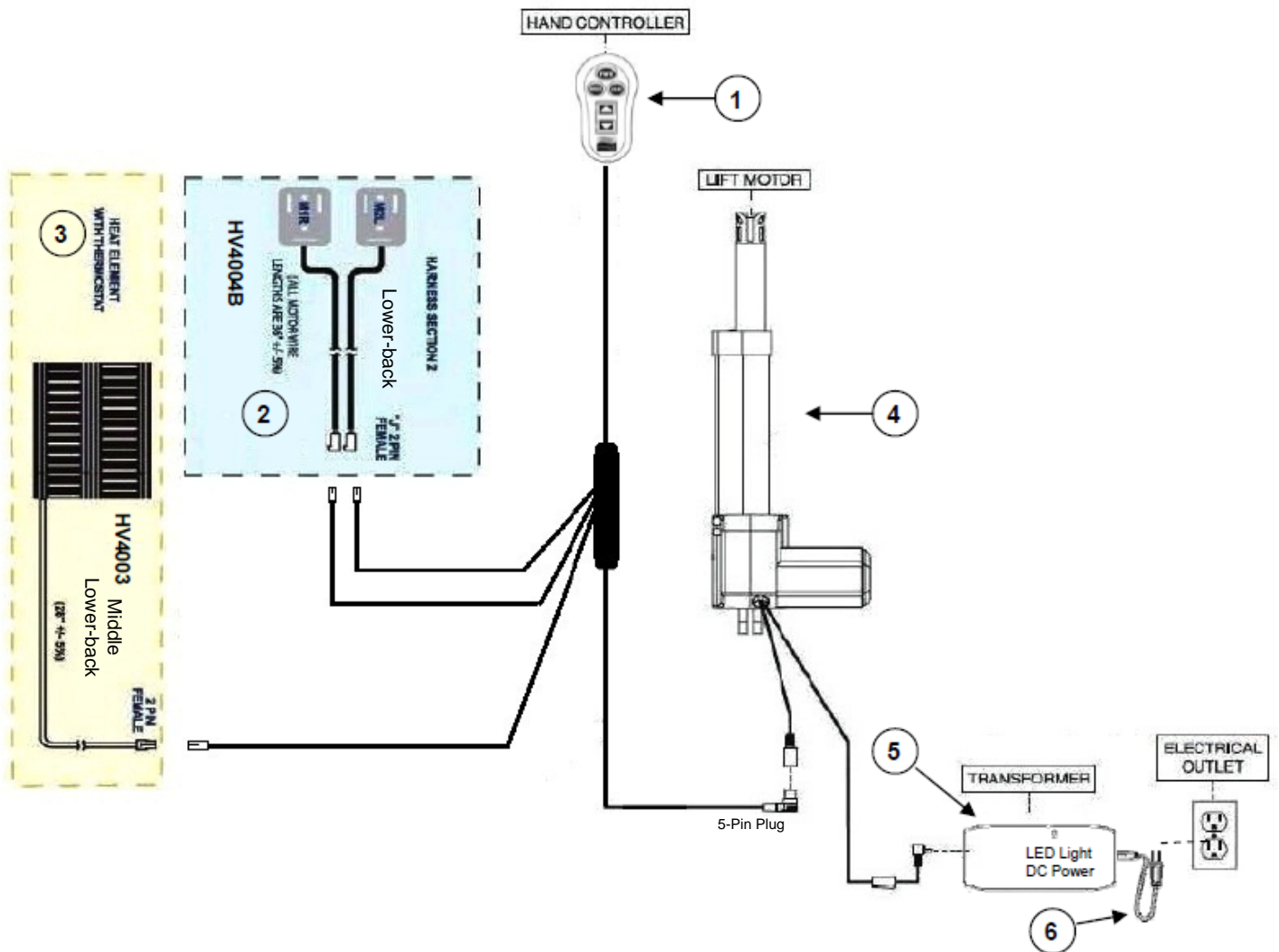

REF #	PART NUMBER	DESCRIPTION	QTY.
1	HV4001	Hand Wand, Heat and Massage and Lift	1
2	HV4004B	Massage Back	2
3	HV4003	Heat Unit	1
4	GM1500-LM	Motor Chair Led Non Transformer	1
5	GM1501-A	Motor Chair Transformer	1
6	GM1501-APUS	Transformer Cord	1

Smart Tek System
Model: UC480 only.

Note: The above drawing is for units manufactured prior to May 2012.

Trouble Shooting with Smart Tek

Models: UC211, UC320, UC330, UC540-SAA, UC540-M, UC540-L, UC480, UC660, UC770, UC550-S, UC550-M, UC550-L, UC552, UC556, UC551-S, UC551-M, UC551-L, UC553, UC557

Problem:

Chair doesn't work, both LED lights are off.

Solution:

1. Check right angle plug is connected to the transformer.
2. Check the plug end of the transformer is plugged into the wall outlet.
3. Check the fuse or breaker to the wall outlet the chair is plugged into. If all above are ok, defective transformer replace it.

Chair doesn't work, both LED lights are on.

1. Defective motor replace it.

Chair motor runs in one direction, both lights on.

1. Defective hand control replace it.

Chair doesn't work; LED on hand control is off.

1. Check the quick release connector is plugged in and locked in the chair pocket.
2. Check the extension from the pocket is connected to the motor.
If all above are ok, defective hand control or extension wire, extension wire rarely goes bad, replace hand control.

Models: UC540M-26

Problem:

Chair doesn't work, both LED lights are off.

Solution:

1. Check right angle plug is connected to the transformer.
2. Check the plug end of the transformer is plugged into the wall outlet.
3. Check the fuse or breaker to the wall outlet the chair is plugged into. If all above are ok, defective transformer, replace it.

Chair doesn't work, both LED lights are on.

1. Check motors are plugged into the control box.
If all above are ok, defective control box or motors, both motors rarely go bad, replace control box.

Chair motor runs in one direction, both lights are on.

1. Defective hand control, replace it.

Chair doesn't work; LED on hand control is off.

1. Check the quick release connector is plugged in and locked in the chair pocket.
2. Check the extension from the pocket is connected to the control box.
If all above are ok, defective hand control or extension wire or control box, extension wire rarely goes bad, replace control box and hand control, replace hand control first to see if problem is resolved.

LM5000C LIFT FRAME ASSEMBLY

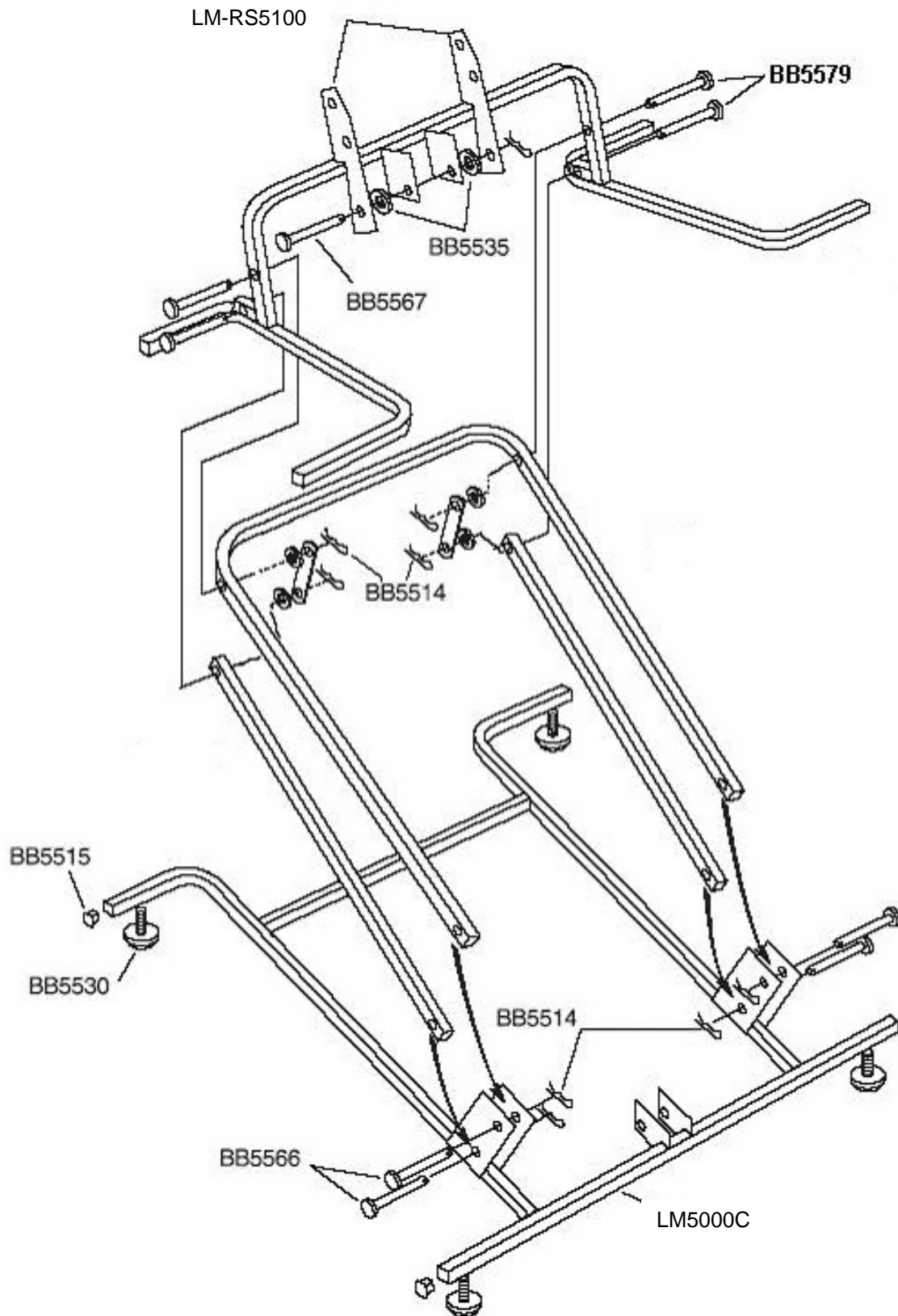

Used for Models: UC211

See parts list for specific parts by model.

LM5000C LIFT MOTOR

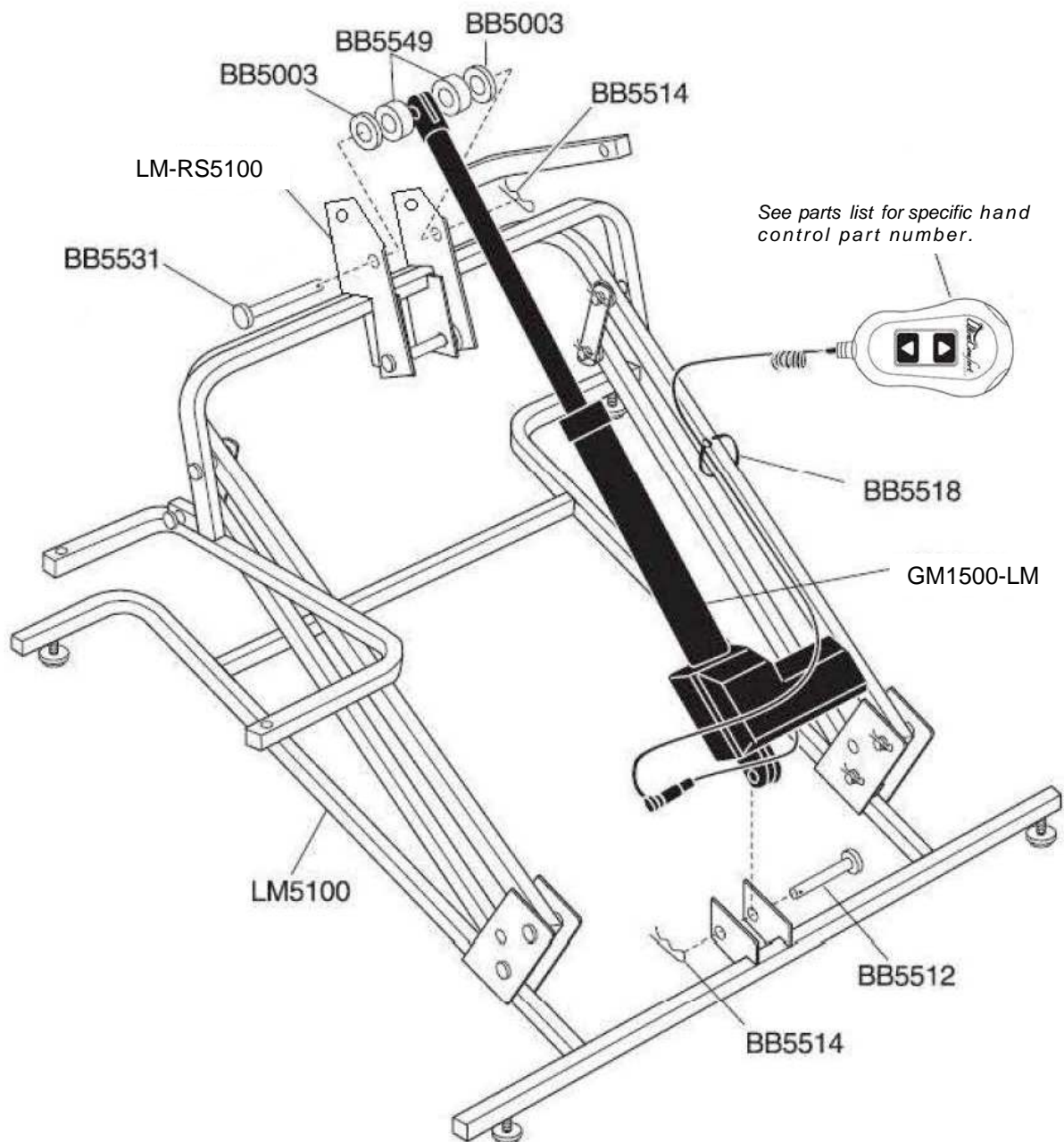

LM5000C LIFT FRAME PARTS LIST

Part Number	Description	Qty. Per Unit
BB5003	Washer, 380 x 750 x 062 Nylon	2
BB5512	Pin, 3/8 x 1 5/8 Zinc Clevis	1
BB5514	Pin, Hitch	11
BB5515	Cap, 1" Square End Chair	8
BB5518	Tywrap, 8" Black	2
BB5530	Leg Leveler 5/16 X 1	4
BB5531	Pin, 3/8 x 2 1/2 Zinc Clevis	1
BB5535	Washer, 750 x 394 x 125 Nylon	6
BB5549	Washer, 400 x 750 x 312 Nylon	2
BB5566	Pin, 3/8 x 3 1/2 Zinc Clevis	4
BB5567	Pin, 3/8 x 2 5/8 Zinc Clevis	1
BB5579	Pin, 3/8 x 2 7/8 Zinc Clevis	4
GM1500-LM	DC INLINE MOTOR	1
LM5000C	5000C LIFT FRAME	1
LM-RS5100	RECLINE STRAP 5100 / 6111 SERIES LIFT FRAME	2
ZKUC-10	Hand Wand, 2 Button LED	1

RECLINE BAR FOR 5000C LIFT FRAME

RB4000-CB	RECLINE BAR CAPRI	1
-----------	-------------------	---

RECLINE MECHANISMS FOR 5100 LIFT FRAME

RM8300L	2 WAY MECHANISM LEFT SIDE	1
RM8300R	2 WAY MECHANISM RIGHT SIDE	1

LEFT AND RIGHT IS DETERMINED BY SITTING IN CHAIR

TRANSFORMER FOR 5100 LIFT FRAME

GM1501-A	Motor Chair Transformer	1
GM1501-APUS	Transformer Cord	1

CALL TECHNICAL SERVICE FOR FABRIC, FOAM, SPRING AND WOOD PART NUMBERS AND PRICING

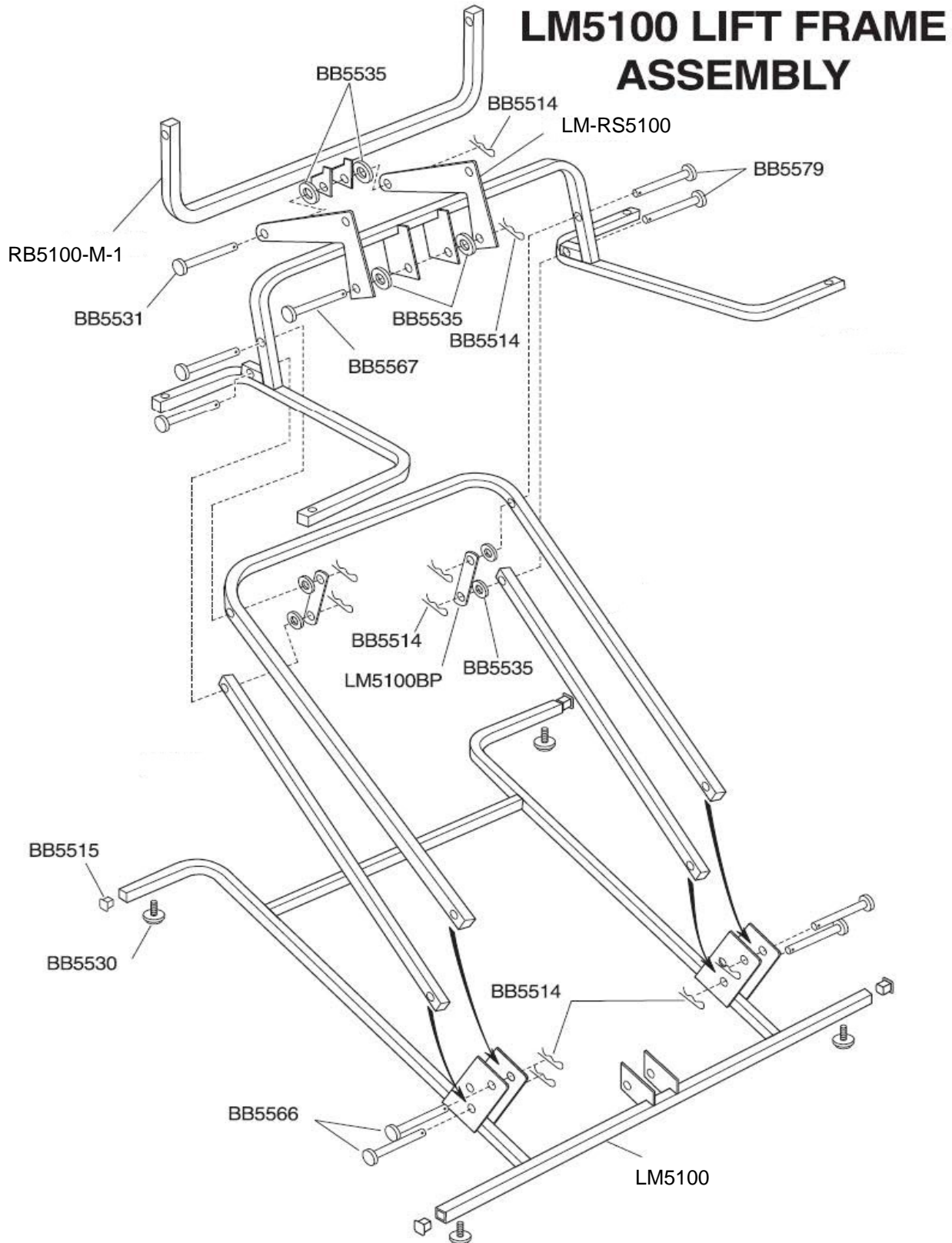

For use in models UC320, UC540-SAA, UC540-M, UC480, UC660, UC550-S, UC550-M, UC552

See parts list for specific parts by model.

LM5100 LIFT MOTOR

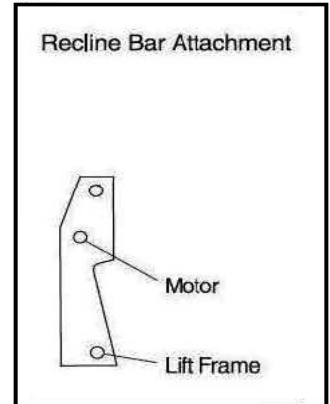
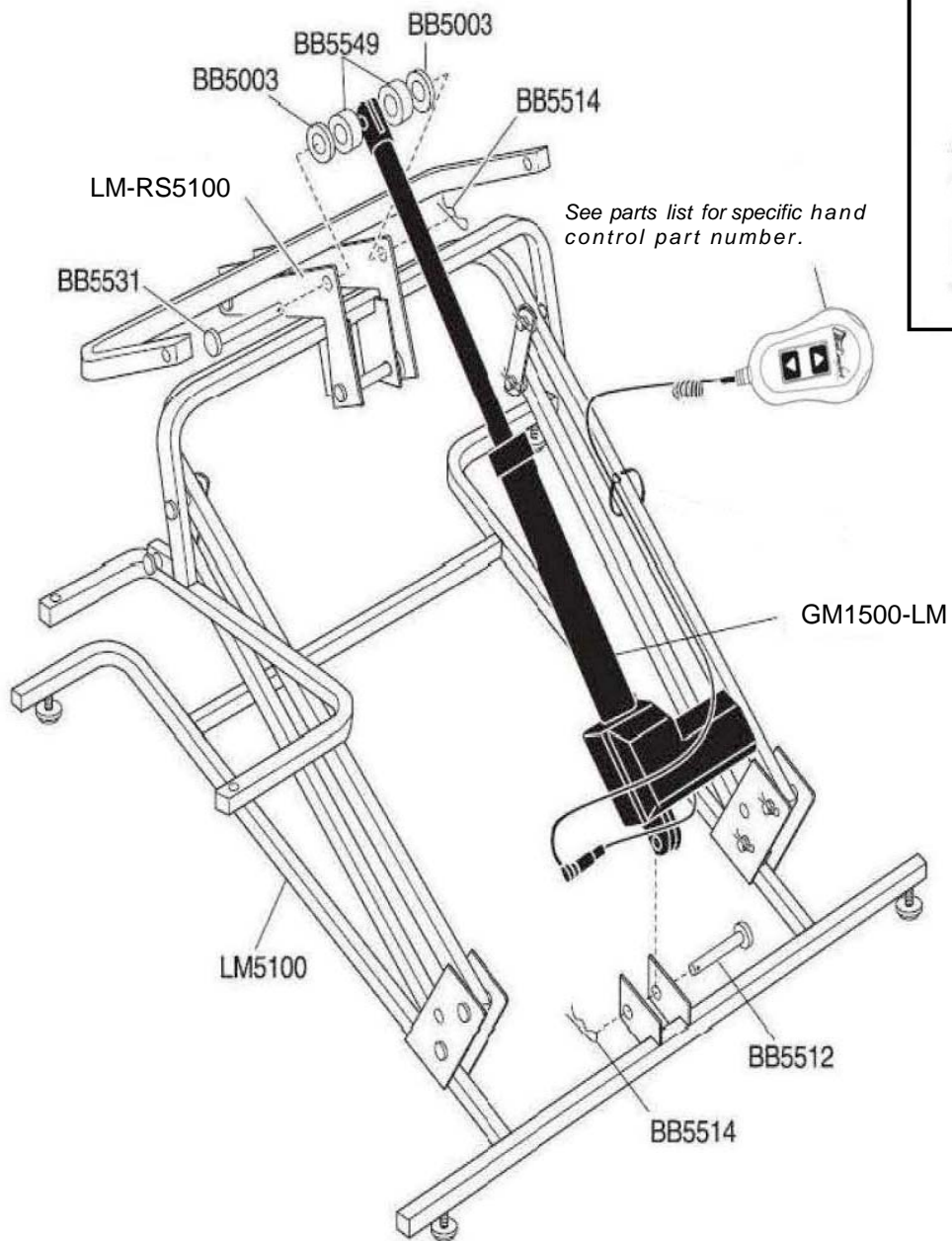

LM5100 LIFT FRAME PARTS LIST

Part Number	Description	Qty. Per Unit
BB5003	Washer, 380 x 750 x 062 Nylon	2
BB5512	Pin, 3/8 x 1 5/8 Zinc Clevis	1
BB5514	Pin, Hitch	11
BB5515	Cap, 1" Square End Chair	8
BB5518	Tywrap, 8" Black	2
BB5530	Leg Leveler 5/16 X 1	4
BB5531	Pin, 3/8 x 2 1/2 Zinc Clevis	1
BB5535	Washer, 750 x 394 x 125 Nylon	6
BB5549	Washer, 400 x 750 x 312 Nylon	2
BB5566	Pin, 3/8 X 1 3/4 Zinc Clevis	4
BB5567	Pin, 3/8 X 2 5/8 Zinc Clevis	1
BB5579	Pin, 3/8 X 2 7/8 Zinc Clevis	4
GM1500-LM	DC INLINE MOTOR	1
LM5100	5100 LIFT FRAME	1
LM-RS5100	RECLINE STRAP 5100 / 6111 SERIES LIFT FRAME	2
ZKUC-10	Hand Wand, 2 Button LED	1
ZKAD-1	Hand Wand Auto Drive for Lift Chairs	1

RECLINE BARS FOR 5100 LIFT FRAME

RB5100-M-1	RECLINE BAR MEDIUM / SMALL	1
------------	----------------------------	---

RECLINE MECHANISMS FOR 5100 LIFT FRAME

RM621L	3 WAY MECHANISM LEFT SIDE	1
RM621R	3 WAY MECHANISM RIGHT SIDE	1
RM8300L	2 WAY MECHANISM LEFT SIDE	1
RM8300R	2 WAY MECHANISM RIGHT SIDE	1

LEFT AND RIGHT IS DETERMINED BY SITTING IN CHAIR

TRANSFORMER FOR 5100 LIFT FRAME

GM1501-A	Motor Chair Transformer	1
GM1501-APUS	Transformer Cord	1

CALL TECHNICAL SERVICE FOR FABRIC, FOAM, SPRING AND WOOD PART NUMBERS AND PRICING

LM5120 LIFT FRAME

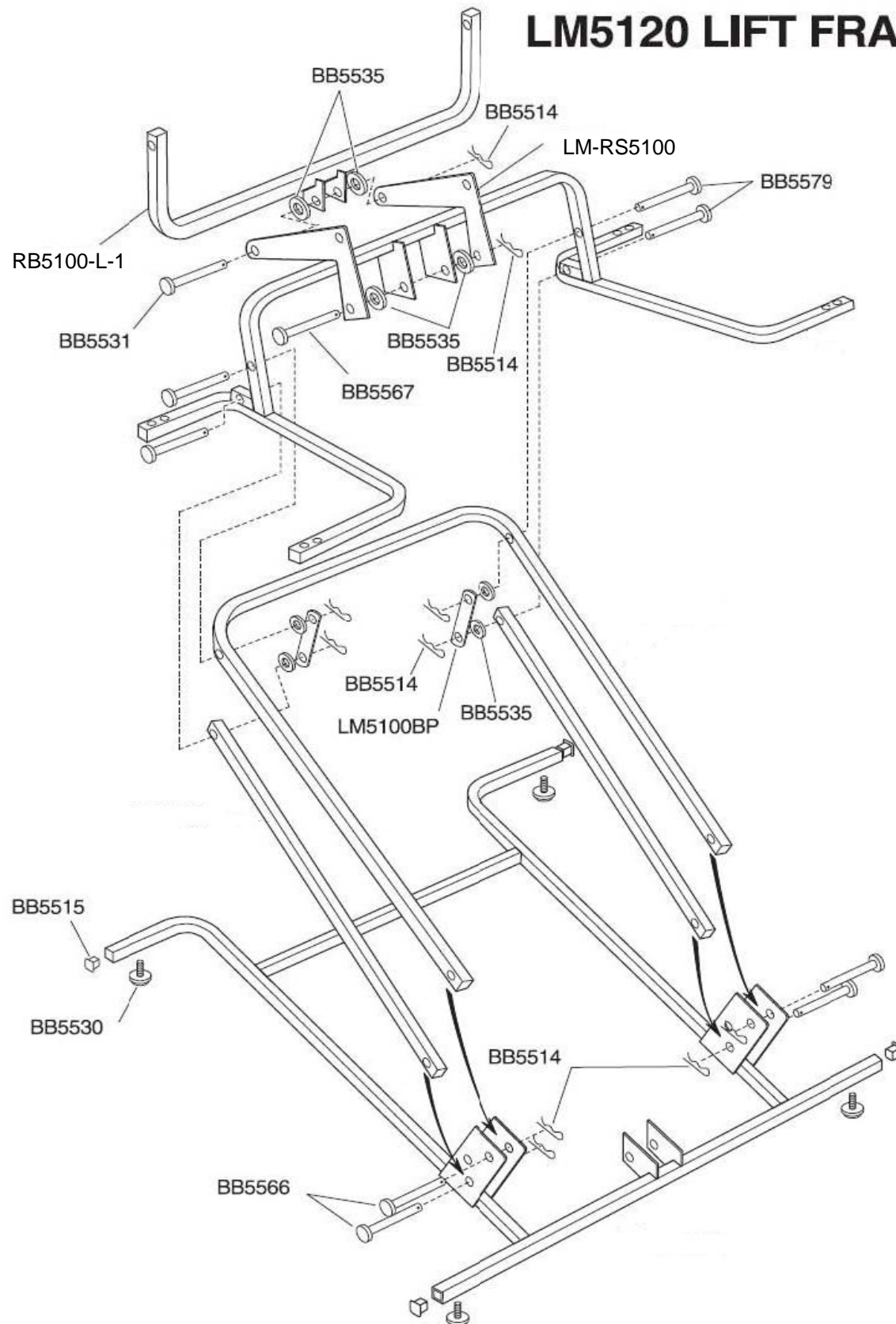

For use in models UC330, UC540-L, UC770, UC550-L, UC556
 See parts list for specific parts by model.

LM5120 LIFT MOTOR ASSEMBLY

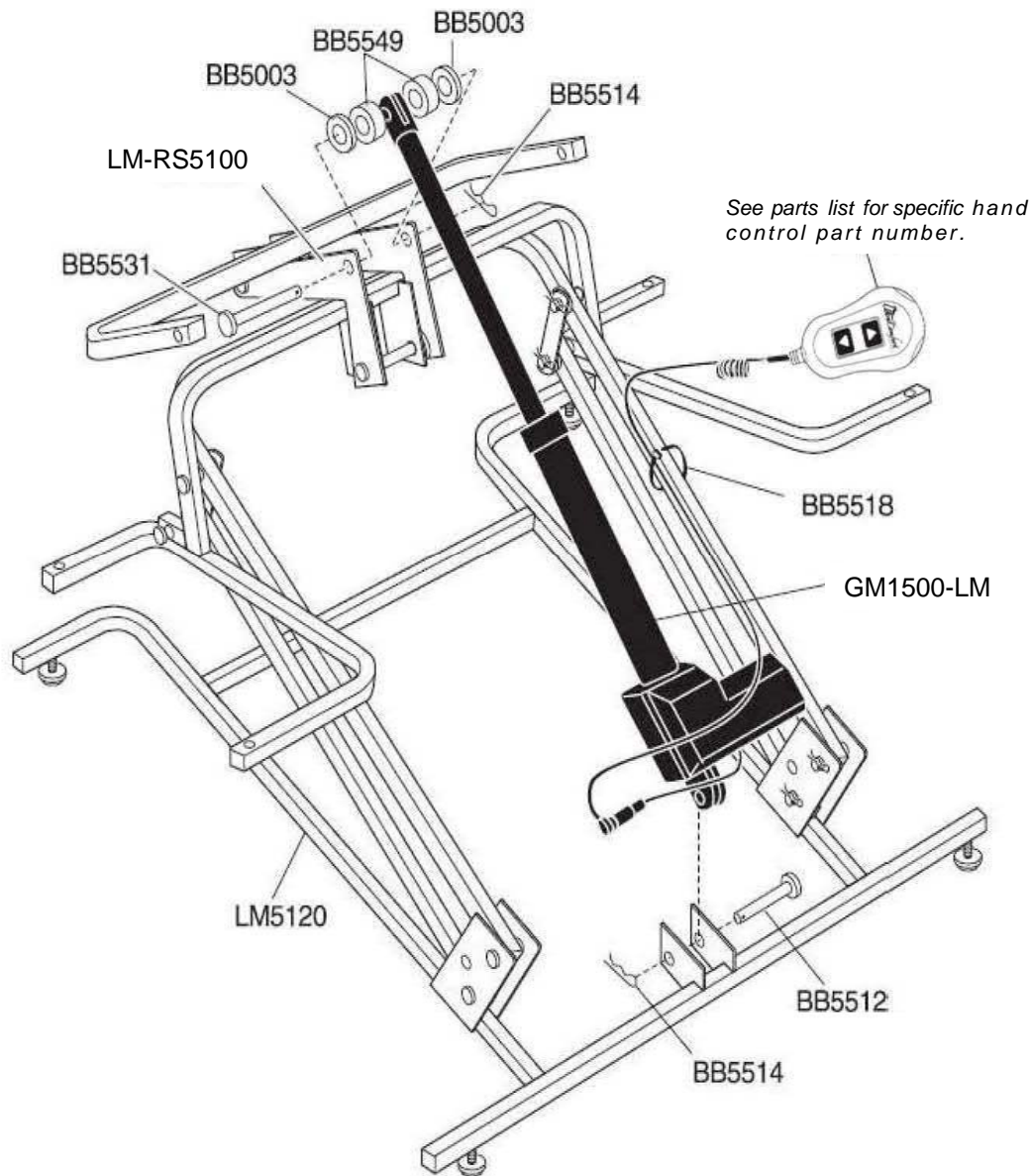

LM5120 LIFT FRAME PARTS LIST

Part Number	Description	Qty. Per Unit
BB5003	Washer, 380 x 750 x 062 Nylon	2
BB5512	Pin, 3/8 x 1 5/8 Zinc Clevis	1
BB5514	Pin, Hitch	11
BB5515	Cap, 1" Square End Chair	8
BB5518	Tywrap, 8" Black	2
BB5530	Leg Leveler 5/16 X 1	4
BB5531	Pin, 3/8 x 2 1/2 Zinc Clevis	1
BB5535	Washer, 750 x 394 x 125 Nylon	6
BB5549	Washer, 400 x 750 x 312 Nylon	2
BB5566	Pin, 3/8 X 1 3/4 Zinc Clevis	4
BB5567	Pin, 3/8 X 2 5/8 Zinc Clevis	1
BB5579	Pin, 3/8 X 2 7/8 Zinc Clevis	4
GM1500-LM	DC INLINE MOTOR	1
LM5120	5120 LIFT FRAME	1
LM-RS5100	RECLINE STRAP 5100 / 6111 SERIES LIFT FRAME	2
ZKAD-1	Hand Wand Auto Drive for Lift Chairs	1
ZKUC-10	Hand Wand, 2 Button LED	1

RECLINE BARS FOR 5120 LIFT FRAME

RB5100-M-1	RECLINE BAR MEDIUM / SMALL	1
RB5100-L-1	RECLINE BAR LARGE / 754	1

RECLINE MECHANISMS FOR 5120 LIFT FRAME

RM621L	3 WAY MECHANISM LEFT SIDE	1
RM621R	3 WAY MECHANISM RIGHT SIDE	1

LEFT AND RIGHT IS DETERMINED BY SITTING IN CHAIR

TRANSFORMER FOR 5120 LIFT FRAME

GM1501-A	Motor Chair Transformer	1
GM1501-APUS	Transformer Cord	1

CALL TECHNICAL SERVICE FOR FABRIC, FOAM, SPRING AND WOOD PART NUMBERS AND PRICING

LM6111 LIFT FRAME

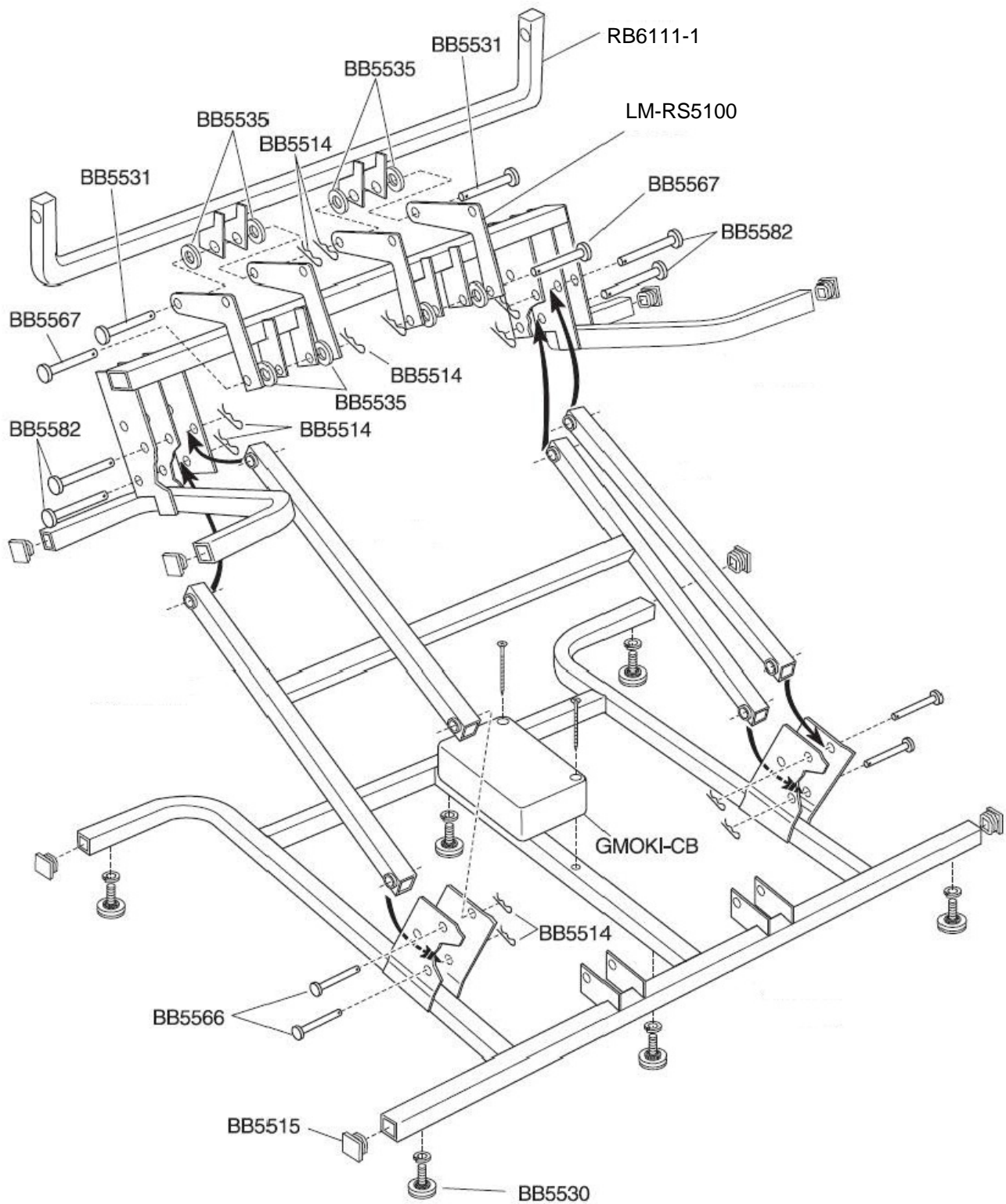

For use in models UC540M-26
 See parts list for specific parts by model.

LM6111 LIFT MOTOR

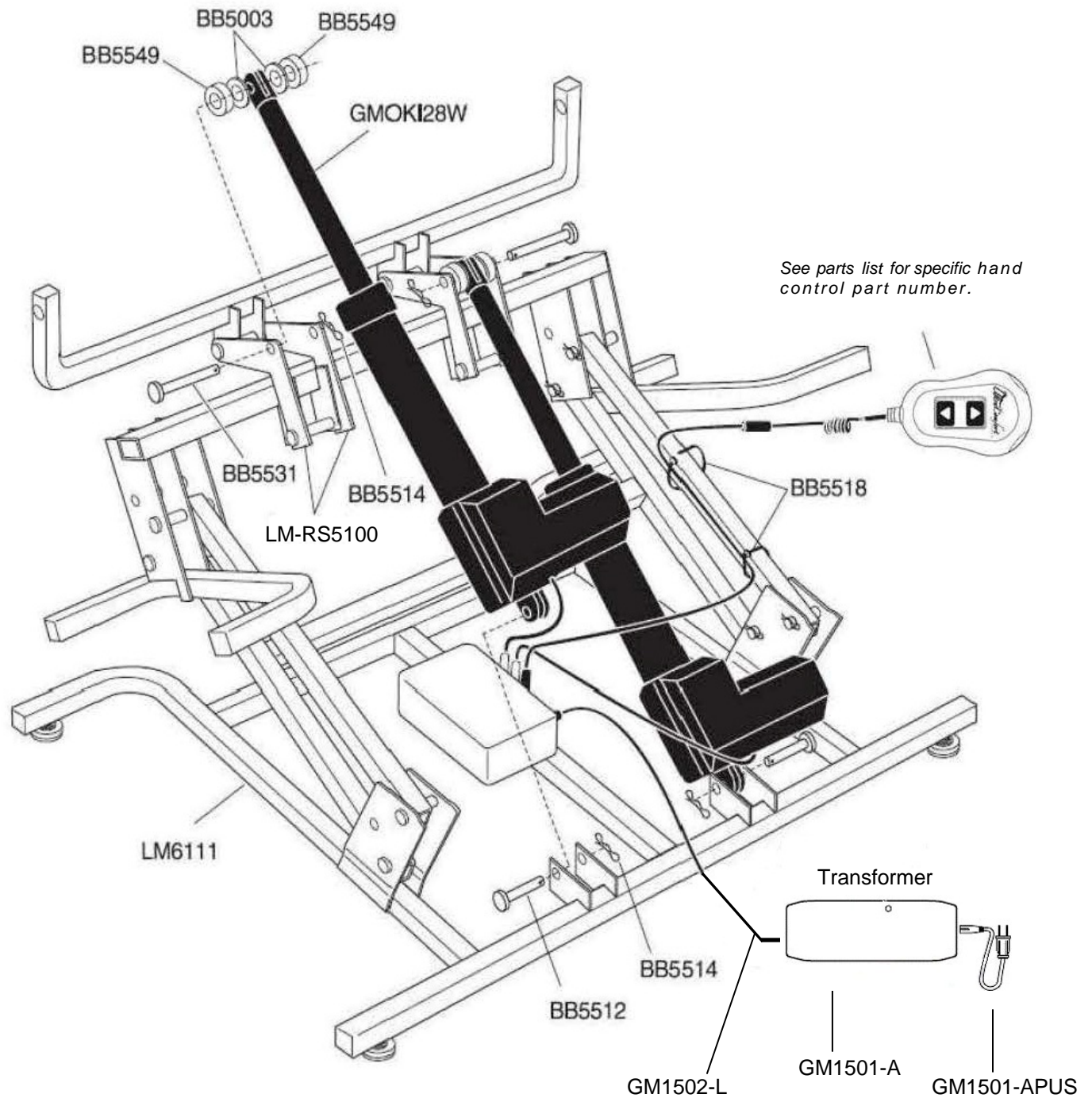

LM6111 LIFT FRAME PARTS LIST

Part Number	Description	Qty. Per Unit
BB5003	Washer, 380 x 750 x 062 Nylon	4
BB5512	Pin, 3/8 x 1 5/8 Zinc Clevis	2
BB5514	Pin, Hitch	13
BB5515	Cap, 1" Square End Chair	8
BB5518	Tywrap, 8" Black	2
BB5530	Leg Leveler 5/16 X 1	6
BB5531	Pin, 3/8 x 2 1/2 Zinc Clevis	2
BB5535	Washer, 750 x 394 x 125 Nylon	4
BB5549	Washer, 400 x 750 x 312 Nylon	4
BB5566	Pin, 3/8 X 1 3/4 Zinc Clevis	4
BB5567	Pin, 3/8 X 2 5/8 Zinc Clevis	2
BB5582	Pin, 3/8 X 3 Zinc Clevis	4
GMOKI-28W	Motor Chair Okin 26-28 Wide Motor	2
GMOKI-CB	Motor Chair Okin 26-28Wide Control Box 4/2003	1
GM1502L	LOW VOLTAGE POWER CORD (Extension wire low voltage)	1
LM6111	Dual Motor Lift Frame	1
LM-RS5100	RECLINE STRAP 5100 / 6111 SERIES LIFT FRAME	2
ZKUC-10	Hand Wand, 2 Button LED	1

RECLINE BARS FOR 6111 LIFT FRAME

RB6111-1	DUAL MOTOR RECLINE BAR	1
----------	------------------------	---

RECLINE MECHANISMS FOR 6111 LIFT FRAME

RM621L	3 WAY MECHANISM LEFT SIDE HEAVY DUTY	1
RM621R	3 WAY MECHANISM RIGHT SIDE HEAVY DUTY	1

LEFT AND RIGHT IS DETERMINED BY SITTING IN CHAIR

TRANSFORMER FOR 6111 LIFT FRAME

GM1501-A	Motor Chair Transformer	1
GM1501-APUS	Transformer Cord	1

CALL TECHNICAL SERVICE FOR FABRIC, FOAM, SPRING AND WOOD PART NUMBERS AND PRICING

LM5200M-RO (Recline Only) FRAME

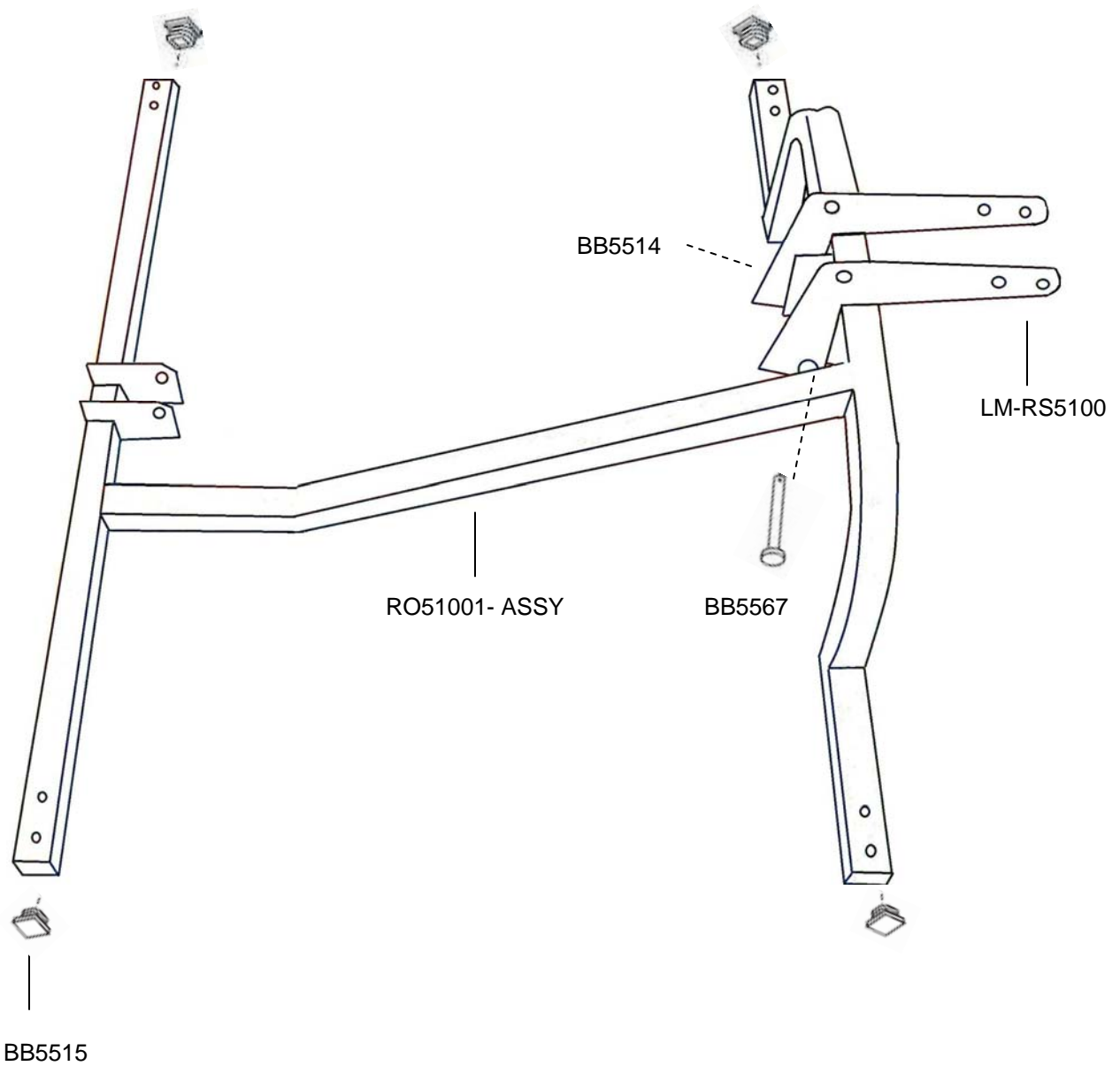

For use in models UC551-S, UC551-M, UC551-L, UC553, UC557
See parts list for specific parts by model.

LM5200M-RO (Recline Only) MOTOR

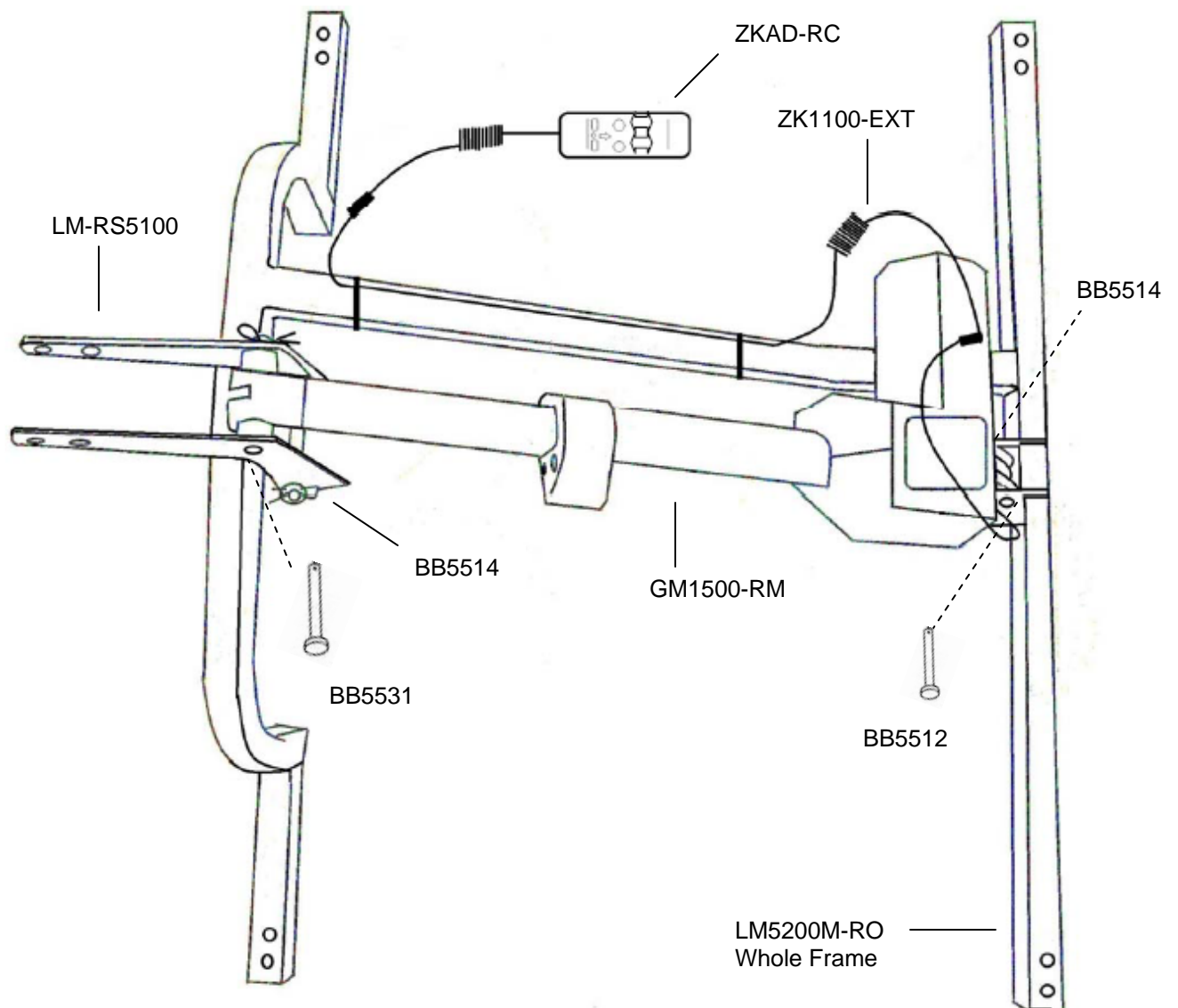

LM5200M-RO FRAME PARTS LIST

Part Number	Description	Qty. Per Unit
BB5003	Washer, 380 x 750 x 062 Nylon	2
BB5512	Pin, 3/8 x 1 5/8 Zinc Clevis	1
BB5514	Pin, Hitch	5
BB5515	Cap, 1" Square End Chair	4
BB5518	Tywrap, 8" Black	2
BB5530	Leg Leveler 5/16 X 1	4
BB5531	Pin, 3/8 x 2 1/2 Zinc Clevis	1
BB5549	Washer, 400 x 750 x 312 Nylon	2
BB5567	Pin, 3/8 X 2 5/8 Zinc Clevis	1
GM1500-RM	RECLINE ONLY MOTOR	1
GM1500-ASSY	DC MOTOR COMPLETE	1
RO51001-ASSY	COMPLETE 5200 RECLINE ONLY FRAME ASSEMBLY	1
LM-RS5100	RECLINE STRAP 5100 / 6111 SERIES LIFT FRAME	2
ZK1100-EXT	Hand Control Extension	1
ZKAD-RC	Hand Wand Auto Drive for Lift Chairs	1

RECLINE BARS

RB5100-M-1	RECLINE BAR MEDIUM / SMALL	1
RB5100-L-1	RECLINE BAR LARGE / 754	1

RECLINE MECHANISMS

RM620L	Left Side Stellar Comfort Mechanism	1
RM620R	Right Side Stellar Comfort Mechanism	1

LEFT AND RIGHT IS DETERMINED BY SITTING IN CHAIR

TRANSFORMER

GM1501-A	Motor Chair Transformer	1
GM1501-APUS	Transformer Cord	1

CALL TECHNICAL SERVICE FOR FABRIC, FOAM, SPRING AND WOOD PART NUMBERS AND PRICING

Stellar Comfort Recline Mechanism

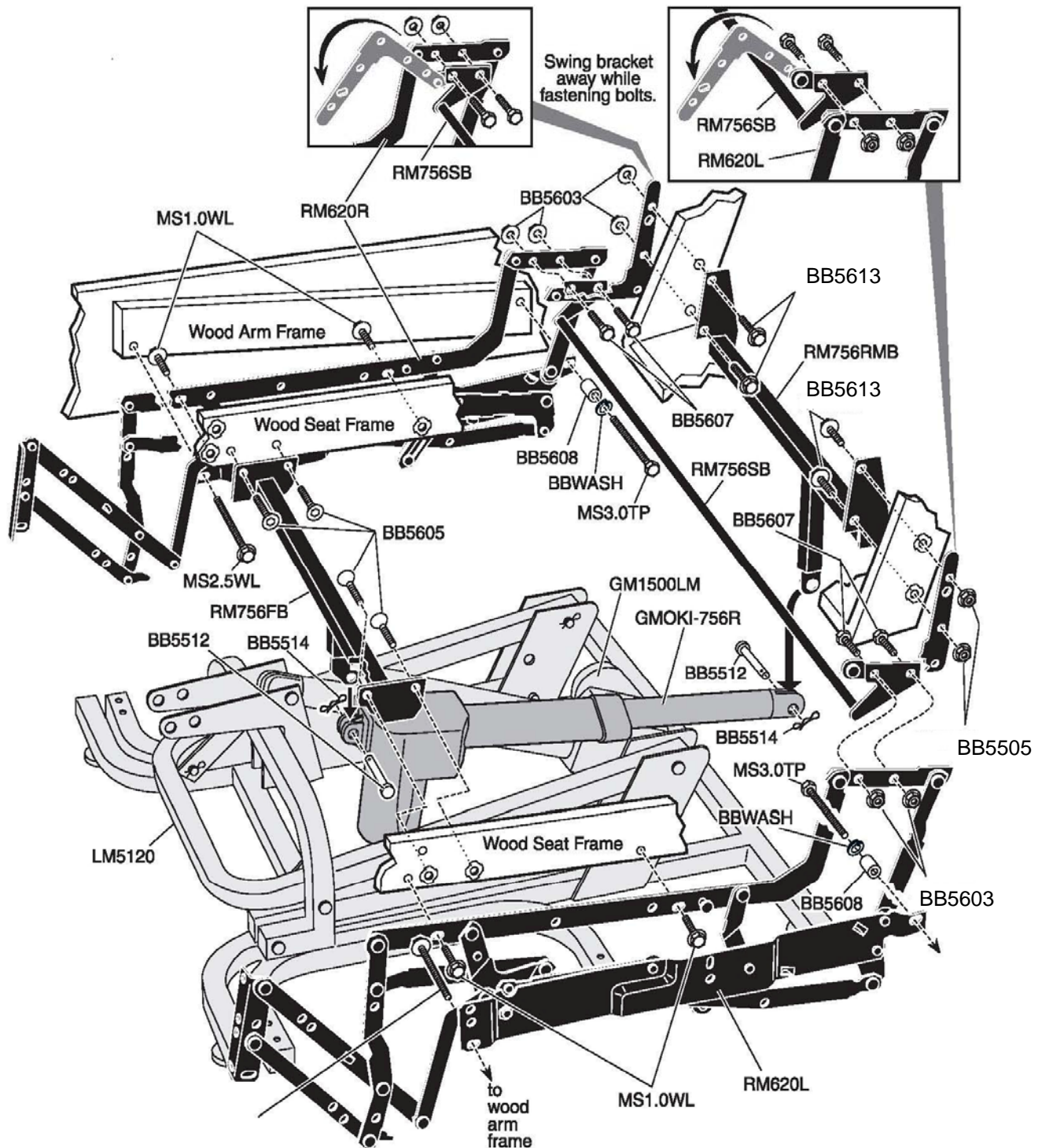

For use in models UC550-S, UC550-M, UC550-L, UC552, UC556, UC551-S, UC551-M, UC551-L, UC553, UC557

See parts list for specific parts by model.

Power Connections

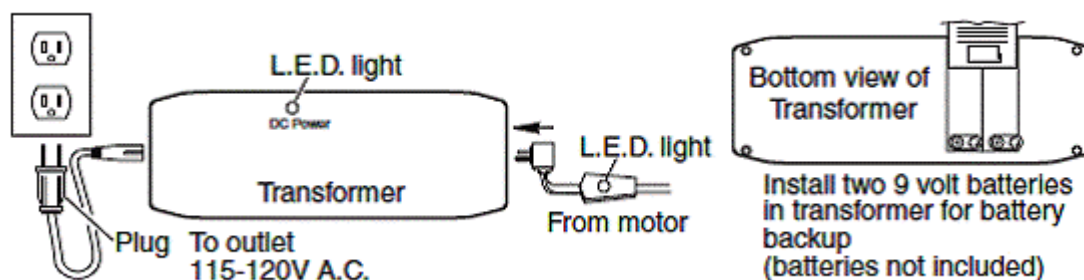

Models: UC211, UC320, UC330, UC540-SAA, UC540-M, UC540-L, UC540M-26, UC480, UC550-S, UC550-M, UC550-L, UC552, UC660, UC770, UC551-S, UC551-M, UC551-L, UC553, UC557

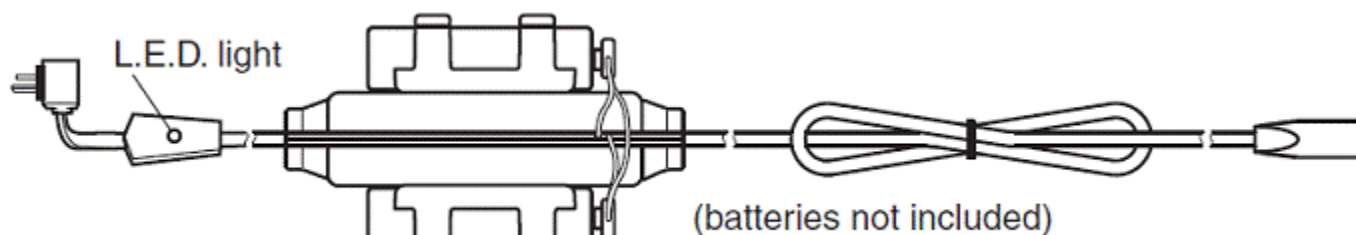

Model: UC540-XL

Back Installation:

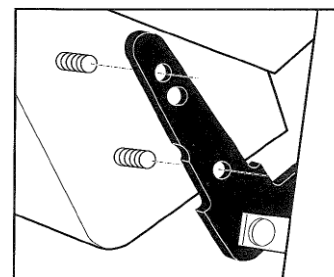
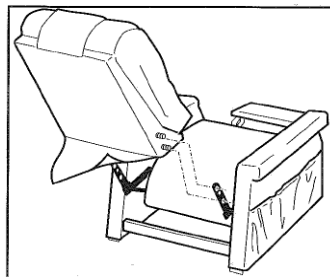
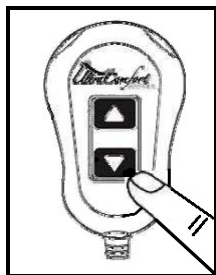
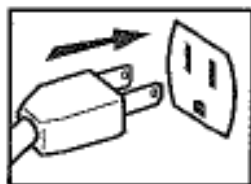

1. Plug the lift chair into a standard (115-120VAC) wall outlet.
2. Press the down arrow on the hand control until the footrest is about parallel to the floor. This will expose the back brackets at the rear of chair.
3. Slide the back down between the brackets until the threaded studs on the back slip thru the holes in the brackets as shown.

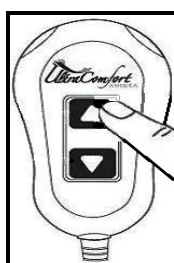
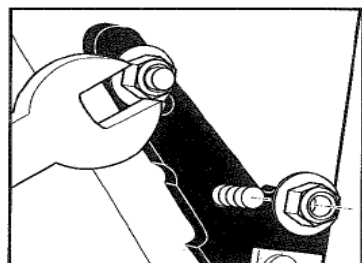

4. Thread the flange lock nuts onto the studs and tighten securely using the supplied wrench or a 7/16" box wrench. Return the chair to the seated upright position by pressing the up arrow on the hand control.
5. Attach the bottom of the outside back to the Velcro on the arm cross rail.

Hand Controls

Lift & Recline and Recline Only

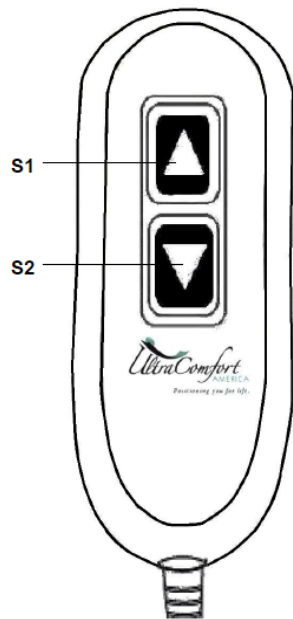

***Models:** UC211, UC320, UC330, UC540-SAA, UC540-M, UC540-L, UC540M-26, UC480, UC660, UC770

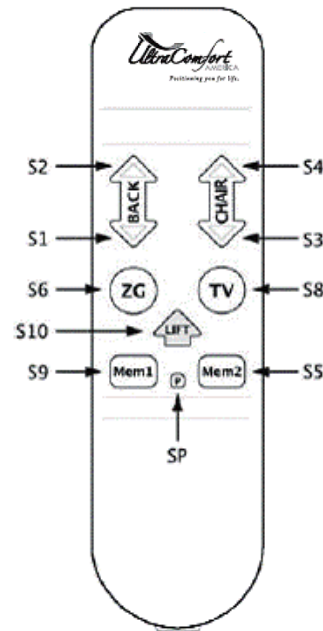

***Models:** UC552, UC556, UC550-S, UC550-M, UC550-L, UC552, **UC551-S, **UC551-M, **UC551-L, **UC553, **UC557

* Hand Control models currently being used.

** Recline only models. Switch S10 the lift function does not apply to recline only chairs. The chair will only open or close when switch S10 is pressed.

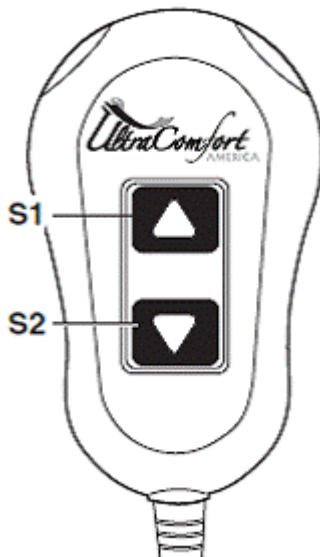

Models: UC211, UC320, UC330, UC540-SAA, UC540-M, UC540-L, UC540M-26, UC480, UC660, UC770

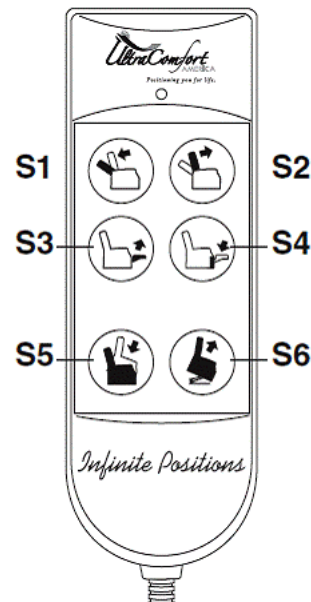

Models: UC550-S, UC550-M, UC550-L, UC552, UC551-S, UC551-M, UC551-L, UC553

Note: For individual switch functions on each hand control, refer to the owner's manuals.

Lift & Recline and Heat & Massage



*Models: UC340, UC480

To Operate Lift

Press Up key to raise chair. Press DOWN key to lower chair.

To Lock/Lift

Press and hold LOCK/UNLOCK key for approximately 3 seconds until red lock icon is lit.

To Unlock Lift

Press and hold LOCK/UNLOCK key for approximately 5 seconds until green unlock icon is lit.

To Operate Heat

Press HEAT key to turn on. Press HEAT key again to turn off.

To Operate Massage

Press MASSAGE key to turn on massage. Press again to change from WAVE/STEADY/PULSE modes (colored LEDs indicate selection).

To Turn Massage Off

Press and hold MASSAGE key.

Massage Intensity

Press INTENSITY key to choose from LO/MED/HI (colored LEDs indicate selection).

NOTE: The heat and massage is controlled by a 20 minute timer.

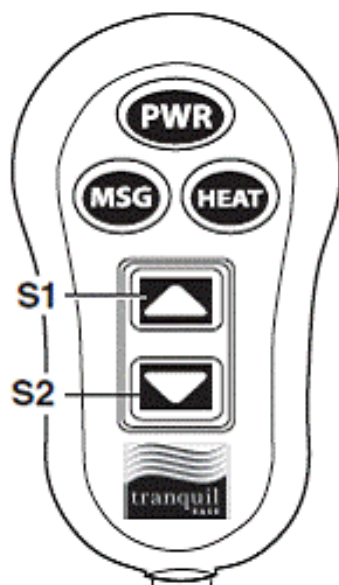

Models: UC340, UC480

Input Power: +27Vdc Switching Power Supply

PWR Button Operation:

Red = Intensity High

Amber = Intensity Medium

Green = Intensity Low

No Color = Turns off All Wand Functions.

MSG Button Operation:

Changing Colors = Wave Mode

Steady Amber = Steady Mode

Pulsing Amber = Pulse Mode

HEAT Button Operation:

Red = Heat High

Green = Heat Low

Arrow Key Operation:

Arrow Up = Recline Position

Arrow Down = Seated Position

Timer Functions: There are two separate timer functions, One for Heat, and the other for Massage functions.

Heat Timer – Heat timer is activated when the heat button is depressed. Timer is factory set for 20 minutes.

Massage Timer- Massage timer is activated when the PWR button is depressed. Timer is factory set for 20 minutes.

* Hand Control models currently being used.

Heat & Massage Only - Hand Control

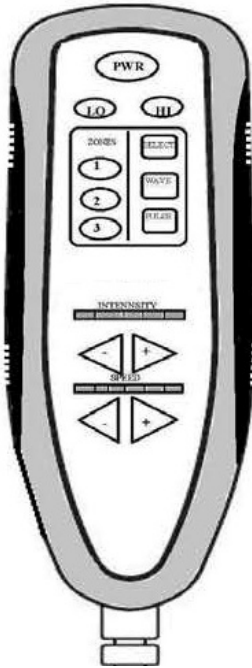

Press PWR to turn On or Off.

15 Minute Timer: Single Press (**GREEN**)

30 Minute Timer: Press & Hold (**ORANGE**)

Press LO or HI to turn HEAT ON or OFF.

Independent 30 Minute Timer.

Press any or all ZONE keys to turn any ZONE On or Off.

Press SELECT, WAVE, or PULSE for desired operating mode.

Press – (Left) to decrease or + (Right) to increase INTENSITY and SPEED.

***Models:** All with standard heat & massage.

** Hand Control models currently being used.*

Infrared Heat Only – Hand Control

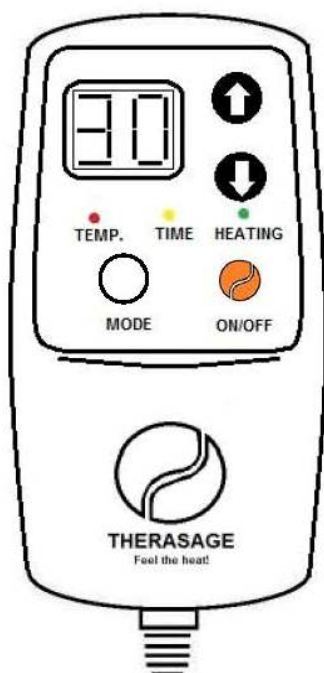

***Models:** All with Far Infrared Heat.

- Press ON and the temperature light will turn on. Controller is pre-set to a low/medium heat level and a 60 minute session.
- Once turned ON, it will display the session time and will count down from the pre-set 60 minutes.
- The temperature level can be adjusted by pressing the up or down arrows, up for more heat, down for less heat.
- The time can only be adjusted when the Controller is OFF.
- Use the MODE button to set the time setting.
- Adjust your time by using the up and down arrows press while the time light is on, up to increase time and down to set less time. Adjustments are in 15 minute increments.
- By pressing the MODE button a second time, the display will return to the temperature setting for any future adjustments.
- After setting the desired time and temperature, the system will be ready to use when you press the ON/OFF button. A heater light will indicate that the system is on and working. When your session is complete the light will go off and the controller will display your heat level.
- For your convenience, the controller will default to the previous setting upon your next use. While it is suggested that the preset temperature, the second grade, and 60 minutes' working time is the best choice, you can set the temperature and time in accordance with your own personal demands.
- Finally, the electrical power should be turned off after use.

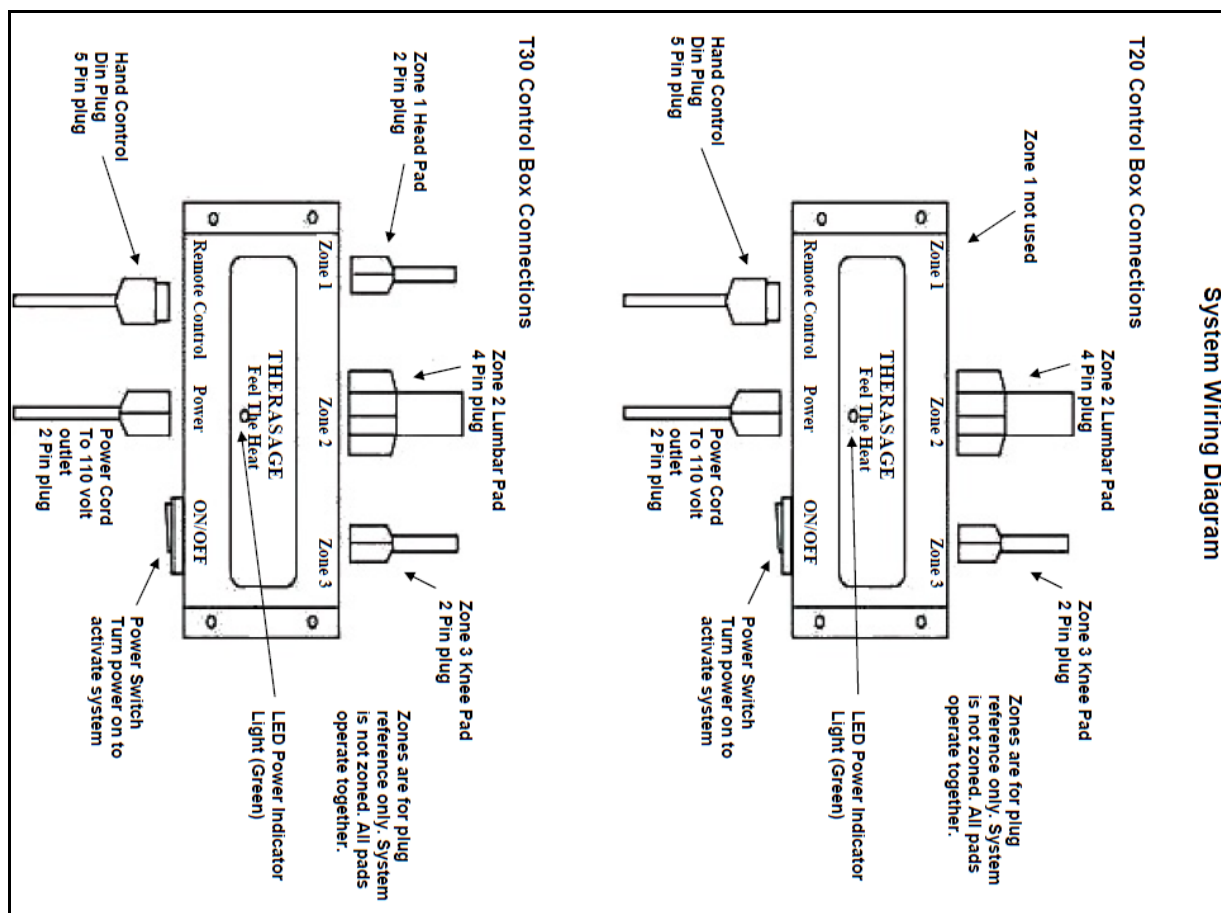

** Hand Control models currently being used.*

Grease Points



WARNING Applying any type of lubricant as a routine maintenance procedure is not necessary. If lubricating the lift chair to alleviate excessive noise, only apply the specified lubricant at the locations shown below. Do not apply excessive lubricant. Excessive lubricant could leak onto the chair or the floor causing damage.

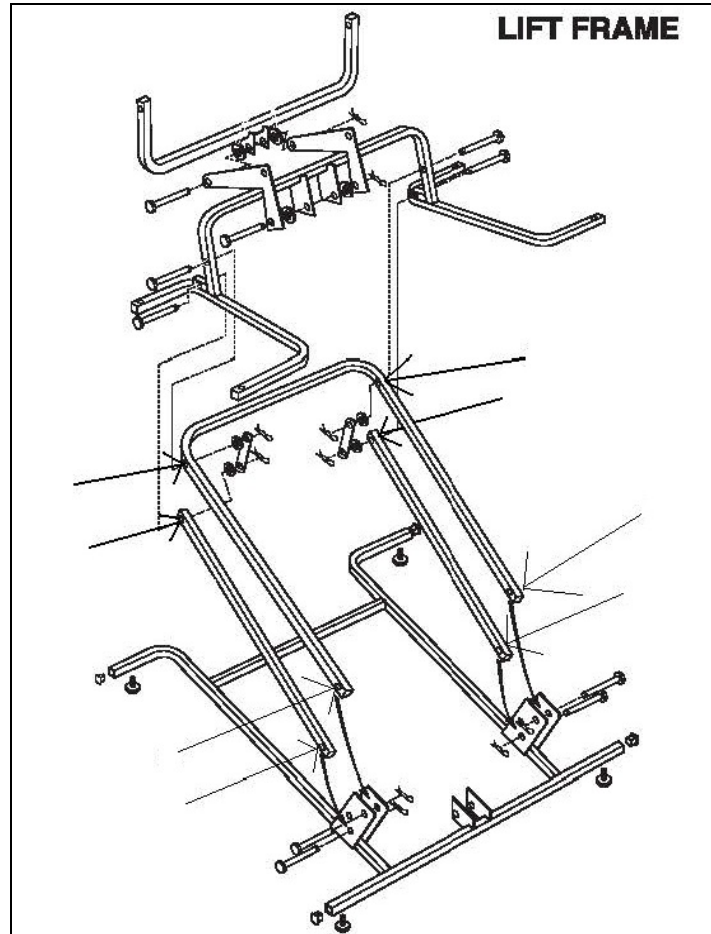

USE WHITE LITHIUM GREASE

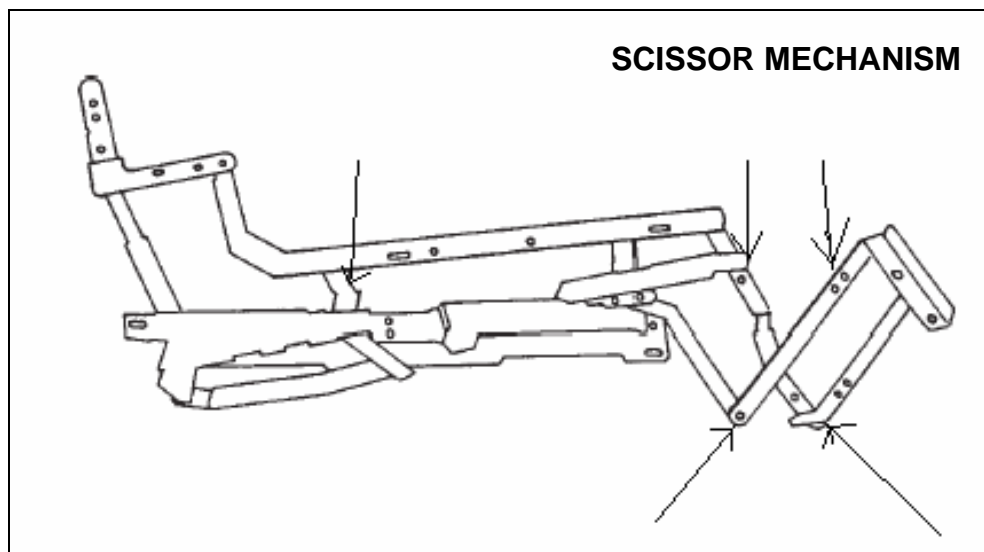

USE ZEP2000

Lift Chair Cut Away

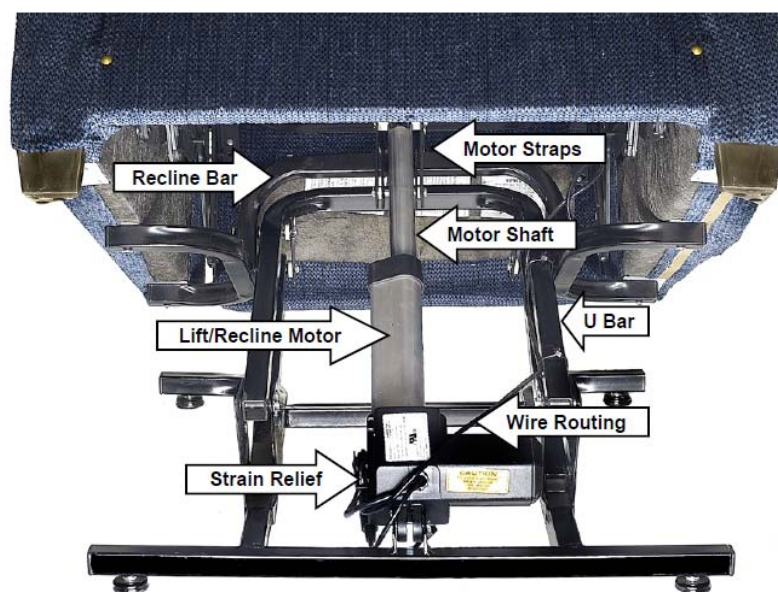

Bottom View

Note: The above illustrations are intended as general information. They do not represent the models in this manual.

Lift Chair Boxing Instructions

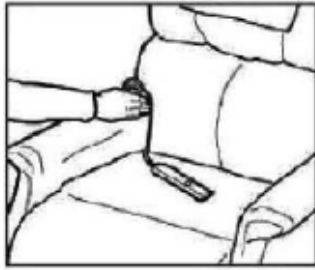

Tuck cord from hand control between arm & back of chair.

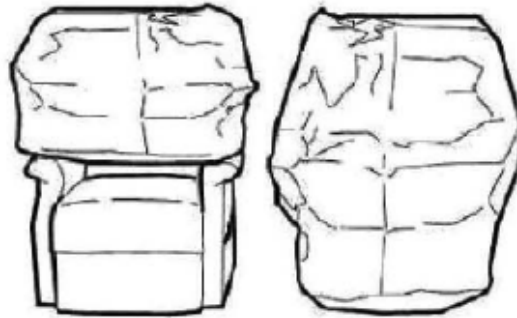

Place bag over chair.

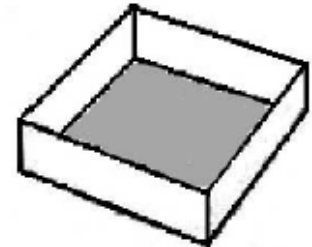

Place bottom tray on floor with opening facing up.

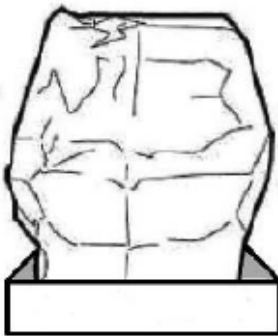

Place chair into bottom tray.

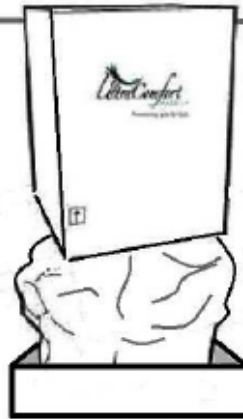

With the UltraComfort name in the upright position, place the sleeve over the chair and into the bottom tray.



Note: Use approved 3" packaging tape.

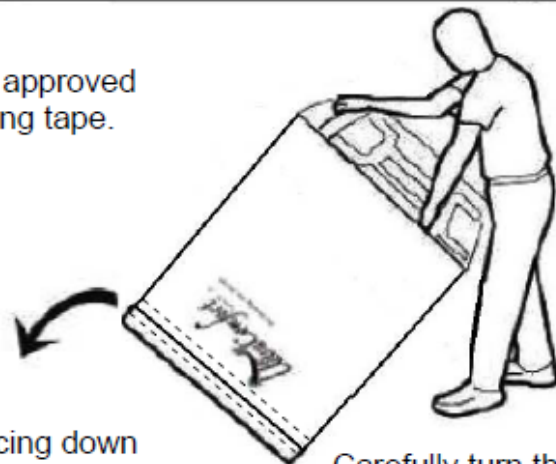

Place top tray onto the sleeve with opening facing down and tape along each edge, 360 degrees.

Note: Banding can be used in place of tape if available. Place bands vertically around top and bottom trays and secure only after all packaging steps are complete.

Carefully turn the box over so that the bottom is facing up. Remove the bottom tray and retain.

Lift Chair Boxing Instructions

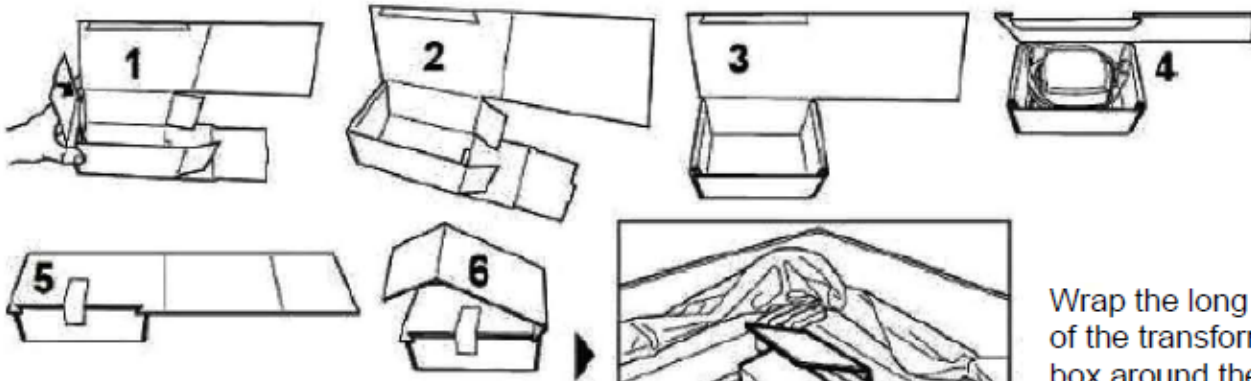

Construct the box for the transformer, (1, 2, 3). Place transformer in box (4) & tape it closed (5).

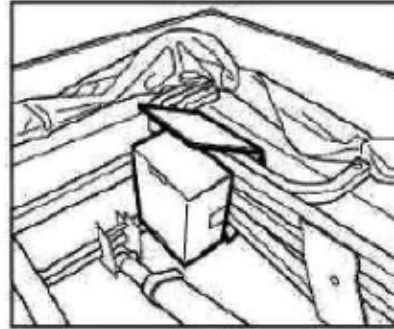

Wrap the long flap of the transformer box around the frame as shown. Then tape it so it is secure.

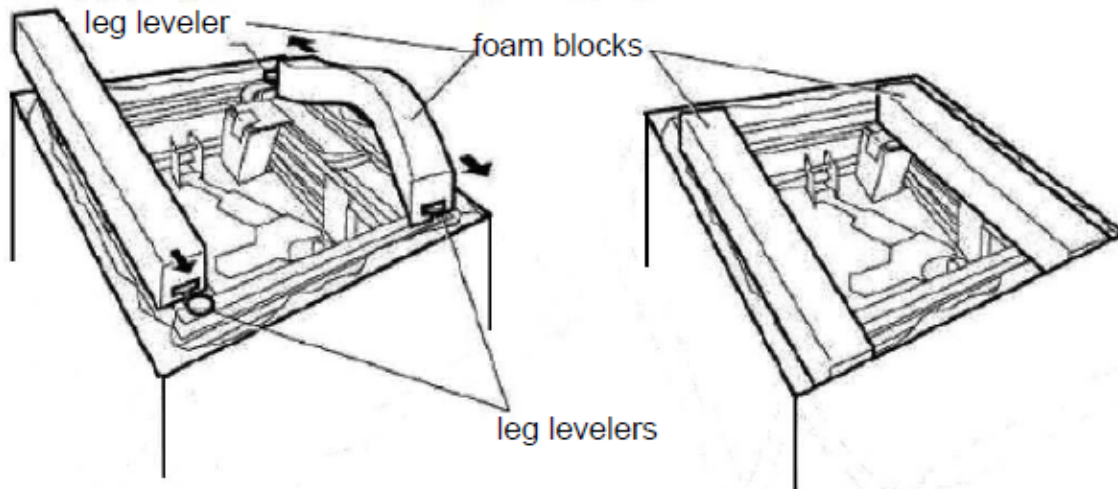

Slide the groove of the foam blocks onto the leg levelers, first onto one, then onto the opposite one, so that the foam is locked into place.

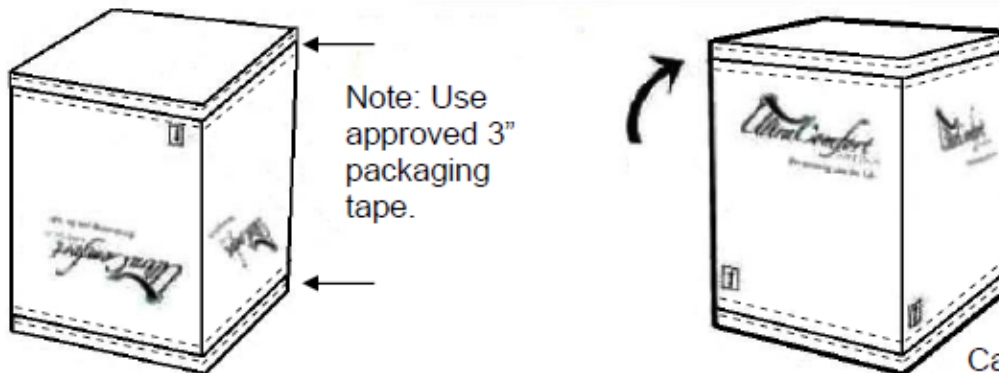

Note: Use approved 3" packaging tape.

Place the bottom tray onto the sleeve with the opening facing down and tape along each edge, 360 degrees.
Note: Banding can be used in place of tape if available.
 Place bands vertically around top and bottom trays and secure.

Carefully turn the box over so the UltraComfort name is in the upright position.

UC540M-26 Model Only

Lift Chair Boxing Instructions



With UltraComfort name in the upright position, form flaps for top of box and tape them.

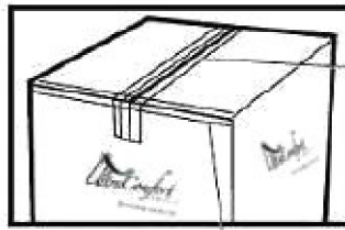

3 strips of tape across the middle.

1 strip of tape along each edge.

NOTE: Use approved 3" packaging tape.

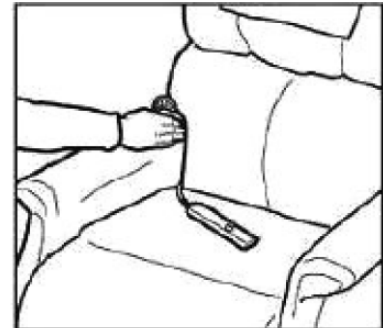

Tuck cord from hand control between arm & back of chair.

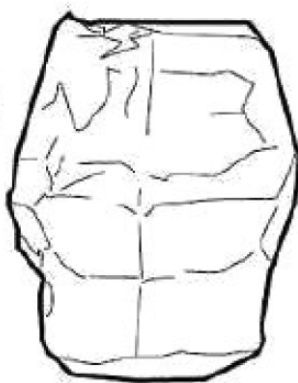
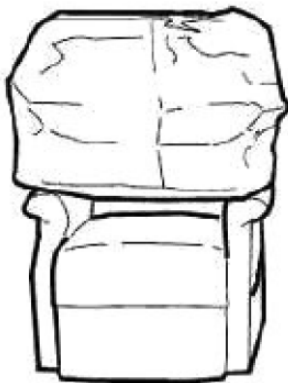

Place bag over chair.



Place box over bagged chair. Make sure UltraComfort's name is upright on the box.

NOTE: Never force box onto chair. If the box is too tight, try turning it 90 degrees to see if it fits better.



Gently flip box to the upside down position.

UC540M-26 Model Only

Lift Chair Boxing Instructions

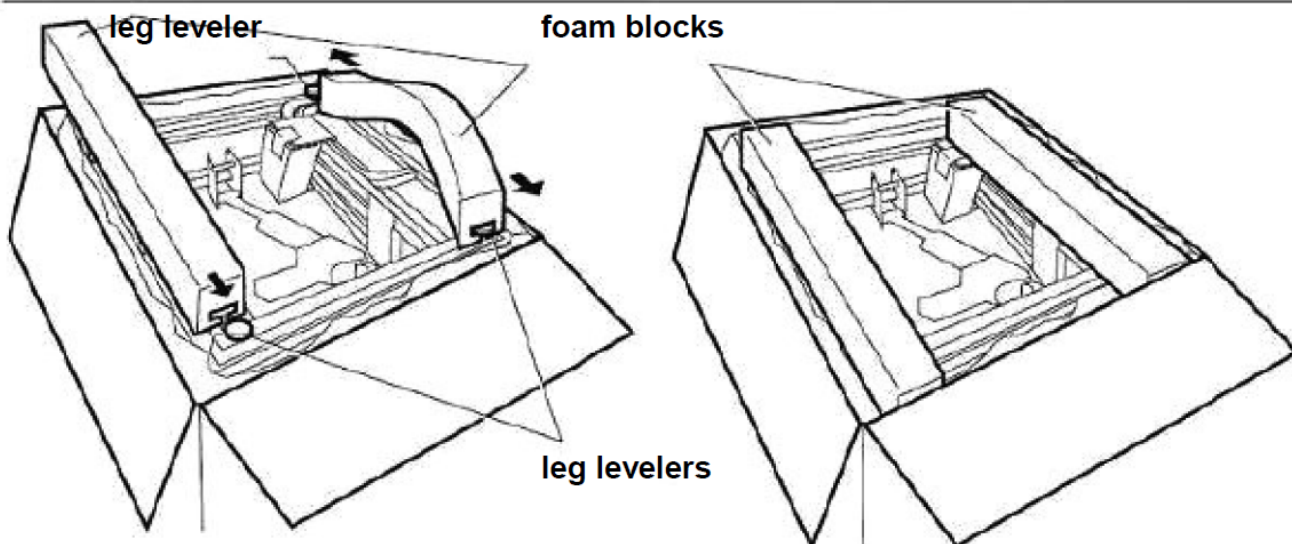
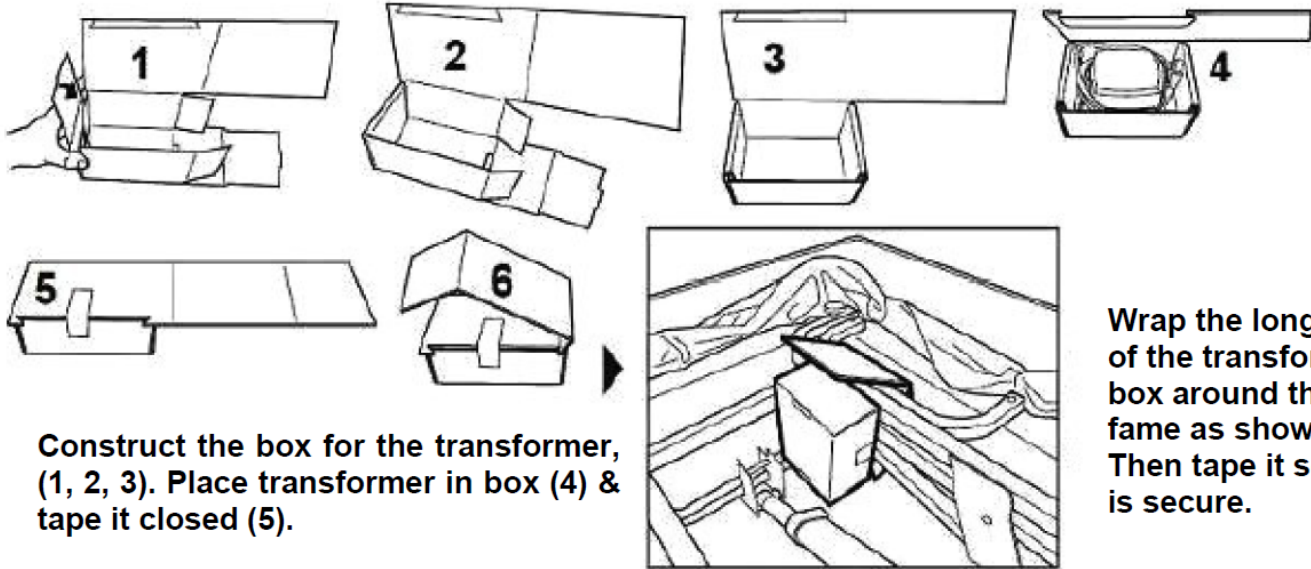

Slide the groove of the foam blocks onto the leg levelers, first onto one, then onto the opposite one, so that the foam is locked into place.

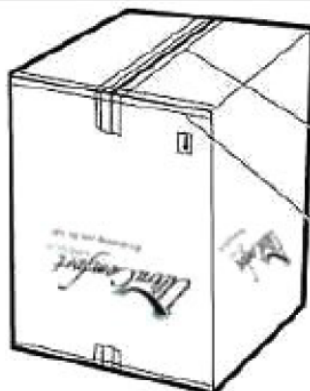

Tape bottom of box.

3 strips of tape across the middle.

1 strip along each edge.

NOTE: Use approved 3" packaging tape.



Gently flip box to the upright position.

⚠ **CAUTION** ⚠
READ BEFORE OPERATING
FAILURE TO DO SO MAY VOID WARRANTY

Chair must be placed to allow free movement between:

BACK of CHAIR and WALL
FOOTREST and any object in FRONT of CHAIR

Keep children, pets and foreign objects from back of chair or underneath chair and from in front of footrest while operating chair.

Do not allow children to play on this mechanized furniture or operate the mechanism.

Leg rest folds down on closing so that a child could possibly be injured.

Always leave chair in a sitting position. Keep hands and feet clear of mechanism. Only the occupant should operate it.

Failure to do so may cause injury or damage to chair.



Positioning you for life.

1-866-793-5100