

TABLE OF CONTENTS

Preface	2
Troubleshooting Procedure	3
General Notes	4
Section I, Litebox Housing Disassembly/Assembly Procedures	5
Section II, Testing/Replacing the Lamp	8
Section III, Testing the Litebox Battery	9
Section IV, Testing/Replacing the Switch	10
Section V, Testing/Replacing the Wiring Harness	11
Section VI, Testing/Repairing the Printed Circuit	15
Section VII, Testing and Repairing the Charging System	18
Appendix I , Identifying and Testing the Power Failure Model	23
Appendix II , Litebox Replacement Parts and Diagram	24
Appendix III , Testing and Repairing the SL - 40X	25
Appendix IV , SL- 40X Replacement Parts and Diagram	30

LITEBOX SERVICE MANUAL

PREFACE

The purpose of this manual is to provide the information needed to service the Streamlight Litebox flashlight system.

This manual is dated (see front cover). Additions, deletions and changes to this manual will display a later date.

A set of tools including a Philips screwdriver, pliers, and a multimeter are required to service the Litebox.

Additional tools which are available:

- (1) Switch boot tool, Streamlight P/N 450074
- (2) Strain relief tool, Streamlight P/N 450075

Lamp may be changed without special tools.

For additional information and/or assistance contact:

STREAMLIGHT, INC.

Repair Department
1030 West Germantown Pike
Norristown, Pa. 19403
Phone (610) 631-0600
Phone (800) 523-7488
FAX (610) 631-0712
7:00 a.m.-5:00 p.m. EST

GENERAL NOTES

Troubleshooting Note

A troubleshooting diagram is provided (page 3) to help enable a repair technician to isolate and repair electrical problems which can arise. The diagram describes a condition and suggests the underlying cause. Repair procedures are provided in the chapters indicated in the solution blocks. The troubleshooting procedure does not attempt to isolate individual components. Instead it suggests replacement of modules or assemblies such as the printed circuit board, the battery, the switch, etc. Occasionally problems may arise which are not included in the troubleshooting procedure. In these cases a thorough physical inspection may reveal a broken wire, cracked or damaged circuit board, or some other mechanical damage which results in an apparent electrical problem. If the Litebox can be turned "on" and "off" and the problem is still elusive the printed circuit board may be malfunctioning. The printed circuit board can be replaced as a module (see Section IV). If the problem remains elusive the Litebox and all of its available components (including the mounting rack and plug-in wall charger) should be returned to Streamlight for factory service.

The Red and Green Charge Indicators

The Litebox is equipped with two LED's which light to indicate the mode which the charging circuit is in. The red LED indicates that the battery is being charged. The green LED indicates that the charging cycle is complete and the battery is at maximum capacity.

The LED's can warn of malfunctions within the charging circuitry. The red LED should turn "off" completely twenty-four (24) hours or less after the charge cycle is initiated and the green LED should turn "on". If the red LED remains lit for more than 24 hours the charging circuit must be tested and replaced or repaired as necessary (see section VI).

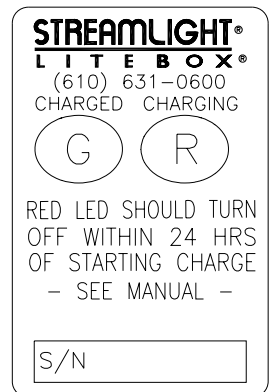

Additional Information

Important Note : When mounting or repairing the charge rack Do Not Use anaerobic thread locking compounds (Loc-tite, etc). Chemical reactions caused by the curing of these compounds destroys the mold

Caution : Adjustments should be performed only with the proper tools. In serious damage settings may require

The plugs and spacers should be used to minimize corrosion. Be sure that the power pin is properly seated.

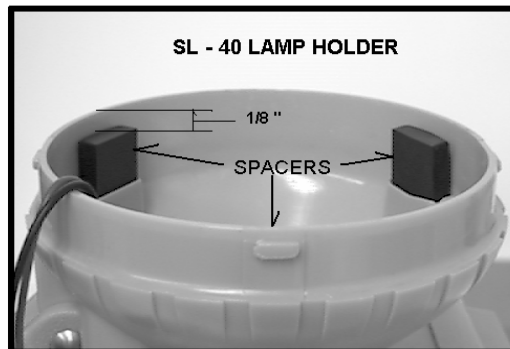

the Litebox should be properly adjusted. Improper adjustment may result in damage caused by improper

use (if it is plastic safe) to retard corrosion. Make sure each connector plug is properly seated.

SECTION I

LITEBOX HOUSING DISASSEMBLY/ASSEMBLY PROCEDURES

Disassembly

1. Use a Phillips screwdriver to remove the six screws from the bottom of the Litebox.
2. Separate the top and bottom halves of the housing by pulling them apart.
3. Remove the black rubber gasket.
4. Disconnect the battery leads and remove the battery.

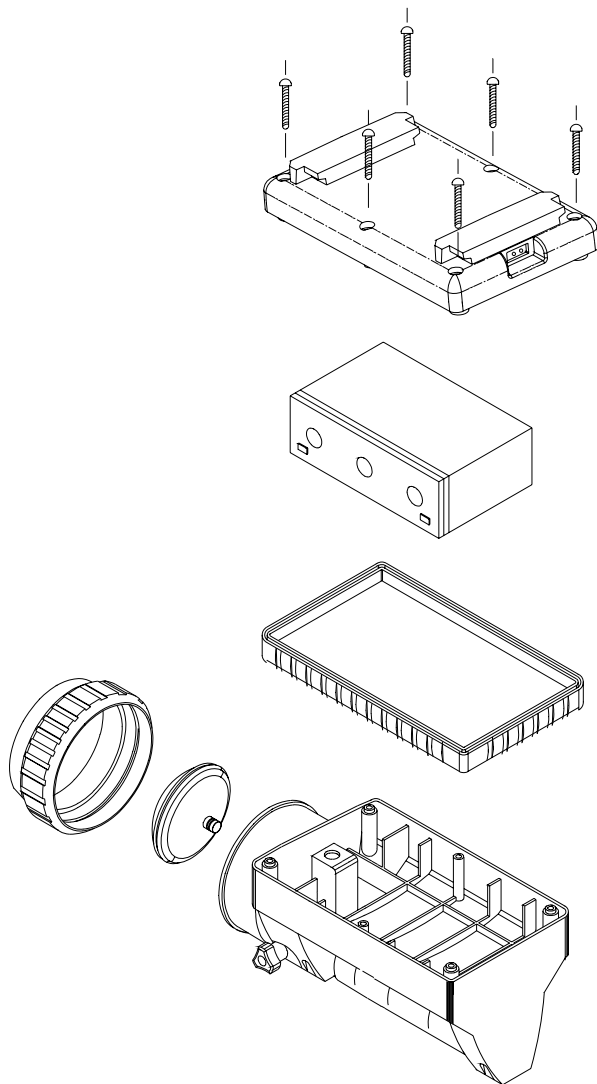

Reassembly

1. Make sure that the battery wires are properly routed (see diagram).

- a. Press each wire firmly into the proper slot.

Note : The battery wires must be properly seated and should not cross one another.

- b. Lay the foam sheet over the wires before inserting the battery.

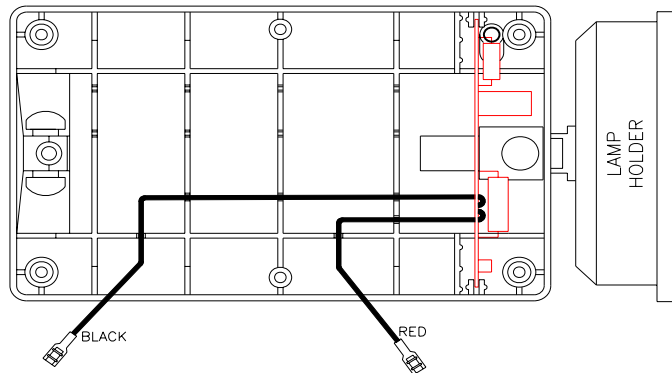

2. Place the battery onto the bottom housing.

- a. The positive battery terminal must face toward the lamp holder (see diagram).

- b. Use a pair of needle nose pliers to connect the leads to the battery terminals (red to positive; black to negative). Note : The positive terminal is marked with a red patch and a "+" sign.

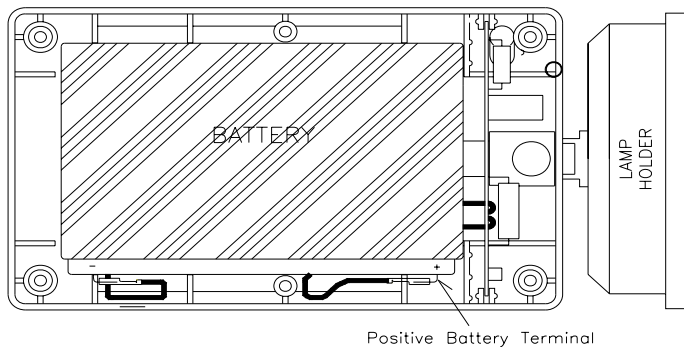

3. Fit the black rubber gasket onto the upper housing.

4. Align the bottom and top halves of the housing.
 - a. The charge connector on the bottom housing should face the rear of the Litebox.
 - b. Make sure that the charge connector wiring is routed through the center channel of the bottom housing.
 - c. Remove the slack from the charge connector wiring by drawing any excess wire to the component side of the printed circuit board (see illustration).

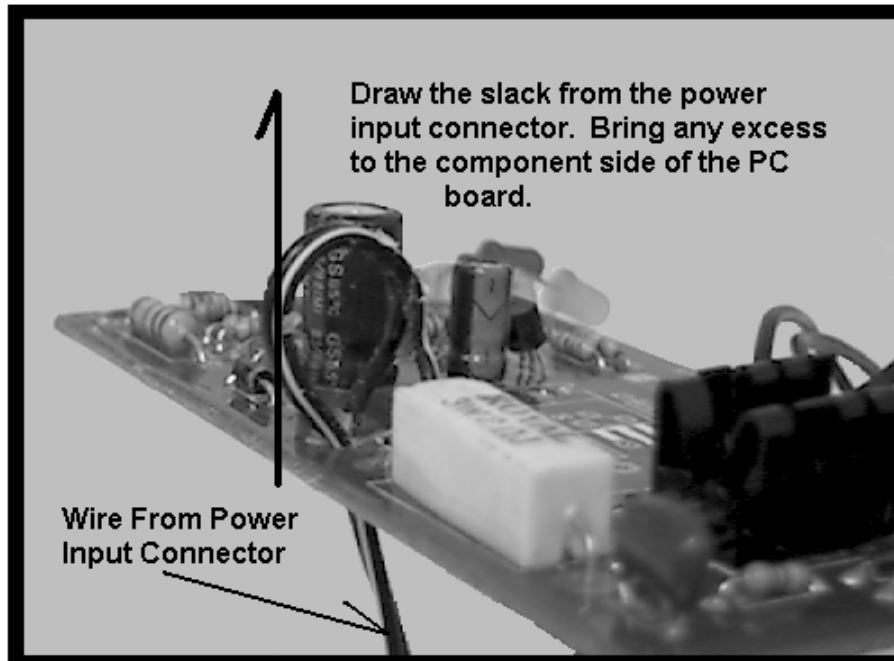

5. Place the top and bottom halves of the housing together and make sure that they mate fully with the black rubber gasket.
6. Insert the six screws into the bottom and tighten them until they are snug.

SECTION II

TESTING/REPLACING THE LAMP

1. Remove the black rubber lamp ring from the lamp housing.
note : A flat blade tool can be used to help pry the black rubber ring from the housing.
2. Pull the lamp/reflector assembly from the lamp housing.
3. If the lamp is the **sealed beam** type disconnect the slip-on connectors from the lamp blades.
 - a. Test the bulb by placing a multimeter into the continuity position and place one lead on each lamp contact (a beep indicates a good bulb).
 - b. Replace the bulb if necessary.
 - c. The wattage of the bulb is shown on the back of the lamp in the second printed data line.
 1. Example " 6V 8W 01-28-96 1720" - the 2nd group of characters (8W) indicates the wattage (8 watts).
 2. A clear lens is a spotlight pattern ("S"); a waffled lens is a flood pattern ("F").
4. If the lamp is the new style with a **plastic reflector and screw-in bulb(s)** follow the instructions below.
 - a. Test the bulb(s) by unscrewing the plastic threaded bulb socket from the plastic reflector.
 1. Pull the old bulb straight out from the socket.
 2. Use a multimeter in the continuity position and place a meter lead on each bulb lead (a beep indicates a good bulb).
 - b. Bulb replacement
 1. Replacement bulb information (voltage and wattage) is printed on a label located on the back of the reflector assembly .
 2. Replace the bulb by aligning the pins with the holes in the socket and seat the bulb firmly.
 3. Wipe off any fingerprints from the bulb with a tissue and alcohol.
 4. Screw the socket back into the reflector assembly.
 - a. The socket can be fully seated in the flood reflector assembly.
 - b. The socket can be adjusted in the spot reflector assembly.
 1. Turn the Litebox on and shine it on a wall approximately 10 feet away.
 2. Adjust to the desired focus by screwing the socket inward towards the fully seated position or outwards until the point where the socket O-ring starts to leave the surrounding screw shell of the reflector. Note : The focus should be attained somewhere between the two limits described (try 1/4 turn out from the fully seated position).
5. Place the reflector assembly into the lamp housing.
 - a. Try to dress the wires away from one another.
 - b. The reflectors need to be aligned so that the key on the reflector fits into the recesses on the lamp housing.
 - c. There are two key positions on the plastic reflector assembly which allow the flood pattern to be adjusted to either a wide or a tall pattern.
6. Replace the black rubber lamp ring.
note : A flat blade tool can be used to help pry the black rubber ring onto the lamp housing.

SECTION III

TESTING THE LITEBOX BATTERY

1. Disassemble the Litebox as shown in Section I.
2. Remove the battery from the Litebox.
 - a. Carefully disconnect the battery leads.
 - b. Slowly pull the battery from the Litebox housing and remove the foam pad.
3. Charge the battery to full capacity in a known good Litebox system.
4. Operate the battery in a known good Litebox and note the run time.
 - a. Run time is the time from when the Litebox is turned on to the point where it becomes no longer usable.
 - b. Nominal run times are 8 hours for the 8 watt bulb and 3.5 hours for the 20 watt bulb.

Lamp Option	Run Time	Charge Time (AC)	Charge Time (DC)
8 watt spot/flood	8.00 hrs.	24.0 hrs.	15-24 hrs.
20 watt spot/flood	3.50 hrs.	24.0 hrs.	15-24 hrs.

- c. Normal intensity and short run time is usually an indication that a battery is suffering from sulfation.
 - d. Low intensity and normal run time is usually an indication that a battery has one or more shorted cells.
 - e. Batteries which exhibit signs of sulfation or shorted cells should be replaced.
5. Install the battery and reassemble the Litebox as shown in Section I.

SECTION IV

TESTING/REPLACING THE SWITCH

Testing the Switch

1. Disassemble the Litebox and disconnect the battery as shown in Section I.
Note : Make sure that the battery leads are disconnected from the battery.
2. Slide the printed circuit board outward from the upper Litebox housing.
 - a. Slide the board out far enough to access the solder pads where the switch leads are connected.
 - b. Use care to avoid bending the leads of the LED's mounted on the underside of the board.
3. Place a multimeter into the continuity position.
4. Place one lead on each of the solder pads marked "S 1".
5. Depress the switch 8 times (4 on/off cycles).
6. The multimeter should indicate continuity for the 4 "on" cycles.
 - a. If continuity is indicated as above the switch is functional.
 1. Slide the printed circuit board back into the upper Litebox housing.
(note: Make sure that the LED's are aligned with their respective openings).
 2. Reinstall the battery and reassemble the Litebox as shown in Section I.
 - b. If continuity is not indicated as described the switch needs to be replaced according to the instructions below.

Replacing the Switch

1. If the Litebox is not already disassembled refer to Section I for instructions.
2. Slide the printed circuit board out of the slots in the upper Litebox housing.
(note: Use caution to avoid bending the LED's out of place).
3. Use the switch boot tool (P/N 450074) to remove the switch boot and integrated lock ring.
(note: The lock ring is an integral part of the boot).
4. Desolder the switch leads from the solder pads marked "S 1" and discard the old switch.
5. Obtain a new switch (P/N 400157).
 - a. Cut the leads to 4" in length.
 - b. Strip and tin 1/4" from the end of each lead.
6. Solder the leads of the switch to the printed circuit board at the solder pads marked "S 1". (note: Either lead to either pad.)
7. Install the new switch in the opening in the upper Litebox housing.
8. Use the switch boot tool to secure the switch boot and integrated lock ring in place.
(note: Do not overtighten the switchboot as it may prevent the switch from turning "on".)
9. Slide the printed circuit board back into its slots in the upper Litebox housing.
(note: Make sure that the LED's are aligned with their respective openings.)
10. Install the battery and reassemble the Litebox as shown in Section I.

SECTION V

TESTING/REPLACING THE WIRING HARNESS

Testing the Wiring Harness

1. Disassemble the Litebox as shown in Section I.
2. Disconnect and remove the battery.
3. Remove the lamp ring, reflector, and lamp from the lamp head as shown in Section II.
 - A . Inspect and test the wiring harness between the Litebox pc board and the lamp housing.
 1. If the wiring is frayed or damaged it should be replaced.
 2. Test the lamp wires for continuity.
 - a. Place a multimeter in the continuity position.
 - b. Place one of the meter leads on any of the lamp lead connectors located at the lamp head.
 1. If the leads are color-coded place the other meter lead onto the corresponding PC board solder pad position (see illustration).
 - a. The meter should indicate continuity.
 - b. Repeat the above procedure for each lamp lead.

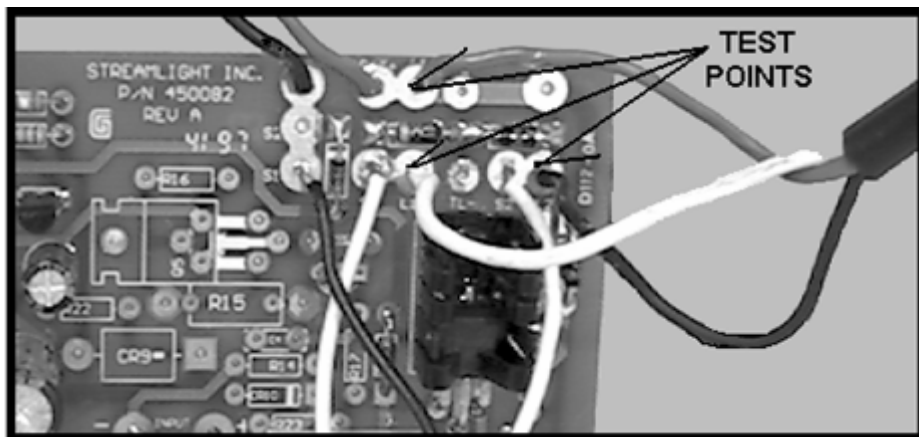

- B. If the test of the leads does not indicate continuity or if the leads are black and made from lamp cord the wiring harness will need to be replaced. A head upgrade kit is available P/N: 450104(orange), 450105(beige), or 450107 (yellow).

- C. If the wiring harness does not need to be replaced the Litebox may be reassembled as shown in Section I.

Replacing The Wiring Harness

1. Remove the existing wiring harness.
 - A . Remove the lamp ring, reflector, and lamp from the Litebox.
 - B. Loosen and remove the swivel assembly which connects the lamp head to the body.
 - C. Cut the wire tie fastener which secures the wiring harness to the lamp head.
 - D. Use wire cutters to cut the wiring harness strain relief base where it passes through the Litebox housing (see illustration).

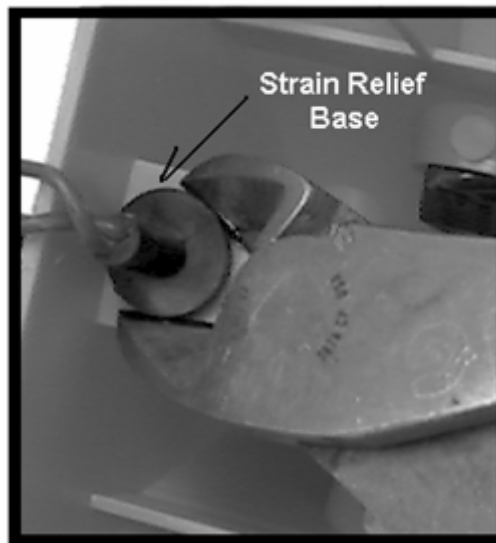

- E. Desolder and remove the lamp leads from the PC board
 - F. Discard the old wiring harness.
2. Install the replacement wiring harness (2 wire P/N : 450053 or 3 wire P/N : 450054).
 - A . Route the wiring harness (slip-on connectors first) through the opening in the Litebox body.
 - B. Place the strain relief in the opening in the Litebox body.
(note: Apply soapy water to the strain relief to provide lubrication.)
 1. Use the strain relief tool (P/N : 450075) to seat the strain relief in place.

2. Place the open end of the strain relief tool over the strain relief and direct the wire leads through the open channel in the tool (see illustration).

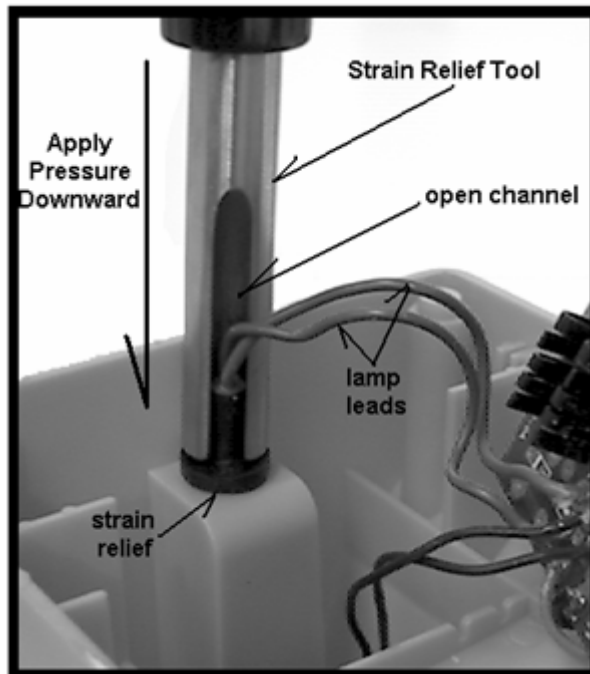

3. Apply pressure until the strain relief is fully seated.
- C. Route the wiring harness (slip-on connector end) through the opening in the back of the lamp housing.
 - D. Reattach the lamp housing to the Litebox body and secure it in the down position (the lamp housing should be flush against the Litebox body).
 - E. Place the wire tie (P/N : 450073) through the anchor located on the interior of the lamp holder and wrap it around the wiring harness (do not tighten the wire tie).

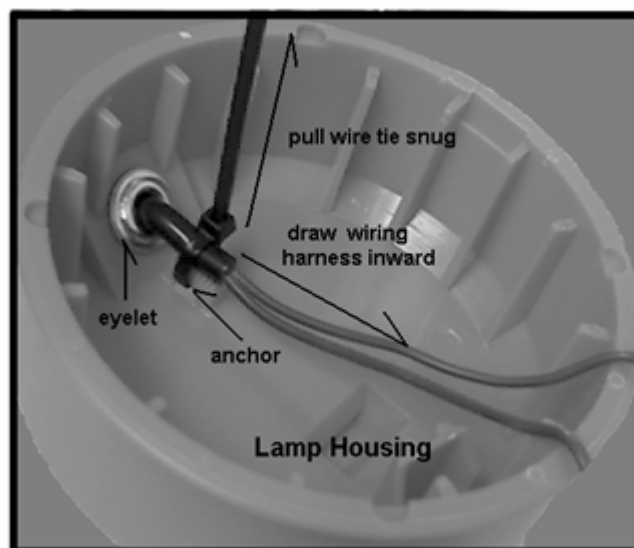

- F. Draw the wiring harness away from the eyelet to remove slack.
- G. Maintain tension on the wiring harness and draw the wire tie snug to secure the harness in place (trim the excess portion of the wire tie).
- H. Solder the lamp leads to the PC board (see Section VI).
- I. Replace the lamp, reflector and lamp ring.
- J. Reassemble the Litebox as shown in Section I.

SECTION VI

TESTING/REPLACING THE PRINTED CIRCUIT BOARD

Testing the Printed Circuit Board

1. Disassemble the Litebox as shown in Section I.
2. It is important to determine that the power input charging connector is functioning properly. Refer to Section VII, Testing the Litebox Charge Connector. Do not reassemble the Litebox; follow the testing instructions below.
3. Disconnect both battery leads and remove the battery.
Caution : The battery must not be connected to the leads.
4. Make sure that the switch has been checked according to the instructions in Section IV.
5. Make sure that the wiring harness has been checked according to the instructions in Section V.
6. Connect the Litebox to a known good wall charger.

A . If the green LED is lighted and the red LED is off follow the test procedures below.

Set the multimeter to the DC volts position.

1. Place the positive meter lead on the red battery lead.
 2. Place the negative meter lead on the black battery lead.
 3. The meter should read between 7.1 and 7.4 volts.
 - a. The green LED should be on
 - b. The red LED should be off.
 4. Keep the multimeter connected to the battery leads.
 - a. Place a 15 ohm/10 watt resistor across the battery leads.
 - b. The multimeter should read between 6.65 and 6.95 volts.
 - c. The green LED should be off.
 - d. The red LED should be on.
 - e. If the PC board performs as outlined in the steps above it is functional (reassemble the Litebox as shown in Section I).
 - f. If the PC board did not perform satisfactorily it should be replaced.
- B. If the red LED is lighted, both LED's are lighted, or neither LED is lighted, the circuit board should be replaced.

Replacing the Printed Circuit Board

1. Disassemble the Litebox as shown in Section I.
2. Remove the input power connector from the bottom Litebox housing.
 - a. Remove the screw holding the connector.
 - b. Pry the connector upward and away from the mounting hole in the housing (see illustration).

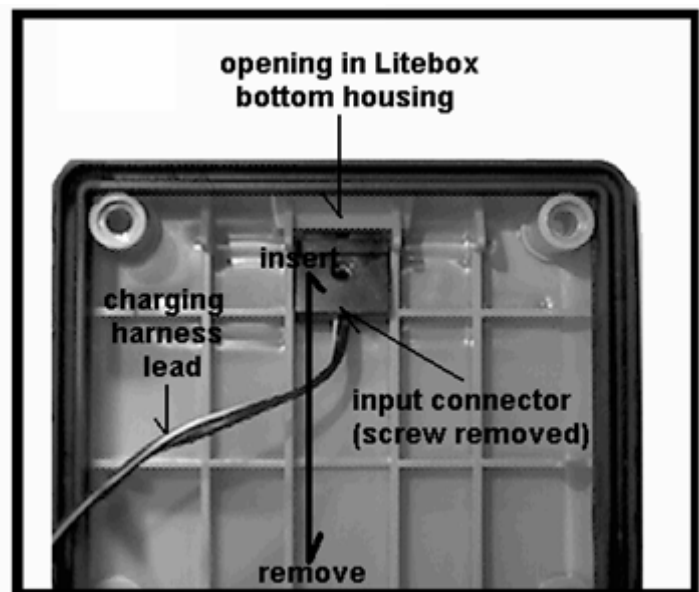

3. Remove the switch.
 - a. Remove the switch boot and integrated lock ring with the switch boot tool.
 - b. Slide the switch free from its mounting hole.
4. Pull the PC board out of its slots in the housing.
5. Desolder the lamp leads and discard the old PC board and switch.
6. Desolder the lamp leads which are included on the new PC board.

- a. For Standard and Power Failure model Liteboxes solder the existing lamp leads to the new PC board at the pads marked "L 1" (see illustration).

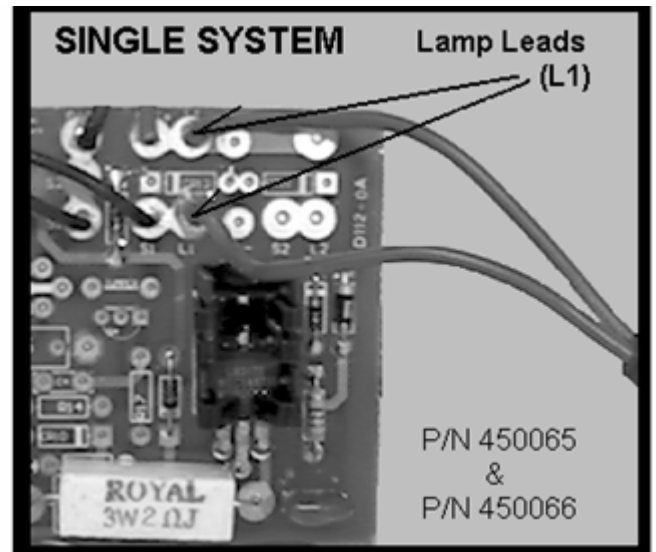

- b. For Dual Filament and Dual Bulb model Liteboxes solder the existing lamp leads to the new PC board as follows:
 1. Solder the green and white lamp leads to the solder pads marked "L 1".
 2. Solder the black lamp lead to the solder pad marked "L 2".

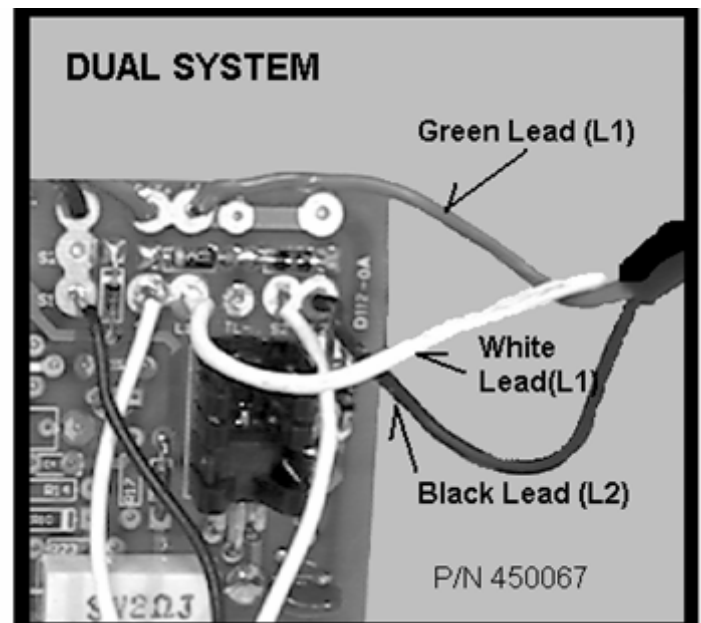

6. Install the new switch(es) in the mounting hole(s); thread a switchboot onto each switch, and use the switch boot tool to secure the switch(es) in place.
7. Align the LED's with their respective openings.
8. Slide the PC board back into the slots in the upper Litebox housing.
 - a. Route any excess switch and lamp wiring into the well where the switch is located.
 - b. Install the power input connector in the bottom housing of the Litebox .
 - 1 . Place the power input connector (slot side up) through the rear opening in the bottom housing and snap the connector into place.
 2. Secure the connector in place with the retaining screw.
 3. Remove the slack from the wire between the connector and the printed circuit board by pulling the wire from the component side of the board (see illustration).

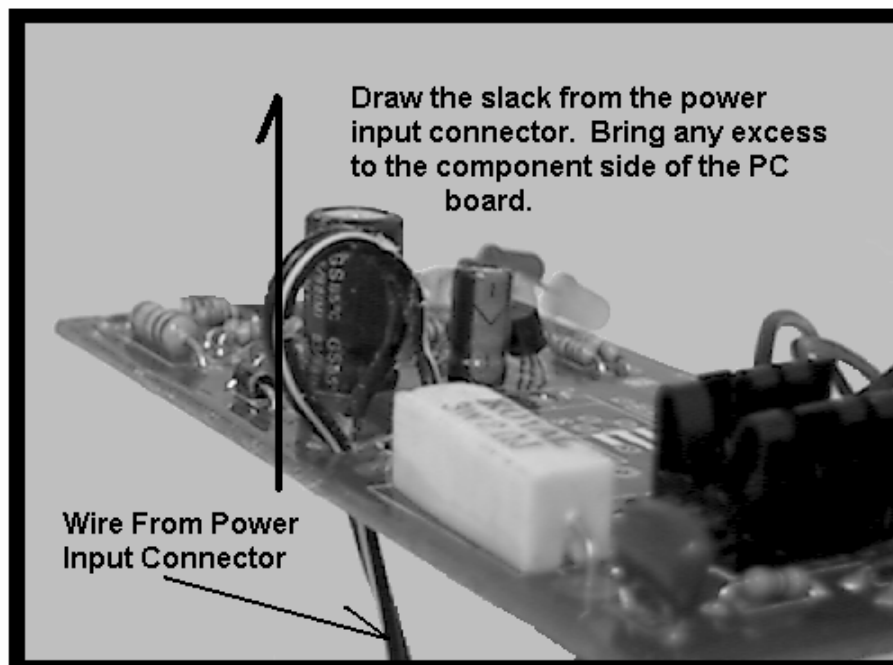

9. Install the battery and reassemble the Litebox as shown in Section I.

SECTION VII

TESTING/REPAIRING THE CHARGING SYSTEM

The Litebox charging rack is available in two configurations. Both systems have a two pin connector located at the rear of the charge rack which provides charging power to the Litebox. The difference between the two systems is the way which external power is delivered to the charge rack. The Litebox Vehicle Mount System has a 12VDC power cord which is permanently attached to the charge rack. The Litebox Standard System rack has a power input connector which is mounted on the side of the rack housing. Systems which use a charge rack must be tested with the Litebox removed from the rack.

Testing For Input Power From The AC Wall Charger

1. The AC wall charger can be tested by simply measuring its output voltage.
2. Make sure that the wall charger is plugged into a functioning 120Volt AC outlet.
3. Place a multimeter in the DC volts position.
4. With the charge connector facing towards you the black key should be located at the top of the connector (see illustration).
 - a. Place the positive lead from the meter onto the left pin of the connector.
 - b. Place the negative meter lead on the right pin.
5. The meter should give a reading between 13 and 22 volts and there should be no indication of reversed polarity.
6. If the voltage or polarity is wrong replace the charger.
7. Do not attempt to repair the AC charger.

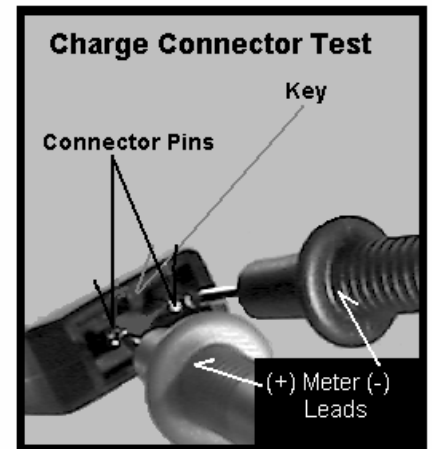

Testing For DC Input Power

DC - 1 System (cigarette plug)

1. Connect the DC-1 charger plug to its power source (power point, cigarette lighter outlet, etc.).
2. Place a multimeter into the DC Volts position.
3. The voltage should be measured as directed in step 4 above (AC testing).
4. The meter reading should reflect the vehicle's supply voltage and should be between 12 and 15 Volts DC.
 - A. If there is no reading the system needs to be checked.
 1. Place the multimeter into the continuity test position and place the positive lead onto the left charge connector pin (with the connector facing you, key on top).
 2. Place the negative meter lead onto the tip of the cigarette lighter plug.
 3. The meter should beep and/or indicate that the circuit is complete.
 - a. If the circuit is not complete then the fuse may have blown or the wire may be broken.
 - b. Replace the fuse by unscrewing the end of the cigarette lighter plug.
 - c. Replace the fuse with a 20mm X 5 mm fuse (2 amp slow-blow, 2 amp fast-blow, or 5 amp fast blow).
 - B. Test again as in steps 2,3,4 above.
 1. If the circuit is still not complete disassemble the cigarette lighter plug and inspect the connections.
 2. Repair any loose or broken connections.

- C. Test the negative (ground) side of the system.
 1. Place the positive meter lead onto the right charge connector pin (connector facing you, key on top).
 2. Place the negative meter lead onto the ground spring on the cigarette lighter plug.
 3. The meter should indicate continuity.
 4. If there is no continuity (complete circuit) the DC-1 should be replaced.

Direct Wire and DC-2 Systems

1. DC-2 system testing (system does not have a rack and utilizes the Litebox input connector).
 - a. Connect the DC-2 to a known good 12 volt source.
 - b. Place a multimeter in the DC volts position.
 - c. The voltage should be measured as in step 4 of the AC input test procedure.
 - d. The meter should give a reading of between 12 and 15 volts DC.
 - e. Replace the DC-2 if there is no voltage detected.
2. The 12VDC direct wire charge rack has a permanently wired cord to supply input power.
 - a. If possible the direct wire charger should be checked while it is connected to its power source (a known good 12VDC source is also suitable).
 - b. Measure the charger output at the charge pins located on the interior rear wall of the charger.
 1. Place the positive meter lead on the charge pin located closest to the side of the rack where the power cord enters the rack.
 2. Place the negative meter lead onto the other charge pin.
 3. The meter should show the supply voltage (12 to 15 volts).
 - a. If there is no voltage or reverse voltage check the wiring between the rack and the supply (also check any in-line fuse).
 - b. If the supplied voltage is higher than 15 volts or lower than 12 volts an alternate source should be used.

Testing the Charge Rack

1. Connect the charge rack to its power input source.
2. Place a multimeter in the DC volts position.
3. There are two charge pins located at the rear of the charge rack.
 - a. Place the positive meter lead on the charge pin which is located closest to the external power input connector.
 - b. Place the negative lead on the other charge pin.
4. With the power source connected the meter should read between 11 and 22 volts.
5. If there is no reading the charge rack needs to be checked for internal wiring integrity.
 - A. Charge racks which utilize an external power connector should be disconnected from their power source.
 1. Place the charge rack on a flat surface with the power input connector facing you.
 2. The power input connector has a key slot which should be facing toward the rear of the rack.
 3. Place a multimeter in the continuity position.
 - a. Place one meter lead into the top contact of the input connector.
 - b. Place the other lead onto the output charge pin (located on the interior wall) which is closest to you.
 - c. The meter should indicate continuity.
 - d. Follow the same procedure to test the bottom contact of the power input connector and the other charge pin.

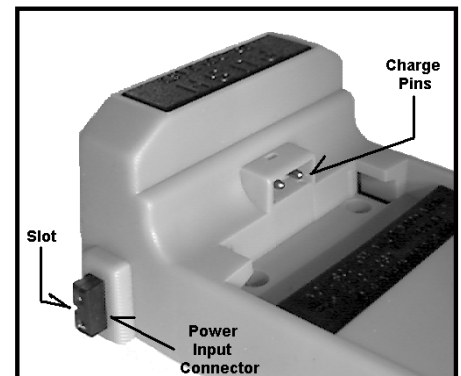

- e. If the meter does not indicate continuity the interior wiring harness should be replaced.
- B. Charge racks with permanently wired input power should be disconnected from their input source.
 1. Place a multimeter into the continuity position.
 2. Place one lead on the positive power input lead (red stripe).
 3. Place the other lead onto the output charge pin (located on the interior wall) which is closest to you.
 4. The meter should indicate continuity.
 5. Follow the same procedure to test the negative lead (black) and the other charge pin.
 6. If the meter does not indicate continuity the wiring harness will need to be replaced.

Repairing The Charge Rack

Both versions of the charge rack disassemble the same way. The charge rack is held together by two push retainers located on the bottom of the rack.

1. Use a pointed tool to remove the push retainers from their mounting posts.
2. Insert the tool (as shown in the illustration) and pry the push retainers up and off of their mounting posts.

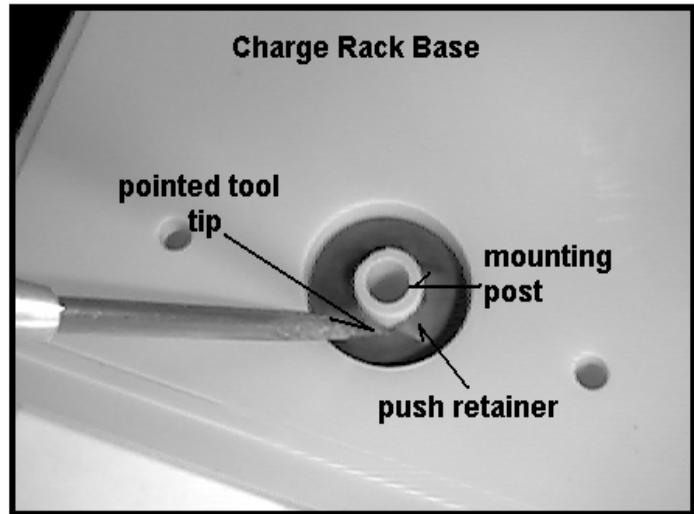

3. Remove the existing wiring harness. Note : Replace the direct wire model with P/N: 450031 and use P/N: 450029 for the standard model.
4. Place the charge connector in the opening in the upper charge rack housing and slide the assembly in place.
5. Place the charge pin assembly in the notches on the rear wall of the charge pin opening. Note: The assembly is keyed and will only install one way. When the assembly is properly installed the positive (white striped) lead is closest to the charge connector.

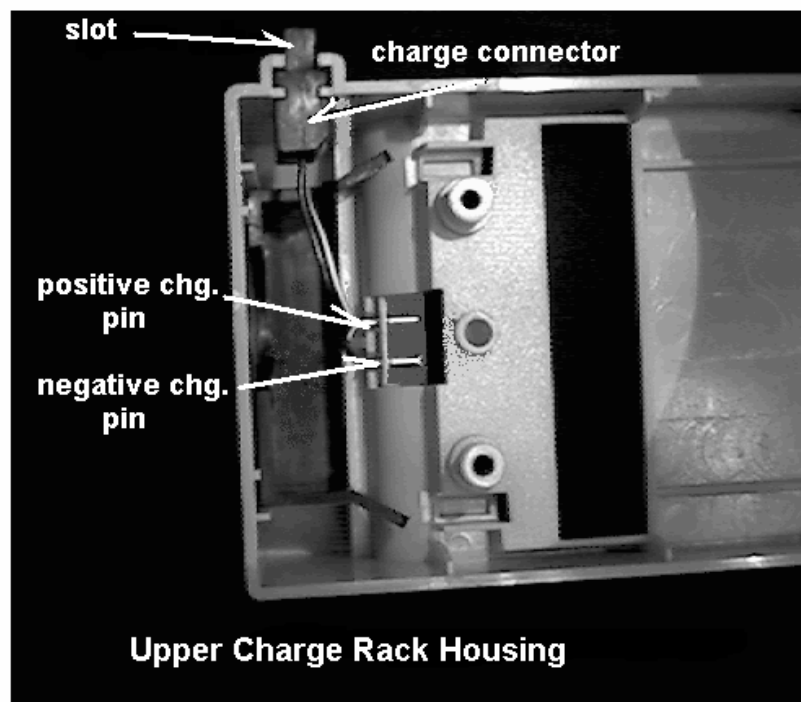

Testing the Litebox Charge Connector

1. The Litebox charge connector should be tested to make sure that it is functional.
2. Disassemble the Litebox and remove the battery as shown in Section I.
3. Test the connector and wiring by one of the following methods.
 - A. If an AC wall transformer is available the output connector from the transformer can be connected directly to the input connector of the Litebox.
 1. Use a multimeter to check the input voltage.
 2. Pull the circuit board straight up and out of the slots in the upper housing.
Note : Make sure that the PC board is on a non-conductive surface whenever power is applied to it.
 3. Place the multimeter into the DC volts position.
 - a. Place the positive lead onto the soldered connection where the wire is connected to the board (this location is marked with a “+”).
 - b. Place the negative lead onto the soldered connection marked “-”.
 - c. The meter should read between 13 and 22 volts and a “-” should not precede the reading.

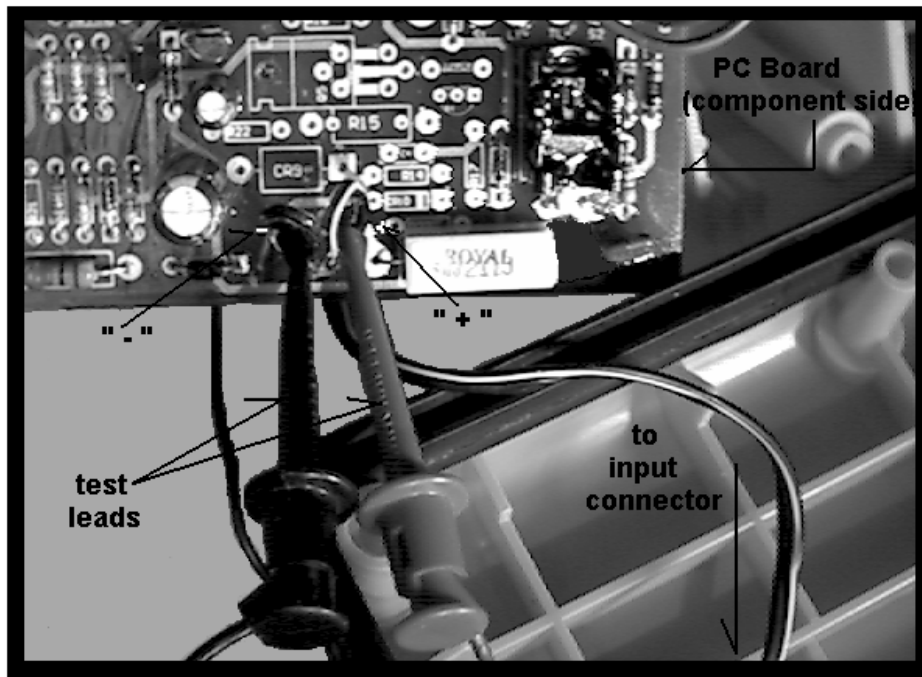

- B. If an AC wall transformer is not available the charging connector can be checked by placing the multimeter into the continuity position.
 1. Test the positive input.
 - a. Hold the input connector so that the keyed slot is facing upwards.
 - b. Place the red lead from the multimeter into the right socket (located inside the charging input connector).
 - c. Place the black lead onto the solder pad marked “+” on the printed circuit board.
 - d. The meter should beep and indicate continuity.
 2. Check the ground input.
 - a. Place the positive meter lead into the left socket and place the negative meter lead onto the solder pad marked “-” on the printed circuit board.
 - b. The meter should beep and indicate continuity.

Replacing the Litebox Charging Connector

- A . If continuity is not indicated or no voltage is detected (AC charger test) the lantern charging harness will need to be replaced.
1. Pull the printed circuit board straight up and out of the slots in the top housing.
 2. Remove the input connector retaining screw.
 3. Insert a screwdriver under the connector where the wire is attached to it.
 4. Pry the rear of the connector upwards approximately 1/4".
 5. Push on the front of the connector where it contacts the housing until the connector slides free from its mounting hole.

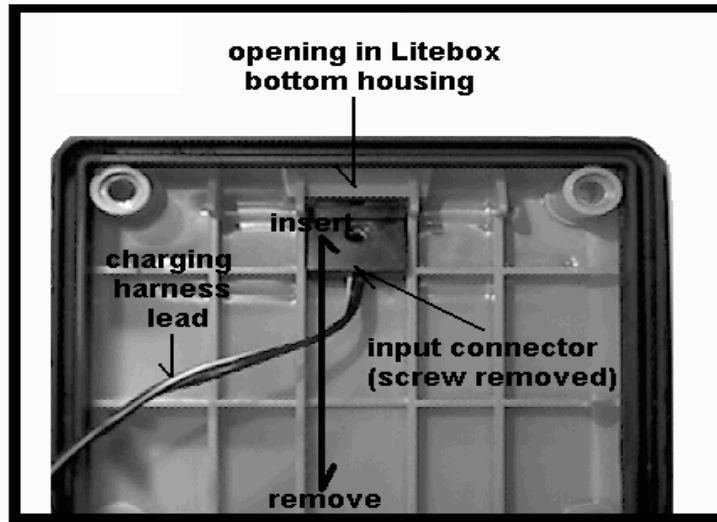

- B. Install the new lantern charging harness as shown below.
1. The wire from the input connector passes through a hole located in the printed circuit board.
 2. Unsolder the two leads of the charging harness from the rear of the PC board.
 - a. Clean the mounting holes thoroughly.
 - b. Discard the old charging harness.
 3. Route the wire of the new charging harness (P/N : 450028) through the hole on the back of the PC board (the side without the components).
 4. Solder the white striped (positive) lead to the solder pad marked “ + ” on the PC board.
 5. Solder the black (negative) lead to the solder pad marked “ - ”.
 6. Place the input connector (slot side up) through the rear opening on the bottom housing and snap the connector into place.
 7. Secure the input connector with the connector retaining screw.
 8. Slide the PC board into the slots in the upper housing until it seats.
Note : Make sure to align the LED's with the openings in the housing.
 9. Route the input connector wire through the open grid in the bottom of the housing.
 10. Install the battery and reassemble the Litebox as shown in Section I.

APPENDIX I

IDENTIFYING AND TESTING THE POWER FAILURE MODEL

Power Failure model Liteboxes are essentially the same as conventional Liteboxes with the exception of the PC board. Follow the standard instructions contained in this manual to identify and test the Power Failure model.

Identifying The Power Failure Model

The label located above the LED's on the Litebox indicates what type of unit it is. The power failure version is marked with the words "power failure" above the serial number on the label. The power failure model Litebox printed circuit board is different from that of the non-power failure Litebox. The power failure circuit board has most component positions filled (some examples are: Q5, C4, Q4, CR10 and R14-R17).

Testing a Power Failure Litebox

1. First remove the Litebox from its charging rack and verify that the lamp is working.
2. If the lamp works switch the Litebox off.
3. Connect a wall charger directly (no charge rack) to the Litebox.
 - a. If the charger is not plugged into a wall outlet the Litebox should turn on with full intensity.
 - b. Plug the wall charger into a working wall outlet; the Litebox should turn off.
4. An optional method of testing the power failure Litebox is to use a piece of wire (or needle nose pliers) to short the contacts on the power input connector. When the contacts are shorted the power failure Litebox should turn on.

If the Power Failure model fails to perform as indicated above; the printed circuit board will need to be replaced. Refer to Section IV.

APPENDIX II, LITEBOX REPLACEMENT PARTS

ITEM	QTY.	PART	DESCRIPTION
1	1	45904	TOP ASSY. LITEBOX ORANGE, STANDARD
	1	45924	TOP ASSY. LITEBOX YELLOW, STANDARD
	1	45905	TOP ASSY. LITEBOX ORANGE, PF
	1	45906	TOP ASSY. LITEBOX BEIGE, PF
	1	45925	TOP ASSY. LITEBOX YELLOW, PF
	1	45926	TOP ASSY. LITEBOX ORANGE, D.F. LAMP
	1	45927	TOP ASSY. LITEBOX YELLOW, D.F. LAMP
2	1	450006	BOTTOM, LITEBOX ORANGE
	1	450006-1	BOTTOM, LITEBOX BEIGE
	1	450006-2	BOTTOM, LITEBOX YELLOW
3	1	450102	SWIVEL HEAD ASSY. ORANGE
	1	450103	SWIVEL HEAD ASSY. BEIGE
	1	450106	SWIVEL HEAD ASSY. YELLOW
4	1	45911	LAMP ASSY. 8WS
	1	45908	LAMP ASSY. 8WF
	1	45910	LAMP ASSY. 20WF
	1	45913	LAMP ASSY. 20WS
	1	45915	LAMP ASSY. 8W DUAL FILAMENT
5	1	45918	LAMP RING
6	1	45907	GASKET
7	1	450065	PCB ASSY. STD W/WIRES
	1	450066	PCB ASSY. PF W/WIRES
	1	450067	PCB ASSY. D.F. LAMP W/WIRES
8	1	45937	BATTERY
9	1	450019	SCREW, CHARGE CONTACT
10,11	1	45916	KNOB & BOLT, SWIVEL HEAD
12	1	400130-1	SWITCH BOOT
13	1	450053	HARNES, 2 WIRE LAMP
	1	450054	HARNES, 3 WIRE LAMP
14	1	450028	HARNES, LANTERN CHARGE
15	1	450033	WIRE, BATTERY POSITIVE
16	1	450034	WIRE, BATTERY NEGATIVE
17	1	400157-1	SWITCH
18	6	450018	SCREW, LANTERN BODY
19	2	450017	FOOT, LANTERN
20	1	400172	O-RING, SWIVEL HEAD
21	1	450011	TOP, CHARGE RACK ORANGE
	1	450011-1	TOP, CHARGE RACK BEIGE
	1	450011-2	TOP, CHARGE RACK YELLOW
22	1	450020	RELEASE BUTTON
23	1	450012	BOTTOM, CHARGE RACK ORANGE
	1	450012-1	BOTTOM, CHARGE RACK BEIGE
	1	450012-2	BOTTOM, CHARGE RACK YELLOW
24	1	450021	LATCH, RACK
25	1	450031	HARNES, DIRECT WIRE
26	1	450029	HARNES, STANDARD RACK
27	1	450022	SPRING LATCH RELEASE
28	2	400103	RACK SNAP RETAINER
29 *	2 OR 3	450055	LAMP TERMINAL
30	1	45901	8W BI-PIN BULB
	1	45903	8W BI-PIN BULB (300 HR)
	1	45902	20W BI-PIN BULB
	1	45921	8W DUAL FILAMENT BULB
	1	450014	SWIVEL ONLY, BLACK (NOT SHOWN)
32	1	450073	CABLE TIE, LAMP HARNES

* 2 OR 3 TERMINALS (ITEM29) DEPENDING IF PARTS ARE
NEEDED FOR A SINGLE OR DUAL FILAMENT LAMP SYSTEM.

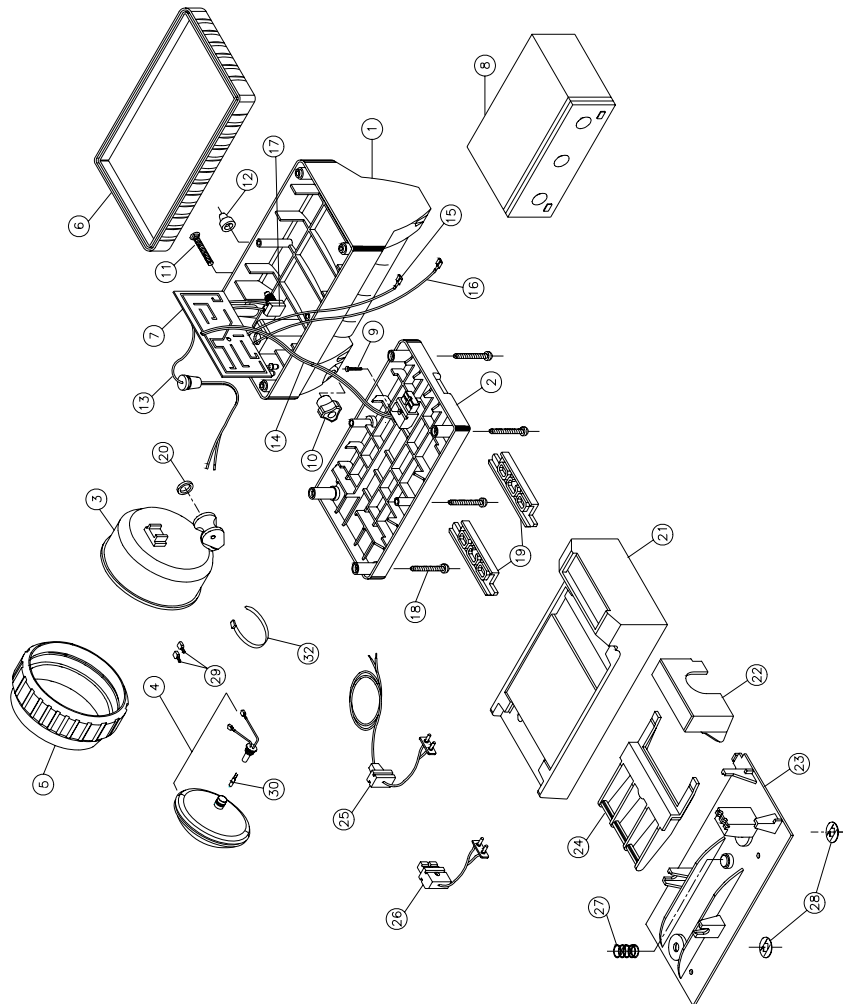

The sealed lead acid battery contained in this product is recyclable. At the end of its useful life, under various state laws, it may be illegal to dispose of this battery in the municipal solid waste stream. Check with your local solid waste officials for details in your area for recycling options or proper disposal.

APPENDIX III

TESTING AND REPAIRING THE SL - 40X

This section includes information to repair the SL - 40 series flashlights. A multimeter and Phillips screwdriver will be needed to perform most repairs and troubleshooting. Some repairs may require the use of a soldering iron.

Testing/Replacing the Lamp

1. The lamp is held in place by the lamp ring.
 - a. Hold the body of the flashlight firmly.
 - b. Press down on the lamp ring and rotate it counter clockwise.
NOTE : Use care and attempt to avoid stressing the lamp housing where it connects to the body of the flashlight. An alternate method of securing the lamp housing is to move the lamp housing to a position 90 degrees from the flashlight body. Place the back of the lamp housing on a sturdy work bench or desk top to provide leverage while the lamp ring is being turned.
 - c. Remove the lamp from the lamp housing and slip the wire leads from the bulb leads.
2. Test the lamp while it is disconnected from the flashlight
 - a. If the lamp is the **sealed beam** type test as below.
 1. Place a multimeter into the continuity position.
 2. Place the red lead on one of the lamp contacts
 3. Place the black lead on the other lamp contact.
 4. The meter should beep and indicate continuity.
 - b. If the lamp is the new style with a **plastic reflector and screw-in bulb** test as below.
 1. Test the bulb by using a multimeter in the continuity position.
 2. Place the red meter lead on one of the bulb leads.
 3. Place the black meter lead on the other bulb lead.
 4. The meter should beep and indicate continuity.
3. If the meter does not indicate continuity the bulb will need to be replaced.
 - a. If the SL-40 was equipped with a sealed beam bulb it will need to be upgraded with the PAR-36 Lamp Retrofit Kit P/N : 40107.
 1. The kit contains 3 lamp spacers which are required to support the new plastic reflector system.
 - a. Place the lamp spacers (beveled edge down) into the slots provided in the head.
 - b. The spacers' support surface should be located 1/8" below the edge of the lamp housing (see illustration).

- 25 -

2. The new black lamp ring will be used at the end of this procedure to secure reflector and bulb in place.
- b. When the SL-40 is equipped with the new system follow the instructions below.
 1. Replace the bulb(s) by unscrewing the plastic threaded bulb socket from the plastic housing.
 - a. Pull the old bulb straight out from the socket.
 - b. The bulb is labeled with voltage and wattage.
 - c. Replacement bulb information is printed on the back of the reflector assembly.
 2. Replace the bulb by aligning the pins of the new bulb with the holes in the socket and seat the bulb firmly.
 3. Wipe off any fingerprints from the bulb with a tissue and alcohol.
 4. Screw the socket back into the reflector assembly.
 - a. The socket can be fully seated in the flood reflector assembly.
 - b. The socket can be adjusted in the spot reflector assembly.
 1. Turn the SL-40 on and shine it on a wall approximately 10 feet away.

2. Adjust to the desired focus by screwing the socket in to the fully seated position or outwards until the point where the socket O-ring starts to leave the surrounding screw shell of the reflector. **Note :** The focus should be attained somewhere between the two limits described (try 1/4 turn out from the fully seated position).
5. Place the reflector in the lamp housing and secure it in place with the lamp ring.

Battery Replacement and Testing

1. Test the battery as instructed in Section III of this manual.
2. Remove the battery from the flashlight.
 - a. Use a Phillips screwdriver to remove the four screws located on the rear cover of the flashlight.
 - b. Remove the rear cover.
 - c. Slowly slide the battery out of the body of the flashlight.

Note : Use care when removing the battery so that the battery terminals and wiring harness do not become stressed.
 - d. Remove the protective tape which covers the battery terminals.
 - e. Slide the battery leads from the battery terminals.
3. Replace the battery in the flashlight.
 - a. Connect the red battery lead to the positive battery terminal.
 - b. Connect the black battery lead to the negative battery terminal.

Note : Always use a fusible link (P/N: 400307) between the negative lead and the negative battery terminal.

Note : It is very important that proper polarity is observed. Reversed wiring may cause permanent damage to the SL - 40.
 - c. Tape the connections securely in place with 3/4" strapping tape.
 - d. Place the positive end of the battery into the rear opening of the flashlight and slowly guide it into the body until its seats in place.
 1. As the battery is sliding in take the slack out of the positive lead and guide it into the channel in the side of the SL - 40. A wire hook is helpful (see illustration).

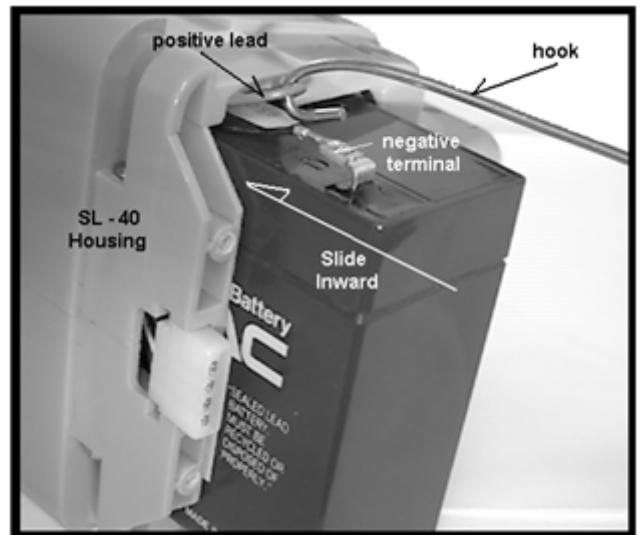

- 26 -

2. A small loop of the black (negative) lead should remain outside of the rear of the housing.
3. When the battery is seated tuck the extra loop of wire into the slot between the battery and the flashlight housing.
- e. Place the rear cover on the flashlight and secure it in place with the four Phillips screws.

Note : Be careful not to overtighten the screws as they could strip their plastic anchors.

Testing/Replacing the Switch

If the battery and lamp are in proper working order but the flashlight still fails to operate the switch may be malfunctioning.

1. Disconnect the SL-40 from any charging source.
2. Remove the battery and rear cover as described in the battery section above.

3. Remove the lamp from the flashlight as described in Testing/Replacing the Lamp
4. Test the switch.
 - a. Place a multimeter in the continuity position.
 1. Place one meter lead on the negative battery lead.
 2. Touch the other meter lead to either of the lamp leads.
 3. The meter must indicate continuity with one of the lamp leads.
 4. If continuity is established with one of the lamp leads put that lead aside.
 5. If neither lamp lead indicates continuity the wiring will need to be checked (see 6 below).
 - b. Place one meter lead on the positive battery lead.
 1. Place the other meter lead on the lamp lead which was not connected to the negative battery lead.
 2. Cycle the switch at least 8 times (four on/off cycles).
 3. If continuity is not indicated in all four "on" cycles the switch will need to be replaced.
5. Disassemble the SL-40.
 - a. Remove the shoulder strap D - Rings (if present) on the carry handle by opening them outwards from the handle.
 - b. Loosen and remove the adjustable wing nut assembly which fastens the lamp housing to the flashlight body.
 - c. Use a Phillips screwdriver to remove the body screws located on the side and foot of the flashlight.

Note : Use caution when removing the screws as their anchor nuts (located on the opposite side) will be freed from their mountings and could be misplaced.
 - d. Carefully separate the two halves of the body.
 - e. Remove the rubber footpads at the bottom of the flashlight and place them aside.
6. Inspect the wires to make sure that none of them are disconnected or broken and replace them as necessary.
7. Use the switch boot tool (P/N 450074) to remove the switchboot and integrated lock ring.
8. Desolder the switch leads from the circuit board. (The replacement switch is P/N 400157)
9. Solder the leads of the replacement switch to the circuit board at the solder pads marked "sw" (either lead to either pad).
10. Place the new switch into the opening in the handle.
11. Use the switch boot tool to secure the switch boot and integrated lock ring in place.
12. Reassemble the SL-40.
 - a. Align the two halves of the flashlight body.

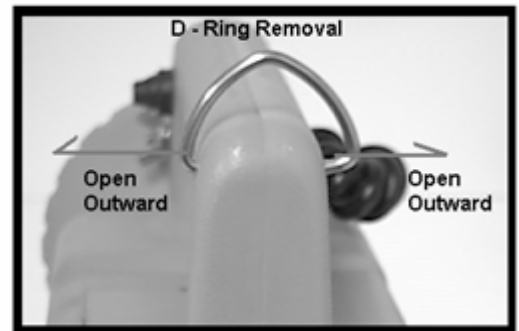

- 27 -

1. Make sure the circuit board is inserted in the slots provided.
2. Join the two halves of the flashlight body together.
3. Check to make sure that there are no pinched wires.
- b. Place the body screws in their mounting holes and secure them with their anchor nuts.
- c. Replace the rubber footpads in their openings at the bottom of the flashlight.
- d. Place the lamp housing mounting screw and wing nut into the mounting hole located on the flashlight body forward of the carrying handle and secure the lamp housing in position.
- e. Reattach the D-Rings (if desired) by aligning them with their mounting holes and squeezing them into place with pliers.
- f. Reinstall the battery and rear cover as described in the battery section.

Testing/Repairing the Circuit Board

If the lamp is functional, the battery tests properly, the switch is operational and the charging system is working, but the flashlight fails to operate or the LED fails to light there may be a problem with the circuit board inside the flashlight.

1. Disconnect the S-40 from any charging source.
2. Remove the battery and rear cover as described in the battery section.
3. Disassemble the flashlight as described in the testing/replacing the switch (step 5).
4. Perform a visual inspection of the circuit board.
 - a. Look for broken or pinched wires.
 - b. Look for broken connections where the wires are soldered to the board.
5. Test the components of the circuit board.
 - A. The 5 ohm, 5 watt resistor is located near the center of the board (see illustration).

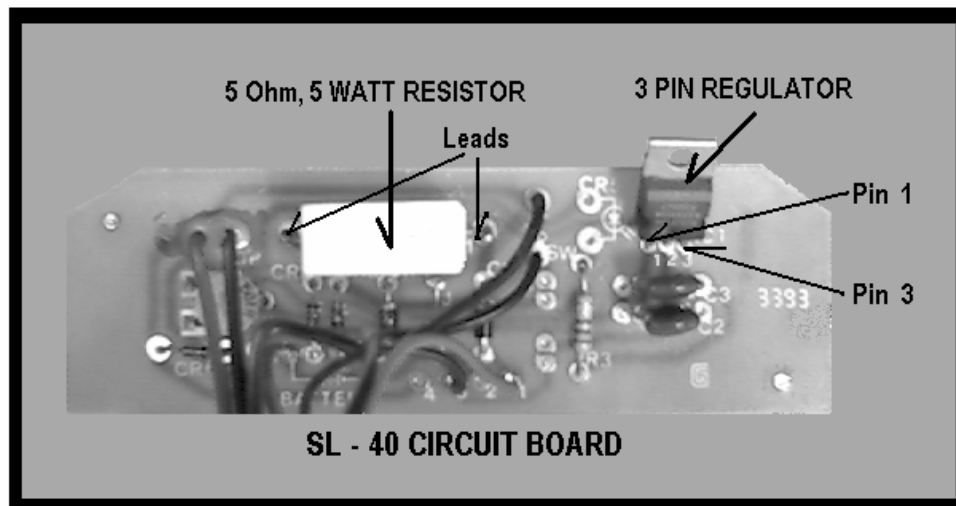

1. Check the resistor to see if it is open.
 - a. Use a multimeter set to the lowest ohms position.
 1. Place the black lead on either one of the resistor leads.
 2. Place the red lead on the other resistor lead.
 3. The meter should read close to zero (approx. 5 ohms).
 4. If the meter indicates an "open" condition the resistor will need to be replaced.
 - b. If a multimeter is not available a jumper wire can be placed across the resistor leads.

- 28 -

1. Apply charge power to the flashlight .
 2. If the charge indicating LED on the flashlight lights the resistor is bad and needs to be replaced.
2. To replace the resistor desolder it from the mounting pads on the rear of the circuit board.
 - a. Make sure that the mounting holes are free of debris.
 - b. Bend the leads of the replacement resistor so that they are aligned with the mounting holes on the circuit board.
 - c. Solder the new resistor in place.
 - d. Test the resistor as described in step A 1 above.
- B. The 3 pin voltage regulator is marked "7905".
 1. Apply charge power to the flashlight.

2. Place a multimeter in the DC volts position.
 - a. Place the red (positive) lead onto pin 1 of the regulator.
 - b. Place the black (negative) lead onto pin 3 of the regulator.
 - c. The multimeter should give a reading of 5 volts (10% tolerance allowed).
3. To replace the voltage regulator desolder it from the solder pads on the rear of the circuit board.
 - a. Make sure that the mounting holes are free of debris.
 - b. When the voltage regulator is properly oriented (label side toward you) pin # 1 is the pin on the left.
 - c. Align the leads of the new voltage regulator with the holes in the circuit board.
 - d. Solder the three pins of the voltage regulator in place.
 - e. Test the voltage regulator as described in B 1,2 above.

Note: If the voltage regulator still fails to perform reassemble the light as below and send it to:

Streamlight, Inc.
Repair Department
1030 W. Germantown Pike
Norristown, Pa. 19403

Testing/Repairing the Charger System

See Section VI of the SL-45 Litebox manual (p. 12) for charger testing and repair information.

STREAMLIGHT®

SL - 40 REPLACEMENT PARTS

ITEM	QTY	PART NO.		ITEM	QTY	PART NO.	DESCRIPTION
1	1	40107	KIT, PAR 36 LAMP RETROFIT (LAMP RING & SPACERS)	16	1	400176 400175	PLUG ASSY.- 4 PIN P.F. PLUG ASSY - 2 PIN STANDARD
2	1	40117	KIT, PAR 36 LAMP RETROFIT, BEIGE	17	1	900079	L.E.D.
		45908	LAMP, 8W FLOOD	18	1	400241	P.C.B. ASSY.- STANDARD
		45911	LAMP, 8W SPOT			400242	P.C.B. ASSY. - POWER FAILURE
		45910	LAMP, 20W FLOOD	19	1	45070	RACK ASSY - STANDARD, ORG
		45913	LAMP, 20W SPOT			45071	RACK ASSY-DIRECT WIRE, ORG
3	3	40114	NEOPRENE SPACER (LAMP)			40072	RACK ASSY-P.F., ORANGE
4	1	400105	LAMP HOUSING, ORANGE			40073	RACK ASSY - P.F. BEIGE
		400105-1	LAMP HOUSING, BEIGE				
5	2	202027	STRAIN RELIEF	NOT SHOWN		40232	SHOULDER STRAP (W/D-RINGS)
6	1	4051	SWIVEL HEAD ATT- ORANGE			400262	D-RINGS, SHOULDER STRAP
		4052	SWIVEL HEAD ATT.- BEIGE			400267	SCREW PACKET,(REAR COVER)
7	1	400130-1	SWITCH BOOT			400266	SCREW PACKET, BODY
8	1	400157	SWITCH W/BOOT			400307	FUSIBLE LINK ASSY
9	1	400258	REAR COVER,ORANGE (W/FOOT)			400179	KIT, 2-PIN PLUG (INCLUDES PARTS FOR RACK AND LIGHT)
		400258-1	REAR COVER,BIEGE (W/FOOT)				
10	1	400254	BODY R.H. - ORANGE	CHARGERS		22311	120V AC, STANDARD
		400256	BODY R.H. - BEIGE			21725	230V AC, STANDARD
11	1	400255	BODY L.H. - ORANGE			22051	12V DC-1, W/LIGHTER ADAPTER
		400257	BODY L.H. - BEIGE				
12	1	400174	DOOR, SOLID - ORANGE	MISC. RACK		400170	STRAIN RELIEF (DIRECT WIRE)
		400126	DOOR, SLIDING - ORANGE	PARTS		40163	LOCK, KEYED DIFFERENTLY (INSTALLED)
		400126-1	DOOR, SLIDING - BEIGE				
13	1	400123	NEOPRENE FOOT			40164	LOCK, KEYED ALIKE (INSTALLED)
14	1	45937	BATTERY				
15	1	400167	COILED CORD ASSY.				



Pb

The lead acid battery in this product is recyclable. At the end of its useful life, under various state laws, it may be illegal to dispose of this battery in the municipal solid waste stream. Check with your local solid waste officials for details in your area for recycling options or proper disposal.

