



US005868133A

**United States Patent** [19]

[11] **Patent Number:** **5,868,133**

**DeVries et al.**

[45] **Date of Patent:** **Feb. 9, 1999**

[54] **PORTABLE DRAG COMPRESSOR  
POWERED MECHANICAL VENTILATOR**

[75] Inventors: **Douglas F. DeVries**, Yucaipa; **Michael J. Cegielski**, Norco; **Warner V. Graves, Jr.**, Hemet; **Malcolm R. Williams**, San Clemente; **Michael B. Holmes**, Riverside, all of Calif.

[73] Assignee: **Bird Products Corporation**, Palm Springs, Calif.

[21] Appl. No.: **794,296**

[22] Filed: **Feb. 3, 1997**

**Related U.S. Application Data**

[63] Continuation of Ser. No. 324,172, Oct. 14, 1994, abandoned.

[51] **Int. Cl.**<sup>6</sup> ..... **A61M 16/00**; **A62B 7/00**;  
F16K 31/02

[52] **U.S. Cl.** ..... **128/204.21**; **128/204.18**

[58] **Field of Search** ..... **128/204.18, 204.21,**  
**128/204.22, 204.23, 204.26, 205.11**

[56] **References Cited**

**U.S. PATENT DOCUMENTS**

Re. 29,778 9/1978 Stewart ..... 128/145.8  
1,793,226 2/1931 Eggleston et al. .

(List continued on next page.)

**FOREIGN PATENT DOCUMENTS**

2558935 7/1977 Germany .  
2126666 3/1984 United Kingdom .  
2166360A 5/1986 United Kingdom .  
00795 6/1985 WIPO .  
00547 12/1993 WIPO .

**OTHER PUBLICATIONS**

“Marks’ Standard Handbook for Mechanical Engineers”, 8th Edition, *Measurement of Fluid Flow Rate*, pp. 16–14 through 16–18 Westlake Plastics Co., Thermalux Polysulfone, 1 page.

“Sandvik 11R51 Stainless Thin Strip”, *Thin Strip with a Smooth Finish, Good Shape and High Fatigue Strength*, 4 pages.

“Microprocessor Control of Step Motors”, Chapter 15, by S.H. Pollack, *Step Motors and Control Systems*, pp. 391–402, 1979.

“Electric Motors & Control Techniques”, by Irving M. Gottlieb, *Stepper Motor Controller*, pp. 183–198 and index, 1982.

“Step Motors and Control Systems”, Edited by Benjamin C. Kuo, *Drive Circuitry for Step Motors*, pp. 114–143 and index, Chapter 4, 1979.

“Stepping Motors and Their Microprocessor Controls” y Takashi Kenjo, *Drive System and Circuitry for Open-Loop Control of Stepping Motors*, Pages 121–165 (Chapter 5) 1984.

“Servo Ventilator 900B—Service Manual”, by Siemens-Elcoma, 55 pages plus front and back matter, 1979. Computer printouts containing abstracts of 62 pages.

*Primary Examiner*—Kimberly L. Asher  
*Attorney, Agent, or Firm*—Stetina Brunda Garred & Brucker

[57] **ABSTRACT**

A ventilator device and system comprising a rotating compressor, preferably a drag compressor, which, at the beginning of each inspiratory ventilation phase, is accelerated to a sufficient speed to deliver the desired inspiratory gas flow, and is subsequently stopped or decelerated to a basal flow level to permit the expiratory ventilation phase to occur. The ventilator device is small and light weight enough to be utilized in portable applications. The ventilator device is power efficient enough to operate for extended periods of time on internal or external batteries. Also provided is an oxygen blending apparatus which utilizes solenoid valves having specific orifice sizes for blending desired amounts of oxygen into the inspiratory gas flow. Also provided is an exhalation valve having an exhalation flow transducer which incorporates a radio frequency data base to provide an attendant controller with specific calibration information for the exhalation flow transducer. Stored, individualized compressor characterization information is used to control the acceleration and deceleration of the rotating compressor.

**54 Claims, 8 Drawing Sheets**

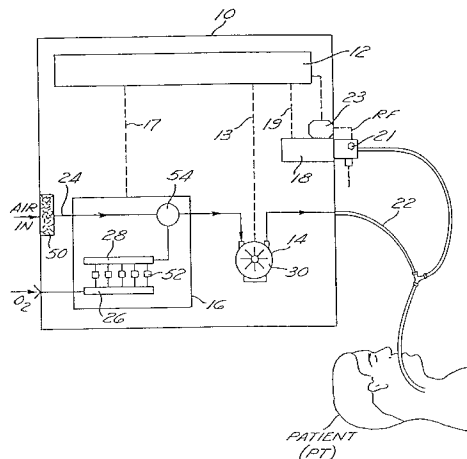

## U.S. PATENT DOCUMENTS

2,503,563	4/1950	Ray	137/139	4,204,536	5/1980	Albarda	128/204.22
2,536,691	1/1951	Miller et al.	137/144	4,235,105	11/1980	Walters	73/861.53
2,586,677	2/1952	Marrett	128/188	4,256,100	3/1981	Levy et al.	128/204.21
2,770,231	11/1956	Falk	128/29	4,256,101	3/1981	Ellestad	128/204.23
2,770,232	11/1956	Falk	128/29	4,266,573	5/1981	Braatz	137/630.18
2,880,719	4/1959	Andreasen	128/29	4,281,651	8/1981	Cox	128/204.23
2,892,348	6/1959	Ekstrom, Jr.	73/228	4,304,136	12/1981	McCabe et al.	73/861.54
2,904,035	9/1959	Andreasen	128/29	4,323,064	4/1982	Hoenig et al.	128/204.21
3,007,490	11/1961	Passmore	137/599	4,326,513	4/1982	Schulz et al.	128/283.14
3,015,963	1/1962	Terry	74/44	4,333,453	6/1982	Rodder	128/205.24
3,043,302	7/1962	Spears et al.	128/203	4,336,590	6/1982	Jacq et al.	364/418
3,306,570	2/1967	Cooksley	251/30	4,350,050	9/1982	Nelson	73/861.54
3,351,057	11/1967	Goodyear et al.	128/188	4,368,646	1/1983	Rogg	73/861.55
3,374,410	3/1968	Cronquist et al.	318/138	4,393,869	7/1983	Boyarsky et al.	128/204.18
3,403,556	10/1968	Koester	73/207	4,401,116	8/1983	Fry et al.	128/205.24
3,416,054	12/1968	Galles	318/138	4,421,113	12/1983	Gedeon et al.	128/204.23
3,450,382	6/1969	Calim	251/58	4,448,192	5/1984	Stawitcke et al.	128/204.26
3,488,030	1/1970	Hulme et al.	251/134	4,457,304	7/1984	Molnar et al.	128/204.25
3,569,813	3/1971	Clark et al.	318/56	4,459,982	7/1984	Fry	128/204.23
3,579,279	5/1971	Inaba et al.	318/696	4,474,068	10/1984	Knetsch et al.	73/861.53
3,586,953	6/1971	Markkamen et al.	318/685	4,493,614	1/1985	Chu et al.	417/22
3,675,633	7/1972	Nakajima et al.	123/119 A	4,524,804	6/1985	Goedecke et al.	137/625.64
3,759,099	9/1973	McGregor	73/207	4,527,557	7/1985	DeVries et al.	128/204.23
3,795,145	3/1974	Miller	73/213	4,535,816	8/1985	Feder et al.	137/625.65
3,813,592	5/1974	Ryberg	318/696	4,540,018	9/1985	Dantlgraber	137/540
3,820,539	6/1974	Ollivier	128/145.8	4,548,382	10/1985	Otting	251/5
3,839,662	10/1974	N'Gayen Van	318/160	4,552,027	11/1985	Larner	73/861.53
3,842,828	10/1974	Bird	128/145.8	4,561,408	12/1985	Jenkins	123/571
3,896,837	7/1975	Rohling	137/110	4,570,631	2/1986	Durkan	128/204.23
3,904,174	9/1975	Glese	251/331	4,576,159	3/1986	Hahn et al.	128/203.14
3,906,792	9/1975	Miller	73/213	4,579,145	4/1986	Leiber et al.	137/625.65
3,910,112	10/1975	Gerlach	73/210	4,587,967	5/1986	Chu et al.	128/204.21
3,961,627	6/1976	Ernst et al.	128/145.8	4,602,653	7/1986	Ruiz-Vela et al.	137/88
3,964,310	6/1976	Stenberg	73/207	4,604,902	8/1986	Sabin et al.	73/861.04
3,968,416	7/1976	Leenhouts	318/696	4,606,340	8/1986	Ansite	128/205.24
3,985,131	10/1976	Buck et al.	128/145.8	4,611,591	9/1986	Inui et al.	128/205.24
4,006,634	2/1977	Billette et al.	73/207	4,614,122	9/1986	Graves	73/861.74
4,024,447	5/1977	Epstein	318/696	4,617,637	10/1986	Chu et al.	364/505
4,027,636	6/1977	Yamamoto et al.	123/119 A	4,619,139	10/1986	Rosaen	73/198
4,031,448	6/1977	Adachi	318/696	4,635,631	1/1987	Izumi	128/204.23
4,036,221	7/1977	Hillsman et al.	128/145.6	4,677,603	6/1987	Kenjyo	369/32
4,081,736	3/1978	Leenhouts et al.	318/696	4,688,433	8/1987	Silverwater	73/861.53
4,083,245	4/1978	Osborn	73/207	4,699,137	10/1987	Schroeder	128/205.24
4,087,732	5/1978	Pritchard	318/696	4,702,240	10/1987	Chaoui	128/204.18
4,094,285	6/1978	Oyama et al.	123/119 A	4,790,194	12/1988	Bellows et al.	73/861.53
4,107,594	8/1978	Jacobs	318/685	4,821,767	4/1989	Jackson	137/491
4,112,757	9/1978	Hayward	73/207	4,838,257	6/1989	Hatch	128/204.18
4,114,601	9/1978	Abels	128/1 R	4,840,457	6/1989	Remer	350/255
4,119,902	10/1978	Newell	318/696	4,957,107	9/1990	Sipin	128/204.21
4,121,578	10/1978	Torzala	128/142 R	4,993,269	2/1991	Guillaume	73/861.53
4,126,818	11/1978	Taylor	318/46	5,044,362	9/1991	Younes	128/204.21
4,126,821	11/1978	Cannon	318/696	5,072,729	12/1991	DeVries	128/204.23
4,153,021	5/1979	Hattori et al.	123/119 EC	5,099,635	3/1992	Butkovich	56/13.5
4,158,351	6/1979	Ando et al.	129/119 A	5,107,830	4/1992	Younes	128/204.18
4,171,697	10/1979	Arion	128/145.8	5,127,400	7/1992	DeVries et al.	128/205.24
4,176,687	12/1979	Ensign	137/625.65	5,148,802	9/1992	Sanders et al.	128/204.18
4,181,108	1/1980	Bellicardi	123/119 EC	5,159,924	11/1992	Cegielski	128/203.12
4,193,301	3/1980	Ferrentino	73/207	5,197,895	3/1993	Stupecky	439/194
4,199,132	4/1980	deMey, II	251/134	5,239,995	8/1993	Estes et al.	128/204.23
				5,315,990	5/1994	Mondry	128/205.11

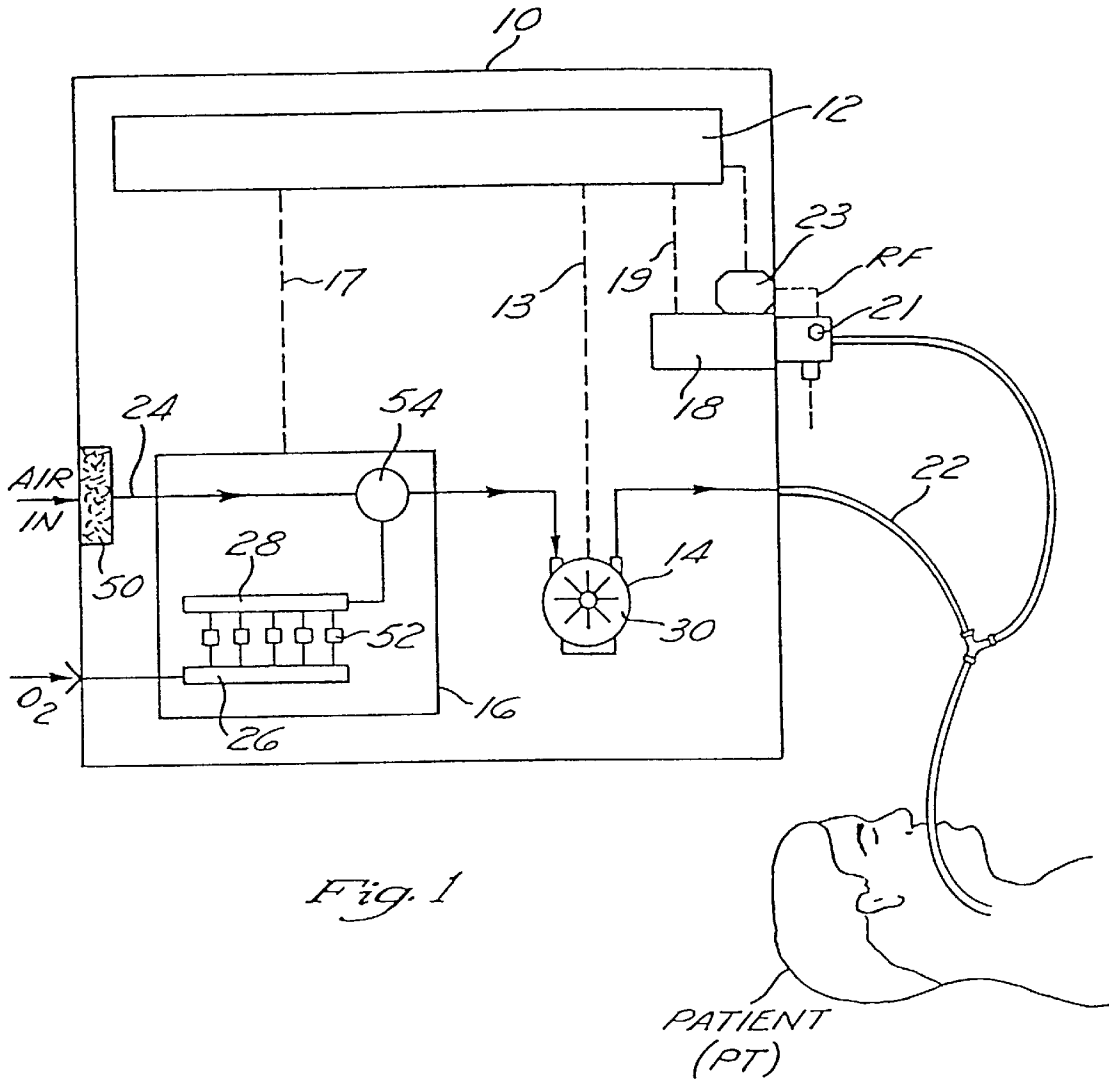
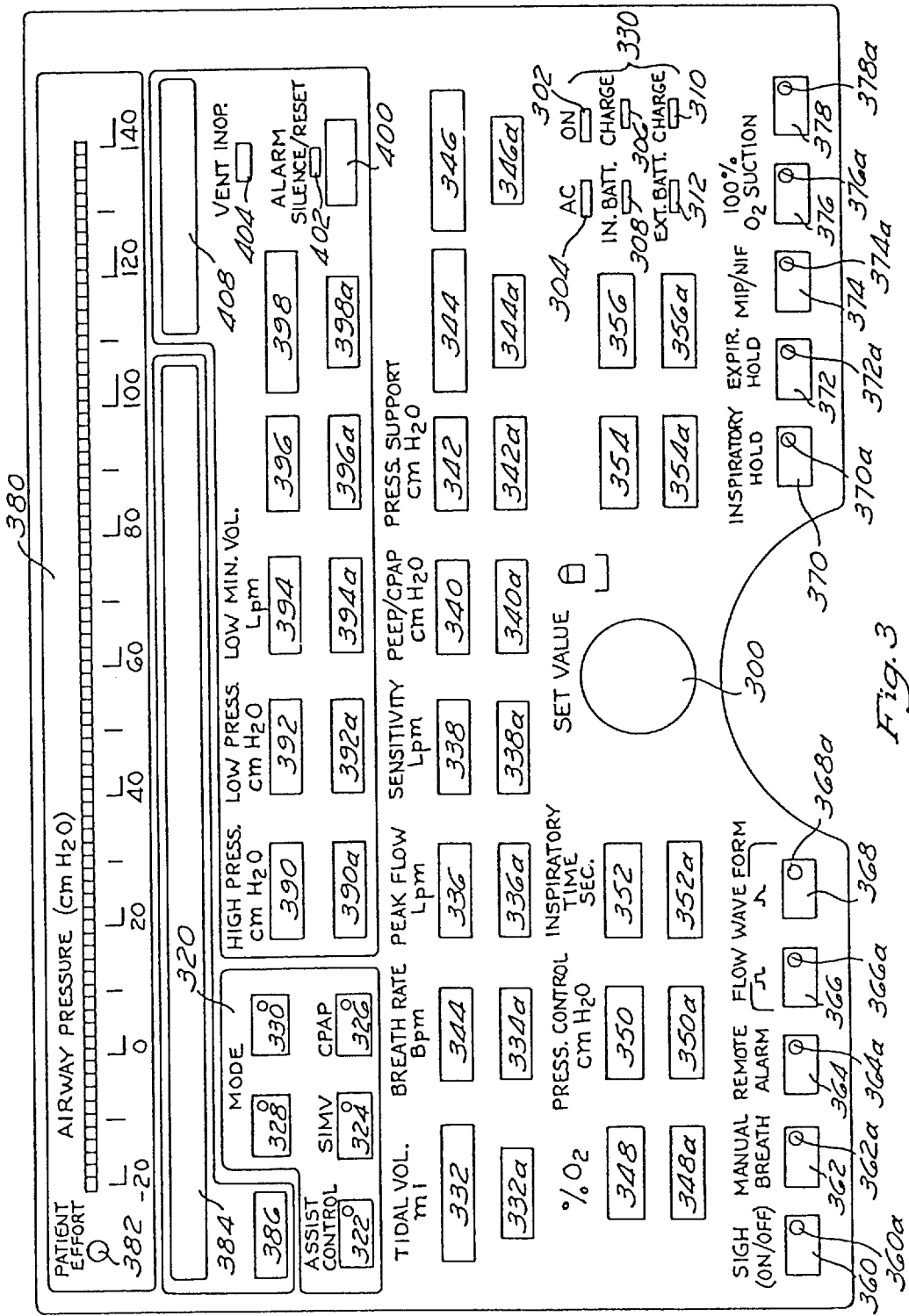
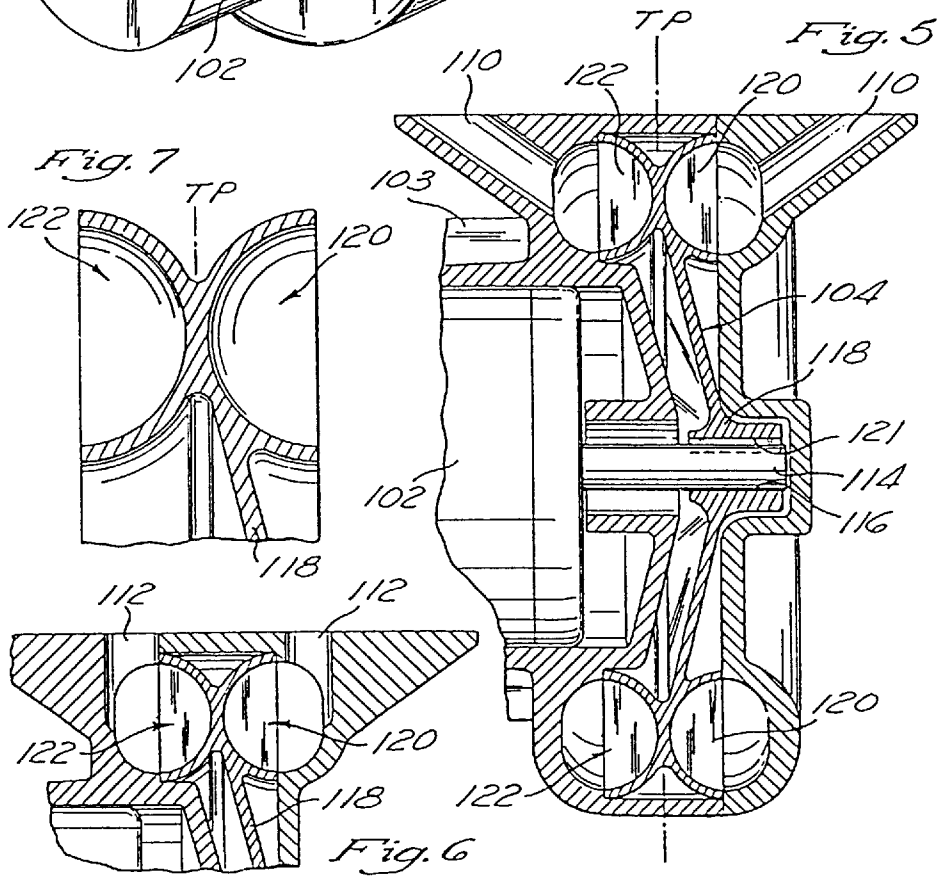
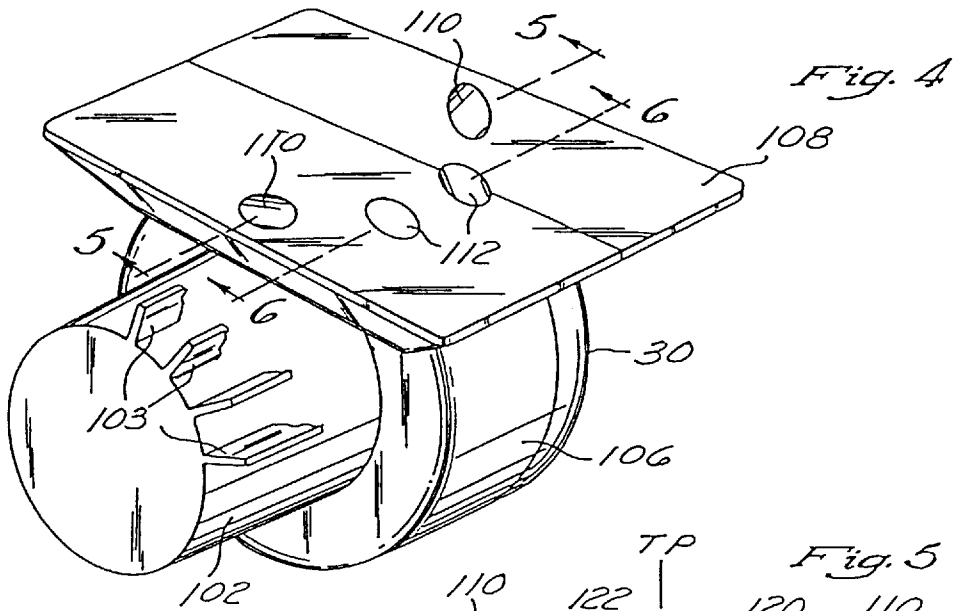
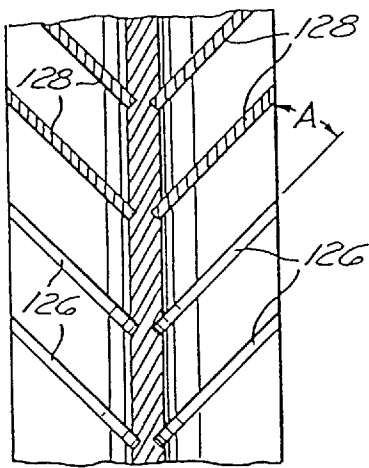
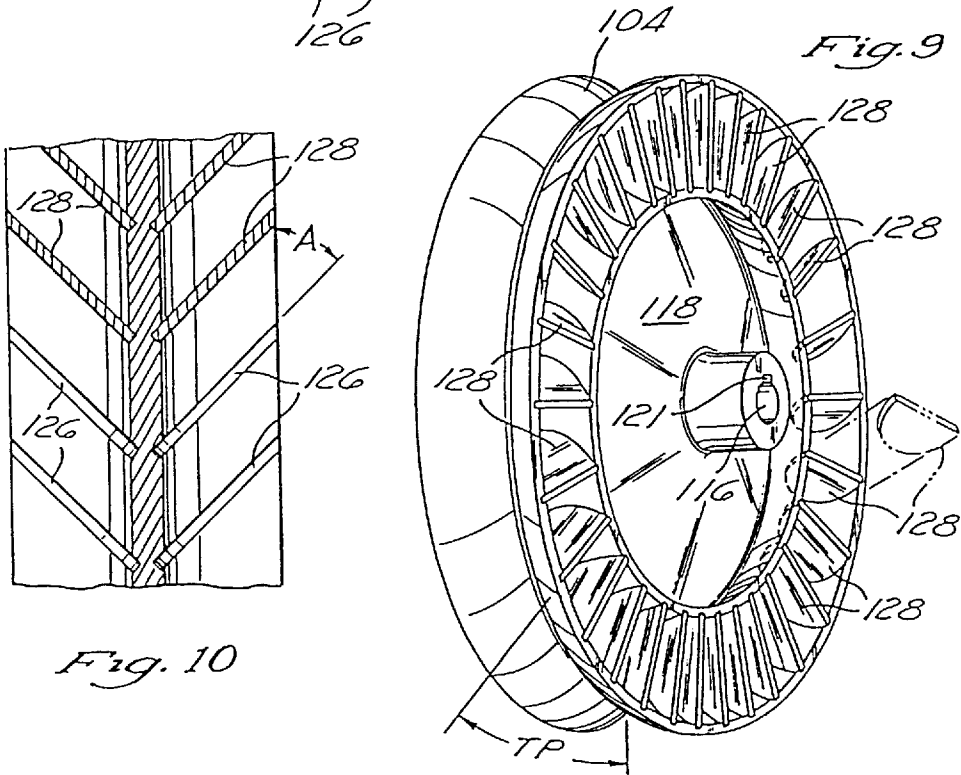
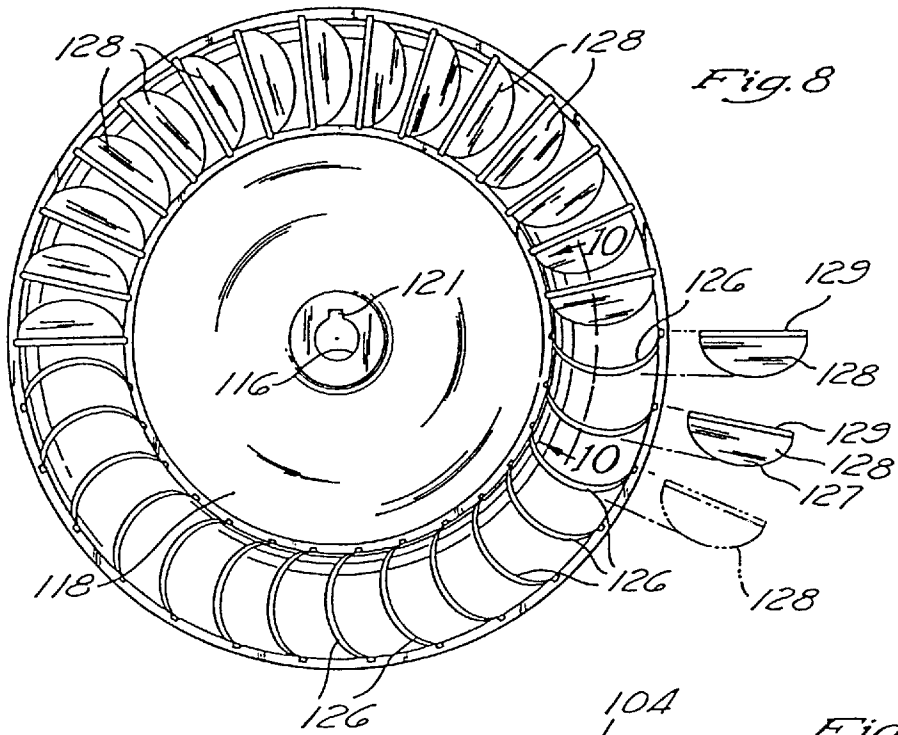

Fig. 1









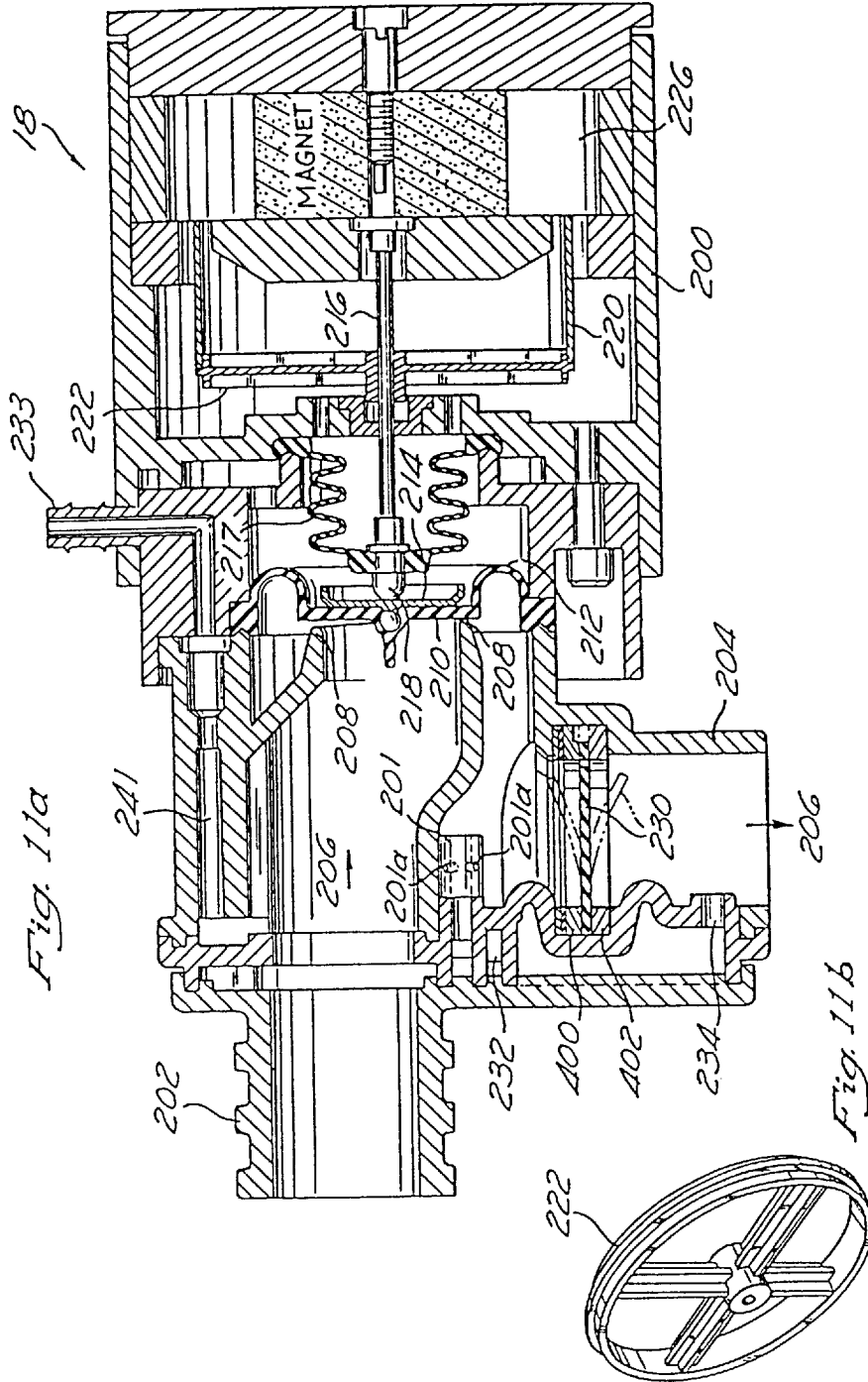



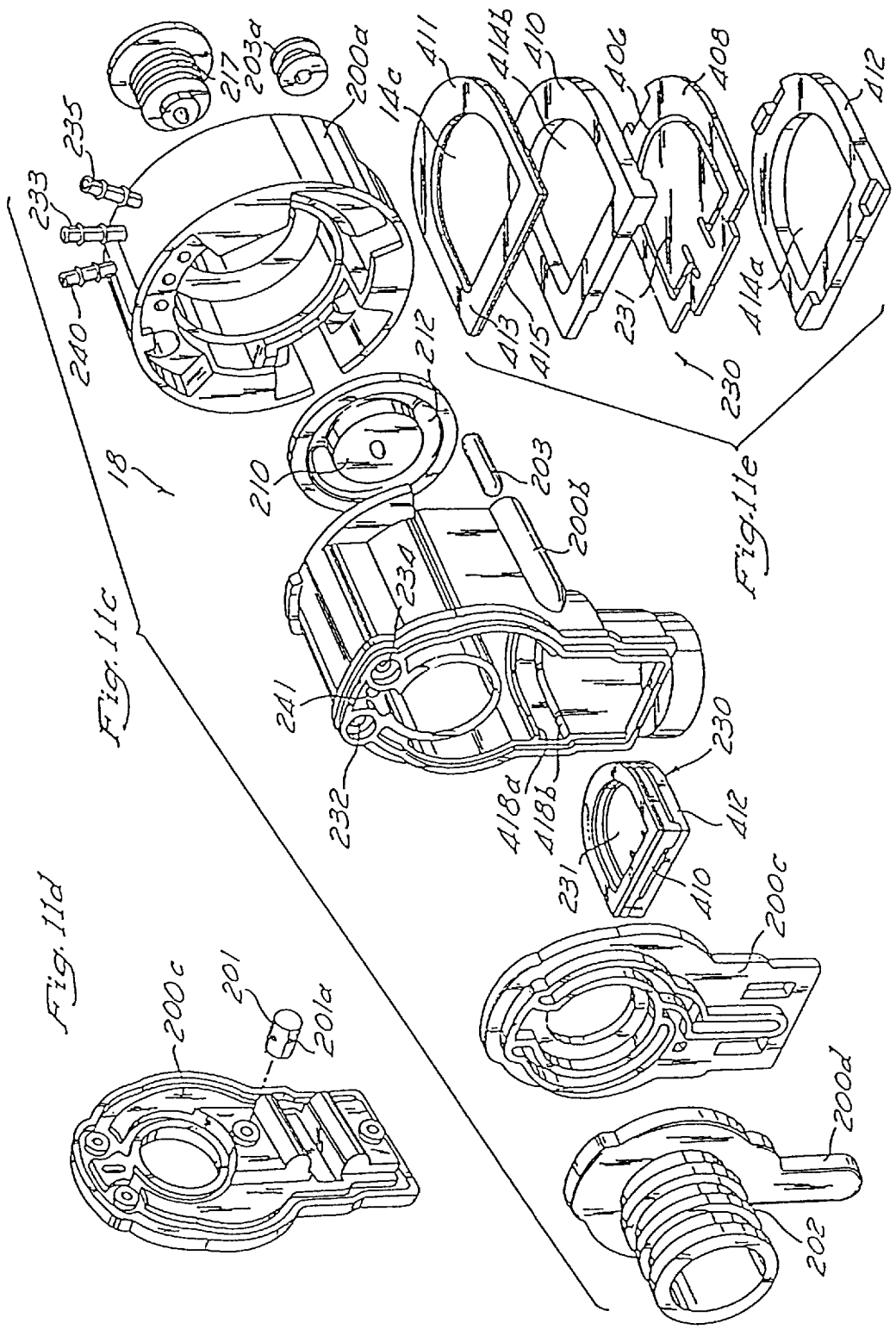

Fig. 11d

Fig. 11c

Fig. 11e

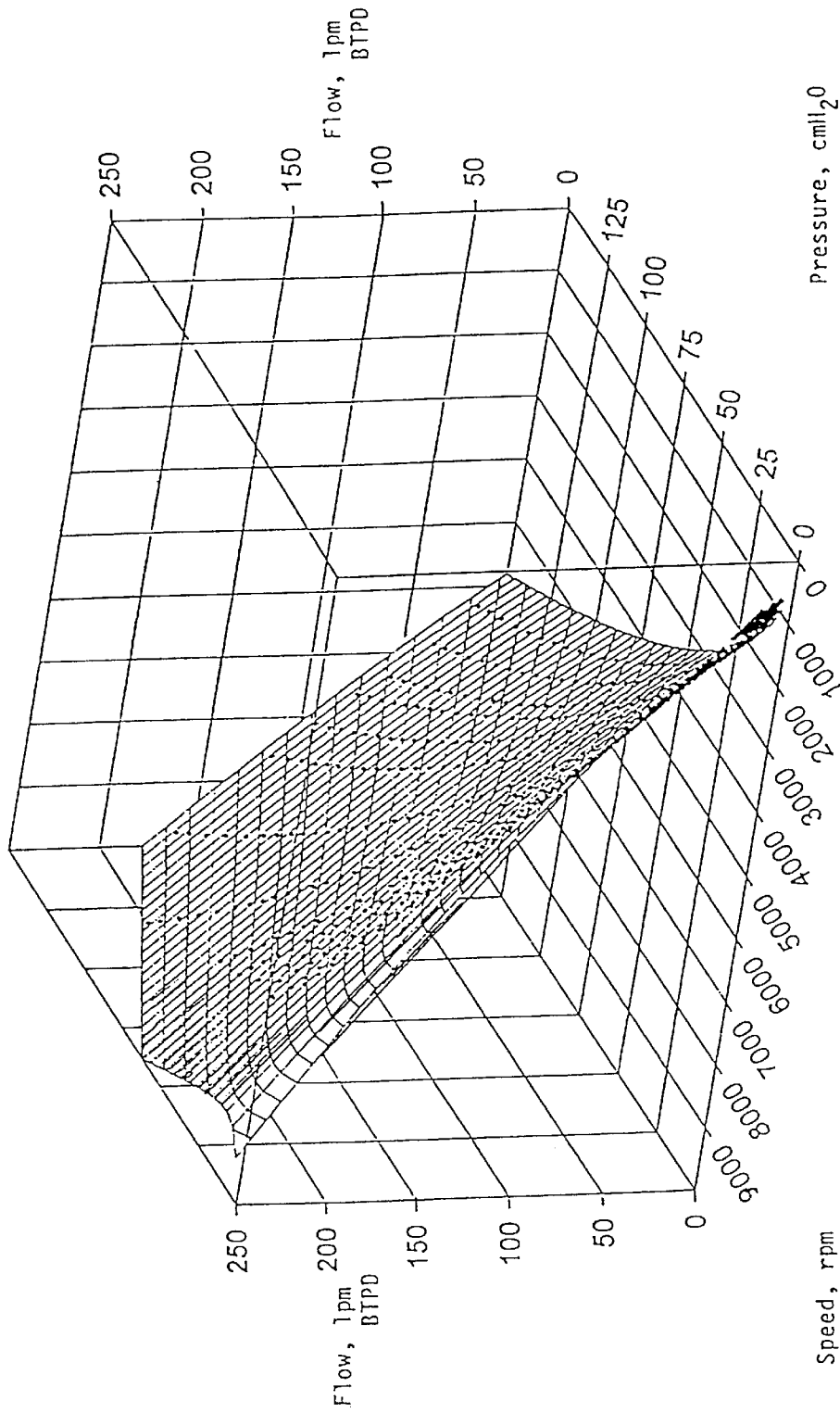

FIGURE 12

## PORTABLE DRAG COMPRESSOR POWERED MECHANICAL VENTILATOR

This application is a continuation of application Ser. No. 08/324,172, filed Oct. 14, 1994, now abandoned.

### FIELD OF THE INVENTION

The present invention pertains generally to medical equipment and more particularly to a compressor powered mechanical ventilator device for delivering respiratory ventilation to a mammalian patient.

### BACKGROUND OF THE INVENTION

#### A. Principles of Mechanical Ventilation

In many clinical settings mechanical ventilators are used to facilitate the respiratory flow of gas into and out of the lungs of patients who are sick, injured or anesthetized.

In general, mechanical ventilators provide a repetitive cycling of ventilatory flow, each such repetitive cycle being separated into two phases—an inspiratory phase followed by an expiratory phase.

The inspiratory phase of the ventilator cycle is characterized by the movement of positive-pressure inspiratory flow of gas through the ventilator circuit and into the lungs of the patient. The expiratory phase of the ventilatory cycle is characterized by cessation of the positive pressure inspiratory flow long enough to allow lung deflation to occur. The exhaled gas is vented from the ventilator circuit, typically through an exhalation valve. In patient whose lungs and thoracic musculature exhibit normal compliance, the act of exhalation is usually permitted to occur spontaneously without mechanical assistance from the ventilator.

It is sometimes desirable to control the airway pressure during exhalation to maintain a predetermined amount of positive back pressure during all, or a portion of, the respiratory cycle. Such techniques are often utilized to treat impairments of lung capacity due to pulmonary atelectasis or other factors.

The mechanical ventilators of the prior art have been grouped under various classification schemes, based on various criteria. In general, mechanical ventilators may be grouped or classified according to the parameter(s) which are utilized for a) triggering, b) limiting and c) terminating (e.g., cycling) the inspiratory phase of the ventilator cycle.

“Triggering” is the action that initiates the inspiratory phase of the ventilator cycle. The initiation of the inspiratory phase may be triggered by the ventilator or the patient. The variables and/or parameters which are utilized to trigger the beginning of the inspiratory phase include: time (i.e., respiratory rate), the commencement of spontaneous inhalation by the patient and/or combinations thereof.

“Limiting” of the inspiratory phase refers to the manner in which the inspiratory gas flow is maintained within prescribed ranges to optimize the ventilation of the patient’s lungs. The limiting variables and/or parameters are typically controlled by the ventilator, but may change as a result of patient effort and/or physiologic variables such as lung compliance and airway resistance. The variables and/or parameters which are utilized for limiting the inspiratory phase include flow rate, airway pressure and delivered volume.

“Terminating” or “cycling” of the inspiratory phase of the ventilator cycle refers to the point at which the inspiratory flow is stopped and the ventilator and/or patient are permit-

ted to “cycle” into the expiratory phase. Depending on the ventilator control settings, the termination of the inspiratory phase may be brought about by the ventilator or the patient. The variables and/or parameters which are utilized to terminate the inspiratory phase include: time; peak airway pressure; and/or tidal volume ( $V_t$ ).

#### B. Mechanical Ventilation Modes Utilized In Modern Clinical Practice

In addition Mechanical ventilators are utilized to deliver various “modes” of mechanical ventilation, the particular mode of ventilation being selected or prescribed based on the clinical condition of the patient and the overall objective (i.e., long term ventilation, short term ventilation, weaning from ventilator, etc . . . ) of the mechanical ventilation.

##### I. Ventilation Modes

###### i. Intermittent Mandatory Ventilation (IMV)

Intermittent Mandatory Ventilation is a ventilation mode wherein a spontaneously breathing patient receives intermittent mechanical inflation supplied asynchronously by the ventilator.

###### ii. Synchronized Intermittent Mandatory Ventilation (SIMV)

Synchronized Intermittent Mandatory Ventilation is a ventilation mode wherein a spontaneously breathing patient receives occasional mandatory ventilatory breaths. Mandatory ventilator breaths are synchronized with the patient’s spontaneous inspiratory efforts.

###### iii. Controlled Mechanical Ventilation (CMV)

Controlled Mechanical Ventilation (CMV) is a ventilation mode wherein mechanical breaths are delivered to the patient at time intervals which are unaffected by patient efforts. Controlled Mechanical Ventilation is typically utilized in patients who are not breathing spontaneously.

###### iv. Assist/Control Ventilation (A/C)

Assist/Control Ventilation (A/C) is a ventilation mode wherein the patient is able to volitionally alter the frequency of mandatory ventilator breaths received, but can not alter the flow and tidal volume ( $V_t$ ) of each ventilator breath received. Controlled, mandatory breaths are initiated by the ventilator based on the set breath rate. In addition, the patient can demand and trigger an assist breath. After successful triggering of an assist breath, the exhalation valve is closed and gas is delivered to the patient to satisfy the preset tidal volume, peak flow and wave form.

#### C. Breath Types Utilized in Modern Clinical Practice Breath

Breath types are typically classified according to the particular functions which control:

- a) triggering;
- b) limiting; and
- c) cycling of each breath delivered by the mechanical ventilator, as described and defined hereabove.

Typical breath types and ventilator parameters utilized in modern clinical practice include the following:

###### i. Machine-Cycled—Mandatory Breath

A machine-cycled, mandatory breath is a breath that is triggered, limited and cycled by the ventilator.

###### ii. Machine-Cycled—Assist Breath

A machine cycled assist breath is a breath that is triggered by the patient, but is limited and cycled by the ventilator.

###### iii. Patient-Cycled—Supported Breath

A patient-cycled, supported breath is a breath that is triggered by the patient, limited by the ventilator, and cycled by the patient.

iv. Patient-Cycled—Spontaneous Breath

A patient-cycled spontaneous breath is a breath that is triggered, limited and cycled by the patient. While patient effort limits the flow, and hence the inspiratory volume of the breath, the ventilator may also limit the breath by providing a flow that is too low to maintain a constant pressure in the face of patient inspiratory demand.

v. Volume-Controlled Mandatory Breaths

Volume-controlled breaths are machine-triggered mandatory breaths. The inspiratory phase is initiated by the ventilator based on a preset breath rate. The inspiratory phase is ended, and the expiratory phase begun, when the breath delivery is determined to be complete based on a preset tidal volume, peak flow and wave form setting. The ventilator remains in expiratory phase until the next inspiratory phase begins.

vi. Volume-Controlled—Assist Breaths

Volume-controlled breaths are machine cycled supported breaths that are initiated by the patient. Volume-controlled assist breaths may be initiated only when the “assist window” is open. The “assist window” is the interval or time during which the ventilator is programmed to monitor inspiratory flow for the purpose of detecting patient inspiratory effort. When a ventilator breath is triggered, the inspiratory phase of such breath will continue until a preset tidal volume peak flow and wave form have been achieved. Thereafter, the exhalation valve is open to permit the expiratory phase to occur. The ventilator remains in the expiratory phase until the next patient-triggered breath, or the next mandatory inspiratory phase, begins.

vii. Pressure-Controlled Breaths

Pressure-Controlled breaths are delivered by the ventilator using pressure as the key variable for limiting of the inspiratory phase. During pressure control, both the target pressure and the inspiratory time are set, and the tidal volume delivered by the ventilator is a function of these pressure and time settings. The actual tidal volume delivered in each pressure-controlled breath is strongly influenced by patient physiology.

viii. Pressure Support Breaths

Pressure support breaths are triggered by the patient, limited by the ventilator, and cycled by the patient. Thus, each breath is triggered by patient inspiratory effort, but once such triggering occurs the ventilator will assure that a predetermined airway pressure is maintained through the inspiratory phase. The inspiratory phase ends, and the expiratory phase commences, when the patient's inspiratory flow has diminished to a preset baseline level.

ix. Sigh Breaths

A sigh breath is a machine-triggered and cycled, volume-controlled, mandatory breath, typically equal to 1.5 times the current tidal volume setting. The inspiratory phase of each sigh breath delivers a preset tidal volume and peak flow. The duration of the inspiratory phase of each sigh breath is limited to a maximum time period, typically 5.5 seconds. The ventilator may be set to deliver a sigh function automatically after a certain number of breaths or a certain time interval (typically 100 breaths for every 7 minutes), which ever interval is shorter. The sigh breath function it may be utilized during control, assist and SIMV modes of operation, and is typically disabled or not utilized in conjunction with pressure controlled breath types or continuous positive air way pressure (CPAP).

x. Proportional Assist Ventilation (PAV)

Proportional Assist Ventilation (PAV) is a type of ventilator breath wherein the ventilator simply amplifies the spontaneous inspiratory effort of the patient, while allowing the patient to remain in complete control of the tidal volume, time duration and flow pattern of each breath received.

xi. Volume Assured Pressure Support (VAPS)

Volume Assured Pressure Support (VAPS) is a type of ventilator breath wherein breath initiation and delivery is similar to a pressure support breath. Additionally, the ventilator is programmed to ensure that a preselected tidal volume ( $V_T$ ) is delivered during such spontaneously initiated breath.

D. Oxygen Enrichment Of The Inspiratory Flow

It is sometimes desirable for mechanical ventilators to be equipped with an oxygen-air mixing apparatus for oxygen enrichment of the inspiratory flow. Normal room air has an oxygen content ( $F_iO_2$ ) of 21%. In clinical practice, it is often times desirable to ventilate patients with oxygen  $F_iO_2$  from 21% to 100%. Thus, it is desirable for mechanical ventilators to incorporate systems for blending specific amounts of oxygen with ambient air to provide a prescribed oxygen-enriched  $F_iO_2$ . Typically, volume-cycle ventilators which utilize a volume displacement apparatus have incorporated oxygen mixing mechanisms whereby compressed oxygen is combined with ambient air to produce the selected  $F_iO_2$  as both gases are drawn into the displacement chamber during the expiratory phase of the ventilator cycle. Nonbellows-type volume-cycled ventilators have incorporated other air-oxygen blending systems for mixing the desired relative volumes of oxygen and air, and for delivering such oxygen-air mixture through the inspirations circuitry of the ventilator.

E. Regulation/Control Of Expiratory Pressure

The prior art has included separately controllable exhalation valves which may be preset to exert desired patterns or amounts of expiratory back pressure, when such back pressure is desired to prevent atelectasis or to otherwise improve the ventilation of the patient.

The following are examples of expiratory pressure modes which are frequently utilized in clinical practice:

i. Continuous Positive Airway Pressure (CPAP)

Continuous Positive Airway Pressure (CPAP) is employed during periods of spontaneous breathing by the patient. This mode of ventilation is characterized by the maintenance of a continuously positive airway pressure during both the inspiratory phase, and the expiratory phase, of the patient's spontaneous respiration cycle.

ii. Positive End Expiratory Pressure (PEEP)

In Positive End Expiratory Pressure a predetermined level of positive pressure is maintained in the airway at the end of the expiratory phase of the cycle. Typically, this is accomplished by controlling the exhalation valve so that the exhalation valve may open only until the circuit pressure has decreased to a preselected positive level, at which point the expiration valve closes again to maintain the preselected positive end expiratory pressure (PEEP).

F. Portable Ventilators of the Prior Art

The prior art has included some non-complex portable ventilators which have inherent limitations as to the number and type of variables and/or parameters which may be utilized to trigger, limit and/or terminate the ventilator cycle.

Although such non-complex ventilators of the prior art are often sufficiently power efficient and small enough for portable use, their functional limitations typically render them unsuitable for long term ventilation or delivery of complex ventilation modes and or breath types.

The prior art has also included non-portable, complex microprocessor controlled ventilators of the type commonly used in hospital intensive care units. Such ventilators typically incorporate a microcomputer controller which is capable of being programmed to utilize various different variables and/or parameters for triggering, limiting and terminating the inspiratory phase of the ventilator cycle. Complex ventilators of this type are typically capable of delivering many different ventilation modes and or breath types and are selectively operable in various volume-cycled, pressure cycled or time-cycled modes. However, these complex ventilators of the prior art have typically been too large in size, and too power inefficient, for battery-driven portable use. As a result of these factors, most of the complex micro-processor controlled ventilators of the prior art are feasible for use only in hospital critical care units.

As is well known there exist numerous settings, outside of hospital critical care units, where patients could benefit from the availability of a small, battery powered, complex micro-processor controlled mechanical ventilator capable of delivering extended modes of ventilation. For example, critically ill patients sometimes require transport outside of the hospital in various transport vehicles, such as ambulances and helicopters. Also, critical care patients are sometimes transiently moved, within the hospital, from the critical care unit to various special procedure areas (e.g., radiology department, emergency room, catheterization lab etc.) where they may undergo diagnostic or therapeutic procedures not available in the critical care unit. Additionally, patients who require long term ventilation are not always candidates for admission to acute care hospital critical care units or may be discharged to step-down units or extended care facilities. Also, some non-hospitalized patients may require continuous or intermittent ventilatory support. Many of these patients could benefit from the use of complex microprocessor controlled ventilators, but may be unable to obtain such benefit due to the non-feasibility of employing such ventilators outside of the hospital-critical care unit environment.

In view of the foregoing limitations on the usability of prior art complex microprocessor controlled volume-cycled ventilators, there exists a substantial need in the art for the development of a portable, highly efficient, ventilator capable of programmed delivery of various modern ventilatory modes and breath types, while also being capable of use outside of the hospital critical care unit environment, such as in transport vehicles, extended care facilities and patients homes, etc.

U.S. Pat. No. 4,493,614 (Chu et al.) entitled "PUMP FOR A PORTABLE VENTILATOR" describes a reciprocating piston pump which is purportedly usable in a portable ventilator operable on only internal or external battery power.

U.S. Pat. No. 4,957,107 (Sipin) entitled "GAS DELIVERY MEANS" describes a rotating drag compressor gas delivery system which is ostensibly small enough to be utilized in a portable ventilator. The system described in U.S. Pat. No. 4,957,107 utilizes a high speed rotary compressor which delivers a substantially constant flow of compressed gas. The rotary compressor does not accelerate and decelerate at the beginning and end of each inspiratory

phase of the ventilator cycle. Rather, the rotating compressor runs continuously, and a diverter valve is utilized to alternately direct the outflow of the compressor a) into the patients lungs during the inspiratory phase of the ventilation cycle, and b) through an exhaust pathway during the expiratory phase of the ventilation cycle.

Thus, there remains a substantial need for the development of an improved portable mechanical ventilator which incorporates the following features:

- A. Capable of operating for extended periods (i.e., at least 2½ hours) using a single portable battery or battery pack as the sole power source;
- B. Programmable for use in various different ventilatory modes, such as the above-described IMV, SMV, CMV, PAV, A/C and VPAS.
- C. Usable to ventilate non-intubated mask patients as well as intubated patients.
- D. Oxygen blending capability for delivering oxygen-enriched inspiratory flow.
- E. Capable of providing controlled exhalation back pressure for CPAP or PEEP.
- F. Portable, e.g., less than 30 lbs.

#### Summary of the Invention

The present invention specifically addresses the above referenced deficiencies and needs of the prior art by providing comprises a mechanical ventilator device which incorporates a rotary compressor for delivering intermittent inspiratory gas flow by repeatedly accelerating and decelerating the compression rotor at the beginning and end of each inspiratory phase. Prior to commencement of each inspiratory ventilation phase, the rotary compressor is stopped, or rotated at a basal rotational speed. Upon commencement of an inspiratory phase, the rotary compressor is accelerated to a greater velocity for delivering the desired inspiratory gas flow. At the end of each inspiratory phase, the rotational velocity of the compressor is decelerated to the basal velocity, or is stopped until commencement of the next inspiratory ventilation phase. A programmable controller is preferably incorporated to control the timing and rotational velocity of the compressor. Additionally, the controller may be programmed to cause the compressor to operate in various modes of ventilation, and various breath types, as employed in modern clinical practice.

Further in accordance with the present invention, there is provided an oxygen blending apparatus which may be utilized optionally with the rotatable compressor ventilation device of the present invention. The oxygen blending apparatus of the present invention comprises a series of valves having flow restricting orifices of varying size. The valves are individually opened and closed to provide a desired oxygen enrichment of the inspiratory gas flow. The oxygen blending apparatus of the present invention may be controlled by a programmable controller associated with, or separate from, the ventilator controller.

Still further in accordance with the invention, there is provided an exhalation valve apparatus comprising a housing which defines an expiratory flow path therethrough and a valving system for controlling the airway pressure during the expiratory phase of the ventilation cycle. A pressure transducer monitors airway pressure during exhalation the output of which is used by the controller to adjust the valving system to maintain desired airway pressure.

In addition the present invention utilizes an exhalation flow transducer to accurately measure patient exhalation

flow which may be utilized for determination of exhaled volume and desired triggering of inspiratory flow. In the preferred embodiment, the exhalation flow transducer is integrally formed with the exhalation valve, however, those skilled in the art will recognize that the same can be a separate component insertable into the system. To insure transducer performance accuracy, in the preferred embodiment, the particular operational characteristics of each flow transducer are stored within a memory device preferably a radio-frequency transponder mounted within the exhalation valve to transmit the specific calibration information for the exhalation flow transducer to the controller. Further, the particular construction and mounting of the flow transducer within the exhalation valve is specifically designed to minimize fabrication inaccuracies.

Further objects and advantages of the invention will become apparent to those skilled in the art upon reading and understanding of the following detailed description of preferred embodiments, and upon consideration of the accompanying drawings.

#### BRIEF DESCRIPTION OF THE DRAWINGS

FIG. 1 is a basic schematic diagram of a preferred ventilator system of the present invention incorporating, a) a rotary compressor ventilator device, b) an optional air-oxygen blending apparatus; and c) a controllable exhalation valve, and d) a programmable controller or central processing unit (CPU) which is operative to control and coordinate the functioning of the ventilator, oxygen blending apparatus and exhalation valve.

FIG. 2 is a detailed schematic diagram of a ventilator system of the present invention.

FIG. 3 is a front view of the control panel of a preferred ventilator system of the present invention.

FIG. 4 is a perspective view of a preferred drag compressor apparatus which may be incorporated into the ventilator system of the present invention.

FIG. 5 is a longitudinal sectional view through line 5—5 of FIG. 4.

FIG. 6 is an enlarged view of a segment of FIG. 5.

FIG. 7 is an enlarged view of a segment of FIG. 6.

FIG. 8 is an elevational view of a preferred drag compressor component of a mechanical ventilator device of the present invention.

FIG. 9 is a perspective view of the drag compressor component of FIG. 8.

FIG. 10 is an enlarged view of a segment of FIG. 9.

FIG. 11a is a longitudinal sectional view of a preferred exhalation valve of the present invention.

FIG. 11b is a perspective view of the preferred spider bobbin component of the exhalation valve shown in FIG. 11a.

FIG. 11c is an exploded perspective view of a portion of the exhalation valve of FIG. 11a

FIG. 11d is a perspective view of a portion of the exhalation valve shown in FIG. 11c.

FIG. 11e is an exploded perspective view of the preferred flow restricting flapper component of the exhalation valve shown in FIGS. 11a-11d.

FIG. 12 is a graphic example of flow vs. speed vs. pressure data generated for a preferred exhalation valve of the present invention, accompanied by an exhalation valve characterization algorithm computed therefrom.

#### DETAILED DESCRIPTION OF THE PREFERRED EMBODIMENT

The following detailed description and the accompanying drawings are provided for purposes of describing and illus-

trating a presently preferred embodiment of the invention and are not intended to describe all embodiments in which the invention may be reduced to practice. Accordingly, the following detailed description and the accompanying drawings are not to be construed as limitations on the scope of the appended claims.

#### A. General Description of the Preferred Ventilator System

With reference to FIGS. 1-2, the mechanical ventilation system 10 of the present invention generally comprises a) a programmable microprocessor controller 12, b) a ventilator device 14, c) an optional oxygen blending apparatus 16 and d) an exhalation valve apparatus 18. Which is preferably implemented as a portable, battery powered system.

The ventilator device 14 incorporates a rotating drag compressor 30 which is driven by an electric motor 102. In response to control signals received from controller 12, a bladed rotor within the compressor 30 will undergo rotation for specifically controlled periods of time and/or, within specifically controlled parameters, so as to provide inspiratory gas flow through line 22 to the patient PT.

The controller 12 comprises a programmable microprocessor which is electrically interfaced a) to the ventilator device 14 by way of control line 13, b) to the optional oxygen blending apparatus 16 by way of control line 17, and c) to the exhalation valve 18 by way of control line 19 and also by RF communication between flow transducer transponder (21) and transmitter/receiver (23), preferably incorporated into the exhalation valve 18 as will be described in more detail infra.

The controller 12 is preferably programmed to utilize selected parameters (e.g., time, flow rate, tidal volume (V<sub>T</sub>), airway pressure, spontaneous breath initiation, etc.) for triggering, limiting and cycling the inspiratory flow in accordance with the selected ventilatory mode or breath type.

At the end of each inspiratory flow cycle, the patient PT is permitted to exhale through exhalation valve 18. The flow rate or pressure of the expiratory flow through exhalation valve 18 is controlled by varying the degree of flow restriction within the exhalation valve 18, in response to control signals received through line 19 from controller 12. This enables the exhalation valve 18 to be utilized to create a selected expiratory back pressure (e.g., CPAP, PEEP).

Optional oxygen blending apparatus 16 may be utilized to enrich the oxygen content of the inspiratory gas flow provided by the drag compressor ventilator device 14. The preferred oxygen blending apparatus 16 comprises a plurality of (preferably five (5)) solenoid valves 52, each having a specific sized flow restricting orifice. The solenoid valves 52 are arranged in parallel between an oxygen inflow manifold 26 and an oxygen outflow manifold 28. The controller 12 is programmed to open and close the individual solenoid valves 52 for specific periods of time so as to provide a metered flow of oxygen through oxygen outflow manifold 28 and into accumulator 54. Ambient air is drawn through conduit 24 and filter 50, into accumulator 54, where the ambient air combines with the metered inflow of oxygen to provide an oxygen-enriched inspiratory flow containing a prescribed oxygen concentration (FIO<sub>2</sub>).

The presently preferred embodiment of the system 10 will operate when supplied with voltage input within the range of 85-264 VAC at 50/60 Hz.

An AC power cord is preferably connectable to the system 10 to provide AC power input.

Additionally, the system **10** preferably includes an internal battery capable of providing at least 15 minutes, and preferably 30 minutes, of operation. During internal battery operation, some non-essential displays may be dimmed or disabled by the controller **12**. The internal battery is preferably capable of being recharged by AC power input provided through the AC power cable, or by a separate battery charger. The internal battery is preferably capable of being fully charged, from a no charged state, within 24 hours. The internal battery charge light **306** shown on the panel of the preferred controller **12a** may additionally flash if desired during charging of the internal battery.

Also, the system may include an external battery or battery set capable of providing at least 2 hours of operation, and preferably capable of providing 4 to 8 hours of operation. During external battery use, some non-essential displays may be dimmed or disabled by the controller **12**. The battery or battery set is preferably capable of being recharged by delivery of AC power through the AC power cable, or by a separate battery charger. It is preferable that the external battery or battery set be capable of being fully charged, from a no charged state within 24 to 48 hours. The external battery charge light **310** on the panel of the preferred controller **12a** may additionally flash if desired during charging of the external battery or battery set.

#### B. The Preferred Controller Apparatus

It will be appreciated that the controller **12** of the ventilator system **10** of the present invention will vary in complexity, depending on the specific capabilities of the system **10**, and whether or not the optional oxygen blending apparatus **16** is incorporated.

FIG. **3** shows the control panel of a preferred controller apparatus **12a** which is usable in connection with a relatively complex embodiment of the ventilatory system **10**, incorporating the optional oxygen blending apparatus **16**.

#### CONTROLS SETTINGS AND DISPLAYS

The specific control settings and displays which are included in the preferred controller **12a**, and the ways in which the preferred controller **12a** receives and utilizes operator input of specific control settings, are described herebelow:

##### 1. Standby-Off Control

The ventilator system **10** incorporates a stand by/off switch (not shown) which turns the main power on or off. A group of indicator lights **300** are provided on the face panel of the controller **12a**, and are more fully described herebelow under the heading "monitors". In general, the panel indicator lights include an "on" indicator **302** which becomes illuminated when the ventilator is turned on. An AC power low/fail indicator light **304** activates when the AC power cord is present and the voltage is out of a specified operating range. Upon sensing low or faulty AC power, the controller **12a** will automatically switch the ventilator **14** to internal battery power. The ventilator will continue to operate on internal battery power until such time as power in the internal battery reaches a minimum level. When the power in the internal battery reaches a minimum level, the controller **12a** will cause the internal battery light and/or audible alarm **308** to signal that the internal battery is near depletion.

A separate external battery light and/or audible alarm **312** is also provided. The external battery light and/or audible alarm will activate when the external battery is in use, and has a battery voltage which is out of the acceptable operation range. During this condition, the controller **12a** will cause all nonessential displays and indicators to shut down.

When AC power is connected to the ventilator **14**, but the ventilator is turned off, any internal or external batteries

connected to the ventilator will be charged by the incoming AC current. Internal battery charge indicator light **306** and external battery charge indicator light **306** and external battery charged indicator light **310** are provided, and will blink or otherwise indicate charging of the batteries when such condition exists.

##### 2. Mode Select

A mode select module **320** incorporates plural, preferably five (5) mode select buttons **322, 324, 326, 328, 330**. Mode select button **322** sets the system **10** for Assist Control (a/c). Mode select button **324** sets the system **10** for Synchronized Intermittent Mandatory Ventilation (SIV). Mode select button **326** sets the system for Continuous Positive Airway Pressure (CPAP).

Spare mode select buttons **328, 330** are provided to permit the controller **12a** to be programmed for additional specific ventilation modes such as volume assured pressure support (VAPS) or proportional assist ventilation. When the controller is programmed for additional specific ventilation modes, select buttons **328, 330** may be correspondingly labeled and utilized to set the ventilator **14** to deliver such subsequently programmed ventilation modes.

##### 3. Tidal Volume

A digital tidal volume display **332**, with corresponding tidal volume setting button **332a** are provided. When tidal volume setting button **332a** is depressed, value setting knob **300** may be utilized to dial in a selected tidal volume. The tidal volume display **332** will then provide a digital display of the currently selected tidal volume value.

The typical range of setable tidal volumes is 25 ml–2000 ml.

##### 4. Breath Rate

A digital breath rate display **334**, with corresponding breath rate setting button **334a** is provided. When breath rate setting button **334a** is depressed, value setting knob **300** may be utilized to dial in the desired breath rate. Breath rate display **334** will thereafter display the currently selected breath rate.

The typical range of selectable breath rates is 0 to 80 breaths per minute.

##### 5. Peak Flow

A digital peak flow display **336**, and corresponding peak flow setting button **336a** are provided. When peak flow setting button **336a** is depressed, value setting knob **300** may be utilized to dial in the desired peak flow. The peak flow display **336** will, thereafter, provide a digital display of the currently selected peak flow.

The typical range of peak flow settings is 10 to 140 liters per minute.

##### 6. Flow Sensitivity

A flow sensitivity digital display **338**, and corresponding flow sensitivity setting button **338a** are provided. When flow sensitivity setting button **338a** is depressed, value setting knob **300** may be utilized to dial in the desired flow sensitivity setting. The flow sensitivity setting display **338** will, thereafter, provide a digital display of the currently selected flow sensitivity setting.

The flow sensitivity setting determines the trigger level for initiation of volume and pressure-controlled assist breaths or pressure support breaths. The initiation of volitional inspiratory effort by the patient creates a change in airway flow as determined by: (turbine bias flow)—(exhalation flow)=patient flow. Triggering occurs when the patient airway flow exceeds the sensitivity setting. The typical range of selectable flow sensitivity settings is from one to ten liters per minute, or off.

Optionally, a fail safe feature may be incorporated whereby, if the patients flow demand does not exceed the

## 11

flow sensitivity setting, but the airway pressure drops more than 5 cmH<sub>2</sub>O below the set PEEP level, and inspiratory cycle will be initiated and a breath will be delivered based on current mode and control settings.

## 7. PEEP/CPAP

A PEEP/CPAP digital display **340**, with corresponding PEEP/CPAP setting button **340a** are provided. When PEEP/CPAP setting button **340a** is depressed, the value setting knob **300** may be utilized to dial in the desired PEEP/CPAP setting.

The current PEEP/CPAP setting sets the level of pressure in the patient circuit that is maintained between the end of inspiration and the start of the next inspiration. It is also known as the "baseline" pressure.

The preferred range of PEEP/CPAP setting is 0 to 50 cmH<sub>2</sub>O.

## 8. Pressure Support

A pressure support digital display **342**, and corresponding pressure support setting button **342a**, are provided. When pressure support setting button **342a** is depressed, value setting knob **300** may be utilized to dial in the desired pressure support setting.

The pressure support setting determines the inspiratory patient circuit pressure during a pressure support breath. This control sets the pressure support level above the baseline setting established by the PEEP/CPAP setting. The total delivered pressure equals the PEEP or CPAP value + pressure support.

The typical range of pressure support settings is from 1 to 60 centimeters of water (cmH<sub>2</sub>O), or off.

9. FiO<sub>2</sub> (%O<sub>2</sub>)

An FiO<sub>2</sub> digital display **348**, and corresponding FiO<sub>2</sub> setting button **348a**, are provided. When the FiO<sub>2</sub> setting button **348a** is depressed, the value setting knob **300** may be utilized to dial in the desired fractional percentage of oxygen in the air/oxygen gas mixture that is delivered to the patient PT and used for the bias flow. In response to the FiO<sub>2</sub> setting, the controller **12** will issue control signals to the oxygen blending apparatus **16** to effect the preset FiO<sub>2</sub>.

The preferred range of settable FiO<sub>2</sub> is between 0.21 and 1.0 (i.e., 21–100 percent oxygen)

## 10. Pressure Control (Optional)

A pressure control digital display **350**, and corresponding pressure control setting button **350a** are provided. When the pressure control setting button **350a** is depressed, the value setting knob **300** may be utilized to dial in the desired pressure control value.

The pressure control setting enables the system **10** to be utilized for pressure control ventilation, and determines the inspiratory pressure level during delivery of each pressure control breath. The pressure control setting sets the pressure level above any PEEP.

It is preferable that the range of possible pressure control settings be from 1 to 100 cmH<sub>2</sub>O.

## 11. Inspiratory Time (Optional)

An optional inspiratory time digital display **352**, and corresponding inspiratory time setting button **352a** may be provided. When the inspiratory time setting button **352a** is depressed, the value setting of **300** may be utilized to dial in the desired inspiratory time.

The set inspiratory time is the time period for the inspiratory phase of a pressure control breath. Thus, this inspiratory time setting is normally usable for pressure control ventilation.

It is preferable that the range of settable inspiratory times being from 0.3 to 10.0 seconds.

## 12. Additional Displays/Settings

## 12

Additional digital displays **344**, **346**, **354**, **356** and corresponding setting buttons **344a**, **346a**, **354a**, **356a** are provided to permit the controller **12** to be subsequently programmed or expanded to receive and display additional control settings beyond those which have been described hereabove.

## 13. Sigh On/Off

A sigh on/off button **360** is provided. When sigh on/off button **360** is depressed, the controller **12** will cause the ventilator **14** to deliver a sigh breath. A sigh breath is a volume-controlled, mandatory breath that is usually equal to 1.5 times the current tidal volume setting shown on tidal volume setting display **332**. The sigh breath is delivered according to the current peak flow setting shown on peak flow setting display **336**. The inspiratory phase of the sigh breath is preferably limited to a maximum of 5.5 seconds. During a sigh breath, the breath period is automatically increased by a factor of 1.5. The sigh breath function is available during all ventilation modes.

A single depression of the sigh on/off button **348** will cause the ventilator to deliver a volume-controlled sigh breath once every 100 breaths or every 7 minutes, whichever comes first. The sigh breath button **360** includes a visual indicator light **360a** which illuminates when the sigh on/off button **360** is depressed and the sigh/breath function is active.

## 14. Manual Breath

A manual breath button **362** is also provided. Upon depression of the manual breath button **362**, the controller **12** will cause the ventilator **14** to deliver a single volume-controlled or pressure-control breath in accordance with the associated volume and/or pressure control settings. An indicator light **362a** will illuminate briefly when manual breath button **362** is depressed.

## 15. Remote Alarm (Optional)

A remote alarm on/off control button **364** is provided to enable or disable the remote alarm. When the remote alarm on/off control button **364** is depressed, indicator light **364a** will illuminate. When the remote alarm on/off button **364** is depressed, the remote alarm will be enabled. When this function is enabled, alarm conditions will transmit via hard wire or radio frequency (wireless) to a remote alarm which may be mounted on the outside of a patients room so as to signal attendants outside of the room, when an alarm condition exists.

The specific alarm conditions which may be utilized with the remote alarm function, are described in greater detail herebelow.

## 16. Flow Waveform (Optional- Applies To Volume Breaths Only)

The controller **12** includes a square flow wave form activation button **366** and a decelerating taper flow wave form actuation button **368**. When the square flow wave form actuation button **366** is depressed, indicator light **366a** will illuminate, and the ventilator will deliver inspiratory flow at a constant rate according to the peak flow setting, as input and shown on peak flow display **336**. When the decelerating paper wave form actuation button **368** is depressed, indicator light **368a** will illuminate, and the ventilator will deliver an inspiratory flow which initially increases to the peak flow setting, as input and shown on peak flow display **336**, then such inspiratory flow will decelerate to 50 percent of the peak flow setting at the end of the inspiratory phase.

## 17. Inspiratory Hold (Optional)

An inspiratory hold actuation button **370** is provided, to enable the operator to hold the patient at an elevated pressure following inspiration, so that breath mechanics can be



## 13

calculated. The length of the delay period is determined by the period of time during which the inspiratory hold button **370** remains depressed, with a maximum limit applied.

## 18. Expiratory Hold (Optional)

The controller **12** also includes an expiratory hold actuation button **372**, which enables the ventilator to calculate auto PEEP. During the expiratory hold, the turbine **30** operation is halted and the exhalation valve **18** remains closed. The difference between the end expiratory pressure, as measured at the end of the expiratory hold period, minus the airway pressure reading recorded at the beginning of the expiratory hold period, will be displayed on monitor window **384**.

## 19. Maximal Inspiratory Pressure/Negative Inspiration Force (Optional)

The preferred controller **12** also incorporates a maximal inspiratory pressure test button **374**, to enable the operator to initiate a maximal inspiratory pressure (MIP) test maneuver. This maneuver causes the ventilator to stop all flow to or from the patient. The patient inspiratory effort is then monitored and displayed as MIP/NIF in the monitor window **384**.

20. 100% O<sub>2</sub> Suction (Optional)

Optionally, the controller **12a** includes a 100% O<sub>2</sub> actuation button **376** which, when depressed, will cause indicator light **376a** to illuminate and will cause the system **10** to deliver an FiO<sub>2</sub> of 1.00 (i.e., 100% oxygen) to the patient for a period of three (3) minutes regardless of the current FiO<sub>2</sub> setting and/or breath type setting.

This 100% O<sub>2</sub> feature enables the operator to selectively deliver 100% oxygen to the patient PT for a three minute period to hyperoxygenate the patient PT prior to disconnection of the patient from the ventilator circuit for purposes of suctioning, or for other clinical reasons.

## 21. Additional Control Actuation Buttons

An additional control actuation button **378**, with indicator light **378a**, is provided to enable the controller **12a** to be subsequently programmed to perform additional control actuation functions beyond those described hereabove.

## MONITORS AND INDICATORS

## 1. AC Power Status Indicator

An AC power indicator light **304** is provided in the face panel of the controller **12** to indicate when sufficient AC power is available and the standby/off switch (not shown) is in the standby position.

## 2. Internal Battery Status Indicator(s)

An internal battery status indicator light **308** is provided on the panel of the controller **12**, and will indicate battery charge level according to predetermined color signals. A separate internal battery charge indicator light **306** may be provided, and will indicate charging status according to predetermined color signals.

## 3. External Battery Status Indicator(s)

An external battery status indicator light **312** is provided on the panel of the controller **12**, and will indicate battery charge level according to predetermined color signals. A separate external battery charge indicator light **310** may be provided, and will indicate charging status according to predetermined color signals.

## 4. Airway Pressure Monitor

The display panel of the controller **12** includes a real time airway pressure bar graph display **380**. A green indicator bar will appear on the airway pressure bar graph display **380** to indicate the real time airway pressure at all times. Red indicators will appear on the airway pressure bar graph to indicate high and low peak pressure alarm setting, as more fully described herebelow under the heading "Alarms". An

## 14

amber colored indicator will appear on the airway pressure bar graph display **380** to indicate the current PEEP/CPAP setting, Pressure Support setting and/or Pressure Control setting. A patient effort indicator light **382** is located near the airway pressure bar graph display **380**, and will illuminate to indicate the occurrence of a patient-initiated breath, including all spontaneous, assist or pressure support breaths.

## 5. Digital Monitor Display

The panel of the controller **12** preferably includes a digital monitor display **384** and an accompanying monitor select button **386**. The controller **12** is programmed to display various monitored parameters. Each time the monitor select button **386** is depressed, the monitored parameters displayed on monitor display **384** will change. The individual parameters may include: exhaled tidal volume, i.e., ratio, mean airway pressure, PEEP, peak inspiratory pressure, total breath rate, total minute ventilation.

Additionally, a display power saving feature may be incorporated, whereby the controller **12** will automatically cause the monitor display **384** to become non-illuminated after a predetermined display period when the system **10** is operating solely on internal or external battery power. Each time the monitor select button **386** is depressed, the display **384** will illuminate for a predetermined period of time only, and then will become non-illuminated. This feature will enable the system **10** to conserve power when the system **10** is being operated solely on internal or external battery power.

Additionally, the controller **12** may be programmed to cause the monitor display **384** to display a special or different group of parameters during a specific operator-initiated maneuver. Examples of special parameter groups which may be displayed during a specific maneuver include the following:

- Real-time Pressure (at start of and during all maneuvers)
- Plateau Pressure (Inspiratory Hold)
- Compliance (Inspiratory Hold)
- End Expiratory Pressure (Expiratory Hold)
- Auto PEEP (Expiratory Hold)
- Maximal Inspiratory Pressure (MIP/NIF)

## Alarms And Limits

The preferred controller **12** may be programmed to received operator input of one or more limiting parameters, and to provide audible and/or visual alarm indications when such limiting parameters have been, or are about to be, exceeded.

The visual alarm indicators may comprise steady and or flashing lights which appear on the control panel of the preferred controller **12a**.

The audible alarm components will preferably comprise electronic buzzers or beepers which will emit sound discernable by the human ear for a preselected period (e.g., 3 seconds). Preferably, the audible portion of any alarm may be volitionally muted or deactivated by the operator.

Additionally it is preferable that the controller **12** be programmed to automatically reset each alarm if the current ventilation conditions do not fall outside of the preset alarm limits.

Examples of specific limiting parameters and alarm limits which may be programmed into the preferred controller **12**, are as follows:

## 1. High Peak Pressure

The preferred controller **12** includes, on its face panel, a high pressure digital display **390** and a corresponding high pressure alarm limit setting button **390a**. When the high pressure alarm limit setting button **390a** is depressed, value

setting knob **300** may be utilized to dial in a desired high pressure alarm limit value. Such high pressure alarm limit value will then be displayed on high pressure alarm limit display **390**.

The currently set high pressure alarm limit, as shown on high pressure alarm limit display **390**, will establish the maximum peak inspiratory pressure for all breath types. When the monitored airway pressure exceeds the currently set high pressure alarm limit, audible and visual alarms will be actuated by the controller **12** and the controller will immediately cause the system **10** to cycle to expiratory mode, thereby allowing the airway pressure to return to the baseline bias flow level and along the exhalation valve **18** to regulate pressure at any currently-set peep level.

In order to avoid triggering of the high pressure alarm during delivery of a sigh breath, the controller **12** will be programmed to automatically adjust the high pressure alarm limit value by a factor of 1.5×during the delivery of a sigh breath, provided that such does result in the high pressure limit value exceeding 140 cmH<sub>2</sub>O. The controller **12** is preferably programmed not to exceed a high pressure limit setting of 140 cmH<sub>2</sub>O, even during delivery of a sigh breath.

#### 2. Low Peak Pressure

A low peak airway pressure limit display **392**, and corresponding low peak pressure limit setting button **392a**, are also provided. When the low peak pressure limit setting button **392a** is depressed, value setting knob **300** may be utilized to dial in a desired low peak airway pressure alarm limit value. Such low peak pressure alarm limit value will then be displayed in the low peak pressure display **392**.

Audible and/or visual alarms will be activated if the monitored airway pressure fails to exceed the low peak pressure alarm limit setting during the inspiratory phase of a machine-cycled mandatory or assist breath.

The controller **12** is preferably preprogrammed to deactivate the low peak airway pressure alarm during spontaneous, CPAP and pressure support breathing.

The range of low peak pressure settings will preferably be from 2 to 140 cmH<sub>2</sub>O.

#### 3. Low Minute Volume

A low minute volume display **394**, and corresponding low minute volume setting button **394a** are provided. When low minute volume setting button **394a** is depressed, value setting knob **300** may be used to dial in the desired low minute volume alarm setting. The currently-set low minute volume alarm setting will be displayed in digital display **394**.

The controller **12** will be programmed to calculate the current exhaled minute volume based on information received from the exhalation valve differential pressure transducer **70**, and to trigger audible and/or visual alarms when the exhaled minute volume becomes less than or equal to the currently set low minute volume alarm limit. This alarm is active for all breath types.

The typical range of setable low minute volume alarm limits is from 0 to 99.9 liters/min.

#### 4. Apnea Alarm

The controller **12** may be programmed to trigger auditory and/or visual apnea alarms when the period between initiation of inspiratory phases exceeds 20 seconds. The controller **12** is preferably also programmed to initiate back-up machine ventilation when an apnea alarm condition exists.

The controller **12** is preferably programmed not to permit volitional silencing of the apnea alarm until the apnea condition has been corrected.

#### 5. Spare Alarm Limit Displays And Setting Buttons

Spare alarm limit displays **396**, **398**, and corresponding spare alarm limit setting buttons **396a** and **398a** are

provided, to permit the controller **12** to be subsequently expanded or programmed to receive operator input of additional limiting parameters, and to provide auditory and/or visual alarms when such limiting parameters have been exceeded.

#### 6. Ventilator Inoperative

A separate ventilator inoperative light indicator **400** is provided on the face panel of the controller **12**. The controller **12** is programmed to cause the ventilator inoperative light to illuminate when predetermined "ventilatory inoperative" conditions exist.

#### 7. AC Power Low/Fail

The controller **12** is preferably programmed to activate visual and/or auditory alarms when an AC power cord is connected to the system **10** and the voltage received by the system **10** is outside of a specified operating range. The controller **12** is preferably also programmed to automatically switch the system **10** to internal battery power under this condition. The AC power low/fail alarm can be silenced, and will remain silenced, until such time as the internal low battery alarm **208** becomes actuated, indicating that the internal battery has become depleted.

#### 8. External/Internal Battery Low/Fail

The controller **12** may be programmed to actuate a visual and or auditory alarm when an external or internal battery is in use, and the battery voltage is outside of an acceptable operating range.

#### 9. O<sub>2</sub> Inlet Pressure

The controller **12** may be programmed to provide auditory and/or visual alarms when the oxygen pressure delivered to the system **10** is above or below predetermined limits.

10. Over Pressure Relief Limit The system **10** includes a mechanical variable pressure relief valve **64**, to relieve any over pressurization of the patient circuit.

The range of setable over pressure relief limit values may be between 0 to 140 cmH<sub>2</sub>O.

### SELF TESTING AND AUTO CALIBRATION FUNCTIONS

#### 1. Self Test Function

The preferred controller **12** may be programmed to perform a self-testing function each time the ventilator is powered up. Such self testing function will preferably verify proper functioning of internal components such as microprocessors, memory, transducers and pneumatic control circuits. Such self testing function will also preferably verify that electronic sub-systems are functioning correctly, and are capable of detecting error conditions relating to microprocessor electronics.

Also, during power up, the controller **12** may be programmed to allow a qualified operator who enters a given key sequence, to access trouble shooting and calibration information. In accordance with this feature, the key operator may induce the controller to display, on the monitor display **384**, information such as the following:

#### SOFTWARE REVISION

PEAK FLOW AND PRESSURE TRANSDUCER  
OUTPUT LAMP TEST/ALL DISPLAYS ON

ANY AUTO ZERO AND PURGE FUNCTIONS  
FOR THE FLOW PRESSURE TRANSDUCER

EVENT DETECTION MENU INCLUDING  
PREVIOUS STATUS OR FAULT CODES

REMOTE ALARM TEST AND PROGRAM; and

DATA COMMUNICATIONS TEST AND  
PROGRAM

Also, the controller **12** may be programmed to allow a qualified operator who entered a given key sequence, to

access a user preference and set up menu. Such menu may include a monitory display 384, of information such as the following:

- System lock, enable or disable;
- Variable Apnea interval;
- Language selection; and
- User verification tests.

The user preference and set up menu function may also be accessible during operation of the system 10.

### C. A Preferred Rotary Drag Compressor Apparatus

The portable system 10 ventilator of the present invention preferably incorporates a rotary drag compressor apparatus 30 comprising a dual-sided, multi-bladed rotor 104 disposed within a rigid compressor housing 106. An inflow/outflow manifold 108 is formed integrally with the compressor housing 106, and incorporates two (2) inflow passageways 112 and two (2) outflow passageways 110 for channeling gas flow into and out of the compressor apparatus 30.

An electric motor 102, such as a 0.8 peak horsepower, 40 volt D.C. motor, is preferably mounted integrally within the compressor housing 106. Alternatively, the motor 102 may be encased or housed in an encasement or housing which is separate from the compressor housing 106. The motor shaft 114 extends transversely into a bore 116 formed in the central hub 118 of rotor 104. As shown, the bore 116 of the central hub 118 of rotor 104 may include a rectangular key-way 121 formed on one side thereof and the motor shaft 114 may include a corresponding elongate rectangular lug formed thereon. The rectangular lug of the motor shaft 114 inserts within and frictionally engages the key-way 121 of the rotor hub 118, thereby preventing the motor shaft 114 from rotationally slipping or turning within the bore 116 of the rotor hub 118. It will be appreciated however, that various alternative mounting structures, other than the lug and keyway 121 shown in FIGS. 8-9, may be utilized to rotatably mount the motor shaft 114 to the rotor 104.

The rotor hub 118 is preferably formed having a concave configuration, as shown in FIG. 5. Such concave configuration serves to impart structural integrity and strength to the rotor 104, without significantly increasing the mass of the rotor 104 as would result from the formation of additional strengthening ribs or bosses on the rotor hub 118.

As shown in FIGS. 5-10, a first annular trough 120 extends about the periphery of the front side of the rotor 104, and a second annular trough 122 extends about the periphery of the backside of the rotor 104.

A multiplicity of rotor blade-receiving slots 126 are formed angularly, at evenly spaced intervals about the inner surfaces of the first 120 and second 122 annular troughs. Rotor blades 128 are mounted at spaced-apart locations around each annular trough 120, 122 such that the radial peripheral edge 127 of each blade 128 is inserted into and resides within a corresponding blade receiving slot 126 and the leading edge 129 of each blade traverses across the open annular trough 120 or 122, as shown. Each blade 128 is affixed by adhesive, or other suitable means, to the body of the rotor 104.

In the preferred embodiment the blades 128 are located in axially aligned positions, i.e., non-staggered directly opposite positions on opposite sides of the rotor 104 so as to promote even pressure balance and symmetrical weight distribution within the rotor 104.

The rotor 104 is rotatably mounted within the compressor housing 106 such that the first 120 and second 122 annular

cavities are in alignment with the inflow 110 and outflow 112 channels, as shown.

In order to optimize the controllability of the rotor 104 velocity, and to minimize the wear or stress on the system drive components from repeated abrupt starting and stopping of the rotor 104, it is desirable that the overall mass of the rotor 104 be minimized. Toward this end, the body of the rotor 104 is preferably constructed of light weight material such as aluminum, and the individual blades 128 of the rotor 104 are preferably constructed of light weight material such as glass-filled epoxy. In embodiments where the body of the rotor 104 is formed of aluminum and the blades 128 are formed of glass-filled epoxy, a suitable adhesive such as epoxy may be utilized to bond the radial edges of the blades 128 within their corresponding blade-receiving slots 126. Alternatively, it is contemplated to form the rotor and blades integrally, as by way of a molding process whereby metal (e.g., aluminum), polymer or composite materials are molded to form the blades 128 and rotor 104 as a unitary structure.

After the rotor blades 128 have been mounted and secured in their respective blade-receiving slots 126, each individual blade 128 will preferably be disposed at an angle of attack A, relative to a flat transverse plane TP projected transversely through the body of the rotor 104, between the first annular trough 120 on the front side of the rotor 104, and the second annular trough 122 on the backside of the rotor 104. The angle A is preferably in the range of 30-60 degrees and, in the preferred embodiment shown in FIGS. 8-10 is 55 degrees. Such angle A is selected to provide optimal flow-generating efficiency of the rotor 104.

In operation, it is necessary to precisely control the timing of the acceleration, deceleration, and the rotational speed, of the rotor 104 in order to generate a prescribed inspiratory pressure and/or flow rate and/or volume. Although standard manufacturing tolerances may be maintained when manufacturing the rotor 104 and other components of the compressor 30 (e.g., the rotor 104, compressor housing 106, motor 102) each individual compressor 30 will typically exhibit some individual variation of flow output as a function of the rotational speed and differential pressure of that compressor 30. Thus, in order to optimize the precision with which the inspiratory flow may be controlled, it is desirable to obtain precise flow and pressure data at various turbine speeds for each individual compressor 30, and to provide such characterization data to the controller 12 to enable the controller 12 to adjust for individual variations in the pressure and/or flow created by the particular compressor 30 in use. As a practical matter, this may be accomplished in either of two ways. One way is to generate discrete flow rate, speed and pressure measurements for each compressor 30 at the time of manufacture, and to provide a table of such discreet flow rate, speed and pressure values to the ventilator controller 12 at the time the particular compressor 30 is installed. The controller 12 will be correspondingly programmed to perform the necessary interpolative mathematical steps to obtain instantaneous flow, speed or pressure determinations as a function of any two such variables, for the particular compressor 30. The second way is to experimentally generate a series of flow, speed and pressure data points over a range of normal operating rotor speeds, and to subsequently derive a unique speed vs. flow vs. pressure equation to characterize each individual compressor 30. Such individual characterization equation is then programmed into, or otherwise provided to, the controller 12 and the controller 12 is programmed to utilize such equation to compute precise, instantaneous speed, flow rate and

pressure control signals for controlling the individual compressor **30** in use. An example of such graphical speed vs. flow rate vs. pressure data, and a characterization equation derived therefrom, is shown in FIG. **12**.

Given the current cost of microprocessor technology, providing a controller **12** which has the capability to receive and process such a characterization equation as shown in (FIG. **12**) for controlling the compressor **30** would require substantial expense and size enlargement of the controller **12**. Accordingly, given the present state of the art, it is most desirable to utilize the former of the two above-described methods—that is, providing a database of discrete flow, speed and pressure values and programming of the controller **12** to perform the necessary mathematical interpolations of the provided data points for maintaining compressor-specific control of the pressure, flow rate and/or volume of gas provided in each inspiratory phase at the ventilation cycle. The experimentally generated database of discrete flow, speed and pressure values may be encoded onto an EPROM or any other suitable database storage device. Such EPROM or other database storage device may be located on or within the compressor **30** itself and communicated to the controller **12** via appropriate circuitry. Alternatively, such EPROM or database storage device may be installed directly into the controller **12** at the time the particular compressor **30** is installed within the ventilator device **14**.

The controlled inspiratory flow generated by the rotary drag compressor **30**, exists from the compressor outlet **34** and through line **22** to the patient PT. As shown in FIG. **2**, an output silencer **60**, such as a hollow chamber having a quantity of muffling material formed therearound, is preferably positioned on inspiratory flow line **22** to reduce the sound generated by the ventilator **14** during operation. An inspiration occlusion valve **62** is additionally preferably mounted on inspiratory flow line **22** to accomplish operator controlled stoppage of the inspiratory flow as required during performance of a maximal inspiratory force maneuver. Additionally, a pressure relief valve **64** is connected to inspiratory flow line **22** to provide a safeguard against delivering excessive inspiratory pressure to the patient PT. The pressure relief valve **64** may be manually set to the desired limit pressure, by the operator.

In general, the rotary drag compressor ventilator **14** operates by periodic rotating of the rotor **130** within the compressor **30** to generate the desired inspiratory gas flow through line **22**. It is desirable that the rotor **130** be accelerated and decelerated as rapidly as possible. Such rapid acceleration/deceleration is facilitated by a reduction in inertial effects as a result of the above-described low mass construction of the rotor **104**. The speed and time of rotation of the rotor **104**, during each inspiratory phase of the ventilator cycle, is controlled by the controller **12** based on the variables and/or parameters which have been selected for triggering, limiting and terminating the inspiratory phase.

The precise flow, volume or pressure delivered through the inspiratory line **22** is controlled by the controller based on the EPROM-stored compressor characterization data received by the controller, as well as periodic or continuous monitoring of the rotational speed of the rotor and the change in pressure ( $\Delta_p$ ) between the inlet side **32** and outlet side **34** of the compressor **30** as monitored by the differential pressure transducer **36**.

In the presently preferred embodiment, the controller **12** is programmed to deliver breaths by either of two available closed loop algorithms; volume or pressure.

#### EXAMPLE

##### Volume Breaths

Prior to Volume breath initiation, the controller **12** generates a predefined command waveform of flow vs time. The

waveform is generated using the current Flow, Volume and Waveform input settings from the front panel. Since the mathematical integral of flow over time is equal to the volume delivered, the controller can determine the appropriate inspiratory time. Once a volume breath has been triggered, the controller uses closed loop control techniques well known in the art to drive the compressor, periodically read the compressor differential pressure and rotational speed, and then calls upon the specific stored compressor characterization data to arrive at the actual flow rate. Once actual flow rate is known, it is compared or “fed back” to the current commanded flow, and a resulting error is derived. The error is then processed through a control algorithm, and the compressor speed is adjusted accordingly to deliver the desired flow rate. This process is repeated continuously until the inspiration is complete.

#### EXAMPLE

##### Pressure Breaths

Pressure breaths include several breath types such as Pressure Support or Pressure Control. In these breath types, the controller commands the compressor to provide flow as required to achieve a pressure as input from the front panel.

Once a pressure breath has been triggered, the controller uses closed loop control techniques well known in the art to drive the compressor **30** and to achieve the desired patient airway pressure. The controller periodically reads the actual airway pressure. Once actual pressure is known, it is “fed back” and compared to the current commanded pressure, and a resulting error is derived. The error is then processed through a control algorithm, and the compressor speed is adjusted accordingly to deliver the desired pressure. This process is repeated continuously until the inspiration is complete.

For both breath types, once the selected inspiratory termination variable is reached, the controller will signal the compressor motor **102** to stop or decelerate to a baseline level, thereby cycling the ventilator in to the expiratory phase.

##### D. A Preferred Oxygen Blending Apparatus

When oxygen enrichment of the inspiratory flow is desired, the controller **12** may be additionally programmed or equipped to control the operation of the oxygen blending apparatus **16** to mix a prescribed amount of oxygen with ambient air drawn through air intake **24**, thereby providing an inspiratory flow having a prescribed oxygen content ( $\text{FiO}_2$ ) between 21%–100%.

As shown in FIGS. **2** and **3**, the preferred oxygen blending apparatus **16** comprises an air inlet line **24** which opens into a hollow vessel or accumulator **54**.

Oxygen inlet line **26** is connected to a pressurized source of oxygen and leads, via a manifold to a series of solenoid valves **52**. Although not by way of limitation, in the preferred embodiment as shown in FIG. **3**, five (5) separate solenoid valves **52a–52e** are utilized. Each such separate solenoid valve **52a–52e** has a specific (usually differing) sized flow restricting orifice formed therein so that each such solenoid valve **52a–52e** will permit differing amounts of oxygen to pass into accumulator **54**, per unit of time during which each such solenoid valve **52a–52e** is maintained in an open position. The controller **12** is preprogrammed to determine the specific period(s) of time each solenoid valve **52a–52e** must remain open to provide the necessary amount of oxygen to accumulator **54** to result in the prescribed oxygen concentration ( $\text{FiO}_2$ ).

21

Algorithm for a Preferred Oxygen Blending Apparatus

The rotational velocity of the rotor 104 and differential pressure across the inflow/outflow manifold 108 are measured by the controller 12 and from this data the controller 12 is able to determine the flow of gas through the compressor 30 from the accumulator 54. The controller 12 integrates the air flow drawn through the compressor 30 to determine the accumulated volume of enriched gas drawn from said accumulator 54. In order to maintain the flow of gas at the prescribed FiO<sub>2</sub> level, a portion of this removed volume must be replaced in the accumulator 54 with pure oxygen.

The accumulated volume is compared to a predetermined trigger volume for each of the solenoids 52a-52e, which in the preferred embodiment, is defined by the equation:

$$\text{Trigger Volume} = (\text{Solenoid Flow} * \text{Time} * 79) / ((\text{FiO}_2 - 21) * 2)$$

Starting with the smallest, each solenoid that is not currently open is compared. When the accumulated volume reaches the trigger volume for a solenoid 52, the controller 12 opens that solenoid 52 for a period of time allowing oxygen to flow from the oxygen inlet line 26 through the solenoid 52 and into the accumulator 54. The controller 12 then adjusts the accumulated volume appropriately by subtracting a volume, proportional to the volume of oxygen delivered to the accumulator 54 from the accumulated volume defined by the equation:

$$\text{Subtracted Volume} = (\text{Solenoid Flow} * \text{Time} * 79) / (\text{FiO}_2 - 21)$$

This process is repeated continuously.

The trigger volume the controller 12 uses to open an individual solenoid 52a-52e is independent for each solenoid 52 and is function of the flow capacity of the particular solenoid 52a-52e, the prescribed FiO<sub>2</sub> level, and the amount of time the solenoid 52 is open. In the preferred embodiment, the amount of time each solenoid 52 is open is the same for each solenoid 52, but may vary as a function of oxygen inlet pressure.

EXAMPLE

Delivery of 0.6 FiO<sub>2</sub> Using 4 Solenoids

In this example, the oxygen blending apparatus has 4 solenoids with flows of 5 lpm, 15 lpm, 40 lpm, and 80 lpm respectively. The FiO<sub>2</sub> setting is 60%, thus the trigger volumes for each of the 4 solenoids is 8 ml, 25 ml, 66 ml, and 133 ml respectively. Furthermore a constant oxygen inlet pressure is assumed resulting in an "on" time of 100 ms for the solenoids, a constant compressor flow of 60 lpm, and a period of 1 ms. The following table describes the state of the oxygen blending algorithm after various iterations:

Time (ms)	Accumulated Volume (ml)	Solenoid 1 (8 ml)	Solenoid 2 (25 ml)	Solenoid 3 (66 ml)	Solenoid 4 (133 ml)
0	0	off	off	off	off
1	1	off	off	off	off
2	2	off	off	off	off
**					
7	7	off	off	off	off
8	0	on	off	off	off
9	1	on	off	off	off
**					
32	24	off	off	off	off
33	0	on	on	off	off

22

-continued

Time (ms)	Accumulated Volume (ml)	Solenoid 1 (8 ml)	Solenoid 2 (25 ml)	Solenoid 3 (66 ml)	Solenoid 4 (133 ml)
34	1	on	on	off	off
**					
98	65	on	on	off	off
99	0	on	on	on	off
100	1	on	on	on	off
**					
107	8	on	on	on	off
108	1	off > on*	on	on	off

\*At 108 ms the 8 ml solenoid turned off after having been on for 100 ms, but since the accumulated volume is now 9 ml the solenoid is turned on again.

Thus, by independently operating the four (4) separate solenoids as shown in the above table, a 0.6 FiO<sub>2</sub> is consistently delivered through the compressor 30.

E. A Preferred Exhalation Valve and Exhalation Flow Transducer

Referring generally to FIGS. 11a-11e the preferred exhalation valve and exhalation flow transducer assembly of the present invention is depicted. By way of overview, the exhalation valve 18 comprises a housing which defines an expiratory flow path therethrough and a valving system for controlling the airway pressure during the expiratory phase of the ventilation cycle. The exhalation valve 18 shares numerous structural and functional attributes with the exhalation valve described in U.S. Pat. No. 5,127,400 (DeVries et al) entitled Ventilator Exhalation Valve, issued Jul. 7, 1994, the disclosure of which is expressly incorporated herein by reference.

In addition, the exhalation valve assembly 18 of the present invention additionally incorporates an exhalation flow transducer 230 which serves to monitor exhalation flow from the patient and generates an output signal to the controller 12. The output signal is then utilized by the controller to determine when patient exhalation has ceased to thereby initiate inspiratory flow to the patient. In the preferred embodiment, the exhalation flow transducer 230 is mounted within the exhalation valve 18 in unique structure to minimize manufacturing inaccuracies. Further, in the preferred embodiment, the particular operational characteristics of the exhalation flow transducer 230 are stored within a memory device which is then communicated to the controller 12 to insure accuracy in flow measurements. The exhalation flow transducer 230 of the present invention shares numerous structural and functional attributes with the flow transducer described in the U.S. Pat. No. 4,993,269, issued to Guillaume et al., entitled Variable Orifice Flow Sensing Apparatus, issued on Feb. 19, 1991, the disclosure of which is expressly incorporated herein by reference.

Referring more particularly to FIGS. 11a through 11e, the exhalation valve 18 of the present invention is formed having a housing 200 including an exhalation tubing connector 202 formed at a first location thereon and an outflow port 204 formed at a second location thereon. An exhalation gas flow passageway 206 extends through the interior of the housing 200 such that expiratory gas may flow from the exhalation tubing connector 202 through the exhalation passageway 206 within the interior of the exhalation valve 18 and subsequently passed out of the outflow port 204. Midway through the expiratory flow passageway 206, there is formed an annular valve seat 208. The annular valve seat 208 may be disposed in a plane which is parallel to the plane of the flat diaphragm 210 or alternatively, as in the embodi-

ment shown, the annular valve seat **208** may be slightly angled or tapered relative to the plane in which the flat diaphragm **210** is positioned. Such angling or tapering of the valve seat **208** facilitates seating of the diaphragm **210** on the valve seat **208** without flutter or bouncing of the diaphragm **210**. The elastomeric disc or diaphragm **210** is configured and constructed to initially contact the farthest extending side of the angled valve seat **208**, and to subsequently settle or conform onto the remainder of the angled valve seat **208**, thereby avoiding the potential for flutter or bouncing which may occur when the diaphragm **210** seats against a flat non-angled valve seat **208**.

The disc or diaphragm **210** is preferably attached to the surrounding rigid housing **200** by way of an annular flexible frenulum **212**. Frenulum **212** serves to hold the disc or diaphragm **210** in axial alignment with the annular valve seat **208**, while permitting the disc or diaphragm **210** to alternatively move back and forth between a closed position wherein the diaphragm **210** is firmly seated against the valve seat **208** (FIG. **11a**) and a fully open position wherein the disc or diaphragm **210** is retracted rearwardly into the adjacent cavity within the housing **200** thereby providing an unrestricted flow path **206** through which expiratory gas may flow.

A pressure distributing plate **214** is mounted on the backside of the diaphragm **210**. A hollow actuation shaft **216** is mounted within the housing **200** and is axially reciprocal back and forth to control the position of the diaphragm **210** relative the valve seat **208**. A bulbous tip member **218** is mounted on the distal end of a hollow actuation shaft **216**. A corresponding pressure distribution plate **214** is mounted on the back of the diaphragm **210**. Forward movement of the actuation shaft **216** causes the bulbous tip member **218** to exert forward pressure against the plate **214** thereby forcing the diaphragm **210** toward its closed position. When the actuation shaft **216** is in a fully forward position, the diaphragm **210** will be held in firm abutment against the annular valve seat **208** thereby terminating flow through the passage **206**. Conversely when the actuation shaft **216** is retracted, the diaphragm **210** moves away from the valve seat **208** thereby allowing flow through the passageway **206** thereby allowing flow through the passageway **206**.

The movement of the shaft **216** is controlled by way of an electrical induction coil **220** and spider bobbin **222** arrangement. In the preferred embodiment, the electrical induction coil **220** is formed without having an internal support-structure typically utilized in induction coils so as to minimize inertial concerns. In this regard, the coil **220** is typically formed by winding upon a mandrel and subsequently maintained in this wound configuration by way of application of a suitable binder or varnish. Additionally, in the preferred embodiment, the bobbin **222** is preferably formed having a cross-beam construction, as shown in FIG. **11b**, to decrease the mass of the bobbin **222** while maintaining its structural integrity. Similarly, the shaft **216** is preferably formed from a hollow stainless steel material so as to be relatively strong yet light weight enough for minimizing inertial concerns.

As shown, the bobbin **222** is affixed to the distal end of the induction coil **220** and the shaft **216** extends through an aperture formed in the center of the bobbin and is frictionally or otherwise affixed to the bobbin such that the shaft **216** will move back and forth in accordance with the bobbin **222** and coil **220**. As the current passing into the induction coil **220** increases, the coil **220** will translate rearwardly into the coil receiving space **226** about the magnet thereby moving the shaft **216** and blunt tip member **218** in the rearward direction

and allowing the diaphragm **210** to move in an open position away from the valve seat **208** of the expiratory flow path **206**. With the diaphragm **210** in such open position, expiratory flow from the patient PT may pass through the expiratory flow pathway **206** and out the expiratory port **204**.

Conversely, when the expiratory flow has decreased or terminated, the current into the induction coil may change direction, thereby causing the induction coil to translate forwardly. Such forward translation of the induction coil **220** will drive the bobbin **222**, shaft **216**, and bulbous tip member **218** in a forward direction, such that the bulbous tip member **218** will press against the flow distributing plate **214** on the backside of the diaphragm **210** causing the diaphragm to seat against the valve seat **208**. With the diaphragm **210** seated against the valve seat **208**, the inspiratory phase of the ventilator cycle may begin and ambient air will be prevented from aspirating or backflowing into the patient circuit through the exhalation port **204**.

In the preferred embodiment, a elastomeric boot **217** or dust barrier is mounted about the distal portion of the hollow actuation shaft **216**, and is configured and constructed to permit the shaft **216** to freely move back and forth between its fully extended closed position and a fully retracted open position while preventing dust or moisture from seeping or passing into the induction coil **220**.

As best shown in FIG. **11**, FIGS. **11a** and **11c**, the housing of the exhalation valve **18** includes a frontal portion formed by the housing segments **200b**, **200c**, and **200d**. An airway pressure passage **241** is provided within the housing portion **200b**, which enables the pressure within the exhalation passageway **206** to be communicated to an airway pressure tubing connector **233**. Airway pressure tubing connector **233** is connected via tubing to an airway pressure transducer **68** (shown in FIG. **2**) which monitors airway pressure and outputs a signal to the controller **12**. Based upon desired operating conditions, the controller **12**, in response of receipt of the pressure signal from pressure transducer **68** increases or decreases the voltage applied to the coil **220** to maintain desired pressure within the exhalation air passage **206**. As will be recognized, such monitoring of the airway pressure is continuous during operation of the ventilator cycle.

As previously mentioned, the exhalation flow transducer **230** of the present invention is preferably disposed with the exhalation valve housing and serves to monitor exhalation flow from the patient PT. More particular, the exhalation flow transducer **230** of the present invention preferably incorporates a feedback control system for providing real time monitoring of the patient's actual expiratory flow rate. As best shown in FIG. **11a** and **11c**, the expiratory flow transducer **230** of the present invention is incorporated within the exhalation flow path **206** within housing segment **200b**. The flow transducer **230** is preferably formed from a flat sheet of flexible material having a cut out region **406** formed therein. A peripheral portion **408** of the flat sheet exists outside of the cut out region **406** and flapper portion **231** is defined within the cut out region **406**. Frame members **410** and **412** preferably formed of a polymer material, are mounted on opposite sides of the flat sheet so as to exert inward clamping pressure on the peripheral portion **408** of the flat sheet. The flapper portion **231** of the flat sheet is thus held in its desired transverse position within the open central aperture **14a** and **14b** of the transducer assembly, and such flapper portion **231** is thus capable of flexing downstream in response to exhalation flow.

To minimize the inducement of stresses within the flow transducer assembly **230**, a frame member **411** is preferably

positioned in abutting juxtaposition to the outboard surface of at least one of the frame members **410**, **412**. In the preferred embodiment shown in FIG. **11c**, the frame member **411** is positioned in abutment with the upper frame member **410**. Such frame member **411** comprises a metal frame portion **413** and includes an elastomeric cushioning gasket or washer **415** disposed on the lower side thereof. A central aperture **414c** is formed in the frame member **411**, such aperture **414c** being of the same configuration, and in axial alignment with central apertures **414 a**, **414 b** of the upper and lower frame members **410**, **412**.

Upper and lower abutment shoulders **418a**, **418b**, are formed within the exhalation valve housing **200** to frictionally engage and hold the flow transducer assembly **230** in its desired operative position. When so inserted, the upper engagement shoulder **418a** will abut against the upper surface of the frame member **411**, and the lower abutment shoulder **418b** will abut against the lower surface of the lower frame member **412**, thereby exerting the desired inward compressive force on the flow transducer assembly **230**. As will be recognized, the inclusion of the cushioning washer **415** serves to evenly distribute clamping pressure about the peripheral portion **408**, thereby minimizing the creation of localized stress within the flow transducer **230**.

When the transducer assembly **230** is operatively positioned between the upper and lower abutment shoulders **418a**, **418b**, an upstream pressure port **232** will be located upstream of the flapper **231**, and a downstream pressure port **234** will be located downstream of the flapper **231**. By such arrangement, pressures may be concurrently measured through upstream pressure port **232** and downstream pressure port **234** to determine the difference in pressures upstream and downstream of the flapper **231**.

As expiratory gas flow passes outwardly, through the outlet port of the exhalation valve **18**, the flapper portion **231** of the flow transducer **230** will deflect or move allowing such expiratory gas flow to pass thereacross, but also creating a moderate flow restriction. The flow restriction created by the flow transducer **230** results in a pressure differential being developed across the flow transducer **230**. Such pressure differential may be monitored by pressure ports **232** and **234** disposed on opposite side of the flow transducer **230** (as shown in FIG. **11a**) which pressure ports are in flow communication by internal passages formed within the housing segment **200c**, **200b** and **200a** to tubing connections **240** and **235**. A manifold insert **201** may be mounted on the upstream pressure port **232** such that the manifold insert **201** protrudes into the expiratory flowpath **206**, upstream of the flapper **231**. A plurality of inlet apertures **201a**, preferably four in number are formed around the outer sidewall of the manifold insert **201**, and communicate through a common central passageway with the upstream pressure port **232**, thereby facilitating accurate measurement of the pressure within the expiratory flowpath **206** at that location.

An exhalation differential pressure transducer **70** (shown in FIG. **2**) may be located within the housing or enclosure of the ventilator **10**. The exhalation differential pressure transducer **70** is connected by way of tubing to the first and third pressure port tubing connectors **240** and **235** so as to continuously measure and provide the controller **12** with the difference between pressure upstream (P1) and pressure downstream (P2) of the flow transducer **230**. The difference in pressure determined by the exhalation differential pressure transducer **70** is communicated to the controller, and the controller is operatively programmed to calculate the actual flow rate at which expiratory gas is exiting the flow channel **206**. As will be recognized, the exhalation flow rate may be

utilized by the controller **12** for differing purposes such as triggering of initiation of the next inspiratory cycle.

Although the particular formation and mounting structure utilized for the exhalation flow transducer **230** provides exceptional accuracy in most situations, the applicant has found that in certain circumstances, it is desirable to eliminate any inaccuracies caused by manufacturing and assembly tolerances. As such, in the preferred embodiment, the specific operational characteristics of each exhalation flow transducer **230**, i.e., pressure differential for specific flow rates are measured for calibration purposes and stored on a storage medium contained within the exhalation valve housing **18**. In the preferred embodiment this specific characterization and calibration information is encoded on a radio frequency transponder **203** of the type commercially available under the product name Tiris, manufactured by Texas Instruments, of Austin, Tex. The radio-frequency transponder **203** and its associated transmitter/receiver antenna **203a** may be mounted within the exhalation valve housing **200** as shown in FIG. **11c**. Additionally, a radio frequency transmitter/receiver is positioned within the ventilator system **10**, such that upon command of the controller **12**, the calibration and characterization data contained within the transponder **203** is transmitted via radio frequency to the receiver and stored within the controller **12**. Subsequently, the controller **12** utilizes such stored calibration and characterization data to specifically determine expiratory flow rate based upon pressure differential values generated by the differential pressure transducer **70**.

#### F. A Preferred Auto Calibration Circuit

In the preferred embodiment, the ventilator device **14** of the ventilator system **10** of the present invention incorporates an auto calibration circuit for periodic rezeroing of the system to avoid errors in the tidal volume or inspiratory flow delivered by the drag compressor **30**.

In particular, as shown in FIG. **2** the preferred auto calibration circuit comprises the following components:

- a) a first auto-zero valve **74** on the line between the inlet **32** of the compressor **30** and the differential pressure transducer **36**;
- b) a second auto-zero valve **76** on the line between the first pressure port of the exhalation valve **18** and the first pressure (P1) side of the exhalation differential pressure transducer **70**;
- c) a third auto-zero valve **80** on the line between the second pressure (P2) port **234** of the exhalation valve **18** and the second pressure (P2) side of the exhalation differential pressure transducer **70**;
- d) a fourth auto-zero valve **78** on the line between the outlet port **34** and the differential pressure transducer **36**; and
- e) and a fifth auto-zero valve **72** on the line between the airway pressure port **241** and the airway pressure transducer **68**.

Each of the auto-zero valves **72**, **74**, **76**, **78**, **80** is connected to the controller **12** such that, at selected time intervals during the ventilatory cycle, the controller **12** may signal the auto-zero valves **72**, **74**, **76**, **78**, **80** to open to atmospheric pressure. While the auto-zero valve **72**, **74**, **76**, **78**, **80** are open to atmospheric pressure, the controller **12** may re-zero each of the transducers **36**, **68**, **70** to which the respective auto-zero valve **72**, **74**, **76**, **80** are connected. Such periodic re-zeroing of the pressure transducers **36**, **68** and **70** will correct any baseline (zero) drift which has occurred during operation.

## Ventilator Operation

With the structure defined, the basic operation of the ventilator system **10** of the present invention may be described. As will be recognized, the particular ventilatory mode selected by a technician may be input to the controller **12** via the input controls upon the display **380**. Additionally, the technician must attach the inspiratory and exhalation tubing circuit to the patient PT as illustrated in FIG. **1**.

Prior to initiation of patient ventilation, the controller **12** initiates its auto calibration circuit and system check to insure that all system parameters are within operational specifications. Subsequently, inspiration is initiated wherein the controller **12** rapidly accelerates the drag compressor **30**. During such acceleration, air is drawn through the filter **50**, accumulator **54** and supplied to the patient PT, via line **22**. During such inspiratory phase, the controller **12** monitors the pressure drop across the compressor **30**, via pressure transducer **36**, and the rotational speed of the rotor **104**. This data is then converted to flow by the controller **12** via the turbine characterization table to insure that the proper flow and volume of inspiratory gas is delivered to the patient PT. Additionally, during such inspiratory phase, the exhalation valve **18** is maintained in a closed position. In those applications where oxygen blending is desired, the controller **12** additionally opens selected ones of the solenoid valve **52a**, **52b**, **52c**, **52d** and **52e**, in timed sequence to deliver a desired volume of oxygen to the accumulator **54**, which is subsequently delivered to the patient PT during inspiratory flow conditions.

When inspiratory flow is desired to be terminated, the controller **12** rapidly stops or decelerates the drag compressor **30** to a basal rotational speed, and the patient is free to exhale through exhalation line **66** and through the exhalation valve **18**. Depending upon desired ventilation mode operation, the controller **12** monitors the exhalation pressure, via pressure transducer **68** connected to the airway passage and adjusts the position of the valve relative the valve seat within the exhalation valve **18** to maintain desired airway pressures. Simultaneously, the controller **12** monitors the pressure differential existing across the exhalation flow transducer **230** via exhalation pressure transducer **70** to compute exhaled flow. This exhaled flow is used to compute exhaled volume and to determine a patient trigger. When a breath is called for either through a machine or patient trigger, the controller initiates a subsequent inspiratory flow cycle with subsequent operation of the ventilator system **10** being repeated-between inspiratory and exhalation cycles.

Those skilled in the art will recognize that differing ventilation modes, such as intermittent mandatory ventilation (IMV), synchronized intermittent mandatory ventilation (SIMV) controlled mechanical ventilation (CMV) and assist control ventilation (A/C), are all available modes of operation on the ventilator **10** of the present invention. Further those skilled in the art will recognize that by proper selection of control inputs to the ventilator **10**, all modern breath types utilized in clinical practice, may be selected, such as machine cycled mandatory breath, machine cycled assist breath, patient cycled supported breath, patient cycled spontaneous breath, volume controlled mandatory breaths, volume controlled assist breaths, pressure controlled breaths, pressure support breaths, sigh breaths, proportional assist ventilation and volume assured pressure support.

What is claimed is:

1. A rotary drag compressor ventilator device for ventilating the lungs of a mammalian patient, said device comprising:

A. a rotary drag compressor comprising:

- i. a housing having a gas inflow passageway and a gas outflow passageway;
- ii. a rotor mounted within said housing, said rotor having a multiplicity of blades formed circularly therearound such that, when said rotor is rotated in a first direction, said blades will compress gas within said housing and expel said compressed gas out of said outflow passageway;
- iii. a motor coupled to said compressor for rotating said rotor within said compressor housing; and

B. a controller apparatus to intermittently accelerate and decelerate the rotation of said rotor in accordance with desired flow rate and pressure of inspiratory gas and in accordance with stored individualized compressor characterization information so as to deliver discrete periods of inspiratory gas flow at said flow rate and pressure through said outflow passageway.

2. The ventilator of claim **1**, further in combination with:

C. an oxygen blending apparatus connected to said inflow passageway for blending oxygen with ambient air to provide oxygen-enriched air to the inlet aperture of said compressor housing.

3. The ventilator of claim **2** wherein said oxygen blending apparatus comprises:

- an ambient air receiving passageway;
- an oxygen receiving passageway;
- an accumulator for receiving ambient air through said ambient air passageway and oxygen through said oxygen passageway; and,

a series of independently actuatable solenoid valves positioned, in parallel, within the oxygen receiving passageway of said bending apparatus, each of said solenoid valves having a predetermined flow rate when fully open, each of said solenoid valves thereby permitting passage therethrough of a predetermined amount of oxygen per time period; and,

said oxygen blending apparatus being connected to said controller and said controller being further programmable to receive input of a desired oxygen concentration setting and to emit control signals to the solenoid valves to cause individual opening and closing of said solenoid valves to result in said desired oxygen concentration within said accumulator.

4. The ventilator system of claim **3** wherein said solenoid valves comprises three to five separate solenoid valves.

5. The ventilator system of claim **3** wherein said controller is programmed to apply a pulse-width modulation signal to control the opening and closing of said solenoid valves.

6. The ventilator of claim **1** wherein said controller comprises at least one microprocessor.

7. The ventilator of claim **1** wherein said compressor rotor comprises a dual-faced compressor rotor having first and second series of blades mounted opposite sides thereof; and, wherein said compressor housing is configured to define first and second compressor flow paths which are positioned in relation to said first and second series of blades, respectively, such that rotation of said compressor rotor in said first direction will a) draw gas into said inflow passageway, b) concomitantly compress and move gas through both of said first and second flow paths and, c) expel the combined gas from said first and second compressor flow paths to compressor flow paths to provide inspiratory gas flow from said ventilator device.

8. The ventilator of claim **7** wherein said compressor rotor is round in configuration and has a diameter of 2-6 inches.



## 29

9. The ventilator of claim 7 wherein said blades are disposed at angles of attack of 30–60 degrees.

10. The ventilator of claim 9 wherein said blades are disposed at 55° angles of attack.

11. The compressor of claim 7 wherein said blades are mounted within concave annular troughs formed on opposite sides of said dual-faced compressor rotor and wherein said first and second compressor flow paths are formed in relation to said first and second annular troughs such that the series of blades mounted within the first annular trough will compress gas within said first compressor flow path and the series of blades mounted within said second trough will compress gas within said second compressor flow path.

12. The ventilator of claim 7 wherein rotor, including said blades, had a mass of less than 40 grams.

13. The ventilator of claim 7 wherein said rotor further comprises:

the convex rotor hub having a central transverse motor shaft receiving aperture formed therein, to facilitate rotation of said rotor by said motor.

14. The ventilator of claim 7 wherein said rotor is formed of molded material.

15. The ventilator of claim 7 wherein said blades are formed of aluminum.

16. The ventilator of claim 7 wherein approximately 30–40 blades are positioned on either side of said rotor.

17. The ventilator of claim 1 further comprising:

a differential pressure transducer for measuring the difference in pressure between gas entering the inlet of said compressor and gas exiting the outlet of said compressor.

18. The ventilator of claim 1 further comprising:

a tachometer for measuring the rotational speed of said compressor.

19. The ventilator of claim 18 wherein said tachometer comprises an optical encoder.

20. The ventilator of claim 1 further comprising:

a differential pressure transducer for measuring the difference in pressure between gas entering the inlet of said compressor and gas entering the outlet of said compressor;

a tachometer for measuring the rotational speed of said compressor; and

said differential pressure transducer and said tachometer being in communication with said controller; and

said controller being programmed to determine the instantaneous flow rate and current accumulated volume of inspiratory gas flow delivered by said ventilator based on the pressure differential measured by said differential pressure transducer and the rotational speed measured by said tachometer.

21. The ventilator of claim 1 wherein said compressor incorporates a controller-readable data base containing specific rotational speed, differential pressure and flow rate data for that particular compressor; and

wherein said controller is further programmed to read said data base and to utilize information obtained from said data base in the calculation of inspiratory flow, volume or pressure delivered by said ventilator.

22. The ventilator of claim 21 wherein said controller-readable data base comprises an EPROM.

23. The ventilator of claim 1 further in combination with a portable battery for supplying power to said device.

24. The ventilator of claim 23 wherein said portable battery contains sufficient power to operate said mechanical ventilator device for at least two hours.

## 30

25. A drag compressor apparatus for creating inspiratory gas flow in a mechanical ventilator, said compressor apparatus comprising:

a housing having a gas inflow passageway and a gas outflow passageway;

a rotor rotatably mounted within said housing, said rotor being configured and constructed such that rotation of said rotor in a first direction will cause said rotor to a) draw gas in said inflow passageway, b) compress said gas and c) expel said gas out of said outflow passageway;

a controller for controlling the rotation of said rotor within said housing, said controller being operative to cause said rotor to intermittently accelerate and decelerate in accordance with desired flow rate and pressure of inspiratory gas and in accordance with stored individualized compressor characterization information so as to deliver discrete periods of inspiratory gas flow at said flow rate and pressure through said outflow passageway.

26. The compressor of claim 25 wherein said rotor incorporates at least one series of blades having leading edges, each of said blades being disposed at a positive angle of attack such that, when said rotor is rotated in said first direction, the leading edge of each blade will precede the remainder thereof.

27. The compressor of claim 26 wherein said blades are disposed at angles of attack of 30–60 degrees.

28. The compressor of claim 27 wherein said blades are disposed at 55 degree angles of attack.

29. The compressor of claim 26 wherein said blades are disposed at spaced intervals within an annular trough which extends about said rotor such that, when said rotor is rotating said first direction, said blades will serially contact and compress gas within said housing.

30. The compressor of claim 29 wherein said housing is further configured to define therewithin at least one compressor flow path said flow path being positioned in relation to said annular trough and being connected to said inflow and outflow passageways such that, when said rotor is rotated in said first direction, the blades of said rotor will a) draw gas inwardly through said inflow passageway into said compressor flow path, b) compress said gas within said compressor flow path, and c) expel said gas out of said outflow passageway.

31. The compressor of claim 30 wherein each of said blades has a leading edge and at least one peripheral edge, and wherein said blades are mounted within said trough such that the leading edges of the blades extend transversely across the trough and the peripheral edge of said blades are in abutment with said trough.

32. The compressor of claim 30 wherein said at least one concave annular trough comprises:

a first annular trough which extends about the periphery of said rotor on a first side thereof; and,

a second annular trough which extends about the periphery of said rotor on a second side thereof.

33. The compressor of claim 32 wherein said housing is configured to define therewithin:

a first compressor flow path which is at least partially within said first annular trough and is connected to said inflow passageway and said outflow passageway; and,

a second compressor flow path which is at least partially within said second annular trough and is connected to said inflow passageway and said outflow passageway; said first and second compressor flow paths being configured and positioned such that, when said rotor is

## 31

rotated in said first direction, the blades mounted within said first annular trough will draw gas into said inflow passageway, compress said gas within said first flow path, and expel said gas out of said outflow passageway and the blades mounted within said second annular trough will draw gas into said inflow passageway, compress said gas within said second flow path, and expel said gas out of said outflow passageway.

34. The compressor of claim 33 wherein said first concave trough and the blades mounted therewithin are mirror images of said second concave trough and the blades mounted therewithin.

35. The compressor of claim 25 further comprising a drive motor located within said compressor housing and coupled to said rotor to rotatably drive said rotor.

36. The compressor of claim 35 further comprising a tachometer for measuring the rotational speed of said rotor.

37. The compressor of claim 36 wherein said tachometer comprises an optical encoder.

38. The compressor of claim 25 wherein said housing further comprises a number of heat dissipation fins formed on the outside of the portion of said housing wherein said motor is positioned to facilitate dissipation of heat from said motor.

39. A method of providing pulmonary ventilation to a mammalian patient, said method comprising the steps of:

- a) providing a rotary drag compressor device comprising:
  - i) a housing having an inflow passageway and an outflow passageway formed therein;
  - ii) a rotor rotatably mounted within said housing such that rotation of said rotor in a first direction will draw gas into said inflow passageway, compress said gas, and expel said gas out of said outflow passageway;
  - iii) a controller for controlling the rotation of said rotor within said housing, said controller being operative to cause said rotor to intermittently accelerate and decelerate in accordance with desired flow rate and pressure of inspiratory gas and in accordance with stored individualized compressor characterization information so as to deliver discrete periods of inspiratory gas flow at said flow rate and pressure through said outflow passageway;
- b) connecting the outflow passageway of said rotary drag compressor to a conduit through which respiratory gas flow may be passed into lungs of the patient;
- c) accelerating said rotor to a first rotational speed for sufficient time to deliver in accordance with desired flow rate and pressure a desired inspiratory gas flow through said conduit at said flow rate and pressure and into the lungs of the patient;
- d) stopping said rotor or decelerating said rotor to a basal rotational speed to terminate the inspiratory gas flow through said conduit and to allow an expiratory phase of a ventilation cycle to occur.

40. The method of claim 39 wherein step b comprises connecting said outflow passageway to an endotracheal tube inserted into the trachea of the patient.

41. The method of claim 39 wherein step b comprises connecting said outflow passageway to a nasotracheal tube inserted into the trachea of the patient.

42. The method of claim 39 wherein step b comprises connecting said outflow passageway to a tracheostomy tube inserted into the trachea of the patient.

43. The method of claim 39 wherein step b comprises connecting said outflow passageway to a mask which is positioned over the nose and mouth of the patient.

## 32

44. The method of claim 39 wherein step c is commenced upon the occurrence of a triggering event, said triggering event being selected from the group of triggering events consisting of:

- i) the passing of a predetermined time period; and
- ii) the initiation of spontaneous inspiratory effort by the patient.

45. The method of claim 39 wherein the inspiratory gas flow delivered in step c is limited by a limiting parameter selected from the group of limiting parameters consisting of:

- i. a predetermined minimum airway pressure;
- ii. a predetermined maximum airway pressure;
- iii. a predetermined minimum flow rate;
- iv. a predetermined maximum flow rate;
- v. a predetermined minimum tidal volume; and
- vi. a predetermined maximum tidal volume.

46. The method of claim 39 wherein step c is terminated and step d is commenced upon the occurrence of a selected terminating event, said terminating event being selected from the group of terminating events consisting of:

- i. the passing of a predetermined period of time since the commencement of step c;
- ii. the attainment of a predetermined airway pressure; and
- iii. the passage of a predetermined tidal volume of inspiratory gas.

47. The method of claim 39 wherein step c further comprises controlling the speed to which said rotor is accelerated during the inspiratory phase by:

- i. storing specific rotor speed, compressor differential pressure and flow rate characterization data for the compressor;
- ii. providing a first input signal to said compressor which is intended to cause the rotor to rotate at a speed calculated to deliver a desired flow rate;
- iii. determining the actual flow rate generated by said compressor in response to said first input signal;
- iv. comparing the actual flow rate determined in step iii, to the desired flow rate;
- v. adjusting the input signal to said compressor to provide the desired flow rate.

48. The method of claim 42 wherein step c further comprises:

- vi. repeating steps ii–v, as necessary to achieve said desired flow rate.

49. A rotary drag compressor ventilator device for delivering inspiratory gas flow to a mammalian patient, said device comprising:

- a) a rotary drag compressor having an intake port and an outflow port;
- b) an inspiratory gas flow passageway for carrying gas from the outflow port of the compressor to the patient during an inspiratory phase of a ventilation cycle;
- c) means for accelerating said compressor at the beginning of the inspiratory phase of the ventilation cycle to deliver inspiratory gas flow through said passageway to said patient;
- d) means for controlling said compressor during the inspiratory phase of the ventilation cycle to maintain a desired inspiratory pressure and flow rate in accordance with stored individualized compressor characterization information; and
- e) means for decelerating said compressor at the end of the inspiratory phase of the ventilation cycle.

33

50. The ventilator device of claim 49 wherein said inspiratory gas flow passageway is devoid of valves for diverting the inspiratory gas flow away from said patient.

51. The ventilator device of claim 49 wherein said rotary drag compressor comprises:

a compressor housing having said intake and outflow ports formed therein;

a rotor mounted within said housing such that rotation of said rotor in a first direction will cause said inspiratory gas flow to be delivered out of said outflow port and through said inspiratory gas flow passageway to said patient; and,

a motor for rotating said rotor within said housing.

52. The ventilator device of claim 49 wherein said means for accelerating, controlling and decelerating said compressor comprise:

a microprocessor controller connected to said compressor.

34

53. The ventilator device of claim 49 further comprising:

f) an exhalation conduit for carrying expiratory gas flow from said patient during the expiratory phase of the ventilation cycle;

g) an exhalation valve positioned on said exhalation conduit, said exhalation valve being constructed to:

i) open during the expiratory phase of the ventilation cycle to permit the expiratory gas flow to pass out of said exhalation conduit, and

ii) close during the inspiratory phase of the ventilation cycle to prevent gas from being drawn into said patient through said exhalation conduit.

54. The ventilator device of claim 49 further comprising:

f) an oxygen blending apparatus connected to said intake port to provide oxygen-enriched air to said compressor.

\* \* \* \* \*