



Service Manual

INDEX

| <u>Sno.</u> | <u>Detail</u> | <u>Page No.</u> |
|-------------|--|-----------------|
| 1 | Model Range | 2 |
| 2 | Feature /Technical specification | 5 |
| 3 | Controls & Electronic configuration | 6 |
| 4 | Wiring Diagram | 7 |
| 5 | Controlling the refrigerator temperature | 9 |
| 6 | Service Process | 10 |
| 7 | Exploded view | 18 |
| 8 | Serviceable Parts List | 30 |
| 9 | Plug Pin Check Points | 33 |

1. MODEL RANGE

| Commercial Code | IRIBT26WA | IRIBT29MB |
|---------------------|---|--|
| 12NC | 852460153230 | 852460153240 |
| 13EAN AUS | 9320921075347 | 9320921075446 |
| Product Description | IKEA 260LT WHITE TOP MOUNT REFRIGERATOR | IKEA 290LT STAINLESS TOP MOUNT REFRIGERATOR |
| Ikea Details | LAGAN fridge/freezer176/57Lwhite AU | ENERGISK fridge/freezer 202/57L silver colour AU |
| Ikea Article # | 00275532 | 20275531 |

Safety precautions and warnings

Read all instructions before using this appliance in order to avoid risk of accident or possible damage.

Warning / Caution



Warning

This symbol is intended to alert the user to the possible death or injury.



Caution

This symbol is intended to alert the user to the possible injury or damage.

Description of symbols



Indicates prohibition



Do not disassemble



Do not contact



Adhere the instruction strictly



Unplug from the electrical outlet



Earth the appliance to avoid the risk of an electric shock.



Warning

Do not plug multiple electric appliances into the same outlet.

This may cause abnormal heating or fire hazard.



Prohibition

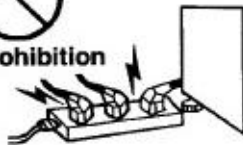

Do not disassemble repair or alter.

It may cause fire or abnormal operation which leads to injury.



Do not disassemble

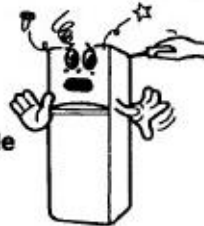

Do not bend the power cord with excessive force or do not have the power cord pressure by heavy article.

This may cause fire.



Check the operating environment

Do not install the refrigerator in a humid (with condensation) location or an unstable surface.

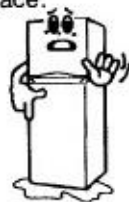

Be sure to earth.

If earthing is not done, it will cause break down and electric shock.



Earth

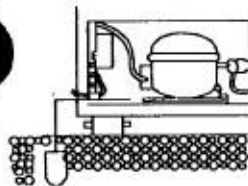

Pull the power plug out for exchanging the interior lam of the refrigerator.

It may cause electric shock



Unplug

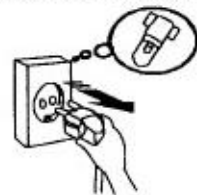



Caution

Do not store bottled food or drinks in the freezing compartment.

Bottles may explode causing personal injury.



Prohibition



Do not store food in unstable manner.

Opening the door may trigger loose items to slip & cause injury.



Prohibition



Do not store anything other than food in the refrigerator.

Medical supplies, which need to be under strict temperature control, should not be stored in the refrigerator.



Prohibition



Do not put on top of the refrigerator.

Opening or closing the door may trigger the loose items to slip & cause injury.



Prohibition



When replacing electric components, be sure to use rated components.

Check the model, rated voltage, rated current, operating temperature etc. of the component.



When servicing the refrigerator completely remove dust or foreign substances from the housing, electric connections etc.

This can protect against the risk of fire hazard caused by tracking and short circuit.



Please wipe out foreign materials of the metal option of power plug cleanly.

Use of it as it is may cause fire.



After servicing the refrigerator be sure to check the components are reassembled in a correct manner.

The service unit should be reassembled & return to its original assembly state.



Check electrical ports for the trace of moisture penetration.

When the trace of moisture penetration is detected, insulation tapping.



Unplug

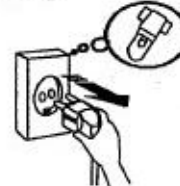

2. TECHNICAL /FEATURE SPECIFICATION

| MODEL | 260L IRIBT26WA | 290L IRIBT29MB |
|---|--------------------------|--------------------------|
| Type | Frost Free | Frost Free |
| Capacities (L) total net | 260 L | 290L |
| Product Dimensions (mm) | | |
| Width | 569 | 569 |
| Height | 1587 | 1714 |
| Depth | 640 | 640 |
| Gross Weight (kg) | 56 | 60 |
| Voltage / Hz | 220V /240V/50Hz | 220V /240V/50Hz |
| Voltage Range | 160-260V | 160-260V |
| Compressor | ADW66AK | ADW66AK |
| Oil Capacity | 220 cu.cm | 220 cu.cm |
| Comp. Run Capacitor | CBB60 | CBB60 |
| PTC Relay | YES | YES |
| Motor Protector | YES | YES |
| Fan motor | MI AC MOTOR FOR DUO 9.8W | MI AC MOTOR FOR DUO 9.8W |
| Compressor Wattage | 120 W | 120 W |
| Split Diffuser | NO | NO |
| Deodorizer | Yes | Yes |
| Number of Shelves | 3 | 3 |
| Type of Shelves | Glass | Glass |
| Humidity Control | NO | NO |
| RC Illumination | Illumination by Lamp | Illumination by Lamp |
| FC Illumination | NO | NO |
| Packet Separator | NO | NO |
| Bottle separator | YES | YES |
| Defrost tray (Thaw zone) | NO | YES |
| Can rack | NO | NO |
| Handle | FLUSH | FLUSH |
| Egg tray | 1 No. | 1 No. |
| Removable ice twister | YES | YES |
| Thaw zone shelf | NO | YES |
| RC Shelf | YES | YES |
| Freezer Door Bins | 2 | 2 |
| Refrigerator Door Bins | 3 | 3 |
| FC SHELF | YES | YES |
| Door lock | NO | NO |
| Roof Rail | NO | NO |
| Cabinet Stopper | YES | YES |
| Beer caddie | NO | YES |
| Electromechanical Control in RC compartment | YES | YES |
| Quick Chill/Fast Forward Cool Operation | NO | NO |
| Door Alarm | NO | NO |
| Auto Power save mode | NO | NO |
| Health Hygiene Benefit | YES | YES |
| EGA to celebrate Health plank | NO | NO |

3. **Electronic Configuration, Logic & Troubleshooting**
 • **GENX Controls & Electronics Configuration**

| Product Configuration | 240/260/290L Dlx |
|-------------------------------------|------------------------------------|
| Product Control | RC Controlled |
| Software | No |
| User interface | No |
| Auto cool mode | No |
| Quick Chill/Fast Forward Ice | No |
| Auto Power save mode | No |
| Door Alarm | NO |
| RC Illumination | Yes(Lamp) |
| Control Board | NO |
| Defrost heater | Yes (Radiant Heater 180 W) |
| Fan motor | FAN MOTOR MI (160-260V) |
| FC Door grounding | No |
| Compressor | ADW66AK |
| Run Capacitor | No |
| Door Reversibility | No |

| | |
|-----------------------------|------------------------------|
| RATED VOLTAGE : | 220-240V,50-60Hz, IPH |
| VOLTAGE RANGE : | 160V – 260V |
| INPUT WATTAGE : | 120W |
| DEFROST WATTAGE : | 180W |
| RATED CURRENT AMPS : | 0.7A |

DELUX: - In this type of refrigerator, there is no user Interface on freezer compartment door for setting cooling .There is a thermostat in RC compartment to set temp settings.

4. Wiring Diagram

• GENX Dlx

WIRING DIAGRAM

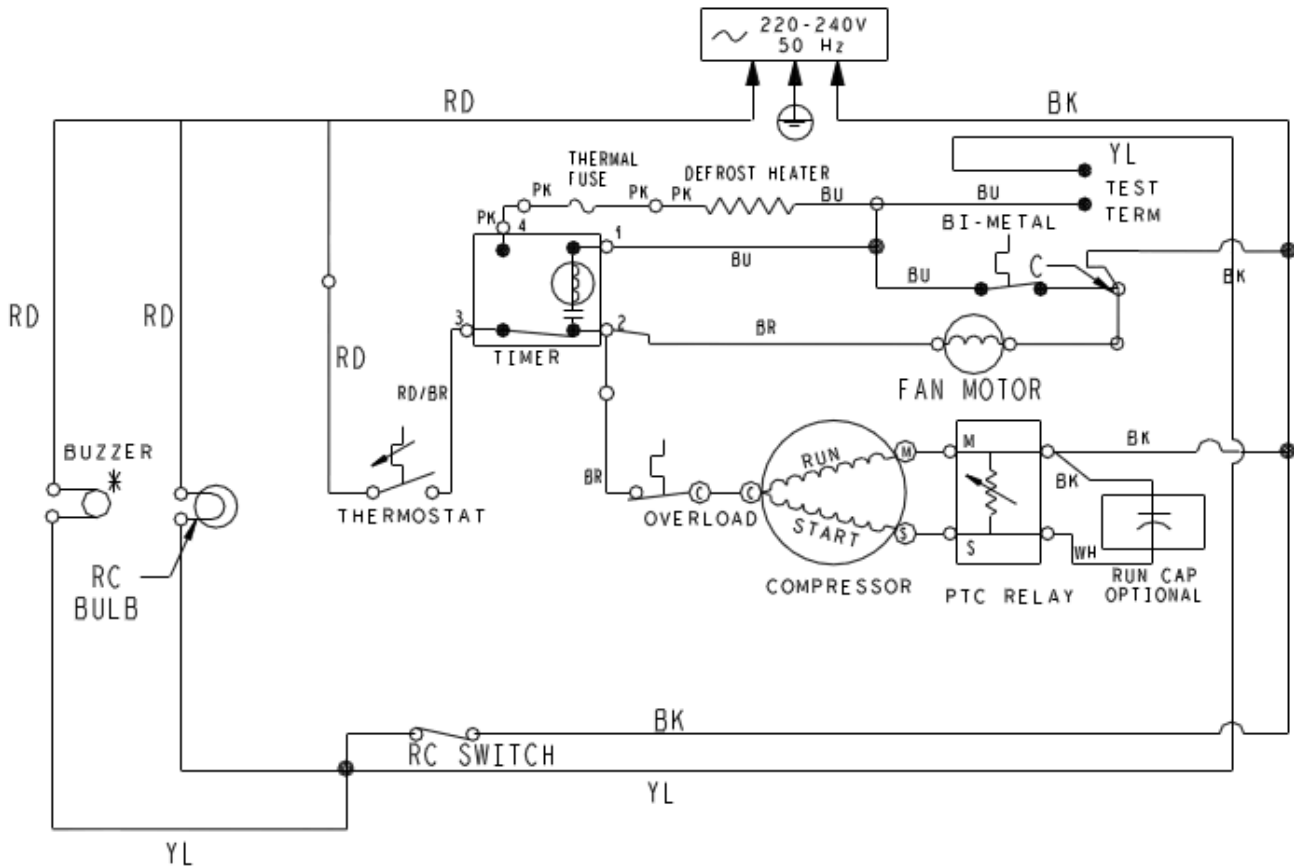

SYMBOL CODE

- ⊙ : CONNECTOR - SCREW ON
- ⊙ : CONNECTOR - CLOSED END
- : DISCONNECT TERMINAL
- : PERMANENT CONNECTION
- ⋈ : PLUG CONNECTOR
- ⊕ : GROUND (CHASSIS)
- * : IF REQUIRED

WIRE COLOR CODE



- GN = GREEN
- BU = BLUE
- BK = BLACK
- RD = RED
- WH = WHITE
- YL = YELLOW
- BR = BROWN
- PK = PINK
- RD/BR = RED/BROWN TRACER
- BR/BK = BROWN/BLACK TRACER

Refrigerant Charging Qty:

| NAME | MODELS | GROSS CAPACITY | NET CAPACITY | REFRIGERANT R134o(CH ₂ FCF ₃)Kg |
|------------|-----------|----------------|--------------|---|
| | | | | ADW66AK |
| GEN·X AUST | IRIBT26WA | 260L | 230L | 0.125 |
| | IRIBT29MB | 290L | 260L | 0.125 |

This product contains
R134a

**Do Not service with R12,
Follow only Approved R134a
service procedure & a
Qualified technician, while
repairing.**

| | | |
|---|---|--|
|  |  WARNING | AVOID ELECTRICAL SHOCK. Follow recognized safety procedures and servicing instructions. |
| | <ul style="list-style-type: none">★ Disconnect power before servicing.★ If refrigerant leak is suspected around compressor terminal, relieve all pressure from system, keeping terminal cover in place.★ Replace all panels before operating, failure to do so can result in death or electrical shock. | <ul style="list-style-type: none">★ To avoid electrical shock hazard, this product must be grounded. Any ground wire disconnected during service must be reconnected.★ Do not reconnect unit to electrical supply until compressor terminal cover is securely in place. |

| | | |
|---|--|--|
|  | ⚠ WARNING | |
| | Electrical Shock Hazard | |
| | Disconnect power before servicing. Any ground circuit disconnected during service must be reconnected. Do not reconnect unit to electrical supply until compressor terminal cover is securely in place. If refrigerant leak is suspected around compressor terminal, relieve all pressure from the system, keeping terminal, cover in place. Failure to do so can result in death or electrical shock. | |

Note: -

- There is no Service routine provided in this model.
- In Dlx models Diagnosis of the Error / Sensor / Pot failure is not of continuous nature.
- In case of any detailed technical information please check with the Dlx technical specification.

5. Controlling the refrigerator temperature-

Dlx Models:

Temperature Control



To control the temperature of your refrigerator. Turn the knob according to your requirement. This control is provided inside the refrigerator section. Turn knob to the left to reduce the cooling and to the right to increase the cooling. It is preset to the middle position.

| SETTING | Usage condition |
|------------|---|
| LOW | During Winter condition or when there is not much food stored in the refrigerator |
| MID | This is the default and recommended setting. Can be used in normal usage. |
| HIGH | During summers or when there is a lot of food stored in the refrigerator |
| QUICKCHILL | During extreme summers or when you want faster cooling. |

6. Service Process:-

1. Separate FC door from refrigerator
2. Use 8mm round spanner and remove three screws of center hinge
3. Remove Center Hinge
4. Pick the RC door upward and separate from refrigerator



FC PLENUM:-

1. Identify 2 screws of FC Plenum
2. Use Star screw driver and remove 2 screws of FC Plenum
3. Pull plenum down by inserting your fingers in the slot located at top center
4. Disconnect fan motor connectors
5. Separate FC Plenum from refrigerator
6. FC Plenum is mandatory to dismantle for dismantling of Thermal fuse, Bimetal, FC sensor, D heater etc.



INTERIOR PARTS OF FC PLENUM :-

1. Separate FC Plenum from refrigerator
2. Remove LHS EPS block
3. Remove RHS EPS block
4. Disconnect Thermal Fuse
5. Disconnect Bi metal
6. Disconnect FC sensor.

Precaution : All the components present interior to FC plenum must be fitted at their original location.



FAN MOTOR:-

1. Use star screw driver and open three screws of fan motor bracket fitted on plenum at back side.
2. Separate fan motor bracket
3. Use star screw driver to remove single screw of fan motor
4. Separate fan motor bracket cover
5. Pull the fan blade out
6. Separate fan blade from fan bracket
7. Separate Fan motor from refrigerator
- 8.



DEFROST HEATER:-

1. Separate FC Plenum from refrigerator
2. Disconnect Heater terminals
3. Pull out cooling coil slightly upwards and towards your side
4. Remove LHS and RHS EPS blocks
5. Remove Thermal Fuse
6. Take the black wire (thin) out
7. Take the white wire (thick) out
8. Cut white wire of defective heater at by wire cutter
9. Separate defrost heater from the machine

Note – All the models above 400L carries 200W integrated heater with evaporator. Need to remove as an assembly.
Part Code A2242730000



DIFFUSER ASSEMBLY:-

1. Pull out the lens cover and bulb holder
2. Use star screw driver and remove 2 screws
3. Pull out assembly slightly from bottom (ensure 2 inserters will come out properly)
4. Pull out thermostat knob
5. Disconnect thermostat connector
6. Separate diffuser assembly from refrigerator.



INTERIOR PARTS OF DIFFUSER ASSEMBLY:-

- Thermostat

- Defrost Timer

1. Disconnect thermostat connectors
2. Separate thermostat from machine
3. Remove deodorizer cover
4. Use star screw driver and remove 1 screw
5. Disconnect D Timer connectors
6. Separate D Timer from refrigerator

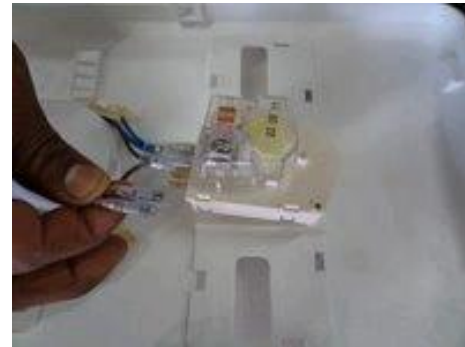

BOTTOM HINGE:-

1. Use 8mm round spanner and open 2 screws from front side
2. Tilt the machine slightly at back side
3. Open 2 screws from bottom side
4. Separate bottom hinge from machine



COMPRESSOR MOUNTING PLATE:-



7. Exploded View:-

| SR NO | LOCATION | PART NO | DISCRIPTION |
|-------|------------------|-----------|---------------------------------------|
| 1 | CABINAT EXTERIOR | W10507748 | TOP HINGE COVER NEO-DLX WHITE |
| 2 | CABINAT EXTERIOR | W10463885 | TOP HINGE COVER NEO-DLX CHARCOAL GRAY |
| 3 | CABINAT EXTERIOR | W10418501 | SCREW- TRILOBULAR M6X1.0 HEX HEAD |
| 4 | CABINAT EXTERIOR | W10444351 | HINGE TOP ASSY- DLX |

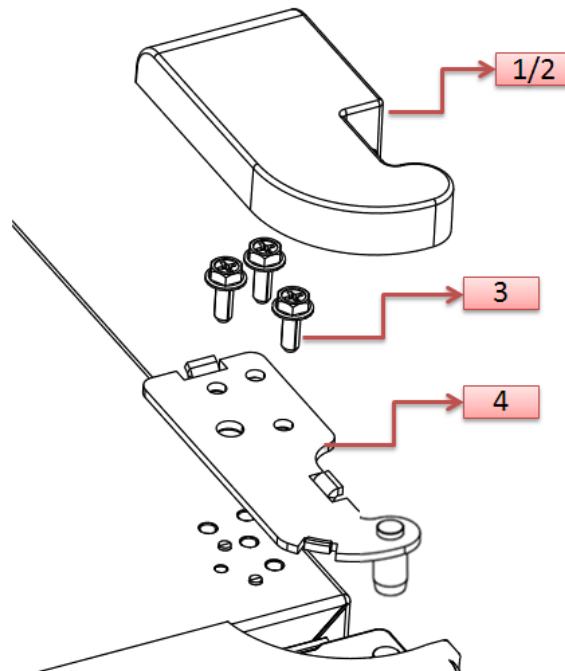

| | | | |
|---|------------------|-----------|----------------------------------|
| 5 | CABINAT EXTERIOR | W10426650 | CENTRE HINGE ASSY- L60 |
| 6 | CABINAT EXTERIOR | W10479958 | CAP - CENTER RAIL WHITE TRINITY |
| 7 | CABINAT EXTERIOR | W10478024 | SCREW-TRILOBULAR M6X1.0 HEX HEAD |

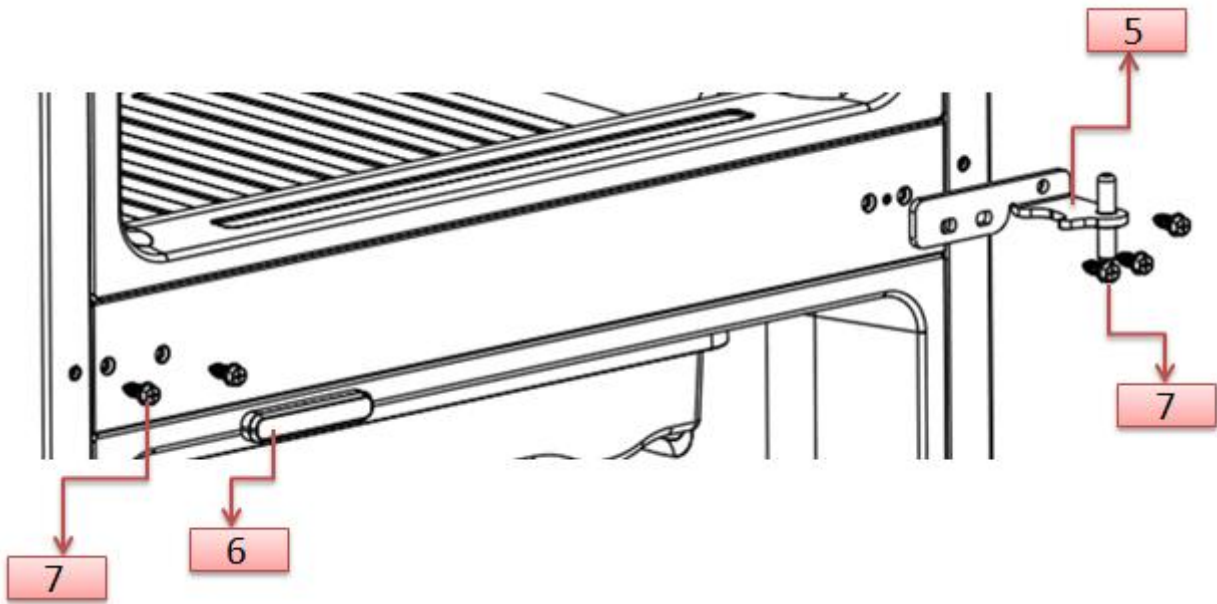

| | | | |
|----|------------------|-------------|------------------------------|
| 8 | CABINAT EXTERIOR | W10528520 | PLATE LEVELLER ASSEMBLY,GENX |
| 9 | CABINAT EXTERIOR | A201354000D | PHILIPS HEAD SCREW M5.5X1.8 |
| 10 | CABINAT EXTERIOR | W10528523 | HINGE BOTTOM ASSEMBLY, GENX |

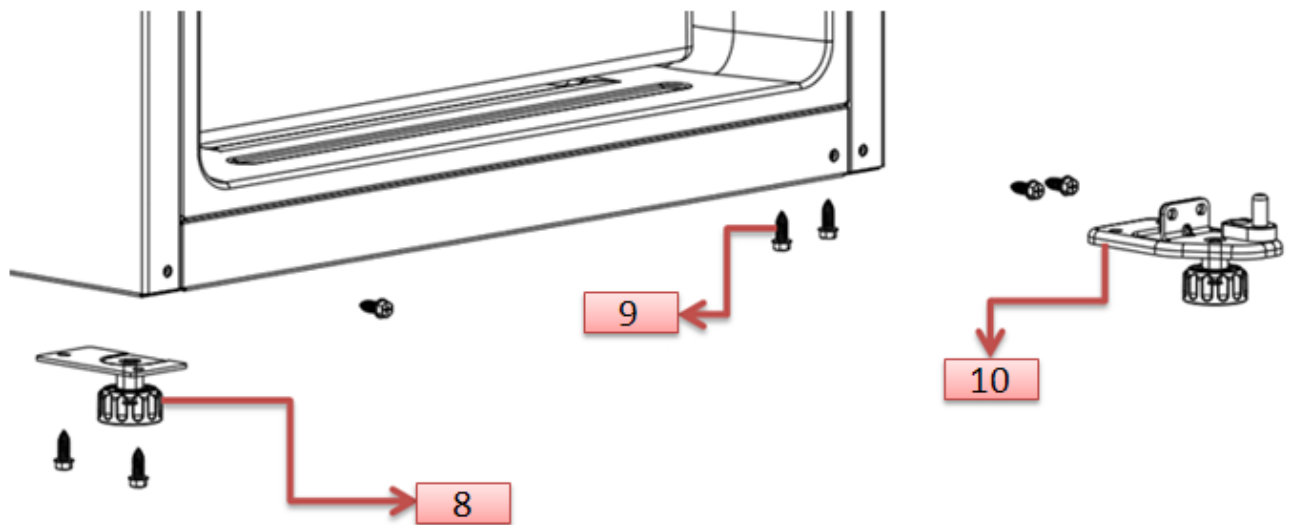

| | | | |
|----|------------------|-------------|--|
| 11 | FC DOOR | W10533610 | FC FOAMED DOOR WHITE GENX-2 FLUSH H |
| 12 | FC DOOR | W10533611 | FC FOAMED DOOR REAL STEEL GENX-2 FLUSH |
| 13 | FC DOOR EXTERIOR | W10391355 | NAMEPLATE-WP,WHT |
| 14 | FC DOOR EXTERIOR | W10412075 | HANDLE FC FRONT FLUSH WHITE |
| 15 | FC DOOR EXTERIOR | W10477284 | HANDLE FC FRONT FLUSH EXPO WARM SILVER 2 |
| 16 | FC DOOR EXTERIOR | W10511612 | HANDLE FC BACK FLUSH WHITE |
| 17 | FC DOOR EXTERIOR | W10412074 | HANDLE FC BACK FLUSH CHARCOAL GRAY |
| 18 | FC DOOR EXTERIOR | W10519257 | SHOULDER SCREW BT TYPE |
| 19 | FC DOOR EXTERIOR | W10426602 | STOP DOOR, RH - ONYX |
| 20 | FC DOOR EXTERIOR | A2241310000 | SCREW-CSK HEAD 4.8, DOOR STOPER-ONYX |
| 21 | FC DOOR EXTERIOR | W10467948 | SLEEVE TOP HINGE - ONYX |

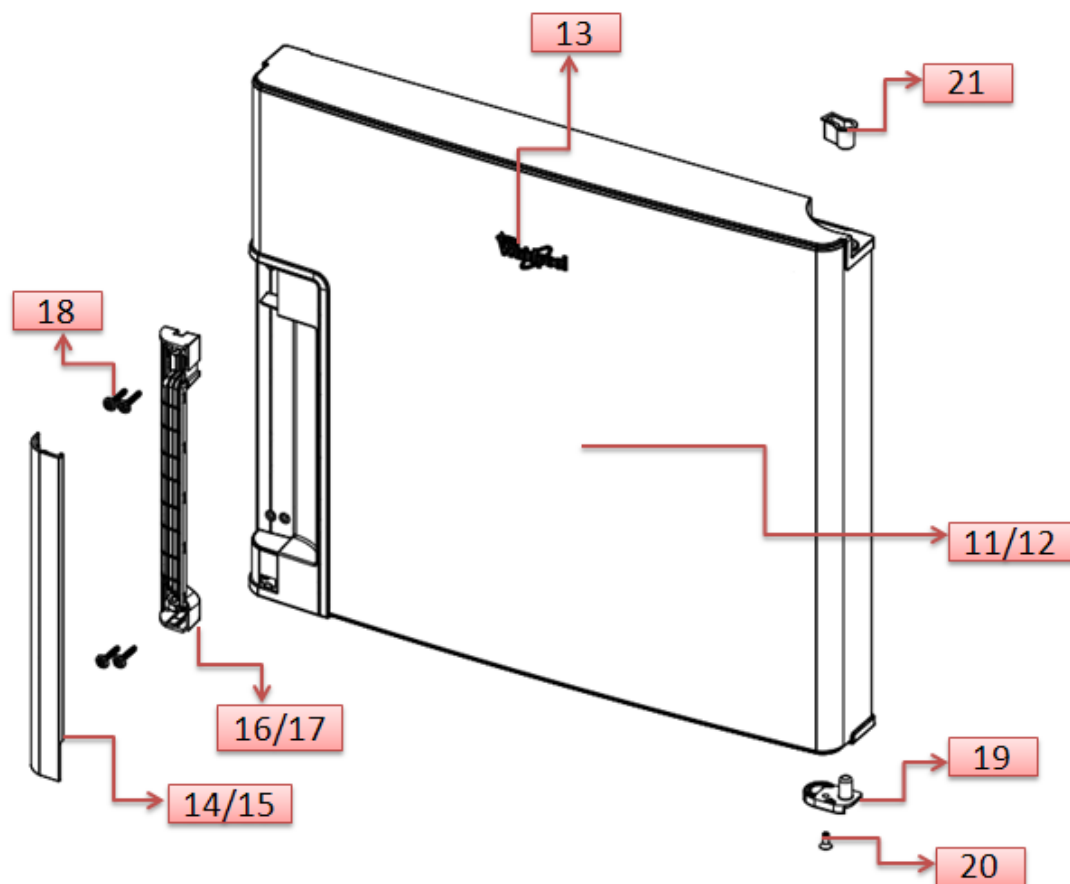

| | | | |
|----|------------------|-----------|-------------------------|
| 22 | FC DOOR INTERIOR | W10412095 | TRIVET FC GENX 2 |
| 23 | FC DOOR INTERIOR | W10530157 | GASKET SUB-ASSY FC GENX |

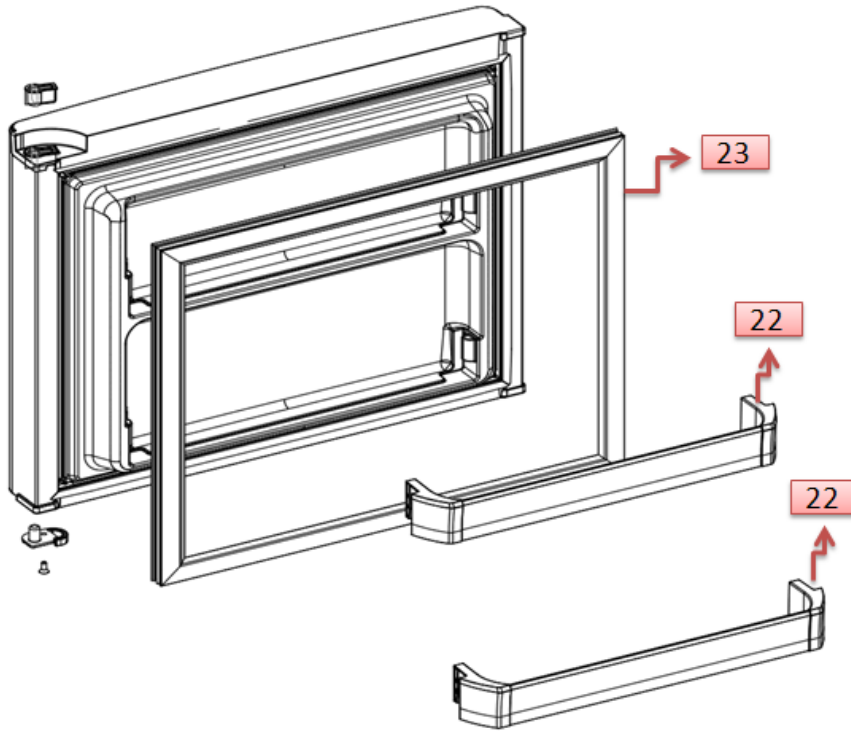

| | | | |
|----|-------------|-------------|---|
| 24 | FC INTERIOR | W10412128 | KNOB - FREEZER DAMPER / THERMOSTAT,L 60 |
| 25 | FC INTERIOR | W10507116 | FC GLASS SHELF FRAME - GEN-X 2 |
| 26 | FC INTERIOR | W10507117 | GLASS FC SHELF - GEN-X |
| 27 | FC INTERIOR | W10471820 | SCREW CAP- PLENUM |
| 28 | FC INTERIOR | A2243490000 | M 4.2 X 16 SELF TAPPING SCREW - ONYX |
| 29 | FC INTERIOR | W10492561 | Assly, Ice Twister, Removable with carton |

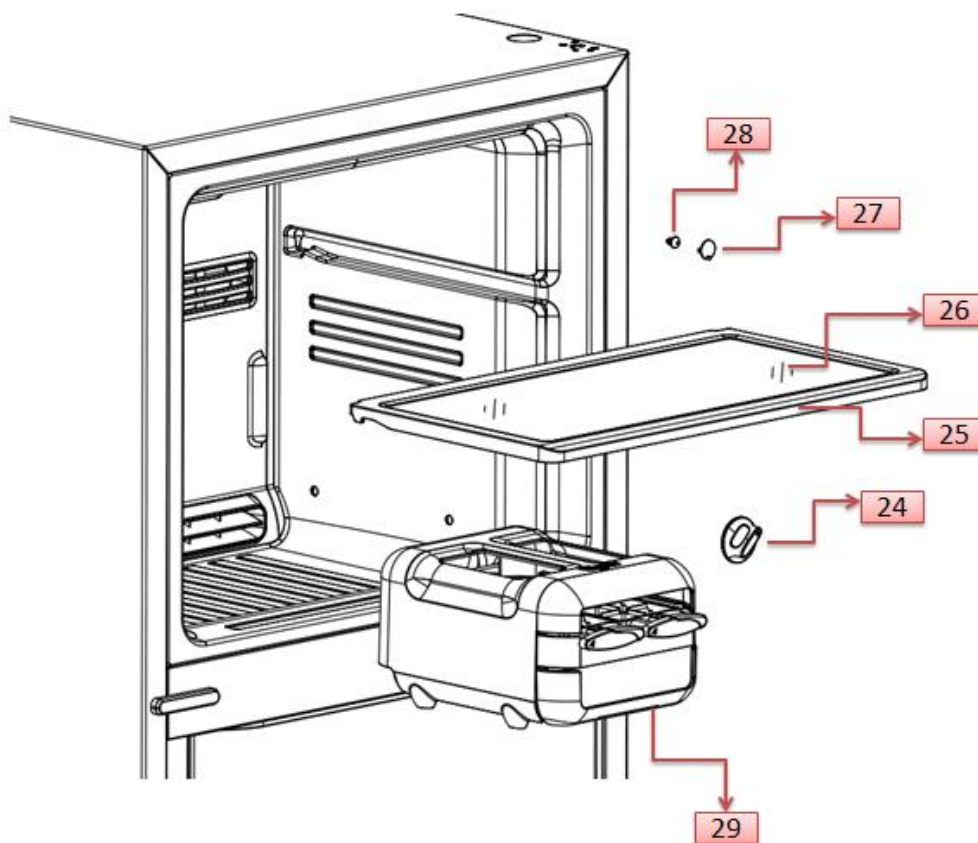

| | | | |
|----|--------------------|-----------|---------------------------------------|
| 30 | FC PLENUM INTERIOR | W10511079 | PLENUM FRONT WITH REFLECTOR L60 |
| 31 | FC PLENUM INTERIOR | W10532079 | PLENUM BACK SUB ASSY L60/GENX 2 |
| 32 | FC PLENUM INTERIOR | W10533473 | Freezer Damper Control GENX- AUS |
| 33 | FC PLENUM INTERIOR | W10468717 | EPS BLOCK FOR PLENUM FRONT L60 & GENX |

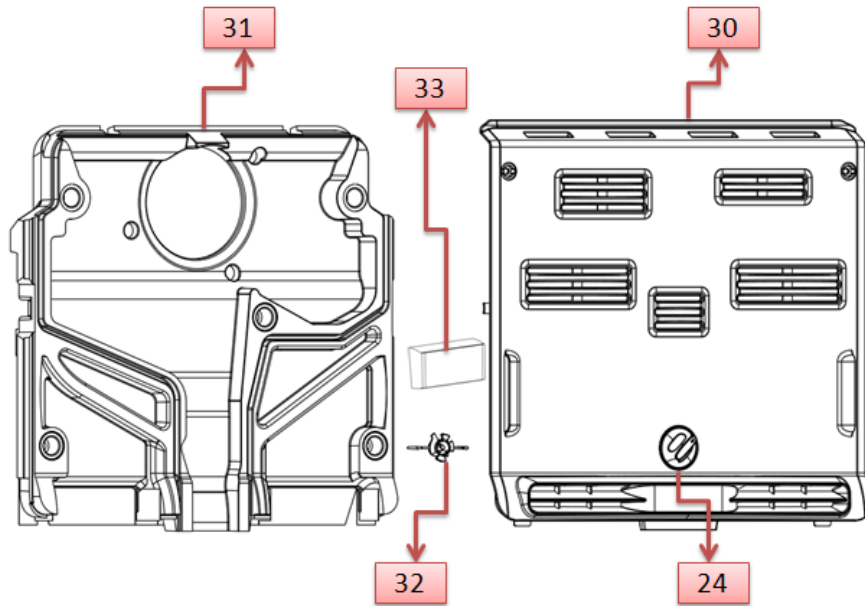

| | | | |
|----|--------------------|-------------|--------------------------------------|
| 34 | FC PLENUM INTERIOR | W10169462 | FAN BLADE 90MM DIAMETER |
| 35 | FC PLENUM INTERIOR | A2221170000 | MI AC MOTOR FOR DUO (9.8W) |
| 36 | FC PLENUM INTERIOR | W10463830 | FAN MOTOR BRACKET |
| 37 | FC PLENUM INTERIOR | W10412088 | FAN MOTOR BRACKET COVER,L 60 |
| 38 | FC PLENUM INTERIOR | W10467581 | GROMET FOR FIXING MOTOR - 5.8W,L 60 |
| 39 | FC PLENUM INTERIOR | W10499651 | GROMET FOR FIXING MOTOR - PANASONIC |
| 40 | FC PLENUM INTERIOR | A222376000A | 4.8 X 16 SELF TAPP AB TYPE SS |
| 41 | FC PLENUM INTERIOR | W10225835 | DAMPING RUBBER GROMMET FOR FAN MOTOR |

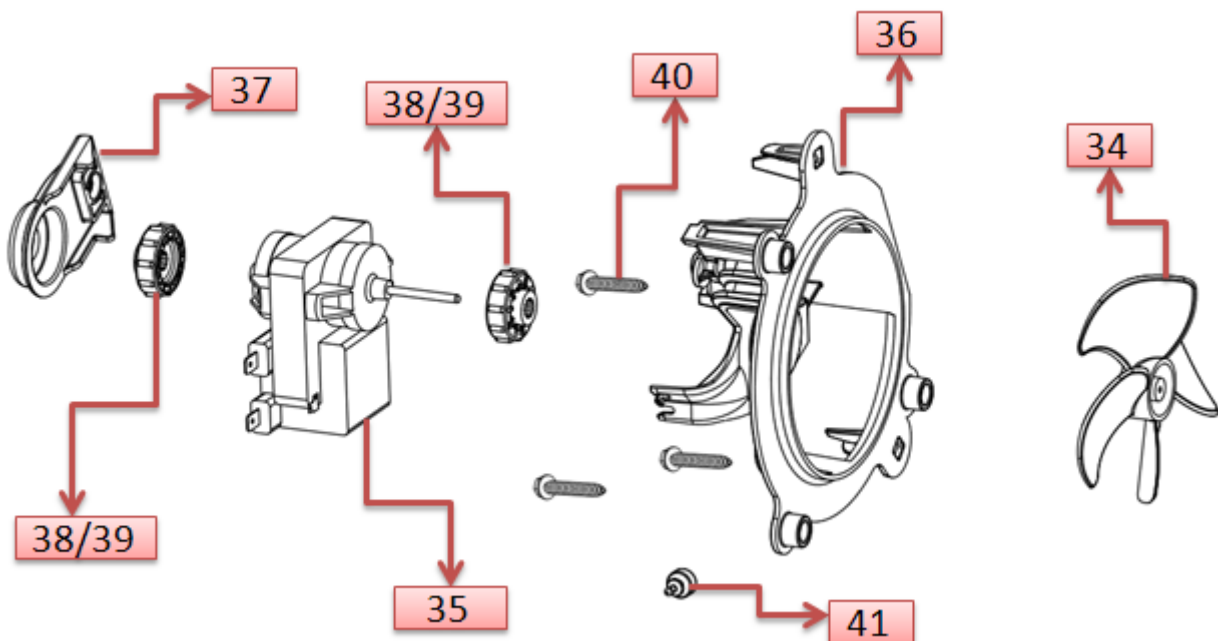

| | | | |
|----|--------------------|-------------|--------------------------------------|
| 42 | FC PLENUM INTERIOR | W10532059 | THERMAL FUSE WITH CONNECTOR FOR GENX |
| 43 | FC PLENUM INTERIOR | A2119170000 | BI-METAL ASSY. TOD-39TV |
| 44 | FC PLENUM INTERIOR | W10467187 | RADIANT HEATER 180W/230V L60 |

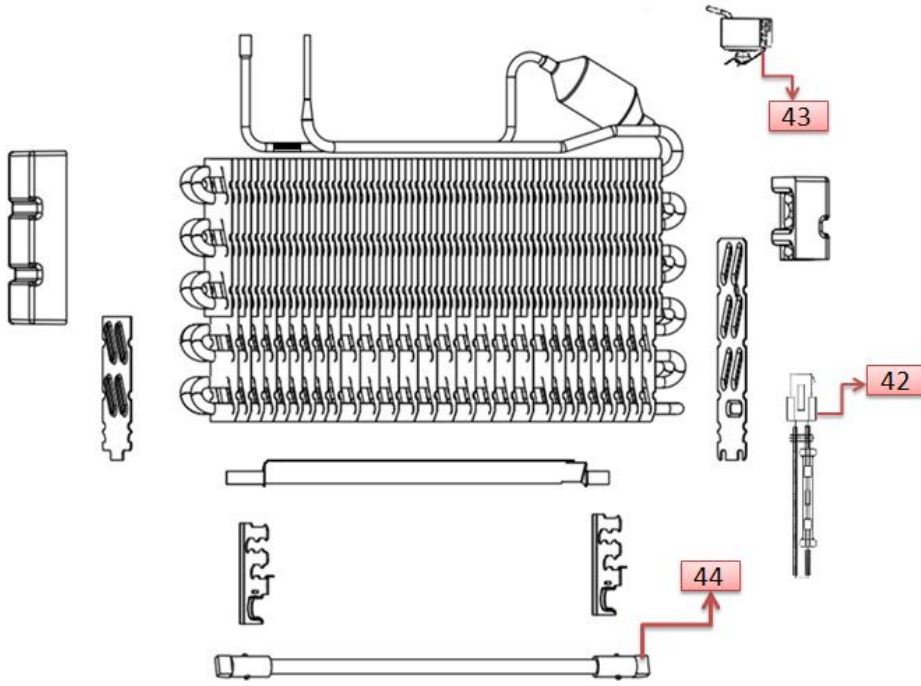

| | | | |
|----|------------------|-----------|--|
| 45 | RC DOOR | W10533613 | 305L RC FOAMED DOOR WHITE GENX-2 FLUSH |
| 46 | RC DOOR | W10533614 | 305L RC FOAM DOOR REAL STEEL GENX2 FLUSH |
| 47 | RC DOOR | W10533612 | 275L RC FOAMED DOOR WHITE GENX-2 FLUSH |
| 48 | RC DOOR | W10548059 | 255L RC FOAMED DOOR WHITE GENX-2 FLUSH |
| 49 | RC DOOR EXTERIOR | W10412079 | HANDLE RC FRONT FLUSH |
| 50 | RC DOOR EXTERIOR | W10477285 | HANDLE RC FRONT FLUSH WARM SILVER 2 |
| 51 | RC DOOR EXTERIOR | W10511613 | HANDLE RC BACK FLUSH WHITE |
| 52 | RC DOOR EXTERIOR | W10412078 | HANDLE RC BACK FLUSH |
| 53 | RC DOOR EXTERIOR | W10467972 | SLEEVE CENTER HINGE - ONYX |

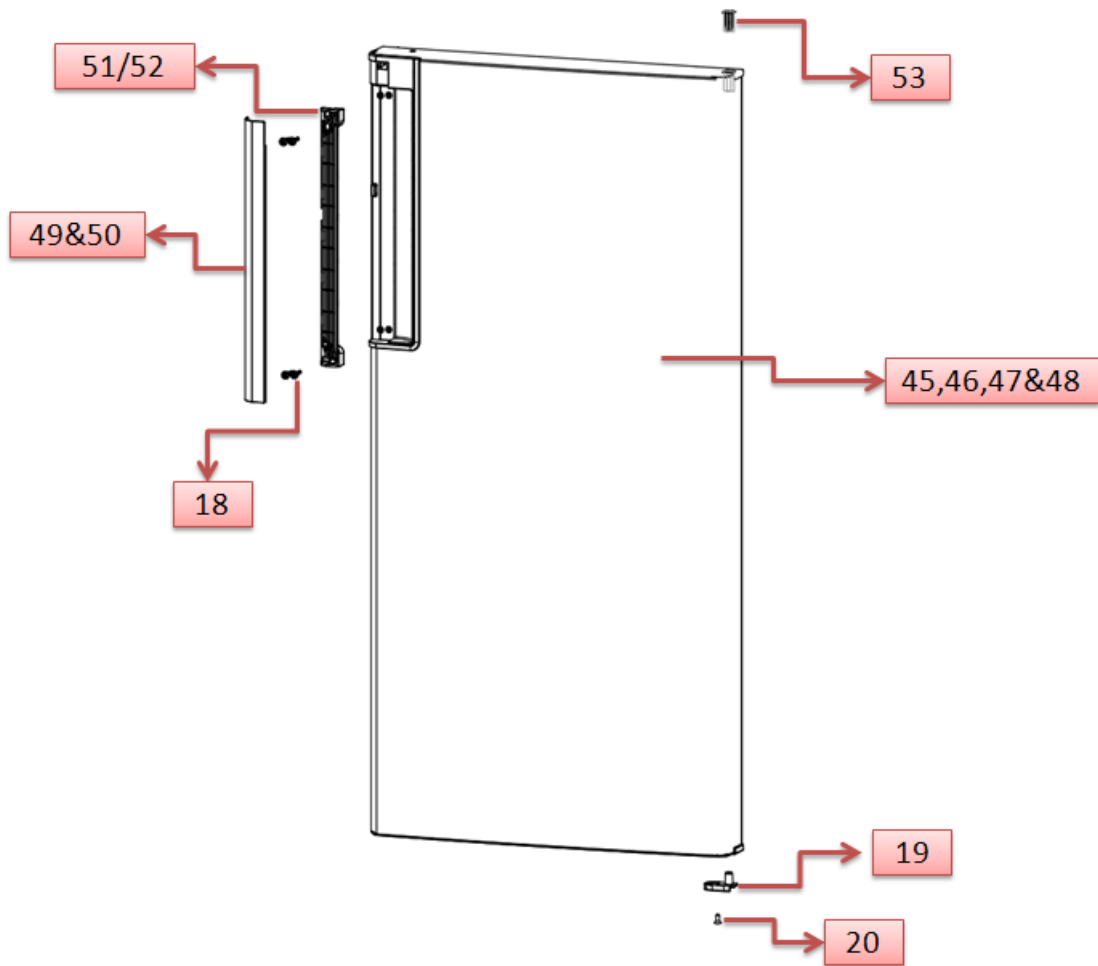

| | | | |
|----|------------------|-------------|------------------------------------|
| 54 | RC DOOR INTERIOR | A2240510000 | EGG TRAY - ONYX |
| 55 | RC DOOR INTERIOR | W10479640 | BOTTLE RETAINER GENX |
| 56 | RC DOOR INTERIOR | W10412105 | TRIVET RC- GENX 2 |
| 57 | RC DOOR INTERIOR | W10412106 | SHALLOW BIN GENX |
| 58 | RC DOOR INTERIOR | W10473470 | PUSH IN GASKET(B)-RC 242L GENX 2 |
| 59 | RC DOOR INTERIOR | W10473471 | PUSH IN GASKET(B)-RC 262L GENX 2 |
| 60 | RC DOOR INTERIOR | W10473472 | PUSH IN GASKET(B)-RC 292L GENX 2 |
| 61 | RC DOOR INTERIOR | W10497994 | BEER CADDY ASSY WITH BOTTLE OPENER |

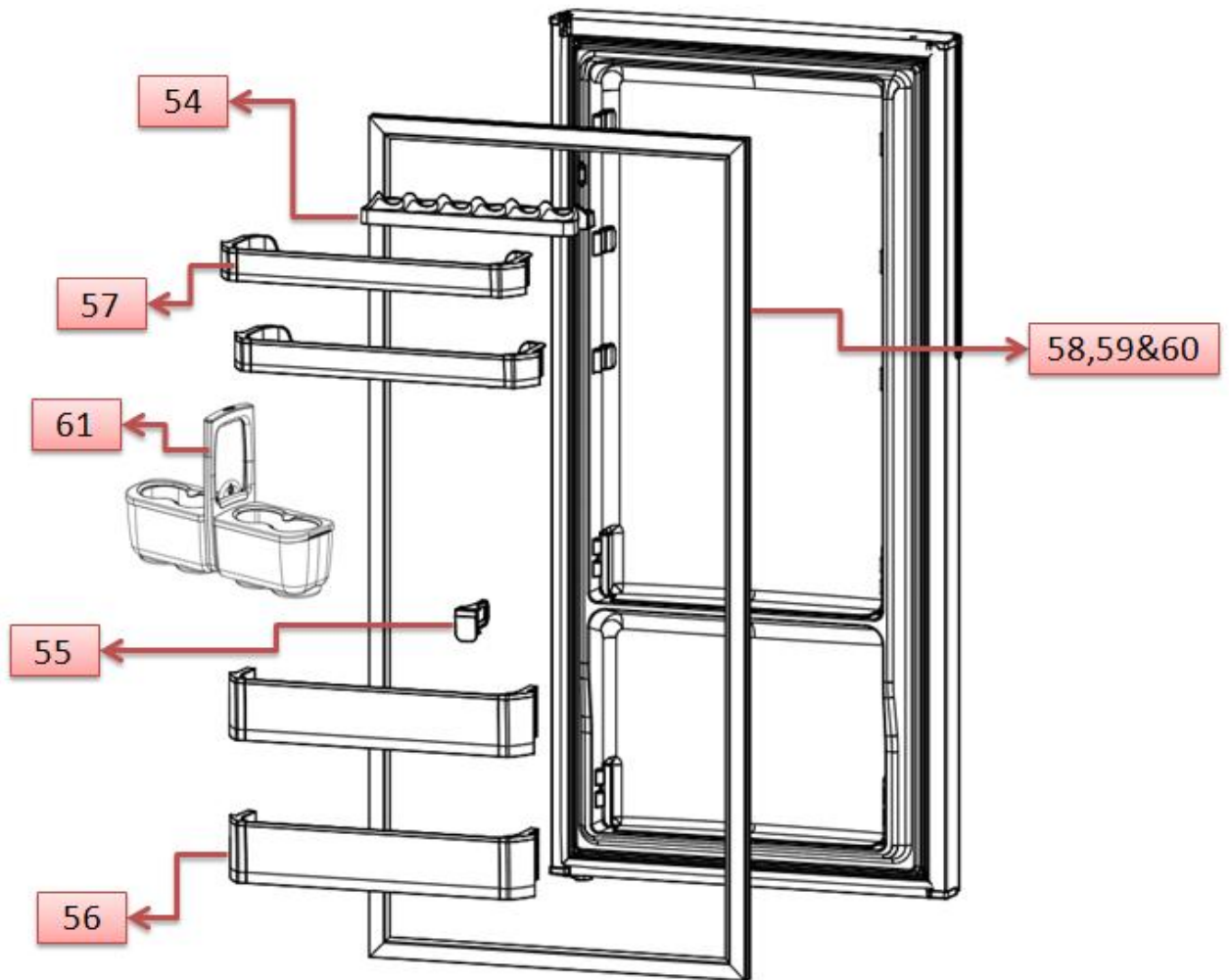

| | | | |
|----|-------------|-------------|---------------------------------------|
| 62 | RC INTERIOR | W10412104 | CRISPER 21.4 L GENX 2 |
| 63 | RC INTERIOR | W10426608 | CRISPER COVER ASSY M1 GENX 2 |
| 64 | RC INTERIOR | W10412101 | ALBUM COVER GLASS SHELF RC GENX 2 |
| 65 | RC INTERIOR | W10509476 | GENX GLASS WITH WHITE PRINTING |
| 66 | RC INTERIOR | W10432663 | DEFROST TRAY - AUSTRALIA |
| 67 | RC INTERIOR | w10507104 | THAW GLASS SHELF FRAME , GEN-X |
| 68 | RC INTERIOR | w10507105 | GLASS THAW ZONE , GEN-X |
| 69 | RC INTERIOR | W10412192 | CHILLER GENX |
| 70 | RC INTERIOR | A2253030000 | SWITCH ROCKER ARM, NC- ESBEE W welded |

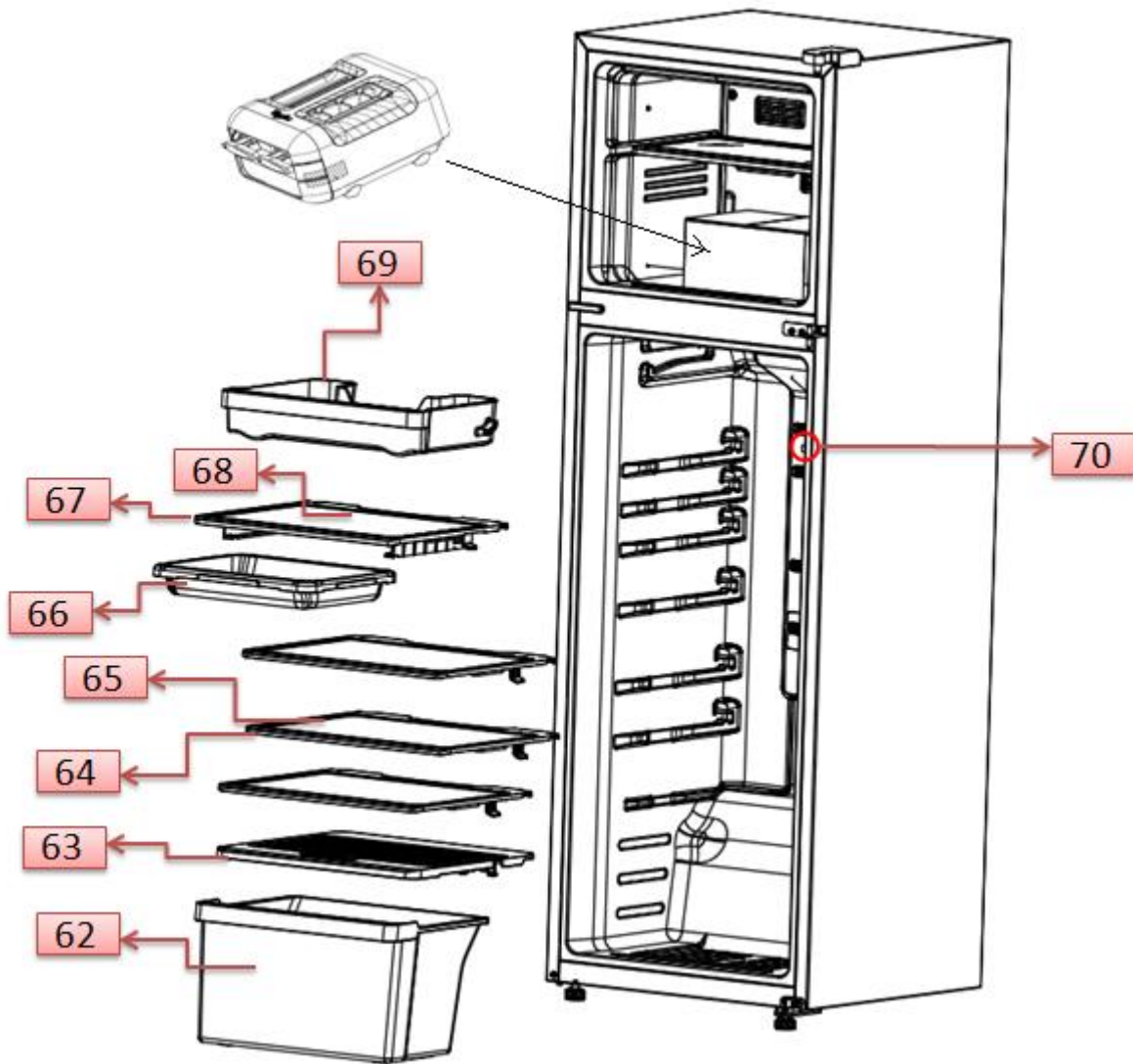

| | | | |
|-----|----------------------|-------------|--|
| 71 | RC DIFFUSER EXTERIOR | A2221820000 | BULB HOLDER - DUO |
| 72 | RC DIFFUSER EXTERIOR | A2221470000 | BULB APPLIANCE, E14 |
| 73 | RC DIFFUSER EXTERIOR | W10441496 | EAST DRAGON DEFROST TIMER |
| 74 | RC DIFFUSER EXTERIOR | W10523684 | THERMOSTAT - GENX 292L/262L |
| 74A | RC DIFFUSER EXTERIOR | W10523685 | THERMOSTAT-GENX,242L |
| 75 | RC DIFFUSER EXTERIOR | W10539585 | LENS IN DIFFUSER ACRYLIC |
| 76 | RC DIFFUSER EXTERIOR | W10412109 | DEODERIZER COVER |
| 77 | RC DIFFUSER EXTERIOR | W10504843 | CHARCOL - DEODRISER L-60 |
| 78 | RC DIFFUSER EXTERIOR | W10507108 | BAD SUB ASSY 292L GENX |
| 79 | RC DIFFUSER EXTERIOR | W10412090 | BODY AIR DIFFUSER ASSLY 242L/262L GENX |
| 80 | RC DIFFUSER EXTERIOR | W10502379 | SUB ASSEMBLY OF COVER AIR DIFFUSER |
| 81 | RC DIFFUSER EXTERIOR | W10412091 | COVER AIR-DIFFUSER 242L/262L GENX |

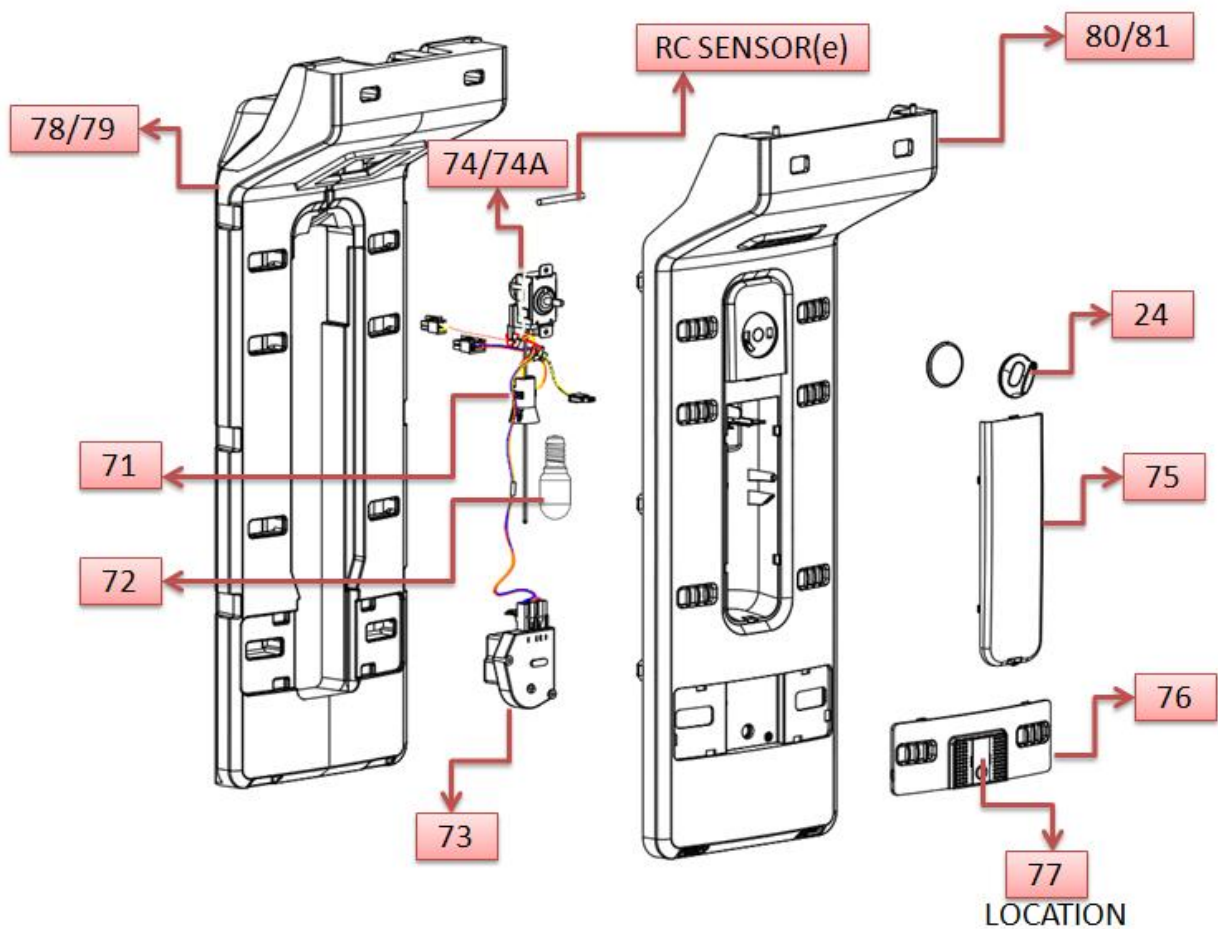

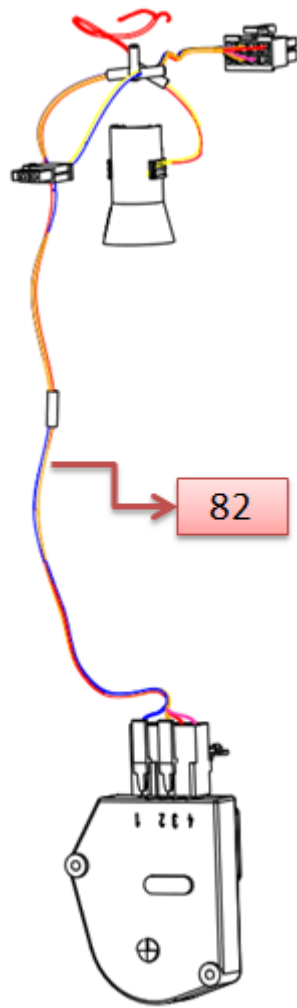

| | | | |
|----|----------------------|-------------|---|
| 83 | CMP | W10412129 | COMPRESSOR MOUNTING PLATE ASSY GENX |
| 84 | CMP | A201354000D | PHILIPS HEAD SCREW M5.5X1.8 |
| 85 | CMP | W10494984 | SLEEVE GROMMET |
| 86 | CMP | W10494985 | WASHER GROMMET L60 |
| 87 | CMP | W10494983 | COMPRESSOR GROMMET L60 |
| 88 | CMP | D111204100D | HEX NYLOC NUT M6 |
| 89 | COMPRESSOR DECK AREA | W10479607 | DRIER HOLDER -L60 & GenX |
| 90 | COMPRESSOR DECK AREA | W10536565 | DISCHARGE COIL GENX2 |
| 91 | COMPRESSOR DECK AREA | W10499649 | DEFROSTWATERTRAY SUB ASSY - L60 |
| 92 | COMPRESSOR DECK AREA | W10334240 | DRAIN TUBE BOTTOM |
| 93 | COMPRESSOR DECK AREA | A2291680000 | CAPACITOR MOUNTING BRACKET, OPAL |
| 94 | COMPRESSOR DECK AREA | A2252230000 | COMPRESOR ASSY,WANBAO ADW66AK,230V/60HZ |
| 95 | COMPRESSOR DECK AREA | W10527348 | SUCTION COMPLIMENT FOR ADW66AK-GENX |
| 96 | COMPRESSOR DECK AREA | A2245960000 | Spacer Sub Assy - Onyx |
| 97 | COMPRESSOR DECK AREA | W10495066 | GROMMET DISCHARGE COIL L60 |

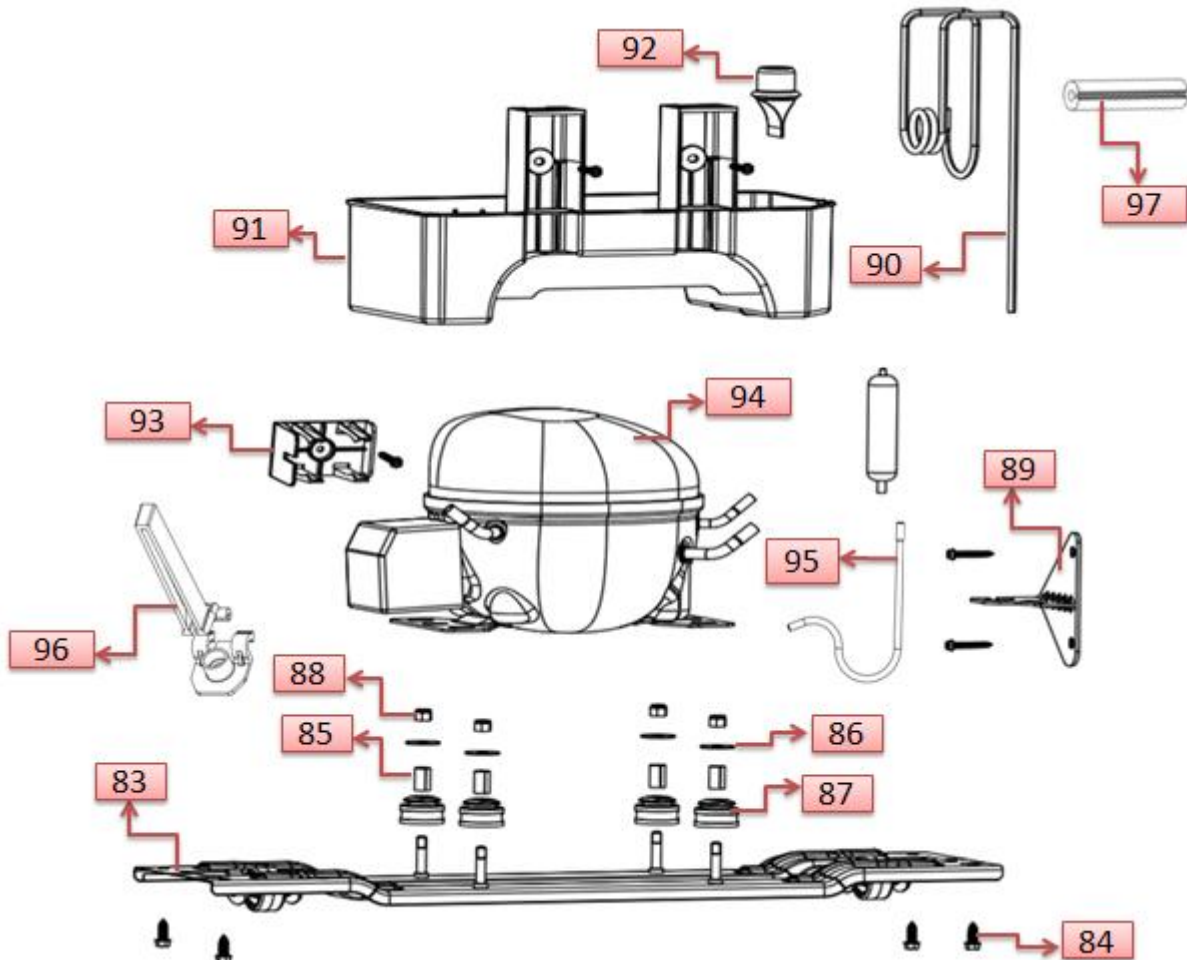

| | | | |
|----|----------------------|-------------|---|
| 98 | COMPRESSOR DECK AREA | A201358000F | M/C Screw for Fan Motor Bracket (FOR EARTHING) |
|----|----------------------|-------------|---|

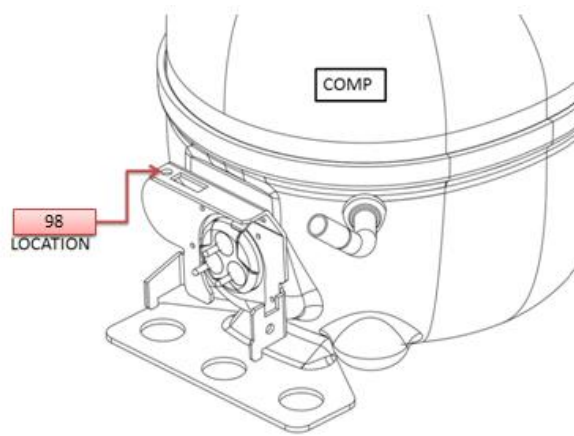
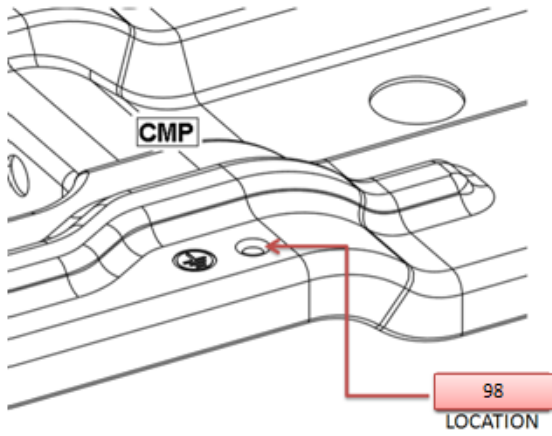

8. Serviceable Part List:-

| | |
|--------------------|--|
| W10507748 | TOP HINGE COVER NEO-DLX WHITE |
| W10463885 | TOP HINGE COVER NEO-DLX CHARCOAL GRAY |
| W10418501 | SCREW- TRILOBULAR M6X1.0 HEX HEAD |
| W10444351 | HINGE TOP ASSY- DLX |
| W10426650 | CENTRE HINGE ASSY- L60 |
| W10479958 | CAP - CENTER RAIL WHITE TRINITY |
| W10478024 | SCREW- RILOBULAR M6X1.0 HEX HEAD CENTRE RAIL |
| W10528520 | PLATE LEVELLER ASSEMBLY,GENX |
| A201354000D | PHILIPS HEAD SCREW 5.5X1.8 CMP BOTTOM HINGE |
| W10528523 | HINGE BOTTOM ASSEMBLY, GENX |
| W10533610 | FC FOAMED DOOR WHITE GENX-2 FLUSH H |
| W10533611 | FC FOAMED DOOR REAL STEEL GENX-2 FLUSH |
| W10391355 | NAMEPLATE-WP,WHT |
| W10412075 | HANDLE FC FRONT FLUSH EXPORTS |
| W10477284 | HANDLE FC FRONT FLUSH EXPO WARM SILVER 2 |
| W10511612 | HANDLE FC BACK FLUSH - WHITE |
| W10412074 | HANDLE FC BACK FLUSH CHARCOAL GRAY |
| W10519257 | SHOULDER SCREW-BT TYPE |
| W10426602 | STOP DOOR, RH - ONYX |
| A2241310000 | SCREW-CSK HEAD 4.8, DOOR STOPER- ONYX |
| W10467948 | SLEEVE TOP HINGE |
| W10412095 | FC TRIVET, GENX |
| W10530157 | GASKET SUB ASSY FC GENX |
| W10412128 | KNOB -FREEZER CONTROL |
| W10507116 | FC GLASS SHELF FRAME - GEN-X 2 |
| W10507117 | GLASS FC SHELF - GEN-X |
| W10471820 | SCREW CAP- PLENUM |
| A2243490000 | M 4.2 X 16 SELF TAPPING SCREW - ONYX |
| W10492561 | Assly, Ice Twister, Removable carton |
| W10511079 | PLENUM FRONT SUB ASSY |
| W10532079 | PLENUM BACK SUB ASSY |
| W10533473 | Freezer Damper Control GENX- AUS |
| W10468717 | EPS BLOCK FOR PLENUM FRONT |
| W10169462 | FAN BLADE 90MM |
| A2221170000 | MI AC MOTOR FOR DUO (9.8W) |
| W10463830 | FAN MOTOR BRACKET |
| W10412088 | FAN MOTOR BRACKET COVER |
| W10467581 | GROMET FOR FIXING MOTOR - 5.8W,L60 |
| W10499651 | GROMET FOR FIXING MOTOR - PANASONIC |
| A201358000F | M/C Screw for Fan Motor Bracket |
| W10225835 | DAMPING RUBBER GROMMET FOR FAN MOTOR |

| | |
|-------------|--|
| W10532059 | THERMAL FUSE WITH CONNECTOR GENX 2 |
| A2119170000 | BI-METAL ASSY. TOD-39TV |
| W10467187 | RADIANT HEATER 180W/230V |
| W10533613 | 305L RC FOAMED DOOR WHITE GENX-2 FLUSH |
| W10533614 | 305L RC FOAM DOOR REAL STEEL GENX2 FLUSH |
| W10533612 | 275L RC FOAMED DOOR WHITE GENX-2 FLUSH |
| W10548059 | 255L RC FOAMED DOOR WHITE GENX-2 FLUSH |
| W10412079 | HANDLE RC FRONT FLUSH |
| W10477285 | HANDLE RC FRONT FLUSH WARM SILVER 2 |
| W10511613 | HANDLE RC BACK FLUSH WHITE |
| W10412078 | HANDLE RC BACK FLUSH |
| W10467972 | SLEEVE- HINGE |
| A2240510000 | EGG TRAY - ONYX |
| W10479640 | BOTTLE RETAINER |
| W10412105 | TRIVET RC - GENX |
| W10412106 | SHALLOW BIN - GENX |
| W10473470 | PUSH IN GASKET (B)-242L GENX |
| W10473471 | PUSH IN GASKET (B)-262L GENX |
| W10473472 | PUSH IN GASKET (B)-292L GENX |
| W10497994 | BEER CADDY ASSY WITH BOTTLE OPENER |
| W10412104 | CRISPER-21.4L GENX |
| W10426608 | CRISPER COVER SUB ASSY M1 GENX |
| W10412101 | ALBUM COVER GLASS SHELF RC GENX 2 |
| W10509476 | GENX GLASS WITH WHITE PRINTING |
| W10432663 | Defrost Tray - Australia |
| w10507104 | THAW GLASS SHELF FRAME , GEN-X |
| w10507105 | GLASS THAW ZONE , GEN-X |
| W10412192 | CHILLER GENX |
| A2253030000 | CTL NO-ROCKER ARM SWITCH (DOOR SWITCH) |
| A2221820000 | BULB HOLDER - DUO |
| A2221470000 | BULB APPLIANCE, E14 |
| W10441496 | DEFROST TIMER, FROM EAST DRAGOAN |
| W10523684 | THERMOSTAT - GENX 292L/262L |

| | |
|-------------|---|
| W10523685 | THEMOSTAT - GENX 242L |
| W10539585 | LENS IN DIFFUSER ACRYLIC |
| W10412109 | DEODERIZER COVER,L60 |
| W10504843 | CHARCOL - DEODRISER |
| W10507108 | BAD SUB ASSY GENX,292L |
| W10412090 | BAD SUB ASSY GENX,242L/262L |
| W10502379 | SUB ASSEMBLY OF COVER AIR DIFFUSER |
| W10412091 | COVER AIR DIFFUSER-GENX,242L/262L |
| W10383978 | CONTROL BOX HARNESS DLX |
| W10412129 | COMPRESSOR MOUNTING PLATE SUB ASSY |
| A201354000D | PHILIPS HEAD SCREW M5.5X1.8 |
| W10494984 | SLEEVE GROMMET - L60 |
| W10494985 | WASHER GROMMET - L60 |
| W10494983 | COMPRESSOR GROMMET - L60 |
| D111204100D | HEX NYLOC NUT M6 |
| W10479607 | DRIER HOLDER - L60 & GENX |
| W10536565 | DISCHARGE COIL GENX2 |
| W10499649 | DEFROSTWATERTRAY SUB ASSY - L60 |
| W10334240 | DRAIN TUBE BOTTOM |
| A2291680000 | CAPACITOR MOUNTING BRACKET, OPAL |
| A2252230000 | COMPRESOR ASSY,WANBAO ADW66AK,230V/60HZ |
| W10527348 | SUCTION COMPLIMENT FOR ADW66AK-GENX |
| A2245960000 | Spacer Sub Assy - Onyx |
| W10495066 | GROMMET DISCHARGE COIL L60 |
| A201356000B | EARTHING SCREW |

9. Plug Pin check points

Ensure proper earthing and phase direction

- Confirm phase at right side
- Confirm voltage in Phase and Neutral ~220V
- Confirm Voltage in Phase and Earthing~ < 220V
- Confirm Voltage in Earthing and Neutral ~ <5V
- There should not be any continuity in between Neutral and Ground

Plug the cord of the Refrigerator. Avoid extension

Run Refrigerator 2~3 Hrs on no load to get cooled sufficiently

