



# INSTRUCTIONS

-J03499

REV. 09-20-2004

Kit Number 17012-03KA

## FRONT CYLINDER HEAD ASSEMBLY

### General

This Front Cylinder Head Assembly fits all Harley-Davidson® 2002 and later VRSCA and 2003 and later VRSCB model motorcycles.

### Additional Parts Required

Installation of this kit will require Loctite® 620. Installation also requires additional Harley-Davidson supplies and tools that are identified in the Service Manual.

See the Service Parts illustration for kit contents.

### ⚠ WARNING

The rider's safety depends upon the correct installation of this kit. Use the appropriate service manual procedures. If the procedure is not within your capabilities or you do not have the correct tools, have a Harley-Davidson dealer perform the installation. Improper installation of this kit could result in death or serious injury. (00333a)

Harley-Davidson recommends that trained technicians at an authorized dealership perform the installation.

### NOTE

This instruction sheet references Service Manual information. A Service Manual for your model motorcycle is available for purchase at your Harley Davidson dealer.

### Remove the Engine

1. Follow the Service Manual ENGINE REPLACEMENT, REMOVAL instructions to remove the engine.
2. Follow the Service Manual STRIPPING MOTORCYCLE FOR SERVICE, ENGINE CRADLE AND STAND instructions to mount the engine in the Engine Cradle (HD-42310-40) for the Benchtop Stand (HD-42310) or Rolling Stand (HD-43646-50).

### Remove the Front Cylinder Head

To remove and disassembly the front cylinder head, follow the Service Manual instructions in the following sections:

THROTTLE BODY, REMOVAL

TOP END DISASSEMBLY, CAM DRIVE REMOVAL

CYLINDER HEAD SERVICE, REMOVAL AND DISASSEMBLY

### Assemble the Cylinder Head

1. To assemble the front cylinder head, follow the Service Manual instructions in the following section.  
CYLINDER HEAD SERVICE, HEAD ASSEMBLY

### Install the Cam Drive Breather Fitting

**For 2002 to 2004 VRSCA/B:** See Figure 1. Thinly coat the silver metal breather hose fitting with Loctite® 620 and push it into the cam drive breather hole next to the intake port until it seats.

**For 2005 and later:VRSCA/B, VRSCSE:** See Figure 2. With light grease, lightly lubricate the rubber o-ring and groove of the brass breather airbox fitting. Press the O-ring end into the cam drive breather hole next to the intake port until it seats.

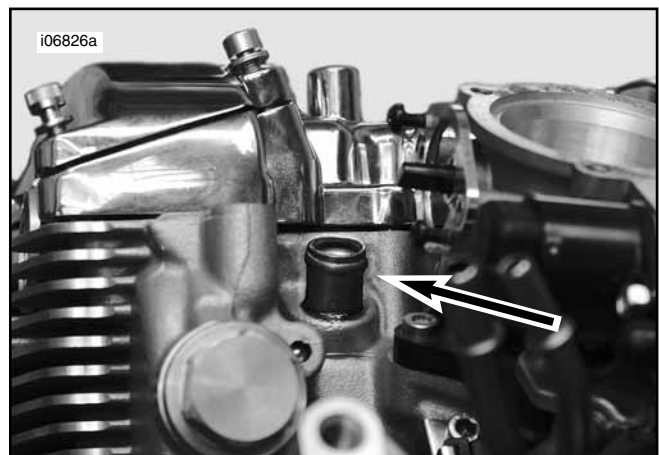

Figure 1. Silver Metal Breather Hose Fitting (2002 to 2004 VRSCA/B)

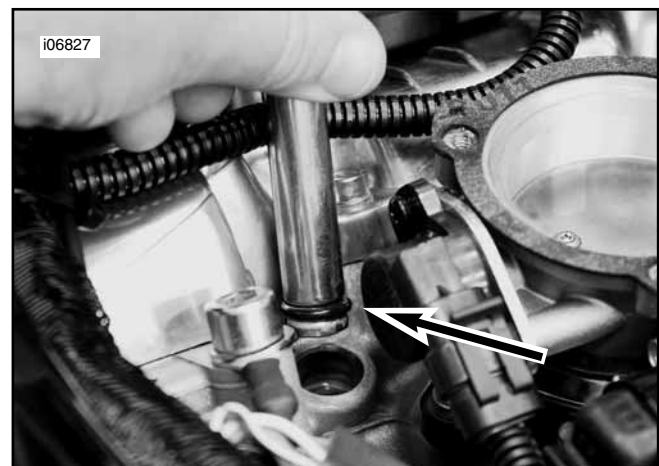

Figure 2. Brass Breather Airbox Fitting w/O-ring (2005 and later VRSCA/B, VRSCSE)

### ***Install the Front Cylinder Head***

To install the front cylinder head, follow the Service Manual instructions in the following sections.

CAM DRIVE, ASSEMBLY

CYLINDER HEADS, INSTALLATION

INSTALLING AND TIMING THE CAMS, PROCEDURE

### ***Install the Engine***

To install the throttle body on the engine and then install the engine in the motorcycle, follow the Service Manual instructions in the following sections:

THROTTLE BODY, INSTALLATION

ENGINE REPLACEMENT, INSTALLATION



# **Service Parts**

Part No. 17012-03KA

Date 09/04

Front Cylinder Head Assembly

i06669

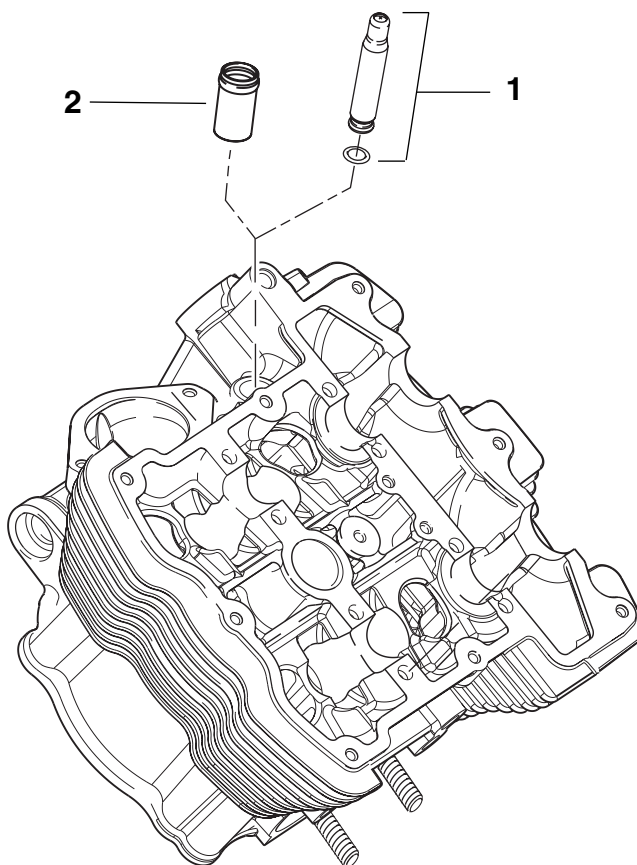

Item	Description (Qty)	Part No.
1	Breather silver metal hose fitting	Not sold separately
2	Breather brass airbox fitting	29601-05K