

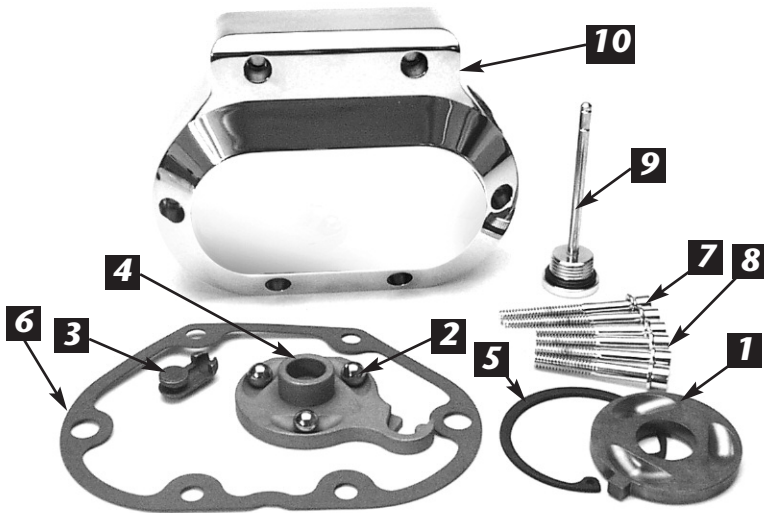

INSTRUCTION SHEET FOR PART No.2371P, 2371CH, 2371CK

**BILLET TRANSMISSION SIDE COVER
USE ON 1987-PRESENT, FLT, FLHT, FLHR,
1991-2005 DYNA, 1987-PRESENT SOFTTAILS**



This billet clutch release end cover is precision machined and comes polished or chrome. This very clean and light end cover is designed to reduce the amount of flex force as seen in most end covers when using either a stock or high pressure clutch spring.

Refer to H-D® service manual for specifications

CAUTION: When installing snap rings always wear eye protection and always disconnect the negative cable on the battery and use the proper tools.

NOTE: ON SIDE COVER No. 2371CH AND No.2371P YOU WILL ONLY RECEIVE 6 ALLEN SCREWS AND A GASKET. ALL OTHER PARTS LISTED COME WITH No. 2371CK.

NOTE: IF YOUR INSTALLING THIS COVER ON A JIMS 6-SPEED TRANSMISSION YOU WILL NEED ALLEN SCREWS SHOWN IN FIG.1. NOT SUPPLIED IN KIT.

1. Screw clutch cable adjuster into side cover. Don't tighten at this time, replace cable fitting o-ring if damaged or deformed.
2. Install outer ramp part number 25453-87A (No.1) into side of cover with three dished out areas facing you. Place outer ramp inside, with post installed in cover at the five o'clock position, in slot provided. Place three balls part No. 8873 (No.2) in dished areas on ramp.
3. Install clutch cable end to coupling part No. 34920-86 (No.3). Install coupling on inner ramp hook part No. 25452-87A (No.4) and install in cover against the three balls with the three dished out areas facing balls.
4. Install retaining ring part No. 10998 (No.5) in cover in slot provided above inner ramp. Place ring with open ends in five o'clock position.
5. Install gasket part No. 36801-87A (No.6) and side cover to transmission using two longest allen screws provided, part No.1117 (No.7) for two top holes and other four allen screws part No. 1121 (No.8) in remaining holes. Tighten all allens to 10-12 ft lbs of torque.
6. Tighten clutch cable fitting to 3-5 ft lbs of torque. For proper adjustment refer to H-D® Service Manual.
7. Fill transmission with lube (recommended JIMS® part No. 1230 80W90 gear oil). Install dipstick (No.9) Tighten exhaust pipe if loosened.

PARTS AVAILABLE SEPARATELY			
1.	1	Outer ramp	25453-87A
2.	3	Ball	8873
3.	1	Coupling	34920-86
4.	1	Inner ramp	25452-87A
5.	1	Retaining ring	10998
6.	1	Gasket	36801-87A
7.	2	2 1/4" long allen	1117
8.	4	1 3/4" long allen	1121
9.	1	Dipstick	37075-87
10.	1	Chrome Side Cover	2371C

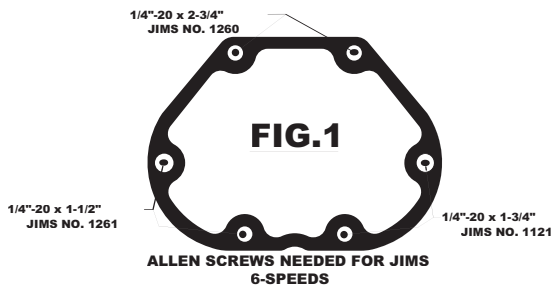

**CAUTION: WEAR SAFETY GLASSES. EXCESSIVE FORCE MAY DAMAGE PARTS!
SEE JIMS® CATALOG FOR HUNDREDS OF TOP QUALITY PROFESSIONAL TOOLS.
THE LAST TOOLS YOU WILL EVER NEED TO BUY.**

Performance Parts For Harley-Davidson® Motorcycles