



INSTALLATION

L.E.D. HALO TRIM RINGS for PASSING LAMPS

7271

PARTS INCLUDED

- 1 Left Black Trim Ring and L.E.D. Halo light
- 1 Right Black Trim Ring and L.E.D. Halo Light
- 2 1/2" Wide Adhesive Foam Strips
- 1 Hardware Kit Including
 - 8 Female T-Tap Connectors
 - 8 Male Spades
 - 3 4" Black Nylon Cable Ties
 - 2 M3 Custom Nuts
 - 2 M3 Phillips Pan Head Screws
 - 1 Dielectric Grease Pack
- 1 Installation Instructions

Please read and understand entire instructions before starting installation.

THANK YOU FOR CHOOSING KÜRYAKYN!

IN ORDER TO PROTECT YOU AND OTHERS FROM POSSIBLE INJURY AND/OR PROPERTY DAMAGE OR LOSS, PLEASE PAY CLOSE ATTENTION TO ALL INSTRUCTIONS, WARNINGS, CAUTIONS AND NOTICES REGARDING THE USE AND CARE OF THIS PRODUCT.

WARNING

THIS INDICATION ALERTS YOU TO THE FACT THAT IGNORING THE CONTENTS DESCRIBED HEREIN CAN RESULT IN POTENTIAL DEATH OR SERIOUS INJURY.

NOTICE

This indication alerts you to the fact that ignoring the contents described herein may negatively affect product performance and functionality.

NOTICE

IF INSTALLING THIS PRODUCT FOR ANOTHER PARTY, PLEASE MAKE SURE THEY RECEIVE THIS COPY OF THE INSTALLATION INSTRUCTIONS SO THEY ARE AWARE OF THE IMPORTANT INFORMATION CONTAINED IN THEM.

TOOLS SUGGESTED

#2 Phillips Head Screwdriver, Wire Crimping Tool, Wire Cutter, Wire Stripper

STRICTLY OBSERVE THE FOLLOWING GUIDELINES IN ORDER TO USE THE PRODUCT PROPERLY AND AVOID POTENTIALLY DANGEROUS ACCIDENTS.

STEP 1

Read and understand all steps in the instructions before starting the installation. Park the motorcycle on a hard, level surface and turn off the ignition. Let cool.

NOTICE

Avoid damage to the motorcycle. Protect painted surfaces with a soft cloth or blanket.

NOTICE

A factory service manual may be helpful in performing this installation. Do not attempt to perform this installation if you are not confident in your ability to complete all of the steps in the procedure; consult a trained technician.

NOTE: Pictures shown are of chrome parts. Installation of **BLACK** parts will be the same.

STEP 2

Determine the left from the right side (sitting on bike) Halo Trim Rings. The wire will exit the Trim Ring towards the headlight. PIC 1

CUSTOMER SERVICE

877.370.3604 (toll free)

INSTALLATION QUESTIONS

techsupport@kuryakyn.com
or call 715.247.2983

LIMITED WARRANTY

Küryakyn warrants that any Küryakyn products sold hereunder, shall be free of defects in materials and workmanship for a period of one (1) year from the date of purchase by the consumer excepting the following provisions:

- Küryakyn shall have no obligation in the event the customer is unable to provide a receipt showing the date the customer purchased the product(s).
- The product must be properly installed, maintained and operated under normal conditions.
- Küryakyn makes no warranty, expressed or implied, with respect to any gold plated products.
- Küryakyn shall not be liable for any consequential and incidental damages, including labor and paint, resulting from failure of a Küryakyn product, failure to deliver, delay in delivery, delivery in nonconforming condition, or for any breach of contract or duty between Küryakyn and a customer.
- Küryakyn products are often intended for use in specific applications. Küryakyn makes no warranty if a Küryakyn product is used in applications other than intended.
- Küryakyn electrical products are warranted for one (1) year from the date of purchase by the consumer. L.E.D.'S contained in components of Küryakyn products will be warranted for defects in materials and workmanship for 3 years from the date of purchase where as all other components shall be warranted for one(1) year. This includes, but is not limited to; control modules, wiring, chrome & other components.
- Küryakyn makes no warranty of any kind in regard to other manufacturer's products distributed by Küryakyn. Küryakyn will pass on all warranties made by the manufacturer and where possible, will expedite the claim on behalf of the customer, but ultimately, responsibility for disposition of the warranty claim lies with the manufacturer.

ABOUT OUR CATALOG

For purchasing Küryakyn® products, you can receive a complete catalog free of charge.

Send the Proof-of-Purchase below with your address to: Küryakyn, P.O. Box 339, Somerset, WI 54025.

Please indicate either Accessories Catalog for Harley-Davidson® or GL & Metric Cruisers.

Be sure to ask your local dealer about other Küryakyn® products, the motorcycle parts and accessories designed for riders by riders.

©2005 Küryakyn USA® All Rights reserved.



kuryakyn.com

STEP 3

Remove the stock trim ring from the Right spot lamp by removing the screw and nut from the bottom of the ring. PIC 2 set these aside, they will not be reused. Hold on to the lamp. Once the trim ring is removed, it can fall out.

STEP 4

Install the new Halo Trim Ring to the spot lamp using the included Phillips Pan Head Screw and Custom Nut. The L.E.D. Halo Light Ring will seat next to the front of the Trim Ring. The post on the bottom of the Light Ring will fit in the notch on the bottom of the Trim Ring. PIC 3 When the locating pin is between the notch, gently press the harness against the Trim Ring. PIC 4 this will help keep the harness from being pinched between the Halo Ring and the spot lamp.

STEP 5

Tighten the Phillips Pan Screw with a #2 Phillips Head Screwdriver while you hold the Custom Nut. As you tighten the Screw, make sure the back edge of the Trim Ring is in the groove on the driving light housing. Gently shake the light after tightening to ensure the Trim Ring is secure.

NOTE: If you have difficulty assembling the Halo Trim Ring and spot lamp using the OEM backing ring, remove the Halo Trim Ring and the spot lamp from the housing. Remove the OEM backing ring and apply one of the included foam strips to the back of each spot lamp. PIC 5 Reinstall the lamp and Halo Trim Ring. Foam strips may need to be trimmed for proper fit.

STEP 6

Route the wire harness from the Halo Trim Ring along the existing spot lamp harness to the inside of the fairing or headlight cowl. Secure the harness with the included cable ties.

STEP 7

Repeat Steps 3, 4, 5 and 6 for the left side. Proceed to the wiring section for your model.

NOTICE

It is the installer's responsibility to ensure that all of the fasteners (including pre-assembled) are tightened before operation of the motorcycle. Kuryakyn will not issue a warranty on components lost due to improper installation. Periodic maintenance may be required.

WIRING FOR FLST MODELS

STEP 8

Remove the left (sitting on bike) rear side of the headlight cowl as per the service manual.

STEP 9

Locate the GRAY/BLACK stripe wire attached to the toggle switch mounted on the left rear cowl. Install two of the included Female T-Tap Connectors to this wire.

STEP 10

Locate a ground wire. This is usually a BLACK wire. Use the wire schematic in the service manual or a test light to confirm that you have a Ground wire. Attach two of the included Female T-Tap Connectors to this wire.

NOTICE

Kuryakyn recommends the use of dielectric grease on electrical connections.

STEP 11

Plug the Male Spades on the RED wires in the Halo Trim Ring harnesses to the Female T-Taps on the GRAY/BLACK stripe wire. Plug the BLACK wires from the Halo Trim Ring harnesses to the determined Ground wire.

STEP 12

Test the Halo Trim Rings and spot lamps to see if they operate with the switch correctly. Replace the headlight cowl.

WARNING

ENSURE PROPER LIGHT OPERATION BEFORE RIDING THE MOTORCYCLE. VISIBILITY IS A MAJOR CONCERN FOR MOTORCYCLISTS. A LIGHT MALFUNCTION COULD RESULT IN DEATH OR SERIOUS INJURY.

NOTICE

Secure all wiring away from any moving parts, pinch points or extreme heat. Kuryakyn WILL NOT issue a warranty on any electrical component that fails due to pinched, crimped, broken, abraded, melted or frayed wires.

-cont.-

Kuryakyn®

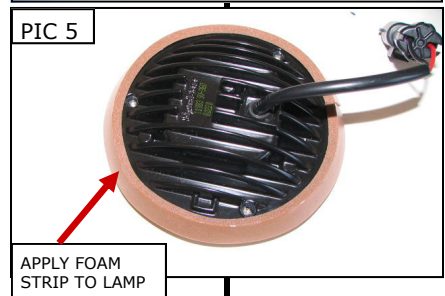
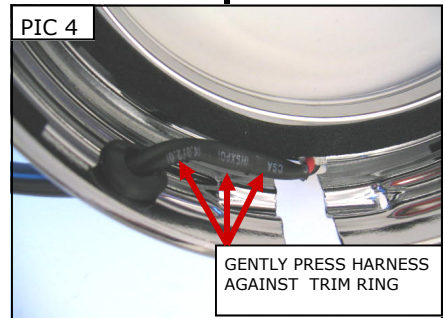
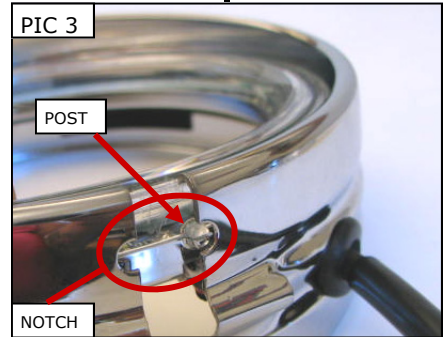
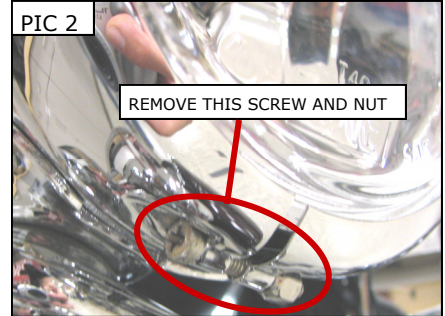
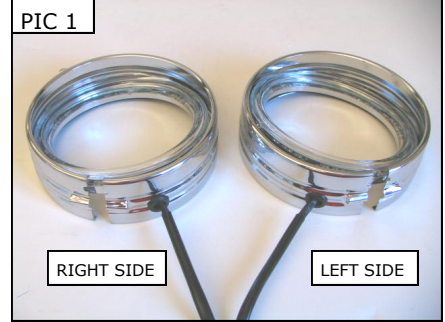

PAGE
2

L.E.D. HALO TRIM RING/SPOT LAMPS INSTALLATION

WIRING FOR FLHT MODELS

STEP 13 Remove the outer fairing as per the service manual.

STEP 14 **On '06 and Later Models:** Locate the stock turn signal connectors. The connectors are located on the inside of the inner fairing, mounted to each inner fairing brace. PIC 6 There will be one violet wire, one blue wire, one gray wire and one black wire coming out of the connector. Attach a Female T-Tap Connector to the GRAY/BLACK stripe wire on each side. Attach a Female T-Tap Connector to the BLACK wire on each side of this harness.

On '05 and Earlier Models: Locate the GRAY/BLACK wire that operates the spot lamps. Attach two of the included Female T-Tap Connectors to this wire. PIC 7 Locate a ground wire. This is usually a BLACK wire. Use the wire schematic in the service manual or a test light to confirm that you have a Ground wire. Attach two of the included Female T-Tap Connectors to this wire.

NOTICE

Küryakyn recommends the use of dielectric grease on electrical connections.

STEP 15 Plug the Male Spades on the RED wires in the Halo Trim Ring harnesses to the Female T-Taps on the GRAY/BLACK wires. Plug the Male Spades on the BLACK wires from the Halo Trim Ring harnesses to the Female T-Taps on the BLACK wires.

STEP 16 Test the Halo Trim Rings and spot lamps to see if they operate with the switch correctly. Replace the outer fairing.



WARNING ENSURE PROPER LIGHT OPERATION BEFORE RIDING THE MOTORCYCLE. VISIBILITY IS A MAJOR CONCERN FOR MOTORCYCLISTS. A LIGHT MALFUNCTION COULD RESULT IN DEATH OR SERIOUS INJURY.

NOTICE

Secure all wiring away from any moving parts, pinch points or extreme heat. Küryakyn WILL NOT issue a warranty on any electrical component that fails due to pinched, crimped, broken, abraded, melted or frayed wires.

WIRING FOR FLHR MODELS

STEP 17 Remove the headlight from the headlight shroud per the service manual.

STEP 18 Locate the GRAY/BLACK wire that operates the spot lamps. PIC 8 Attach two of the included Female T-Tap Connectors to this wire.

STEP 19 Locate a ground wire. This is usually a BLACK wire. Use the wire schematic in the service manual or a test light to confirm that you have a Ground wire. Attach two of the included Female T-Tap Connectors to this wire.

NOTICE

Küryakyn recommends the use of dielectric grease on electrical connections.

STEP 20 Plug the Male Spades on the RED wires in the Halo Trim Ring harnesses to the Female T-Taps on the GRAY/BLACK stripe wire. Plug the BLACK wires from the Halo Trim Ring harnesses to the determined Ground wire.

STEP 21 Test the Halo Trim Rings and spot lamps to see if they operate with the switch correctly. Replace the headlight.



WARNING ENSURE PROPER LIGHT OPERATION BEFORE RIDING THE MOTORCYCLE. VISIBILITY IS A MAJOR CONCERN FOR MOTORCYCLISTS. A LIGHT MALFUNCTION COULD RESULT IN DEATH OR SERIOUS INJURY.

NOTICE

It is the installer's responsibility to ensure that all of the fasteners (including pre-assembled) are tightened before operation of the motorcycle. Küryakyn will not issue a warranty on components lost due to improper installation. Periodic maintenance may be required.

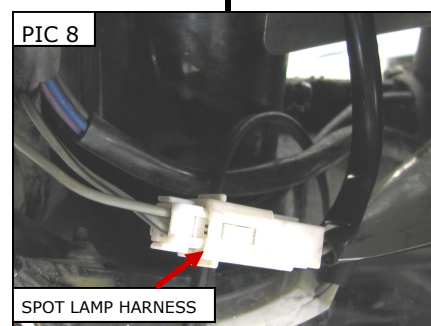
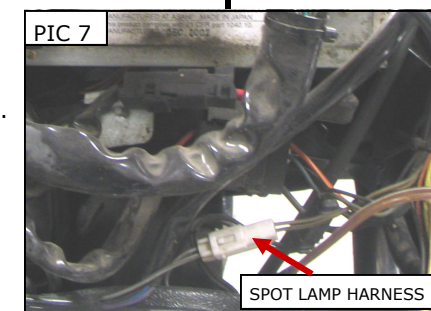
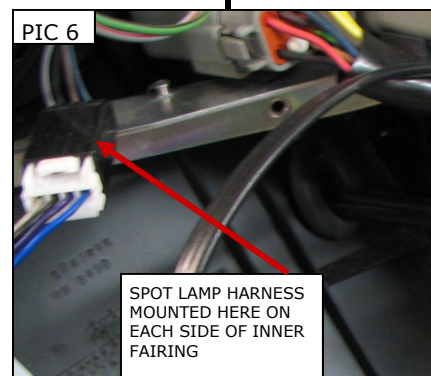

Ride On!